

|      |          |
|------|----------|
| Area | Form no. |
|      | 536      |

MASSACHUSETTS HISTORICAL COMMISSION  
80 Boylston Street, Boston, MA 02116

PHOTO (3x3" or 3x5", black & white)  
Staple to left side of form  
Photo number \_\_\_\_\_

SKETCH MAP

Draw map showing property's location in relation to nearest cross streets and other buildings or geographical features.  
Indicate north.

Recorded by Betsy Friedberg  
Organization Mass. Historical Commission  
Date 1/85

Town Arlington  
Address 1007 Massachusetts Avenue  
Historic Name Highland Hose House  
Use: Original Fire House  
Present Fire House  
Ownership:  Private individual  
Private organization \_\_\_\_\_  
Public Town of Arlington  
Original owner Town of Arlington

DESCRIPTION:

Date 1928  
Source Building Permit  
Style Georgian Revival  
Architect George Ernest Robinson  
Exterior wall fabric Red-Brick  
Outbuildings None  
Major alterations (with dates) None  
Moved No Date N/A  
Approx. acreage less than one acre  
Setting This fire station is located in the midst of a dense area of commercial building and multifamily housing.  
UTM: 19/321550/4698460

ARCHITECTURAL SIGNIFICANCE (describe important architectural features and evaluate in terms of other buildings within community)

The Highland Hose House is a brick structure built in 1928 in conscious imitation of several of Boston's 18th and early 19th century buildings. Its stepped gable ends and rounded windows are reminiscent of the Old State House, while its delicate cupola and gilded grass-hopper weathervane imitate Faneuil Hall. Violet-paned windows copy those of Bulfinch townhouses along Boston Common.

HISTORICAL SIGNIFICANCE (explain the role owners played in local or state history and how the building relates to the development of the community)

This fire station was one of several built in Arlington in response to increasing suburbanization. The building's architect, George Ernest Robinson, of Belmont, also designed Arlington's Central Fire Station (1926; Town Center Historic District). Interior woodwork by the Theodore Schwamb Company was that company's first commission after the firm converted its milling and cabinetry operation from the manufacture of pianocases to architectural woodworking. The station contains a bronze relief of Fire Chief Charles Goff, to whom the station was dedicated. The relief was done by Cyrus Dallin, nationally known sculptor and Arlington resident.

CRITERIA FOR EVALUATION

A well-detailed Georgian Revival building, Highland Hose House reflects a major growth period in Arlington's history, and a period of strong municipal response to that growth. It retains integrity of setting, design, location, materials, workmanship, feeling, and association, and fulfills Criteria A and C of the National Register of Historic Places.

BIBLIOGRAPHY and/or REFERENCES

Arlington Heritage Trust, Arlington Celebrates the Growing Years: 1875-1975. Arlington, 1977.  
Building Permit  
Assessors Records

**United States Department of the Interior  
National Park Service**

**National Register of Historic Places  
Inventory—Nomination Form**

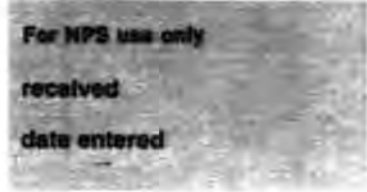

Continuation sheet

Item number

Page

Multiple Resource Area  
Thematic Group

Name Arlington Multiple Resource Area  
State Middlesex County, MASSACHUSETTS

Nomination/Type of Review

Date/Signature

21. First Parish Church  
Parsonage

Entered in the  
National Register

for Keeper  
Attest

Delores Byers 4/18/85

22. Hall, Edward, House

Entered in the  
National Register

for Keeper  
Attest

Delores Byers 4/18/85

23. Highland Hose House

Entered in the  
National Register

for Keeper  
Attest

Delores Byers 4/18/85

24. Hill, Addison, House

Entered in the  
National Register

for Keeper  
Attest

Delores Byers 9/27/85

25. Hornblower, Edward, House  
and Barn

Entered in the  
National Register

for Keeper  
Attest

Delores Byers 4/18/85

26. House at 45 Claremont Avenue

Entered in the  
National Register

for Keeper  
Attest

Delores Byers 4/18/85

27. House at 5--7 Winter Street

Entered in the  
National Register

for Keeper  
Attest

Delores Byers 4/18/85

28. House at 5 Willow Court

Entered in the  
National Register

for Keeper  
Attest

Delores Byers 4/18/85

29. Kimball, W.W., House

Entered in the  
National Register

for Keeper  
Attest

Delores Byers 4/18/85

30. Locke, Lt. Benjamin, Store

Entered in the  
National Register

for Keeper  
Attest

Delores Byers 4/18/85

NATIONAL REGISTER OF HISTORIC PLACES  
EVALUATION/RETURN SHEET

Highland Hose House (Arlington MRA)  
Middlesex County  
MASSACHUSETTS

Working No. MAR 6 1985  
Fed. Reg. Date: 2/4/86  
Date Due: 4/4/85 - 4/20/85  
Action:  ACCEPT 4-18-85  
 RETURN  
 REJECT  
Federal Agency: \_\_\_\_\_

Entered in the  
National Register

- resubmission
- nomination by person or local government
- owner objection
- appeal

Substantive Review:  sample  request  appeal  NR decision

Reviewer's comments:

Recom./Criteria \_\_\_\_\_  
Reviewer \_\_\_\_\_  
Discipline \_\_\_\_\_  
Date \_\_\_\_\_  
\_\_\_\_\_ see continuation sheet

Nomination returned for: \_\_\_\_\_ technical corrections cited below  
\_\_\_\_\_ substantive reasons discussed below

1. Name

2. Location

3. Classification

| Category | Ownership<br>Public Acquisition | Status<br>Accessible | Present Use |
|----------|---------------------------------|----------------------|-------------|
|----------|---------------------------------|----------------------|-------------|

4. Owner of Property

5. Location of Legal Description

6. Representation in Existing Surveys

Has this property been determined eligible?  yes  no

7. Description

|                                    |                                       |                                    |   |
|------------------------------------|---------------------------------------|------------------------------------|---|
| Condition                          |                                       | Check one                          | Check one                                 |
| <input type="checkbox"/> excellent | <input type="checkbox"/> deteriorated | <input type="checkbox"/> unaltered | <input type="checkbox"/> original site    |
| <input type="checkbox"/> good      | <input type="checkbox"/> ruins        | <input type="checkbox"/> altered   | <input type="checkbox"/> moved date _____ |
| <input type="checkbox"/> fair      | <input type="checkbox"/> unexposed    |                                    |   |

Describe the present and original (if known) physical appearance

- summary paragraph
- completeness
- clarity
- alterations/integrity
- dates
- boundary selection

---

**8. Significance**

Period \_\_\_\_\_ Areas of Significance—Check and justify below

Specific dates \_\_\_\_\_ Builder/Architect \_\_\_\_\_

Statement of Significance *(in one paragraph)*

- summary paragraph
- completeness
- clarity
- applicable criteria
- justification of areas checked
- relating significance to the resource
- context
- relationship of integrity to significance
- justification of exception
- other

STATE OF MASSACHUSETTS  
SHERIFF  
MIDDLESEX COUNTY  
100 STATE STREET  
BOSTON, MASSACHUSETTS 02109  
TEL: 617-725-2000

---

**9. Major Bibliographical References**

---

**10. Geographical Data**

Acreage of nominated property \_\_\_\_\_

Quadrangle name \_\_\_\_\_

UTM References \_\_\_\_\_

---

Verbal boundary description and justification

---

**11. Form Prepared By**

---

**12. State Historic Preservation Officer Certification**

The evaluated significance of this property within the state is:

\_\_\_\_ national      \_\_\_\_ state      \_\_\_\_ local

State Historic Preservation Officer signature

title \_\_\_\_\_ date \_\_\_\_\_

---

**13. Other**

- Maps
- Photographs
- Other

Questions concerning this nomination may be directed to \_\_\_\_\_

Signed \_\_\_\_\_ Date \_\_\_\_\_ Phone: \_\_\_\_\_



Highland

Fire Station - Arlington Heights  
Mass. Ave.

Highland Hose Access

~~Fire House~~

1067 Mass Ave  
Arlington NRA

819M

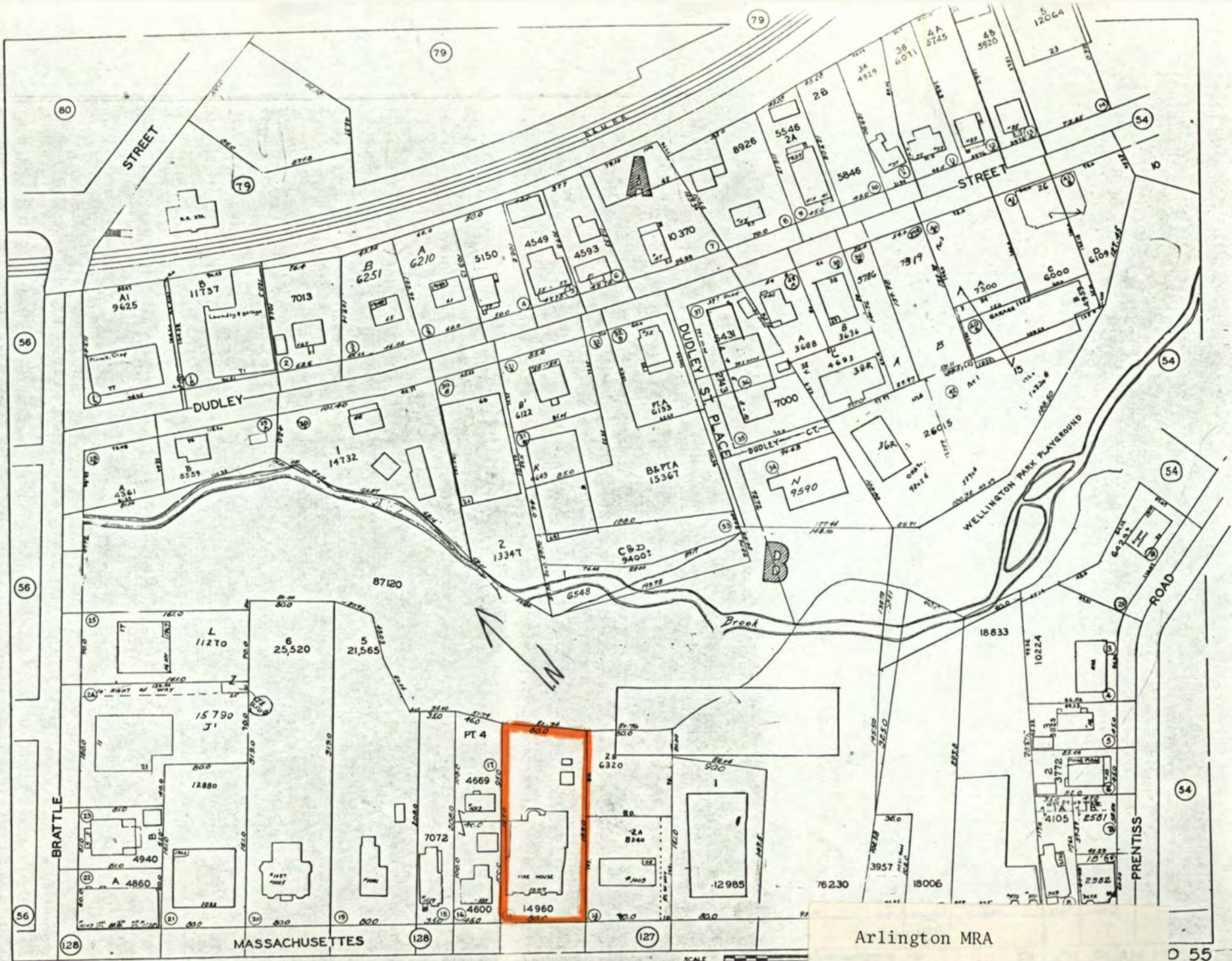

Arlington MRA

1007 Massachusetts Avenue  
Highland Hose House

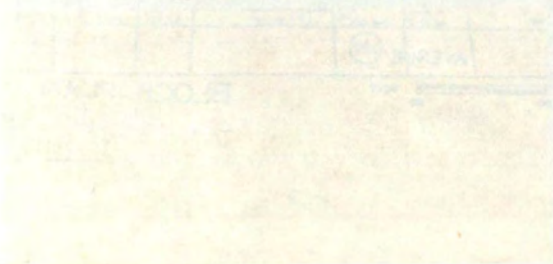

Highland Hose House