

1380

United States Department of the Interior
National Park Service

NATIONAL REGISTER OF HISTORIC PLACES
REGISTRATION FORM

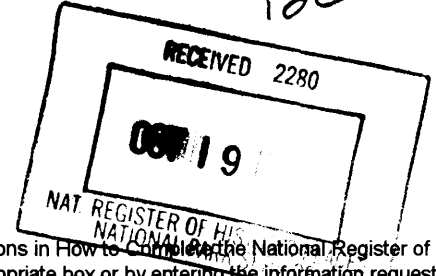

This form is for use in nominating or requesting determinations for individual properties and districts. See instructions in How to Complete the National Register of Historic Places Registration Form (National Register Bulletin 16A). Complete each item by marking "x" in the appropriate box or by entering the information requested. If any item does not apply to the property being documented, enter "N/A" for "not applicable." For functions, architectural classification, materials, and areas of significance, enter only categories and subcategories from the instructions. Place additional entries and narrative items on continuation sheets (NPS Form 10-900a). Use a typewriter, word processor, or computer, to complete all items.

1. Name of Property

historic name First Street School
other names/site number DeRidder Grammar School, DeRidder Elementary School

2. Location

street & number 500 West First Street NA not for publication
city or town DeRidder NA vicinity
state Louisiana code LA county Beauregard code 011 zip code 70634

3. State/Federal Agency Certification

As the designated authority under the National Historic Preservation Act of 1986, as amended, I hereby certify that this X nomination request for determination of eligibility meets the documentation standards for registering properties in the National Register of Historic Places and meets the procedural and professional requirements set forth in 36 CFR Part 60. In my opinion, the property X meets does not meet the National Register Criteria. I recommend that this property be considered significant nationally statewide X locally. (See continuation sheet for additional comments.)

Gerri Hobdy 10/9/98
Signature of certifying official/Title Gerri Hobdy, Date
Louisiana SHPO, Department of Culture, Recreation and Tourism
State or Federal agency and bureau

In my opinion, the property meets does not meet the National Register criteria. (See continuation sheet for additional comments.)

Signature of certifying official/Title _____ Date _____
State or Federal agency and bureau _____

4. National Park Service Certification

I, hereby certify that this property is:

- entered in the National Register
 See continuation sheet.
- determined eligible for the
National Register
 See continuation sheet.
- determined not eligible for the
National Register
- removed from the National
Register
- other (explain): _____

Edson H. Beall 11-19-98
Signature of Keeper Date of Action

First Street School
Name of property

Beauregard Parish, LA
County and State

5. Classification

Ownership of Property
(Check as many boxes as apply)

Category of Property
(Check only one box)

Number of Resources within Property
(Do not include previously listed resources in the count.)

- private
- public-local
- public-State
- public-Federal

- building(s)
- district
- site
- structure
- object

Contributing	Noncontributing	
1	—	buildings
—	—	sites
—	—	structures
—	—	objects
1	0	Total

Name of related multiple property listing
(Enter "N/A" if property is not part of a multiple property listing.)

Number of contributing resources previously listed in the National Register

NA

0

6. Function or Use

Historic Functions

(Enter categories from instructions)

Cat. Education

Sub. School

Current Functions

(Enter categories from instructions)

Cat. Education

Sub. School

7. Description

Architectural Classification

(Enter categories from instructions)

Moderne

Materials

(Enter categories from instructions)

foundation Concrete

walls Brick

roof Asbestos

other _____

Narrative Description

(Describe the historic and current condition of the property on one or more continuation sheets.)

8. Statement of Significance

Applicable National Register Criteria

(Mark "X" next to the criteria qualifying the property for National Register listing)

- A** Property is associated with events that have made a significant contribution to the broad patterns of our history.
- B** Property is associated with the lives of persons significant in our past.
- C** Property embodies the distinctive characteristics of a type, period, or method of construction or represents the work of a master, or possesses high artistic values, or represents a significant and distinguishable entity whose components lack individual distinction.
- D** Property has yielded, or is likely to yield information important in prehistory or history.

Criteria Considerations NA
(Mark "X" next to all that apply.)

- A** owned by a religious institution or used for religious purposes.
- B** removed from its original location.
- C** a birthplace or a grave.
- D** a cemetery.
- E** a reconstructed building, object, or structure.
- F** a commemorative property.
- G** less than 50 years of age or achieved significance within the past 50 years.

Areas of Significance

(Enter categories from instructions)

Architecture

Period of Significance

1940

1948

Significant Dates

1940

1948

Significant Person

(Complete if Criterion B is marked above)

NA

Cultural Affiliation

NA

Architect/Builder

1940 Section--Max Heinberg, Alexandria, LA

1948 Section--Barron & Heinberg, Alexandria, LA

Narrative Statement of Significance

(Explain the significance of the property on one or more continuation sheets.)

9. Major Bibliographical References

(Cite the books, articles, and other sources used in preparing this form on one or more continuation sheets.)

- Previous documentation on file (NPS):** NA
- preliminary determination of individual listing (36 CFR 67) has been requested.
 - previously listed in the National Register
 - previously determined eligible by the National Register
 - designated a National Historic Landmark
 - recorded by Historic American Buildings Survey # _____
 - recorded by Historic American Engineering Record # _____

Primary location of additional data:

- State Historic Preservation Office
 - Other State agency
 - Federal agency
 - Local government
 - University
 - Other
- Name of repository: _____

First Street School
Name of property

Beauregard Parish, LA
County and State

10. Geographical Data

Acreage of Property Approximately 4 acres

UTM References

(Place additional UTM references on a continuation sheet)

Zone Easting Northing Zone Easting Northing

1 15 472300 3412600

2 _____

3 _____

4 _____

___ See continuation sheet.

Verbal Boundary Description

(Describe the boundaries of the property on a continuation sheet.)

Boundary Justification

(Explain why the boundaries were selected on a continuation sheet.)

11. Form Prepared By

name/title National Register Staff

organization Division of Historic Preservation date June 1998

street & number P.O. Box 44247 telephone (225) 342-8160

city or town Baton Rouge state LA zip code 70804

Additional Documentation

Submit the following items with the completed form:

Continuation Sheets

Maps

A **USGS map** (7.5 or 15 minute series) indicating the property's location.

A **sketch map** for historic districts and properties having large acreage or numerous resources.

Photographs

Representative **black and white** photographs of the property.

Additional items

(Check with the SHPO or FPO for any additional items)

Property Owner

(Complete this item at the request of the SHPO or FPO.)

name Beauregard Parish School Board, Frances Jouban, President, F. Gary Brewer, Superintendent

street & number P. O. Drawer 938 telephone (318) 463-5551

city or town DeRidder state LA zip code 70634

Paperwork Reduction Act Statement: This information is being collected for applications to the National Register of Historic Places to nominate properties for listing or determine eligibility for listing, to list properties, and to amend existing listings. Response to this request is required to obtain a benefit in accordance with the National Historic Preservation Act, as amended (16 U.S.C. 470 et seq.).

Estimated Burden Statement: Public reporting burden for this form is estimated to average 18.1 hours per response including the time for reviewing instructions, gathering and maintaining data, and completing and reviewing the form. Direct comments regarding this burden estimate or any aspect of this form to the Chief, Administrative Services Division, National Park Service, P.O. Box 37127, Washington, DC 20013-7127; and the Office of Management and Budget, Paperwork Reductions Project (1024-0018), Washington, DC 20503.

**United States Department of the Interior
National Park Service**

NATIONAL REGISTER OF HISTORIC PLACES CONTINUATION SHEET

Section 7 Page 1

DeRidder's First Street School is a two-story brick structure erected in 1940 and expanded in 1948 in keeping with its original restrained Modernistic styling. The school's campus lies only half a block from the Beauregard Parish Courthouse, and the DeRidder central business district is only a short distance further east. Although the facade stands quite close to a busy, tree-lined street, the rear elevation faces a large playground. The entire campus occupies approximately four acres. The school has experienced very little alteration since the 1948 expansion, and it remains eligible for National Register listing.

The original (1940) building consists of a central block with a forward-projecting wing on each side, set at an angle. The central block features a recessed entrance; the wings contain classrooms. The school's small original auditorium survives on the central block's second level. The previously mentioned 1948 wing is set to the rear of the central block. It contains a two-story auditorium flanked by one-story hallways and classrooms. (An outline of the building's footprint is included with the boundary sketch map.)

The school's Modernistic features are found primarily in the geometry expressed on the central block and at the end of each original wing. A series of superimposed masses and pilasters gives the facade of the multi-bay central block a visual energy. The pilasters separate the facade's three centermost bays, further reinforce the main block's stepped nature, and also emphasize its verticality. The end of each wing exhibits three Modernistic features. The first is a recessed secondary building entrance which adjoins a curved alcove containing a large curved window filled with glass blocks. The second is a set of two narrow, vertical, glass block windows. Located above the recessed entrance, these also suggest verticality while strongly reinforcing the geometric character of the building. The third is a pair of low curved walls (similar to balustrades) which flank the steps leading to the side entrance. Another interesting geometric feature on the exterior is the fact that the building's brick walls are laid in a manner to form horizontal bands. This effect is achieved through the use of a slightly darker shade of brick laid with its header turned outward within every sixth brick course.

On the interior, hallway pilasters mimic the uneven surface of the central block's facade. In the 1948 auditorium angled walls, severely rectangular half walls separating seating areas from walkways, and the sharply projecting rectangular projection room also reflect the geometrical emphasis of the Modernistic style. Interestingly, the balcony's pipe-like railings suggest the influence of the International style. Although

CONTINUED

**United States Department of the Interior
National Park Service****NATIONAL REGISTER OF HISTORIC PLACES
CONTINUATION SHEET**Section 7 Page 2

not a Modernistic motif, concrete hallway floors scored to resemble large stone blocks are another interesting feature. Otherwise, the interiors of the 1940 building and the classroom sections of the 1948 addition are typical of period schools. Classrooms are characterized by large windows providing ample light and doors with multi-light transoms. Most classrooms retain their original slate blackboards.

Alterations to the First Street School include the addition of ceiling tiles in the classrooms and hallways, the loss of some baseboards and chair rails, and the construction (during the 1950s) of a small incinerator attached to the wall of one 1948 classroom. The latter's ruin remains in place. The 1960s saw alterations to the auditorium's orchestra pit. Finally, the building's present roof has failed in places, causing water damage in many of the second floor rooms. (Plans are underway to replace the roof.) None of the above alterations has impacted the building's restrained Modernistic styling, with the result that the facade and important curved alcoves on the side wings remain entirely intact. As a rare architectural landmark within the community of DeRidder, the First Street School is a legitimate candidate for National Register listing.

**United States Department of the Interior
National Park Service****NATIONAL REGISTER OF HISTORIC PLACES
CONTINUATION SHEET**Section 8 Page 1

DeRidder's First Street School is locally significant in the area of architecture because it is one of very few "high style" buildings in the community.

Founded at the turn of the century and incorporated in 1914, DeRidder does not have very many buildings which are high quality examples of specific architectural styles. The historic building stock consists largely of vernacular commercial buildings and fairly plain residences (mostly bungalows) from the 1910-1940 period. Important exceptions include the Beaux Arts courthouse, the Gothic Revival Beauregard Parish Jail, and the Classical Revival First Methodist Church. Although the central business district is listed on the National Register, this listing is based upon the fact that the CBD contains Beauregard Parish's largest and best examples of the type of commercial architecture which was constructed in the small towns of Louisiana during the first third of the twentieth century. With two or three exceptions, the CBD does not contain notable architectural landmarks. Against this fairly humble background, the architectural significance of the First Street School emerges. Its Modernistic facade is one of only two examples of a style which was rare in Louisiana and even more rare in the state's small towns. And, although there is a second building with slight Modernistic touches in the CBD, the school is by far the more convincing example.

Historical Note

Although it has never undergone an official name change, the candidate has been known by three titles over the years. Beauregard Parish School Board minutes refer to it as the DeRidder Grammar School for the first year of its existence. However, the minutes also show that it was called First Street School throughout the 1940s. Later it became known as DeRidder Elementary School. Because "First Street School" is a name associated with the historic period, that term has been chosen for use in this nomination.

The land upon which the school stands has been used for educational purposes since 1906. In that year the Ludington, Wells & Van Schaick Company (a lumber concern) donated the site to Calcasieu Parish, of which DeRidder was at that time a part. The current building is the third school to be constructed on the site and was built after a 1938 fire destroyed its predecessor. The school population grew to such an extent that it was necessary to utilize three Civilian Conservation Corps buildings as additional classrooms until the new auditorium and classroom wing was finished in 1948. The building served as an elementary school until 1980. Since that time its

CONTINUED

**United States Department of the Interior
National Park Service**

**NATIONAL REGISTER OF HISTORIC PLACES
CONTINUATION SHEET**

Section $\frac{8}{9}$ Page $\frac{2}{1}$
 $\frac{10}{1}$

second floor and the large auditorium have been used for storage. The first floor houses the parish teacher's credit union, an adult education center, a professional education library, facilities for special education, the school nursing program, a computer repair center, and the GED program. Current plans call for the school board to move into the building. An organization known as "Friends of DeRidder Elementary" is working to restore the building.

BIBLIOGRAPHY

Division of Historic Preservation staff knowledge of DeRidder's historic building stock.

Lane, Pat and Smith, Velmer. *Historical Sketch: First Street School, DeRidder, Beauregard Parish, Louisiana*, typescript; copy in National Register file.

Site visit by National Register staff.

BOUNDARY DESCRIPTION:

Please see attached sketch map.

BOUNDARY JUSTIFICATION:

Boundaries follow current property lines, which coincide with historic property lines.

First Street School
DeRidder, Beauregard Parish, LA

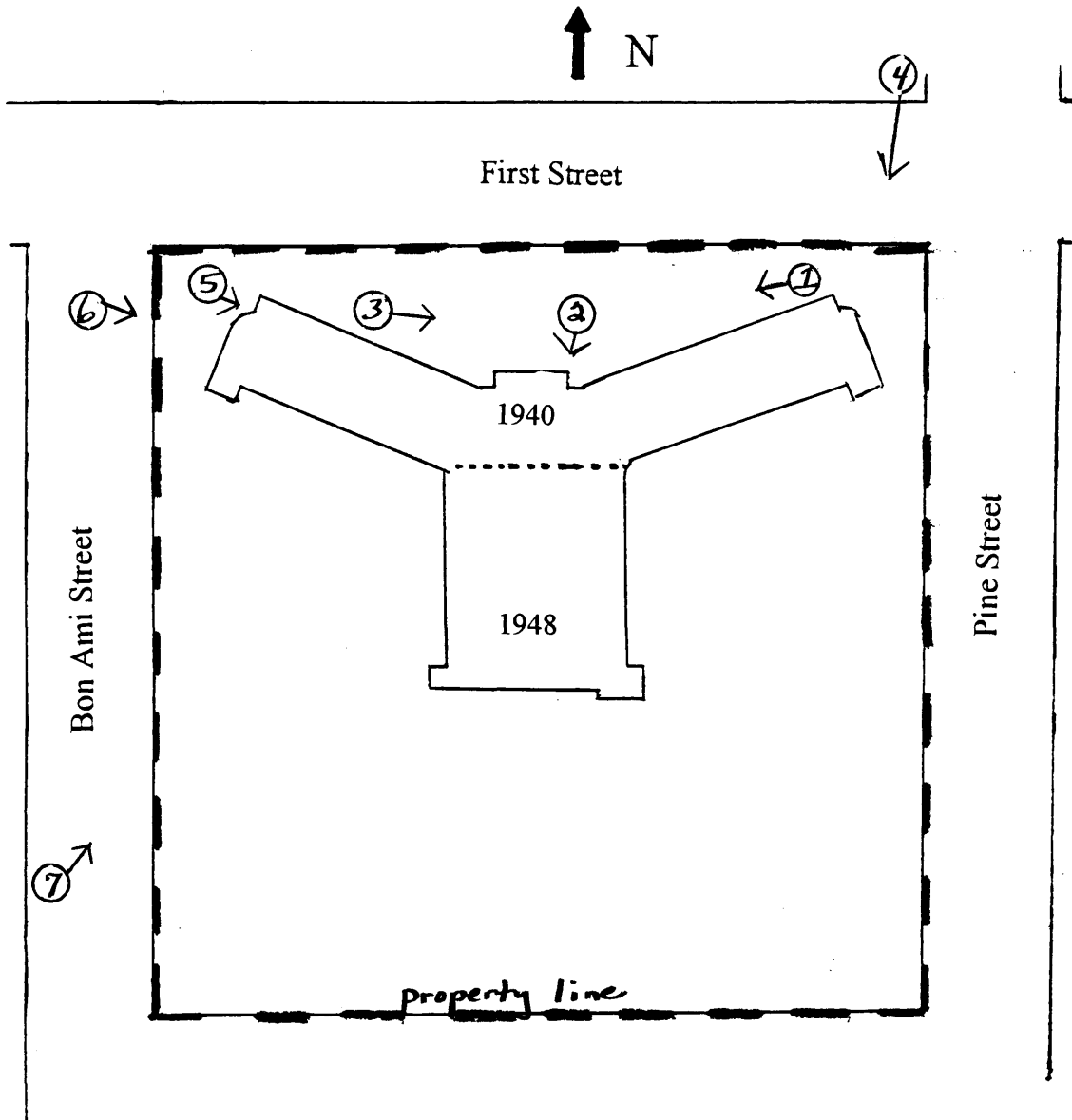

Scale: 1" = 100'

--- BOUNDARY