

United States Department of the Interior  
National Park Service

For NPS use only

National Register of Historic Places  
Inventory—Nomination Form

received OCT 19 1987

date entered NOV 20 1987

See instructions in *How to Complete National Register Forms*  
Type all entries—complete applicable sections

1. Name

historic Masonic Home for Children

and or common same

2. Location

street & number 5800 Masonic Drive

N/A not for publication

city, town Alexandria N/A vicinity of

state LA code 22 county Rapides Parish code 079

3. Classification

Category	Ownership	Status	Present Use
<input type="checkbox"/> district	<input type="checkbox"/> public	<input checked="" type="checkbox"/> occupied	<input type="checkbox"/> agriculture
<input checked="" type="checkbox"/> building(s)	<input checked="" type="checkbox"/> private	<input type="checkbox"/> unoccupied	<input type="checkbox"/> commercial
<input type="checkbox"/> structure	<input type="checkbox"/> both	<input type="checkbox"/> work in progress	<input type="checkbox"/> educational
<input type="checkbox"/> site	<b>Public Acquisition</b>	<b>Accessible</b>	<input type="checkbox"/> entertainment
<input type="checkbox"/> object	<input type="checkbox"/> N/A in process	<input checked="" type="checkbox"/> yes: restricted	<input type="checkbox"/> government
	<input type="checkbox"/> N/A being considered	<input type="checkbox"/> yes: unrestricted	<input type="checkbox"/> industrial
		<input type="checkbox"/> no	<input type="checkbox"/> military
			<input type="checkbox"/> museum
			<input type="checkbox"/> park
			<input type="checkbox"/> private residence
			<input type="checkbox"/> religious
			<input type="checkbox"/> scientific
			<input type="checkbox"/> transportation
			<input checked="" type="checkbox"/> other: orphanage

4. Owner of Property

name Grand Lodge of the State of Louisiana, Free and Accepted Masons

street & number 333 St. Charles Avenue

city, town New Orleans N/A vicinity of state LA 70130

5. Location of Legal Description

courthouse, registry of deeds, etc. Rapides Parish Courthouse

street & number 701 Murray Street P. O. Box 952

city, town Alexandria state LA 71301

6. Representation in Existing Surveys

title Louisiana Comprehensive Historic Structures Survey has this property been determined eligible?  yes  no

date 1986  federal  state  county  local

depository for survey records Louisiana State Historic Preservation Office

city, town Baton Rouge state LA

## 7. Description

<b>Condition</b>		<b>Check one</b>	<b>Check one</b>	
<input type="checkbox"/> excellent	<input type="checkbox"/> deteriorated	<input type="checkbox"/> unaltered	<input checked="" type="checkbox"/> original site	
<input checked="" type="checkbox"/> good	<input type="checkbox"/> ruins	<input checked="" type="checkbox"/> altered	<input type="checkbox"/> moved	date <u>N/A</u>
<input type="checkbox"/> fair	<input type="checkbox"/> unexposed			

### **Describe the present and original (if known) physical appearance**

The Masonic Home for Children (1924) is a two-story brick Italian Renaissance style institutional building located in a park-like setting on the outskirts of Alexandria. The building has not been significantly altered since construction.

Set on an English basement, the Masonic Home has a symmetrical plan with a central entrance. The foyer leads to a two-story common room in the rear. To either side are corridors, each of which leads to a large dormitory space. The interiors are fairly plain, featuring transoms over the doors and chair rails.

The exterior surface of the building is a combination of buff and light brown rough brick laid up in Flemish bond with cast cement accent details. The basic articulation is that of a French Baroque palace--i.e., a central entrance pavilion flanked by hyphen wings and end pavilions. The center is marked by monumental steps leading to a grand Serlian entrance with free-standing Ionic columns, Ionic pilasters, ornamental panels, and a crowning balustrade. This leads to a deep entrance vestibule where the Serlian motif is repeated. Many of the principal windows are surmounted by large lunettes with inset secondary arches. (The arched windows on the facade are obscured by canvas awnings.) The ground story windows on the end pavilions feature a three-part aedicule motif with pilasters and a full entablature. The building is surmounted by a system of hip roofs with wide overhangs and ornamentally cut rafter ends. The roof itself is sheathed in red glazed pantiles. The only other noteworthy exterior features are the ornamental crested grills on the arched windows of the facade and the Vitruvian scroll motif used to accent the second story windows of the central pavilion.

### Alterations/Assessment of Integrity:

In addition to the previously mentioned canvas awnings, some ceilings have been lowered, fire doors have been installed, and the side exits from the building have been fitted with covered walkways. In our opinion, these changes are minor. The canvas awnings are the most noteworthy alteration because they obscure some of the arched windows, but this is a very easily reversible change. In any event, the arched windows are not a major element of the building's architectural significance.

### Contributing Elements:

Adjacent to the Masonic Home is a contemporaneous one story brick infirmary built by the Masonic Women's Auxiliary. It features low-key neo-classical styling and has brickwork similar to the main building. It is listed as a contributing element.

# 8. Significance

Period	Areas of Significance—Check and justify below			
<input type="checkbox"/> prehistoric	<input type="checkbox"/> archeology-prehistoric	<input type="checkbox"/> community planning	<input type="checkbox"/> landscape architecture	<input type="checkbox"/> religion
<input type="checkbox"/> 1400–1499	<input type="checkbox"/> archeology-historic	<input type="checkbox"/> conservation	<input type="checkbox"/> law	<input type="checkbox"/> science
<input type="checkbox"/> 1500–1599	<input type="checkbox"/> agriculture	<input type="checkbox"/> economics	<input type="checkbox"/> literature	<input type="checkbox"/> sculpture
<input type="checkbox"/> 1600–1699	<input checked="" type="checkbox"/> architecture	<input type="checkbox"/> education	<input type="checkbox"/> military	<input type="checkbox"/> social/ humanitarian
<input type="checkbox"/> 1700–1799	<input type="checkbox"/> art	<input type="checkbox"/> engineering	<input type="checkbox"/> music	<input type="checkbox"/> theater
<input type="checkbox"/> 1800–1899	<input type="checkbox"/> commerce	<input type="checkbox"/> exploration/settlement	<input type="checkbox"/> philosophy	<input type="checkbox"/> transportation
<input checked="" type="checkbox"/> 1900–	<input type="checkbox"/> communications	<input type="checkbox"/> industry	<input type="checkbox"/> politics/government	<input type="checkbox"/> other (specify)
		<input type="checkbox"/> invention		

**Specific dates** 1924 **Builder/Architect** Builder: Grand Lodge of the State of Louisiana

**Statement of Significance (in one paragraph)** Free & Accepted Masons  
Architects: Jones, Roessle, Olschner & Wiener

Criterion C

The Masonic Home for Children is locally significant in the area of architecture because it is a high style architectural landmark within the context of the City of Alexandria. The comprehensive historic structures survey has identified some 3,182 buildings within the city limits that are fifty years old or older. The vast majority of these date from the twentieth century. Almost without exception, these structures reflect the builder's taste. They are either plain, or they feature standard applied details such as bungalow columns or commercial false fronts. The Masonic Home is one of about thirty landmarks in the city that stand above the overall building stock. This can be seen in the following: (1) It is one of only a handful of buildings designed by high style practitioners. (2) It is one of very few buildings that are consistently articulated in a recognized historical style of architecture. (3) It is the city's only sizable example of the Italian Renaissance style. Noteworthy features in this regard include the red pantile roof, the projecting eaves with decorative rafter ends, the impressive Serlian motif entrance, the Vitruvian scrollwork, and the overall classical-Mediterranean character of the building.

## 9. Major Bibliographical References

Rapides Parish Comprehensive Historic Structures Survey, Louisiana State Historic Preservation Office.

Historical sketch based upon Board of Trustee records stored at the Masonic Home for Children.

## 10. Geographical Data

Acreeage of nominated property @ 5 acres

Quadrangle name Alexandria, LA

Quadrangle scale 1:24000

### UTM References

A 

1	5	5	4	9	7	0	0	3	4	5	8	3	0	0
Zone		Easting						Northing						

B 

Zone		Easting						Northing						

C 

Zone		Easting						Northing						

D 

Zone		Easting						Northing						

E 

Zone		Easting						Northing						

F 

Zone		Easting						Northing						

G 

Zone		Easting						Northing						

H 

Zone		Easting						Northing						

### Verbal boundary description and justification

Please refer to enclosed sketch map. Boundaries are irregular and do not follow property lines because there are various low-scale modern buildings on the grounds. The boundaries recognize the park-like setting by including the front lawn and cut closely around the circular driveway, home, and infirmary to exclude adjacent modern buildings.

List all states and counties for properties overlapping state or county boundaries

state	N/A	code	county	code
-------	-----	------	--------	------

state	code	county	code
-------	------	--------	------

## 11. Form Prepared By

name/title National Register Staff

Assisted by Harold W. Moyer,  
Superintendent, Masonic Home  
for Children

organization Division of Historic Preservation  
State of Louisiana

date August 1987

street & number P. O. Box 44247

telephone 504-922-0358

city or town Baton Rouge

state LA 70804

## 12. State Historic Preservation Officer Certification

The evaluated significance of this property within the state is:

national  state  local

As the designated State Historic Preservation Officer for the National Historic Preservation Act of 1966 (Public Law 89-665), I hereby nominate this property for inclusion in the National Register and certify that it has been evaluated according to the criteria and procedures set forth by the National Park Service.

State Historic Preservation Officer signature



Robert B. DeBlieux

title State Historic Preservation Officer

date October 12, 1987

For NPS use only

I hereby certify that this property is included in the National Register

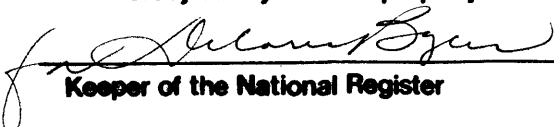

Keeper of the National Register

date 11-20-87

Attest:

date

Chief of Registration

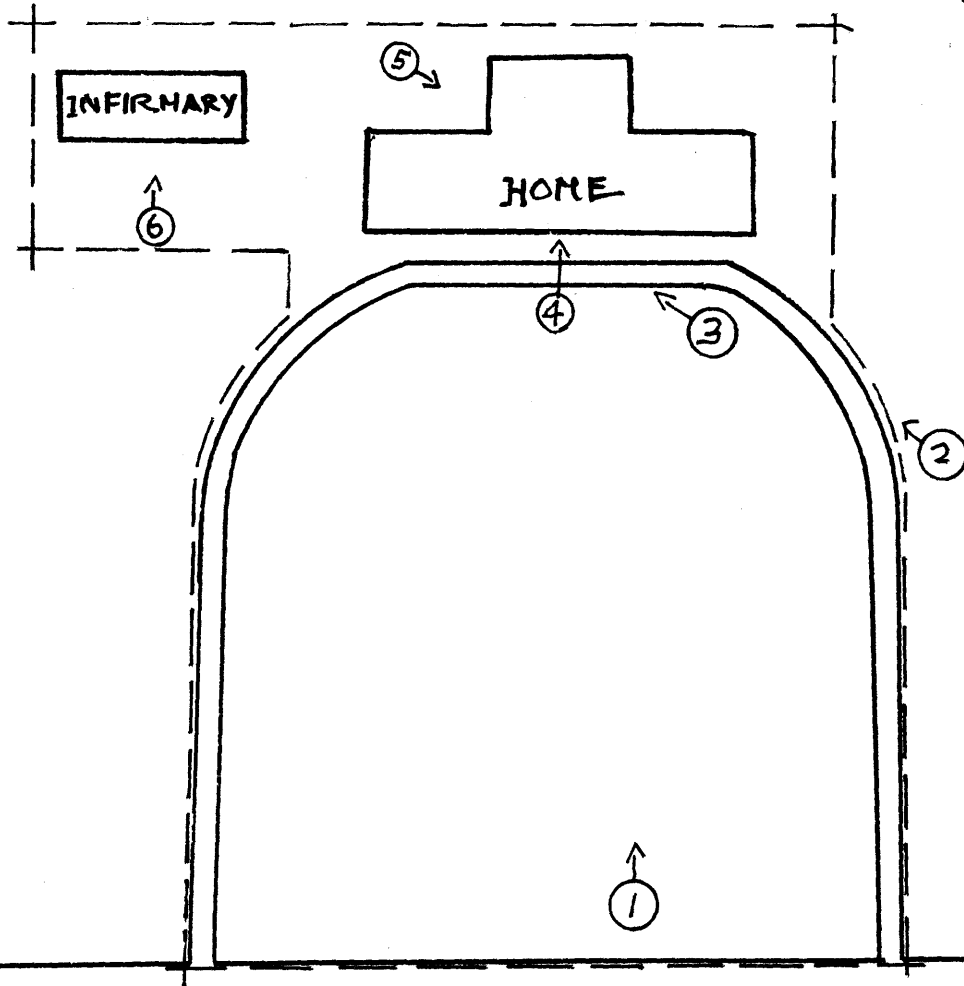
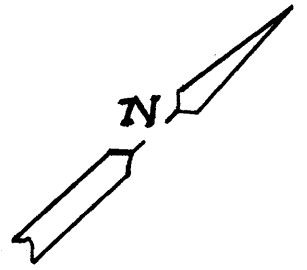

BOUNDARY

MASONIC HOME FOR CHILDREN  
RAPIDES PARISH,  
LA.

SCALE 1" = 100'