

HISTORIC RESOURCES OF DALLAS COUNTY
DALLAS COUNTY, ARKANSAS

ARKANSAS HISTORIC PRESERVATION PROGRAM

Survey Number DA-5

Owner Mr. John S. Marlar

Property Name Thomas Homestead

Address 2800 Mimosa

CFF AR 7
Location Fairview

Camden, AR 71701

Significant Date/s c. 1910

ARCHITECTURAL DESCRIPTION

Thomas Homestead is located on an unpaved county road off Highway 7 between Dalark and Sparkman. The Homestead contains eight historic outbuildings sited around a dwelling. The dwelling (#1 on the attached map), built about 1910, is a wood frame dog-trot with an original rear ell attached to the north pen. Both the main block and the ell are covered with board and batten siding. The structure's gable roofs are covered with asphalt shingles simulating historic wood shingles. The house and its two exterior end chimneys of brick rest on stone piers. The fenestration of this house is simple; each pen has a central entry onto the passageway and a pair of one-over-one double-hung windows on the front (east) facade. Shading the front facade is the half-hip roof supported by six square posts of the full length porch.

Among the outstructures is a small rectangular wood frame garage (2), built about 1930. It is sheathed in vertical boards and is capped by a gable roof of wood shingles. A double door entry with clipped corners faces east. This garage is the eastern most structure. These other structures, shed (4), potato house (5) smokehouse (6), sit behind it in a line running parallel and north of the dwelling. Immediately behind the garage is an open shed (4) on a square concrete pad. The shed is covered by a gable roof sheathed in wooden shingles supported by a round post at each corner. The gable ends are filled with vertical boards. Next is a square potato house (5) of round logs. Built at the same time as the dwelling this structure is covered by a wood shingle gable roof, the ends of which are filled with vertical boards. A door of vertical planks exists in the south facade. To the west of the potato house is a rectangular smoke house (6) of wood frame construction. It's gable roof of wood shingles extends three feet over the front facade which contains a vertical plank door and is covered with horizontal boards. The remaining facades are sheathed in board and batten siding. Farthest north from the dwelling is a wood-frame gable-roofed structure (3) used as a tool and blacksmith shop. Covered with vertical boards, this structure has a single door in the south gable end. Immediately behind (west) the dwelling is a well (7) which is covered by a wood shingle gable roof supported by four round posts. Farther to the west and beyond the fenced house yard is a large transverse crib barn (8) constructed of round logs. This 1½ story barn is covered by a gable roof with vertical boards filling the ends. A full-length shed addition supported by round posts has been added to each side. To the rear of this barn is a small two crib barn (9). Sheathed with vertical boards it is covered by a wood-shingle gable roof. A shed addition has been attached to the west side.

Survey Number DA-5

Property Name Thomas Homestead

page 2

STATEMENT OF SIGNIFICANCE

The 1910 Thomas Homestead is significant in its undisturbed representation of the early 20th century farm in Arkansas. Unlike the other documented farms, which were settled in the mid 19th century, its structures reflect one construction period, 1910-1920. Another noticeable difference with the Thomas Farm is the absence of laborers dwellings, present on other farms. This reflects, not only a one family farm operation but also the emerging impact of mechanized farming in Arkansas. The Thomas Homestead is an unusually fine collection of 20th century farm structures that represent a one family farm operation in Arkansas.

Acreage: $2\frac{1}{2}$

Quadrangle Name: Sparkman

Quadrangle Scale: 1:24000

UTM Reference: A 15 513490/3760300

B 15 513480/3760290

C 15 513370/3760200

D 15 513380/3760310

Verbal Boundary Description:

The nominated property, located within the $S\frac{1}{2}$ of the $SW\frac{1}{4}$ of section 33, T8S R17W, is a square, containing $2\frac{1}{2}$ acres, the east boundary of which is the county road; the main house is centered in the east half.



United States Department of the Interior
National Park Service

National Register of Historic Places
Inventory—Nomination Form

For NPS use only

received

date entered

9/14/83

Continuation sheet

Item number

Page 30 of 3

Multiple Resource Area
Thematic Group

Name Dallas County Multiple Resource Area
State Arkansas

Nomination/Type of Review

Date/Signature

21. Princeton Methodist Church

Keeper

Bob Grosvenor 10/28/83

Attest

22. Rock Island Railway Depot

Entered in the
National Register

for Keeper

Melvin Byers 10/28/83

Attest

23. Russell, John, House

Entered in the
National Register

for Keeper

Melvin Byers 10/28/83

Attest

24. Sardis Methodist Church

Entered in the
National Register

for Keeper

Melvin Byers 10/28/83

Attest

25. Smith, Jessie B., House

Entered in the
National Register

for Keeper

Melvin Byers 10/28/83

Attest

26. Thomas Homestead

Entered in the
National Register

Keeper

Melvin Byers 3/27/84

Attest

27. Tulip Cemetery

Substantive Review

Keeper

Bob Grosvenor 10/28/83

Attest

28. Wynne House

Entered in the
National Register

for Keeper

Melvin Byers 10/28/83

Attest

29. Charlotte Street Historic
District

Entered in the
National Register

for Keeper

Melvin Byers 9/14/87

Attest

30.

Keeper

Attest

NATIONAL REGISTER OF HISTORIC PLACES
EVALUATION/RETURN SHEET

Thomas Homestead (Dallas County MRA)
Dallas County
ARKANSAS

Working No. 9/14/83
Fed. Reg. Date: _____
Date Due: 10/13/83 - 10/29/83
Action: ACCEPT
RETURN 10/28/83
REJECT
Federal Agency: _____

- ☐ resubmission
☐ nomination by person or local government
☐ owner objection
☐ appeal

Substantive Review: ☐ sample ☐ request ☐ appeal ☐ NR decision

Reviewer's comments:

Recom./Criteria _____
Reviewer _____
Discipline _____
Date _____
see continuation sheet

Nomination returned for: ☒ technical corrections cited below
☐ substantive reasons discussed below

1. Name

2. Location

3. Classification

Category	Ownership	Status	Present Use
	Public Acquisition	Accessible	

4. Owner of Property

5. Location of Legal Description

6. Representation in Existing Surveys

Has this property been determined eligible? ☐ yes ☐ no

7. Description

Condition	Check one	Check one
<input type="checkbox"/> excellent	<input type="checkbox"/> deteriorated	<input type="checkbox"/> original site
<input type="checkbox"/> good	<input type="checkbox"/> ruins	<input type="checkbox"/> moved date _____
<input type="checkbox"/> fair	<input type="checkbox"/> unexposed	
	<input type="checkbox"/> unaltered	
	<input type="checkbox"/> altered	

Describe the present and original (if known) physical appearance

- ☐ summary paragraph
☐ completeness
☐ clarity
☐ alterations/integrity
☐ dates
☐ boundary selection

8. Significance

Period Areas of Significance—Check and justify below

Specific dates Builder/Architect

Statement of Significance (*in one paragraph*)

- ☐ summary paragraph
- ☐ completeness
- ☐ clarity
- ☐ applicable criteria
- ☐ justification of areas checked
- ☐ relating significance to the resource
- ☐ context
- ☐ relationship of integrity to significance
- ☐ justification of exception
- ☐ other

9. Major Bibliographical References

X 10. Geographical Data

Acreage of nominated property _____

Quadrangle name _____

UTM References

f Verbal boundary description and justification

Please provide north or South boundary reference point.

11. Form Prepared By

12. State Historic Preservation Officer Certification

The evaluated significance of this property within the state is:

____ national ____ state ____ local

State Historic Preservation Officer signature

title

date

13. Other

- ☐ Maps
- ☐ Photographs
- ☐ Other

Questions concerning this nomination may be directed to _____

Signed *Helene Byers* Date *10/28/83* Phone: _____

UNITED STATES DEPARTMENT OF THE INTERIOR
NATIONAL PARK SERVICE

NATIONAL REGISTER OF HISTORIC PLACES
EVALUATION/RETURN SHEET

Thomas Homestead (Dallas County MRA)
Dallas County
ARKANSAS

Working No. 7/14/83

Fed. Reg. Date: 2/5/85

Date Due: 4/8/84

Action: ☒ ACCEPT 3/27/84

Entered in the National Register

☐ RETURN

☐ REJECT

Federal Agency: _____

- ☒ resubmission
☐ nomination by person or local government
☐ owner objection
☐ appeal

Substantive Review: ☐ sample ☐ request ☐ appeal ☐ NR decision

Reviewer's comments:

Recom./Criteria _____

Reviewer _____

Discipline _____

Date _____

_____ see continuation sheet

Nomination returned for: _____ technical corrections cited below
_____ substantive reasons discussed below

1. Name

2. Location

3. Classification

Category	Ownership Public Acquisition	Status Accessible	Present Use
----------	---------------------------------	----------------------	-------------

4. Owner of Property

5. Location of Legal Description

6. Representation in Existing Surveys

Has this property been determined eligible? ☐ yes ☐ no

7. Description

Condition

- ☐ excellent
☐ good
☐ fair

- ☐ deteriorated
☐ ruins
☐ unexposed

Check one

- ☐ unaltered
☐ altered

Check one

- ☐ original site
☐ moved date _____

Describe the present and original (if known) physical appearance

- ☐ summary paragraph
☐ completeness
☐ clarity
☐ alterations/integrity
☐ dates
☐ boundary selection

8. Significance

Period Areas of Significance—Check and justify below

Specific dates

Builder/Architect

Statement of Significance (*in one paragraph*)

- ☐ summary paragraph
- ☐ completeness
- ☐ clarity
- ☐ applicable criteria
- ☐ justification of areas checked
- ☐ relating significance to the resource
- ☐ context
- ☐ relationship of integrity to significance
- ☐ justification of exception
- ☐ other

9. Major Bibliographical References

10. Geographical Data

Acreage of nominated property _____

Quadrangle name _____

UTM References

Verbal boundary description and justification

11. Form Prepared By

12. State Historic Preservation Officer Certification

The evaluated significance of this property within the state is:

____ national ____ state ____ local

State Historic Preservation Officer signature

title

date

13. Other

- ☐ Maps
- ☐ Photographs
- ☐ Other

Questions concerning this nomination may be directed to _____

Signed _____ Date _____ Phone: _____



DA-5
Thomas Homestead
Sarah Brown, photographer
May 27, 1982
Negative on file at the AHPP
View from the northeast



DA-5
Thomas Homestead,
structure #2
Sarah Brown, photographer
May 27, 1982
Negative on file at the AHPP
View from the Northwest



DA-5
Thomas Homestead,
structure #3
Sarah Brown, photographer
May 27, 1982
Negative on file at the AHPP
View from the Northeast



DA-5
Thomas Homestead,
structure #4
Sarah Brown, photographer
May 27, 1982
Negative on file at the AHPP
View from the Southeast



DA-5
Thomas Homestead,
structure #5
Sarah Brown, photographer
May 27, 1982
Negative on file at the AHPP
View from the Southeast



DA-5
Thomas Homestead,
structure #6
Sarah Brown, photographer
May 27, 1982
Negative on file at the AHPP
View from the Northeast



DA-5
Thomas Homestead,
structure #7
Sarah Brown, photographer
May 27, 1982
Negative on file at the AHPP
View from the West



DA-5
Thomas Homestead,
structure #8
Sarah Brown, photographer
May 27, 1982
Negative on file at the AHPP
View from the Northwest



DA-5
Thomas Homestead,
structure #9
Sarah Brown, photographer
May 27, 1982
Negative on file at the AHPP
View from the Southeast

UNITED STATES
DEPARTMENT OF THE INTERIOR
GEOLOGICAL SURVEY

SPARKMAN QUADRANGLE
ARKANSAS—DALLAS CO.
7.5 MINUTE SERIES (TOPOGRAPHIC)
NE 1/4 SPARKMAN 15' QUADRANGLE

Dallas County Multiple Resource
Quadrangle Name-Sparkman
Scale-1:24000
DA-05 Thomas Homestead
15 A 513490/3760300
B 513480/3760290
C 513370/3760200
D 513380/3760310

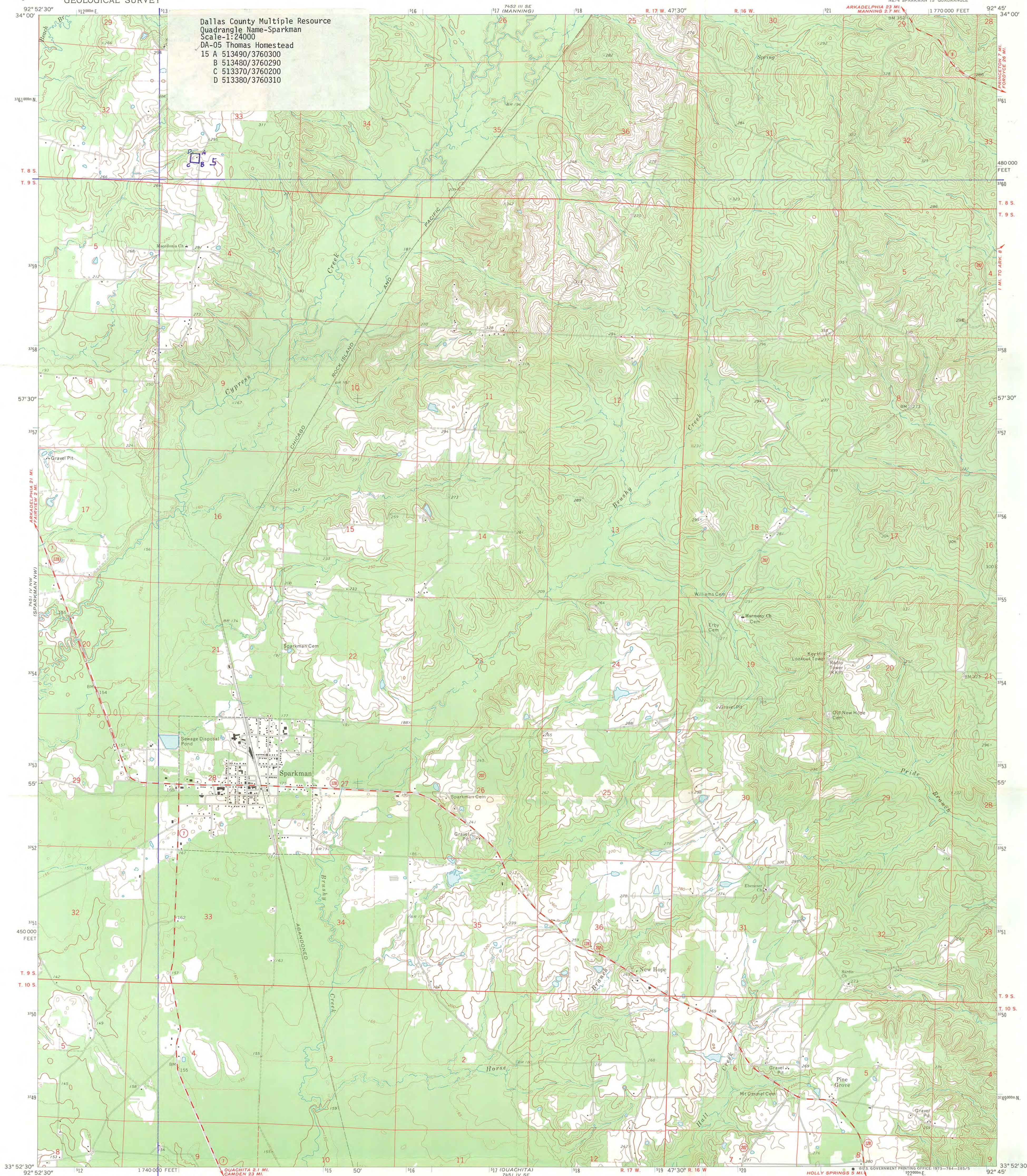

Mapped, edited, and published by the Geological Survey
Control by USGS and USC&GS
Topography by photogrammetric methods from aerial
photographs taken 1970. Field checked 1971
Projection and 10,000-foot grid ticks: Arkansas coordinate
system, south zone (Lambert conformal conic)
1000-meter Universal Transverse Mercator grid ticks,
zone 15, shown in blue. 1927 North American datum
Fine red dashed lines indicate selected fence and field lines where
generally visible on aerial photographs. This information is unchecked

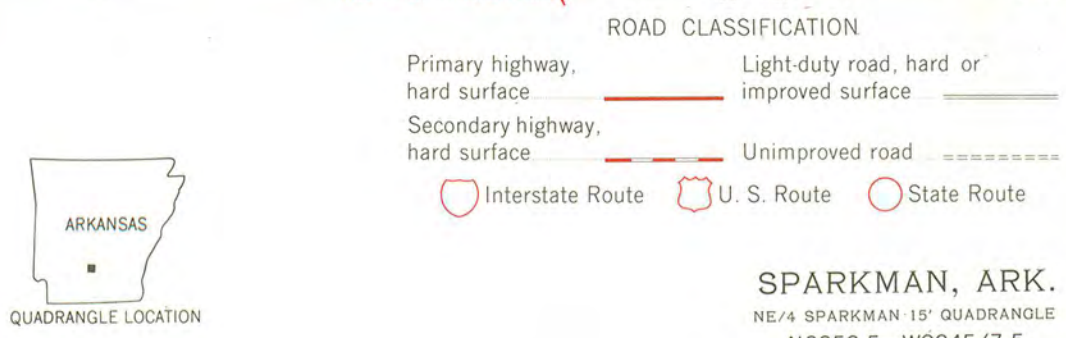
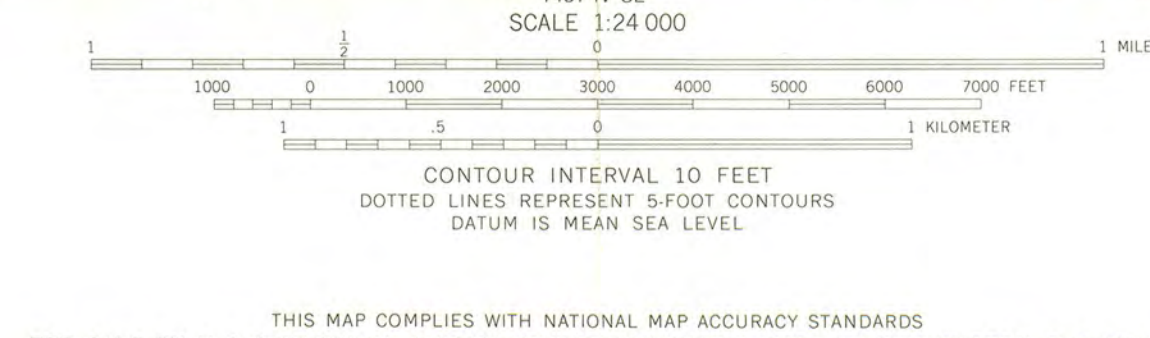
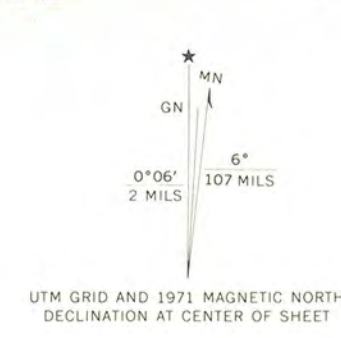

THIS MAP COMPLIES WITH NATIONAL MAP ACCURACY STANDARDS
FOR SALE BY U.S. GEOLOGICAL SURVEY, DENVER, COLORADO 80225, OR WASHINGTON, D. C. 20242
AND BY THE ARKANSAS GEOLOGICAL COMMISSION, LITTLE ROCK, ARKANSAS 72201
A FOLDER DESCRIBING TOPOGRAPHIC MAPS AND SYMBOLS IS AVAILABLE ON REQUEST

SPARKMAN, ARK.
NE 1/4 SPARKMAN 15' QUADRANGLE
N3352.5-W9245.7/7.5
1971
AMS 7451 IV NE—SERIES V884

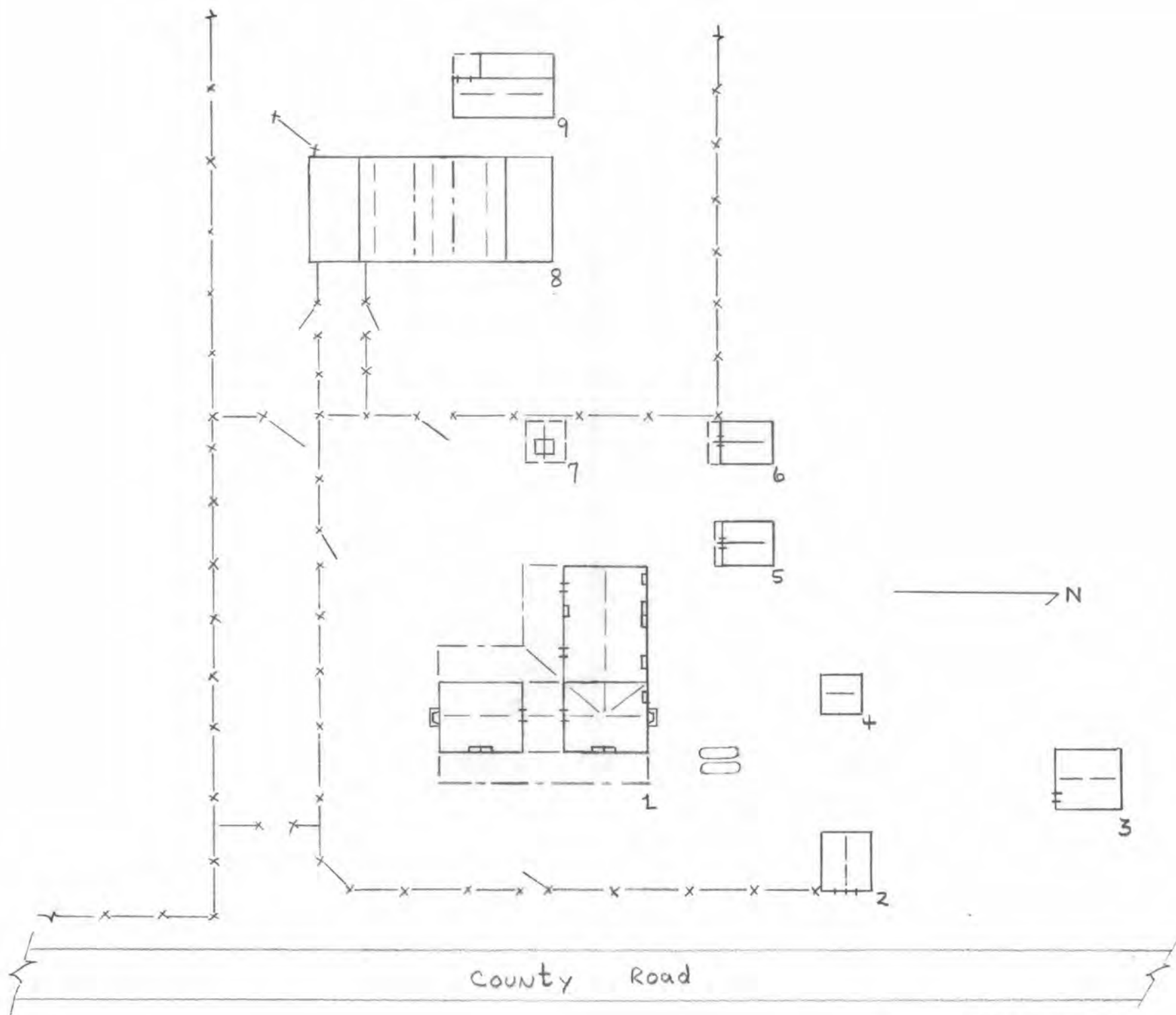

Thomas Homestead
Fairview, Dallas County, Ark.
Not to Scale