

1124173 PH0020974

NATIONAL REGISTER OF HISTORIC PLACES
INVENTORY - NOMINATION FORM

(Type all entries - complete applicable sections)

STATE: Connecticut	
COUNTY: Middlesex Fairfield	
FOR NPS USE ONLY	
ENTRY NUMBER 2	DATE 2 SEP 1972

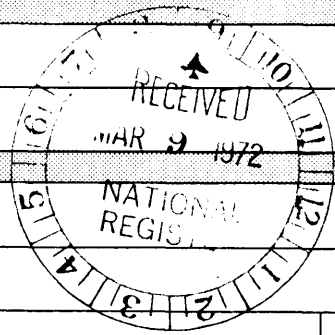

1. NAME

COMMON:
Amasa Day House

AND/OR HISTORIC:

2. LOCATION

STREET AND NUMBER:
Plains Road

CITY OR TOWN:
East Haddam village of S Moodus

STATE: Connecticut CODE: 09 COUNTY: Middlesex CODE: 007

3. CLASSIFICATION

CATEGORY (Check One)	OWNERSHIP	STATUS	ACCESSIBLE TO THE PUBLIC
<input type="checkbox"/> District <input type="checkbox"/> Site <input type="checkbox"/> Object <input checked="" type="checkbox"/> Building <input type="checkbox"/> Structure	<input type="checkbox"/> Public <input checked="" type="checkbox"/> Private <input type="checkbox"/> Both	<input checked="" type="checkbox"/> Occupied <input type="checkbox"/> Unoccupied <input type="checkbox"/> Preservation work in progress <input type="checkbox"/> In Process <input type="checkbox"/> Being Considered	Yes: <input checked="" type="checkbox"/> Restricted <input type="checkbox"/> Unrestricted <input type="checkbox"/> No
PRESENT USE (Check One or More as Appropriate)			
<input type="checkbox"/> Agricultural <input type="checkbox"/> Commercial <input type="checkbox"/> Educational <input type="checkbox"/> Entertainment	<input type="checkbox"/> Government <input type="checkbox"/> Industrial <input type="checkbox"/> Military <input checked="" type="checkbox"/> Museum	<input type="checkbox"/> Park <input type="checkbox"/> Private Residence <input type="checkbox"/> Religious <input type="checkbox"/> Scientific	<input type="checkbox"/> Transportation <input type="checkbox"/> Other (Specify) <input type="checkbox"/> Comments

4. OWNER OF PROPERTY

OWNER'S NAME:
Antiquarian and Landmarks Society, Inc.

STREET AND NUMBER:
391 Main Street

CITY OR TOWN: Hartford STATE: Connecticut CODE: 09

5. LOCATION OF LEGAL DESCRIPTION

COURTHOUSE, REGISTRY OF DEEDS, ETC.:
Town Hall

STREET AND NUMBER:

CITY OR TOWN: East Haddam STATE: Connecticut CODE: 09

6. REPRESENTATION IN EXISTING SURVEYS

TITLE OF SURVEY:
Connecticut Historic Structures and Landmarks Survey

DATE OF SURVEY: 1968 Federal State County Local

DEPOSITORY FOR SURVEY RECORDS:
Connecticut Historical Commission

STREET AND NUMBER:
54 Pratt Street

CITY OR TOWN: Hartford STATE: Connecticut CODE: 09

SEE INSTRUCTIONS

STATE: Connecticut

COUNTY: Middlesex

ENTRY NUMBER: 2

DATE: 2 SEP 1972

FOR NPS USE ONLY

7. DESCRIPTION

CONDITION

(Check One)

Excellent Good Fair Deteriorated Ruins Unexposed

(Check One)

Altered Unaltered

(Check One)

Moved Original Site

DESCRIBE THE PRESENT AND ORIGINAL (if known) PHYSICAL APPEARANCE

The Amasa Day House is a fine example of a late Federal style house of typical form with twin chimneys and 9-windows facade. The centered front entry has a portico with triangular pediment, replete with mutules and return cornice. There is a frieze here and columns and pilasters flanking the doorway which match those at the corners of the house. There is a leaded fanlight of semi-oval form with a keystone above the six-panel door. In the gable ends at attic level is a similar semi-oval light in the same pattern. Both beneath the eaves line and above the frieze at the gable ends are mutules without guttae. They are simply plain blocks. On the south side is an entry with quite elaborate detail, with a paneled door, flat pediment, frieze, fanlight, and pilasters.

The rear extensions of the house were added in 1878 by Amasa Day. He enlarged the original kitchen, added a modern one, and built the conservatory. All was added, however, not in the scroll and bracket style of the day, but in keeping with the style of the original house of 1816 with mutules at the eaves and proper 12/12 window sash. The large chimney matches those of the house proper, since it is a survival from the 1816 period, a remnant of the old ell which had its roof raised. The small conservatory on the south side is also of the 1878 period. The foundation of the main part of the house is granite blocks; here it is brick.

The Amasa Day House is an impressive structure, set on a knoll on the green of the village of Woodus. On the property is a carriage house dated 1878 and looking very much as it must have originally, with flush boarding as sheathing and a cupola at the center of the roof.

SEE INSTRUCTIONS

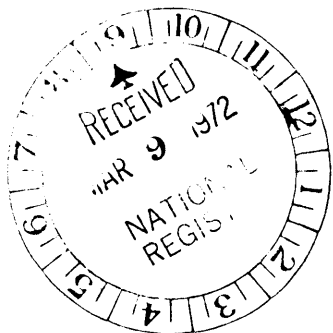

6. SIGNIFICANCE

PERIOD (Check One or More as Appropriate)

- | | | | |
|--|---------------------------------------|--|---------------------------------------|
| <input type="checkbox"/> Pre-Columbian | <input type="checkbox"/> 16th Century | <input type="checkbox"/> 18th Century | <input type="checkbox"/> 20th Century |
| <input type="checkbox"/> 15th Century | <input type="checkbox"/> 17th Century | <input checked="" type="checkbox"/> 19th Century | |

SPECIFIC DATE(S) (If Applicable and Known) 1816

AREAS OF SIGNIFICANCE (Check One or More as Appropriate)

- | | | | |
|--|---|--|--|
| <input type="checkbox"/> Aboriginal | <input type="checkbox"/> Education | <input type="checkbox"/> Political | <input type="checkbox"/> Urban Planning |
| <input type="checkbox"/> Prehistoric | <input type="checkbox"/> Engineering | <input type="checkbox"/> Religion/Philosophy | <input type="checkbox"/> Other (Specify) |
| <input type="checkbox"/> Historic | <input type="checkbox"/> Industry | <input type="checkbox"/> Science | |
| <input type="checkbox"/> Agriculture | <input type="checkbox"/> Invention | <input type="checkbox"/> Sculpture | |
| <input checked="" type="checkbox"/> Architecture | <input type="checkbox"/> Landscape Architecture | <input type="checkbox"/> Social/Humanitarian | |
| <input type="checkbox"/> Art | <input type="checkbox"/> Literature | <input type="checkbox"/> Theater | |
| <input type="checkbox"/> Commerce | <input type="checkbox"/> Military | <input type="checkbox"/> Transportation | |
| <input type="checkbox"/> Communications | <input type="checkbox"/> Music | | |
| <input type="checkbox"/> Conservation | | | |

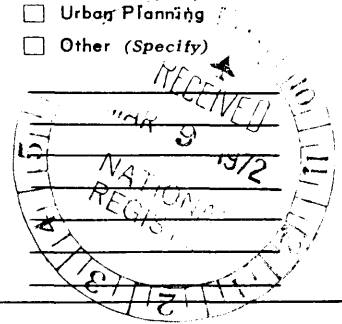

STATEMENT OF SIGNIFICANCE

SEE INSTRUCTIONS

The Amasa Day House is one of the earliest structures remaining in the village of Moodus, hence, by age alone, is one of the most important. But it also derives importance from its fine architecture, rendering it one of the most beautiful houses in the area. Finally, the Day House, as well as others near it, is to become part of a redeveloped area, in the planning stage for years, now becoming a reality. To the south and east of the house are many other structures, some still private residences, most renovated offices. The majority of these are either Greek Revival, one or two of which are extremely handsome, or Victorian, built between 1860 and 1880, the carriage houses of which may be even more ornate than the residences themselves. To the north of this grouping, along Route 149 on the south bank of the Moodus River, a redevelopment project is being carried out. The buildings have been vacated and are presently (February, 1972) being demolished. According to the East Haddam Redevelopment Agency, the site is to be landscaped and will be a park and open space area. The Amasa Day House sits just to the south of this area, across a state highway, on the village green. Its grounds are surrounded by a picket fence on the front and a stone wall to the north side. To the rear of the house lie gardens, shrubs, and trees. The property is shielded by foliage and some acreage and forms a quiet spot at a busy highway intersection (State Routes 149 and 151).

The history of the house is sparse. It was built in 1816 by Julius Chapman whose wife is said to have "laid-on" the stenciled floor and stairs that are still apparnet today. In 1843 Amasa Day of Colchester attended an auction of the house. He made a quick offer and became the owner. He and his second wife, Sarah Selden Spencer, daughter of a prosperous merchant of Hadlyme, brought to the house many family heirlooms from the Spencer home at Hadlyme Ferry. Day was a successful businessman in insurance from 1851 to 1892, a partner in the Moodus Machine Company, vice-president of the Moodus Savings Bank and a member of the First Congregational Church. It was Amasa Day who remodeled the rear ell and raised its roof in 1878. He died in 1896.

Katherine Maria Day was the only surviving child of Amasa and Sarah Day. She married Eugene W. Chaffee in 1868 and had two children, Amasa Day Chaffee, (1870-1925), and Katherine Day Chaffee, (1888-1961), who married Allan K. Roberts. The property and an endowment were given to the Antiquarian and Landmarks Society by the Roberts in 1967, upon the death of Mr. Roberts.

9. MAJOR BIBLIOGRAPHICAL REFERENCES

Antiquarian and Landmarks Society, Inc. Research paper prepared by
 Arthur Leibundguth, Director

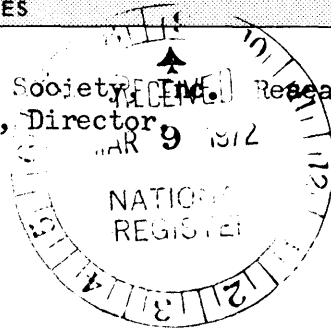

10. GEOGRAPHICAL DATA

LATITUDE AND LONGITUDE COORDINATES DEFINING A RECTANGLE LOCATING THE PROPERTY			OR	LATITUDE AND LONGITUDE COORDINATES DEFINING THE CENTER POINT OF A PROPERTY OF LESS THAN TEN ACRES		
CORNER	LATITUDE	LONGITUDE		LATITUDE	LONGITUDE	
	Degrees Minutes Seconds	Degrees Minutes Seconds		Degrees Minutes Seconds	Degrees Minutes Seconds	
NW	° ' "	° ' "		41° 30' 07"	72° 27' 09"	
NE	° ' "	° ' "				
SE	° ' "	° ' "				
SW	° ' "	° ' "				

APPROXIMATE ACREAGE OF NOMINATED PROPERTY: 3 1/2 acres

LIST ALL STATES AND COUNTIES FOR PROPERTIES OVERLAPPING STATE OR COUNTY BOUNDARIES

STATE:	CODE	COUNTY	CODE

11. FORM PREPARED BY

NAME AND TITLE: Susan Rabbitt, Administrative Trainee

ORGANIZATION: Connecticut Historical Commission DATE: February 29, 1972

STREET AND NUMBER: 54 Pratt Street

CITY OR TOWN: Hartford STATE: Connecticut CODE: 09

12. STATE LIAISON OFFICER CERTIFICATION

NATIONAL REGISTER VERIFICATION

As the designated State Liaison Officer for the National Historic Preservation Act of 1966 (Public Law 89-665), I hereby nominate this property for inclusion in the National Register and certify that it has been evaluated according to the criteria and procedures set forth by the National Park Service. The recommended level of significance of this nomination is:

National State Local

Name: [Signature]

Title: State Liaison Officer

Date: March 1, 1972

I hereby certify that this property is included in the National Register.

[Signature]
 Chief, Office of Archeology and Historic Preservation

Date: 9/22/72

ATTEST: [Signature]
 Keeper of The National Register

Date: _____

SEE INSTRUCTIONS

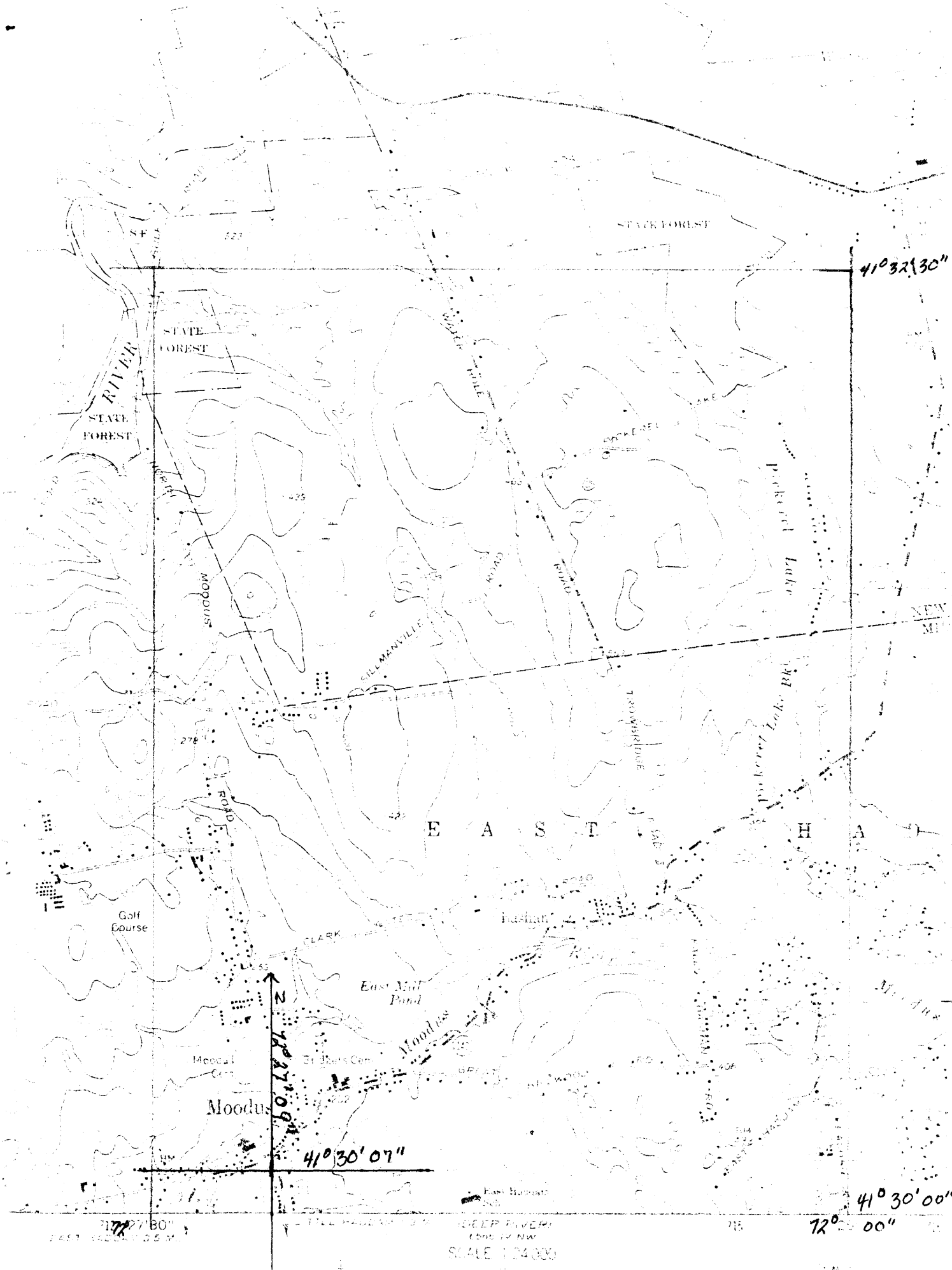

Moodus Quadrangle