

United States Department of the Interior
National Park Service

For NPS use only

National Register of Historic Places
Inventory—Nomination Form

received FEB 15 1985

date entered 4/1/85

See instructions in *How to Complete National Register Forms*
Type all entries—complete applicable sections

1. Name

historic N/A

and/or common Saenger Theatre Addendum (1101-11 Canal Street)

2. Location

street & number 1101-11 Canal Street N/A not for publication

city, town New Orleans N/A vicinity of

state LA code 22 parish Orleans code 071
~~county~~

3. Classification

Category	Ownership	Status	Present Use
<input type="checkbox"/> district	<input type="checkbox"/> public	<input type="checkbox"/> occupied	<input type="checkbox"/> agriculture
<input checked="" type="checkbox"/> building(s)	<input checked="" type="checkbox"/> private	<input checked="" type="checkbox"/> unoccupied	<input type="checkbox"/> commercial
<input type="checkbox"/> structure	<input type="checkbox"/> both	<input checked="" type="checkbox"/> work in progress	<input type="checkbox"/> educational
<input type="checkbox"/> site	Public Acquisition	Accessible	<input type="checkbox"/> entertainment
<input type="checkbox"/> object	N/A in process	<input checked="" type="checkbox"/> yes: restricted	<input type="checkbox"/> government
	N/A being considered	<input type="checkbox"/> yes: unrestricted	<input type="checkbox"/> industrial
		<input type="checkbox"/> no	<input type="checkbox"/> military
			<input checked="" type="checkbox"/> other: vacant

4. Owner of Property

name Popeye's Famous Fried Chicken

c/o John Silva, Director of Architectural Services
street & number 1333 South Clearview Parkway

city, town Jefferson N/A vicinity of state LA 70121

5. Location of Legal Description

courthouse, registry of deeds, etc. Department of Conveyance, City Hall

street & number 1300 Perdido Street

city, town New Orleans state LA 70112

6. Representation in Existing Surveys

title LA Historic Sites Survey has this property been determined eligible? yes no

date 1984 federal state county local

depository for survey records LA State Historic Preservation Office

city, town Baton Rouge state LA

7. Description

Condition		Check one	Check one	
<input type="checkbox"/> excellent	<input type="checkbox"/> deteriorated	<input type="checkbox"/> unaltered	<input checked="" type="checkbox"/> original site	
<input checked="" type="checkbox"/> good	<input type="checkbox"/> ruins	<input checked="" type="checkbox"/> altered	<input type="checkbox"/> moved	date <u>N/A</u>
<input type="checkbox"/> fair	<input type="checkbox"/> unexposed			

Describe the present and original (if known) physical appearance

On November 25, 1977 the Saenger Theatre was entered into the National Register. At that time the application addressed only the theatre space itself and the grand entrance corridors which lead to it. It left out the two other buildings on the block, one of which (1101-11 Canal Street) is the subject of this addendum.*

When the Saenger was built (1927), Saenger Theatres Inc, did not have control of the entire city block (see map). There were two buildings on the site already. Hence the theatre ultimately had to be built at the rear of the block and access from the front (Canal Street) and the sides (Rampart and Basin Streets) was provided by a system of grand corridors. There are three corridors emanating from the theatre lobby. The main one proceeds forward between the two commercial buildings to a grand, albeit narrow, triumphal arch entrance on Canal Street. The two other hallways proceed sideways to lesser entrances on Rampart and Basin Streets.

The hallways are divided into bays by shallow slender panels formed of marble. Display cases occupy the ground floor bays, and on the second floor the bays are occupied by Renaissance aedicule motifs formed of quoins, many of which have inset mirrors. At one time the main hall had four massive crystal chandeliers hanging from the painted beam ceiling. These chandeliers were acquired from the Chateau Pierrefonds D'Olse by the Saenger Company when the theatre was built. Today only one of the four remains.

1101-11 Canal was built in 1923 four years before the Saenger was completed. It is a four story brick neo-classical structure with a heavy frieze and a modillion cornice. Most of the windows are set in groups of two or three. The shopfront level was originally divided into bays by Roman Doric pilasters. About twenty percent of this articulated shopfront remains. The interior of the building is devoid of significant historic features.

The fact that 1101-11 Canal Street and its companion building support and augment the basically classical composition of the Saenger is not an accident. In 1921 developers acquired control of the lots and made arrangements for the construction of the present commercial buildings. They also entered into an agreement with Saenger Theatres Inc. to permit entrances to the theatre to be built in the form of passages between the two buildings. So, despite the differences in dates, the theatre, 1101-11 Canal and 1113-17 Canal were conceived of as a whole before any of them were built.

Assessment of Integrity:

The historic interiors of the building have largely disappeared, light wells have been enclosed, and there have been some significant shopfront level modifications. Despite these, the brick mass and the classical style of the building remains dominant. It still fulfills its historic role as an architectural "bookend" for the slender Saenger entrance.

CONTINUED

**United States Department of the Interior
National Park Service**

**National Register of Historic Places
Inventory—Nomination Form**

(1101-11 Canal Street)

Continuation sheet Saenger Theatre Addendum

Item number 7

Page 2

For NPS use only

received

date entered

7. Description (cont'd)

- * The other building (1113-17 Canal) is also involved in the addendum process. However, because both of its owners filed notarized letters of objection, it is being submitted separately for inclusion on the list of properties eligible for the Register but not actually listed. (These were the instructions given us by our reviewer.)

In the original nomination both buildings were excluded from the nominated area because it was a very unusual case with no precedent whatsoever. Hence the staff drew a conservative set of boundaries and the Saenger was duly listed on the Register. In early 1984 an Economic Recovery Tax Act renovation project was suggested for 1101-11 Canal Street, and consequently the staff was asked to investigate whether it and 1113-17 should be included in the Saenger listing. The National Register Review Unit in Washington, D. C. was contacted for a technical ruling and the consensus was that they should. (See Item 8 for technical explanation.)

8. Significance

Period	Areas of Significance—Check and justify below			
<input type="checkbox"/> prehistoric	<input type="checkbox"/> archeology-prehistoric	<input type="checkbox"/> community planning	<input type="checkbox"/> landscape architecture	<input type="checkbox"/> religion
<input type="checkbox"/> 1400-1499	<input type="checkbox"/> archeology-historic	<input type="checkbox"/> conservation	<input type="checkbox"/> law	<input type="checkbox"/> science
<input type="checkbox"/> 1500-1599	<input type="checkbox"/> agriculture	<input type="checkbox"/> economics	<input type="checkbox"/> literature	<input type="checkbox"/> sculpture
<input type="checkbox"/> 1600-1699	<input checked="" type="checkbox"/> architecture	<input type="checkbox"/> education	<input type="checkbox"/> military	<input type="checkbox"/> social/
<input type="checkbox"/> 1700-1799	<input type="checkbox"/> art	<input type="checkbox"/> engineering	<input type="checkbox"/> music	<input type="checkbox"/> humanitarian
<input type="checkbox"/> 1800-1899	<input type="checkbox"/> commerce	<input type="checkbox"/> exploration/settlement	<input type="checkbox"/> philosophy	<input type="checkbox"/> theater
<input checked="" type="checkbox"/> 1900-	<input type="checkbox"/> communications	<input type="checkbox"/> industry	<input type="checkbox"/> politics/government	<input type="checkbox"/> transportation
		<input type="checkbox"/> invention		<input type="checkbox"/> other (specify)

Specific dates 1923 **Builder/Architect** Architect uncertain

Statement of Significance (in one paragraph) Criterion C :

1101-11 Canal Street is an essential component of the Saenger Theatre National Register site because it (along with 1113-17 Canal) is related to the theatre's architectural development and style, as follows:

- (1) As mentioned in Item 7, the two commercial buildings and the theatre were conceived as a whole before any of them were built. The architectural style of the grouping is more or less classical, and although the theatre entrance is more ornate, the buildings are so complementary that the Canal Street elevation can almost be read as a single facade.
- (2) 1101-11 and 1113-17 Canal Street gave the Saenger one of its most distinctive and architecturally significant features--i.e., its grand approach corridors. These are very unusual in theatre architecture and the ones at the Saenger are widely recognized as one of the building's most distinguishing aspects. Yet they would never have been built were it not for the other buildings on the block. In addition, the grand hallways and the two commercial buildings are structurally interlinked. Finally, it would probably be possible to demolish the two commercial buildings and leave the hallways standing. But if this were done, the standing hallway configuration would make no sense architecturally.

9. Major Bibliographical References

Research report submitted by applicant; researched by Hilary Irvin, Based upon research conducted in primary sources such as conveyance records, city directories, archival collections in New Orleans, etc. Copy of report in Saenger Addendum Register file, LA State Historic Preservation Office.

10. Geographical Data

Acree of nominated property @1/8th of an acre (addendum only)

Quadrangle name New Orleans East, LA

Quadrangle scale 1:24000

UTM References

A

1	5	7	8	2	4	9	0	3	3	1	7	3	2	0
Zone			Easting				Northing							

B

Zone			Easting				Northing							

C

Zone			Easting				Northing							

D

Zone			Easting				Northing							

E

Zone			Easting				Northing							

F

Zone			Easting				Northing							

G

Zone			Easting				Northing							

H

Zone			Easting				Northing							

Verbal boundary description and justification

Please refer to attached sketch map. Boundaries follow curblines and party walls, as indicated.

List all states and counties for properties overlapping state or county boundaries

state N/A code county code

state code county code

11. Form Prepared By

Assisted by Diane Manget, Preservation

name/title National Register Staff Division of Historic Preservation Consultant

organization State of Louisiana date October 1984

street & number P. O. Box 44247 telephone (504) 922-0358

city or town Baton Rouge state LA 70804

12. State Historic Preservation Officer Certification

The evaluated significance of this property within the state is:

national state local (Saenger is listed with state significance,)

As the designated State Historic Preservation Officer for the National Historic Preservation Act of 1966 (Public Law 89-665), I hereby nominate this property for inclusion in the National Register and certify that it has been evaluated according to the criteria and procedures set forth by the National Park Service.

State Historic Preservation Officer signature



Robert B. DeBlieux

title State Historic Preservation Officer

date February 6, 1985

For NPS use only

I hereby certify that this property is included in the National Register



Keeper of the National Register

date 7/1/85

Attest:

date

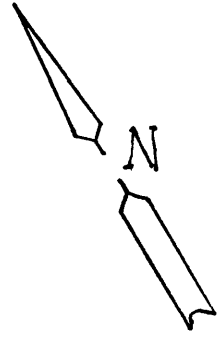
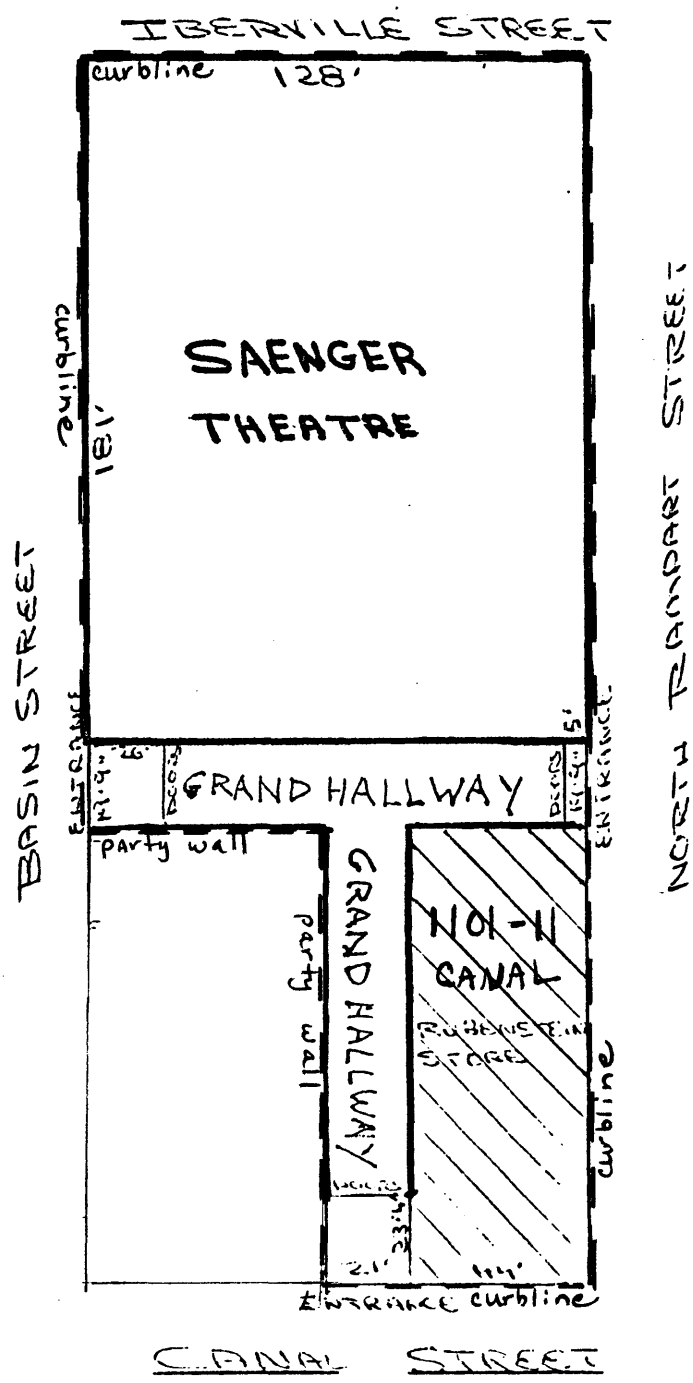
Chief of Registration



 boundary lines
 (including Saenger
 + addendum)

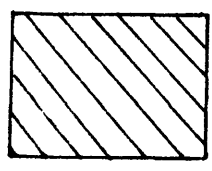

ADDENDUM
 AREA

Saenger Theatre
 Addendum
 (1101-11 Canal)
 New Orleans, LA