

AUG 0 4 1989

1233

**FORM B - BUILDING**

MASSACHUSETTS HISTORICAL COMMISSION  
80 BOYLSTON STREET  
BOSTON, MA 02116

AREA	FORM NO.
	114

Photo (3"x3" or 3"x5", black and white) Indicate address of property on back of photo. Staple to left side of form.

Sketch Map: Draw map showing property's location in relation to nearest cross streets and/or geographical features. Indicate all buildings between inventoried property and nearest intersection(s).  
Indicate north

See Attached Assessor's Map

UTM REFERENCE 19 326/840 4693/040

USGS QUADRANGLE Boston North

SCALE 1:25,000

Town Somerville

Address 33 Beacon Street

Historic Name George Wyatt House

---

Use: Present residential

Original residential

**DESCRIPTION**

Date ca. 1860

Source map research / visual analysis

Style Italianate

Architect none

Exterior Wall Fabric clapboard

Outbuildings none

Major Alterations (with dates) none

Condition good

Moved no Date n/a

Acreage less than one acre

Setting North side of Beacon Street, among other residential buildings, rowhouses, apartment houses, some industrial and commercial surrounds.

Recorded by Gretchen G. Schuler

Organization Mass. Historical Commission

Date September, 1988

### **NATIONAL REGISTER CRITERIA STATEMENT (if applicable)**

The George Wyatt House retains integrity of location, design, materials, workmanship, and association with the development of Ward II as well as association with the brickmaking industry through locally important brick yard owner George Wyatt. The house is significant for its architecture and its historical association, thus, fulfills Criteria A and C of the National Register of Historic Places on the local level.

### **ARCHITECTURAL SIGNIFICANCE Describe important architectural features and evaluate in terms of other buildings within the community.**

Situated in what has become a late-19th century multi-housing area with some industrial encroachment, the George Wyatt House is one of the best local examples of a single-family Italianate dwelling of the three-bay, side-hall entrance plan. The Italianate details exhibited in this dwelling include the raking dentil cornice with carved paired brackets, the molded corner posts, the double entrance door and the fenestration of 6/1 sash and molded surrounds. The scale of the house is of the Greek Revival tradition with a temple gable front and the elaboration is of Italianate influence.

### **HISTORICAL SIGNIFICANCE Explain the role owners played in local or state history and how the building relates to the development of the community.**

The George Wyatt House is located in the southern section of Ward II near the Cambridge line and is representative of the mid 19th century dwellings of the area. It is one of only a few Italianate houses remaining in the immediate area.

The House is important for its association with George Wyatt, and the development of one of Somerville's important 19th century industries, brick making. Wyatt was one the few mid 19th century brick yard owners. His claypit was located just north of his house and has been replaced with Lincoln Park. The brickyard was functioning from ca. 1850 until the mid 1880s. The brickyard was adjacent to the Fitchburg Railroad and was a prosperous yard for over thirty years.

### **BIBLIOGRAPHY and/or REFERENCES**

Draper, Martin, Map of Somerville, 1852  
Hopkins, G.M. Atlas of the City of Somerville, 1874.

#114  
GEORGE WYATT HOUSE  
33 BEACON ST  
SOMERVILLE (MBA)  
MASS.

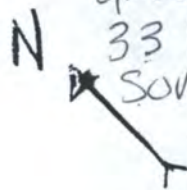

1" = 100'



United States Department of the Interior  
National Park Service

AUG 4 1989

National Register of Historic Places  
Continuation Sheet

Section number \_\_\_\_\_ Page \_\_\_\_\_

Multiple Resource Area  
Thematic Group

Name Somerville MPS  
State Middlesex County, MASSACHUSETTS

Nomination/Type of Review	Date/Signature
71. Tufts, Peter and Oliver, House <i>Entered in the National Register</i>	<i>for</i> Keeper <u>Melrose Byrum 9/18/89</u> Attest _____
72. Warren, H., House <i>Entered in the National Register</i>	<i>for</i> Keeper <u>Melrose Byrum 9/18/89</u> Attest _____
73. West Somerville Branch Library <i>Entered in the National Register</i>	<i>for</i> Keeper <u>Melrose Byrum 9/18/89</u> Attest _____
74. Williams, Charles, House <i>Entered in the National Register</i>	<i>for</i> Keeper <u>Melrose Byrum 9/18/89</u> Attest _____
<i>SEN</i> 75. Williams, Charles, Jr., House Substantive Review	<i>for</i> Keeper <u>Betty L. Savage 9-18-89</u> Attest _____
76. Williams, F.G., House <i>Entered in the National Register</i>	<i>for</i> Keeper <u>Melrose Byrum 9/18/89</u> Attest _____
77. Worthen, Daniel, House <i>Entered in the National Register</i>	<i>for</i> Keeper <u>Melrose Byrum 9/18/89</u> Attest _____
78. Wright House <i>Entered in the National Register</i>	<i>for</i> Keeper <u>Melrose Byrum 9/18/89</u> Attest _____
<i>SEN</i> 79. Wyatt, George, House Substantive Review	<i>for</i> Keeper <u>Betty L. Savage 9-18-89</u> Attest _____
80. Somerville Theatre <del><i>Entered in the National Register</i></del> Substantive Review	Keeper <u>Melrose Byrum 1/20/90</u> <del><i>Entered in the National Register</i></del>

UNITED STATES DEPARTMENT OF THE INTERIOR  
NATIONAL PARK SERVICE

NATIONAL REGISTER OF HISTORIC PLACES  
EVALUATION/RETURN SHEET

REQUESTED ACTION: NOMINATION

PROPERTY NAME: Wyatt, George, House

MULTIPLE NAME: Somerville MPS

STATE & COUNTY: MASSACHUSETTS, Middlesex

DATE RECEIVED: 8/04/89      DATE OF PENDING LIST: 8/15/89  
DATE OF 16TH DAY: 8/31/89      DATE OF 45TH DAY: 9/18/89  
DATE OF WEEKLY LIST:

REFERENCE NUMBER: 89001233

NOMINATOR: STATE

REASONS FOR REVIEW:

APPEAL: N DATA PROBLEM: N LANDSCAPE: N LESS THAN 50 YEARS: N  
OTHER: N PDIL: N PERIOD: N PROGRAM UNAPPROVED: N  
REQUEST: N SAMPLE: N SLR DRAFT: Y NATIONAL: N

COMMENT WAIVER: N

ACCEPT     RETURN     REJECT    9/18/89 DATE

ABSTRACT/SUMMARY COMMENTS:

*Locally significant Italianate residence associated w/ prosperous brick yard owner George Wyatt. The house is apparently all that survives intact of the Wyatt brickmaking business complex.*

RECOM./CRITERIA Accept A+C  
REVIEWER Javage  
DISCIPLINE Architectural History  
DATE 9/18/89

DOCUMENTATION see attached comments Y/N see attached SLR Y/N

---

CLASSIFICATION

count       resource type

---

STATE/FEDERAL AGENCY CERTIFICATION

---

FUNCTION

historic       current

---

DESCRIPTION

architectural classification  
 materials  
 descriptive text

---

SIGNIFICANCE

Period      Areas of Significance--Check and justify below

Specific dates      Builder/Architect  
Statement of Significance (in one paragraph)

summary paragraph  
 completeness  
 clarity  
 applicable criteria  
 justification of areas checked  
 relating significance to the resource  
 context  
 relationship of integrity to significance  
 justification of exception  
 other

---

BIBLIOGRAPHY

---

GEOGRAPHICAL DATA

acreage       verbal boundary description  
 UTM's       boundary justification

---

ACCOMPANYING DOCUMENTATION/PRESENTATION

sketch maps     USGS maps     photographs     presentation

---

OTHER COMMENTS

Questions concerning this nomination may be directed to

\_\_\_\_\_ Phone \_\_\_\_\_

Signed \_\_\_\_\_ Date \_\_\_\_\_



33 Beacon St.

1. 33 Beacon Street  
2. Somerville, MA

3. C. Zellie

4. 1980

5. Somerville City Hall

6. Coolidge North

7. #114 Wyatt, George, House  
Somerville MA, MA

Please refer to the map in the  
Multiple Property Cover Sheet  
for this property

Multiple Property Cover Sheet Reference Number: 64500253