

**United States Department of the Interior
National Park Service**

**National Register of Historic Places
Continuation Sheet**

Section number _____ Page _____

SUPPLEMENTARY LISTING RECORD

NRIS Reference Number: 02001250

Date Listed: October 24, 2002

Property Name: Abraham Lincoln High School

County: Polk

State: Iowa

Public Schools for Iowa: Growth and Change
Multiple Name

This property is listed in the National Register of Historic Places in accordance with the attached nomination documentation subject to the following exceptions, exclusions, or amendments, notwithstanding the National Park Service certification included in the nomination documentation.

for Daniel J. Vivian
Signature of the Keeper

October 24, 2002
Date of Action

Amended Items in Nomination:

Section 8. Statement of Significance

"1957," "1962," "1965," and "ca. 1975" are hereby deleted as significant dates because they are not within the period of significance.

The Iowa State Historic Preservation Office was notified of this amendment.

DISTRIBUTION:

- National Register property file**
- Nominating Authority (without nomination attachment)**

AUG 27 2002

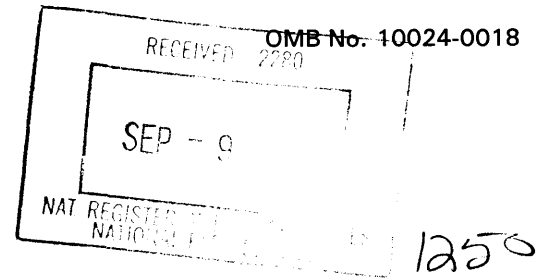

United States Department of the Interior
National Park Service

**NATIONAL REGISTER OF HISTORIC PLACES
REGISTRATION FORM**

This form is for use in nominating or requesting determinations for individual properties and districts. See instructions in How to Complete the National Register of Historic Places Registration Form (National Register Bulletin 16A). Complete each item by marking "x" in the appropriate box or by entering the information requested. If any item does not apply to the property being documented, enter "N/A" for "not applicable." For functions, architectural classification, materials, and areas of significance, enter only categories and subcategories from the instructions. Place additional entries and narrative items on continuation sheets (NPS Form 10-900a). Use a typewriter, word processor, or computer, to complete all items.

1. Name of Property

historic name Abraham Lincoln High School

other names/site number

2. Location

street & number 2600 SW 9th Street

not for publication N/A

city or town Des Moines

vicinity N/A

state Iowa code IA county Polk

code 153 zip code 50315

3. State/Federal Agency Certification

As the designated authority under the National Historic Preservation Act of 1966, as amended, I hereby certify that this X nomination request for determination of eligibility meets the documentation standards for registering properties in the National Register of Historic Places and meets the procedural and professional requirements set forth in 36 CFR Part 60. In my opinion, the property X meets does not meet the National Register Criteria. I recommend that this property be considered significant nationally statewide X locally.

(See continuation sheet for additional comments.)

Rowell J. Locke
Signature of certifying official

August 28, 2002
Date

STATE HISTORICAL SOCIETY OF IOWA
State or Federal agency and bureau

In my opinion, the property meets does not meet the National Register criteria.

(See continuation sheet for additional comments.)

Signature of commenting or other official

Date

State or Federal agency and bureau

4. National Park Service Certification

I hereby certify that this property is:

entered in the National Register

See continuation sheet.

determined eligible for the National Register

See continuation sheet.

determined not eligible for the National Register

removed from the National Register

other (explain):

Daniel J. Vivian 10/24/02

for Signature of the Keeper

Date of Action

5. Classification

Ownership of Property

(Check as many boxes as apply.)

- private
- public-local
- public-State
- public-Federal

Category of Property

(Check only one box.)

- building(s)
- district
- site
- structure
- object

Number of Resources within Property

Contributing	Noncontributing	
<u> 1 </u>	<u> 0 </u>	buildings
<u> </u>	<u> </u>	sites
<u> </u>	<u> </u>	structures
<u> </u>	<u> </u>	objects
<u> 1 </u>	<u> 0 </u>	Total

Number of contributing resources previously listed in the National Register: 0

Name of related multiple property listing (enter "N/A" if property is not part of a multiple property listing):

Public Schools for Iowa: Growth and Change, 1848-1966

Name of Property or District
County, State

Abraham Lincoln High School
Polk County, Iowa

6. Function or Use

Historic Functions (enter categories from instructions)

Cat: EDUCATION Sub: School

Current Functions (enter categories from instructions)

Cat: EDUCATION Sub: School

7. Description

Architectural Classification (enter categories from instructions):

Cat: LATE 19th AND 20th CENTURY REVIVALS Sub: Tudor Revival

Materials (enter categories from instructions):

foundation CONCRETE
roof ASPHALT
walls BRICK

other

Narrative Description (Describe the historic and current condition of the property on one or more continuation sheets.)

8. Statement of Significance

Applicable National Register Criteria

(Mark "x" in one or more boxes for the criteria qualifying the property for National Register listing.)

- A Property is associated with events that have made a significant contribution to the broad patterns of our history.
- B Property is associated with the lives of persons significant in our past.
- C Property embodies the distinctive characteristics of a type, period, or method of construction or represents the work of a master, or possesses high artistic values, or represents a significant and distinguishable entity whose components lack individual distinction.
- D Property has yielded, or is likely to yield information important in prehistory or history.

Criteria Considerations

(Mark "x" in all the boxes that apply.)

- A owned by a religious institution or used for religious purposes
- B removed from its original location
- C a birthplace or a grave
- D a cemetery
- E a reconstructed building, object, or structure
- F a commemorative property
- G less than 50 years of age or achieved significance within the past 50 years

Areas of Significance (enter categories from instructions):

EDUCATION

ARCHITECTURE

Period of Significance

1922-1952

Significant Dates

1922

1957

1962

1965

ca.1975

Significant Person (complete if Criterion B is marked above)

N/A

Cultural Affiliation

Architect/Builder

Proudfoot, Bird and Rawson

Narrative Statement of Significance (Explain the significance of the property on one or more continuation sheets.)

Name of Property or District
County, State

Abraham Lincoln High School
Polk County, Iowa

9. Major Bibliographical References

(Cite the books, articles, and other sources used in preparing this form on one or more continuation sheets.)

Previous documentation on file (NPS)

- preliminary determination of individual listing (36 CFR 67) has been requested.
- previously listed in the National Register
- previously determined eligible by the National Register
- designated a National Historic Landmark
- recorded by Historic American Buildings Survey #
- recorded by Historic American Engineering Record #

Primary Location of Additional Data

- State Historic Preservation Office
- Other State agency
- Federal agency
- Local government
- University
- Other

Name of repository

10. Geographical Data

Acreage of Property: 2.6 Acres

UTM References (Place additional UTM references on a continuation sheet)

	Zone	Easting	Northing		Zone	Easting	Northing
1	<u>15</u>	<u>447784.977</u>	<u>461114.156</u>	3	<u> </u>	<u> </u>	
2	<u> </u>	<u> </u>	<u> </u>	4	<u> </u>	<u> </u>	

See continuation sheet.

Verbal Boundary Description (Describe the boundaries of the property on a continuation sheet.)

Boundary Justification (Explain why the boundaries were selected on a continuation sheet.)

Name of Property or District
County, State

Abraham Lincoln High School
Polk County, Iowa

11. Form Prepared By

name/title Camilla Deiber, Architectural Historian

organization The Louis Berger Group, Inc. date 7/10/02

street & number 950 50th Street telephone 319-373-3043

city or town Marion state Iowa zip code 52302

Additional Documentation

(Submit the following items with the completed form.)

Continuation Sheets

Maps: A USGS map (7.5 or 15 minute series) indicating the property's location.
A sketch map for historic districts and properties having large acreage or numerous resources.

Photographs: Representative black and white photographs of the property.

Additional items (check with the SHPO or FPO for any additional items)

Property Owner

(Complete this item at the request of the SHPO or FPO.)

name Des Moines Public Schools, Superintendent Dr. Eric Witherspoon

street & number 1801 16th Street telephone 515-242-7911

city or town Des Moines state Iowa zip code 50314-1902

Paperwork Reduction Act Statement: This information is being collected for applications to the National Register of Historic Places to nominate properties for listing or determine eligibility for listing, to list properties, and to amend existing listings. Response to this request is required to obtain a benefit in accordance with the National Historic Preservation Act, as amended (16 U.S.C. 470 et seq.).

Estimated Burden Statement: Public reporting burden for this form is estimated to average 18.1 hours per response including the time for reviewing instructions, gathering and maintaining data, and completing and reviewing the form. Direct comments regarding this burden estimate or any aspect of this form to the Chief, Administrative Services Division, National Park Service, P.O. Box 37127, Washington, DC 20013-7127; and the Office of Management and Budget, Paperwork Reductions Project (1024-0018), Washington, DC 20503.

United States Department of the Interior
National Park Service

**NATIONAL REGISTER OF HISTORIC PLACES
CONTINUATION SHEET**

Section 7 Page 1

name of property
county, state

Abraham Lincoln High School
Polk County, Iowa

DESCRIPTION SUMMARY

The Abraham Lincoln High School, built in 1922, is a two-story Tudor Revival brick building that has an H-shape plan. The structure sits on a 15-acre site with the main (east) facade facing an open lawn. The school has an elaborate entrance on both the interior and exterior, a Tudor Revival style auditorium, and a gymnasium. Though there have been several additions to the structure, on the west facade, the structure has a high degree of integrity.

GENERAL DESCRIPTION

Abraham Lincoln High School (Lincoln) is located at 2600 SW 9th Street in Des Moines, Iowa. The school is situated on a 15-acre site with modern additions and parking lots located behind the structure. Several large additions have been constructed onto the west side of the structure including a large rotunda that serves as the principal gymnasium. The original section of the school faces east onto a small wooded lawn. The site of Lincoln is smaller than its counterpart, Roosevelt, since area around Lincoln was more populated when it was built in 1922.

The Tudor Revival style school building, built in 1922, is a two-story, H-shape brick structure with large modern additions on its west facade. The building is dominated by a central five-bay, two-story block that serves as the main entrance to the school. The entrance is five bays wide, the two outer bays being brick with engaged hexagonal piers and limestone oriel windows. The interior bay has a classical arrangement of round arch doorways, and second-story windows with closed and broken pediments. The roof line of the entrance block has a narrow cornice with a limestone balustrade above.

The wings that flank the central entrance block are each five bays wide, the alternating bays being emphasized with a shaped parapet and finials. Each of the window bays is visually grouped with limestone quoins and filigree-like limestone carving on the parapet above the cornice. The secondary facade of the wings, the north and south facades, are each composed of a two-story limestone bay with a highly decorative limestone balustrade, which serves as an entryway, and outer bays of patterned brickwork with a central limestone medallion.

The school has several modern additions including a small one-story counseling center addition built in 1954 on the north side of the building, a library wing in the center of the southern portion of the school that was built in 1962 and a large gymnasium addition on the east side of the school.

INTERIOR ARRANGEMENT

Central corridors run the full length of each of the wings. Cross corridors run along the outside wall of the interior block. The interior block contains a large auditorium and classrooms. The first floor of easternmost wing contains an entrance lobby, administrative offices and conventional classrooms. The majority of northwest wing of the school contains conventional classrooms. The southwest wing, which is a modern addition, contains the library. A large block that contains a gymnasium and locker rooms extends out from the center of the west facade. Originally, the entire block was housed both a boys and girls gym and locker rooms. Most of the upper story contains conventional classroom spaces.

United States Department of the Interior
National Park Service

**NATIONAL REGISTER OF HISTORIC PLACES
CONTINUATION SHEET**

Section 7 Page 2

name of property
county, state

Abraham Lincoln High School
Polk County, Iowa

MAIN LOBBY

The interior of the main lobby has a strong Tudor Revival influence with floor to ceiling oak wainscot, beamed ceiling, and plaster beams with arabesque ornamentation. Three doorways with arched multi-pane transoms mirror the doorways on the main façade. Oak pilasters support molded plaster beams that are highly decorated with arabesque ornament. The floor is terrazzo with a central marble medallion.

HALLWAYS/STAIRWAYS

The hallways are finished with terrazzo flooring, oak wainscot up to five feet, and plaster walls. Original oak lockers have been replaced with modern steel lockers. Staircases, located on either side of the auditorium have metal stairs, metal balustrades, and oak wainscot.

AUDITORIUM

The auditorium is located immediately behind the front entrance, to provide easy access to the public while restricting access to the remainder of the school. The auditorium, with a seating capacity of 1,300, has wooden seats and a large U-shaped balcony that is half the depth of the space. The ornament mirrors that of the lobby with a beamed ceiling adorned with quatrefoil designs. Tudor arch windows with plaster hood moldings and label stops are located on the side walls of the space. The proscenium is decorated with a framework of slender faceted columns filled with three panels inscribed with Lincoln's Gettysburg Address. Original brass chandeliers hang from large, star-shaped gothic centerpieces.

GYMNASIUMS

The original plan of Abraham Lincoln High School had separate gymnasiums for boys and girls, both located in a large block on the west facade of the structure. The boy's gymnasium was converted into locker rooms. However, the girl's gymnasium remains intact with its pine flooring, two-story segmental arch windows, and brick walls.

Though there have been numerous additions onto the rear and secondary facades of the building, the east and north facades remain virtually intact, maintaining the integrity of the building's design, feeling, materials, and association. The additions have not diminished the building's original floor plan or interior finishes: major public spaces such as the lobby, hallways, auditorium and one of the gymnasiums remain intact and are able to convey the period of significance of the school.

The Des Moines School District does plan to renovate the building within a couple of years. Details of the renovation plans are not available at this time.

United States Department of the Interior
National Park Service

NATIONAL REGISTER OF HISTORIC PLACES CONTINUATION SHEET

Section 8 Page 3 name of property Abraham Lincoln High School
county, state Polk County, Iowa

SIGNIFICANCE SUMMARY

Abraham Lincoln High School is locally significant under Criterion A as it is associated with the development of secondary educational facilities after district consolidation in Des Moines in 1907 and is locally significant under Criterion C as it is quintessential example of the "Modern School" with its H-shape plan, highly decorated main lobby, and specialized spaces such as an auditorium and gymnasium and as an excellent example of the Tudor Revival style of architecture designed by one of Iowa's preeminent architectural firms, Proudfoot, Bird and Rawson. Evaluation of East High School for National Register eligibility is based upon criteria outlined in the Multiple Property Documentation Form *Public Schools for Iowa: Growth and Change, 1848-1966* (Beedle and Deiber 2002) under the property type "City High School." The school meets all of the requirements for registration of the modern high school type; the open plan, the elaborate lobby space, a pool, an auditorium, and a girl's and boy's gymnasium.

RESOURCE HISTORY AND HISTORIC CONTEXT

Tremendous growth in Des Moines in the 1920s created an increasing demand for classroom space at the high school level. The 1920s also saw a shift in educational organization from the 8-4 plan, an eight year elementary and a four year high school, to the 6-3-3 plan, a six year elementary, a three year junior high and a three year high school. In order to alleviate the demands for more high school space, the Des Moines Independent School District issued over \$6,500,000 in bonds to finance the construction of two new high schools, Abraham Lincoln and Theodore Roosevelt High Schools.

Abraham Lincoln and Theodore Roosevelt High Schools were built in 1922 and designed by Proudfoot, Bird, and Rawson. Lincoln was built on a 15-acre site and cost \$775,492 to construct. It was constructed to serve the increasing student population of the South Side neighborhood, which was a mixture of Sicilian/Italian immigrants and some upper class families such as the Hubbells and the Cassidys.

Lincoln was established as a six-year high school, but in the first years served only seventh and eighth grade students. The first year the school had an enrollment of only 145 students. By 1926, the school had an enrollment of 396 students and offered a full high school curriculum including a commercial course, college preparatory course, industrial arts course, and home economics course. The educational curriculum was supplemented by art, music, drama, journalism, and debating clubs. Lincoln continued as a six-year high school until 1967, when three junior high schools were constructed in the South Side neighborhood.

Through the years the school has had several additions and alterations. In 1938, a football stadium, which was located to the northwest of the school, was built with WPA funds. A new athletic field was constructed just east of the football stadium and floodlights were added to the football stadium in 1947. The industrial arts annex of the school, located on the southwest corner of the structure, was completely destroyed by fire in 1957. A slightly larger L-shaped wing replaced the industrial annex that same year. In 1962, a wing that included a library, and science classrooms was added to the rear of the school. A new rotunda that housed a gymnasium and swimming pool was added to the school complex in 1965: it was attached to the main school via an enclosed corridor. A three-story block, termed "the tower" by school administrators, was built around 1975 and attached to the south side of the school by an elevated walkway. Also around 1975, an auto shop was constructed on the northwest side of the school and also connected via an enclosed walkway.

United States Department of the Interior
National Park Service

**NATIONAL REGISTER OF HISTORIC PLACES
CONTINUATION SHEET**

Section 8 Page 4

name of property
county, state

Abraham Lincoln High School
Polk County, Iowa

The firm of Proudfoot, Bird & Rawson was one of Iowa's foremost architectural firms. The firm and its predecessor, Proudfoot & Bird, designed countless secondary and post-secondary school buildings including numerous buildings at Iowa State University and the University of Iowa. Besides Roosevelt and Lincoln High Schools, Proudfoot, Bird and Rawson designed the David W. Smouse Opportunity School, Callanan Junior High School, Amos Hiatt Junior High School, John Quincy Adams School, and the Phillips School.

United States Department of the Interior
National Park Service

**NATIONAL REGISTER OF HISTORIC PLACES
CONTINUATION SHEET**

Section 9 Page 5 name of property Abraham Lincoln High School
county, state Polk County, Iowa

MAJOR BIBLIOGRAPHICAL REFERENCES

Abraham Lincoln High School

1973 The Fiftieth Anniversary of Abraham Lincoln High School. Booklet available at the Abraham Lincoln High School Library, Des Moines, Iowa.

Denny, Robert (ed.)

1966 *History of the Des Moines Public Schools*. The Des Moines Public Schools, Des Moines, Iowa.

Sanborn Fire Insurance Company

1901-57 *Map of Des Moines, Iowa*. Sanborn Fire Insurance Company, Chicago.

United States Department of the Interior
National Park Service

**NATIONAL REGISTER OF HISTORIC PLACES
CONTINUATION SHEET**

Section 10 Page 6 name of property Abraham Lincoln High School
county, state Polk County, Iowa

GEOGRAPHICAL DATA

Verbal Boundary Description

The National Register boundary for Abraham Lincoln High School is depicted on the following figure.

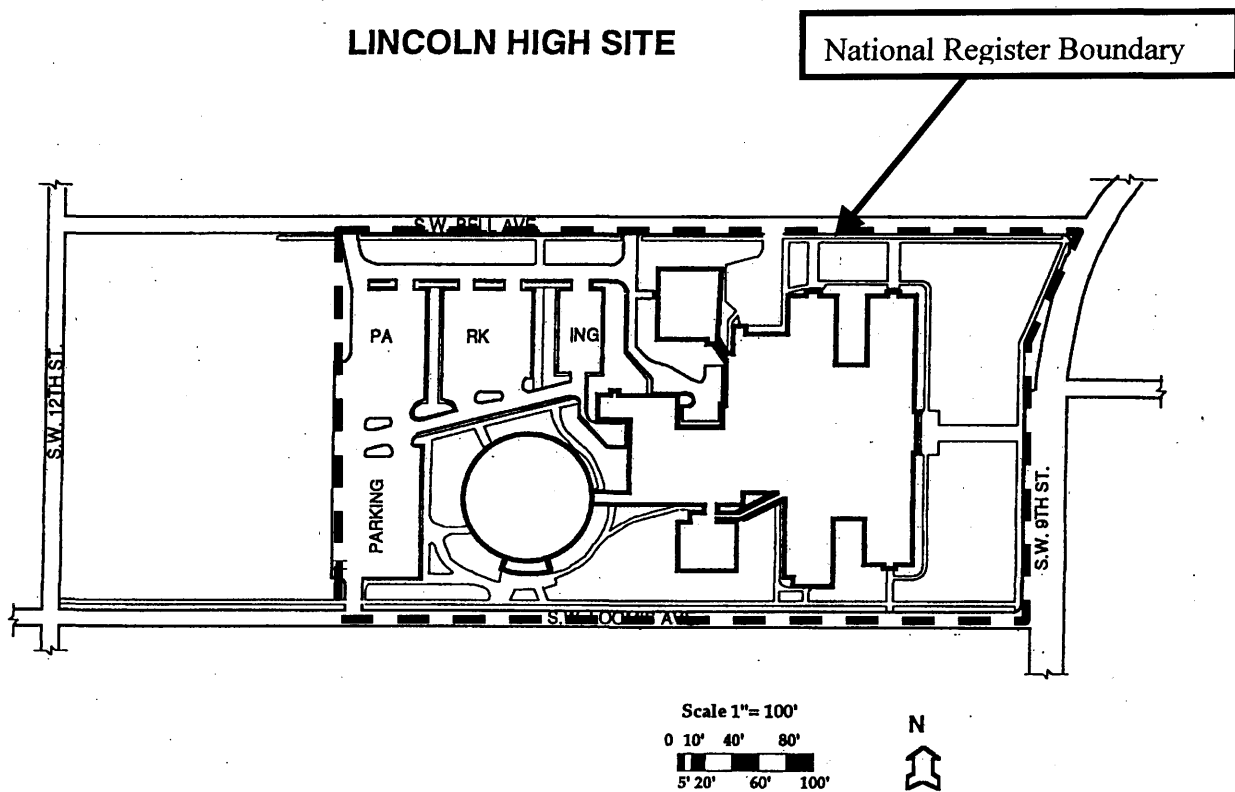

Boundary Justification

The nominated property includes the entire parcel historically associated with the school.

United States Department of the Interior
National Park Service

**NATIONAL REGISTER OF HISTORIC PLACES
CONTINUATION SHEET**

Section Photos Page 7 name of property Abraham Lincoln High School
county, state Polk County, Iowa

The following items apply to all photographs:

Property Name: Abraham Lincoln High School
Location: Des Moines, Polk County, Iowa
Photographer: Camilla R. Deiber
Date of Photographs: 2001
Location of Negatives: The State Historical Society of Iowa, Community Programs Bureau, Des Moines, Iowa
50319

Individual Photograph Identifications:

1. Overall view, looking northwest
2. View of main entrance, looking west
3. View of carved limestone panel on east facade, looking west
4. Overall view, looking southwest
5. View of north entrance, looking south
6. Overall view, looking north
7. Overall view, looking northeast
8. Overall view, looking south by southeast
9. First floor hallway, looking south
10. Niche with bust of Abraham Lincoln located across main lobby, looking west
11. Main lobby, looking southwest
12. Auditorium, looking northeast
13. Auditorium stage and proscenium, looking northwest
14. Girl's gymnasium, looking west by northwest
15. Classroom, looking northwest

United States Department of the Interior
National Park Service

**NATIONAL REGISTER OF HISTORIC PLACES
CONTINUATION SHEET**

Section Floor Plans Page 8 name of property Abraham Lincoln High School
county, state Polk County, Iowa

LINCOLN HIGH SITE

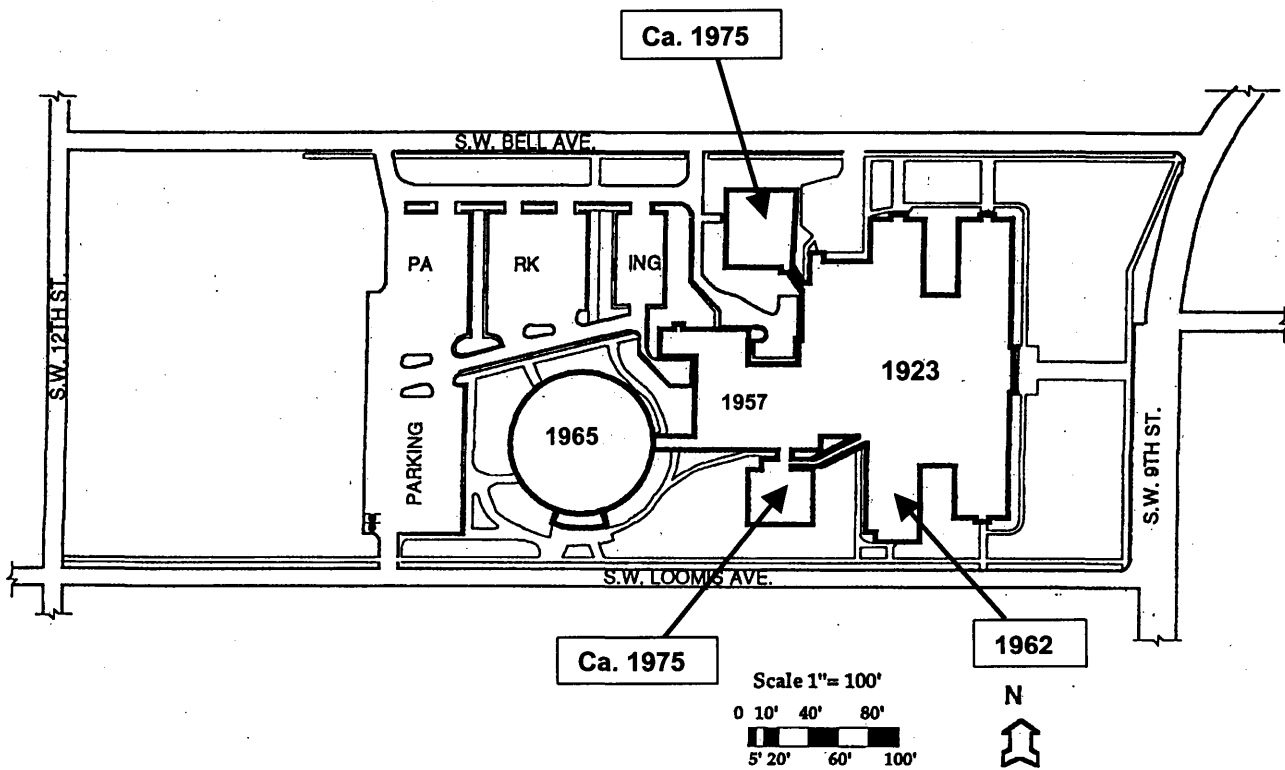

Duane Van Hemert, Exec. Director of Facilities, Des Moines Public Schools, Des Moines, Iowa. December 2001.

United States Department of the Interior
National Park Service

**NATIONAL REGISTER OF HISTORIC PLACES
CONTINUATION SHEET**

Section Floor Plans Page 9 name of property Abraham Lincoln High School
county, state Polk County, Iowa

LINCOLN HIGH SCHOOL

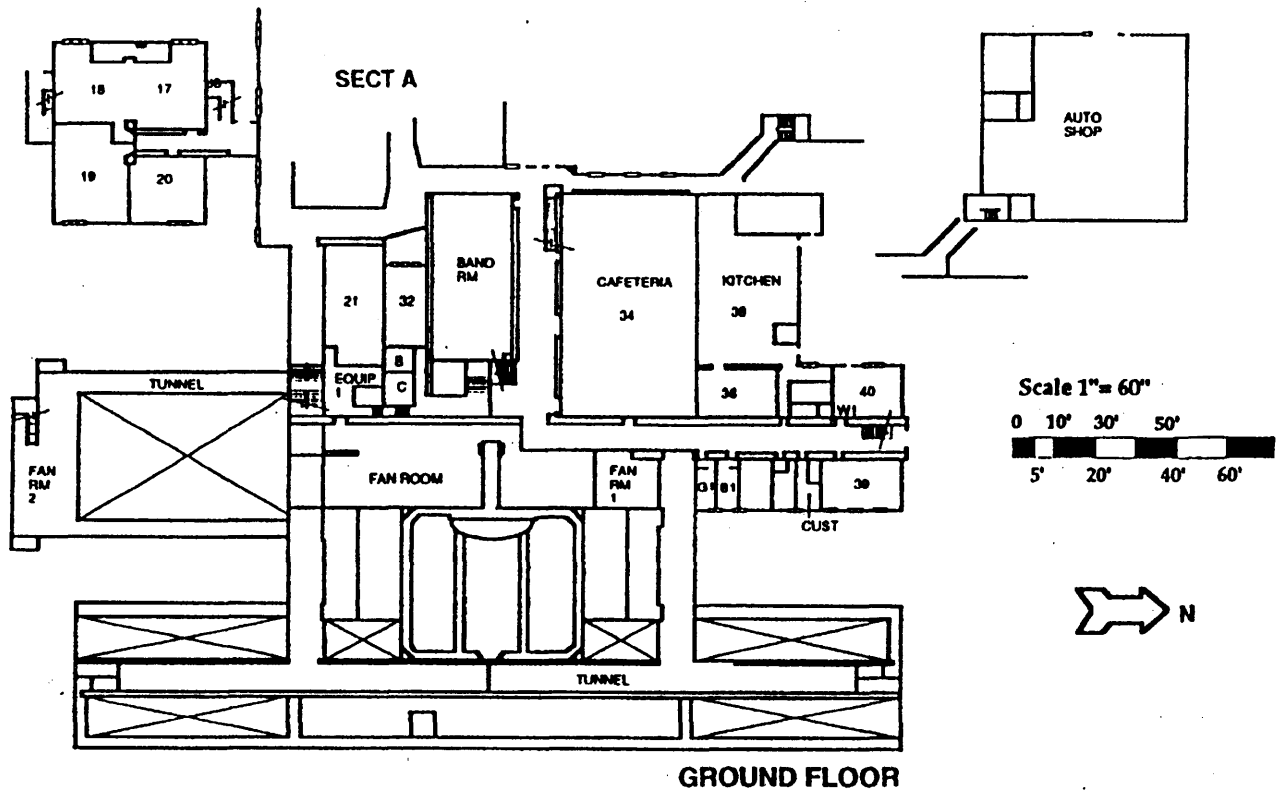

Duane Van Hemert, Exec. Director of Facilities, Des Moines Public Schools, Des Moines, Iowa. December 2001.

United States Department of the Interior
National Park Service

NATIONAL REGISTER OF HISTORIC PLACES CONTINUATION SHEET

Section Floor Plans Page 10 name of property Abraham Lincoln High School
county, state Polk County, Iowa

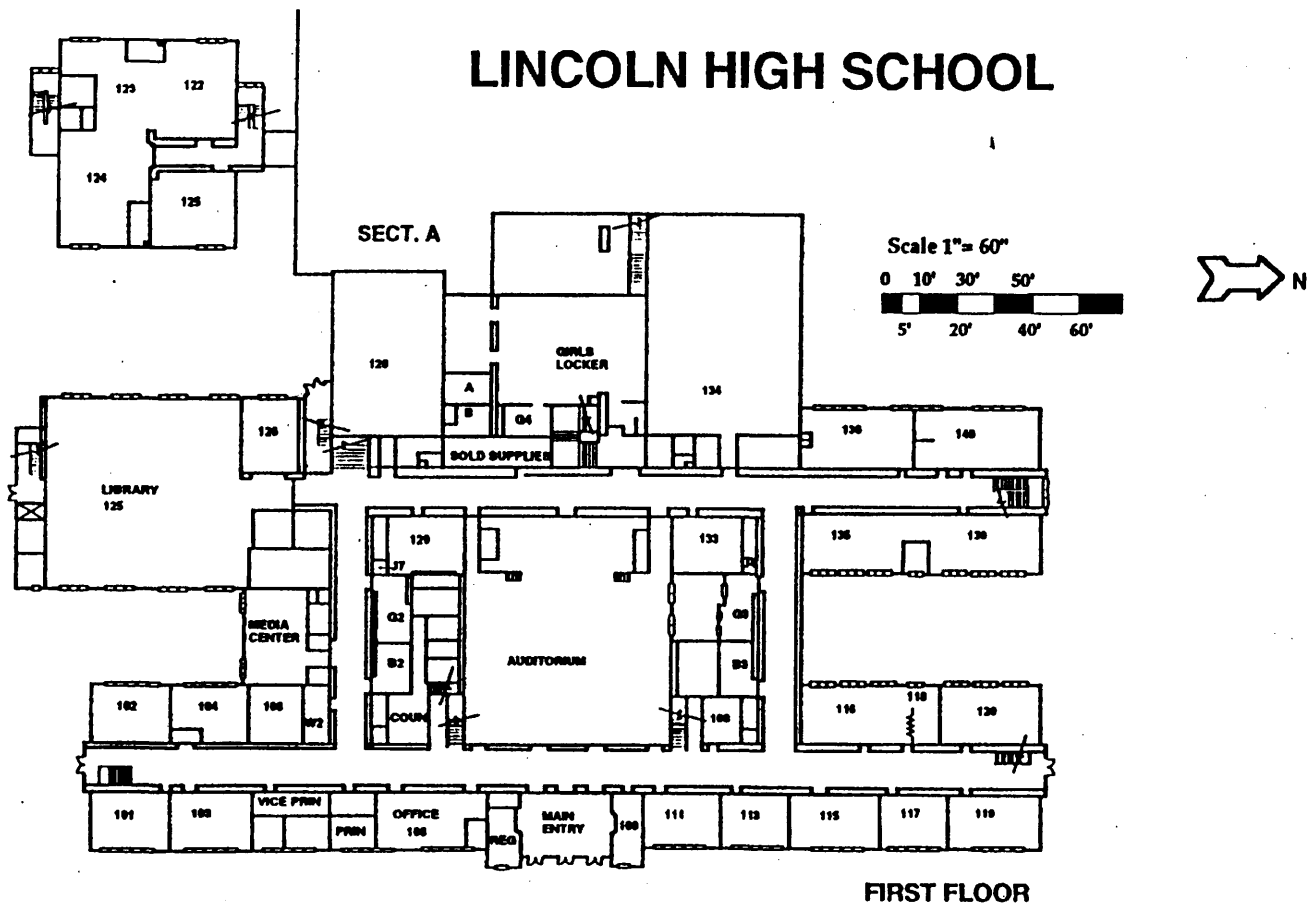

Duane Van Hemert, Exec. Director of Facilities, Des Moines Public Schools, Des Moines, Iowa. December 2001.

United States Department of the Interior
National Park Service

**NATIONAL REGISTER OF HISTORIC PLACES
CONTINUATION SHEET**

Section Floor Plans Page 11 name of property Abraham Lincoln High School
county, state Polk County, Iowa

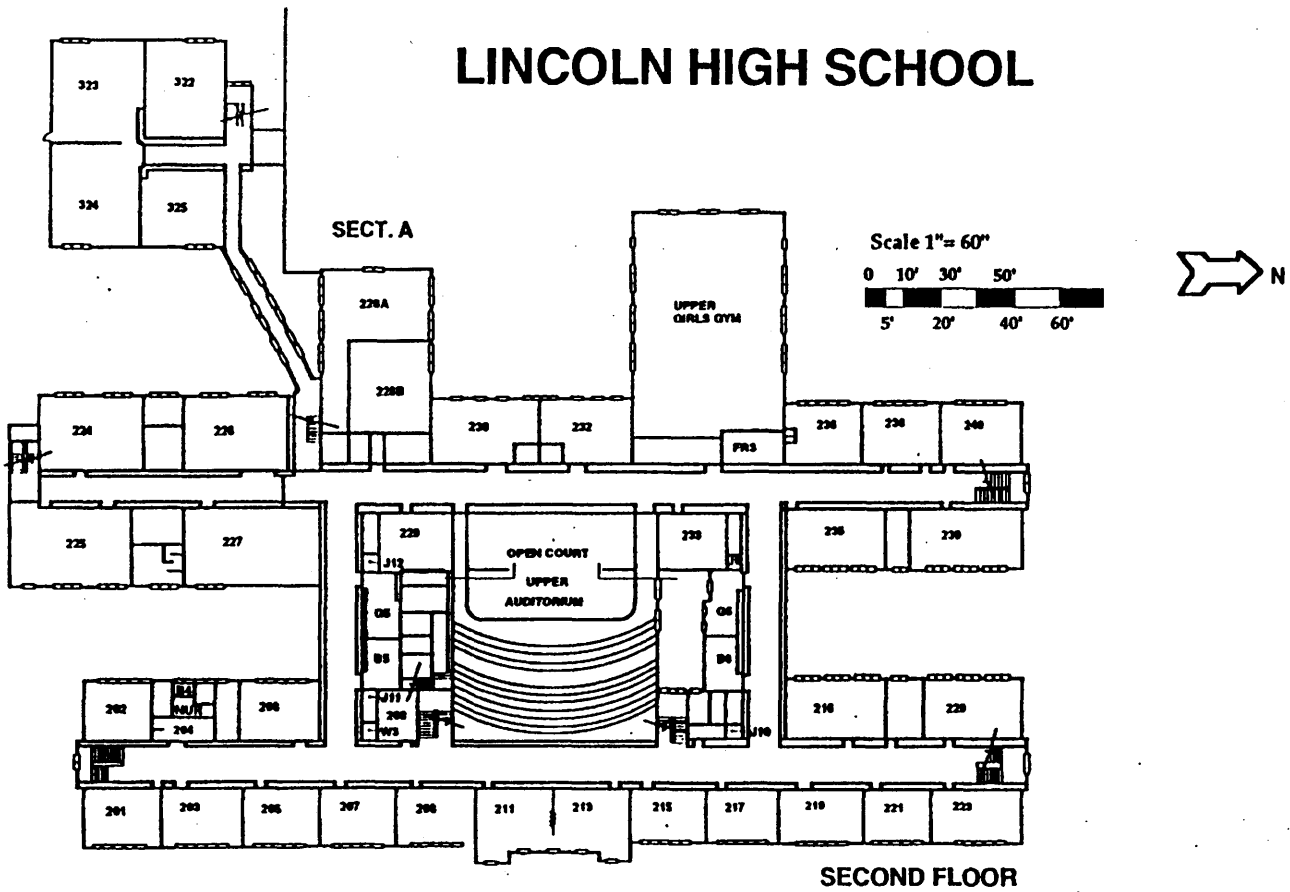

Duane Van Hemert, Exec. Director of Facilities, Des Moines Public Schools, Des Moines, Iowa. December 2001.