

United States Department of the Interior
National Park Service

4727

National Register of Historic Places Registration Form

This form is for use in nominating or requesting determinations for individual properties and districts. See instructions in National Register Bulletin, *How to Complete the National Register of Historic Places Registration Form*. If any item does not apply to the property being documented, enter "N/A" for "not applicable." For functions, architectural classification, materials, and areas of significance, enter only categories and subcategories from the instructions.



1. Name of Property

Historic name: Burlington Township No. 9 School
Other names/site number: Milburn School
Name of related multiple property listing:
Indiana's Public Common and High Schools 1816-1945
(Enter "N/A" if property is not part of a multiple property listing)

2. Location

Street & number: 6013 County Road E 600 S
City or town: Burlington State: IN County: Carroll
Not For Publication: Vicinity:

3. State/Federal Agency Certification

As the designated authority under the National Historic Preservation Act, as amended,

I hereby certify that this x nomination request for determination of eligibility meets the documentation standards for registering properties in the National Register of Historic Places and meets the procedural and professional requirements set forth in 36 CFR Part 60.

In my opinion, the property x meets does not meet the National Register Criteria. I recommend that this property be considered significant at the following level(s) of significance:

 national statewide x local

Applicable National Register Criteria:

 x A B x C D

	ASSISTANT DIR. OF PRES. SERVICES	10.17.19
Signature of certifying official/Title:		Date
<u>Indiana DNR-Division of Historic Preservation and Archaeology</u>		
State or Federal agency/bureau or Tribal Government		

In my opinion, the property <u> </u> meets <u> </u> does not meet the National Register criteria.	
Signature of commenting official:	Date
Title :	State or Federal agency/bureau or Tribal Government

Burlington Township No. 9 School
Name of Property

Carroll County, IN
County and State

4. National Park Service Certification

I hereby certify that this property is:

- entered in the National Register
- determined eligible for the National Register
- determined not eligible for the National Register
- removed from the National Register
- other (explain:)

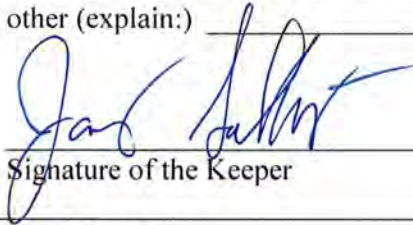
Signature of the Keeper

11.29.2019
Date of Action

5. Classification

Ownership of Property

(Check as many boxes as apply.)

- Private:
- Public – Local
- Public – State
- Public – Federal

Category of Property

(Check only **one** box.)

- Building(s)
- District
- Site
- Structure
- Object

Burlington Township No. 9 School
Name of Property

Carroll County, IN
County and State

Number of Resources within Property

(Do not include previously listed resources in the count)

Contributing	Noncontributing	
<u>1</u>	<u>0</u>	buildings
<u>0</u>	<u>0</u>	sites
<u>0</u>	<u>0</u>	structures
<u>0</u>	<u>0</u>	objects
<u>1</u>	<u>0</u>	Total

Number of contributing resources previously listed in the National Register 0

6. Function or Use

Historic Functions

(Enter categories from instructions.)

EDUCATION: school

Current Functions

(Enter categories from instructions.)

WORK IN PROGRESS

Burlington Township No. 9 School
Name of Property

Carroll County, IN
County and State

7. Description

Architectural Classification

(Enter categories from instructions.)

LATE VICTORIAN: Italianate

Materials: (enter categories from instructions.)

foundation: STONE

walls: BRICK

roof: ASPHALT

other:

Narrative Description

(Describe the historic and current physical appearance and condition of the property. Describe contributing and noncontributing resources if applicable. Begin with a **summary paragraph** that briefly describes the general characteristics of the property, such as its location, type, style, method of construction, setting, size, and significant features. Indicate whether the property has historic integrity.)

Summary Paragraph

Burlington Township No. 9 School, also known as Milburn School, was built about 1876 in rural southeast Burlington Township. The building sits on less than an acre at the corner of two county roads and faces south. The brick one-room gable-front building has simple Italianate features and double entries on its front wall. It was used for educating children until consolidation caused it to be closed by 1910. The building, which is undergoing restoration, is the only resource on the property which is surrounded by lawn and extends into tilled ground to its north and east.

Burlington Township No. 9 School
Name of Property

Carroll County, IN
County and State

Narrative Description

The small corner site of Burlington Township No. 9 School features lawn in its south and west ends and is partly tilled and cultivated for crops in its north and east ends. The brick building, which faces south, is situated near the center of the site.

The building has a foundation composed of split fieldstone with several larger hand-split and squared cornerstones. The ground around the building is built up in the front (south) at the entries and tapers off to the back where more of the stone foundation is visible. The walls are composed of common bond brick courses with header courses approximately every nine courses. The building features door and window openings with thick limestone sills and segmental arched hoods. The arches are composed of two header courses stepped outward to a standard course that trims the perimeter of the arch. The arches have a single brick corbel under each side of the arch, to each side of the window and door openings. The wood windows are not extant. The entries feature a four-panel wood door in the west entry (photo 0008); the east entry door is not extant. Originally, there were wood transoms over the doors. Currently, the door and window openings are covered with boards and plywood. A frieze board is at the top of the walls. The roof is covered with new asphalt shingles and new wood fascia boards (2017).

The front (south) façade features two entries, one in each half of the wall, and a small round opening in the top of the gable wall (photos 0001-0002). The round opening is trimmed with brick and was originally filled with a wood window. The east and west facades feature two small rectangular metal foundation grate-like vents in the foundation wall just below the bottom course of brick (photos 0002-0003). These facades also each feature four window openings. The rear (north) wall is the back gable; it is without any openings (left side of photo 0003). A small chimney was once located on the ridge near this back wall but it had been truncated and then removed in 2017.

The interior is arranged as one large room with a raised wood platform between the entries (photo 0007). The platform has cutaway corners on its front (north) end. The floor of the room and platform are composed of narrow planking. Tall wood baseboards are around the perimeter and step up at the back of the platform. The building has plaster walls; the plaster had largely fell from the ceiling and was completely removed in 2017. Chalkboards are painted black over plaster across the entire width of the north wall (photo 0004), about three feet above the floor, and between the entries in the south wall. While the wood top trim and chalk tray is missing on the north wall, it is located above and below the chalkboard on the south wall. Extant narrow wood strips nailed in the southwest corner of the room, and between the southernmost two windows on the east wall appear to have been used for coats and lunch pail hanging (left side of photo 0005).

All of the wood casings around the entries and window openings are extant (photo 0006). These are simple, wide boards forming vertical trim on each side of the openings and a skirt board under the wood sill of the windows. Wide wood jambs cover the brick walls on the inside of the openings. A trim board with angle-cut ends tops the windows and entries.

Burlington Township No. 9 School
Name of Property

Carroll County, IN
County and State

8. Statement of Significance

Applicable National Register Criteria

(Mark "x" in one or more boxes for the criteria qualifying the property for National Register listing.)

- A. Property is associated with events that have made a significant contribution to the broad patterns of our history.
- B. Property is associated with the lives of persons significant in our past.
- C. Property embodies the distinctive characteristics of a type, period, or method of construction or represents the work of a master, or possesses high artistic values, or represents a significant and distinguishable entity whose components lack individual distinction.
- D. Property has yielded, or is likely to yield, information important in prehistory or history.

Criteria Considerations

(Mark "x" in all the boxes that apply.)

- A. Owned by a religious institution or used for religious purposes
- B. Removed from its original location
- C. A birthplace or grave
- D. A cemetery
- E. A reconstructed building, object, or structure
- F. A commemorative property
- G. Less than 50 years old or achieving significance within the past 50 years

Burlington Township No. 9 School
Name of Property

Carroll County, IN
County and State

Areas of Significance

(Enter categories from instructions.)

ARCHITECTURE

EDUCATION

Period of Significance

c. 1876-1910

Significant Dates

Significant Person (last name, first name)

(Complete only if Criterion B is marked above.)

Cultural Affiliation

Architect/Builder (last name, first name)

Burlington Township No. 9 School
Name of Property

Carroll County, IN
County and State

Period of Significance (justification)

The period of significance for Burlington Township No. 9 School begins c. 1876, the estimated year the school building was constructed, and it ends in 1910. This was the last year it was used for school purposes prior to a consolidation of one-room district schools to the township school in Burlington.

Criteria Considerations (explanation, if necessary)

N/A

Statement of Significance Summary Paragraph (Provide a summary paragraph that includes level of significance, applicable criteria, justification for the period of significance, and any applicable criteria considerations.)

Burlington Township No. 9 School is eligible to be listed on the National Register of Historic Places under criterion A in the area of education as an excellent example of a rural district schoolhouse located in Burlington Township in Carroll County, Indiana. The building retains high architectural integrity identifying it as a district schoolhouse including its form, original interior plan, intact chalkboard, and teacher’s platform. The school also qualifies for listing on the National Register of Historic Places under criterion C in the area of architecture. The building is a good example of a small district schoolhouse constructed in the Italianate style. While the original doors and windows are no longer extant, the openings remain. The interior retains a high level of architectural integrity including significant wood trim casings and platform.

Burlington Township No. 9 School also meets registration requirements under the multiple properties documentation form: *Indiana’s Public Common & High Schools*. The building is identified under the associated property type “One-Room Schoolhouse” and meets registration requirements through the building’s rural nature and simple plan design. The building’s massing and pattern of window and entry door openings has not been changed, nor has the interior space been altered with new partition walls. The building also retains sufficient interior integrity of historic features such as wood trim, blackboard, and teacher’s platform. The building’s construction and operation as a publicly-funded township education facility is also evidenced in its documented use on township atlases.

Burlington Township No. 9 School
Name of Property

Carroll County, IN
County and State

Narrative Statement of Significance (Provide at least **one** paragraph for each area of significance.)

EDUCATION

Burlington Township was established in 1832, separated from Jackson Township. Carroll County's three original townships were established in 1828. Education in Burlington Township, in its earliest form, took place in log schools located both in the town of Burlington (the only platted town in the township) and in section 32 west of Burlington. School was also held in a building that doubled as a church called Asbury in section 30 in the northwestern part of the township and in an abandoned cabin in section 6 on the west side of the township. These schools were held during 1835-1840. The first transfer of land for a school building purpose was in 1856; however other school buildings were being constructed during the 1850s without legal transfer which then permitted the land to revert back to the farm once the building was vacated by the township school.

In 1848, the State of Indiana allowed voters to decide if education should be made available free to the public in a referendum. The State Constitution was amended to include Article VIII providing for tax dollars to be used for the free education of the public's children. After its adoption, rural schools began to develop. The new Indiana Constitution of 1851 reaffirmed the concept of free public education. District schools were typically positioned so that students need not walk any further than about one mile. Such schools were frequently on land donated by a farming family under the condition the land would revert back to the family if there was no longer a school on the land.

The first township map of Burlington Township shows eight school districts in 1863. Milburn School/District No. 9 did not exist at that time. The nearest district schools were about an equal distance apart from where Milburn would be located, No. 6 (southeast of Milburn and east of the Michigan Road) and No. 7 (southwest of Milburn). There was also a school located in Burlington, northeast of where Milburn would be located. By 1897, the township map included ten district schools, the highest division of the township into school districts. This included the Milburn School (No. 9) in the southwest corner of section 3, southwest of Burlington. The following is a list of Burlington Township's ten district schools by district number, section number, generally used name and length of operation (though each district school may have had more than one building if it had been reconstructed):

- District 1, Section 26, Liberty School, 1859-1914
- District 2, Section 21, Eikenberry School, 1857-1879
- District 2, Section 28, Gwinn or Brush College, 1879-1914
- District 3, Section 30, Asbury, before 1856-1920
- District 4, Section 32, Otterbein, 1857-1910
- District 5, Section 34, Burlington, 1836-1980
- District 6, Section 11, Hendrix, 1859-1879

Burlington Township No. 9 School
Name of Property

Carroll County, IN
County and State

District 6, Section 10, Hendrix, 1879-1913
District 7, Section 17, Koro or College Corner, 1856-1923 or 1924
District 8, Section 18, Possum Trot, before 1863-1920
District 9, Section 3, Milburn, about 1876-1910
District 10, Section 21, Union, 1892-1920

Evidently, it was felt that District 9 filled a geographic need as it appears to fill a void demonstrated in the 1863 map. Union also filled a geographic need, serving children from both Carrollton Township, which borders Burlington Township's north boundary, and Burlington Township. The schoolhouse was built near the township line in section 21.

Of these ten township schools, only Milburn (No. 9, photo 0001) and Otterbein (No. 4) are extant. Otterbein was built on the Lafayette-Burlington State Road (County Road 500 S) between Cutler and Burlington on section 32. A half-acre was purchased for the school in 1857 for \$10.00 from the Moss family who owned the land. The extant building appears to date to c. 1880 and was also used by the Otterbein Methodist Protestant Church. The building ceased as a school in 1910 under township consolidation of schools. It was converted to a residence and includes a modern addition on its front.

District No. 9 School was established by about 1876. That estimated date of construction is due to a newspaper article that states that the township was accepting bids on the construction of two brick schools in that year. It is known to have been built prior to about 1881 because the township had been divided into nine school districts by that time and No. 9 is the number Milburn carried, and it appears in an 1882 map of the township. The township trustee, George Appenzellar, purchased one acre of land on August 11, 1883 from Andrew and Catherine Milburn for \$25.00; however, the building appears to have already been constructed on the site by that time. The 1882 History of Carroll County indicates that there were nine schools, seven of which were brick and two were frame. The total value of school property was \$9,150.00 in that year. The total number of students admitted in the township during the 1880-1881 school year was 415 with an average attendance of 200. The average length of the school term was 105 days and teachers' salaries were \$2.23 per day.

Classes were held at District No. 9/Milburn School through the 1909/1910 school year. Beginning in the fall of 1910, Burlington Township schools were consolidated to a new building in the town of Burlington. The Milburn School was sold back to Andrew Milburn for \$700.00 in December 1911. Burlington School had been constructed in 1886 as a two-story building with four classrooms. With consolidation of the township's district schools, a new building was constructed on the same site in 1912. A gymnasium and additional classrooms were added in 1928-1929, and a cafeteria was built in 1941. The building accepted all of the township's pupils. The building was converted for sole use as an elementary school in 1961, but by 1980, the building was abandoned and students sent elsewhere. The Burlington School is no longer extant.

Burlington Township No. 9 School
Name of Property

Carroll County, IN
County and State

ARCHITECTURE

District No. 9 School is a simple example of the Italianate style used in the construction of a one-room schoolhouse. The Italianate style was popular between 1850 and 1880, particularly in Midwestern towns where the expansion of railroads brought wealth to communities and created a building boom during the period. The style traces its roots to England as part of the Picturesque Movement; the movement rejected formal classical ideas of art and architecture that were popular for 200 years. The Picturesque Movement emphasized rambling, informal architecture, including rural Italian farmhouses and villas. As the style entered the United States, it was often modified and embellished into a truly Americanized style typically in wooden construction, due to the plentiful timber in America. Cupolas, towers, and bracketed cornices became the style's hallmarks. The first Italianate house was constructed in the United States in the late 1830s. The style was popularized by house pattern books by Andrew Jackson Downing during the middle part of the 1800s, but its popularity began to wane as it began to be replaced by the Queen Anne Style in the last decades of the 19th century.

The school's architectural style is in keeping with the popularity of the Italianate style during its construction date of 1876. The building's most notable Italianate feature is window and entry hoods composed of brick that top tall openings in the walls (see photo 0002). The segmental arches were developed further than just the transfer of weight over the openings, but were articulated with stepped courses of header brick trimmed with standard brick and carried by one-brick corbels. This detail, though simple, gives the building a distinctive nod to the Italianate style. The building's front gable also features a small round opening at the top of the wall (photo 0002). These are also often found in Italianate architecture. The interior is simple with its only distinguishing feature found in the lintel trim boards that top the window and entry openings, which are cut at angles on either end (photo 0006). Two other important architectural features of the interior include the raised wood teacher's platform and blackboard between the entries (south wall, photo 0007). Platforms were uncommon in one-room schools and seldom remain extant. The blackboards top trim and chalk shelf are extant on the south wall, but not on the full-width board on the north wall (photo 0004).

As previously mentioned, only Milburn School and Otterbein School are extant from the original ten district schools in Burlington Township. Otterbein School, also a gable-front brick building, was converted to a residence and has a modern gabled addition on its front façade. Milburn School has an unusual feature of two entries in its front façade (photo 0001). Of Carroll County's extant 25 one-room schoolhouses, this is unique. However, historic photographs show at least two other brick schoolhouses with similar double entries in Burlington Township. One was the Hendrix School (No. 6) located on Michigan Road south of Burlington. It was built c. 1879 and features a small round window in the top of its gable. The other school with two front entries was the Gwinn School/Brush College (No. 2) that was located in section 28. It was also constructed about 1879. These two buildings and Milburn School are very similar in appearance: brick gable-front buildings with two front entries and round windows in the top of the front gables. They may have been constructed by the same builder, or the trustee may have provided matching plans for bidding. Of the remaining extant Carroll County one-room schools,

Burlington Township No. 9 School
Name of Property

Carroll County, IN
County and State

most are brick gable-front or T-plan buildings with single front entries. Most of these have been converted for farm use or storage. The extant buildings have simple architectural features and brickwork, as did most one-room schools of the late 1800s.

Developmental History/Additional historic context information

Burlington Township No. 9 School
Name of Property

Carroll County, IN
County and State

9. Major Bibliographical References

Bibliography (Cite the books, articles, and other sources used in preparing this form.)

Carroll County, Indiana Historic Sites and Structure Inventory. Indiana Landmarks, 2011.

Diebold, Paul. *Indiana's Public Common & High Schools 1816-1945*, Multiple Properties Documentation Form, 1998.

History of Carroll County, Indiana. Chicago: Kingman Brothers, 1882.

Maxwell, Bonnie. *Burlington Township Schools, Carroll County, Indiana* (a self-published report). 2018.

Maxwell, Bonnie. *Carroll County Schools* (a self-published report). 2018.

Odell, John C., History of Carroll County, Indiana. Indianapolis: B. F. Bowen & Co., 1916.

Previous documentation on file (NPS):

- preliminary determination of individual listing (36 CFR 67) has been requested
- previously listed in the National Register
- previously determined eligible by the National Register
- designated a National Historic Landmark
- recorded by Historic American Buildings Survey # _____
- recorded by Historic American Engineering Record # _____
- recorded by Historic American Landscape Survey # _____

Primary location of additional data:

- State Historic Preservation Office
 - Other State agency
 - Federal agency
 - Local government
 - University
 - Other
- Name of repository: _____

Historic Resources Survey Number (if assigned): 015-081-70020

Burlington Township No. 9 School
Name of Property

Carroll County, IN
County and State

10. Geographical Data

Acreeage of Property Less than one acre

Use the UTM system

UTM References

Datum (indicated on USGS map):

NAD 1927 or NAD 1983

- | | | |
|-------------|-----------------|-------------------|
| 1. Zone: 16 | Easting: 549934 | Northing: 4479056 |
| 2. Zone: | Easting: | Northing: |
| 3. Zone: | Easting: | Northing: |
| 4. Zone: | Easting : | Northing: |

Verbal Boundary Description (Describe the boundaries of the property.)

Beginning in the center of the intersection of county roads 600 East and 600 South, face north and continue in a line with the center of 600 East approximately 170'. Turn east and continue in a line 160', then turn south and continue in a line 170' to the center of county road 600 South. Turn west and follow a line 160' with the center of the road to the center of its intersection with 600 East, or the place of beginning. Subject to all recorded rights-of-way.

Boundary Justification (Explain why the boundaries were selected.)

The boundaries described above include the one historic resource of the property, the school, and the entirety of the parcel owned by the building owner. Because property lines extend to the center of the county road, these portions of the property are included, subject to recorded rights-of-way, in the nomination. No other features associated with the school were located off of this property as described.

Burlington Township No. 9 School
Name of Property

Carroll County, IN
County and State

11. Form Prepared By

name/title: Kurt West Garner
organization: Heartland Heritage Inc./Indiana Landmarks PIP
street & number: 12954 6th Road
city or town: Plymouth state: IN zip code: 46563
e-mail: kwgarner@kwgarner.com
telephone: 574-936-0613
date: March 1, 2018

Additional Documentation

Submit the following items with the completed form:

- **Maps:** A **USGS map** or equivalent (7.5 or 15 minute series) indicating the property's location.
- **Sketch map** for historic districts and properties having large acreage or numerous resources. Key all photographs to this map.
- **Additional items:** (Check with the SHPO, TPO, or FPO for any additional items.)

Photographs

Submit clear and descriptive photographs. The size of each image must be 3000x2000 at 300 ppi (pixels per inch) or larger. Key all photographs to the sketch map. Each photograph must be numbered and that number must correspond to the photograph number on the photo log. For simplicity, the name of the photographer, photo date, etc. may be listed once on the photograph log and doesn't need to be labeled on every photograph.

Photo Log

Name of Property: Burlington Township No. 9 School

City or Vicinity: Burlington

County: Carroll County State: IN

Photographer: Kurt West Garner

Burlington Township No. 9 School
Name of Property

Carroll County, IN
County and State

Date Photographed: February 17, 2018

Description of Photograph(s) and number, include description of view indicating direction of camera: Looking northeast toward front of school building from intersection

1 of 8.

Name of Property: Burlington Township No. 9 School

City or Vicinity: Burlington

County: Carroll County State: IN

Photographer: Kurt West Garner

Date Photographed: February 17, 2018

Description of Photograph(s) and number, include description of view indicating direction of camera: Looking northwest toward front of school building and east facade

2 of 8.

Name of Property: Burlington Township No. 9 School

City or Vicinity: Burlington

County: Carroll County State: IN

Photographer: Kurt West Garner

Date Photographed: February 17, 2018

Description of Photograph(s) and number, include description of view indicating direction of camera: Looking southeast toward back of school building and west facade

3 of 8.

Name of Property: Burlington Township No. 9 School

City or Vicinity: Burlington

County: Carroll County State: IN

Burlington Township No. 9 School
Name of Property

Carroll County, IN
County and State

Photographer: Kurt West Garner

Date Photographed: August 4, 2016

Description of Photograph(s) and number, include description of view indicating direction of camera: Looking northeast inside of school building toward back wall/chalkboard

4 of 8.

Name of Property: Burlington Township No. 9 School

City or Vicinity: Burlington

County: Carroll County State: IN

Photographer: Kurt West Garner

Date Photographed: August 4, 2016

Description of Photograph(s) and number, include description of view indicating direction of camera: Looking southeast inside of school building toward front wall

5 of 8.

Name of Property: Burlington Township No. 9 School

City or Vicinity: Burlington

County: Carroll County State: IN

Photographer: Kurt West Garner

Date Photographed: August 4, 2016

Description of Photograph(s) and number, include description of view indicating direction of camera: Looking southwest inside of school building

6 of 8.

Name of Property: Burlington Township No. 9 School

City or Vicinity: Burlington

County: Carroll County State: IN

Burlington Township No. 9 School
Name of Property

Carroll County, IN
County and State

Photographer: Kurt West Garner

Date Photographed: August 4, 2016

Description of Photograph(s) and number, include description of view indicating direction of camera: Looking southeast inside school building at front wall and platform

7 of 8.

Name of Property: Burlington Township No. 9 School

City or Vicinity: Burlington

County: Carroll County State: IN

Photographer: Kurt West Garner

Date Photographed: August 4, 2016

Description of Photograph(s) and number, include description of view indicating direction of camera: Looking southwest inside school building at front wall and west entry door

8 of 8.

Paperwork Reduction Act Statement: This information is being collected for applications to the National Register of Historic Places to nominate properties for listing or determine eligibility for listing, to list properties, and to amend existing listings. Response to this request is required to obtain a benefit in accordance with the National Historic Preservation Act, as amended (16 U.S.C.460 et seq.).

Estimated Burden Statement: Public reporting burden for this form is estimated to average 100 hours per response including time for reviewing instructions, gathering and maintaining data, and completing and reviewing the form. Direct comments regarding this burden estimate or any aspect of this form to the Office of Planning and Performance Management, U.S. Dept. of the Interior, 1849 C. Street, NW, Washington, DC.

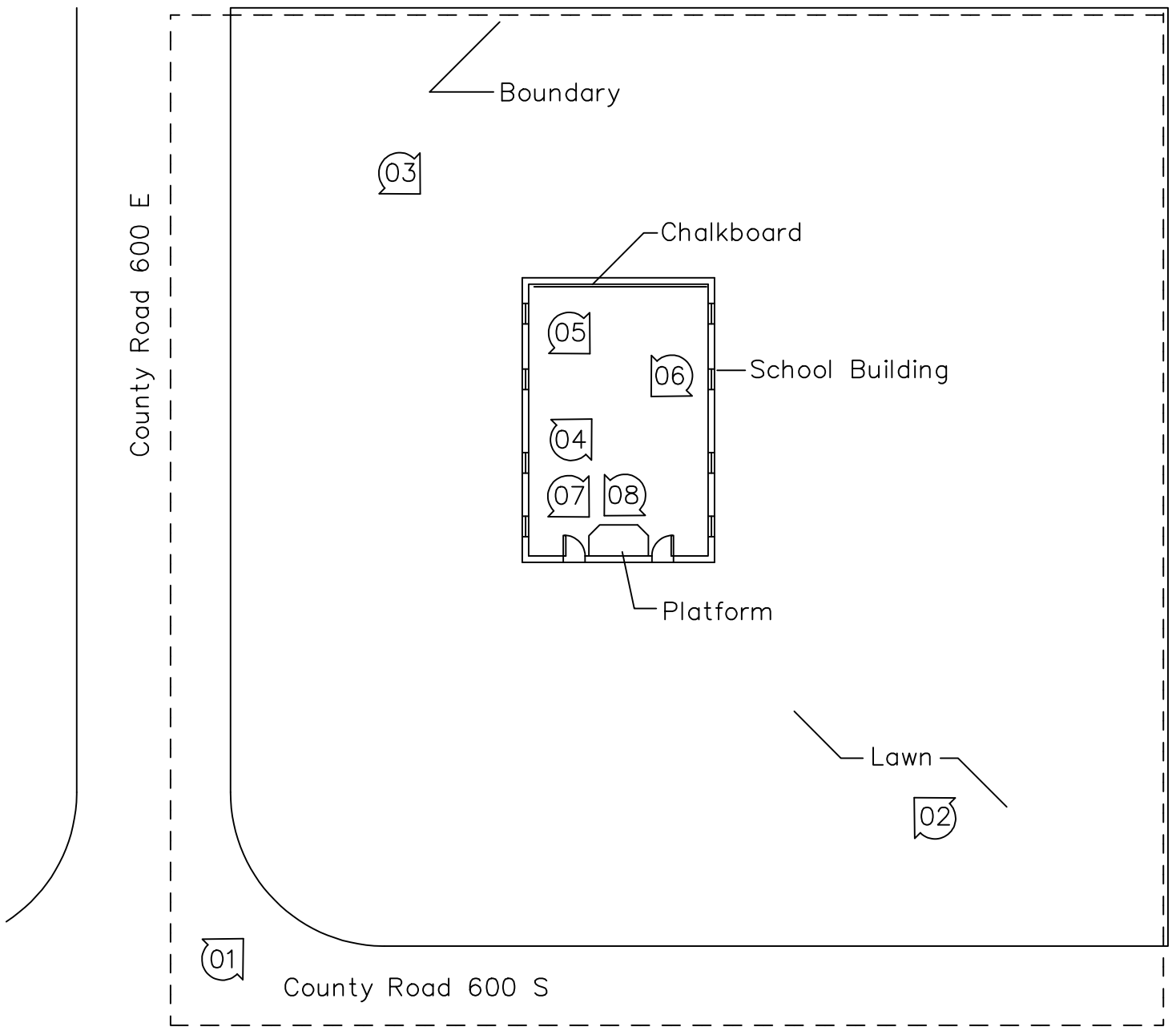

Burlington Twp. No. 9 School
 National Register of Historic Places
 Site Sketch Map
 Burlington Twp., Carroll County, IN

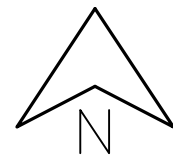

 = Photographs

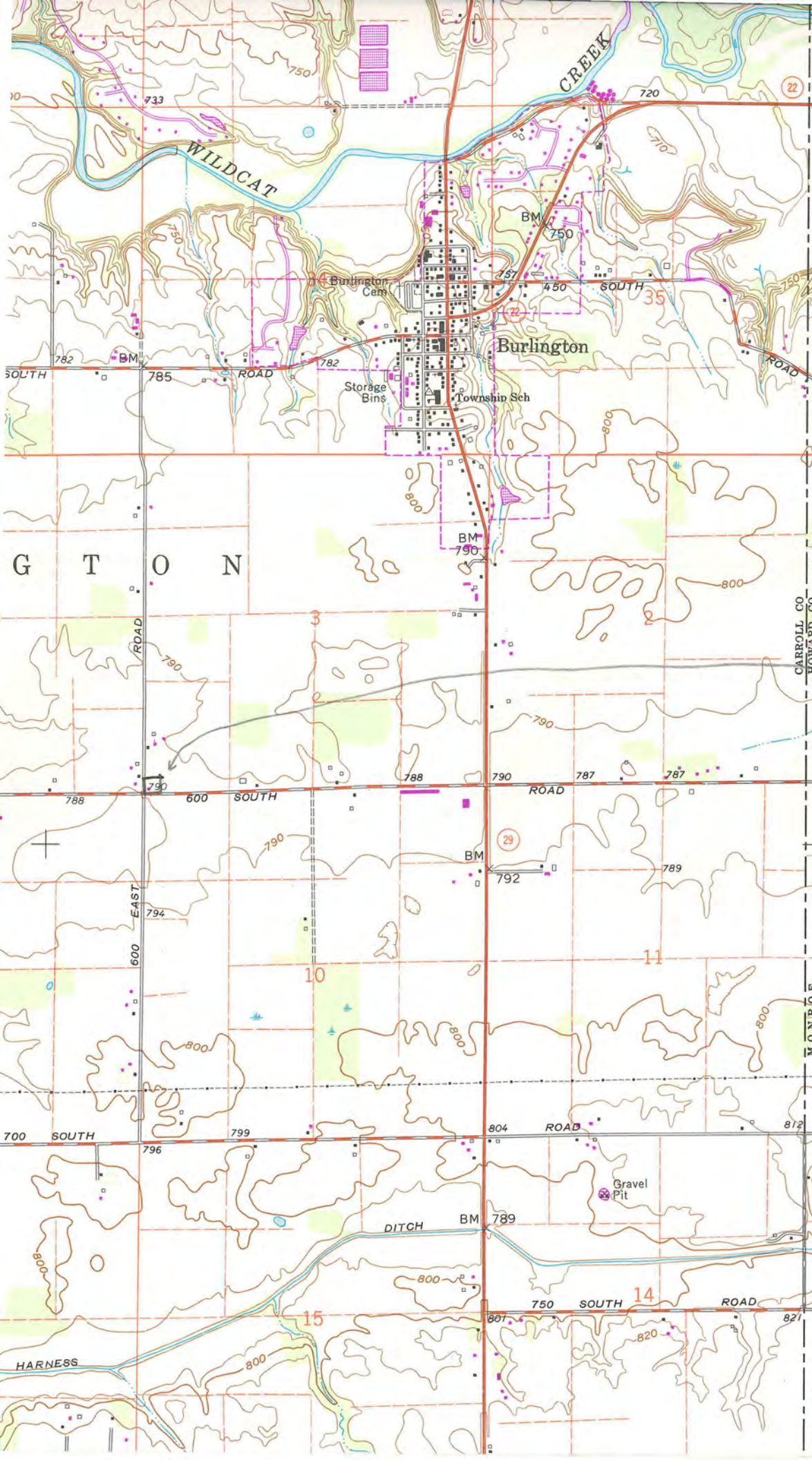

1 090 000
 FEET
 KOKOMO (U.S. 31 & 35) 13 MI.
 481
 T. 24 N.
 T. 23 N.
 480
 CARROLL CO
 HOWARD CO
 479
 27'30"
 478
 MONROE
 477
 (RUSSIAVILLE)
 3764 IV NE
 476

Burlington Twp.
 No. 9 School
 NATIONAL REGISTER OF
 HISTORIC PLACES
 NAD 83 UTM
 16 549934
 4479056
 CARROLL CO.,
 IN



LOT 10















UNITED STATES DEPARTMENT OF THE INTERIOR
NATIONAL PARK SERVICE

NATIONAL REGISTER OF HISTORIC PLACES
EVALUATION/RETURN SHEET

Requested Action: Nomination

Property Name: Burlington Township No. 9 School

Multiple Name: Indiana's Public Common and High Schools MPS

State & County: INDIANA, Carroll

Date Received: 10/22/2019 Date of Pending List: 11/14/2019 Date of 16th Day: 11/29/2019 Date of 45th Day: 12/6/2019 Date of Weekly List:

Reference number: MP100004727

Nominator: SHPO

Reason For Review:

X Accept Return Reject 11/29/2019 Date

Abstract/Summary Comments: Meets registration requirements of MPS. Excellent example of rural school in design.

Recommendation/ Criteria: Accept / A & C

Reviewer Jim Gabbert Discipline Historian

Telephone (202)354-2275 Date _____

DOCUMENTATION: see attached comments : No see attached SLR : No

If a nomination is returned to the nomination authority, the nomination is no longer under consideration by the National Park Service.



Division of Historic Preservation & Archaeology • 402 W. Washington Street, W274 • Indianapolis, IN 46204-2739
Phone 317-232-1646 • Fax 317-232-0693 • dhpa@dnr.IN.gov • www.IN.gov/dnr/historic

October 17, 2019

Ms. Joy Beasley
Keeper of the National Register
National Register of Historic Places
Mail Stop 7228
1849 C St, NW
Washington, D.C. 20240



Re: Burlington Township No. 9 School, Carroll County, Indiana

Dear Ms. Beasley,

Enclosed is a National Register of Historic Places nomination for the Burlington Township No. 9 School, Carroll County, Indiana. The Indiana Historic Preservation Review Board reviewed the application and voted to recommend its approval to the National Register of Historic Places.

The enclosed disk contains the true and correct copy of the nomination for the Burlington Township No. 9 School, Carroll County, Indiana to the National Register of Historic Places.

Please address any questions you or your staff may have about this nomination to my National Register staff members, Paul Diebold or Holly Tate.

Sincerely,

Cameron F. Clark
State Historic Preservation Officer

CFC:PCD:pcd

enclosure: nomination package