

1. Historic Name (s) **Polk House**

Original Owner \_\_\_\_\_

Present Name **Old Polk Farm**

3. Owner's Name **William Rawlings**

4. Owner's Address **Rt 1 Woodburn**

5. Location **N. side Ming Rd; btwn College + Garden Sts; Woodburn**

6. Open to Public Yes  No

7. Visible from road Yes  No

8. Ownership Private  Local  State  Federal

9. Local Contact/Organization \_\_\_\_\_

22. ADD/County **BARI V, WA**

23. Zoning Classification **Magisterial District**

24. U.S.G. S. Quadrant (15'/75') **Woodburn**

25. UTM Reference Zone **116** Easting **542380** Northing **4077280**

26. Prehistoric Site  Historic Site  Object  Structure

27. District Name: Yes  No

28. Significance Evaluation **NR**

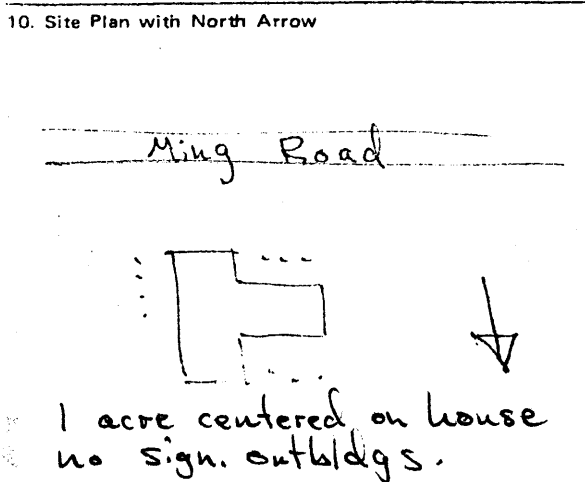

11. Architect \_\_\_\_\_

12. Builder \_\_\_\_\_

13. Date **last 1/4 19th c.**

14. Style **dec. cottage**

15. Original Use **house**

16. Present Use **house**

17. Condition Interior **excellent** Exterior **excellent**

29. Status National Landmark  National Register  Landmark Certificate  Kentucky Survey  Local Landmark  HABS/HAER

30. Theme Primary **architecture** Secondary \_\_\_\_\_ Other \_\_\_\_\_

31. Endangered Yes  No

13. Description **1 story plan - chair rails interior - original gingerbread porches - segmental openings with hoodmolds - essentially intact - key site at fringe of Woodburn - visual link between town + farm**

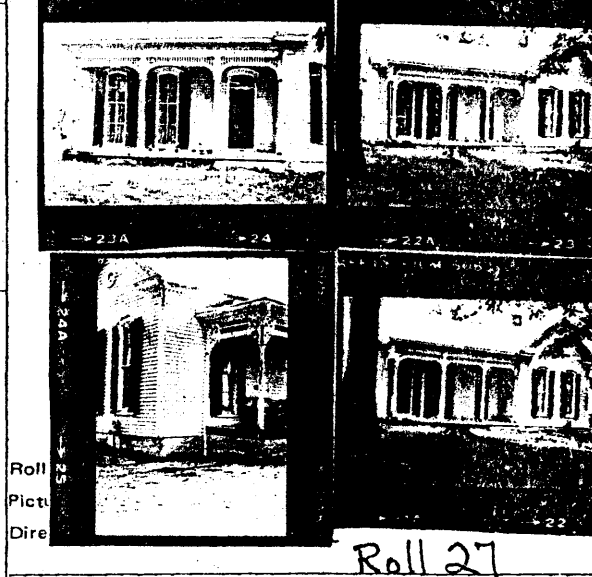

19. History \_\_\_\_\_

20. Significance **Particularly clear illustration of a common type and style; outstanding design and craftsmanship.**

33. Tape No. \_\_\_\_\_ Negative No. \_\_\_\_\_

34. Prepared by: **KTG-JCH**

35. Organization **KHC**

36. Date **Spring 1978**

21. Source of Information \_\_\_\_\_

37. Revision Dates \_\_\_\_\_ 38. Staff Review \_\_\_\_\_



## Architecture:

117. One of the few decorated cottages of the late nineteenth century in the county to have survived with its entire decorative scheme intact (see Wa-22 and 54), this house is based on the T-plan type and demonstrates the nineteenth century tenet that even the most modest dwellings could be given architectural dignity through ornamentation. It is one of the best examples of its type in the county.