

United States Department of the Interior  
National Park Service

National Register of Historic Places  
Registration Form

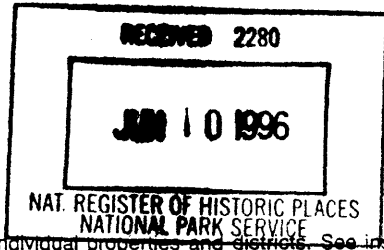

771

This form is for use in nominating or requesting determinations for individual properties and districts. See instructions in *How to Complete the National Register of Historic Places Registration Form* (National Register Bulletin 16A). Complete each item by marking "x" in the appropriate box or by entering the information requested. If an item does not apply to the property being documented, enter "N/A" for "not applicable." For functions, architectural classification, materials, and areas of significance, enter only categories and subcategories from the instructions. Place additional entries and narrative items on continuation sheets (NPS Form 10-900a). Use a typewriter, word processor, or computer, to complete all items.

1. Name of Property

historic name Lynchburg Historic District

other names/site number N/A

2. Location

street & number Roughly along Majors and Main, including Elm and Wall  not for publication

city or town Lynchburg  vicinity

state Tennessee code TN county Moore code 341 zip code 37352

3. State/Federal Agency Certification

As the designated authority under the National Historic Preservation Act, as amended, I hereby certify that this  nomination  request for determination of eligibility meets the documentation standards for registering properties in the National Register of Historic Places and meets the procedural and professional requirements set forth in 36 CFR Part 60. In my opinion, the property  meets  does not meet the National Register criteria. I recommend that this property be considered significant  nationally  statewide  locally. ( See continuation sheet for additional comments.)

Herbert L. Huger 6/5/96  
Signature of certifying official/Title Date

Deputy State Historic Preservation Officer, Tennessee Historical Commission  
State of Federal agency and bureau

In my opinion, the property  meets  does not meet the National Register criteria. ( See continuation sheet for additional comments.)

Signature of certifying official/Title Date

State or Federal agency and bureau

4. National Park Service Certification

I hereby certify that the property is:

- entered in the National Register.  See continuation sheet.
- determined eligible for the National Register.  See continuation sheet.
- determined not eligible for the National Register.
- removed from the National Register.
- other. (explain:)

Edson H. Beall  
Signature of the Keeper

Date of Action  
2-19-96

Entered in the  
National Register

5. Classification

Ownership of Property

(Check as many boxes as apply)

- private
- public-local
- public-State
- public-Federal

Category of Property

(Check only one box)

- building(s)
- district
- site
- structure
- object

Number of Resources within Property

(Do not include previously listed resources in the count.)

Contributing	Noncontributing	
74	17	buildings
0	1	sites
0	0	structures
0	0	objects
74	18	Total

Name of related multiple property listing

(Enter "N/A" if property is not part of a multiple property listing.)

N/A

Number of contributing resources previously listed in the National Register

4

6. Function or Use

Historic Functions

(Enter categories from instructions)

DOMESTIC: single dwelling; hotel

COMMERCE: specialty store; financial institution

GOVERNMENT: courthouse; government office

INDUSTRY: manufacturing facility

RELIGION: religious facility

Current Functions

(Enter categories from instructions)

DOMESTIC: single dwelling

COMMERCE: specialty store; financial institution

GOVERNMENT: courthouse, government office

INDUSTRY: manufacturing facility

RELIGION: religious facility

7. Description

Architectural Classification

(Enter categories from instructions)

Greek Revival; Italianate; Bungalow

OTHER: Folk Victorian; Gable Front and Wing; 1 and 2 part Commercial Blocks

Materials

(Enter categories from instructions)

foundation Stone; Brick; Concrete Block; Concrete

walls Weatherboard; Brick; Stone; Concrete Block; Asbestos Shingle; Vinyl; Stucco

roof Metal; Asphalt Shingle; Composite Shingle

other Metal and Tile Coping; Glass; Iron

Narrative Description

(Describe the historic and current condition of the property on one or more continuation sheets.)

See Continuation Sheets

8. Statement of Significance

Applicable National Register Criteria

(Mark "x" in one or more boxes for the criteria qualifying the property for National Register listing.)

- A Property is associated with events that have made a significant contribution to the broad patterns of our history.
- B Property is associated with the lives of persons significant in our past.
- C Property embodies the distinctive characteristics of a type, period, or method of construction or represents the work of a master, or possesses high artistic values, or represents a significant and distinguishable entity whose components lack individual distinction.
- D Property has yielded, or is likely to yield, information important in prehistory or history.

Criteria Considerations

(Mark "x" in all the boxes that apply.)

Property is: N/A

- A owned by a religious institution or used for religious purposes.
- B removed from its original location.
- C a birthplace or grave.
- D a cemetery.
- E a reconstructed building, object, or structure.
- F a commemorative property.
- G less than 50 years of age or achieved significance within the past 50 years.

Areas of Significance

(Enter categories from instructions)

- ARCHITECTURE
- COMMERCE
- GOVERNMENT

Period of Significance

1867-1946

Significant Dates

N/A

Significant Person

(Complete if Criterion B is marked above)

N/A

Cultural Affiliation

N/A

Architect/Builder

Multiple; Unknown; Swanton, Fred (artist)  
Pauley Jail and Manufacturing Company

Narrative Statement of Significance

(Explain the significance of the property on one or more continuation sheets.)

9. Major Bibliographical References

Bibliography

(Cite the books, articles, and other sources used in preparing this form on one or more continuation sheets.)

Previous documentation on file (NPS): N/A

- preliminary determination of individual listing (36 CFR 67) has been requested
- previously listed in the National Register
- previously determined eligible by the National Register
- designated a National Historic Landmark
- recorded by Historic American Buildings Survey # \_\_\_\_\_
- recorded by Historic American Engineering Record # \_\_\_\_\_

Primary location of additional data:

- State Historic Preservation Office
- Other State agency
- Federal agency
- Local government
- University
- Other

Name of repository:

MTSU Center for Historic Preservation

10. Geographical Data

Acreage of Property Approximately 32 acres

Lynchburg 79 SW  
Lynchburg 79 SE

UTM References

(Place additional UTM references on a continuation sheet.)

1	1 6	5 5 7 1 8 0	3 8 0 4 5 9 0
	Zone	Easting	Northing
2	1 6	5 5 7 1 8 0	3 8 0 4 3 4 0

3	1 6	5 5 6 6 0 0	3 8 0 4 1 2 0
	Zone	Easting	Northing
4	1 6	5 5 6 5 1 0	3 8 0 4 3 8 0

See continuation sheet

Verbal Boundary Description

(Describe the boundaries of the property on a continuation sheet.)

Boundary Justification

(Explain why the boundaries were selected on a continuation sheet.)

11. Form Prepared By

name/title Megan Dobbs, Brian Eades, and Carroll Van West

organization Center for Historic Preservation date April 1996

street & number MTSU Box 80 telephone (615) 898-2947

city or town Murfreesboro state TN zip code 37132

Additional Documentation

Submit the following items with the completed form:

Continuation Sheets

Maps

A USGS map (7.5 or 15 minute series) indicating the property's location.

A Sketch map for historic districts and properties having large acreage or numerous resources.

Photographs

Representative black and white photographs of the property.

Additional items

(Check with the SHPO or FPO for any additional items)

Property Owner

(Complete this item at the request of SHPO or FPO.)

name Multiple Owners--listed on inventory sheets (More than 50-legal notice)

street & number \_\_\_\_\_ telephone \_\_\_\_\_

city or town \_\_\_\_\_ state \_\_\_\_\_ zip code \_\_\_\_\_

Paperwork Reduction Act Statement: This information is being collected for applications to the National Register of Historic Places to nominate properties for listing or determine eligibility for listing, to list properties, and to amend existing listings. Response to this request is required to obtain a benefit in accordance with the National Historic Preservation Act, as amended (16 U.S.C. 470 et seq.).

Estimated Burden Statement: Public reporting burden for this form is estimated to average 18.1 hours per response including time for reviewing instructions, gathering and maintaining data, and completing and reviewing the form. Direct comments regarding this burden estimate or any aspect of this form to the Chief, Administrative Services Division, National Park Service, P.O. Box 37127, Washington, DC 20013-7127; and the Office of Management and Budget, Paperwork Reductions Projects (1024-C018), Washington, DC 20503.

United States Department of the Interior  
National Park Service

# National Register of Historic Places Continuation Sheet

Section number 7 Page 1

---

Lynchburg Historic District, Moore Co., TN

## VII. NARRATIVE DESCRIPTION

The Lynchburg Historic District is comprised of eighty-two primary properties which make up the central part of the community, located in Moore County, Tennessee. The small town is the county seat as well as the commercial and industrial center for the county. The nominated area contains buildings that represent the development of Lynchburg from a crossroads community into the political and commercial center of Moore County. The integrity of the district is evident not only in the historic buildings, but in the layout of the town, which reflects the impact of the county seat designation.

Lynchburg developed as a small agricultural based, rural community, and the early layout of the town is still evident despite later changes to the town plan. Main Street originally served as the primary thoroughfare through town and was sited along the Mulberry Creek. Commercial and residential buildings were interspersed along this street, while most of the industrial buildings were located closer to the creek and further away from town. The Fire of 1883 burned many of the early buildings in Lynchburg, but there are several fine residences located along East Majors and West Main streets that represent mid- to late 19th architecture.

When Lynchburg was designated as the county seat of the newly established Moore County in 1871, the town changed to accommodate its new status. There was no formal public square, and the Church of Christ, which was located at the center of Main Street, became the temporary courthouse until it burned and the present courthouse was constructed in 1885. The town square followed the model set by nearby Shelbyville, implementing a central courthouse with streets bounding the square on the north, south, east, and west, with no other cross streets, except for a narrow, gravel road that connects Mechanic Street with Dance Street (see map). Main and Majors were established thoroughfares, so the logical choice was to intersect these two east-west roads with two north-south streets. Hiles and Mechanic streets formed the west and east boundaries of the new square. Lynchburg's plan differs from the typical Shelbyville plan in that Majors was a large transportation corridor, so the actual north boundary of the square is an unnamed street which is actually part of the south side of Majors street. The town still retains its original plan, with no significant alterations to the 1885 courthouse square.

The focus of the Lynchburg Historic District is a downtown core which surrounds the courthouse block and is known as the Public Square. Residential buildings surround the commercial area around the square on the north, east, south, and west sides. The northern boundary is Majors Street, which is intersected by Elm Street and Wall Street on the west and Main Street on the

## National Register of Historic Places Continuation Sheet

Section number 7 Page 2

---

Lynchburg Historic District, Moore Co., TN

east. Main also serves as the southern boundary of the district. The public square is bounded by Hiles Street on the west, Mechanic Street on the east, and Main Street on the south. The north side of the square is an unnamed street.

The historic district contains commercial and residential buildings constructed between circa 1860 and 1940. Residential buildings and outbuildings in the Greek Revival, Gothic Revival, Folk Victorian, I-house, gable and wing, center hall, hall and parlor, and bungalow styles surround a central core of commercial buildings. The heart of the district is the public square, which contains thirty one part commercial buildings and one two part commercial building. Public buildings, including the courthouse and county jail, a textile factory, and two churches complete the district for a total of eighty-two buildings.

The Lynchburg Historic District is comprised of mid to late nineteenth and early to mid twentieth century buildings. The oldest building in the district is the Bobo Boardinghouse, built in 1867, which includes a circa 1830 rear section (#33) and there are sixteen nineteenth century houses, primarily gable and wing or center hall, with Folk Victorian influence or vernacular adaptations of other styles. There are also superior examples of the Greek Revival (#18, #30) and Gothic Revival (#20). Twentieth century domestic architecture is primarily vernacular in design, and of the twenty buildings, there are examples of Tudor Revival (#10, #11), Colonial Revival (#42), and Bungalow (#2, #5, #35) styles.

Public buildings associated with Lynchburg's role as county seat are the County Jail (NR 9/26/79, #39), a two-story brick building that served the county until 1991, and the Moore County Courthouse (NR 9/26/79, #82). This large brick building was the last Italianate style courthouse built in Tennessee, and is an excellent example of small town vernacular design in public buildings.

The commercial buildings within the district are all one and two part commercial blocks constructed of brick with concrete or stone foundations and storefront display windows. The terms one- and two-part commercial block buildings were created by architectural historian Richard Longstreth to distinguish different commercial buildings constructed between the late nineteenth and mid twentieth centuries. One part commercial blocks are either square or rectangular in form, usually only one story in height, with decorative storefront facade. The two part commercial block is two or more stories with a horizontal separation between the storefront

United States Department of the Interior  
National Park Service

# National Register of Historic Places Continuation Sheet

Section number 7 Page 3

---

Lynchburg Historic District, Moore Co., TN

level and the additional stories. In the Lynchburg district, only the Lynchburg Hardware Store and Pepper Patch Bakery (#69) falls into this category.

There are few gaps in the town's blocks due to demolition or fire, and most of the modern buildings, which are few, are located beyond the northern boundary of Majors Street. Of the eighty-two primary buildings and structures inventoried, only fifteen are non-contributing, due either to date or significant alterations.

Contributing resources (C) have similar design features and maintain the scale and use of the district. They also represent specific styles of architecture or trends in building in Lynchburg. Non-contributing resources (NC) have lost their character defining architectural features through significant alteration or were built later than the 1946 date for the fifty-year eligibility rule.

The district is inventoried as Majors, Main, Wall, and the Courthouse Square, and the properties are keyed on the map according to the inventory. Since the houses in Lynchburg do not have individual postal addresses, the properties inventoried are listed according to the street and named for the owner of the property. In some cases, both the historic and present names of owners are used because the property is commonly known by its historic name. These buildings are marked with an asterisk (\*) to indicate the use of names other than the current owners.

## INVENTORY:

### Majors Street

1. Majors Boulevard  
Arbor Primitive Baptist Church House  
Arbor Primitive Baptist Church, Lynchburg, Tennessee

Circa 1875 one story side gabled hall and parlor house, with limestone foundation, weatherboard siding, metal roof and brick interior central chimney. The gable end faces Majors Street and is flanked on either side by full porches with wood floors and chamfered wood posts.

United States Department of the Interior  
National Park Service

# National Register of Historic Places Continuation Sheet

Section number 7 Page 4

---

Lynchburg Historic District, Moore Co., TN

Ornamentation is limited to decorative window framing, with flat lintels and projecting sills and the projecting eaves with returns. (C)

Outbuilding: Circa 1930 board and batten building has stone pier foundation and a gabled roof with metal covering. (C)

2. Majors Boulevard.

Gray House

Lucille Gray, Route 3, Box 250, Lynchburg, Tennessee 37352

Circa 1930 one and one half story brick bungalow has hipped roof with asphalt shingles and rests on a brick and concrete foundation. A half-width porch has brick piers with wood posts and rests on a brick base with concrete top. The facade windows are as follows: two four-over-four double hung sash windows flanking a single fixed pane glass window, a six panel wood door and paired four-over-four double hung sash windows. (C)

3. Majors Boulevard.

Philpot House

Roscoe Philpot, Box 35, Tullahoma, Tennessee 37388

Circa 1890 one story gable front and wing, weatherboard and asbestos shingle siding with interior center gable brick chimney. A wraparound porch with shed roof extends from the gable end and rests on a brick and molded concrete block foundation. Windows are narrow four-over-four double hung sash with molded frames. Two exterior doors at the eastern corner of the gable and wing are two panel, two pane, half-glass with metal storm doors. (C)

4. Majors Boulevard.

Arbor Primitive Baptist Church

Arbor Primitive Baptist Church, circa 1965. Two story brick building with brick and concrete foundation has Colonial Revival style two story portico with weatherboard infill and cylindrical wood columns. Gable end facade is brick with weatherboard in gable section. A weatherboard steeple is located in the front central section of the gable roof. (NC)



United States Department of the Interior  
National Park ServiceNational Register of Historic Places  
Continuation SheetSection number 7 Page 5

Lynchburg Historic District, Moore Co., TN

5. Majors Boulevard.  
Parks House  
Joe Parks, Box 35, Lynchburg, Tennessee 37352

Circa 1935 one and one half story gable end bungalow with vinyl siding and asphalt shingle roof has projecting eaves with returns and poured concrete foundation. The pitched roof extends to the shed roof of the full porch, and has two gabled dormers with paired three-over-three double hung sash windows. The three bay facade has two paired three-over-one double hung sash windows, which flank the twelve light, half-glass door. (C)

6. Majors Boulevard.  
Hinkle-Price House\*  
Joyce Price, Box 198, Lynchburg, Tennessee 37352

1877 one story weatherboard and asbestos shingle house with rockface concrete block foundation. The side gable roof has a brick exterior end chimney and Greek Revival portico with square columns. A plain cornice is above two separate shed roof porch extensions on either side of the portico, each with spindlework posts and railing. Two four-over-four double hung sash windows with wood shutters flank the center door which is half glass with single pane sidelights and transom. The house is also significant due to its painted interior done by itinerant artist Fred Swanton in the late-nineteenth century. (C)

Outbuilding: A circa 1900 side gable three bay garage has concrete pier foundation and square wood posts. Front is open to the street and side walls are weatherboard with an asphalt shingle roof. (C)

7. Majors Boulevard.  
Jennings Funeral Home  
Buford Jennings, Box 804, Lynchburg, Tennessee 37352

Circa 1878 two story Greek Revival with weatherboard siding, sheet metal gable roof, and brick foundation. A two-story entry porch marks the central hall with paneled door and single pane sidelights and fanlight and is bordered by a two foot high spindled railing. A second story balcony has decorative spindle work railing and surrounds the double, half-glass doors with single-pane sidelights. The three bay facade has paired four-over-four double hung sash

United States Department of the Interior  
National Park ServiceNational Register of Historic Places  
Continuation SheetSection number 7 Page 6

Lynchburg Historic District, Moore Co., TN

windows on both floors, except the upper east window, which has been replaced with paired one-over-one double hung windows. (C)

Outbuildings: Circa 1878 one and a half story weatherboard smokehouse with brick foundation, brick end chimney and gable end central door. The attached one story building was added circa 1990 and has a shed roof and vinyl siding with two metal garage doors. (NC)

A separate one story gable front building, circa 1990, is located behind the southeast corner of the house. (NC)

8. Majors Boulevard.  
Morgan-Fanning House\*  
H.M. Fanning, Box 63, Lynchburg, Tennessee 37352

Circa 1880 two story, center hall, side gable house was remodeled circa 1930. Weatherboard exterior walls rest on concrete block foundation. The side gable roof is covered in asphalt shingles with a front shed roof covering the front porch. The full porch is supported by four wood posts with concrete bases. The facade is characterized by a center twelve pane door with wood frame and two single pane sidelights and single pane transom. Paired nine-over-one double hung sash windows flank the front door and correspond with the eight pane paired windows in the second story center dormer. (C)

9. Majors Boulevard.  
Womble House  
Ava Lee Womble, Route 6, Box 224, Shelbyville, Tennessee 37160

Circa 1915 one story gable-front and wing with wraparound porch has a concrete foundation, weatherboard siding, and metal roof. The center door on the street side facade is located near the junction of the two wing sections, which are linked by a street side gable. The nine panel wood door has a small circular light and two narrow, single pane sidelights. Two six-over-six double hung sash windows flank the center door. The wrap porch has a metal shed roof, wood posts with brick bases and a poured concrete floor, but the street side porch section was added later. A central brick chimney is located in the west wing, and a brick exterior end chimney is located at the gable end of the north wing. (C)

United States Department of the Interior  
National Park Service

National Register of Historic Places  
Continuation Sheet

Section number 7 Page 7

---

Lynchburg Historic District, Moore Co., TN

10. Majors Boulevard.  
Taylor-Ervin House

Circa 1930 two story Tudor Revival brick duplex with stone foundation asbestos shingle infill siding in the second story gables, and asphalt shingles cover the roof. The side gable roof has double gabled wall dormers and projecting entry porches with arched openings. The facade is divided into two identical sections, each with a projecting, covered porch entry with decorative brickwork along arched opening, craftsman styled doors with elongated glass panes and wood frames, and paired three-over-one double hung sash windows. The second story front gables originally contained three-over-one double hung sash windows in each gable, but the east gable window was replaced with a six-over-one double hung sash window. A one story addition was built circa 1960, connecting it to the east exterior wall, and contains a ribbon window with four single, fixed panes. The wood addition has weatherboard siding with a flat, asphalt shingled roof. (C)

11. Majors Boulevard.  
Booher House  
Dr. F.H. Booher, Box E, Lynchburg, Tennessee 37352

Circa 1935 two story Tudor Revival stone and brick cottage has concrete foundation and asphalt shingle roof and gabled dormers. The cross gabled house has a steeply pitched gable end roof and side gable wing facing Majors Street with an exterior brick chimney at the western corner of the house. Square-cut ashlar stone wall surface has five bays on the lower story and two on the second story. All windows are six-over-six double hung sash with wood framing. (C)

12. Majors Boulevard.  
Cummins House  
Ansel L. Cummins, Box 7, Lynchburg, Tennessee 37352

Circa 1930 Greek Revival one story center hall house with vinyl siding, an asphalt shingle roof with brick exterior end chimneys and rock-faced concrete block foundation. The three bay

## National Register of Historic Places Continuation Sheet

Section number 7 Page 8

---

Lynchburg Historic District, Moore Co., TN

facade has a full-height portico and two four-over-one double hung sash windows on either side of a three-pane half-glass door with three-pane sidelights. (C)

Outbuilding: Circa 1930 garage has a gable end of vertical boards and metal roof with a front shed with vertical boards and metal roof. Foundation is concrete block pier with dirt flooring. (C)

13. Majors Boulevard.  
Moore County Public Library  
City of Lynchburg

Circa 1963 one story public building has a flat roof and horizontal, fixed pane ribbon windows. The brick building has a poured concrete foundation and asphalt shingle roof. (NC)

14. Majors Boulevard.  
General Staffing Office  
Karen K. Yasui, 3881 Highway 130 East, Tullahoma, Tennessee 37388

Circa 1930 one and one half story, side gabled building has a gabled portico with wood supports, asbestos shingle siding, molded concrete block foundation, and an asphalt shingle roof. The gable end street facade contains paired six-over-six double hung sash windows with wood shutters and a metal awning. (C)

15. Majors Boulevard.  
Lynchburg Medical Clinic  
Karen K. Yasui, Box 106, Lynchburg, Tennessee, 37352

Circa 1900 one and one half story gable front and wing house has a stone foundation, vinyl siding, and an asphalt shingle roof. The gable front has projecting eaves with returns, and a elongated four-over-four double hung sash window and the wing section contains a modern metal door with glass and metal storm door and one four-over-four double hung sash window. The 3/4 porch has a concrete floor with asphalt shingle shed roof, and decorative scroll-sawn frieze with wrought iron posts. (C)

United States Department of the Interior  
National Park ServiceNational Register of Historic Places  
Continuation SheetSection number 7 Page 9

Lynchburg Historic District, Moore Co., TN

16. Majors Boulevard.Don Bobo House

Don D. Bobo, Route 2, Box 215, Lynchburg, Tennessee 37352

Circa 1940 one story side gable cottage with concrete block foundation, vinyl siding, and asphalt shingle roof. Three bay facade is composed of a center half-glass door with one four-over-four double hung sash window on the east side and one eight-over-eight double hung sash window on the west. The full porch has four wood posts and concrete flooring and central stairs with wrought iron railing. (C)

Outbuilding: Circa 1940 gable end building is one and one half stories. The remodeled building has a concrete foundation, vinyl siding, and an asphalt shingle roof. A plate glass double sliding door is located in the western end of the first floor facade while the upper half story has a single solid wood door with single light and narrow balcony with wrought iron railing. (C)

17. Majors Boulevard.Stegall-Cashion House\*

Jack Cashion, 408 Longmeadow Circle, Pulaski, Tennessee 38478

Circa 1880 one and one half story Folk-Victorian hall and parlor house has a stone pier foundation with concrete block porch foundation. The side gable roof is metal with a brick interior central chimney and the full porch has a metal shed roof with wood posts and spindle work frieze. The three bay facade is composed of two six-over-six double hung sash windows with flat wood lintels, decorative wood panels, wood side shutters. The center four panel wood door has an elliptical fan light within the door and two single pane sidelights. (C)

Outbuilding: Circa 1880 one story weatherboard building was the original Moore County Library, and has a pier foundation with pressed metal surrounding the base, and concrete stoop with metal shed roof. The three bay facade has a four-pane half-glass door with two plate glass windows. (C)

United States Department of the Interior  
National Park ServiceNational Register of Historic Places  
Continuation SheetSection number 7 Page 10

Lynchburg Historic District, Moore Co., TN

18. Majors Boulevard.  
Althausen-Dickey House\*  
Marjorie Dickey, Route 3, Lynchburg, Tennessee, 37352

Circa 1874 two story Greek Revival house has weatherboard siding, concrete foundation, and metal hipped roof. A full-height, temple-front entry porch with four Doric columns has a projecting gable roof with metal covering and wide cornice beneath the projecting eaves. The three bay facade is identical on each of the two stories and contains four-over-four double hung sash windows with arched lintels and wood shutters, center door with arched frame and semi-circular segmented fanlight, and four-over-four double hung sash windows with arched lintels and wood shutters. The second story center doors are paired or double doors with recessed panels, and the first story entrance door is a modern single panel wood door with three stepped rectangular lights and a plastic storm door. A decorative jigsaw railing surrounds the second floor balcony in front of the double doors. (C)

19. Majors Boulevard.  
Womble House  
Carroll Womble and Harriet Harris, Box 227, Lynchburg, Tennessee 37352

Circa 1940 one and one-half story brick modified gable front and wing. The three bay facade is as follows: paired six-over-six double hung sash windows, single panel wood door with diamond shaped lights, and a paired six-over-six double hung sash window. The house rests on a poured concrete foundation and has vinyl siding with an asphalt shingle roof. (C)

20. Majors Boulevard.  
Cobble House\*  
Jane West and Betty Ann Nutt, Box 13, Lynchburg, Tennessee 37352

1876 two story, Carpenter Gothic, triple gable house has two street side facades, each with triple cross gables within a side gabled roof, stone foundation with poured concrete porch section on Majors facade, vinyl siding over original weatherboard, and pressed metal shingle roof. The 3/4 porch facing Majors has a shed roof with asphalt shingles, spindlework railing, and scroll sawn porch supports. The front entry facade, facing Main street, has a side gabled roof with triple gable wall dormers, two of which contain six-over-six double hung sash windows within

United States Department of the Interior  
National Park Service

National Register of Historic Places  
Continuation Sheet

Section number 7 Page 11

---

Lynchburg Historic District, Moore Co., TN

pointed, Gothic style recesses with wood bracing. The center gable dormer has scroll-sawn brackets designed in a series of three progressively smaller triangles. Two brick interior chimneys flank the center dormer. A full porch with spindlework railing and frieze has plain wooden posts and contains a center multi-paned door with single pane sidelights and wood pilasters, flanked by single six-over-six double hung sash windows with wood shutters. (C)

Outbuildings: Weatherboard gable end smokehouse with stone pier foundation and metal roof, circa 1900 has a six panel wood entry door and no windows. (C)

Circa 1900 gable end carriage house with side lean-tos has a center steeple with fish scale metal shingles, weatherboard siding, and stone foundation. The center double doors are vertical board and are flanked by a second set of smaller double doors on the east and a single door on the west. Three four-over-four double hung sash windows are placed above and on either side of the center double doors. (C)

21. Majors Boulevard.

Boyd House

Mary Boyd, 1716 Bon Air Drive, Lexington, Kentucky 40502

Circa 1890 one and one-half story folk-Victorian weatherboard gable front and wing has a stone foundation, weatherboard siding and a composite shingle roof. A brick chimney is located on the east exterior wall. The facade contains two one-over-one double hung sash windows with flat lintels and wood sills, a one-over-one glass pane door with wood frame, and a single one-over-one double hung sash window with flat lintel and sill and wooden shutters. The 3/4 porch has four wood posts with decorative spindlework railing. (C)

Outbuilding: Circa 1890 gable end garage has horizontal wood siding and a corrugated metal roof and rests on a stone pier foundation. (C)

United States Department of the Interior  
National Park Service

# National Register of Historic Places Continuation Sheet

Section number 7 Page 12

---

Lynchburg Historic District, Moore Co., TN

Main Street

22. Main Street.  
Mary Jane Motlow House

Circa 1890 upright and wing with 3/4 porch has a brick exterior end chimney, metal roof, weatherboard siding, and concrete block foundation. The side wing has flush board siding with one one-over-one double hung sash window, a central door with metal and screen door, and another one-over-one double hung sash window. The upright contains one one-over-one double hung sash window. (C)

Outbuilding: Small gable front garage, circa 1930 has a metal roof, vinyl siding, and concrete foundation. (C)

23. Main Street.  
Johnson House  
Eugene W. Johnson III, Box 286, Lynchburg, Tennessee 37352

Circa 1890 one story center hall with side gabled roof has composite shingles, vinyl siding, and concrete block foundation. The full porch has a shed roof with wrought iron posts and brick bases. The center half-glass door is flanked by two three-over-one double hung sash windows and one three-over-one double hung sash window. (C)

24. Main Street.  
Mary Jane Motlow

Circa 1960 one and one half story house, has concrete foundation, brick exterior with vinyl siding on facade, and stepped gable roof with composite shingles. A brick wing has a shed roof and contains four ten-pane windows. The full facade porch has four posts supporting the projecting gable front roof and contains a bay window with three eight pane windows, a four panel wood door with four pane transom, and a bay window with three eight pane windows. (NC)



United States Department of the Interior  
National Park ServiceNational Register of Historic Places  
Continuation SheetSection number 7 Page 13

Lynchburg Historic District, Moore Co., TN

25. Main Street.  
Tipps House  
H.H. Tipps, Route 1, Box 8, Lynchburg, Tennessee 37352

Circa 1890 one and one-half story folk-Victorian gable front and wing with metal roof, asbestos shingle siding, and molded concrete block foundation. The gable front has fish scale shingles and spindlework gable detailing and three one-over-one double hung sash windows. The wing contains paired one-over-one double hung sash windows and a paneled wood door with metal storm door. The wraparound porch has a metal shed roof and decorative spindlework frieze. (C)

26. Main Street.  
Kelley House  
Dorothy S. Kelley, Route 7, Box 7712, Manchester, Tennessee 37355

Circa 1940 two story brick house with concrete foundation and asphalt shingle roof. Side gabled roof has a front gable which contains a three pane picture window and four panel wood door with three lights. A six-over-six double hung sash window is located in the side gable section. (C)

27. Main Street.  
Tucker House  
Nell Tucker, 260 Kelso-Mulberry Road, Mulberry, Tennessee 37359

Circa 1890 one and one half story Folk-Victorian gable front and wing with pressed metal roof, weatherboard siding, and brick foundation. The house contains two brick interior chimneys, spindle work gable detailing, and a wraparound porch with decorative spindlework frieze and railing. One-over-one double hung sash windows are located in the gable and in the facade of the wing. (C)

28. Main Street.  
Church of Christ

Circa 1900 Greek Revival church with concrete block foundation , vinyl siding, and asphalt shingle roof. The building is characterized by a three story temple front portico with Doric columns and double six-panel entry doors and one story side wing addition.(C)

United States Department of the Interior  
National Park ServiceNational Register of Historic Places  
Continuation SheetSection number 7 Page 14

Lynchburg Historic District, Moore Co., TN

29. Main Street.Daniel House

Ruth P. Daniel, Box 257, Lynchburg, Tennessee 37352

Circa 1980 one story brick modified gable front and wing with concrete foundation, and composite shingle roof. The facade contains three six-over-six double hung sash windows, a wood paneled door with three pane sidelights, paired six-over-six double hung sash windows, one six-over-six double hung sash windows and an attached garage. (NC)

30. Main Street.McEwen House

Ray McEwen, Box 177, Lynchburg, Tennessee 37352

Circa 1870 one story Greek Revival center hall with stone foundation, vinyl siding over original weatherboard, and an asphalt shingle roof, side gabled house with two brick exterior end chimneys and a rear ell addition. The three bay facade has a full-height projecting temple front pediment with two Doric columns for support, and a plain cornice. The center four panel door has single pane, full length sidelights and three section transom with decorative dental molding. Two nine-over-nine double hung sash windows with flat lintels and sills flank the center door. A limestone fence borders the property on the southwestern side. (C)

31. Main Street.Lusty House

Helen Lusty, Route 2, Box 181, Lynchburg, Tennessee, 37352

Circa 1880 one story weatherboard hall and parlor house with stone foundation and asphalt shingle roof. The house is characterized by a side gable roof with central interior chimney, full porch with flat jigsaw posts, and a center half-glass door flanked by one-over-one double hung sash windows. (C)

United States Department of the Interior  
National Park Service

# National Register of Historic Places Continuation Sheet

Section number 7 Page 15

---

Lynchburg Historic District, Moore Co., TN

32. Main Street.

Huffman House

R.B. Golden Huffman, Route 3, Box 1A, Lynchburg, Tennessee 37352

Circa 1880 one story center hall house with vinyl siding over original weatherboard, concrete block infill with stone pier foundation, and metal roof. The side gable roof has a projecting temple front pediment. The three bay facade contains a center door with eight panes and wood frame beneath the full height entry porch with pediment and squared columns, and is flanked by two six-over six double hung sash windows. (C)

33. Main Street.

Mary Bobo's Boarding House (NR 12/17/92).

Brown-Forman Corporation c/o Jack Daniel Distillery, Box 90, Lynchburg, Tennessee 37352

1867 Greek Revival I-house built on the same property as the first house in Lynchburg. The two story house has a stone foundation, weatherboard siding, and an asbestos shingle roof. A central, full height Greek Revival portico is flanked by sets of six-over-six double hung sash windows on both floors and contains a second floor balcony above the double wood doors with single pane sidelights at the ground floor entrance. Square columns with plain capitals support the large portico and compliment the squared pilasters at the front entrance. The rear ell is a circa 1830 house which was incorporated into the later circa 1867 house. (C)

34. Main Street.

Golden Huffman House

R.B. Golden Huffman, Route 3, Box 1A, Lynchburg, Tennessee 37352

Circa 1900 one and one half story rockface concrete block bungalow with metal roof and concrete block foundation. The metal hipped roof has a front shed dormer, which contains triple five-over-one double hung sash windows and has asbestos shingled side walls. The wraparound porch has rockface concrete block walls and posts, which extend up to the bracketed rafters of the hipped roof. The three bay facade is as follows: paired five-over-five double hung sash windows, central door with two-pane sidelights and two-pane transom, and paired five-over-one double hung sash windows. A side door is located at the east end of the porch. (C)

United States Department of the Interior  
National Park ServiceNational Register of Historic Places  
Continuation SheetSection number 7 Page 16

Lynchburg Historic District, Moore Co., TN

35. Main Street.  
Kirby House  
Neal Kirby, Route 1, Lynchburg, Tennessee 37352

Circa 1930 two story craftsman bungalow has a composite shingle roof, vinyl siding, and a stone and concrete foundation. The side gable roof contains a gabled wall dormer with three three-over-one double hung sash windows and a stone exterior end chimney. The full porch has a shed roof, stone posts, and contains paired three-over-one double hung sash windows on either side of a center ten-pane door. (C)

36. Main Street.  
Harrison Funeral Home\*  
Christine Harrison, Drawer 507, Lynchburg, Tennessee 37352

Circa 1920 two story weatherboard house with concrete block foundation and an asphalt shingled, side gabled roof with projecting center gable front porch entrance. A two story sleeping porch with flat roof has been enclosed, and a circa 1939 one story wing addition was built on the west side of the house. The facade windows are single pane awning, set in panels of two, six, and eight. (NC)

Outbuilding: One story frame garage with parapet roof and stone pier foundation, circa 1930. Double garage doors are in the center of the facade with a small double pane casement window on the west side. A metal shed porch roof has wood posts. (C)

37. Main Street.  
The Post  
Neal Kirby, Route 1, Lynchburg, Tennessee 37352

One story gable front commercial building with weatherboard siding and metal roof. Built circa 1890, the building has been modified with the addition of a large circa 1920 eight pane window and wood porch. (C)

United States Department of the Interior  
National Park Service

# National Register of Historic Places Continuation Sheet

Section number 7 Page 17

---

Lynchburg Historic District, Moore Co., TN

38. Main Street.  
Moore County Building  
City of Lynchburg

One part brick public building built in 1951 has a concrete foundation and flat roof. Large glass double doors with transom are flanked by a twelve pane fixed window and a three pane ribbon window. (NC)

39. Main Street.  
Moore County Jail (NR 9/26/79)  
Box 206, Lynchburg, Tennessee 37352

1893 two story brick building has a hipped roof with gablets, asphalt shingles, and a stone foundation. The flat facade contains three two-over-two arched windows on the second floor and two two-over-two double hung sash windows on the ground floor. A hipped roofed portico with four chamfered posts marks the central entrance, which has a paneled wood door and metal storm door. The jail has two interior end brick chimneys and a wide dentilwork cornice. (C)

## Wall Street

40. Wall Street.  
Stewman House  
Alton Stewman, Box 335, Lynchburg, Tennessee 37352

Circa 1940 one story Minimal Traditional with composite shingle roof, vinyl siding, and rockface concrete block foundation. The side gabled facade contains a center gabled portico with a central four panel wood door with four lights and a glass storm door, flanked by one six-over-six double hung sash window and paired six-over-six double hung sash windows. (C)

United States Department of the Interior  
National Park ServiceNational Register of Historic Places  
Continuation SheetSection number 7 Page 18

Lynchburg Historic District, Moore Co., TN

41. Wall Street.Limbaugh House

Willowynne Limbaugh, Route 1, Box 698, Lynchburg, Tennessee 37352

Circa 1940 one story center hall with vinyl siding, a side gabled, asphalt shingle roof, and concrete foundation. The facade has two eight-over-eight double hung sash windows with shutters and a four panel wood door with metal storm door and a gabled portico with wrought iron posts. A side gable carport and storage room are located on the north side of the building. (C)

42. Wall Street.Holt House

Mary Holt, Box 172, Lynchburg, Tennessee 37352

Circa 1935 Colonial Revival one and one-half story brick house with side gable asphalt shingle roof and concrete foundation. The three bay facade contains a central gabled wall dormer with vinyl siding, a six-over-six double hung sash window, a center half-glass door and a single pane fixed window flanked by six-over-six double hung sash windows. A side addition includes a carport with shed roof and rear storage space. (C)

43. Wall StreetSimpson House

Lyndon Simpson, Box 146, Lynchburg, Tennessee 37352

Circa 1940 one story brick Minimal Traditional with asphalt shingle roof and concrete foundation. The side gabled roof has two end cross gables with projecting eaves with returns. The facade is as follows: six panel wood garage door with two lights, three-pane sliding window, two pane casement window, paired six-over-six double hung sash windows, twelve light entry door with metal storm door, and triple six-over-six double hung sash windows. All windows have wooden shutters and aluminum awnings and a round single pane window is located in the south gable. (C)

United States Department of the Interior  
National Park Service

National Register of Historic Places  
Continuation Sheet

Section number 7 Page 19

---

Lynchburg Historic District, Moore Co., TN

Lynchburg Commercial District -- Courthouse Square

West Side Square -- Hiles Street

44. Hiles Street.  
Metro Water, Sewer, and Sanitation Department  
John T. Motlow and Mary L. Richman, Box 287, Lynchburg, Tennessee 37352

Circa 1970 one part commercial block with brick foundation, metal siding, and front brick veneer. Plate glass windows flank the center plate glass entry door. (NC)

45. Hiles Street.  
Lynchburg Post Office  
Robert Van Houser, Box G, Huntland, Tennessee 37345

Circa 1965 rectangular one story brick building with flat roof, concrete foundation, and double glass entry doors with metal frames. (NC)

46. Hiles Street.  
Richard's Jewelry Repair  
Richard Luccisano, Route 1, Box 143, Mulberry, Tennessee 37359

Circa 1940 one part commercial block with tile coping, flat roof, and flat metal awning, enframed window wall, and a half-glass door with transom. (C)

47. Hiles Street.  
Wilkinson D.D.S.  
Dr. Leroy Wilkinson, Box 82, Lynchburg, Tennessee 37352

Circa 1940 brick one part commercial block with flat roof and corrugated metal awning. Paired six-over-six double hung sash windows have a projecting wood sill and are flanked by wood framed doors and single glass panes. (C)

United States Department of the Interior  
National Park ServiceNational Register of Historic Places  
Continuation SheetSection number 7 Page 20

Lynchburg Historic District, Moore Co., TN

48. Hiles Street.  
Elin Wofford Real Estate  
Mrs. Elin Wofford, 345 Wabash Road, Mulberry, Tennessee 37359

One part concrete block commercial building, circa 1940, has a flat roof with board and batten cornice and corrugated metal awning. The facade has wood frame doors with single paned glass, two one-over-one double hung sash windows, and a wood frame door with single paned glass. (C)

49. Hiles Street.  
Moore County News  
Terry Craig, Drawer A, Lynchburg, Tennessee 37352

Circa 1940 one part commercial block with flat roof, board and batten cornice, metal shed awning, and concrete foundation. The exterior walls have stucco wall cladding with a center door with single pane glass and wood frame flanked by large plate glass windows and projecting sills. (C)

50. Hiles Street.  
Lynchburg Factory Outlet  
DeLong Sportswear, Inc., Box 270, Grinnell, Iowa 50112

One part commercial block has a flat roof with tile coping, Roman brick veneer siding, and a concrete foundation, circa 1930. Two large plate glass storefront windows flank a half-glass door with metal storm door. (C)

51. Hiles Street.  
Middle Tennessee Home Health  
Thomas G. Armour, Box 159, Lynchburg, Tennessee 37352

Circa 1935 one part commercial block originally used as an auto dealership. Building has common bond brick veneer over concrete block, with a concrete block foundation and flat roof with tile coping. The four bay facade is as follows: Sixteen pane garage door with wood



United States Department of the Interior  
National Park ServiceNational Register of Historic Places  
Continuation SheetSection number 7 Page 21

Lynchburg Historic District, Moore Co., TN

framing, single pane glass door with wood frame and single pane transom, another identical door, and a large plate glass storefront window, added in the 1950's. A large canvas awning extends over the large window. (C)

52. Hiles Street.Sunsation, Inc

Leroy Wilkinson and Mary Edde, Box 82, Lynchburg, Tennessee 37352

Circa 1950 one part commercial block with flat roof, vertical board cornice, common bond brick veneer over concrete block, and concrete foundation. The center door is single pane glass with wood frame and flanked by plate glass windows with concrete sills. (NC)

53. Hiles Street.The County Seat Deli

Ronald Frazier, Box 195, Lynchburg, Tennessee 37352

Circa 1900 one part commercial block is one story with a flat roof, concrete foundation, and stucco wall cladding over the original stone veneer. Original wraparound fixed pane storefront windows are intact although the original door in the recessed entry was replaced in circa 1950. The facade contains a six pane storefront window with four pane window facing the recessed entry, two plate glass and metal frame entry doors with plate glass center panel, a four pane window facing entry, and a four pane window. (C)

54. Hiles Street.Sully's GiftsJames Sullinger, Route 2, Box 41, Lynchburg, Tennessee 37352 and Sunshine Ervin,  
Box 51, Lynchburg, Tennessee, 37352

Circa 1970 one part commercial block has a flat roof with tile coping, glazed brick veneer, metal shed awning, and concrete foundation. The three bay facade is composed of a center plate glass door with metal frame flanked by plate glass storefront windows with metal frames. (NC)

United States Department of the Interior  
National Park Service

# National Register of Historic Places Continuation Sheet

Section number 7 Page 22

---

Lynchburg Historic District, Moore Co., TN

55. Hiles Street.  
Lynchburg Public Park  
Jack Daniel Distillery, Box 90A, Lynchburg, Tennessee 37352

Built by Jack Daniel Distillery in 1980, the small park has a picket fence, flagstone walkway, and wood frame gazebo. (NC)

### North Side of Square

56. Public Square.  
Lynchburg Auto Parts  
Roger Simmons, Box 191, Lynchburg, Tennessee 37352

One part commercial block contains two buildings with flat roof and concrete foundation. The building on east was built circa 1910 and originally served as a gas station. This one story brick building has decorative dichromatic brickwork on the facade, which contains two single pane glass storefronts on either side of a recessed entrance, which is flanked by single pane glass storefront windows and covered by a flat awning. Three light transoms are located above the storefront windows, and a four light transom is above the entry doors, which are double wood frame with single paned glass fronts.(C)

57. Public Square.  
Lynchburg Auto Parts  
Roger Simmons, Box 191, Lynchburg, Tennessee 37352

Circa 1920 one part commercial block built adjacent to the original 1910 auto parts building. This one story brick building contains a recessed entrance with single pane glass door with wood frame, flanked by single pane glass storefront windows. Two three-light transoms and a four-light transom are located above the two windows and the door. A flat awning extends the width of the facade, which is characterized by dichromatic brickwork. (C)

United States Department of the Interior  
National Park ServiceNational Register of Historic Places  
Continuation SheetSection number 7 Page 23

Lynchburg Historic District, Moore Co., TN

58. Public Square.  
Oak Leaf Emporium  
Gary D. Smith and William Dickey, 703 Bagley Drive, Fayetteville, Tennessee 37334

One part commercial block with a concrete foundation, dichromatic brick work, metal shed awning, flat roof, and stepped parapet. Built circa 1920, the building has wrap storefront windows and recessed entrance with half-glass doors and four light transom. (C)

59. Public Square.  
Sundae's Restaurant and Ice Cream Shoppe  
Leroy Prince, Route 4 Box 40156 Winchester, Tennessee 37398

Circa 1910 one part brick commercial block with flat roof, concrete coping, dichromatic brickwork, metal shed awning, and concrete foundation. The three bay facade contains two plate glass storefront windows with wood frames, a recessed entrance with side storefront windows, and double half-glass entry doors with wood frame. Two three-light transoms are located above the storefront display windows and a two-light transom is located above the double entry doors. (C)

60. Public Square.  
Lynchburg Ladies Handiwork.  
Jack Daniel Distillery, Route 1, Lynchburg, Tennessee 37352

Circa 1900 one part commercial block has brick exterior with concrete foundation and flat roof with concrete coping and decorative brick work along the upper section of the building. The original storefront contains two single pane glass display windows on either side of the center half-glass door with wood frame. Two three-light transoms and a center two-light transom are located above a flat awning with metal covering. (C)

61. Public Square.  
"Our Place" Framers.  
Samuel F. Robertson, Jr. Box 234, Lynchburg, Tennessee 37352

Formerly the Lynchburg Post Office, this one part brick commercial block was built circa 1900 with a concrete foundation, recessed entrance, and flat roof. The facade has decorative inlaid

United States Department of the Interior  
National Park Service

# National Register of Historic Places Continuation Sheet

Section number 7 Page 24

---

Lynchburg Historic District, Moore Co., TN

tile and contains two plate glass display windows on either side of the half-glass double entry door. Three single pane transoms extend across the facade and are directly above the roof of a covered walkway which extends across the adjacent building. (C)

62. Public Square.

Our Place General Store

Samuel F. Robertson, Jr. Box 234, Lynchburg, Tennessee 37352

Circa 1970 building replaced demolished building. One part brick commercial block has a concrete foundation and stepped parapet roof. Plate glass storefront windows flank the center half-glass double door entrance. (NC)

63. Public Square.

Lynchburg Grocery

Jimmy Wolaver, Box 357, Lynchburg, Tennessee 37352

Circa 1970 one part commercial block with brick exterior, concrete foundation, flat roof, metal awning, enframed window wall, and double glass entry doors with metal frames. (NC)

East Side of Square -- Mechanic Street

64. Mechanic Street.

Raphael's Roastery

Raphael Smith, Box 387, Lynchburg, Tennessee 37352

Renovated gas station, circa 1940 has original gas pumps intact. The rectangular, one story building is concrete block on a concrete foundation, with flat roof on the garage section, which contains original paneled doors, and a gabled roof with asphalt shingles over the station office. The office section has a projecting front gabled roof with metal posts and wood paneled gable. The facade contains two paneled garage doors, eight pane casement window, half-glass door, half-glass door, and two-paned glass storefront windows. (C)

United States Department of the Interior  
National Park ServiceNational Register of Historic Places  
Continuation SheetSection number 7 Page 25

Lynchburg Historic District, Moore Co., TN

65. Mechanic Street.Richman House

Mary L. Richman, 106 Red Bud Lane, Tullahoma, Tennessee 37388

Circa 1900 modified gable front and wing house has a full porch with shed roof and wood posts. The house has asphalt shingle roof, weatherboard siding, and concrete block and stone foundation. The two-story gable front contains a one-over-one double hung sash window in the second story and another one-over-one double hung sash window and half-glass door on the first story. The one and one half story wing contains a brick interior chimney and center five panel wood door with wood screen door. A four-over-four double hung sash window and one-over-one double hung sash window flank the center door. (C)

66. Mechanic Street.Welcome Center and Craft Shops

Mary L. Richman, 106 Red Bud Lane, Tullahoma, Tennessee 37388

Circa 1900 one and one-half story center hall house with brick exterior end chimneys and a side gabled roof with asphalt shingles. The house has a weatherboard exterior and stone pier foundation with concrete block infill. The three bay facade contains a temple front portico with plain cornice and gable end and square posts with side railing. The center half-glass, three panel door has single pane sidelights and transom, with plain pilasters and is flanked by four-over-four double hung sash windows with wood shutters. A one story side addition has a side gabled roof and contains six casement windows. (C)

67. Mechanic Street.Mulberry Creek Sticks and Stones (located behind the Welcome Center).

Mary L. Richman, 106 Red Bud Lane, Tullahoma, Tennessee 37388

Circa 1930 one story board and batten building has a gabled roof with metal covering and concrete pier foundation. The facade contains a six pane fixed window in the gable end and a fifteen-pane door and single-pane storefront window beneath a flat roofed porch with three wood posts. (C)

United States Department of the Interior  
National Park Service

## National Register of Historic Places Continuation Sheet

Section number 7 Page 26

---

Lynchburg Historic District, Moore Co., TN

68. Mechanic Street.  
Lynchburg Pharmacy  
Bob Gray, Route 1, Lynchburg, Tennessee 37352

One part commercial block is brick with concrete foundation has a flat roof and flat metal awning. Built in circa 1970, the building contains an enframed window wall and double glass entry doors with single pane transom. (NC)

69. Mechanic Street.  
Lynchburg Hardware & General Store / Pepper Patch Bakery & Candy Kitchen  
Pepper Patch, Inc., (Dorothy B. Smith) 1250 Old Hillsboro Road, Franklin, Tennessee  
37064

1913 two part commercial block is divided into three two story brick buildings. The buildings, which have flat roofs, decorative brickwork cornices, and concrete foundations, are divided by brick pilasters, which are also located at the ends of the buildings, and connected by a full length flat awning with metal posts. The buildings have identical second story composition, each contains three six-over-six double hung sash windows with concrete lintels and sills, and nearly identical storefronts, with single pane display windows, double half-glass doors, recessed entrances, and full front transoms. (C)

70. Mechanic Street.  
Farmer's Bank of Lynchburg

1921 two part commercial block has a concrete foundation, modern stucco veneer over brick exterior, and parapet roof with triangular pediment. The original windows have been replaced by fixed plate glass windows with stucco covered concrete sills. The ground level has a recessed center entrance with double plate glass doors and recessed plate glass windows. A full length covered walkway has a flat roof with wood posts. (NC)

United States Department of the Interior  
National Park ServiceNational Register of Historic Places  
Continuation SheetSection number 7 Page 27

Lynchburg Historic District, Moore Co., TN

South Side of Square -- Main Street

71. Main Street.  
Collectibles and Gifts by Howard Bentley  
Robert F. Misicka, Box 18, Lynchburg, Tennessee 37352

Circa 1920 one part commercial block has a flat roof with tile coping, brick veneer over concrete block, and concrete foundation. The modified facade contains a three panel glass storefront with single glass panel entrance door with transom. A metal shed roofed walkway with metal posts extends across the facade. (C)

72. Main Street.  
Barrel Shop / Baker's Antiques & Collectibles  
Tracy and Lisa Matlock, Box 182, Lynchburg, Tennessee 37352  
John Statum, Route 4, Shelbyville, Tennessee 37160

Circa 1900 one part brick commercial block has a flat roof with tile coping, dichromatic brickwork cornice, and concrete foundation. The building is divided into two separate stores with remodeled storefronts. The Barrel Shop retains its original three panel storefront window and recessed entrance with glass and metal door. A covered walk is provided by a metal shed roof with wood frame and posts. Baker's Antiques has an enframed window wall, containing two windows and a center entrance with double glass doors. (C)

73. Main Street.  
Diamond Video  
Main Street, Lynchburg, Tennessee 37352

Circa 1930 one part commercial block with flat roof and concrete foundation. Three bay facade contains two plate glass storefront windows and a center entrance with plate glass door. Vertical brick lintels with projecting horizontal brick border are above filled in transoms. (C)

United States Department of the Interior  
National Park ServiceNational Register of Historic Places  
Continuation SheetSection number 7 Page 28

Lynchburg Historic District, Moore Co., TN

74. Main Street.  
Country By Nature  
Paul Smotherman, Box 448, Lynchburg, Tennessee 37352

Circa 1900 one part commercial block with flat roof, rockfaced and smooth concrete block exterior, and concrete foundation. The three bay facade contains a recessed entrance with center display window and transom, and two corner doors with single glass panes and transoms. Two plate glass storefront windows are located on either side of the center alcove entrance. (C)

75. Main Street.  
Mary Ruth Fuqua Antiques  
James F. Fuqua, Lakewood Drive, Tullahoma, Tennessee 37388

Circa 1900 one part commercial block has brick exterior with a flat roof and concrete foundation. The facade contains an enlarged storefront window and side entrance with single panel door and transom. A flat roofed covered walkway runs the width of the facade. (C)

76. Main Street.  
Co-Op Tire Center  
Farmers Co-Op, Main Street, Lynchburg, Tennessee

Circa 1915 one part commercial block has a gable front parapet roof with brick details, a stone veneer over concrete block, and concrete foundation. The three bay facade contains two glass storefront windows with semicircular fanlights on either side of the center entrance with semicircular fanlight. Arched window and door openings have stone keystones and lintels. A small paneled wood door is located at the east corner of the building and also has arched lintel with keystone. (C)

77. Main Street.  
Moore Farmers Co-Op  
Bedford Moore Co-Op, Moore County Branch, Box 64, Shelbyville, Tennessee 37160

Circa 1915 one part commercial block with flat roof and tile coping, has a brick veneer over concrete block, and a concrete foundation. Decorative brickwork includes dentil work cornice and four pilasters. The storefront facade contains a plate glass display window, twelve-pane



United States Department of the Interior  
National Park ServiceNational Register of Historic Places  
Continuation SheetSection number 7 Page 29

Lynchburg Historic District, Moore Co., TN

entry door, two plate glass windows, and the original garage entrance. Double pane transoms run the width of the building but have been painted over in recent years. A flat roofed covered walkway extends across the facade at street level. (C)

78. Main Street.Iron Kettle Restaurant

Johnny and Darlene Woods, Box 182, Lynchburg, Tennessee 37352

Circa 1915 one part commercial block has a flat roof, brick facade over concrete block, and concrete foundation. Full-height brick pilasters are located at each end of the building, which has a decorative brickwork cornice and recessed brick panels in the upper portion, above a flat roofed covered walkway. An enframed window wall also includes a plate glass side door. (C)

79. Main Street.DeLong Lynchburg Division (formerly Craftmore Glove Company).

Morrison Schultz Manufacturing Company, Inc., Box 270, Grinnell, Iowa 50112

Circa 1945 rectangular concrete block commercial building with parapet front and flat roof. The facade is composed of paired six-over-three double hung sash windows, center double doors with single pane lights and flat awning, and glass block window. (C)

80. Main Street.Dance House\*

Thomas J. Armour, Lynchburg, Tennessee 37352

Circa 1900 one and one half story gable front and wing with brick and stone foundation, asbestos shingle siding, and asphalt shingle roof. The gable end contains the interior brick chimney and has one one-over-one double hung sash window with wood shutters. The wing section has a side gable roof and contains a three panel wood and half-glass door with metal screen door and paired one-over-one double hung sash windows with wood shutters. The 3/4 porch has a shed roof with three wood posts and scroll-sawn gingerbread railing. (C)

## National Register of Historic Places Continuation Sheet

Section number 7 Page 30

---

Lynchburg Historic District, Moore Co., TN

81. Main Street.  
Parks-Hill House\*  
Quinn Hill, Box 262, Lynchburg, Tennessee 37352

Circa 1940 two story vinyl sided bungalow with hipped roof with asphalt shingles. A central shed dormer contains three fixed pane windows above the full porch with shed roof and wrought iron porch supports. The three bay facade contains paired one-over-one double hung sash windows, a central door with five pane sidelights, and another paired one-over-one double hung sash window. (C)

Outbuilding: Circa 1940 rectangular outbuilding is one story with a hipped roof, vertical board siding, and concrete foundation. A lean-to addition has a shed roof and half-glass three panel wood door. (C)

82. Center of Public Square.  
Moore County Courthouse (NR 9/26/79)  
City of Lynchburg

Two story 1885 Italianate brick building with flat roof with metal covering, wide cornice with scroll-sawn brackets, and a wood cupola with steeply pitched pyramidal roof with metal shingles. The rectangular building has identical configuration on the north and south sides, each containing a 7 bay facade with six-over-six double hung sash windows with arched hood molds and center double doors with round hood molds above semicircular fanlights. The east and west elevations are identical and each contains five six-over-six double hung sash windows with window hoods and center double doors with fanlight and hood molds. The courthouse originally consisted of a five bay facade until 1967-68, when one bay, replicating the original, was added to each end of the facade. The window lintels on the new facade are concrete. (C)

## National Register of Historic Places Continuation Sheet

Section number 8 Page 31

---

Lynchburg Historic District, Moore Co., TN

### VIII. SIGNIFICANCE

The Lynchburg Historic District located in Lynchburg, Moore County, Tennessee is eligible for the National Register of Historic Places under Criterion A for its significance in government and commerce. The district is also eligible for listing under Criterion C, for its late-nineteenth and early-twentieth century rural domestic and commercial architecture set within a significant vernacular landscape of town development. Due to a lack of late-twentieth century commercial growth, the late-nineteenth and early-twentieth century appearance of Lynchburg remains largely intact and exhibits a high degree of historical integrity.

Settlers first arrived in the Lynchburg area around 1800, which was until 1871, a part of Lincoln County. These pioneers from North Carolina and Georgia came to the area searching for farm land and an adequate water supply. An early settler who played an important role in Lynchburg's early settlement and development was Thomas Roundtree, who established the town's first cotton mill along the banks of East Mulberry Creek near the present location of Jack Daniel's Distillery, which is outside of the district's boundaries. He later built his own dwelling, a one story brick house which now serves as the ell-wing to the Mary Bobo Boardinghouse (#33, NR 12/17/92), on a country lane leading west from the mill site. This country lane developed into the present day Main Street and established the initial orientation of the settlement in an east-to-west direction, with industries on the east side of the village, adjacent to the water power provided by East Mulberry Creek and residences on the west end, along Main Street, where the creek ran to the south of the dwellings. In the early years of settlement, the East Mulberry Creek was clearly a primary determinant of where one might locate their home or business. In that sense, the first decades of settlement at Lynchburg created a textbook definition of vernacular landscape in that the settlers adapted themselves and their properties to the lay of the land and the resources at hand; in particular, the creek.

Other settlers and entrepreneurs soon followed Roundtree. In the 1820s-1830s, William P. Long opened a grist mill and cotton gin in Lynchburg. There was also a large tannery in operation. Another early settler, Moses Crawford, made a considerable profit selling lots after the town had been laid out in an east-west grid along two streets, Main Street, and to the north, Majors Boulevard (Tennessee Highway 55).

Like most small Tennessee towns in the mid-nineteenth century, Lynchburg's economy relied heavily upon agriculture. Farmers in the area concentrated on various types of animal husbandry (cattle, sheep, and hogs) and also raised hay, corn, grain, and other staples.

## National Register of Historic Places Continuation Sheet

Section number 8 Page 32

---

Lynchburg Historic District, Moore Co., TN

During the Civil War, the citizens of Lynchburg chose to support the Southern cause and raised several companies of young men who fought with the Army of Tennessee. There are no records of any major skirmishes in and around Lynchburg, however, both sides in the conflict passed through the surrounding countryside on various foraging raids.

Following the war, residents of remote parts of Franklin, Coffee, Bedford, and Lincoln counties hoped to form a new county for several reasons, according to the July 4, 1876 issue of the Lynchburg Sentinel. First, they found themselves far removed from their respective county seats. Second, the roads in the remote parts of these counties were treacherous and at certain times of the year, almost impassable. Finally, they hoped that the establishment of a new county would provide them with the legal protection offered by courts and grand juries. By an act of the Tennessee Grand Assembly, Moore County was formally chartered on December 14, 1871 and named in honor of General William Moore, an early Lincoln County settler, veteran of the War of 1812, and Jacksonian Democratic politician. Shortly thereafter, in June of 1873, Lynchburg was declared the county seat of the new county largely because of its central location.

Industries, like the Jack Daniel's Distillery (NR 9/14/72) and the DeLong Lynchburg Division (formerly Craftwork Glove Company, built ca. 1945, # 79) are on the eastern end of town, still oriented to the East Mulberry Creek. The town's commercial zone is located around the town square as is the historic political center, represented by the courthouse (NR 9/26/79, #82) and jail (NR 9/26/79, #39). In the last half of the twentieth century, some public and commercial institutions have moved just off the square in a direction toward Majors Boulevard (Tennessee Highway 55). These properties, like the town post office, library, and gas station, certainly relied on commuter traffic, and/or desired individual parking. Unlike many similar sized towns, such as Liberty (NR 6/25/87, DeKalb County), basic commercial services like the grocery store remain on the Lynchburg square today. While the square retains its function as a commercial and political center of the Lynchburg landscape; residences still tend to be located to the west of the square. The mixture of a church and turn of the century Victorian folk houses on Main Street are a particularly powerful historical example of the persistence of these earlier settlement patterns. A large residential area is also located north of the square, centered on Majors Boulevard. This pattern too has been in place since the mid-nineteenth century, as is evident from such dwellings as #1, ca. 1875; #8, ca. 1880; #6, ca. 1877; #7, ca. 1878; #18, ca. 1874.

## National Register of Historic Places Continuation Sheet

Section number 8 Page 33

---

Lynchburg Historic District, Moore Co., TN

Thus, by the early 1870s, at the time of the creation of Moore County, the vernacular landscape of Lynchburg became a mixed one shaped also by a new "political" landscape brought about by the decision of the county commissioners to impose a courthouse square into the earlier village plan. That unique aspect of Lynchburg's built environment is still intact today, even though the town has experienced various periods of economic growth and decline in the last one hundred and twenty years. The decision to transform the rural village of Lynchburg into a proper Victorian-era county seat had an immediate impact on the landscape. The new county commissioners imposed a fully realized courthouse square, following the influential Shelbyville plan, into the earlier vernacular landscape along Main Street and Majors Boulevard. The pattern they created in the early 1870s is still intact today.

In the 1870s, Lynchburg became the regional center of the mule trade. Although the town was small and did not have connections to the railroad, it did have one major advantage. It was situated at the center of an economic triangle formed by Tullahoma (Coffee County) to the northeast, Shelbyville (Bedford County) to the northwest, and Fayetteville (Lincoln County) to the south. Tullahoma, Shelbyville, and Fayetteville all were situated along the railroad. Farmers on their way to these three lucrative markets often traveled the turnpike through Lynchburg, now known as Tennessee Highway 55 or Majors Boulevard. Thus, Lynchburg prospered as mule traders and general merchants began to recognize this small town as a place to buy and sell goods. On February 2, 1876, the Lynchburg Sentinel reported that "mule trading has been rather lively . . . . Considerable crowds of traders and mules collect occasionally on the corner of Main and Mechanic Streets."

Along with the birth of the mule market in Lynchburg came the rise of the whiskey distillery industry. The practice of whiskey distilling can be traced back to the town's early settlement area. Yet, as the nineteenth century progressed, several distilleries were established in and around Lynchburg for sale to local residents and traveling merchants. The whiskey distillery industry continued to increase well into the 1880s. At this time, there were fifteen registered distilleries in Moore County with the now famous Jack Daniel's Distillery (registered 1876) being second only to Tom Eaton's Distillery in the amount of production. According to Goodspeed's Histories of Giles, Lincoln, Franklin, and Moore Counties of Tennessee, Jack Daniel produced "one hundred and fifty gallons of spirit per day" (807).

The economic prosperity brought about by mule trading and the whiskey distilling industry led to an increase in population and a need for increased development in Lynchburg. Hiles Street,

## National Register of Historic Places Continuation Sheet

Section number 8 Page 34

---

Lynchburg Historic District, Moore Co., TN

along the square, was laid out in 1877. Lynchburg's square became a major economic center where sour mash whiskey, dry goods, farming implements, and tobacco were all bought and sold.

Lynchburg contains several extant buildings that reflect this early economic growth in the town's history. The Bobo Hotel (NR 12/17/92, #33) was built on to a previously existing brick house (circa 1830) that once served as the home of Thomas Roundtree. In 1857, Dr. E. Y. Salmon bought the house and ten years later added a large two-story Greek Revival frame residence to the original ca. 1830 brick house. The frame residence served as the Grand Central Hotel from 1867 until Salmon's retirement in 1908. This hotel functioned as a boardinghouse for both townspeople and travelers who passed through Lynchburg. Its location on Main Street speaks to the prominence of this earlier vernacular roadway until it was finally surpassed as the town's primary artery to the outside world by the state highway improvement of Majors Boulevard into Tennessee Highway 55 in the mid-twentieth century. As additional evidence of the earlier prominence of Main Street, compared to Majors Boulevard, one may note the number of once stylish Folk Victorian gable-front and wing houses on Main Street (#25, ca. 1890; #27, ca. 1890; #80, ca. 1900).

Among the dwellings on Majors Boulevard, the Hinkle-Price House (#6) is particularly important as an example of decorative interior painting. This structure's significance lies not only in its outward appearance, which combines both Greek Revival and Victorian architectural styles, but more importantly, the interior of the house exemplifies a fine appreciation for late-nineteenth century Victorian design. This house contains several outstanding examples of woodgraining and landscape painting that can be attributed to itinerant artist Fred Swanton who painted several domestic interiors throughout the Middle Tennessee area in the 1880s. In addition to his work at the Hinkle-Price House, Swanton was also commissioned to paint the interior of the Green-Evans farmhouse (NR 12/17/92), a Greek Revival dwelling located along the outskirts of Lynchburg. The existence of Swanton's work in Lynchburg provides evidence that residents of the town were quite aware of Victorian styles and could afford to pursue this popular style, both in exterior architectural appearance (as evident along Main Street) and in decorative painted interiors.

In addition to the fine examples of Folk Victorian architecture, the district contains fine examples of vernacular Greek Revival (#18, ca. 1874; #30, ca. 1870) and Carpenter Gothic Revival (#20, ca. 1876) architecture. The two Greek Revival structures (#18, #30) exemplify the

## National Register of Historic Places Continuation Sheet

Section number 8 Page 35

---

Lynchburg Historic District, Moore Co., TN

vernacular aspect of this architectural style through the use of square columns, which were much easier to construct than the rounded columns of the high-style Greek Revival architecture. The Carpenter Gothic Revival dwelling (#20) found at the corner of main Street and Majors Boulevard possesses such vernacular aspects of this architectural style as wood construction and restrained door and window treatments. A high-style Carpenter Gothic Revival structure would often be of masonry construction and contain elaborate porch, door, and window treatments.

To meet the needs of the growing population, several schools and churches were erected. In the 1880s, Moore County had twenty-five schools for white children and four schools for black children. Two schools were located in Lynchburg, the Lynchburg Male and Female Institute, chartered in 1870, and the Lynchburg Normal School, which was holding sessions by 1876. Unfortunately, neither one of these structures are extant. Of the churches, the most notable were the Methodist Episcopal Church (1872) and several churches established by the Primitive Baptists.

In the midst of the prosperity brought by increased trade, disaster struck in the form of a fire early in the morning of December 4, 1883. The fire, started by unknown causes, originated on an abandoned storehouse and consumed twenty-four buildings, approximately half of the town. Blacksmiths' shops, drug stores, saddle shops, storehouses, and the original courthouse were all destroyed in the blaze. Residents of Lynchburg immediately began to rebuild within the confines of the town plan as it had evolved from the 1820s to the 1870s.

The Moore County Courthouse (NR 9/26/79, #82), constructed in 1885, is a simple, yet imposing, late vernacular Italianate two-story brick structure. In 1893, the County Court appointed the Pauley Jail and Manufacturing Company to build a new jail because the old jail (located due north of the Lynchburg Historic District) was no longer a satisfactory incarceration facility. The 1893 jail (NR 9/26/79, #39) is a two-story brick vernacular Italianate structure. The emergence of these two structures in Lynchburg's built environment symbolizes both the town's acceptance and desire for a strong local government. These properties remained the only buildings used for local government until a new jail was built in 1991. The old jail is now being restored by the Moore County Historical Society and serves as a local history museum.

The visual presence of an organized local government and a growing commercialization attracted more merchants and their families to Lynchburg. Many of these new settlers built houses in the gable-front and wing style. Several of these houses that were built in the 1890s along Main Street and Majors Boulevard (#3, #21, #25, #27) serve as excellent examples of this

## National Register of Historic Places Continuation Sheet

Section number 8 Page 36

---

Lynchburg Historic District, Moore Co., TN

vernacular style due to their simple folk house forms and restrained decorative treatments along the porch and cornice lines. A variation of this style, the up-right and wing, is located on Main Street (#22).

Coupled with the arrival of new banks, flouring mills, and groceries in the early 1900s, the town made technological progress with the establishment of a telephone exchange that effectively increased Lynchburg's communication capabilities. The editors of the Lynchburg Falcon, J.J.Bean and Ray Parks, recognized Lynchburg's potential as a major trading center and in the November 30, 1906 issue of that paper they appealed to local merchants to "reach out after their [travelers] trade, and get them in the habit of dropping in to look at your goods." Elsewhere in the same issue, the editors instructed Lynchburg merchants to "advertise your wares and let the people know you are selling goods as cheap as the merchants of nearby towns."

In the mid-1910s, the emergence of the automobile greatly affected both the landscape and the economy of Tennessee. The state's new road system boosted Lynchburg's economy by bringing more professionals and merchants through Lynchburg on their way to Tullahoma, Shelbyville, and Fayetteville. This increased traffic brought with it a boom in the development of commercial and domestic structures in Lynchburg. Extant examples of these early vernacular commercial structures can be found along the west and north sides of the Public Square. These five buildings (#53, #56, #59, #60, #61) all date between 1900 and 1910. Examples of 1900s and 1910s domestic structures can be found along Mechanic Street (#65, #66); Majors Boulevard (#15); and Main Street (#80, #34).

On July 18, 1913, another fire erupted in Lynchburg that completely destroyed the east and south sides of the square, which were almost entirely of frame construction. The fire raged until it reached the fireproof concrete walls of the Moore County Bank (now Country By Nature, #74). At this point, the Lynchburg Volunteer Fire Department was able to bring the fire under control. Following this blaze, the resolute citizens of Lynchburg once again built back the square. A group of local merchants hired Kimsey Brothers Contractors to build a long brick commercial building extending two-thirds of the way down the east side of the square (#69, constructed in 1913). On the south side, individual merchants built commercial buildings utilizing brick and concrete construction.



## National Register of Historic Places Continuation Sheet

Section number 8 Page 37

---

Lynchburg Historic District, Moore Co., TN

According to Foster's Counties of Tennessee, Lynchburg had a population of 365 in 1920 and boasted "several good schools and churches, a weekly newspaper, two banks, and flourishing business establishments" (76). Due to the town's small size, residents who lived around

Lynchburg still relied upon the land for their subsistence. The fertility of the soil in the area resulted in high yield production of corn, wheat, and oats. In addition to this, farmers raised hogs, cattle, sheep, chickens, and turkeys to provide an income for their families. Many residents depended on the numerous distilleries in the area for steady employment. Yet, the passage of the Eighteenth Amendment and the Volstead Act in 1920 effectively halted the legal production of whiskey in the United States. Thus, former distillery workers in Lynchburg were forced to seek employment elsewhere. Many went back to their agricultural jobs while others commuted to larger towns such as Tullahoma, Shelbyville, and Fayetteville where they found steady employment in industrial related fields. Lynchburg's built environment reflects this economic transformation. The Lynchburg Historic District contains only two contributing structures (#36, #71) that date to the 1920s. The repeal of Prohibition in 1933 brought about the revival of the distilling industry, and consequently, a rise in grain production.

The 1930s and 1940s witnessed a gradual increase in domestic and commercial development in Lynchburg. Majors Boulevard contains several fine examples of 1930s domestic architecture. These styles include bungalows (#5, ca. 1935; #2, ca. 1930) and Tudor Revival cottages (#11, ca. 1938; #10, ca. 1930). The economic effects of the Great Depression greatly limited commercial development and only two examples of commercial structures from this period can be found along the west and south sides of the square (#51, ca. 1935; #73, ca. 1930).

Extant examples of 1940s domestic architecture include a bungalow on Main Street (#81, ca. 1940) and a two-story brick house on Main Street (#26, ca. 1940). Examples of 1940s commercial architecture can be found on the south side of the square (#79, ca. 1945) and along the west side of the square (#46, #47, ca. 1940). In addition to these structures, Lynchburg contains an excellent example of a 1940s Texaco gas station (#64, ca. 1940) complete with original gas pumps.

Lynchburg's economy continues to center around agriculture and the whiskey industry. This trend is evident in the businesses comprising Lynchburg's Public Square. For example, half of the south side of the square serves as the headquarters for the Moore County Co-Op, thus emphasizing the town's continued dependence on agriculture. According to the South Central Bell Phone Book-Lynchburg 1994-95, Moore County has sixteen Grade A dairies, over one

## National Register of Historic Places Continuation Sheet

Section number 8 Page 38

---

Lynchburg Historic District, Moore Co., TN

hundred producers of feeder pigs, and 2,000 acres of corn, soybeans, tobacco, and wheat. Jack Daniel's Distillery is the county's leading employer. The next largest single employer is DeLong Sportswear, which has seventy employees (1). Other stores on the square cater to the thousands of tourists who visit Lynchburg and Jack Daniel's Distillery each year.

Thus, Lynchburg's dependence on the integrity of its historic built environment (examples of which include Jack Daniel's Distillery, Mary Bobo's Boardinghouse, and the Public Square) has nurtured the town's economy through increased tourism. Furthermore, the absence of major industrial enterprises and large corporations has helped Lynchburg to maintain a large degree of historic architectural integrity in many of its late-nineteenth and early-twentieth century domestic and cultural structures. Although the two devastating fires (1883 and 1913) claimed many of the early buildings, the town has undergone very few changes in the twentieth century and serves as an excellent example of Lynchburg's early economic prosperity.

# National Register of Historic Places Continuation Sheet

Section number 9 Page 39

---

Lynchburg Historic District, Moore Co., TN

## IX. BIBLIOGRAPHY

Bean, J.J. and Ray Parks, Lynchburg Falcon 30 November 1906.

Bigger, Jeane. "Jack Daniel Distillery and Lynchburg: A Visit to Moore County, Tennessee." Tennessee Historical Quarterly 31 (Spring 1972): 3-21.

Cornelius, Kay O. "General William Moore: Pioneer, Patriot, Politician." Tennessee Historical Quarterly 54 (Spring 1995): 16-29.

Ferguson, Joan C. Reminiscing About Lynchburg: Abstracts From Early Lynchburg, Moore County, Tennessee, Old Newspapers: 1873-1932. Unpublished manuscript, Lynchburg City Library.

Foster, Austin P. Counties of Tennessee. Nashville: Department of Education, Division of History, 1939.

Franklin, Rachel and Carroll Van West. "Mary Bobo Boarding House, Moore Co. , TN. NRHP Nomination. Tennessee Historical Commission. Nashville, TN. 1993.

Goodspeed, Westin A., ed. Goodspeed's Histories of Giles, Lincoln, Franklin, and Moore Counties of Tennessee. Nashville: The Goodspeed Publishing Co., 1886.

Hankins, Caneta. Hearthstones: The Story of Rutherford County Homes. Murfreesboro, TN: The Oaklands Association, Inc., 1993.

McAlester, Virginia and Lee. A Field Guide to American Houses. New York: Alfred A. Knopf., 1993.

No Author Listed. History of Moore County. Unpublished manuscript, Lynchburg City Library.

No Author Listed. Lynchburg Sentinel. 2 February; 4 July 1876.

## National Register of Historic Places Continuation Sheet

Section number 9 Page 40

---

Lynchburg Historic District, Moore Co., TN

Owens, Anne-Leslie. "The Decorative Painting Tradition in Tennessee Interiors: 1830-1890."  
Master's thesis, Middle Tennessee State University, 1995.

South Central Bell Telephone Book-Lynchburg, Tennessee, 1994-95.

Upton, Dell and John Michael Vlach, eds. Common Places: Readings in American Vernacular  
Architecture. Athens: University of Georgia Press, 1986.

West, Carroll Van. Tennessee's Historic Landscapes: A Traveler's Guide. Knoxville:  
University of Tennessee Press, 1995.

\_\_\_\_\_. "Middle Tennessee Houses and the Plain Painter Tradition: The Work of Fred  
Swanton in the Late Victorian Era." Tennessee Historical Quarterly 53 (Spring 1994):  
56-63.

# National Register of Historic Places Continuation Sheet

Section number 10 Page 41

---

Lynchburg Historic District, Moore Co., TN

## X. GEOGRAPHICAL DATA

### Verbal Boundary Description

The Lynchburg Historic District boundary begins at the east corner of Main Street and Majors Avenue and runs along the property line on the north side of Majors Avenue in a westward direction. The district's northwestern boundary runs along the western boundary of property number 3, then crosses Majors Avenue and runs down the western boundary of property number 1. The district's boundary line then projects west along the northern boundary of property number 22, then turns in a southward direction on Elm Street before turning east at the corner of Main and Elm Streets. The district's western boundary ends along the western boundary of property number 23. The district then goes in an eastern direction along the property lines on the south side of Main Street and includes all four sides of the public square. The district's eastern boundary runs in an east-to-west direction from the southern boundary of property number 20 and terminates at the southwest corner of property number 18. The district's boundary line then turns south and follows the eastern boundary of property number 80, crosses Main Street, and then continues in a southward direction along the eastern boundary of property number 81 before terminating at the extreme southeast corner of said lot.

### Boundary Justification

The Lynchburg Historic District includes all the buildings in the downtown area that are centered along the courthouse square along with the surrounding residential area. These structures retain their integrity in building materials, use, and construction within the period of significance. The district consists of a variety of architectural styles and building types. All contributing resources represent various commercial and residential functions of the historic area within the period of significance. Excluded from the district are buildings which have been heavily altered or were constructed after the period of significance.

United States Department of the Interior  
National Park Service

# National Register of Historic Places Continuation Sheet

Section number PHOTOS Page 42

---

Lynchburg Historic District, Moore Co., TN

## PHOTOGRAPHS

Lynchburg Historic District  
Lynchburg, Moore Co., TN

Photos By: Carroll Van West and Brian Eades  
MTSU Center for Historic Preservation  
P.O. Box 80, MTSU  
Murfreesboro, Tennessee 37132

Negatives: Tennessee Historical Commission  
2941 Lebanon Road  
Nashville, Tennessee 37243

Date: October 1995

West side of square, looking west  
1 of 30

West side of square, looking north  
2 of 30

North side of square, looking west  
3 of 30

Detail, north side of square, looking north  
4 of 30

East side of square, looking east  
5 of 30

Southeast corner of square, looking southeast  
6 of 30



United States Department of the Interior  
National Park Service

National Register of Historic Places  
Continuation Sheet

Section number PHOTOS Page 44

---

Lynchburg Historic District, Moore Co., TN

Detail, Hinkle-Price House, Majors Avenue, looking north  
19 of 30

Majors Avenue, looking west  
20 of 30

Detail, Bean-West House, Majors Avenue, looking southwest  
21 of 30

East end of Main Street, looking west  
22 of 30

Detail, Moore County Jail, Main Street, looking south  
23 of 30

Main Street, looking east  
24 of 30

Main Street, looking east  
25 of 30

Main Street, looking east  
26 of 30

Main Street, looking east  
27 of 30

Wall Street, looking north  
28 of 30

Wall Street, looking southwest  
29 of 30

Corner of Wall Street and Majors Avenue, looking west  
30 of 30



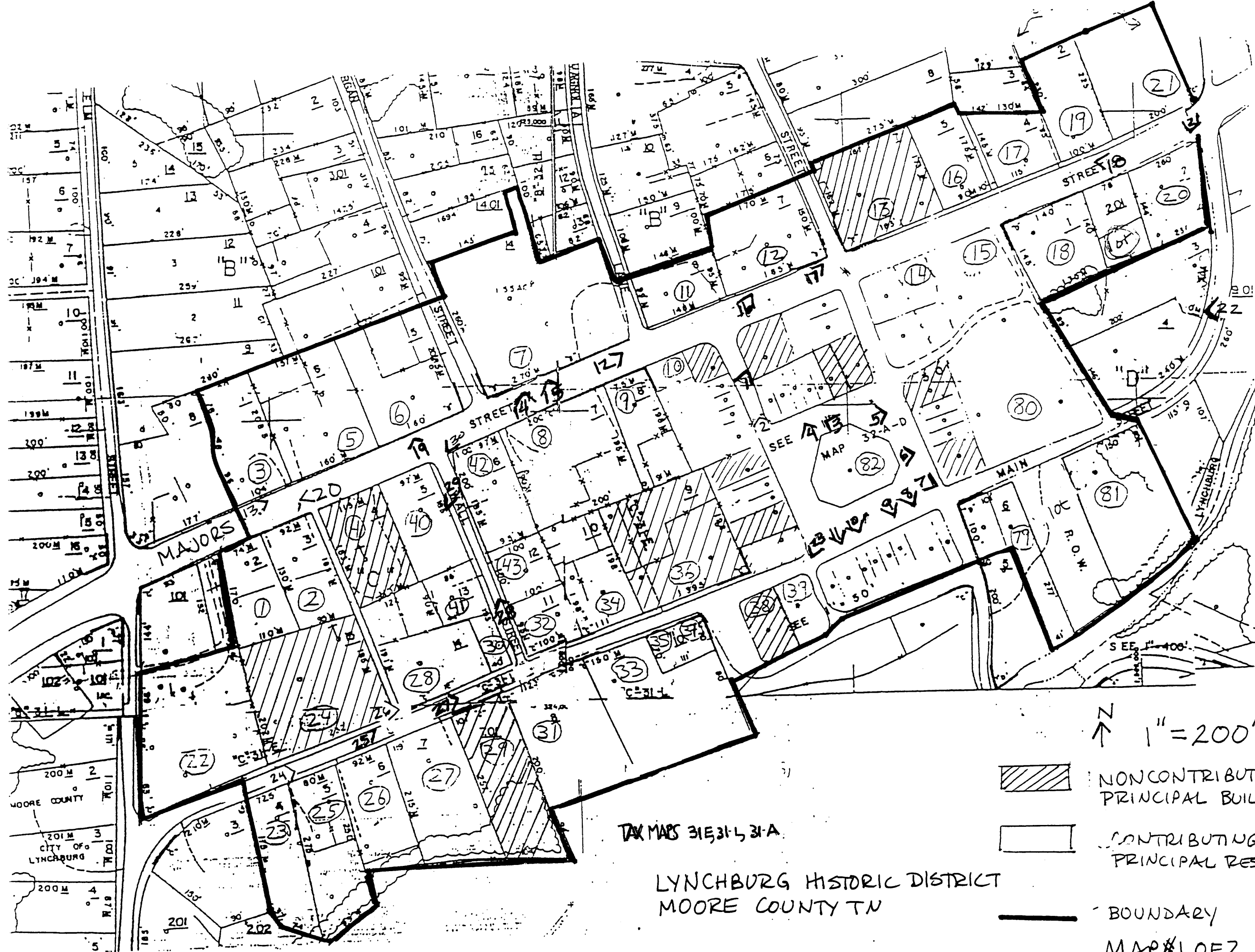



TAX MAPS 31E, 31-L, 31-A

LYNCHBURG HISTORIC DISTRICT  
MOORE COUNTY TN

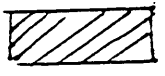
↑ N  
1" = 200'

-  NONCONTRIBUTING PRINCIPAL BUILDING
  -  CONTRIBUTING PRINCIPAL RESOURCE
  -  BOUNDARY
- MAP #1 OF 2

# LYNCHBURG HISTORIC DISTRICT MOORE COUNTY TN MAP # 2 OF 2

32-11

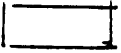

-  NON-CONTRIBUTING PRINCIPAL BUILDINGS
-  CONTRIBUTING PRINCIPAL BUILDINGS

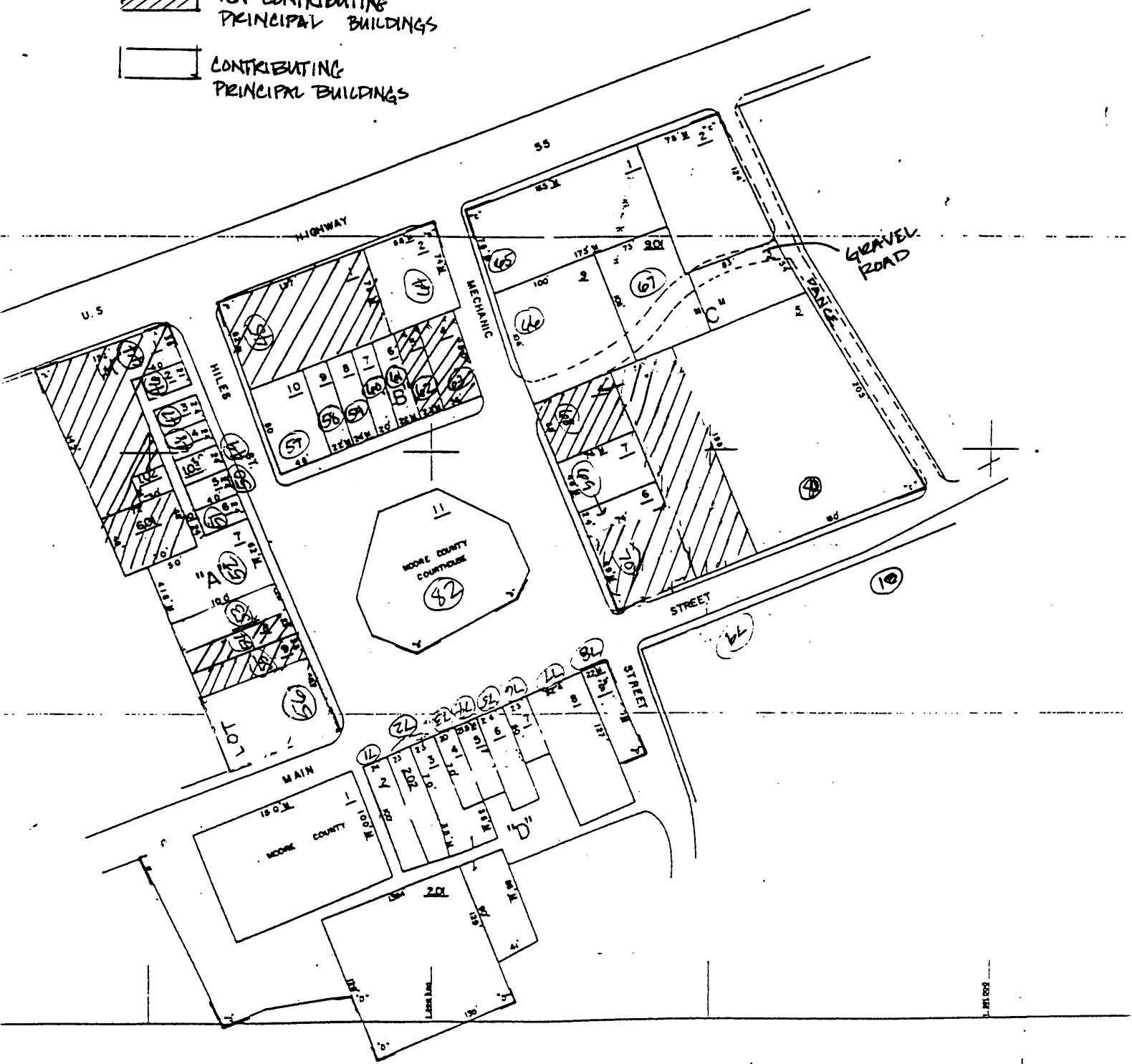

1. UNCLE SHANNON  
2. UNCLE SHANNON  
3. UNCLE SHANNON

4. UNCLE SHANNON  
5. UNCLE SHANNON  
6. UNCLE SHANNON

7. UNCLE SHANNON  
8. UNCLE SHANNON  
9. UNCLE SHANNON

10. UNCLE SHANNON  
11. UNCLE SHANNON  
12. UNCLE SHANNON

MOORE CO. (LYNCHBURG)  
TAX MAPS 32-H, 32 A-D