

NOV 26 1986 Substantive Review

KENTUCKY HISTORIC RESOURCES
Individual Inventory Form

Resource # BU-7
Bullitt County

1. Name of Resource:
Bank of the Commonwealth

2. Original Owner:
Abram Fields

3. Other Names:
"Old Stone Bank"

4. Prehistoric Site Building Object
Historic Site Structure Other

5. Location: west side Buckman Street
in Shepherdsville

6. Owner's Name:
Charles Hamilton & Burlyn Pike [p]

7. Owner's Address:
Route #5
Shepherdsville, Kentucky 40165

8. Evaluation: [G]

9. Recognition & Date:
Nat.Landmark Local Landmark
Nat.Register HABS/HAER
Highway Marker KY Inventory
KY Landmark Certificate

10. N.R.Status & Date:

11. N.R.Group:
District Name: []
Mult.Resource Area: []
Thematic Name: Early Stone Buildings []

12. Historical Theme:
Primary: Architecture [030]
Secondary: Banking [05B]
Other: []

13. Statement of Significance:
Good example of dry-stone construction used for a bank building. The two remaining early stone banks in Kentucky (this and GN-G-14) each have the main entrance in the gable end. This one has an unusually wide flat arch spanning a tripartite opening. []

14. History:
Built ca. 1809. Was said by General Henry Crist (U.S. Congressman 1804-1811) to have been the first bank in the state. Building was operated as a combined bank and store by Abram Fields, who was born in 1781.

15. Source of historical information and/or contact person: Wife of S.N.Brooks, descendant of Abram Fields (in Kentucky Heritage Council Files).

16. Date:
Original Building CA. 1809 [8]
Addition []

17. Style:
Federal [21]
[]

18. Architect/Builder:
Not Known

19. No. of Stories: One [1.0]

20. Original Floor Plan:
Shotgun [NA]

21. Single Pile Double Pile N.A.

22. Roof Form & Material: Original
Gable Not Original

23. Structural Material:
Stone [S]

24. Exterior Material:
Stone [S]

25. Foundation Material:
Stone [S]

26. Major Alterations:
Moved/Rebuilt Other
Additions

27. Special Features:

28. Outbuildings:
None [0]

29. Original Function:
Bank [02A]

30. Present Use:
Business [02A]

31. Condition: [G]

32. Endangered: Yes
No

33. Attach Photos:
Roll: 13 Photo Nos: 31-35 No. of Slides: X

34. Prepared by: Carolyn Murray-Wooley

35. Organization: Kentucky Heritage Council

36. Date: January 1984

37. New Survey Resurvey

KENTUCKY HISTORIC RESOURCES
Individual Inventory Form

Resource # BU-7

38. UTM Point of Primary Building: Quadrant: <u>Shepherdsville</u>	Zone <u>16</u>	Easting <u>612640</u>	Northing <u>4204940</u>	39. G.I.S. Mod. []	40. Coordi. Accuracy []
41. UTM Points of Boundary (for N. R. eligible sites only):					
A. -----				D. -----	
B. -----				E. -----	
C. -----				F. -----	
42. Total Acreage in Present Property:	43. Acreage included in proposed N.R. boundary: .17 acre				
44. Site Plan (and boundary description and justification for N.R. sites):					

See Attached

45. Description and House Plan:

One-story, single-cell, dry-stone building, 18 x 30 feet, with gable end entrance, and with one stone room added to west end, 18 x 24 feet. Masonry in regular courses of varying heights on front (east gable end) with 17-voussoir flat arch without keystone, and with skew backs, in center of wall, spanning two windows and one door in center. One window toward rear of room on north side; one door and window in south side, as unit, spanned by 11-voussoir flat arch with keystone and skew backs (filled in to size of one window). Masonry on side walls in broken courses. Interior chimney in west gable end. This section has pegged, beaded frames, trim missing; square wooden window sills; square corner stone door sills. Cellar window (closed) on north side of front door, spanned by six-voussoir flat arch.

Room added to rear (west) of similar construction, has one door, one window on each side, and interior chimney in west gable end. These frames are not beaded.

Interior refinished. Contains original vault with "S Spang and Sons" stamped into door.

Building located at sidewalk bordering the main street of town, one block north of the Salt River which runs through the town.

KENTUCKY HISTORIC RESOURCE INVENTORY SUPPLEMENT
BOUNDARY AND LOCATION INFORMATION

Historic Property Name Bank of Commonwealth Site # Bu-7

Multiple Resource/Thematic Nomination Title _____

U.T.M. Coordinates - List multiple UTM's if property is ten or more acres.

A. 16 612640 4204940 D. _____

B. _____ E. _____

C. _____ F. _____

Verbal Boundary Description Acreage .17 acre

Beginning at A, 25 ft N of the N.E. corner of the stone bank, at the curb of the street, thence with street 75 ft S to B, thence at right angle, N 100 ft to C, thence parallel to A-B, N 75 ft to D, thence parallel to B-C, E 100 ft to the beginning.

This is the present property line.

contributing building

Sketch of Site Plan (Showing outbuildings, structures, landscape features and the site boundary as described above.)

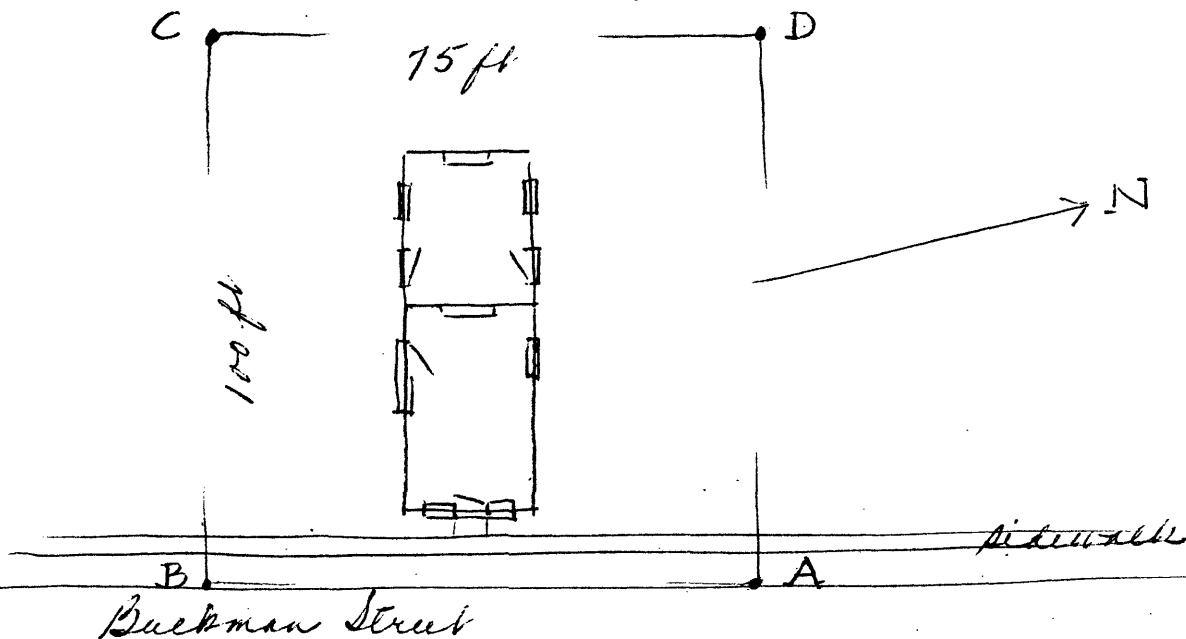

Official Courthouse Property Reference: