

UNITED STATES DEPARTMENT OF THE INTERIOR
NATIONAL PARK SERVICE

FOR NPS USE ONLY
RECEIVED NOV 3 1981
DATE ENTERED DEC 16 1981

**NATIONAL REGISTER OF HISTORIC PLACES
INVENTORY -- NOMINATION FORM**

SEE INSTRUCTIONS IN *HOW TO COMPLETE NATIONAL REGISTER FORMS*
TYPE ALL ENTRIES -- COMPLETE APPLICABLE SECTIONS

1 NAME

HISTORIC

Ernest Shelton Van Tassel *House* Residence

AND/OR COMMON

Nutridge

2 LOCATION

STREET & NUMBER

3280 Round Top Drive

__ NOT FOR PUBLICATION

CITY, TOWN

Honolulu

CONGRESSIONAL DISTRICT

__ VICINITY OF

first

STATE

Hawaii

CODE
15

COUNTY
Honolulu

CODE
03

3 CLASSIFICATION

CATEGORY

OWNERSHIP

STATUS

PRESENT USE

__DISTRICT

PUBLIC

__OCCUPIED

__AGRICULTURE

__MUSEUM

BUILDING(S)

__PRIVATE

UNOCCUPIED

__COMMERCIAL

__PARK

__STRUCTURE

__BOTH

__WORK IN PROGRESS

__EDUCATIONAL

PRIVATE RESIDENCE

__SITE

PUBLIC ACQUISITION

ACCESSIBLE

__ENTERTAINMENT

__RELIGIOUS

__OBJECT

__IN PROCESS

YES: RESTRICTED

__GOVERNMENT

__SCIENTIFIC

__BEING CONSIDERED

__YES: UNRESTRICTED

__INDUSTRIAL

__TRANSPORTATION

__NO

__MILITARY

__OTHER

4 OWNER OF PROPERTY

NAME

State of Hawaii, Department of Land and Natural Resources

STREET & NUMBER

1151 Punchbowl Street

CITY, TOWN

Honolulu

__ VICINITY OF

STATE

Hawaii

5 LOCATION OF LEGAL DESCRIPTION

COURTHOUSE,
REGISTRY OF DEEDS, ETC.

Bureau of Conveyances

STREET & NUMBER

1151 Punchbowl Street

CITY, TOWN

Honolulu

STATE

Hawaii

6 REPRESENTATION IN EXISTING SURVEYS

TITLE

Hawaii Register of Historic Places

DATE

1981

__FEDERAL STATE __COUNTY __LOCAL

DEPOSITORY FOR
SURVEY RECORDS

Department of Land and Natural Resources

CITY, TOWN

Honolulu

STATE

Hawaii

7 DESCRIPTION

| CONDITION | | CHECK ONE | CHECK ONE |
|--|---------------------------------------|---|---|
| <input type="checkbox"/> EXCELLENT | <input type="checkbox"/> DETERIORATED | <input checked="" type="checkbox"/> UNALTERED | <input checked="" type="checkbox"/> ORIGINAL SITE |
| <input type="checkbox"/> GOOD | <input type="checkbox"/> RUINS | <input type="checkbox"/> ALTERED | <input type="checkbox"/> MOVED DATE _____ |
| <input checked="" type="checkbox"/> FAIR | <input type="checkbox"/> UNEXPOSED | | |

DESCRIBE THE PRESENT AND ORIGINAL (IF KNOWN) PHYSICAL APPEARANCE

Located on the Ewa (west) side of the saddle between the two hills, Puu Ualakaa and Puu Kakea, Nutridge sits on a knoll commanding a majestic view of Honolulu and the ocean. The house is a long, horizontal shingled structure which takes advantage of the vista afforded by the site. A local adaptation of the colonial style, it features an outset living room bay with a picture window and a gabled roof with returns. Double-pitched hipped roofed wings extend from either side of the living room bay.

The Diamond Head (east) wing extends from the living room's entry hall, and is dominated by a flat roofed lanai (porch) with three bays, two of which are enclosed by sliding glass doors. Two bedrooms, both of which have doors opening onto the lanai (porch), with a tiled bathroom and a dressing room between them, are contained within this wing. The wing terminates with a single car garage.

The Ewa (west) wing contains a dining area, pantry, kitchen, utility room, and maid's quarters. Two sets of French doors open out from the living room and the dining area. The kitchen and dining room each contain casement windows and the utility area is ventilated with sliding windows. All rear windows are 6 x 6 and 6 x 9 double hung sash, except for the kitchen, pantry and bathroom casement windows of six panes. The original interior is intact and includes built-in cabinets in the dressing room and a lofty open-beamed ceiling, chandeliers and fireplace in the living room.

The nomination includes the entire twenty-two acre plantation parcel, most of which originally contained macadamia nut groves. These groves have not been tended and in many areas trees have died off. Brush and other trees have grown up in the groves; however, the original terracing and a number of the trees remain. Several plantation worker cottages and a "flume" which was used in the harvesting of the nuts, remain on the property in deteriorated condition. The caretaker's cottage, a modest single story, frame, hipped roof, single-wall structure, also stands on the property and is still occupied.

8 SIGNIFICANCE

| PERIOD | AREAS OF SIGNIFICANCE -- CHECK AND JUSTIFY BELOW | | | |
|----------------|--|---------------------------|---------------------------|------------------------|
| ___PREHISTORIC | ___ARCHEOLOGY-PREHISTORIC | ___COMMUNITY PLANNING | ___LANDSCAPE ARCHITECTURE | ___RELIGION |
| ___1400-1499 | ___ARCHEOLOGY-HISTORIC | ___CONSERVATION | ___LAW | ___SCIENCE |
| ___1500-1599 | X_AGRICULTURE | ___ECONOMICS | ___LITERATURE | ___SCULPTURE |
| ___1600-1699 | X_ARCHITECTURE | ___EDUCATION | ___MILITARY | ___SOCIAL/HUMANITARIAN |
| ___1700-1799 | ___ART | ___ENGINEERING | ___MUSIC | ___THEATER |
| ___1800-1899 | ___COMMERCE | ___EXPLORATION/SETTLEMENT | ___PHILOSOPHY | ___TRANSPORTATION |
| X_1900- | ___COMMUNICATIONS | X_INDUSTRY | ___POLITICS/GOVERNMENT | ___OTHER (SPECIFY) |
| | | ___INVENTION | | |

SPECIFIC DATES 1922

BUILDER/ARCHITECT Hart Wood

STATEMENT OF SIGNIFICANCE

Nutridge is significant for its associations with the commencement of the macadamia nut industry in Hawaii. This was the initial plantation on Oahu of E. S. Van Tassel, the president and founder of the Hawaiian Macadamia Nut Company, which pioneered the commercial growing of macadamia nuts on the planet earth.

The macadamia nut, a native of Australia, was introduced to Hawaii in the early 1890's at the residence of E. W. Jordan in Nuuanu valley. Brought in "solely as an addition to the natural beauty of Paradise,"¹ it was not until E. S. Van Tassel started some plantings at Nutridge in 1921 that the commercial growing of the plant began. On June 1, 1922, the Hawaiian Macadamia Nut Company Ltd. was formed. Besides its plantation on Oahu the company also started another at Keauhou, Kona, Hawaii, which eventually proved to be more successful. In 1927, the Territory of Hawaii granted Mr. Van Tassel a fifty year lease on Nutridge. This plantation remained in operation until the nineteen seventies and discontinued when the Honolulu processing plant suspended operations.

In 1925, Mr. Van Tassel commissioned architect Hart Wood to design his residence at Nutridge. The house is architecturally significant as a good example of Hart Wood's residential work of this period. Wood was at the forefront of the movement to create a style of architecture in Hawaii which would appropriately reflect a sense of place, and the Van Tassel residence discloses one solution to this problem. The house evidences a sensitive handling of the building in relationship to its site, neither dominating nor being dominated by the location. One story high, and presenting a horizontal facade, broken by the vertical plane of the living room the house takes advantage of the site's magnificent vistas. Although employing a few colonial motifs, the house is essentially devoid of ornate embellishment and follows an extremely original layout with the lanai (porch) serving in the capacity of a hallway, providing direct access to the bedrooms. Such an arrangement accentuates the sense of outdoor living. Also by placing the rooms in a serial manner, the architect provided each room with cross-ventilation taking advantage of the trade winds. The dwelling's double-pitched hipped roof would become a common feature in the evolving "Hawaiian style" of architecture, and adds to the building's low profile.

¹ Hawaiian Annual, 1940, page 98.

9 MAJOR BIBLIOGRAPHICAL REFERENCES

Betty MacDonald, "A Hard Nut to Crack," Paradise of the Pacific, Dec. 1940
 "Widening Our Industries, Macadamia Nut Culture," Hawaiian Annual, 1928
 Copy of the original architectural specifications for Nutridge
 "Important Agricultural Products," Hawaiian Annual, 1940

10 GEOGRAPHICAL DATA

ACREAGE OF NOMINATED PROPERTY 22.06
 UTM REFERENCES

A | 0,4 | 6,2,2 | 1,0,0 | 2,3 | 5,8 | 1,2,0 |
 ZONE EASTING NORTHING
 C | 0,4 | 6,2,1 | 7,0,0 | 2,3 | 5,7 | 6,7,0 |

B | 0,4 | 6,2,2 | 0,9,0 | 2,3 | 5,7 | 9,2,0 |
 ZONE EASTING NORTHING
 D | 0,4 | 6,2,1 | 6,8,0 | 2,3 | 5,7 | 8,7,0 |

VERBAL BOUNDARY DESCRIPTION

This nomination includes the property described by tax map key 2-5-19-4 in 1981.

LIST ALL STATES AND COUNTIES FOR PROPERTIES OVERLAPPING STATE OR COUNTY BOUNDARIES

| STATE | CODE | COUNTY | CODE |
|-------|------|--------|------|
| STATE | CODE | COUNTY | CODE |

11 FORM PREPARED BY

NAME / TITLE

Don Hibbard, Architectural Historian and Nathan Napoka, Historian

ORGANIZATION

Department of Land and Natural Resources

DATE

March 31, 1981

STREET & NUMBER

1151 Punchbowl Street

TELEPHONE

548-7460

CITY OR TOWN

Honolulu

STATE

Hawaii

12 STATE HISTORIC PRESERVATION OFFICER CERTIFICATION

THE EVALUATED SIGNIFICANCE OF THIS PROPERTY WITHIN THE STATE IS:

NATIONAL

STATE

LOCAL

As the designated State Historic Preservation Officer for the National Historic Preservation Act of 1966 (Public Law 89-665), I hereby nominate this property for inclusion in the National Register and certify that it has been evaluated according to the criteria and procedures set forth by the National Park Service.

STATE HISTORIC PRESERVATION OFFICER SIGNATURE

TITLE

DATE

11/26/81

FOR NPS USE ONLY

I HEREBY CERTIFY THAT THIS PROPERTY IS INCLUDED IN THE NATIONAL REGISTER

DIRECTOR, OFFICE OF ARCHEOLOGY AND HISTORIC PRESERVATION

DATE

12/16/81

ATTEST

KEEPER ON THE NATIONAL REGISTER

KEEPER OF THE NATIONAL REGISTER

DATE

12/9/81

PAUOA
SECTION 2

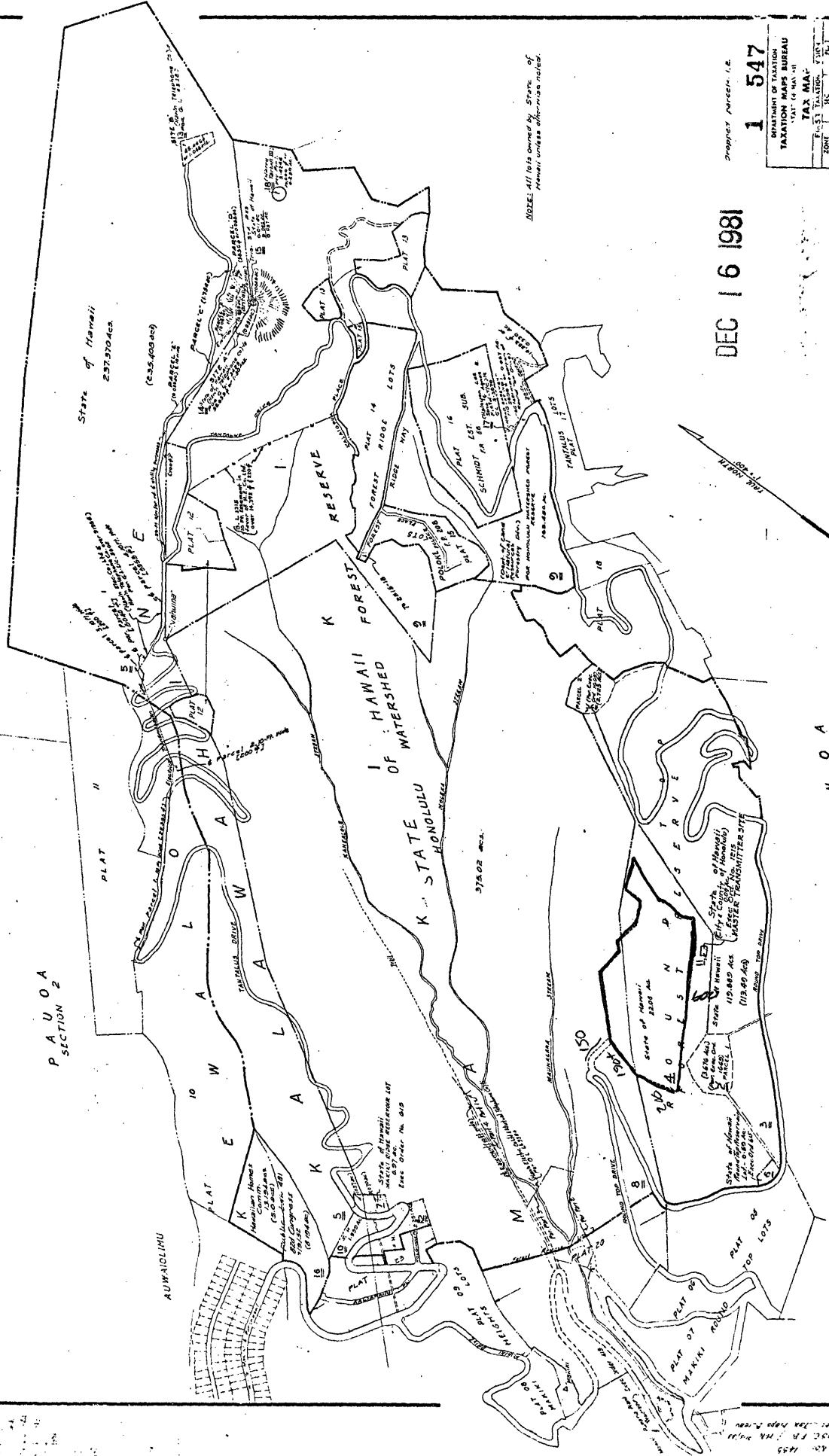

DEC 16 1981

1 547

| | |
|-----------------------|----------|
| STATEMENT OF TAXATION | |
| TAXATION MAPS BUREAU | |
| TAX MAP | |
| PLAT NO. | 1547 |
| SECTION | 19 |
| DATE | 12/16/81 |

FOR REAL PROPERTY TAXATION PURPOSES
SUBJECT TO CHANGE

MAKIKI & TANTALUS, OAHU (HONOLULU WATERSHED FOREST RESERVE)

NOTE: All lots owned by State of Hawaii unless otherwise noted.

Property Owner, i.e.

Map No. 1455
By D.C. FR. H.K. HULL
Surveyed from maps on file