

UNITED STATES DEPARTMENT OF THE INTERIOR  
Heritage Conservation and Recreation Service

NATIONAL REGISTER OF HISTORIC PLACES INVENTORY  
NOMINATION FORM

Continuation Sheet

Item Number

Page

<u>Name</u> Historic:		Location: Along - sections of Vincent Street and Crosson Street .
Common:	Vincent Street Historic District	Classification: District
<u>Owner:</u>	Multiple Ownership (see continuation sheet)	

Representation in Existing Surveys      Inventory of Historic Places in South Carolina  
(1979 update)

Description: The Vincent Street Historic District is a small but compact collection of late nineteenth and early twentieth century residences. Among the most notable buildings are the twin raised cottages at 1706 and 1700 Vincent Street and the Greek Revival dwelling at 1615 Vincent Street.

Significance: The Vincent Street Historic District is significant as a cohesive collection of late nineteenth and early twentieth residences exemplary of domestic vernacular building modes prevalent in Newberry. Its tree shaded lots add to the quiet, residential character of the district.

Acreage approximately 2.6

Verbal Boundary Description: The boundary of the Vincent Street Historic District nomination is shown as the heavy black line on the accompanying map entitled "Vincent Street Historic District" and drawn at a scale of one inch to 200 feet.

<u>UTM Reference Point</u>	A. 17/442358/3792660	B. 17/442299/3792580
	C. 17/442122/3792730	D. 17/442181/3792820

Other Information

OCT 21 1980

**United States Department of the Interior  
Heritage Conservation and Recreation Service**

**National Register of Historic Places  
Inventory—Nomination Form**



Continuation sheet

Item number

Page

Key properties contributing to the character of the historic district:

- V-1. 1706 Vincent Street. The Stephenson Cottage. Built ca. 1875, this Victorian raised cottage is a square, weatherboarded dwelling of one story above a brick basement. The hip roof, the eaves brackets, and the central doorway with its multi-paned transom and sidelights are prominent original features. Although the original projecting front porch has been replaced by a full width modern porch, the basic integrity of the decorated cottage remains.
- V-2. 1700 Vincent Street. The Livingston Cottage. This is a Victorian raised cottage, built ca. 1875, of one story on a raised brick basement. The residence is frame, weatherboarded, with a raised seam metal roof. A projecting central porch, under a hip roof, shields a double doorway on the main floor. The doorway is framed by sidelights and a transom. A balustrade with turned balusters connects the square wooden porch posts. Both the porch and the house eaves are bracketed. Entrance to the main floor is via the basement; there is no stairway to the front porch.
- V-6. 1611 Vincent Street. A two-story frame vernacular residence, demonstrating, in its asymmetry, balustrades, and spindle friezes, the importance of the carpenter in Victorian decoration. The house has an L-shaped plan, with a two-tiered veranda in the crook of the L. Cross gables accentuate the location of the doorways on both levels of the veranda. The house was built ca. 1900.

Other properties contributing to the character of the district:

- V-3. 1618 Vincent Street. A one-story frame residence, sheathed in weatherboard, with an irregular plan and a multi-gabled roof. Two interior brick chimneys mark the junctions of the major roof gables.
- V-5. 1615 Vincent Street. A one-story brick cottage, with a projecting entrance portico, supported by square wooden pillars. The central entrance is framed by sidelights and transom. Tripartite windows on either side of the entrance have shutters that cover only the lateral window elements. The building is currently in poor condition.
- V-7. 1603 Vincent Street. A one-story frame residence, sheathed in weatherboard, with an irregular plan, and one roof gable extending over a polygonal bay. A porch is located in an angle of the house.
- V-8. 831 Crosson Street. A one and one-half story frame residence, sheathed in weatherboard, with a central hall plan. A cross gable dormer is centered above the entrance. The house and its hip roofed porch have standing seam metal roofs. The house was built ca. 1900.

Noncontributing properties:

- V-4. 1621 Vincent Street. A one-story brick veneer ranch house, with a carport, built ca. 1960.

**United States Department of the Interior  
Heritage Conservation and Recreation Service**

**National Register of Historic Places  
Inventory—Nomination Form**



Continuation sheet

Item number

Page

Vincent Street Historic District Property Owners:

Frank J. Toland  
Box 873  
Tuskegee Institute, Ala. 36088

Carrie Lee Ruff  
Wallace Ruff  
1700 Vincent  
Newberry, S. C. 29108

Marquis D. Singleton, et al.  
G. W. Singleton, Jr.  
2221 Emory St.  
Newberry, S.C. 29108

Gevenell J. Pratt  
831 Crosson St.  
Newberry, S. C. 29108

Henry M. Sligh  
1621 Vincent St.  
Newberry, S. C. 29108

Estate of Ralph T. Williams  
c/o Marjah Mazyeh, Adm. & Richard E. Fields  
655 Spring St.  
Charleston, S. C. 29403

Mary Singley  
1611 Vincent St.  
Newberry, S. C. 29018

Thomas Louis Boyd  
230 W. 131 St.  
New York, N. Y. 10027

VINCENT STREET  
HISTORIC DISTRICT  
Newberry, South Carolina  
Scale 1" = 200'

SUMMER BROTHERS STORE  
Newberry, South Carolina  
Scale 1" = 200'

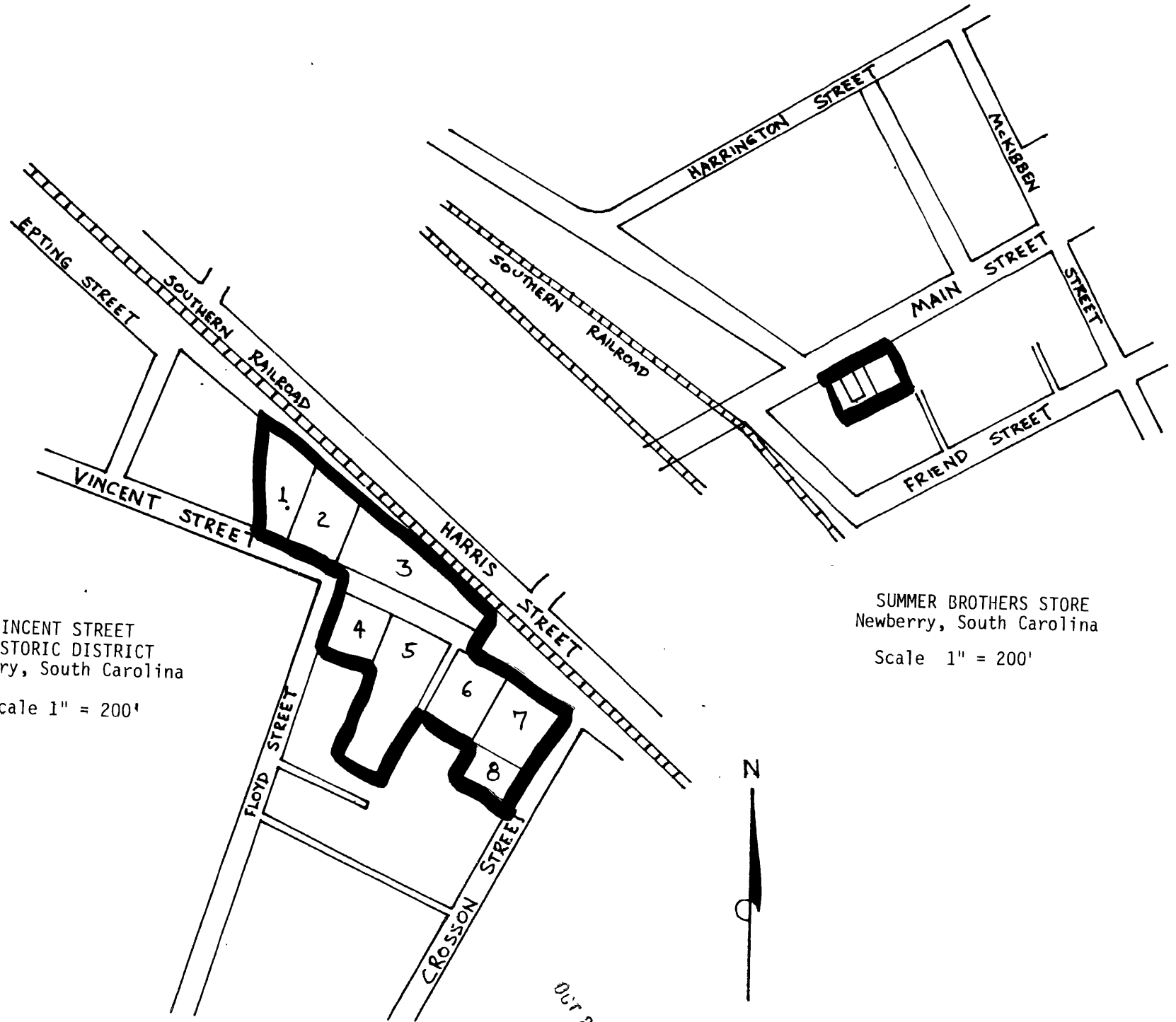

OCT 2