

United States Department of the Interior
National Park Service

National Register of Historic Places
Inventory—Nomination Form

For NPS use only
received **JL 20** 1983
date entered

See instructions in *How to Complete National Register Forms*
Type all entries—complete applicable sections

1. Name

historic Marigold Building

and/or common

2. Location

street & number 94-837 Waipahu Street not for publication

city, town Waipahu vicinity of ~~Congressional District~~

state Hawaii code 15 county Honolulu code 03

3. Classification

Category	Ownership	Status	Present Use
<input type="checkbox"/> district	<input type="checkbox"/> public	<input type="checkbox"/> occupied	<input type="checkbox"/> agriculture
<input checked="" type="checkbox"/> building(s)	<input checked="" type="checkbox"/> private	<input checked="" type="checkbox"/> unoccupied	<input checked="" type="checkbox"/> commercial
<input type="checkbox"/> structure	<input type="checkbox"/> both	<input type="checkbox"/> work in progress	<input type="checkbox"/> educational
<input type="checkbox"/> site	Public Acquisition	Accessible	<input type="checkbox"/> entertainment
<input type="checkbox"/> object	<input type="checkbox"/> in process	<input type="checkbox"/> yes: restricted	<input type="checkbox"/> government
	<input type="checkbox"/> being considered	<input checked="" type="checkbox"/> yes: unrestricted	<input type="checkbox"/> industrial
	N/A	<input type="checkbox"/> no	<input type="checkbox"/> military
			<input type="checkbox"/> museum
			<input type="checkbox"/> park
			<input type="checkbox"/> private residence
			<input type="checkbox"/> religious
			<input type="checkbox"/> scientific
			<input type="checkbox"/> transportation
			<input type="checkbox"/> other:

4. Owner of Property

name Cris Bartolome

street & number 94-371C Ana Lane

city, town Waipahu vicinity of state Hawaii

5. Location of Legal Description

courthouse, registry of deeds, etc. Bureau of Conveyances

street & number 1151 Punchbowl Street

city, town Honolulu state Hawaii

6. Representation in Existing Surveys

title State Historic Sites Inventory has this property been determined eligible? yes no

date 1970 federal state county local

depository for survey records Department of Land and Natural Resources

city, town Honolulu state Hawaii

7. Description

Condition

excellent

good

fair

deteriorated

ruins

unexposed

Check one

unaltered

altered

Check one

original site

moved date _____

Describe the present and original (if known) physical appearance

The Marigold Building is a two-story, single wall construction building with a lateral running gable roof. The original building was rectangular in shape, five bays wide and two bays deep. The Seabees built an irregularly shaped, five-sided, shed roofed addition to the rear during World War II, when the building served as a U.S.O. club. This addition served as a dance hall, and is approximately four feet below the grade of the original building.

A porch with a concrete floor extends the length of the facade. On the first floor each bay contains two 1 x 1 double-hung sash windows, with the exception of the central bay which has a double door entry. On the second floor each bay has only one window, similar to those on the first floor. These windows are enhanced with planter boxes with three figure four brackets serving as consoles. These boxes are further embellished with simple X patterns in the side and two front panels. The sides of the building have no windows on the first floor, but have two windows on the second, and a ventilator in the gable. The building terminates with an overhanging gable roof.

The interior of the building has been greatly altered by a succession of owners over the past thirty years. The second floor is divided into sleeping quarters. Originally a set of interior stairs provided access to the second floor but these are gone, supplanted by an exterior set of steps, which was a later addition to the west side.

The building rests on posts and concrete footings. Because of differential settling, the building is currently in poor condition and requires attention. The current owner intends to rehabilitate this building.

There have been no major exterior alterations to the original building and the only additions were the side steps and the dance hall at the rear.

8. Significance

Period	Areas of Significance—Check and justify below			
<input type="checkbox"/> prehistoric	<input type="checkbox"/> archeology-prehistoric	<input type="checkbox"/> community planning	<input type="checkbox"/> landscape architecture	<input type="checkbox"/> religion
<input type="checkbox"/> 1400-1499	<input type="checkbox"/> archeology-historic	<input type="checkbox"/> conservation	<input type="checkbox"/> law	<input type="checkbox"/> science
<input type="checkbox"/> 1500-1599	<input type="checkbox"/> agriculture	<input type="checkbox"/> economics	<input type="checkbox"/> literature	<input type="checkbox"/> sculpture
<input type="checkbox"/> 1600-1699	<input checked="" type="checkbox"/> architecture	<input type="checkbox"/> education	<input type="checkbox"/> military	<input type="checkbox"/> social/ humanitarian
<input type="checkbox"/> 1700-1799	<input type="checkbox"/> art	<input type="checkbox"/> engineering	<input type="checkbox"/> music	<input type="checkbox"/> theater
<input checked="" type="checkbox"/> 1800-1899	<input type="checkbox"/> commerce	<input checked="" type="checkbox"/> exploration/settlement	<input type="checkbox"/> philosophy	<input type="checkbox"/> transportation
<input type="checkbox"/> 1900-	<input type="checkbox"/> communications	<input type="checkbox"/> industry	<input type="checkbox"/> politics/government	<input type="checkbox"/> other (specify)
		<input type="checkbox"/> invention		

Specific dates c. 1898 **Builder/Architect** Unknown

Statement of Significance (in one paragraph)

The Marigold building is historically significant for its associations with the development of Waipahu by the Oahu Sugar Company. The Oahu Sugar Company was incorporated in 1896 and established a mill in Waipahu shortly thereafter. This building was one of the earliest structures built in the town, and served as a medical dispensary for the area until c. 1920 when a hospital was constructed. The building then was converted into a Y.M.C.A. and as such was a major hub for social life in the community. Later this building was converted into a rooming house and bar. Presently the building is unoccupied, but the current owner intends to rehabilitate it and use it for commercial purposes.

Modern Waipahu was developed as a sugar plantation town, and its relationship with Oahu Sugar Company still remains strong as the company's main office and mill still are in operation in the town.

The building is also significant as a major building in Waipahu to employ single wall construction. This method of building has been popular in the Islands throughout the late nineteenth and twentieth centuries, and is frequently associated with plantation architecture. Because of the vulnerability of frame construction to termites and Hawaii's climate, the number of buildings in this style is rapidly dwindling.

9. Major Bibliographical References

Old Honolulu A Guide to Oahu's Historic Buildings (Honolulu, 1969) item 79
Oahu Sugar Plantation Records
Historic Buildings Task Force Inventory Form

10. Geographical Data

Acreeage of nominated property less than half an acre
Quadrangle name Waipahu Quadrangle scale 1:24000

UMT References

A	<u>04</u>	<u>602590</u>	<u>2365500</u>	B	<u> </u>	<u> </u>	<u> </u>
	Zone	Easting	Northing		Zone	Easting	Northing
C	<u> </u>	<u> </u>	<u> </u>	D	<u> </u>	<u> </u>	<u> </u>
E	<u> </u>	<u> </u>	<u> </u>	F	<u> </u>	<u> </u>	<u> </u>
G	<u> </u>	<u> </u>	<u> </u>	H	<u> </u>	<u> </u>	<u> </u>

Verbal boundary description and justification

This nomination includes all the property designated by Tax Map Key 9-4-13:17 in 1983.

List all states and counties for properties overliapping state or county boundaries

state	code	county	code

11. Form Prepared By

name/title Cris Bartolome

organization _____ date April 1983

street & number 94-371C Ana Lane telephone (808) 671-1682

city or town Waipahu state Hawaii

12. State Historic Preservation Officer Certification

The evaluated significance of this property within the state is:

national state local

As the designated State Historic Preservation Officer for the National Historic Preservation Act of 1966 (Public Law 89-665), I hereby nominate this property for inclusion in the National Register and certify that it has been evaluated according to the criteria and procedures set forth by the National Park Service.

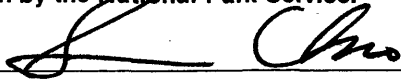
State Historic Preservation Officer signature 

title _____ date JUL 15 1983

For NPS use only

I hereby certify that this property is included in the National Register

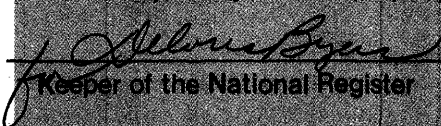
 Keeper of the National Register

date 8/18/83

Attest: _____ date _____

Chief of Registration

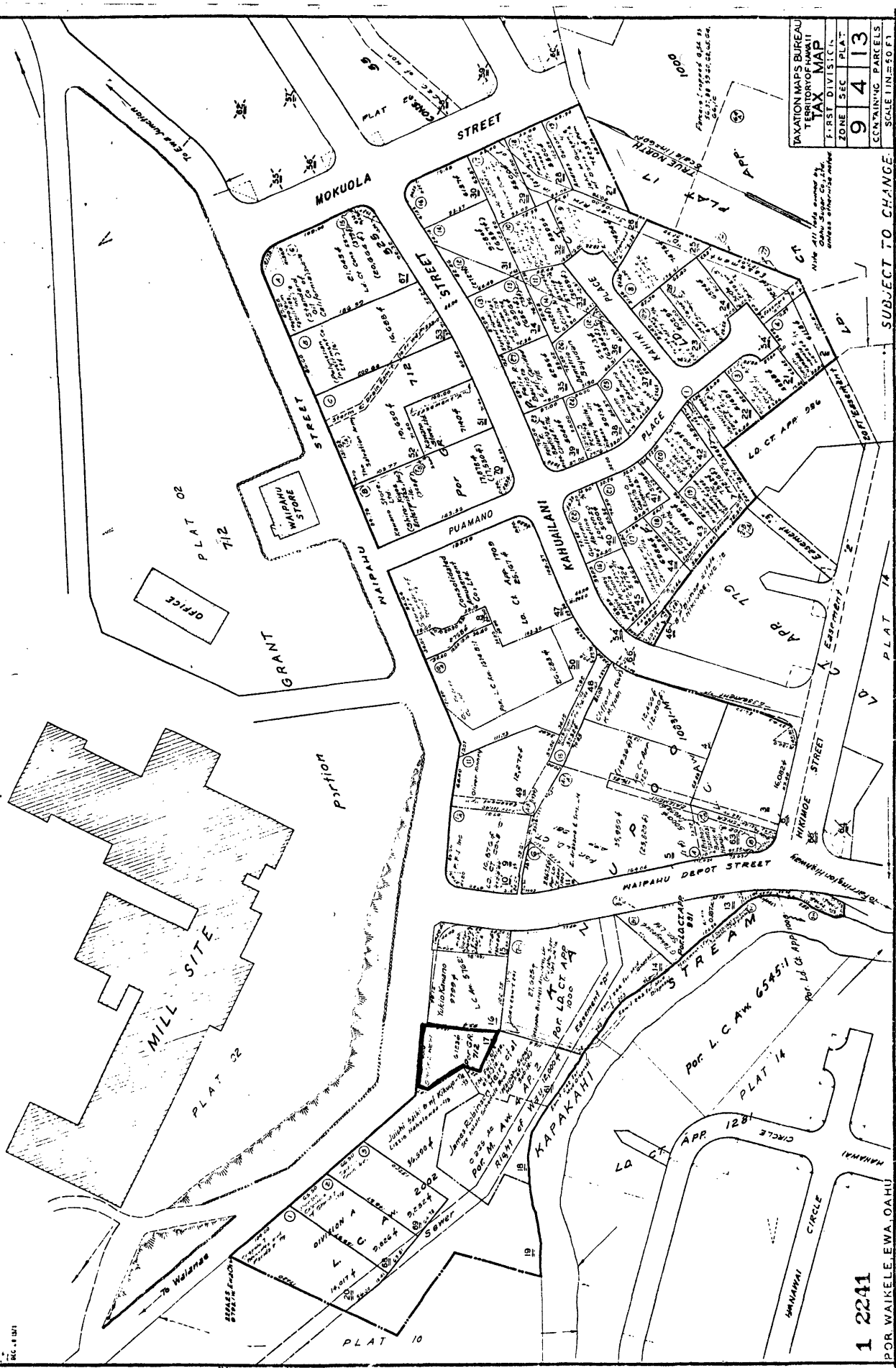

TAXATION MAPS BUREAU			
TERRITORY OF HAWAII			
TAX MAP			
ZONE	SEC	PLAT	PARCELS
9	4	13	
			CONTAINING PARCELS
			SCALE 1 IN = 50 FT

SUBJECT TO CHANGE

1 2241

POR. WAIKELE, EWA, OAHU