

**NATIONAL REGISTER OF HISTORIC PLACES
INVENTORY - NOMINATION FORM**

(Type all entries - complete applicable sections)

STATE:
North Dakota

COUNTY:
Billings

FOR NPS USE ONLY

ENTRY DATE
FEB 18 1975

1. NAME

COMMON:
de Mores Packing Plant *Rearings*

AND/OR HISTORIC:

2. LOCATION

STREET AND NUMBER:
**NE 1/4 • NE 1/4 • section 27,
200 yards northwest of Medora *County* T. 140N. ; R. 102 W.**

CITY OR TOWN:
Medora *Wis.*

CONGRESSIONAL DISTRICT:
1

STATE: **North Dakota** CODE: **38** COUNTY: **Billings** CODE: **007**

3. CLASSIFICATION

| CATEGORY (Check One) | OWNERSHIP | STATUS | ACCESSIBLE TO THE PUBLIC |
|---|--|---|---|
| <input type="checkbox"/> District <input type="checkbox"/> Building <input checked="" type="checkbox"/> Site <input type="checkbox"/> Structure <input type="checkbox"/> Object | <input checked="" type="checkbox"/> Public <input type="checkbox"/> Private <input type="checkbox"/> Both | Public Acquisition: <input type="checkbox"/> In Process <input type="checkbox"/> Being Considered | <input type="checkbox"/> Occupied <input checked="" type="checkbox"/> Unoccupied <input type="checkbox"/> Preservation work in progress |
| PRESENT USE (Check One or More as Appropriate) | | | |
| <input type="checkbox"/> Agricultural <input type="checkbox"/> Commercial <input type="checkbox"/> Educational <input type="checkbox"/> Entertainment | <input type="checkbox"/> Government <input type="checkbox"/> Industrial <input type="checkbox"/> Military <input type="checkbox"/> Museum | <input checked="" type="checkbox"/> Park <input type="checkbox"/> Private Residence <input type="checkbox"/> Religious <input type="checkbox"/> Scientific | <input type="checkbox"/> Transportation <input checked="" type="checkbox"/> Other (Specify) Public Historic Site |

4. OWNER OF PROPERTY

OWNER'S NAME:
State Historical Society of North Dakota

STREET AND NUMBER:
Liberty Memorial Building

CITY OR TOWN:
Bismarck

STATE:
North Dakota CODE: **38**

5. LOCATION OF LEGAL DESCRIPTION

COURTHOUSE, REGISTRY OF DEEDS, ETC.:
Register of Deeds, Billings County

STREET AND NUMBER:
Billings County Court House

CITY OR TOWN:
Medora

STATE:
North Dakota CODE: **38**

6. REPRESENTATION IN EXISTING SURVEYS

TITLE OF SURVEY:
State Historic Site Registry; North Dakota Century Code 55-10-03

DATE OF SURVEY: **1967** Federal State County Local

DEPOSITORY FOR SURVEY RECORDS:
State Historical Society of North Dakota

STREET AND NUMBER:
Liberty Memorial Building

CITY OR TOWN:
Bismarck

STATE:
North Dakota CODE: **38**

SEE INSTRUCTIONS

STATE: **North Dakota**

COUNTY: **Billings**

ENTRY NUMBER: **FEB 18 1975**

DATE: **FEB 18 1975**

FOR NPS USE ONLY

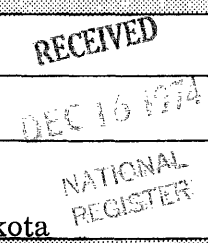

7 DESCRIPTION

CONDITION

(Check One)

Excellent Good Fair Deteriorated Ruins Unexposed

(Check One)

Altered Unaltered

(Check One)

Moved Original Site

DESCRIBE THE PRESENT AND ORIGINAL (if known) PHYSICAL APPEARANCE

The DeMores packing plant was completed and began operation in 1883 at Medora, Dakota Territory. It was constructed near the east bank of the Little Missouri River on the west edge of the town which the Marquis de Mores also built.

When the plant facilities were completed, its processing capacity was 150 beeves per day. The abattoir was a large frame building 105 feet by 180 feet. Included in the slaughter house was a power house measuring 30 feet by 40 feet, a cooper shop 25 feet by 30 feet, and a fertilizer room 30 feet by 38 feet. Three ice houses 40 feet by 100 feet were also constructed adjacent to the plant. A cooling and storage building, loading platform and cattle holding pens completed the plants facilities.

Closed in 1886, the de Mores packing plant was destroyed by fire March 17, 1907. All that remained when the property was acquired by the State Historical Society in 1936 were the tall, native brick chimney, sandstone and brick foundations which supported the main part of the slaughtering house, cement foundation with bolts for engine mountings in the power house, and an old boiler. During a WPA project in the late 1930's markers were placed at points describing the foundation corners of the various buildings included in the packing plant. Repairs were also made to the crumbled portions of the abattoir foundation and the chimney. During the summer of 1970 more repair work was done to the chimney as crumbling bricks on the structure were replaced and the top was capped.

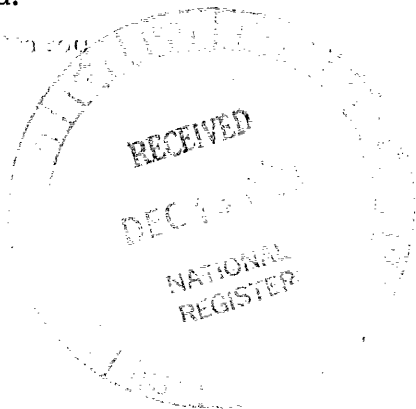

SEE INSTRUCTIONS

SIGNIFICANCE

PERIOD (Check One or More as Appropriate)

- | | | | |
|--|---------------------------------------|--|---------------------------------------|
| <input type="checkbox"/> Pre-Columbian | <input type="checkbox"/> 16th Century | <input type="checkbox"/> 18th Century | <input type="checkbox"/> 20th Century |
| <input type="checkbox"/> 15th Century | <input type="checkbox"/> 17th Century | <input checked="" type="checkbox"/> 19th Century | |

SPECIFIC DATE(S) (If Applicable and Known)

AREAS OF SIGNIFICANCE (Check One or More as Appropriate)

- | | | | |
|---|---|--|--|
| <input type="checkbox"/> Aboriginal | <input type="checkbox"/> Education | <input type="checkbox"/> Political | <input type="checkbox"/> Urban Planning |
| <input type="checkbox"/> Prehistoric | <input type="checkbox"/> Engineering | <input type="checkbox"/> Religion/Philosophy | <input type="checkbox"/> Other (Specify) |
| <input type="checkbox"/> Historic | <input type="checkbox"/> Industry | <input type="checkbox"/> Science | _____ |
| <input checked="" type="checkbox"/> Agriculture | <input type="checkbox"/> Invention | <input type="checkbox"/> Sculpture | _____ |
| <input type="checkbox"/> Architecture | <input type="checkbox"/> Landscape Architecture | <input type="checkbox"/> Social/Humanitarian | _____ |
| <input type="checkbox"/> Art | <input type="checkbox"/> Literature | <input type="checkbox"/> Theater | _____ |
| <input checked="" type="checkbox"/> Commerce | <input type="checkbox"/> Military | <input checked="" type="checkbox"/> Transportation | _____ |
| <input type="checkbox"/> Communications | <input type="checkbox"/> Music | | _____ |
| <input type="checkbox"/> Conservation | | | _____ |

STATEMENT OF SIGNIFICANCE

The de Mores meat packing plant was built by Antoine Amédée Marie Vincent de Vallombrosa, the Marquis de Mores, a pretender to the French throne, determined and resourceful, who arrived at the tiny settlement of Little Missouri, Dakota Territory, in April of 1883 for the purpose of establishing a meat packing enterprise utilizing some innovative ideas that he was convinced could revolutionize the meat producing industry. De Mores believed that by slaughtering and processing meat animals close to the producing range and shipping the carcasses by refrigerated railroad car (thereby eliminating the costs of feeding and caring for live animals and reducing weight loss or volume shrinkage) economies could be obtained that would permit successful competition both economically and qualitatively with the operations of the Eastern packers.

The Badlands of the Little Missouri provided everything de Mores needed for his undertaking; a railroad, a producing range, a cattle raising industry, and lots of open space in which to operate. He selected the vicinity of the Northern Pacific Railway's crossing of the Little Missouri River, just east of the town of Little Missouri, to be the seat of his operations. East of the river, he built the huge abattoir that would, he hoped, turn 150 beeves a day into food for the nation's consumers. He built cold storage facilities at Helena, Billings, Miles City, Medora, Bismarck, Fargo, Brainard, Duluth, Minneapolis, St. Paul and Chicago to facilitate the shipment of his products; and he purchased 15,000 acres of land (another innovation for the previously "free" range area) to use as grazing and pasture land.

Also east of the Little Missouri and next to his packing plant, the ever optimistic Mores platted a new town which, in his gallant manner, he named Medora after his recent bride. Intended and designed to better serve his needs than could its rough west river neighbor, Little Missouri, Medora prospered and grew as rapidly as the ambitions of its founder. It soon boasted a brick yard, church, newspaper, three hotels, several stores and saloons, and by the end of 1884, boasted of a permanent population of 251.

SEE INSTRUCTIONS

9. MAJOR BIBLIOGRAPHICAL REFERENCES

Dresden, Donald. The Marquis de Mores: Emperor of the Badlands Norman Oklahoma, University of Oklahoma Press, 1970

Goplen, Arnold. "The Career of the Marquis de Mores in the Badlands of North Dakota," North Dakota History, Vol XIII, No. 1 and 3 (January and April, 1946).

Goplen, Arnold. "Historical Narrative and Plans for Restoration, Development and Preservation of the DeMores Historic Site at Medora, North Dakota," National Park Service Report, May 29, 1939.

Saum, Lewis O. "The Marquis de Mores :Instrument of American Progress" North Dakota History, Vol. XXXVI, 1969

10. GEOGRAPHICAL DATA

| LATITUDE AND LONGITUDE COORDINATES DEFINING A RECTANGLE LOCATING THE PROPERTY | | | O R | LATITUDE AND LONGITUDE COORDINATES DEFINING THE CENTER POINT OF A PROPERTY OF LESS THAN TEN ACRES | | |
|---|-------------------------|-------------------------|--------|---|-------------------------|--|
| CORNER | LATITUDE | LONGITUDE | | LATITUDE | LONGITUDE | |
| | Degrees Minutes Seconds | Degrees Minutes Seconds | | Degrees Minutes Seconds | Degrees Minutes Seconds | |
| NW | 46 ° 55 ' 06 " | 103 ° 31 ' 52 " | | | | |
| NE | 46 ° 55 ' 06 " | 103 ° 31 ' 29 " | | | | |
| SE | 46 ° 54 ' 56 " | 103 ° 31 ' 29 " | | | | |
| SW | 46 ° 54 ' 56 " | 103 ° 31 ' 52 " | | | | |

APPROXIMATE ACREAGE OF NOMINATED PROPERTY: **20 acres**

LIST ALL STATES AND COUNTIES FOR PROPERTIES OVERLAPPING STATE OR COUNTY BOUNDARIES

| STATE: | CODE | COUNTY: | CODE |
|--------|------|---------|------|
| STATE: | CODE | COUNTY: | CODE |
| STATE: | CODE | COUNTY: | CODE |
| STATE: | CODE | COUNTY: | CODE |

11. FORM PREPARED BY

NAME AND TITLE:
Walter L. Bailey - Historic Preservation Planner

ORGANIZATION: **State Historical Society of North Dakota** DATE: **10-10-74**

STREET AND NUMBER:
Liberty Memorial Building

CITY OR TOWN: **Bismarck** STATE: **North Dakota** CODE: **38**

12. STATE LIAISON OFFICER CERTIFICATION **NATIONAL REGISTER VERIFICATION**

As the designated State Liaison Officer for the National Historic Preservation Act of 1966 (Public Law 89-665), I hereby nominate this property for inclusion in the National Register and certify that it has been evaluated according to the criteria and procedures set forth by the National Park Service. The recommended level of significance of this nomination is:

National State Local

Name: **Lana E. Sherry**

Title: **S.O.N.D. S.H.P.O.**

Date: **Nov 19, 1974**

I hereby certify that this property is included in the National Register.

AR Montrose
Director, Office of Archeology and Historic Preservation

Date: **2/18/75**

ATTEST:

W. Monty
Keeper of The National Register

Date: **2-14-75**

SEE INSTRUCTIONS

**NATIONAL REGISTER OF HISTORIC PLACES
INVENTORY - NOMINATION FORM**

(Continuation Sheet)

| | |
|------------------|-------------|
| STATE | |
| North Dakota | |
| COUNTY | |
| Billings | |
| FOR NPS USE ONLY | |
| ENTRY NUMBER | DATE |
| | FEB 18 1975 |

(Number all entries)

8 Significance (continued page 2)

Recognizing a need, Mores next started a stage coach line from Medora to Deadwood, center of the gold mining region in the Black Hills.

Unfortunately, the packing venture failed. Eastern housewives seemed to prefer "corn fed" to the tougher "range fed" beef and the competitive packers of the east met the challenge with a price war that reduced prices to as little as 3¢ a pound. With the closing of the packing plant, the other Mores enterprises also declined and before the disastrous winter of 1886-87, which nearly put an end to the area's cattle business, the Marquis and his family had returned to the East and Europe.

The imprint of the man and his venture remains on the country. The town of Medora flourishes and, interestingly enough, before North Dakota statehood in 1889, beef packing plants based on the Mores premise were operating successfully in Fargo and Grand Forks. The cattle industry continues to thrive and thousands of persons each year visit the headquarters of a vindicated visionary.



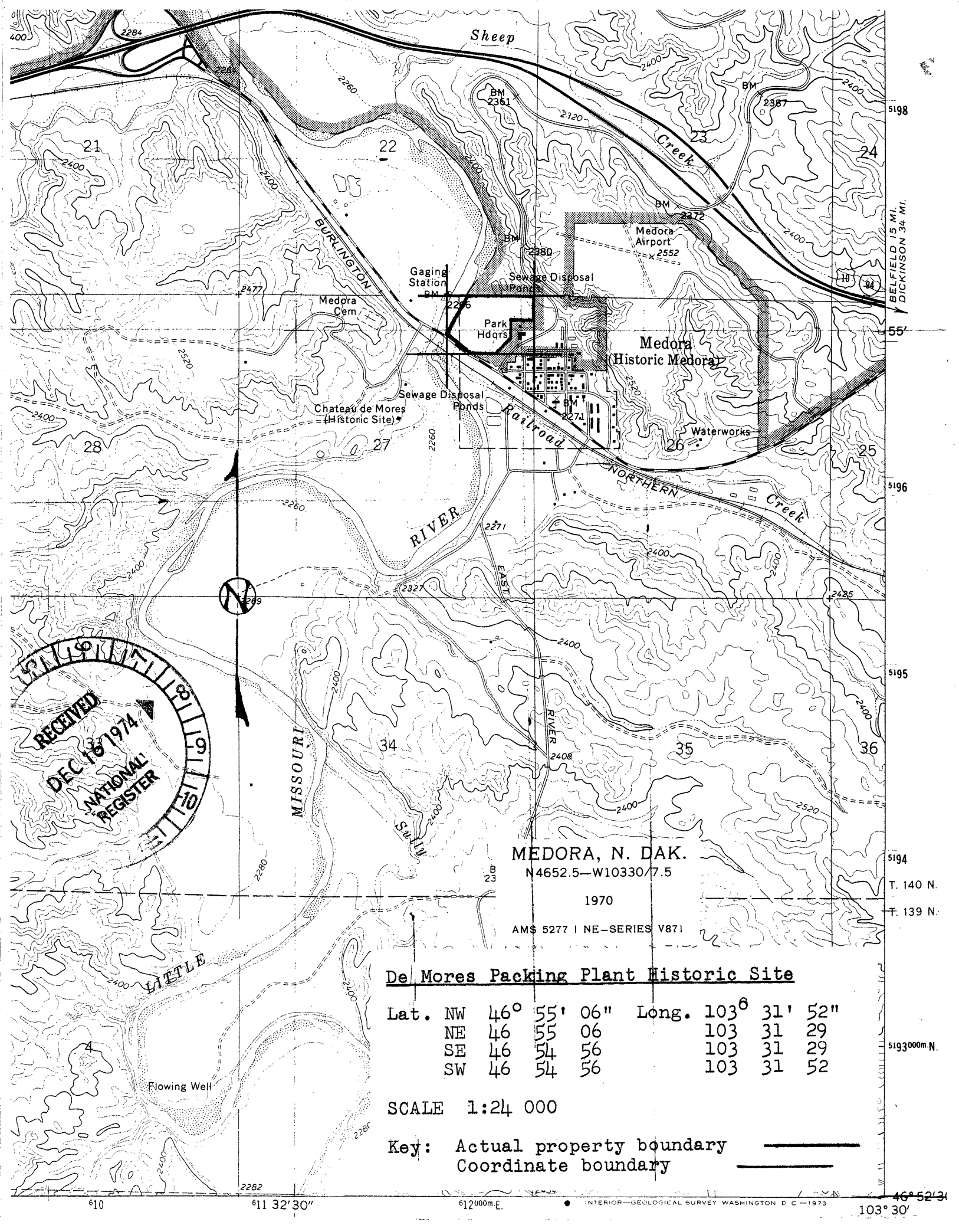

MEDORA, N. DAK.

N4652.5-W10330/7.5

1970

AMS 5277 I NE-SERIES V871

De Mores Packing Plant Historic Site

| | | | | | | |
|---------|-----|-----|-----|------------|-----|-----|
| Lat. NW | 46° | 55' | 06" | Long. 103° | 31' | 52" |
| NE | 46 | 55 | 06 | 103 | 31 | 29 |
| SE | 46 | 54 | 56 | 103 | 31 | 29 |
| SW | 46 | 54 | 56 | 103 | 31 | 52 |

SCALE 1:24 000

Key: Actual property boundary
 Coordinate boundary

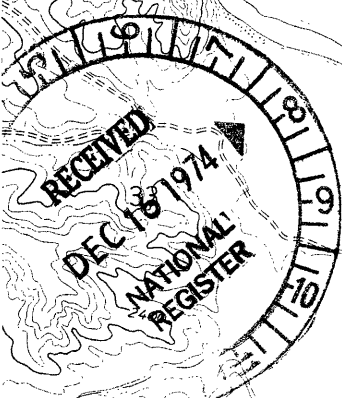

5198
55'
5196
5195
5194
T. 140 N.
T. 139 N.
5193000m N.