

KENTUCKY HISTORIC RESOURCES INVENTORY

Site No. CP-81

1. Historic Name(s) Gubser-Schuchter Farm (G-S TA)		22. ADD/County Campbell	
Original Owner Andrew Gubser		23. U.S.G.S. Quadrant (15'/75') New Richmond	
2. Present Name Mincey Farm		24. UTM Reference 16 728420 4318060	
3. Location Four Mile Pike, Camp Springs		Zone Easting Northing	
4. Owner's Name Mr. & Mrs. Donald Mincey		25. Coordinate Accuracy	
5. Owner's Address Box 197, Melbourne, Kentucky		26. Prehistoric Site Object Historic Site Structure Building Other	
6. Open to Public Yes <input type="checkbox"/> No <input checked="" type="checkbox"/>	7. Visible from road Yes <input checked="" type="checkbox"/> No <input type="checkbox"/>	27. National Register District Name: GERMAN SETTLEMENT PROPERTIES FOUR MILE CREEK AREA	
9. Local Contact/Organization Campbell County Heritage League		28. Significance Evaluation	
8. Ownership Private <input checked="" type="checkbox"/> Local <input type="checkbox"/> State <input type="checkbox"/> Federal <input type="checkbox"/>		29. Status _____ Date _____ National Landmark _____ National Register _____ Landmark Certificate _____ Kentucky Survey <input checked="" type="checkbox"/> May 16, 1979 Local Landmark _____ HABS/HAER _____	
10. Site Plan with North Arrow		30. Historic Theme Primary Architecture <input type="checkbox"/> Secondary Ethnic Settlement <input type="checkbox"/> Other Agriculture <input type="checkbox"/>	
11. Architect		31. Endangered Yes <input type="checkbox"/> No <input checked="" type="checkbox"/>	
12. Builder		32. Preservation Project Status <input type="checkbox"/>	
13. Date C. 1850-1860 A. <input checked="" type="checkbox"/> B. <input type="checkbox"/>		Actual Cost in \$1,000s _____	
14. Style A. Vernacular <input checked="" type="checkbox"/> B. <input type="checkbox"/>		33. ATTACH PHOTO	
15. Original Use Farm Complex <input checked="" type="checkbox"/>			
16. Present use Farm Complex			
17. Condition <input checked="" type="checkbox"/>			
18. Description Important hillside sited farm complex immediately south of Camp Springs. Complex consists of log and stone house, smoke-house, summer kitchen, barn and ancillary outbuildings. Two story, double pen log house characterized by a 1 1/2 story, stone unit attached to the rear elevation. The simple, three-bay log house has clapboard wall siding whereas the northern (Continue on Back)			
No. Stories <input checked="" type="checkbox"/>		Roll No. 25/26	
Single Pile _____ NA _____		Picture No. 27-36/2-13	
Double Pile <input checked="" type="checkbox"/>		Direction _____	
Floor Plan <input checked="" type="checkbox"/>		34. Prepared by: Carolyn M. Torma Edward A Chappell	
Structural Fabric A. <input checked="" type="checkbox"/> B. <input checked="" type="checkbox"/>		35. Organization Kentucky Heritage Council	
Decorative Fabric A. <input checked="" type="checkbox"/> B. <input checked="" type="checkbox"/>		36. Date May 16, 1979	
Roof Form Gable end: ribbed metal		37. Revision Dates 10/20/82 Steve Gordon	
19. History Double pen log house appears to have been built by Andrew Gubser (Kupser) about the time he purchased the property in 1850 from Daniel Ware. Ware had owned the property since 1813. Gubser, also spelled Kupser in the census, had immigrated to Kentucky from Switzerland		38. Staff Review	
20. Significance A significant farm complex associated with ethnic settlement into the Four Mile Creek Valley. The Gubser's were part of a small Swiss enclave that		21. Source of Information Mr. & Mrs. Mincey Seventh Census of the United States; 1850, Campbell County.	

18. (Continued)

portion of the stone section is whitewashed. Flat wood lintels over windows in stone section. Foundation of front porch is stone and has ground level entrance that leads into a cellar.

A vaulted cellar space is below the smokehouse.

19. sometime between 1844 and 1849. A farmer by occupation, Gubser had eight children in 1850, the youngest having been born in Kentucky in 1849. In 1883 Frank and Katherine Schuchter purchased the 30 acre farm for \$2,300. The Schuchters were large wine producers and stored wine barrels in the vaulted cellar space below the smokehouse. The frame summer kitchens were widely used in the Four Mile area before gas and electricity was made available in the early 1930s.

20. immigrated into the area along with the Germans.

GUBSER-SCHUCHTER
HOUSE

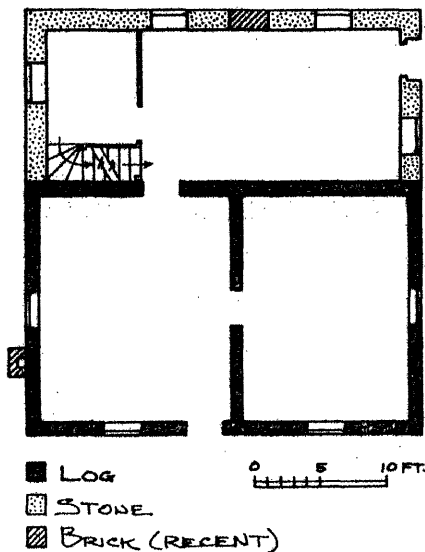

Fig.3



Two room log section and
stone foundation under porch



stone smokehouse

KENTUCKY HISTORIC RESOURCE INVENTORY SUPPLEMENT
BOUNDARY AND LOCATION INFORMATION

Historic Property Name Gubser-Schuchter Farm Site # CP-81

Multiple Resource/Thematic Nomination Title German Settlement Properties
Four Mile Creek Area

U.T.M. Coordinates - List multiple UTMs if property is ten or more acres.

A. 16 728420 4318060 D. _____

B. _____ E. _____

C. _____ F. _____

Verbal Boundary Description Acreage 2.52 acres

Beginning at a point on the east side of Four Mile Pike, 1100' south of Upper Tug Fork Road, proceed east 400', then proceed south 250' to the edge of a small creek, then proceed west 400' following said creek to the edge of Four Mile Pike. Then proceed north 300' along said road to the point of origin. Boundaries include the house, barn, and all contributing outbuildings.

Sketch of Site Plan (Showing outbuildings, structures, landscape features and the site boundary as described above.)

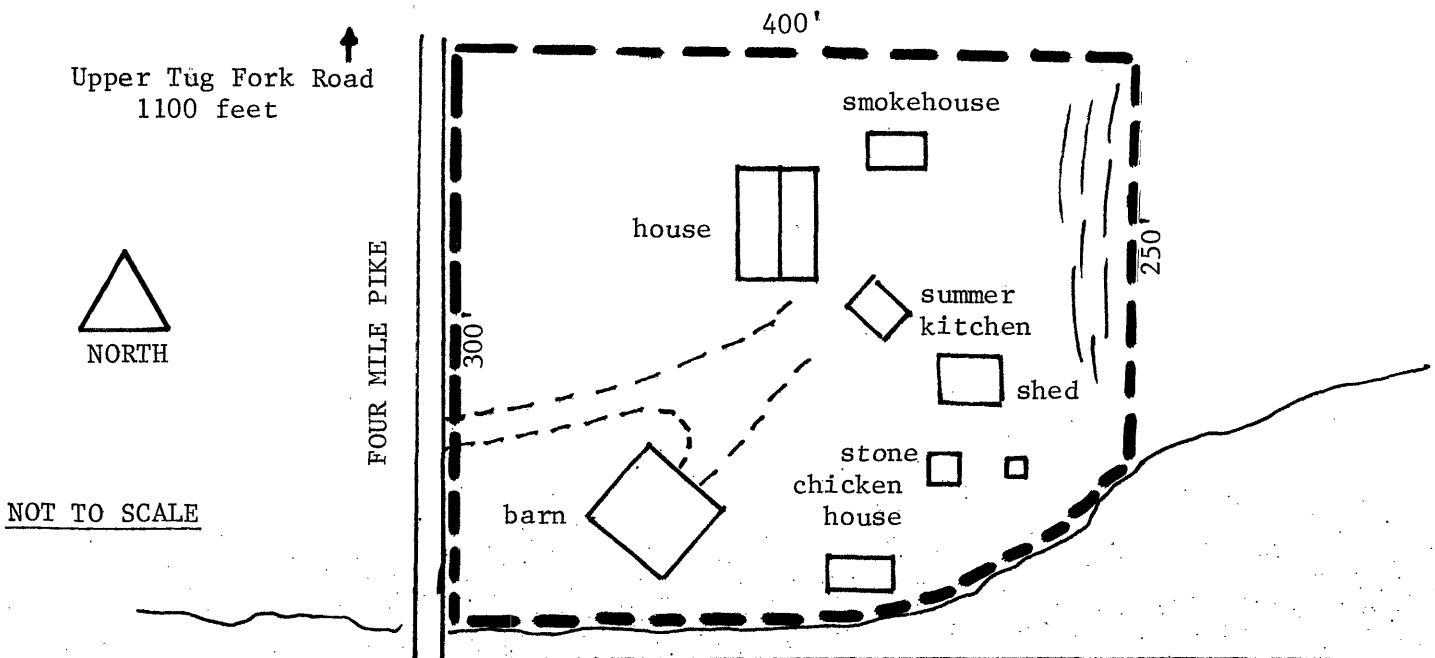

Official Courthouse Property Reference:

County Book: Page 25, Parcel 7. Part of 71 acre tract.