

HB NO 47M

**NATIONAL REGISTER OF HISTORIC PLACES
INVENTORY - NOMINATION FORM**

(Type all entries - complete applicable sections)

STATE: Mississippi	
COUNTY: Holmes	
FOR NPS USE ONLY	
ENTRY NUMBER 70.11.28.0014	DATE 11/10/70

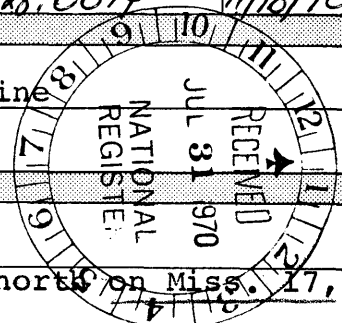

1. NAME

COMMON:
Rob Morris Little Red Schoolhouse, O.E.S. Shrine

AND/OR HISTORIC:
Eureka Masonic College

2. LOCATION

STREET AND NUMBER:

CITY OR TOWN: Approximately 4.5 miles north of Richland Community - off U. S. 51

STATE: Mississippi CODE: 23 COUNTY: Holmes CODE: 051

3. CLASSIFICATION

CATEGORY (Check One)	OWNERSHIP	STATUS	ACCESSIBLE TO THE PUBLIC
<input type="checkbox"/> District <input type="checkbox"/> Site <input type="checkbox"/> Object <input checked="" type="checkbox"/> Building <input type="checkbox"/> Structure	<input type="checkbox"/> Public <input checked="" type="checkbox"/> Private <input type="checkbox"/> Both	Public Acquisition: <input type="checkbox"/> In Process <input type="checkbox"/> Being Considered <input checked="" type="checkbox"/> Occupied <input checked="" type="checkbox"/> Unoccupied <input type="checkbox"/> Preservation work in progress	Yes: <input checked="" type="checkbox"/> Restricted <input type="checkbox"/> Unrestricted <input type="checkbox"/> No

PRESENT USE (Check One or More as Appropriate)

<input type="checkbox"/> Agricultural	<input type="checkbox"/> Government	<input type="checkbox"/> Park	<input type="checkbox"/> Transportation	<input type="checkbox"/> Comments
<input type="checkbox"/> Commercial	<input type="checkbox"/> Industrial	<input type="checkbox"/> Private Residence	<input type="checkbox"/> Other (Specify)	
<input type="checkbox"/> Educational	<input type="checkbox"/> Military	<input type="checkbox"/> Religious	Historic Shrine	
<input type="checkbox"/> Entertainment	<input type="checkbox"/> Museum	<input type="checkbox"/> Scientific		

4. OWNER OF PROPERTY

OWNER'S NAME:
Grand Chapter of Mississippi, Order of the Eastern Star

STREET AND NUMBER:
1130 West Capitol Street

CITY OR TOWN: Jackson STATE: Mississippi CODE: 23

5. LOCATION OF LEGAL DESCRIPTION

COURTHOUSE, REGISTRY OF DEEDS, ETC.:
Holmes County Courthouse

STREET AND NUMBER:

CITY OR TOWN: Lexington STATE: Mississippi CODE: 23

6. REPRESENTATION IN EXISTING SURVEYS

TITLE OF SURVEY:

DATE OF SURVEY: Federal State County Local

DEPOSITORY FOR SURVEY RECORDS:

STREET AND NUMBER:

CITY OR TOWN: STATE: CODE:

SEE INSTRUCTIONS

STATE: Mississippi
COUNTY: Holmes
ENTRY NUMBER: 70.11.28.0014
DATE: 11/10/70
FOR NPS USE ONLY

7. DESCRIPTION

CONDITION	(Check One)					
	<input type="checkbox"/> Excellent	<input checked="" type="checkbox"/> Good	<input type="checkbox"/> Fair	<input type="checkbox"/> Deteriorated	<input type="checkbox"/> Ruins	<input type="checkbox"/> Unexposed
	(Check One)			(Check One)		
	<input checked="" type="checkbox"/> Altered	<input type="checkbox"/> Unaltered	<input type="checkbox"/> Moved	<input checked="" type="checkbox"/> Original Site		

DESCRIBE THE PRESENT AND ORIGINAL (if known) PHYSICAL APPEARANCE

The Rob Morris Little Red Schoolhouse, built in 1847, is a two story red brick structure, possessing some features of the Federal style of architecture. The building measures 60' by 30', and consists of two large rooms on the first floor; whereas, the second floor is comprised of only one room. There are fireplaces on the east and west walls on both floors. The upstairs of the building was originally used as dormitory space, with the first floor serving as classrooms.

A considerable amount of restoration has been completed on the building by the Grand Chapter of Mississippi, Order of the Eastern Star, since it acquired the property in 1959. The original brick has been cleaned and waterproofed. During the work, the original cornerstone was revealed and was preserved in place. The tin roof, used on the building when it served as a public school, was removed and replaced with a roof of wooden shingles. Shutters were reconstructed and installed on the windows. Two windows on the top floor of the west end of the building, bricked in through the years, were restored to complement the original windows. The stairway, leading from the front entrance, has been reconstructed, with new flooring being installed on the second floor.

All of the outbuildings, which had been placed near the school during the Depression years, have been removed. Still remaining to the east of the building is a cistern and cistern house. The Grand Chapter installed a chain-link fence around the property in 1959 and also constructed an open-air pavilion back of the building in 1962.

SEE INSTRUCTIONS

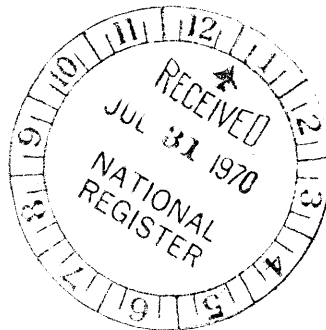

3. SIGNIFICANCE

PERIOD (Check One or More as Appropriate)

- Pre-Columbian | 16th Century | 18th Century | 20th Century
 15th Century | 17th Century | 19th Century

SPECIFIC DATE(S) (If Applicable and Known)

1847-1959

AREAS OF SIGNIFICANCE (Check One or More as Appropriate)

- | | | | |
|---|---|--|--|
| <input type="checkbox"/> Aboriginal | <input checked="" type="checkbox"/> Education | <input type="checkbox"/> Political | <input type="checkbox"/> Urban Planning |
| <input type="checkbox"/> Prehistoric | <input type="checkbox"/> Engineering | <input type="checkbox"/> Religion/Philosophy | <input type="checkbox"/> Other (Specify) |
| <input type="checkbox"/> Historic | <input type="checkbox"/> Industry | <input type="checkbox"/> Science | <u>Fraternal</u> |
| <input type="checkbox"/> Agriculture | <input type="checkbox"/> Invention | <input type="checkbox"/> Sculpture | _____ |
| <input type="checkbox"/> Architecture | <input type="checkbox"/> Landscape Architecture | <input type="checkbox"/> Social/Humanitarian | _____ |
| <input type="checkbox"/> Art | <input type="checkbox"/> Literature | <input type="checkbox"/> Theater | _____ |
| <input type="checkbox"/> Commerce | <input checked="" type="checkbox"/> Military | <input type="checkbox"/> Transportation | _____ |
| <input type="checkbox"/> Communications | <input type="checkbox"/> Music | | _____ |
| <input type="checkbox"/> Conservation | | | _____ |

STATEMENT OF SIGNIFICANCE

The Rob Morris Little Red Schoolhouse, as it is commonly known today, was built in 1847 to house the Richland Literary Institute. On February 7, 1848, a special act of the Mississippi State Legislature changed the name of the school to the Eureka Masonic College, which never became more than a high school.

Dr. Robert Morris came from Oxford, Mississippi, to serve as principal of the new school, and it was here that he conceived the idea of the organization of the Order of the Eastern Star. This building, therefore, is recognized by the Eastern Star organization as its birthplace; though Morris' actual writing of the Order's ritual took place in Jackson, Mississippi.

Morris began his Masonic career when he was initiated into the Lodge of Masons at Oxford, March 5, 1846. In 1849, he was named Grand Chaplain of the Grand Chapter of Mississippi; and, in 1850, Morris founded the Order of the Eastern Star.

Tradition has it that during the Civil War, the building was used temporarily as the headquarters for Company C, 15th Mississippi Infantry, which was mustered into service in Holmes County. After the war, the building was converted into a public school for Negroes, which remained in operation until the end of the 1958-1959 school year. On July 9, 1959, the Holmes County Board of Supervisors leased the land to the Grand Chapter of Mississippi, Order of the Eastern Star; and, on August 5, 1968, title to the property was vested in the Grand Chapter. The Chapter has since proceeded with the restoration of the building as a historic shrine.

SEE INSTRUCTIONS

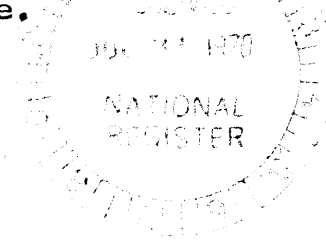

9. MAJOR BIBLIOGRAPHICAL REFERENCES

Freemason Monthly Magazine, December, 1847. (Boston, 1847), 41-43.
Freemason Monthly Magazine, November, 1848. (Boston, 1848), 26-27.
 Little Red Schoolhouse brochure. (n.p., n.d.)
Mississippi A Guide to the Magnolia State, Federal Writers' Project of the Works Progress Administration. (New York: The Viking Press, 1938), 386-387.

10. GEOGRAPHICAL DATA

LATITUDE AND LONGITUDE COORDINATES DEFINING A RECTANGLE LOCATING THE PROPERTY			O R	LATITUDE AND LONGITUDE COORDINATES DEFINING THE CENTER POINT OF A PROPERTY OF LESS THAN TEN ACRES		
CORNER	LATITUDE	LONGITUDE		LATITUDE	LONGITUDE	
	Degrees Minutes Seconds	Degrees Minutes Seconds		Degrees	Minutes	Seconds
NW	° ' "	° ' "		32	58	25
NE	° ' "	° ' "		89	59	11
SE	° ' "	° ' "				
SW	° ' "	° ' "				

APPROXIMATE ACREAGE OF NOMINATED PROPERTY: **3.6**

LIST ALL STATES AND COUNTIES FOR PROPERTIES OVERLAPPING STATE OR COUNTY BOUNDARIES

STATE:	CODE	COUNTY	CODE
STATE:	CODE	COUNTY:	CODE
STATE:	CODE	COUNTY:	CODE
STATE:	CODE	COUNTY:	CODE

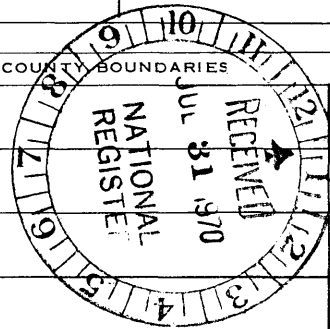

SEE INSTRUCTIONS

11. FORM PREPARED BY

NAME AND TITLE:
Elbert Hilliard, Director, Div. of Historic Sites and Archaeology

ORGANIZATION: **Mississippi Department of Archives and History** DATE: **July 27, 1970**

STREET AND NUMBER:
120 North State Street

CITY OR TOWN: **Jackson** STATE: **Mississippi 39205** CODE: **23**

12. STATE LIAISON OFFICER CERTIFICATION

As the designated State Liaison Officer for the National Historic Preservation Act of 1966 (Public Law 89-665), I hereby nominate this property for inclusion in the National Register and certify that it has been evaluated according to the criteria and procedures set forth by the National Park Service. The recommended level of significance of this nomination is:

National State Local

Name: *J. A. McJannet*

Title: Director, Mississippi Dept. of Archives and History

Date: July 27, 1970

NATIONAL REGISTER VERIFICATION

I hereby certify that this property is included in the National Register.

Ernest Allen Connally
 Chief, Office of Archeology and Historic Preservation

NOV 10 1970

Date _____

ATTEST:
William J. Mantel
 Keeper of the National Register

NOV 3 1970

Date _____

NATIONAL REGISTER OF HISTORIC PLACES
INVENTORY - NOMINATION FORM

(Continuation Sheet)

STATE Mississippi	
COUNTY Holmes	
FOR NPS USE ONLY	
ENTRY NUMBER	DATE
70.11.28.0014	11/10/70

(Number all entries)

9. Proceedings Sixty-Third Annual Session of the Grand Chapter of the State of Mississippi Order of the Eastern Star.
(Jackson, 1969), 27, 76, 117-118.

Laws of Mississippi: 1848. (Jackson: Price & Fall, 1848),
474-476.

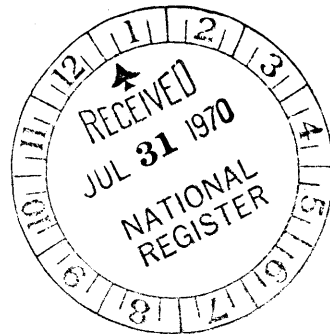

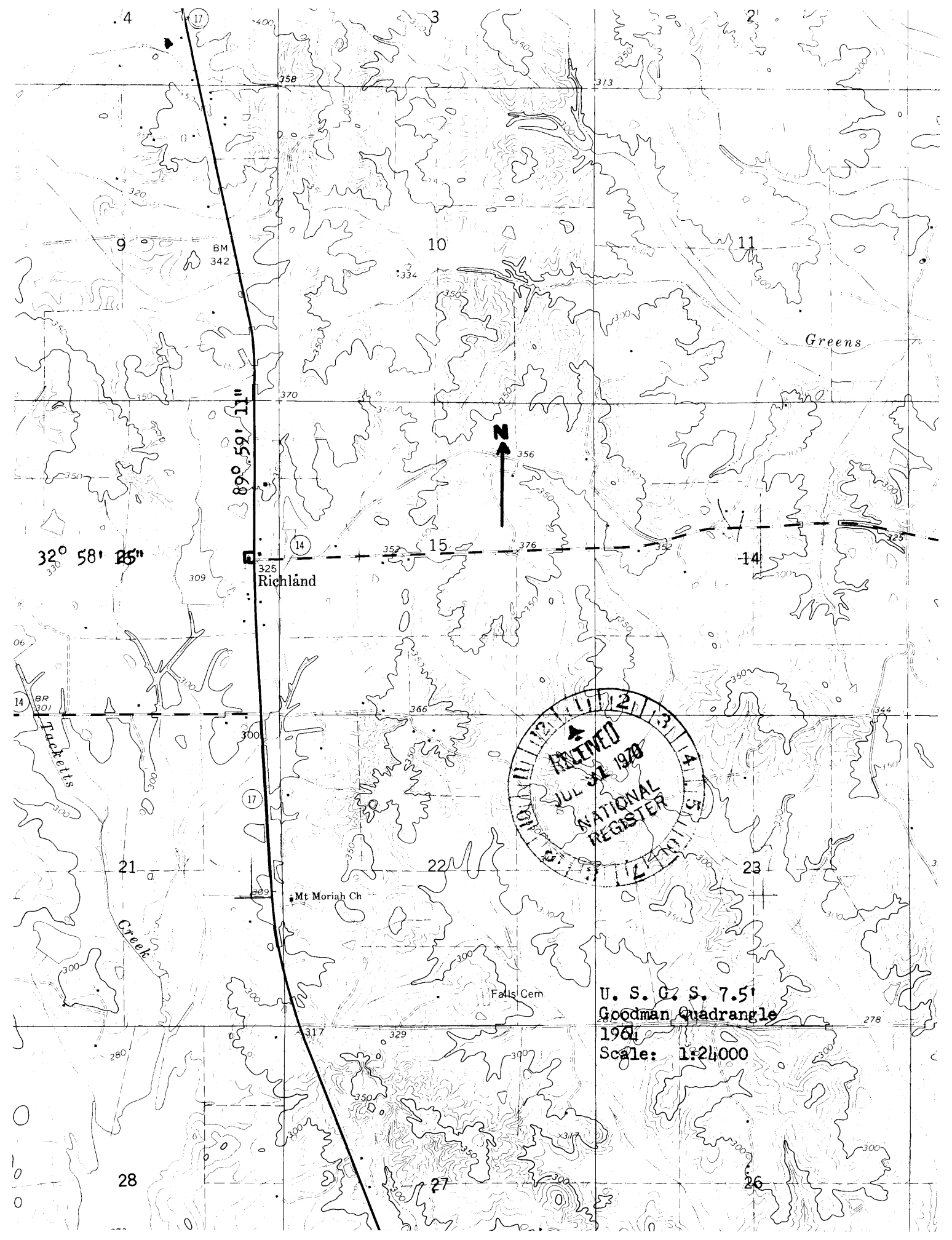

32° 58' 25"

89° 59' 11"

Richland

Mt Moriah Ch



U. S. G. S. 7.51
Goodman Quadrangle
1904
Scale: 1:24,000



Form 10-301
(July 1969)

UNITED STATES DEPARTMENT OF THE INTERIOR
NATIONAL PARK SERVICE

**NATIONAL REGISTER OF HISTORIC PLACES
PROPERTY MAP FORM**

(Type all entries - attach to or enclose with map)

STATE	
Mississippi	
COUNTY	
Holmes	
FOR NPS USE ONLY	
ENTRY NUMBER	DATE
70.11.28.0014	11/10/70

SEE INSTRUCTIONS

1. NAME

COMMON: Rob Morris Little Red Schoolhouse, O.E.S. Shrine
AND/OR HISTORIC: Eureka Masonic College

2. LOCATION

STREET AND NUMBER:
CITY OR TOWN: Approximately 4.5 miles north on Miss. 17,
Richland Community - off U. S. 51.
STATE: Mississippi CODE: 23 COUNTY: Holmes CODE: 051

3. MAP REFERENCE

SOURCE: U. S. G. S. 7.5', Goodman Quadrangle
SCALE: 1:24000
DATE: 1964

4. REQUIREMENTS

TO BE INCLUDED ON ALL MAPS

- Property boundaries where required.
- North arrow.
- Latitude and longitude reference.

