

**United States Department of the Interior
National Park Service**

**National Register of Historic Places
Inventory—Nomination Form**

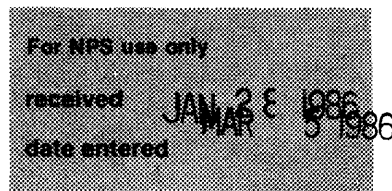

Thibodaux Multiple Resource Area

Continuation sheet Lafourche Parish, LA

Item number 7 & 8

Page

Building #10

UTM: 15/710600/3298120

LAMARTINA BUILDING

700-704 West Third

Owner: Philip Wu
Great Southern Computers
915 Talbot Road
Thibodaux, LA 70301

Pre-Civil War; remodeled in 1922

Local Significance: Commerce

The Lamartina Building is a two story brick commercial building with gable parapets and a wooden cantilevered front gallery. There is also a contemporaneous single story brick shed roof wing in the rear. It is not known if the chamfered post gallery is original, but it certainly dates from well before the turn-of-the-century at least. The building consists of two shops downstairs with a staircase between. The upstairs contains living quarters with French doors front and rear. The front French doors appear to date from the early twentieth century, while the rear ones appear to date from the mid-nineteenth century. At one time there was a rear gallery, but this has long since been removed. The handsome Gothic style balustrades on the front gallery are not original, but have been with the building a considerable length of time. The interiors feature beaded wall board throughout. In 1922 the facade was stuccoed to resemble dressed stone and the present shopfronts were installed. Since 1922 the only changes have been the bricking over of the bulkheads, the replacement of some of the shopfront glass, and the removal of a few of the shopfront glazing bars. In our opinion, these alterations should be regarded as minor.

Significance:

The Lamartina Building is locally significant in the area of commerce as a rare surviving example of a once common phenomenon. Old photos and Sanborn maps reveal that galleried commercial buildings were once a dominant element in Thibodaux. However, today there are only five remaining examples. Of these, the Lamartina Building is the oldest. Although it has been modified over the years, the changes have reflected continuing business activity in the area. Thus the building is an important material representative of Thibodaux's historic role as a commercial center for Lafourche Parish. (See galleried commercial buildings section of Item 8 for further explanation and justification.)

LAMARTINA BLDG
THIBODAUX
LA FOURCHE PARISH,
LA.

THIBODAUX MRA

BOUNDARY

THE EAST & WEST BOUNDARY LINES FOLLOW
PARTY WALLS. THE NORTH & SOUTH
BOUNDARY LINES FOLLOW CURBLINES,

2 1/4 ACRE

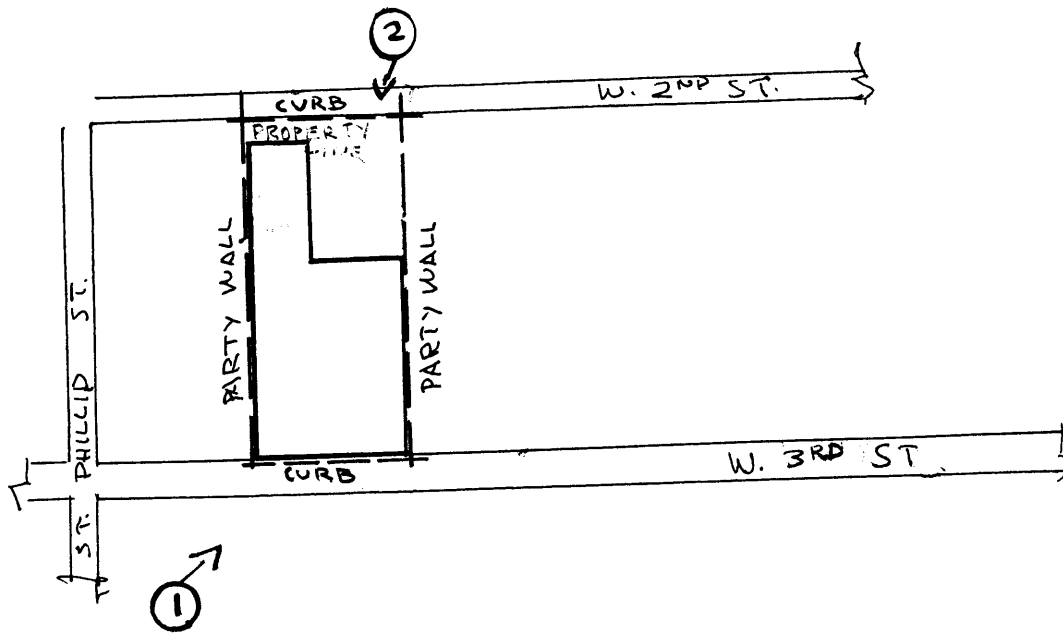

(NOT TO SCALE)

