

**United States Department of the Interior
National Park Service**

**NATIONAL REGISTER OF HISTORIC PLACES
REGISTRATION FORM**

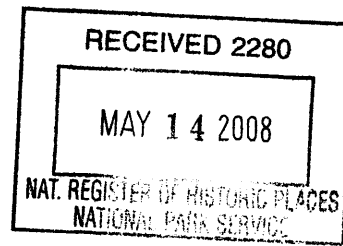

551

This form is for use in nominating or requesting determinations for individual properties and districts. See instructions in How to Complete the National Register of Historic Places Registration Form (National Register Bulletin 16A). Complete each item by marking "x" in the appropriate box or by entering the information requested. If any item does not apply to the property being documented, enter "N/A" for "not applicable." For functions, architectural classification, materials, and areas of significance, enter only categories and subcategories from the instructions. Place additional entries and narrative items on continuation sheets (NPS Form 10-900a). Use a typewriter, word processor, or computer, to complete all items.

1. Name of Property

historic name The Hub

other names/site number Student Services Building/AL4968

2. Location

street & number Stadium Road between Buckman Drive and Fletcher Drive n/a not for publication

city or town Gainesville n/a vicinity

state Florida code FL county Alachua code 001 zip code 32611

3. State/Federal Agency Certification

As the designated authority under the National Historic Preservation Act, as amended, I hereby certify that this nomination request for determination of eligibility meets the documentation standards for registering properties in the National Register of Historic Places and meets the procedural and professional requirements set forth in 36 CFR Part 60. In my opinion, the property meets does not meet the National Register criteria. I recommend that this property be considered significant nationally statewide locally. (See continuation sheet for additional comments.)

Barbara E. Mattick / DSHPO 5/8/08
Signature of certifying official/Title Date

Florida Department of State, Division of Historical Resources, Bureau of Historic Preservation
State or Federal agency and bureau

In my opinion, the property meets does not meet the National Register criteria. (See continuation sheet for additional comments.)

Signature of certifying official/Title Date

State or Federal agency and bureau

4. National Park Service Certification

I hereby certify that the property is:

- entered in the National Register
 See continuation sheet
- determined eligible for the National Register
 See continuation sheet.
- determined not eligible for the National Register
 See continuation sheet.
- removed from the National Register.
- other, (explain) _____

Signature of the Keeper

Date of Action

Patrick Andrews

6/24/2008

The Hub
Name of Property

Alachua Co., FL
County and State

5. Classification

Ownership of Property
(Check as many boxes as apply)

- private
- public-local
- public-State
- public-Federal

Category of Property
(Check only one box)

- buildings
- district
- site
- structure
- object

Number of Resources within Property
(Do not include any previously listed resources in the count)

Contributing	Noncontributing	
1	0	buildings
0	0	sites
0	0	structures
0	0	objects
1	0	total

Name of related multiple property listings
(Enter "N/A" if property is not part of a multiple property listing.)

University of Florida Campus Historic Resources

Number of contributing resources previously listed in the National Register

0

6. Function or Use

Historic Functions
(Enter categories from instructions)

Education: Education-related

Current Functions
(Enter categories from instructions)

Education: Education-related

7. Description

Architectural Classification
(Enter categories from instructions)

Modern Movement: International Style

Materials
(Enter categories from instructions)

foundation Concrete
walls Brick
roof Asphalt
other Tile
Glass

Narrative Description

(Describe the historic and current condition of the property on one or more continuation sheets.)

8. Statement of Significance

Applicable National Register Criteria

(Mark "x" in one or more boxes for the criteria qualifying the property for National Register listing.)

- A** Property is associated with events that have made a significant contribution to the broad patterns of our history.
- B** Property is associated with the lives of persons significant in our past.
- C** Property embodies the distinctive characteristics of a type, period, or method of construction or represents the work of a master, or possesses high artistic values, or represents a significant and distinguishable entity whose components lack individual distinction.
- D** Property has yielded, or is likely to yield information important in prehistory or history.

Criteria Considerations

(Mark "x" in all the boxes that apply.)

Property is:

- A** owned by a religious institution or used for religious purposes.
- B** removed from its original location.
- C** a birthplace or grave.
- D** a cemetery.
- E** a reconstructed building, object, or structure.
- F** a commemorative property.
- G** less than 50 years of age or achieved significance within the past 50 years

Narrative Statement of Significance

(Explain the significance of the property on one or more continuation sheets.)

9. Major Bibliographical References

Bibliography

Cite the books, articles, and other sources used in preparing this form on one or more continuation sheets.)

Previous documentation on file (NPS):

- preliminary determination of individual listing (36 CFR 36) has been requested
- previously listed in the National Register
- previously determined eligible by the National Register
- designated a National Historic Landmark
- recorded by Historic American Buildings Survey # _____
- recorded by Historic American Engineering Record

Areas of Significance

(Enter categories from instructions)

Architecture

Period of Significance

1950

Significant Dates

1950

Significant Person

n/a

Cultural Affiliation

n/a

Architect/Builder

Ferendino, Andrew, Architect

Primary location of additional data:

- State Historic Preservation Office
- Other State Agency
- Federal agency
- Local government
- University
- Other

Name of Repository
University of Florida

The Hub
Name of Property

Alachua Co., FL
County and State

10. Geographical Data

Acreeage of Property Less than one acre

UTM References

(Place additional references on a continuation sheet.)

1	1	7	3	6	9	7	7	0	3	2	8	0	5	2	0
	Zone		Easting						Northing						
2															

3															
	Zone		Easting						Northing						
4															

See continuation sheet

Verbal Boundary Description

(Describe the boundaries of the property on a continuation sheet.)

Boundary Justification

(Explain why the boundaries were selected on a continuation sheet.)

11. Form Prepared By

name/title Prof. Susan Tate and Ms. Murray Laurie and Barbara E. Mattick/DSHPO

organization Bureau of Historic Preservation date May 2008

street & number R.A. Gray Building, 500 S. Bronough Street telephone 850-245-6333

city or town Tallahassee state Florida zip code 32399-0250

Additional Documentation

Submit the following items with the completed form:

Continuation Sheets

Maps

A **USGS map** (7.5 or 15 minute series) indicating the property's location.

A **Sketch map** for historic districts and properties having large acreage or numerous resources.

Photographs

Representative **black and white photographs** of the property.

Additional items

(check with the SHPO or FPO for any additional items)

Property Owner

(Complete this item at the request of SHPO or FPO.)

name State of Florida, Board of Trustees of the Internal Improvement Fund

street & number 3900 Commonwealth Boulevard telephone 850-245-6333

city or town Tallahassee state Florida zip code 32399

Paperwork Reduction Act Statement: This information is being collected for applications to the National Register of Historic Places to nominate properties for listing or determine eligibility for listing, to list properties, and amend listings. Response to this request is required to obtain a benefit in accordance with the National Historic Preservation Act, as amended (16 U.S.C. 470 *et seq.*).

Estimated Burden Statement: Public reporting burden for this form is estimated to average 18.1 hours per response including time for reviewing instructions, gathering and maintaining data, and completing and reviewing the form. Direct comments regarding this burden estimate or any aspect of this form to the Chief, Administrative Services Division, National Park Service, P.O. Box 37127, Washington, DC 20013-7127; and the Office of Management and Budget, Paperwork Reductions Projects (1024-0018), Washington, DC 20503.

United States Department of the Interior
National Park Service

**NATIONAL REGISTER OF HISTORIC PLACES
CONTINUATION SHEET**

Section number 7 Page 1 **THE HUB**
Gainesville, Alachua Co., FL

DESCRIPTION

The Hub, completed in 1950, reflects International Modern influences, yet harmonizes with historic buildings constructed before that date on the University of Florida campus in scale and the use of red brick with contrasting trim. The building is slightly V-shaped, with a wide, curving covered walkway across the main, north façade. The two-story masonry structure was designed by Andrew Ferendino. It has a flat roof and fenestration consists of horizontal banks of windows framed in cast concrete. The Hub is located on Stadium Road between Buckman Drive and Fletcher Drive, across from the south boundary of the University of Florida Campus Historic District. The Hub is nominated under the cover for **University of Florida Campus Historic Resources, Gainesville, Alachua County, Florida**, using **Associated Property Type F.1: Historic Buildings and Structures**.

Setting

The Hub, as its name suggests, is sited near the center of the main campus of the University of Florida, more or less equidistant from clusters of academic buildings, dormitories, and sports and recreation facilities. It is not located within the Campus Historic District, but is on the south side of Stadium Road, which forms the southern boundary of the district. It was built in 1950 on a flat parcel of land to the south of Newell Hall and Rolfs Hall that was used extensively by the College of Agriculture for pasture and orange groves that spread out to the east, south, and west of the historic campus. Since then other structures have been built close to the building on the east (Marston Science Library) and to the west (Williamson Hall). However, the space to the south remains open, the tree-shaded Union Lawn, which is crossed with multiple paved footpaths. In front of The Hub, there is an open, landscaped area between the building and the sidewalk that runs along Stadium Road. A paved courtyard with cast concrete picnic tables is set in front of the rounded northeast section of the building, which serves as a food court.

Description: Exterior

The Hub has three elements: the two-story rectangular central block, a two-story pavilion with a curved façade projecting from the west end, and a one-story rounded element to the east (photos 1-4). The roof is flat with a coping of cast concrete, and the walls are clad in red brick. Fenestration consists of horizontal bands of windows on each level framed in cast concrete. On the ground floor, the main, north elevation features a broad concrete awning supported by slender columns that follows the curve of the building and emphasizes its horizontal lines. The curve continues around the sides of the building. The wall on the one-story east end curves entirely around to the rear of the building. The wide paved walkway along the main, north elevation is shaded by the concrete awning and lined with concrete benches on the outer edge. A two-story expanse of glass, framed in light colored cast concrete, emphasizes the main entryway and lights the interior stairway. To further differentiate the entry sequence, the glass entry is the only vertical opening on the front elevation of the

United States Department of the Interior
National Park Service

**NATIONAL REGISTER OF HISTORIC PLACES
CONTINUATION SHEET**

Section number 7 Page 2 **THE HUB**
Gainesville, Alachua Co., FL

Hub. On the south elevation, columns covered glazed tile support the second floor landing of the open stairway that leads up to the balcony with metal railings (photo 5). Vertical windows framed with cast concrete are set in the rear wall at the top of the landing, and a horizontal band of windows runs along the wall behind the balcony. The southwest of the rear elevation and the west are simplified in form; service functions have been added to this less visible area. The northwest corner curves around as an extension of the front curve of the main façade.

A decided departure from the Collegiate Gothic style used on buildings on the University of Florida campus between 1906 and 1950, the Hub brought International Modern architectural influences to the campus. The irregular shape of the building with its low-sweeping curves and horizontal lines, is accentuated by the flat cast concrete awning on the ground floor of the main, north facade, and the use of tile and corrugated glass, reflected a contemporary, Florida-of-the-tropics look. Yet the scale and the use of red brick and cast concrete details tie the building to the traditional buildings on the campus.

Description: Interior

The main lobby on the interior of the Hub links the circular east wing that centered on a curving service area for post office and banking services (photo 6) with the central block bookstore. A circular soda fountain offered ice cream from the UF dairy program. Other food services, a barber shop, and ticket office completed the west end of the building. Inside the main lobby, pink marble stairs with metal rails formed a noteworthy entrance (photo 7). The second floor included a ballroom with stage and projection room, as well as a manager's apartment. An upstairs deck and offices with expansive windows overlooked the green to the south that would later link to the Reitz Union.

United States Department of the Interior
National Park Service

**NATIONAL REGISTER OF HISTORIC PLACES
CONTINUATION SHEET**

Section number 8 Page 1 THE HUB
Gainesville, Alachua Co., FL

SUMMARY

The Hub, built in 1950 as the Student Services Center and renamed by the students shortly thereafter, is significant at the **local and statewide levels** under **Criterion C** in the area of **Architecture** for its architectural style, which reflects International Modernism in contrast to the Collegiate Gothic style of the older buildings on the University of Florida campus. It was built with student funds and served multiple functions as a center for recreation, dining, social activities, and banking, and as the campus post office. Designed by UF graduate Andrew Ferandino, it was an informal gathering place for students in the center of campus and is significant under Criterion A in the area of Education as it represents the university's more progressive, modern approach to providing recreational and social facilities to an increasingly diverse student body, which now consisted of single men and women as well as married students. The Hub is nominated under the cover of the Multiple Property Submission for **University of Florida Campus Historic Resources, Gainesville, Alachua County, Florida**, under **Context III. The Post-World War II Campus, 1945-1956.**

Historical Background

The Florida Union, the first student center on the University of Florida campus, was built in 1936 in the Collegiate Gothic style. Fund-raising for this building was spearheaded by orator William Jennings Bryan, with major contributions from the YMCA. This building is now Dauer Hall (named for political science professor, Manning Dauer), which is used for classrooms and faculty offices, although part of the building formerly used as a dining hall was renovated in 1998 to provide a social space for faculty events (Keene Faculty Center). The influx of students following World War II created unprecedented demand for more academic and administrative space as well as student housing, but the social needs of the student body were not neglected. Designated as the Student Service Center when it opened in 1950, it was renamed "The Hub" after a campus-wide contest. In order to encourage students to engage in wholesome, on-campus activities, the Hub was originally designed with a soda fountain, a ballroom and projection room. Students could mail letters, pay fees, cash checks, pick up dry cleaning, buy a meal, and meet their friends for a light meal at this central location.¹ The J. Wayne Reitz Union replaced some of the functions of The Hub in 1967 when that new facility opened as the largest student union in the South.

Architectural Significance

The Hub, designed by Andrew Ferandino, a graduate of the University of Florida, is the only building of its kind on the campus, built in the International Moderne style with elements of Art Deco. Ferandino was a

¹ Samuel Proctor and Wright Langley. *Gator History: A Pictorial History of the University of Florida*. (Gainesville: South Star Publishing, 1986). 156, 175.

**United States Department of the Interior
National Park Service**

**NATIONAL REGISTER OF HISTORIC PLACES
CONTINUATION SHEET**

Section number 8 Page 2 THE HUB
Gainesville, Alachua Co., FL

member of a Miami architectural firm of Pancoast and Associates, headed by another UF graduate, Russell Pancoast. The firm was well known for its Moderne and Art Deco-style buildings in south Florida. The Hub design was primarily the concept of the project architect Ferendino, with Jefferson M. Hamilton as consulting architect for the University and Guy C. Fulton as Architect for the State Board of Control.² The architecture captured the spirit of the times, the modernist aesthetic that was expressed throughout the state in new shopping centers, hotels, and suburban housing in the 1950s.³

The design featured a sweeping curved covered walkway that linked the geometric composition of the rectilinear west arm and circular east end. The generous fenestration emphasized the architectural form and connected the large interior spaces to the campus. The architecture reflected new international modern ideas while linking with the early campus through continuity of materials, scale, and height.

Built without state tax dollars, this facility for student services was funded by student activity fees. The streamlined look of the Hub with its sweeping curves, horizontal lines, and jazzy angles appealed to the students, who made it a Mecca for their social activities.

Following prevailing standards for preservation and sustainability, the building was rehabilitated in 2006, restoring open spaces that had been obscured over the decades, preserving significant elements, and incorporating compatible new features. The Hub is now the home for international student services and academic technology, providing student services appropriate to a new era for the campus.

² Anne Catinna, "Years of Transition: Architecture on the University of Florida Campus, 1944-1956." Master's thesis, University of Florida. 1993. 79.

³ Catinna 24-25

**United States Department of the Interior
National Park Service**

**NATIONAL REGISTER OF HISTORIC PLACES
CONTINUATION SHEET**

Section number 9 & 10 Page 1 **THE HUB**
Gainesville, Alachua Co., FL

BIBLIOGRAPHY

Catinna, Anne. "Years of Transition: Architecture on the University of Florida Campus, 1944-1956." Master's thesis, University of Florida, 1993.

Garrett, Jennifer. "Finally Home, The University of Florida as a Microcosm of American Post World War II Residential Design." Master's thesis, University of Florida, 2005.

Kerber, Stephen. "William Edwards and the Historic University of Florida Campus: A Photographic Essay." *Florida Historical Quarterly*, Vol. LVII, No. 3, January, 1979, 327-336.

McCarthy, Kevin, and Murray D. Laurie. *Guide to the University of Florida and Gainesville*. Sarasota: Pineapple Press, 1997.

Proctor, Samuel, and Wright Langley. *Gator History: A Pictorial History of the University of Florida*. Gainesville: South Star Publishing, 1986.

University of Florida Campus Historic District, Listed on the National Register of Historic Places, 1989.

Van Ness, Carl, and Kevin McCarthy. *Honoring the Past, Shaping the Future*. Gainesville: University of Florida, 2003.

Whiffen, Marcus. *American Architecture Since 1780: A Guide to the Styles*. Cambridge, MA: MIT Press, 1981.

<http://www.cba.ufl.edu/publications/about/history> .

<http://www.arts.ufl.edu/carillon/history1.html>

GEOGRAPHIC INFORMATION

Verbal Boundary Description

The Hub is on the campus of the University of Florida, facing Stadium Road, which forms its northern boundary. The east boundary and the west boundaries are delineated by service roads that extend almost to the rear of the building. The southern boundary is the paved sidewalk that separates the Hub from the Union Lawn.

**United States Department of the Interior
National Park Service**

**NATIONAL REGISTER OF HISTORIC PLACES
CONTINUATION SHEET**

Section number 9 & 10 Page 2 **THE HUB**
Gainesville, Alachua Co., FL

Boundary Justification

The boundaries encompass the entire space historically associated with The Hub.

**United States Department of the Interior
National Park Service**

**NATIONAL REGISTER OF HISTORIC PLACES
CONTINUATION SHEET**

Section number _____ Photos _____ Page 1 **THE HUB**
Gainesville, Alachua Co., FL

PHOTOGRAPHS

- 1 The Hub, University of Florida
- 2. Gainesville, Alachua County, Florida
- 3. Professor Susan Tate
- 4. November 2006
- 5. Professor Susan Tate and Ms. Murray Laurie
- 6. View of N (main) façade, facing S
- 7. 1 of 9

Items 1-5 are the same for the remaining photographs.

- 6. View of N (main) façade at E end of covered walkway, facing S
- 7. 2 of 9

- 6. View of N (main) covered walkway, facing SW
- 7. 3 of 9

- 6. View of W and N elevations, facing E
- 7. 4 of 9

- 6. View of N elevation covered exterior walkway, facing E
- 7. 5 of 9

- 6. View of interior, original post office circle, facing W
- 7. 6 of 9

- 6. View interior, facing NE
- 7. 7 of 9

- 6. Interior marble stair from first floor, facing S
- 7. 8 of 9

- 6. Interior marble stair from second floor, facing S
- 7. 9 of 9

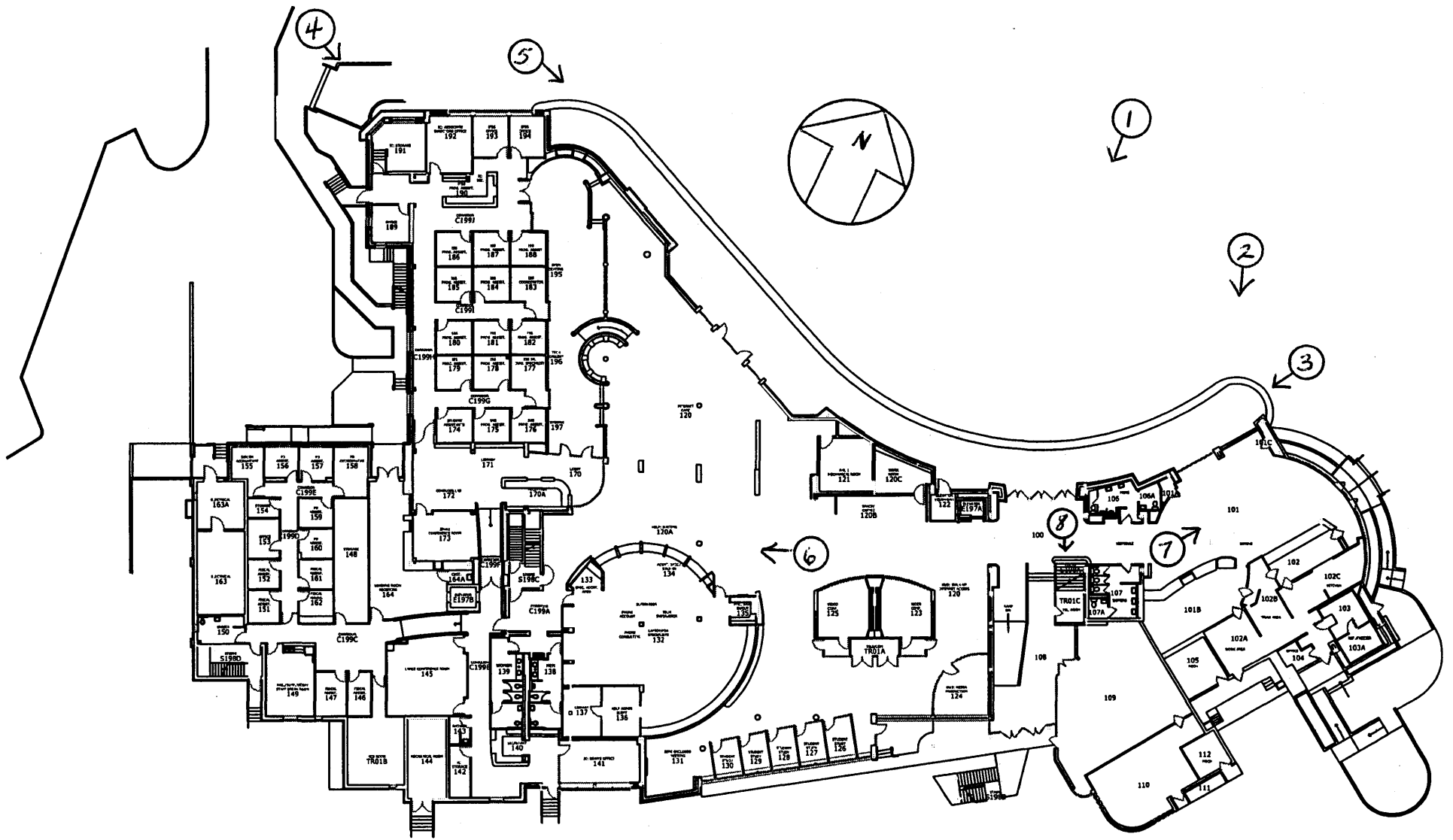

Scale: 1" = 40'

FIRST FLOOR

THE HUB
 University of Florida, Gainesville, Alachua County, Florida

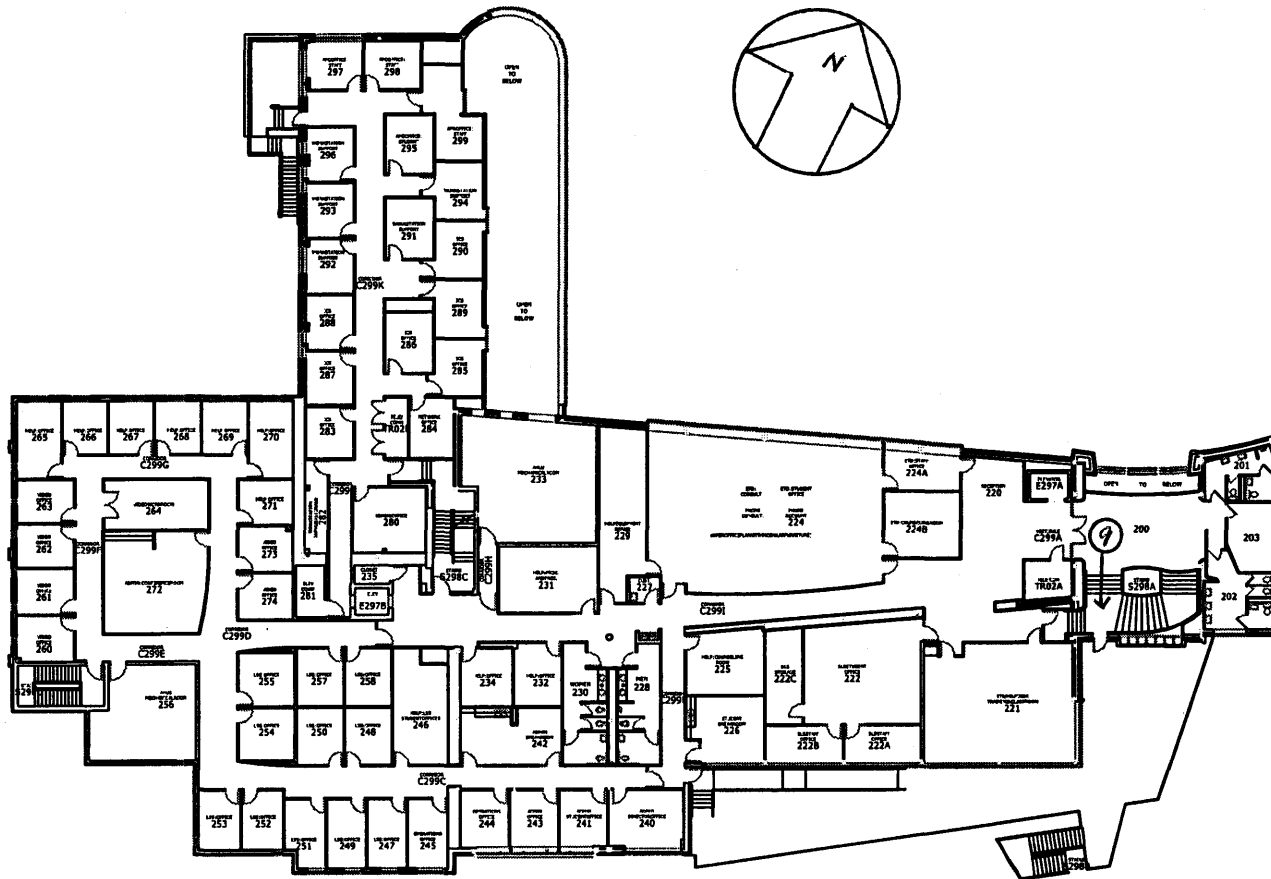

Scale: 1" = 40'

SECONDFLOOR

THE HUB
 University of Florida, Gainesville, Alachua County, Florida