

4298

United States Department of the Interior
National Park Service

National Register of Historic Places Registration Form



This form is for use in nominating or requesting determinations for individual properties and districts. See instructions in National Register Bulletin, *How to Complete the National Register of Historic Places Registration Form*. If any item does not apply to the property being documented, enter "N/A" for "not applicable." For functions, architectural classification, materials, and areas of significance, enter only categories and subcategories from the instructions. **Place additional certification comments, entries, and narrative items on continuation sheets if needed (NPS Form 10-900a).**

1. Name of Property

historic name Friendship Baptist Church Cemetery

other names/site number Lower / Old Friendship Baptist Church Cemetery

2. Location

street & number 3759 Friendship Road

X

not for publication

vicinity

city or town Buford

state Georgia code GA county Hall code 139 zip code 30519

3. State/Federal Agency Certification

As the designated authority under the National Historic Preservation Act, as amended,

I hereby certify that this X nomination request for determination of eligibility meets the documentation standards for registering properties in the National Register of Historic Places and meets the procedural and professional requirements set forth in 36 CFR Part 60.

In my opinion, the property X meets does not meet the National Register Criteria. I recommend that this property be considered significant at the following level(s) of significance:

national statewide X local

Dr. David C. Crass

Signature of certifying official/Title: Dr. David C. Crass/Historic Preservation Division Director/Deputy SHPO Date 2 JUL 2019

Historic Preservation Division, Georgia Dept. of Natural Resources

State or Federal agency/bureau or Tribal Government

In my opinion, the property meets does not meet the National Register criteria.

Signature of commenting official

Date

Title

State or Federal agency/bureau or Tribal Government

4. National Park Service Certification

I hereby certify that this property is:

✓ entered in the National Register

determined eligible for the National Register

determined not eligible for the National Register

removed from the National Register

other (explain:)

Bontalini

Signature of the Keeper

8/20/19
Date of Action

Friendship Baptist Church Cemetery
Name of Property

Hall County, Georgia
County and State

5. Classification

Ownership of Property

(Check as many boxes as apply.)

<input checked="" type="checkbox"/>	private
<input type="checkbox"/>	public - Local
<input type="checkbox"/>	public - State
<input type="checkbox"/>	public - Federal

Category of Property

(Check only **one** box.)

<input type="checkbox"/>	building(s)
<input type="checkbox"/>	district
<input checked="" type="checkbox"/>	site
<input type="checkbox"/>	structure
<input type="checkbox"/>	object

Number of Resources within Property

(Do not include previously listed resources in the count.)

Contributing	Noncontributing	
0	0	buildings
1	0	sites
0	0	structures
0	0	objects
1	0	Total

Name of related multiple property listing

(Enter "N/A" if property is not part of a multiple property listing)

N/A

Number of contributing resources previously listed in the National Register

N/A

6. Function or Use

Historic Functions

(Enter categories from instructions.)

FUNERARY: cemetery

Current Functions

(Enter categories from instructions.)

FUNERARY: cemetery

7. Description

Architectural Classification

(Enter categories from instructions.)

NO STYLE

Materials

(Enter categories from instructions.)

foundation: N/A

walls: N/A

roof: N/A

other: STONE: granite/marble; BRICK

Friendship Baptist Church Cemetery
Name of Property

Hall County, Georgia
County and State

Narrative Description

(Describe the historic and current physical appearance of the property. Explain contributing and noncontributing resources if necessary. Begin with a **summary paragraph** that briefly describes the general characteristics of the property, such as its location, setting, size, and significant features.)

Summary Paragraph

Friendship Baptist Church Cemetery, one of the oldest intact cemeteries in the area, is located northwest of the City of Buford in Hall County, approximately one mile from the Gwinnett County line in a once rural agricultural area off Friendship Road. The c.1854 cemetery is associated with the early settlement of this area after Hall and Gwinnett Counties were formed in 1818 from portions of Jackson County. The cemetery is associated with Friendship Baptist Church, organized c.1835. The church building is located approximately one-fourth of a mile away and is not included in this nomination due to lack of historic integrity. Within the cemetery there several hundred graves, with a majority of those marked dating from 1855 to the 1960s. A 2015 archeological survey done on the property noted the potential for unmarked graves in the cemetery, and church history and records indicate that there are many. The unmarked graves are throughout the cemetery with a concentration located in the center, which is also the location of the oldest marked burials. The earliest readable marker dates to 1854. Family plots are delineated by brick, block and granite curbing with many covered by crushed stone. Funerary art represented in the cemetery includes concrete, sandstone, granite and marble headstones, footstones, obelisks, and government-issued veteran markers. There are a variety of symbolic motifs represented, such as secular decorative elements including crosses, doves, lambs, flowers, open gates to heaven, crown & cross, as well as Masonic and Woodman of the World symbols. Burials in the cemetery include early settlers, farmers and veterans of the Revolutionary War, Civil War, World War I, World War II, the Korean War and the Vietnam War. Many generations of families are buried here including five generations of the Hays and Puckett families, as well as other influential families in the settlement of Hall County. Landscaping in the cemetery is informal with minimal mature trees including hickory, sycamore, oak, holly, and pine. The cemetery is raised approximately three feet above the surrounding land and is bordered by a circular paved driveway. The area surrounding the cemetery is primarily wooded with sparse 20th-century residential development. The cemetery retains a high level of integrity in feeling, setting, materials, and workmanship.

Narrative Description

NOTE: The following description was written by Teresa Owens, and minimally edited by Christy Atkins, National Register Historian, Historic Preservation Division, from "Friendship Baptist Church Cemetery," *Historic Property Information Form*, October 28, 2016. On file at the Historic Preservation Division, Georgia Department of Natural Resources, Atlanta, Georgia.

Friendship Baptist Church Cemetery is one of the oldest intact cemeteries in the surrounding area, and is a 1.51-acre cemetery located northwest of the City of Buford in Hall County, in a once rural agricultural area approximately one mile from the Gwinnett County line. The cemetery is associated with the early settlement of this area, with fifteen early settlers as founding members of Friendship Baptist Church in c.1835, and many of their descendants are buried in the cemetery. The current church building, located approximately one-fourth of a mile north of the cemetery property, was moved in 1848, had additions in 1848, 1961, 1964 and 1972. The church is not included in this nomination due to loss of historic integrity.

The cemetery sits on an open space raised three feet above the surrounding land and approximately 100 yards off Friendship Road. The landscaping throughout the cemetery is informal with minimal mature trees including a hickory tree in the middle of the cemetery (photograph 20), a sycamore tree near the front of the cemetery (photograph 18), and several pine, oak and holly trees near the rear of the cemetery (photograph 28). The area surrounding the cemetery is primarily wooded with sparse 20th century residential development that is minimally visible from the cemetery. The road that accesses the property from Friendship Road and encircles the cemetery was paved in the 1970s. Also, a chain link fence and gate is located at the front entrance of the cemetery that was added in the 1970s to help prevent potential vandalism.

It is understood that burials began at this location with the establishment of the Friendship Baptist Church congregation in the 1830s. Church history notes early settlers were buried here, and a 2015 Archeological report confirmed that there was the likelihood of many unmarked burials in the cemetery. The earliest legible burial marker dates to 1854 (photograph 12) for an infant of the Puckett family. There are approximately 305 marked burials and an estimated 57 unmarked burials. Unmarked burials are located throughout the cemetery, with a concentration found in the center area. This is also the

Friendship Baptist Church Cemetery

Name of Property

Hall County, Georgia

County and State

location of the oldest marked burials. The largest number of burials date to 1855 through the 1960s, with the highest number dating to 1890-1930. Modern markers are scattered throughout the cemetery, as it remains an active burial ground, however the vast majority of burials date to the historic period. Burials are in rows and east-west, with both east- and west-oriented markers.

Funerary art is represented in the cemetery by various materials, marker types and styles. Family plots are well defined and delineated by brick, block, and granite curbing, covered in crushed stone, and located throughout the cemetery (photograph 19, 23, 24, 25, 26, 27, 28, 29). Materials for markers include concrete (photograph 2), sandstone (photograph 14), granite (photograph 12, 13, 24, 25), and marble (photograph 3, 6). An array of marker types found in the cemetery include headstones (photograph 40), footstones (photograph 23), government-issued veteran markers, pedestal tomb with vaulted roof (photograph 34), obelisk (photograph 5), die-on-base (photograph 49), die-in-socket (photograph 26), lawn-type marker (photograph 51), plaque marker (photograph 28), pedestal tomb with urn (photograph 8), and more. An assortment of marker shapes represented in the cemetery include squared, rounded (photograph 37, 38), pillow, pointed (photograph 39, 41), obelisk (photograph 5), modified rounded (photograph 36) and more. There are a variety of symbolic motifs represented as well, including secular decorative elements like crosses, doves (photograph 37), lambs (photograph 31, 36), flowers, open gates to heaven (photograph 7), crown and crosses (photograph 26), as well as Freemason (photograph 15) and Woodman of the World (photograph 4) fraternal organization symbols. Government-issued military markers are found throughout the cemetery (photograph 19, 42, 50, 51, 52). The military markers represent soldiers from the Civil War, World War I, World War II, the Korean War and the Vietnam War. Spouses are often found paired together and children are buried near their parents. There are also several hand-carved markers (photographs 2, 10, 11, 53).

The following table is a sampling of burials, markers and symbols as identified by church volunteers:

Mary J Bailey (1888-1894): die-on-(double) base with Lamb representing purity and innocence (photograph 31).
Mary Robuck (1801-1885) and O.P. Robuck (1874-1914): two sided pulpit on base with open book representing knowledge and a symbol of Divine Word (photograph 16, 17).
A. C. Cleghorn (1846-1892): pulpit with gates representing the entrance to Heaven, a dove representing the Holy Spirit or Christianity, and ivy on the side representing friendship and immortality (photograph 9).
Mary Swansey (1849-1907): double base with an orb at the top symbolizing a celestial body and the deceased's Heavenly reward, a crown symbolizing glory of life after death on each side, oak leaves representing faith and virtue, fleur-de-lis representing passion and love (photograph 41).
Solomon Puckett (1821-1899): die-in-socket with rounded top, right hand with finger pointing up representing pathway to heaven (photograph 32).
E. R. Breedlove (1876-1900): scroll on a triple base with a raised anchor and cross symbol representing the Christian symbol of hope; located in the Wilbanks family plot (photograph 33).
Mary Cain (1833-1905): obelisk on a double base with a vaulted top, fleur-de-lis design on all sides representing passion and love (photograph 34).
John F M Cain (1839 – 1907): obelisk on a double base with a vaulted top, fleur-de-lis representing passion and love (photograph 35).
Marion Cain (1886-1906): obelisk on a double base with a vaulted top, fleur-de-lis representing passion and love (photograph 5).
Estie May Puckett (1906-1907): die-in-socket, dove with a lily representing the Holy Spirit, purity and innocence (photograph 37).
Amarintha Blankenship (1849-1908) and C.C. Blankenship (1848-1917): double die-in-socket on a double base with pointed top, curved sides and squared corners with a Masonic symbol (photograph 15).
William Cleo Mobley (1901-1902): die-in-socket with rounded top, dove representing the Holy Spirit (photograph 38).
Lucinda C Wheeler (1865-1890): pointed top, circle of roses and ivy, roses represent love, beauty and purity and the ivy represents friendship and eternal life; located in the Williams family plot (photograph 39).
Linsey Williams (1836-1903): rounded top with squared corners, Masonic symbol; located in the Williams family plot (photograph 40).
Stacey Mobley (1882-1909): die-in-socket with rounded top and double squared corners, circle with crown and cross representing Sovereignty of the Lord (photograph 6).
J. V. McDaniel (1869-1914): tree stump representing the Woodmen of the World organization, motto "Dum, Tace, Clamat", represents Though Silent He Speaks, calla lily representing beauty, and ivy represents friendship, eternal life or immortality (photograph 4).
Alfred Joe Puckett (1917-1918): squared headstone on base, five pointed star representing Star of Bethlehem;

Friendship Baptist Church Cemetery

Hall County, Georgia

Name of Property

County and State

located in the Puckett family plot (photograph 42).
Litha C. Wilbanks (1853-1927) and John L. Wilbanks (1853-unk): double headstone on double base, divided in center with squared top, a palm branch represents victory or rejoicing, urn represents immortality, fleur-de-lis on top represents passion and love, oak leaves represents victory; located in the Wilbanks family plot (photograph 43).
Floyd Williams (1895-1898): die-in-socket with a rounded top, lamb representing innocence; located in the Williams family plot (photograph 44).
Vesta A Puckett (1859-1886): die-in-socket with rounded top and rounded sides, clasp hands representing farewell and hope of meeting again in eternity; located in the Puckett family plot (photograph 45).
Ernest Coggins (1906-1906): die-in-socket with rounded top, dove representing Holy Spirit, a verse on the back says "Budded on earth, to bloom in Heaven" (photograph 46, 47).
Grady H Blankenship (1917-1919): die-in-socket on a double base with flat top and slanted corners, daisy leaf on each side and five daisy flowers design which represents innocence of a child (photograph 49).
Mandy J.O. Fraser (1875-1925): headstone on base with flat top and rounded corners, drape over top representing grieving, rosebud and ivy design representing love and undying affection, words "At Rest" (photograph 48).
Winnie Lou Blankenship (1904-1904): die-in-socket on base with rounded top and rounded corners, scroll design, lamb representing innocence (photograph 36).
Winnie Jane Roberts (1869-1909): die-in-socket on base with pointed top and rounded corners, circle with crown and cross representing sovereignty of the Lord, rosebuds representing death early in life; located in the Roberts family plot (photograph 41).

Friendship Baptist Church Cemetery
Name of Property

Hall County, Georgia
County and State

8. Statement of Significance

Applicable National Register Criteria

(Mark "x" in one or more boxes for the criteria qualifying the property for National Register listing.)

- ☒ A Property is associated with events that have made a significant contribution to the broad patterns of our history.
- ☐ B Property is associated with the lives of persons significant in our past.
- ☒ C Property embodies the distinctive characteristics of a type, period, or method of construction or represents the work of a master, or possesses high artistic values, or represents a significant and distinguishable entity whose components lack individual distinction.
- ☐ D Property has yielded, or is likely to yield, information important in prehistory or history.

Criteria Considerations

(Mark "x" in all the boxes that apply.)

Property is:

- ☐ A Owned by a religious institution or used for religious purposes.
- ☐ B removed from its original location.
- ☐ C a birthplace or grave.
- ☒ D a cemetery.
- ☐ E a reconstructed building, object, or structure.
- ☐ F a commemorative property.
- ☐ G less than 50 years old or achieving significance within the past 50 years.

Areas of Significance

(Enter categories from instructions.)

ART

EARLY EXPLORATION/SETTLEMENT

Period of Significance

c.1854-1969

Significant Dates

N/A

Significant Person

(Complete only if Criterion B is marked above.)

N/A

Cultural Affiliation

N/A

Architect/Builder

N/A

Period of Significance (justification)

The period of significance for Friendship Baptist Church Cemetery begins in c.1854, the date of the earliest legible marked burial, through 1969, the end of the historic period.

Criteria Considerations (explanation, if necessary)

Friendship Baptist Church Cemetery meets the requirements of Criteria Consideration D as a cemetery that derives its primary significance from age. The cemetery is a rare extant historic resource representative of early 19th century development of the area.

Friendship Baptist Church Cemetery

Name of Property

Hall County, Georgia

County and State

Statement of Significance Summary Paragraph (Provide a summary paragraph that includes level of significance and applicable criteria.)

Hall and Gwinnett Counties were created in 1818 from portions of Jackson County, and this area was sparsely settled by Revolutionary War land grantees. Friendship Baptist Church was established in c.1835 by fifteen early area settlers on land owned by one of the church founders. The Friendship Baptist Church Cemetery was likely established around the same time as the church. Many early settlers, planters and farmers, and military veterans are buried in the cemetery, with the earliest readable marked grave dating to 1854. The cemetery is significant under Criterion A in the area of exploration/settlement for its association with early white settlement in the area, now near the city of Buford, located in southern Hall County. As one of the oldest cemeteries in the area, the cemetery pre-dates the forming of nearby Buford and the Friendship General Militia District #1419 by 20 years or more. The cemetery is also significant under Criterion C in the area of art for its collection of grave markers that are representative of early 19th- to mid-20th-century markers found in church cemeteries in Georgia. The cemetery is significant at the local level of significance, as a good and intact early 19th-century cemetery associated with the exploration and settlement of this area.

Friendship Baptist Church Cemetery meets the requirements of Criteria Consideration D as a cemetery that derives its primary significance from age, its distinctive design features, and from its association with historic events – in this case the settlement of the area. The cemetery is a rare extant historic resource representative of early 19th century development of the Friendship community.

Narrative Statement of Significance (Provide at least **one** paragraph for each area of significance.)

Friendship Baptist Church Cemetery is significant at the local level under Criterion A in the area of exploration/settlement, as an intact cemetery associated with early white settlement of the area. This area was part of the older county of Franklin, established in 1784, created during an expansion of Georgia as a colony after the American Revolution. Jackson County was formed from this area in 1796 and Hall County was formed from this area in 1818. Friendship Baptist Church was established in c.1835, and read their first constitution in 1844. Friendship Baptist Church Cemetery is thought to have been established at the same time as the associated church. However, the earliest documented burial in the cemetery dates to 1854 for “Infant Daughter of Nimrod and Carline A. Puckett.” Oral history and church records indicate that there are earlier burials, but locations and markers have been lost over time. An archeological survey done in 2015 confirmed the likelihood of unmarked burials and location near the center of the cemetery, where the oldest marked burials are found. The many unmarked graves are thought to be of known early settlers of the area and members of the church. The cemetery is the final resting place for many of the area’s early settlers, planters and farmers, and their descendants. Also, many military veterans are interred at the cemetery and represent local service during many wars and conflicts over time. As one of the oldest cemeteries in the area, the cemetery pre-dates the forming of the nearby cities of Buford and Flowery Branch, as well as the Friendship General Militia District #1419, all by 20 years or more. Many generations of families are buried in Friendship Baptist Church Cemetery, including five generations of the Hays and Puckett families, as well as other influential families in the settlement of this area of Hall County.

Friendship Baptist Church Cemetery is also significant at the local level under Criterion C in the area of art, for its collection of grave markers that are representative of early 19th- to mid-20th century funerary art found in church cemeteries in Georgia. Funerary art is represented in the cemetery by various materials, marker types and styles. Materials include granite, sandstone, marble and concrete. Monument types include headstone, footstone, die-in-socket, die-on-base, lawn-type marker, plaque marker, obelisk, government-issued military, pedestal tomb – vaulted roof, and pedestal tomb – urn. Monument shapes represented include square, modified square, pointed, rounded, rounded with square corners, modified rounded, obelisk, and pillow. A variety of symbolic motifs are represented as well, including secular decorative elements such as crosses, doves, lambs, flowers, open gates to heaven, crown and crosses, as well as Freemason and Woodman of the World fraternal organization symbols. The latter can be found throughout the United States, but are most common in the South and Midwest. There are also several rudimentary hand-carved markers. The wide range of markers reflects the evolution of the cemetery from early white settlement of the area through the mid-20th century.

Although the cemetery is still active, the vast majority of the burials date to the historic period, and the cemetery retains a high level of historic integrity. Integrity of design, materials and workmanship is intact as the markers have not been damaged, vandalized or altered over time. The location, setting and feeling of the cemetery all retain integrity due to the cemetery’s location slightly away from the busy main road, and being surrounded by trees, obscuring neighboring

Friendship Baptist Church Cemetery

Name of Property

Hall County, Georgia

County and State

properties and any modern development. The cemetery retains integrity of association by the associated church still having an active congregation which is involved in maintaining the cemetery, and with many descendants of original settlers of the area continuing to be buried in the cemetery.

Developmental history/additional historic context information (if appropriate)

NOTE: The following narrative was written by Teresa Owens, and minimally edited by Christy Atkins, National Register Historian, Historic Preservation Division, from "Friendship Baptist Church Cemetery," *Historic Property Information Form*, October 28, 2016. On file at the Historic Preservation Division, Georgia Department of Natural Resources, Atlanta, Georgia.

The Friendship Baptist Church Cemetery is in an area of Georgia that was opened for white settlement in the late 18th century. The first counties of Georgia were formed from these lands, with Franklin County created in 1784. The area where the Friendship Baptist Church Cemetery is located today was once the southwest border of Franklin County and the Indian Territory. The first settlers were most likely Revolutionary War Soldiers who received land grants for their service, and were encouraged to settle near the borders. Most of this area was sparsely populated until 1796 when Jackson County was formed from a portion of Franklin County. Hall and Gwinnett counties were then formed in 1818 from Jackson County. Friendship Baptist Church and Friendship Baptist Church Cemetery was established in c.1835. The cemetery and its associated church were established long before the nearby City of Buford, incorporated in 1871, City of Flowery Branch, incorporated in 1874, and the area's Friendship General Militia District #1419, established in 1878.

The cemetery property is owned by Friendship Community Baptist Church, Inc. The grounds are maintained by members of Friendship Baptist Church, and burials still take place on occasion. According to a 1994 history of Friendship Baptist Church by Lorene Veal and Mary Puckett, church members first met under a brush arbor or clearing in the trees soon after the counties of Hall and Gwinnett were created in the early 1800s. As late as the 1950s, a sign attached to the front of the church building held the words "Established 1835." The origin of this date has not been fully documented besides church history, however the official constitution of the church occurred in 1844, according to a history of Friendship prepared for the Mulberry Baptist Association in 1888. The original building of Friendship Baptist Church was built between 1835 and 1844, when the first constitution was read. A deed from June 28, 1845 and recorded November 17, 1845 granted three acres from John Phillips, an early settler and founder of the church, for \$1 to the church, and is where the Friendship Baptist Church and cemetery are now located. The original church building was always located approximately one-fourth of a mile on the other side of the road from the Friendship Baptist Church Cemetery. The Church voted on November 13, 1948 to move the original building across the original Friendship Road (now Friendship Circle) to its present location, approximately 50 yards from the original location. Additions for Sunday school rooms were added in 1948, 1961 and again in 1964. The historic church building is still within part of the church, but now obscured by the additions. The church was also later bricked over and a new front entrance addition was added in 1972.

The first Elders of Friendship Baptist Church included Hiram Roberts, Robert Carlisle and Silas King. Hiram (Harden) Roberts (c.1782-1859) served as the first Pastor of Friendship Baptist Church from the Constitution in 1844 until 1846. Robert Carlisle (1793-after 1870) served as Pastor from 1846 to 1851. Silas King (c.1779-after 1868) served as Pastor of Friendship Baptist Church from 1854 to 1858. Silas King was an evangelical Baptist clergyman, and was the first non-Indian to occupy the area now known as Buford. He purchased 250 acres on March 10, 1822.

Other Early Churches and Cemeteries:

According to *Gwinnett Churches* by James C Flanigan, the first church in this area was Mount Moriah Baptist Church. The current building has a plaque on the side of the church that states that the congregation was established in 1779, the building was erected in 1953, and it was bricked in 1974. Mount Moriah Baptist Church was originally located in what is present day Hall County but moved to what is now Gwinnett County. The cemetery at this church dates to 1850, possibly earlier, with many unmarked burials located in the center. Shoal Creek Baptist Church, another area church, was established in 1823 by Rev. Samuel B. Crowe. This church and its associated cemetery had to be moved by the Army Corps of Engineers when Lake Lanier was inundated in 1956 and Buford Dam was built. There were 85 marked burials and 34 unmarked burials at that time. The only part of the historic church that remained in place was the foundation, which can be seen on an island across the shores of Shoal Creek Park when the lake level is very low. The pastor, Rev. Samuel B. Crowe also established Friendship Baptist Church around c.1835. Bethlehem United Methodist Church was established in 1825 by Dr. John Bowman. Its cemetery is hard to date due to many unmarked burials. Sardis Methodist Church (now

Friendship Baptist Church Cemetery

Name of Property

Hall County, Georgia

County and State

Holy Stump Korean United Methodist Church) was established in 1805, and the earliest legible burial marker in its associated cemetery dates to 1863. Earlier markers in this cemetery have weathered and are unreadable.

Although Mount Moriah Baptist Church is the oldest Baptist church in this area, it was moved to Gwinnett County. Sardis Methodist Church has changed congregations to Holy Stump Korean UMC. The oldest intact Methodist congregation still serving the community today is Bethlehem United Methodist Church, established in 1825. The oldest intact Baptist congregation still serving the community today is Friendship Baptist Church, established in c.1835. By the number of burials present in the Friendship Baptist Church Cemetery, it is evident that it and its associated church have been a central part of the community for almost 200 years.

Other cemeteries in the area are privately owned and family-oriented. Those not associated with a church include: Waters Family Cemetery, which dates to 1826 and has approximately 30 burials; Tuggle Family Cemetery, which dates to 1854 and has approximately 10 marked and numerous unmarked burials; Fraser Family Cemetery (Number 1), which dates to 1872 and has approximately 20 burials; Fraser Family Cemetery (Number 2), which dates to 1878 and has approximately 22 burials; Pirkle Family Cemetery, which dates to 1878 and has approximately 30 burials; and Sloan Family Cemetery, has only one grave dating to 1878.

Early Settlers:

Many of the internments in the Friendship Baptist Church Cemetery are of early settlers, their family and their descendants. Several of these people and families had a large impact on the formation and history of local communities, with remnants seen in the form of geographical items such as street names and prior ferry locations. Founding members of the Friendship Baptist Church in c.1835 included: John and Elizabeth Phillips, Harris and Sarah Puckett, Irwin and Catherine Smith, Elijah and Nancy Puckett, Martha Wills, Samuel B. and Sarah Crow, Thomas and Melinda Sloan, and George and Rebecca Sloan. Some of the identified people and brief associated history are as follows:

J.T. Orr (John Thomas Orr) (1852-1932). John Orr (J.T. Orr's father) (1807-1899), moved with his father Robert Orr (1775-after 1824), to Hall County by 1820. Robert Orr's father was John Orr (c.1760-1828) from Jackson County. The community of Orrsville in Gwinnett County at the Chattahoochee River was named for this family in 1839. This community was later destroyed due to the building of Buford Dam and the inundation of Lake Lanier in 1950s. John Orr (c.1760-1828), was a Revolutionary War Veteran (DAR number A112825). John Orr (b. 1807) married Celia Young (b.1824). Celia Young's Grandfather Robert Young (1760-1854) was an early settler to this area when it was Jackson County. Robert Young (1760-1828) was a Revolutionary War Soldier (DAR number A130211) and his father Stephen Young (c.1735-7 June 1812) was also a Revolutionary War Soldier (DAR number A201430). Robert Young came to this area while the Cherokees still resided here and built a twelve-room log cabin known as "Young's Tavern" located at the intersection of Hog Mountain Road and Old Federal Road at Atlanta Highway (now Falcon's Parkway/SR Hwy 23) in Flowery Branch. General Andrew Jackson and his staff lodged at this tavern at least on two occasions – once when the famed American Indian fighter's troops were marching to Fort Early in South Georgia on the old Federal Road to quell an Indian uprising there. On another occasion, Jackson was on his way to South Carolina to meet with President James Monroe to confer with him about the Monroe Doctrine. General Andrew Jackson offered to pay for his lodging and Robert Young declined to accept any payment. In appreciation, General Jackson presented his gracious host with a silver snuff box still in possession today of Robert Young's descendants.

Robert Young (1760-1854), William Nesbit (1785-1863), and Isham Williams (1776-1852) were commissioned by the government to lay out and build a trail from Ft. Daniel in Hog Mountain to Ft. Standing Peachtree on the Chattahoochee River and Peachtree Creek (today in Atlanta, Georgia). The trail they identified was eventually called Peachtree Road, a thoroughfare which is quite well-known today. Robert Young married Celia Strickland (1779-1837) in Hall County. Celia Strickland's father was Jacob Strickland (c.1741-1804) and was a Revolutionary War Soldier (DAR number A111340). Robert Young's son Robert Young, Jr. married Martha Louisa Winn (1828-1892). Martha's father was Richard Winn (1779-1847), who won the lot on the Hall County side of the Chattahoochee River in the 1820 land lottery, where Chief James Vann's 1805 ferry crossed the Chattahoochee River at Vann's Ferry. This is where the Federal Road crossed the Chattahoochee River in Flowery Branch. After Richard Winn took over the ferry on the Hall County side of the Chattahoochee River, it was then called Winn's Ferry. This ferry ran for almost 100 years and in 1956 the tavern that was built on the Forsyth County side of the Chattahoochee River was moved to New Echota and restored. Richard Winn's brother was Elisha Winn (1777-1842), who settled in the Hog Mountain area about 1805. He built a two-story log cabin and barn in Dacula, south of the Friendship area, where the first Superior Court of Gwinnett County was held after Gwinnett

Friendship Baptist Church Cemetery

Name of Property

Hall County, Georgia

County and State

County was formed in 1818. Richard and Elisha Winn's father was Thomas Winn (1750-1797) from Abbeville, South Carolina and was a Revolutionary War Soldier (DAR number A128768).

Millie Caroline Roberts (1837-1881) married Robert Longshore Marbut (1828-1886) in Gwinnett County. Robert was one of the first doctors in Buford. Millie Caroline Roberts' father was James Roberts (1800-1872), who lived in a log cabin built with twelve-inch logs, located at the intersection of Hog Mountain and Friendship Roads called "Roberts Crossroad." The log cabin was used as the first post office and trading post for the Friendship area. Later Col. James Roberts used it as a recruiting station for Civil War soldiers to sign up for the Georgia Militia.

James Collie Waters (1894-1967), served in WWI and was a descendant of the first Waters family that settled in Franklin County in the 1790s. He was the son of William Waters (1866-1941) and Sarah Phillips (1865-1944), and a descendant of Collenson Waters (c.1770-1826), who ran a stagecoach stop located on Friendship Road in the 1820s. After Collenson Waters died in 1826, his son Matthew J. Waters ran the stagecoach until the railroads became the popular mode of transportation. The stagecoach ran from this area to Jefferson, to Athens, to Washington and on to Augusta.

Linsey (Linzy) Williams (1836-1903), served in the military in CSA and owned Williams Mill on Mitchell Creek in the Friendship Community. The property is now a greenspace owned by Hall County. Williams ran the post office and general store in 1892, and also served as Pastor of Friendship Baptist Church from 1879 to 1888.

Solomon Puckett (1821-1899), who served in the military in CSA, and Nimrod Puckett (1823-1907), were sons of Harris Puckett, who came to the Friendship Community c.1827 with his wife, Alsabeth, and their 12 children from South Carolina, walking all the way pushing a two-wheeled cart with their only belongings. They lived under a rock shelter in the Friendship Community previously used by natives until they could build shelter for their family in 1828. This rock shelter is extant and located on property owned by Hall County, and is being developed as a park. Nimrod Puckett married Abigail Caroline (Carline) Bayley in 1845. They are the parents of the Puckett infant buried in the Friendship Baptist Church Cemetery. Five generations of this Puckett family are buried in the Friendship Baptist Church Cemetery. The Puckett's District in Gwinnett County, next to the Friendship Community, was established in 1870s and named for this Puckett family.

Elias D. Hays (1833-1908), served in the military in CSA. His father, Elias Hays (1799-1850), came to Georgia in 1830 with his wife Elizabeth and four children, and lived in the Friendship Community. Five generations of the Hays family are buried in the Friendship Baptist Church Cemetery. Enoch Hays (1896-1957), served as a Clerk and Deacon of Friendship Baptist Church and as a Justice of the Peace for the Friendship/Roberts District, as well as taught school in a one-room school in the Rabbit Hill community in nearby Gwinnett County.

John Francis Marion Cain (1839-1902), served in the Civil War along with brothers Cicero Columbus Cain (b.1844) and Clinton McDill Cain (b.1832). Clinton McDill Cain was a school teacher and farmer. John FM Cain married Mary Elizabeth Bailey (1833-1905) whose mother was known as Frances (b.1797 in South Carolina) and was half American Indian. John FM Cain's father was James J. Cain (1812-1871), and mother was Easter Skelton Cain (1812-after 1852). James J. Cain was a Baptist "Old Time Fire & Brimstone Preacher" at Friendship Baptist Church and Mt. Moriah Baptist Church nearby in Gwinnett County. James J. Cain's sons Marion (1826-1877) and William Anderson Cain (1819-1907) both served in the Civil War. William Anderson Cain was also a member of the Oddfellows, served on the Board of Education in 1870, and was Postmaster for the Grapevine Post Office from 1883 – 1891. John FM Cain's Grandfather John Marion Cain (b.1779) was listed in the 1820 South Carolina Pendleton Census but moved by 1830 to the Cain's District in Gwinnett County, adjacent to the Friendship Community. John Marion Cain was the first Postmaster at Cain's District, named for him.

Henry Byrd Fraser (1885-1948), and Grandfather Joseph Arthur Fraser (1812-1901) that was a winner of the 1832 Gold Land Lottery, drawing lot #282-2-1, in Cherokee County. Joseph Arthur Fraser and his brother John Milton Fraser served in the Civil War. Their father, Samuel Carroll Fraser, served in the War of 1812 during the Battle of Horseshoe Bend. Samuel Carroll Fraser is listed in the 1830 Hall County Census, and served in the Georgia Militia during the American Indian War of 1838. Samuel Carrol Fraser married Beersheba Hamilton in 1809. Beersheba Hamilton's father David Hamilton (1750-1837) served in the Revolutionary War. David Hamilton's father, David Hamilton (1725-1801), came to Pennsylvania from Scotland with four small children and later migrated to South Carolina. Five of David Hamilton's sons served in the American Revolution. This family furnished lumber, flour and food to the militia.

Andrew Sizemore (1868-1920), submitted an Eastern Cherokee application #17272 on the 1909 Guion Roll. His father was Seaborn Jones Sizemore (1844-1903), grandfather was Ephraim Sizemore (1804-1865), and great-grandfather was

Friendship Baptist Church Cemetery

Name of Property

Hall County, Georgia

County and State

Henry Tal Sizemore (unknown-c.1826). Henry Tal Sizemore came to Gwinnett County after 1820 and died before 1830. His wife and children are listed on the 1830 Gwinnett County Census. More than 2000 descendants of this Sizemore line submitted Eastern Band Cherokee applications in 1909 and listed on the Guion Roll, but all were denied for various reasons. In order to qualify, it was necessary for an applicant to prove a relationship to a Cherokee whose name had appeared on one of the Cherokee Census Rolls of 1835, 1848 or 1851. Those who made the decision to reject the Sizemore claims were clear in their statement that the Sizemore's were Indians, but since none of their ancestors had willingly registered in any Cherokee census, they were not accepted.

Due to its age, Friendship Baptist Church Cemetery contains burials of many soldiers that represent different eras of service in our country. Veterans identified by church volunteers buried in the Friendship Baptist Church Cemetery include:

Calvin Clinton Blankenship	b. 8 Aug 1848	d. 19 Dec 1917	CSA
Cicero C. Cain	b. 29 Oct 1844	d. 30 May 1916	CSA Co F GA INF 24th Regiment SGT
Clinton M. Cain	b. 1832	d. 1880	CSA Co F GA INF 24th Regiment
John Francis Marion Cain	b. 15 May 1839	d. 27 Nov 1902	CSA Co F GA INF 24th Regiment, PVT
Marion Cain	b. 6 May 1826	d. 1 Sept 1877	CSA Troop H, 10th Cavalry Regiment, Gwinnett County, 2nd Sargent
William Anderson Cain	b. 26 Apr 1819	d. 15 Feb 1907	CSA Troop H, 10th Cavalry Regiment, Gwinnett Co., Captain
Thomas A. Etheridge	b. unknown	d. unknown	CSA Co F GA INF 24th Regiment 24
Elias D. Hayes	b. 24 Jan 1833	d. 4 Dec 1908	CSA Co F GA INF 24th Regiment PVT
Cyrus V. Henry	b. 6 July 1836	d. 16 Dec 1915	CSA Co D GA INF 42nd Reg. PVT/SGT
John H. Puckett	b. 1826	d. 2 Nov 1862	CSA Co F GA INF 24th Regiment PVT
Solomon Puckett	b. 16 Feb 1821	d. 22 Mar 1899	CSA Co A GA VOL 2nd Reg., State Troops Cummings Brigade PVT
Seaborn Jones M. Sizemore	b. 25 May 1844	d. 23 Nov 1903	CSA Co H GA INF 35th Regiment PVT
David Swansey	b. 25 Oct 1845	d. 21 Nov 1924	CSA Co B GA CAVALRY 2nd Reg., 1864
Linsey Williams	b. 4 July 1836	d. 28 May 1903	CSA Co F GA INF 24th Regiment
James Collie Waters	b. 31 Aug 1894	d. 4 Jan 1967	WWI
Vyron Adams	b. 5 Oct 1933	d. 30 Sept 1988	US ARMY WWII
Virgil Beacham	b. 5 June 1922	d. 26 Sept 2003	US ARMY WWII PVT
Allen C Day	b. 5 May 1916	d. 29 May 1978	US ARMY WWII
Clarence Alton Jones	b. 17 May 1983	d. 11 Feb 1986	US ARMY WWII
Harley Thomas Jones	b. 2 Oct 1926/7	d. 2 April 1983	US ARMY WWII
Harold Puckett	b. 15 Nov 1924	d. 4 Mar 2014	US NAVY, US AMPHIBIAN FORCES
W. D. Swansey	b. 18 Sep 1916	d. 26 July 1987	US ARMY, WWII PVT
Felton R. Jack Swansey	b. 24 Nov 1913	d. 22 Jan 1984	US ARMY, WWII PVT
Byron J. Williams	b. 19 Sep 1917	d. 3 Dec 1953	WWII GA PVT 1853 SVC Comd Unit
Jerry Donald Williams	b. 11 Aug 1933	d. 20 Nov 1980	US ARMY
Bonnie Lee Harrison	b. 23 April 1932	d. 23 Mar 2013	KOREAN WAR
Kenneth W. Gilleland	b. 17 Jan 1946	d. 2 Feb 2007	VIETNAM, US ARMY SP4

Friendship Baptist Church Cemetery
Name of Property

Hall County, Georgia
County and State

9. Major Bibliographical References

Bibliography (Cite the books, articles, and other sources used in preparing this form.)

- Baughman, John W. and McCabe, Alice S. *Gwinnett County Schools, 1923*. Gwinnett Historical Society, 1991, p.61.
- Bishop, Eddie. *John Cain Family Research*. 2015.
- Buford, the Leather City*. Gainesville Times. 1973.
- Carlisle, Wanda. *Carlisle Family History Center*. 2010.
- Confederate Pension Applications, Georgia Confederate Pension Office. Georgia State Archives.
- Flanigan, J.C. *Gwinnett Churches*. 1911, p.9.
- Ford, John. *Orr Family Research*. 2009.
- Fraser, Michael. "Fraser Family Genealogy." Rootsweb (2013).
- Friendship Baptist Church. *Friendship Baptist Church Cemetery Directory Survey*. 1986.
- Georgia Archaeological Site Form. Official State Site No. 9HL608. July 18, 2015.
- Giddeon, Keith. "Georgia Civil War Soldier Index." www.rootsweb.com/~gagenweb/military/gsi/index.html.
- Gwinnett Historical Society. *Elisha Winn House*. 2001.
- Lucas Jr., Reverend S. Emmett. *1832 Gold Lottery of Georgia*. Southern Historical Press. 1988.
- Maner, Gary. "Waters Family Research." Rootsweb. 2013.
- Marbut, Scott. *Marbut Family Research*. 2007.
- McHugh, Matthew Lee and McHugh, Celena Russel Smith. *Celena (Lena) Jane Russell Smith – Her Ancestors, Descendant and Collateral Kinsmen*. 1974.
- Meeks, Angela. *Harden Roberts Family Research*. 2005.
- Membership applications of: John Orr A084225, Stephen Young A201430, Robert Young A13011, Thomas Winn A128768, Jacob Strickland A111340, Harden Roberts A096804; National Society Daughters of the American Revolution, Office of the Registrar General, Washington, D.C.
- McRay, Sybil. *Robert Young 1760-1854, Trailblazer of the Peach Tree Trail*. 1994.
- Owens, Teresa. "Friendship Baptist Church Cemetery," Historic Property Information Form, October 28, 2016. On file at the Historic Preservation Division, Georgia Department of Natural Resources, Atlanta, Georgia.
- Prince, Thelma Faye Cain. *Our Southern Ancestors, Descendants of Robert Young*. Monroe-Walton Library.
- Puckett, Robert. *Harris Puckett and His Ancestors*. 1991.
- Pugh, Agnes and Sharon Hudson. *Hayes Family Research*. 2010.

Friendship Baptist Church Cemetery

Name of Property

Hall County, Georgia

County and State

Quick Field Guide to Monument Types. Available at Historic Preservation Division, Stockbridge, Georgia. Chicora Foundation. 1999.

Reider, Bobby. *Silas King Family Research*. 2008.

Tabor, Anna Belle Little. *History of Franklin County, Georgia*. Franklin County Historical Society. 1986.

Tutton, Winnie. *Roberts Family Bible*.

Typical Gravestone Shapes. Available at Historic Preservation Division, Stockbridge, Georgia. *Cemetery Preservation, Restoration and Recording*. p.52.

United States Censuses, Hall County (1820-1940) and Gwinnett County (1820-1860)

United States Court of Claims, 1909. Eastern Band Cherokee applications: #17272, #36098, #36096, #38410, #38411, #38528, #35871, #25871, #21663, #16404, #35827, #34015, #15748, #35846, #35844, #35841, #36928, #36297, #36926, #22167, #17313, #9512, #14457, #11245, #35830, #21663, #35132, #2563, #2565.

Veal, Lorene and Puckett, Mary. *History of Friendship Baptist Church, 1844-1994*.

Veal, Lorene. *Sizemore Family Research*.

Wells, David A. *Linsey Williams Family Research*. 2015.

Previous documentation on file (NPS):

☐ preliminary determination of individual listing (36 CFR 67 has been requested)
☐ previously listed in the National Register
☐ previously determined eligible by the National Register
☐ designated a National Historic Landmark
☐ recorded by Historic American Buildings Survey # _____
☐ recorded by Historic American Engineering Record # _____
☐ recorded by Historic American Landscape Survey # _____

Primary location of additional data:

☒ State Historic Preservation Office
☐ Other State agency
☐ Federal agency
☐ Local government
☐ University
☐ Other
Name of repository: _____

Historic Resources Survey Number (if assigned): _____

Friendship Baptist Church Cemetery
Name of Property

Hall County, Georgia
County and State

10. Geographical Data

Acreage of Property 1.51 acres

Latitude/Longitude Coordinates
(enter coordinates to 6 decimal places)

1. **Latitude:** 34.12570

Longitude: -83.92020

UTM References

(Place additional UTM references on a continuation sheet.)

1	<u>17 S</u> Zone	<u>230696</u> Easting	<u>3779767</u> Northing	3	<u> </u>	<u> </u>	<u> </u>
2	<u> </u> Zone	<u> </u> Easting	<u> </u> Northing	4	<u> </u>	<u> </u>	<u> </u>

Verbal Boundary Description (Describe the boundaries of the property.)

The boundary of the nominated property is delineated by a thick black line on the attached tax parcel map.

Boundary Justification (Explain why the boundaries were selected.)

The boundary of the nominated property is the current legal boundary of the intact acreage historically associated with the Friendship Baptist Church Cemetery. The boundary line coincides with the parcel boundary, which runs along the circular drive around the cemetery.

11. Form Prepared By

name/title Christy Atkins, National Register Historian

organization Historic Preservation Division, GA Dept. of Natural Resources date July 2, 2019

street & number 2610 GA Hwy 155, SW telephone 770-389-7844

city or town Stockbridge state GA zip code 30281

e-mail Christy.atkins@dnr.ga.gov

Additional Documentation

Submit the following items with the completed form:

- **Maps:** A **USGS map** (7.5 or 15 minute series) indicating the property's location.

A **Sketch map** for historic districts and properties having large acreage or numerous resources. Key all photographs to this map.

- **Continuation Sheets**
- **Additional items:** (Check with the SHPO or FPO for any additional items.)

Friendship Baptist Church Cemetery

Name of Property

Hall County, Georgia

County and State

Photographs:

Submit clear and descriptive photographs. The size of each image must be 1600x1200 pixels at 300 ppi (pixels per inch) or larger. Key all photographs to the sketch map.

Name of Property: Friendship Baptist Church Cemetery
City or Vicinity: Buford vicinity
County: Hall State: Georgia
Photographer: Teresa Owens
Date Photographed: October, 2014 - August, 2015

Description of Photograph(s) and number:

- 1 of 53: Friendship Baptist Church Cemetery; photographer facing southeast.
- 2 of 53: Swansey family plot; photographer facing east.
- 3 of 53: Swansey family plot; photographer facing east.
- 4 of 53: McDaniel family plot; photographer facing east.
- 5 of 53: Cain family plot; photographer facing east.
- 6 of 53: Mobley family plot; photographer facing east.
- 7 of 53: Henry family plot; photographer facing east.
- 8 of 53: Swansey family plot; photographer facing east.
- 9 of 53: Cleghorn family plot; photographer facing east.
- 10 of 53: Phillips family plot; photographer facing east.
- 11 of 53: Phillips family plot; photographer facing east.
- 12 of 53: Puckett family plot; photographer facing east.
- 13 of 53: Puckett family plot; photographer facing east.
- 14 of 53: Puckett family plot; photographer facing west.
- 15 of 53: Blankenship family plot; photographer facing west.
- 16 of 53: Robuck family plot; photographer facing west.
- 17 of 53: Robuck family plot; photographer facing east.
- 18 of 53: Friendship Baptist Church Cemetery; photographer facing northeast.
- 19 of 53: Friendship Baptist Church Cemetery; photographer facing north.
- 20 of 53: Friendship Baptist Church Cemetery; photographer facing east.
- 21 of 53: Friendship Baptist Church Cemetery; photographer facing north.
- 22 of 53: Friendship Baptist Church Cemetery; photographer facing north.
- 23 of 53: Friendship Baptist Church Cemetery; photographer facing north.
- 24 of 53: Puckett family plot; photographer facing northwest.
- 25 of 53: Friendship Baptist Church Cemetery; photographer facing west.
- 26 of 53: Friendship Baptist Church Cemetery; photographer facing west.
- 27 of 53: Friendship Baptist Church Cemetery; photographer facing south.
- 28 of 53: Friendship Baptist Church Cemetery; photographer facing south.
- 29 of 53: Friendship Baptist Church Cemetery; photographer facing south.

Friendship Baptist Church Cemetery

Name of Property

Hall County, Georgia

County and State

- 30 of 53: Friendship Baptist Church Cemetery; photographer facing east.
- 31 of 53: Bailey family plot; photographer facing east.
- 32 of 53: Puckett family plot; photographer facing east.
- 33 of 53: Breedlove family plot; photographer facing east.
- 34 of 53: Cain family plot; photographer facing east.
- 35 of 53: Cain family plot; photographer facing east.
- 36 of 53: Blankenship family plot; photographer facing west.
- 37 of 53: Puckett family plot; photographer facing west.
- 38 of 53: Mobley family plot; photographer facing east.
- 39 of 53: Wheeler family plot; photographer facing east.
- 40 of 53: Williams family plot; photographer facing east.
- 41 of 53: Roberts family plot; photographer facing west.
- 42 of 53: Puckett family plot; photographer facing west.
- 43 of 53: Wilbanks family plot; photographer facing east.
- 44 of 53: Williams family plot; photographer facing east.
- 45 of 53: Puckett family plot; photographer facing east.
- 46 of 53: Coggins family plot; photographer facing east.
- 47 of 53: Coggins family plot; photographer facing west.
- 48 of 53: Fraser family plot; photographer facing west.
- 49 of 53: Blankenship family plot; photographer facing west.
- 50 of 53: Waters family plot; photographer facing west.
- 51 of 53: Day family plot; photographer facing west.
- 52 of 53: Gilleland family plot; photographer facing northwest.
- 53 of 53: Phillips family plot; photographer facing east.

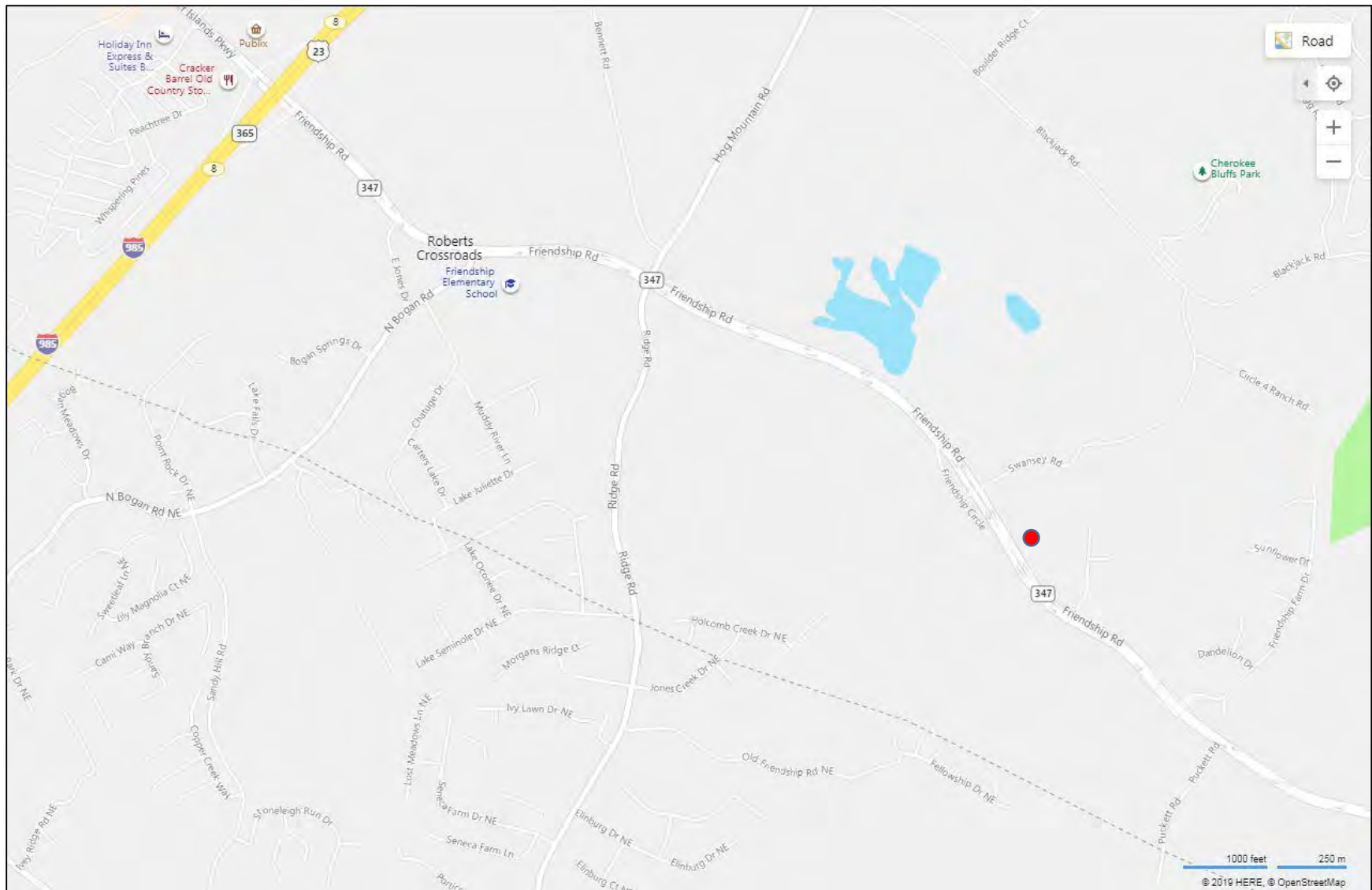

Friendship Baptist Church Cemetery
3759 Friendship Road
Buford vicinity, Hall County, Georgia
North: 
Lat, Long: 34.12570, -83.92020

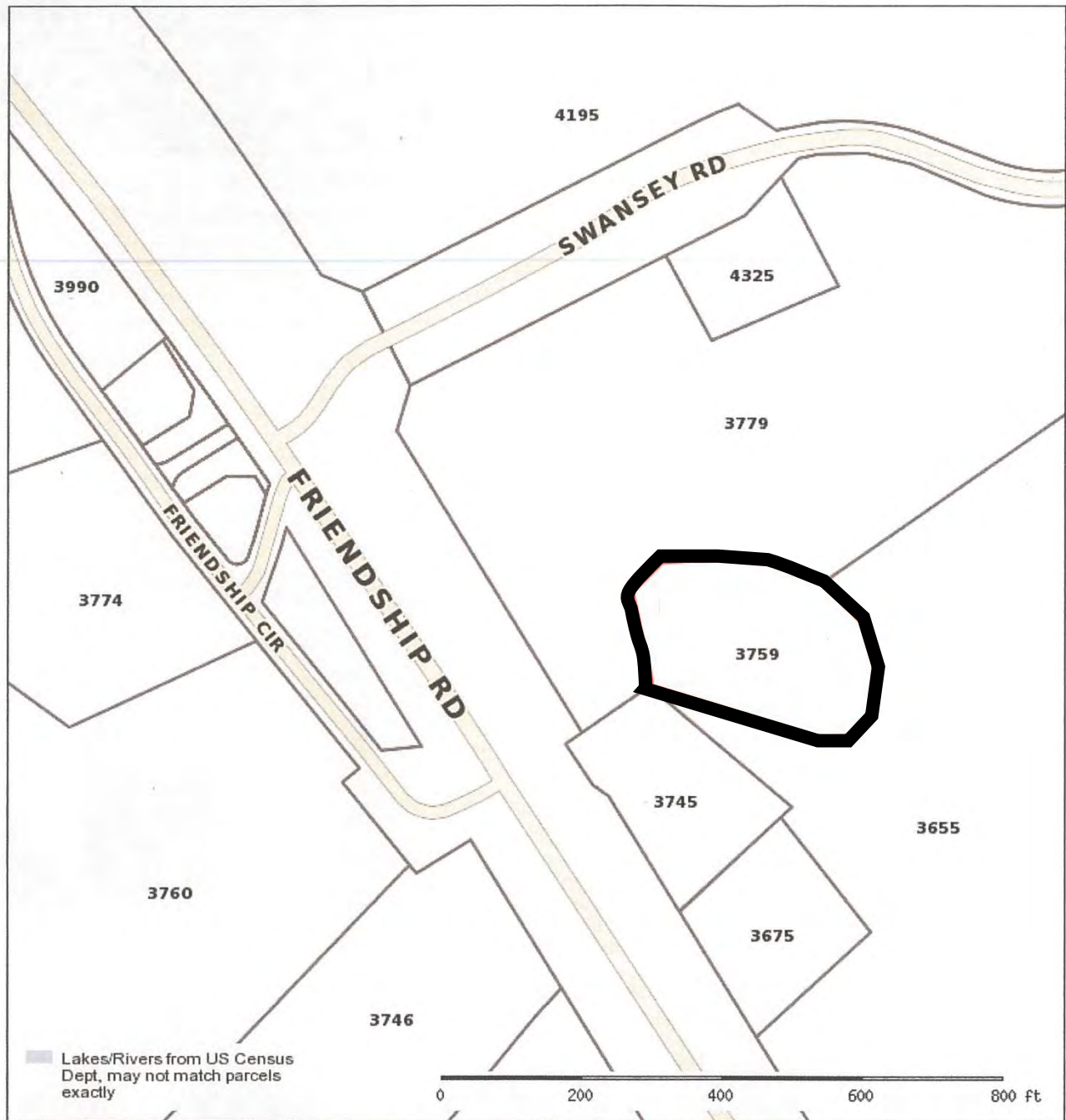

Friendship Baptist Church Cemetery			
Parcel: 15048 000064 Acres: 1.51			
Name:	FRIENDSHIP COMMUNITY BAPTIST CHURCH, INC	Land Value:	\$69,000.00
Site:	3759 FRIENDSHIP RD	Building Value:	\$0.00
Sale:	\$0 on 07-2009 Reason=26 Qual=U	Misc Value:	\$0.00
Mail:	3990 FRIENDSHIP RD. BUFORD, GA 30519	Total Value:	\$69,000.00

Hall County makes every effort to produce the most accurate information possible. No warranties, expressed or implied, are provided for the data herein, its use or interpretation. The assessment information is from the last certified taxroll. All data is subject to change before the next certified taxroll.
 Date printed: 07/06/16 : 15:08:51

Friendship Baptist Church Cemetery
 3759 Friendship Road
 Buford vicinity, Hall County, Georgia

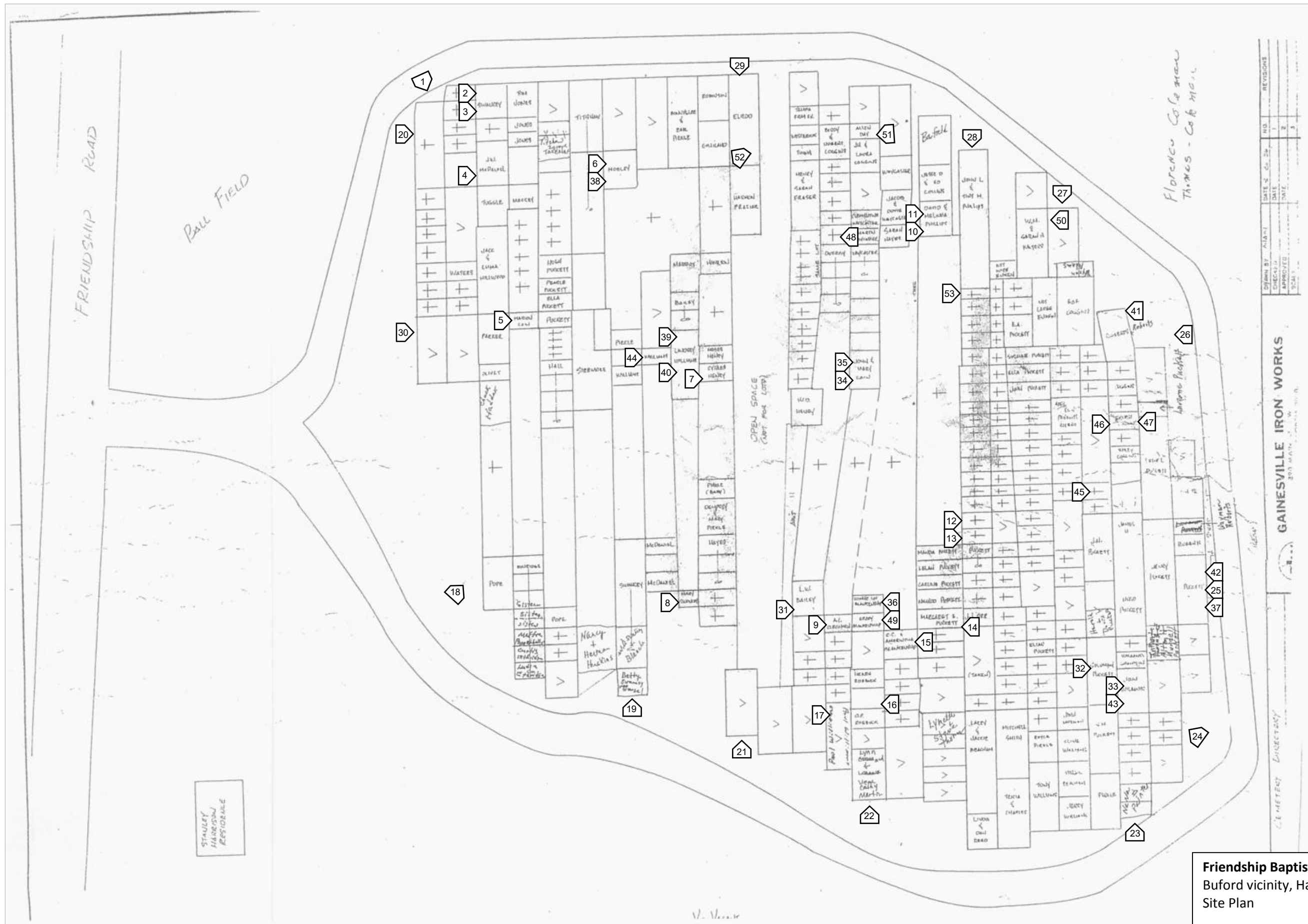

DATE	BY	NO.	REVISIONS
DATE	DATE	1	1
DATE	DATE	2	2
DATE	DATE	3	3

GAINESVILLE IRON WORKS



C. H. METZGER

Friendship Baptist Church Cemetery
 Buford vicinity, Hall County, Georgia
 Site Plan

North:
 Photograph #/Direction of View:
 Scale: Not to Scale



TITSHAW

TITSHAW





JOHN B. BROWN

BORN

MAY 24

1844

DIED

JULY 28

1908



L. S. WAITISEN
OCT. 23, 1869
NOV. 22, 1924



JOHN W. TITSHAW
SEP 27 1869
DEC 12 1914
IN DEAR
SLEEP ON
FOR
OUR MAILS
THINKS
OF YOU

TITSHAW
JOHN W.
1869-1914

TITSHAW
JOHN W.
FOR GOD SO LOVED THE WORLD
THAT HE GAVE HIS ONLY
SON







THE
GRAVE
OF
JAMES
W. HARRIS
BORN
JAN 10 1845
DIED
MAY 15 1915
WIFE
OF
JAMES W. HARRIS
BORN
JAN 10 1845
DIED
MAY 15 1915



CYRUS V. HENRY
BORN JULY 6, 1838
DIED DEC. 16, 1915

ELIAS D.
HAYES
BORN
JAN 24 1833
DIED
DEC 4 1908

MARY E.
WIFE OF
JAMES
SWANSEY
BORN
JUN 10 1849
DIED
JUL 9 1907

A dark grey granite gravestone for A.C. GLENNON. The stone is rectangular with a wide base and a narrower top section. The top section features a large, arched, recessed area containing a stylized, carved image of a classical building with columns. Below this arch, the inscription is carved in a simple, sans-serif font. The stone is set in a grassy field with scattered brown leaves. Other gravestones are visible in the background.

A.C. GLENNON
BORN AUG. 27, 1848
DIED DEC. 26, 1912

DAVID PHILLIPS

OCT. 28. 1820

FEB. 9. 1906

AT REST

RALPH
PHILLIPS

WILLIAM
DEAN
SEPT. 9, 1819
NOV. 26, 1896
ASLEEP

DECEASED

WILLIAM
DAVIDSON
N. S. GAY
PICKETT
BORN 1810
DIED 1880
PROPRIETOR

WILLIAM
ALLEN
N. & B. A.
BUCKETT
BORN & DIED
1854
MAY 10 1890



CLARENCE SHAW BLANKS
JAN. 29 1848 - AUG. 18 1917
JULY 16 1908 - DEC. 19 1917
AT REST AT REST
Decorative scrollwork

MARY
ROBBER
DIED SEP
17, 1860
AGE
61 YEARS

JOHN
ROBERTSON
DIED DEC
21 1874
AGE
40 YEARS

HUSBAND OF
JANE ROBERTSON

ROBERTSON















PUCKETT

HENRY I. OCT. 23, 1891 SEPT. 29, 1950	SARAH M. JUNE 25, 1885 MAY 2, 1963
---	--

PUCKETT

GROVER H. MAY 16, 1912 OCT. 5, 1990	SARAH L. NOV. 3, 1914 MAY 11, 1987
---	--

MARY L. PUCKETT
JULY 29, 1932
AT REST





Winnie Jane
ROBERTS
BORN
SEPT. 29, 1869
DIED
DEC. 11, 1909

ROBERTS
WINNIE JANE
BORN SEPT. 29, 1869
DIED DEC. 11, 1909
ANDREW
BORN SEPT. 19, 1869
DIED SEPT. 11, 1909

COGGINS









ANDREW A.
PARKER
APR. 25, 1878 - NOV. 3, 1948
AT REST

WILLIAM V. WORTH
HADDOX



And though the world is full of sorrow
And though the world is full of pain
But let the world be full of love





WILLIAM
BANKS
BORN
JULY 27, 1876
DIED
FEB 13, 1900

Remains of the body of
the deceased were
interred in the
casket of the deceased

WILLBANKS

MARY E.
WIFE OF
JOHN F. M.
CANN
BORN
JUNE 13, 1838
DIED
JUNE 14, 1905

CANN



JOHN E. CAIN
BORN
MAY 15 1839
DIED
NOV 27 1902

Gather thou dust from
this
the region far above
where thou rest this stone
inscribed by our family

JOHN E. CAIN

CAIN



WINNIE LOU
DAUGHTER OF
T. D. & PEARL
BLANKENSHIP
BORN
SEPT. 25, 1904
DIED
DEC. 18, 1904

Could be an angel



ESTHER
PUCHE
BOEN
DEC. 23, 1903
DIED
JULY 3, 1961
AGE 57



WILLIAM
CEEO
MOBLEY
NOV 30 1890
APR 23 1902



WILLIAM S. STANLEY
BORN 1850
DIED 1910
Aged 60 years





ALFRED JOE
PUCKETT

MAY 23, 1917

JUNE 25, 1918

LITHA C.
WILLBANKS
MAR. 15 1853
JUNE 3 1927

She was the sun-
shine of our home

JOHN L.
WILLBANKS
SEPT. 12 1853

Come to a bright
home
Where grief only
can come

MOTHER & FATHER









JOHN J. BROWN
BORN 1845
DIED 1905

FRASIER

MANDY J. O.

NOV. 28, 1875

DEC. 2, 1925



FRANK E. WILLIAMS
BORN 1871
DIED 1941
JULY 10
1941



JAMES COLLIE WATERS
GEORGIA

PVT 130 INFANTRY
WORLD WAR I

AUG 31 1894 JAN 4 1967



ALLEN C DAY

PVT US ARMY

WORLD WAR II

1916

1978



KENNETH W GILLELAND

SP4 US ARMY

VIETNAM

JAN 27 1946 FEB 2 2007



JOHN H. DEDD
MAY 10 1870
OCT 10 1907

UNITED STATES DEPARTMENT OF THE INTERIOR
NATIONAL PARK SERVICE

NATIONAL REGISTER OF HISTORIC PLACES
EVALUATION/RETURN SHEET

Requested Action: Nomination

Property Name: Friendship Baptist Church Cemetery

Multiple Name:

State & County: GEORGIA, Hall

Date Received:
7/9/2019

Date of Pending List:
7/30/2019

Date of 16th Day:
8/14/2019

Date of 45th Day:
8/23/2019

Date of Weekly List:

Reference number: SG100004298

Nominator: SHPO

Reason For Review:

☐ Appeal

☒ SHPO Request

☐ Waiver

☐ Resubmission

☐ Other

☐ PDIL

☐ Landscape

☐ National

☐ Mobile Resource

☐ TCP

☐ CLG

☐ Text/Data Issue

☐ Photo

☐ Map/Boundary

☐ Period

☐ Less than 50 years

☒ Accept

☐ Return

☐ Reject

8/20/2019 Date

Abstract/Summary AOS: Exploration/Settlement, Art; POS: c. 1854-1969; LOS: local
Comments:

Recommendation/ NR Criteria: A & C
Criteria

Reviewer Lisa Deline

Discipline Historian

Telephone (202)354-2239

Date

8/20/19

DOCUMENTATION: see attached comments : No see attached SLR : No

If a nomination is returned to the nomination authority, the nomination is no longer under consideration by the National Park Service.



GEORGIA

DEPARTMENT OF NATURAL RESOURCES

HISTORIC PRESERVATION DIVISION

MARK WILLIAMS
COMMISSIONER

DR. DAVID CRASS
DIVISION DIRECTOR

July 2, 2019

Kathryn Smith
National Park Service
National Register of Historic Places
1849 C St, NW, Mail Stop 7228
Washington, D.C. 20240



Dear Ms. Smith:

The enclosed disk contains the true and correct copy of the nomination for the **Friendship Baptist Church Cemetery** in **Buford, Hall County, Georgia** to the National Register of Historic Places.

- ☒ Disk of National Register of Historic Places nomination form and maps as a pdf
- ☒ Disk with digital photo images
- ☒ Physical signature page
- ☐ Original USGS topographic map(s)
- ☐ Sketch map(s)/attachment(s)
- ☐ Correspondence
- ☐ Other:

COMMENTS:

- ☒ Please ensure that this nomination is reviewed
- ☐ This property has been certified under 36 CFR 67
- ☐ The enclosed owner objection(s) do ☐ do not ☐ constitute a majority of property owners.
- ☐ Special considerations:

Sincerely,

Olivia Head
National Register Specialist