

KENTUCKY HISTORIC RESOURCES  
Individual Inventory Form

Resource # ME-184  
Mercer County

1. Name of Resource: Wildwood

2. Original Owner: W. W. Goddard

3. Other Names: None

4. Prehistoric Site Building  Object  
Historic Site Structure Other

5. Location: 388 Curry Pike

6. Owner's Name: Mr. and Mrs. Ralph Anderson [ P ]

7. Owner's Address: 8725 Deep Run Lake  
Cincinnati, Ohio 45243

8. Evaluation: [ N ]

9. Recognition & Date:  
Nat.Landmark \_\_\_\_\_ Local Landmark \_\_\_\_\_  
Nat.Register \_\_\_\_\_ HABS/HAER \_\_\_\_\_  
Highway Marker \_\_\_\_\_ KY Inventory 1985 \_\_\_\_\_  
KY Landmark Certificate \_\_\_\_\_

10. N.R.Status & Date:

11. N.R.Group:  
District Name: [ ]  
Mult.Resource Area: Mercer Co. [ ]  
Thematic Name: [ ]

12. Historical Theme:  
Primary: Architecture [030 ]  
Secondary: [ ]  
Other: [ ]

13. Statement of Significance:  
See Attached.

16. Date: Original Building c. 1870 [ 4 ]  
Addition [ ]

17. Style: Italianate [ 42 ]  
[ ]

18. Architect/Builder: Unknown

19. No. of Stories: Two [ 2.0 ]

20. Original Floor Plan: T-plan [ TP ]

21. Single Pile Double Pile  N.A.

22. Roof Form & Material: Original   
Gable/Tin Not Original

23. Structural Material: Brick [ B ]

24. Exterior Material: [ B ]  
Brick : common bond [ ]

25. Foundation Material: Stone [ S ]

26. Major Alterations: None  
Moved/Rebuilt Other Addition of  
Additions bathrooms in 1950

27. Special Features: None

28. Outbuildings: None [ ]

29. Original Function: Residence [ 01A ]

30. Present Use: Residence [ 01A ]

31. Condition: Good [ G ]

32. Endangered: Yes \_\_\_\_\_  
No

33. Attach Photos:  
Roll: Photo Nos: No. of Slides:  
2 24-30

14. History:

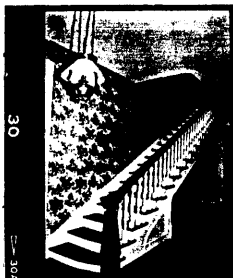

15. Source of historical information and/or contact person: Frances Keightley

34. Prepared by: F. Keightley/H. Powell

35. Organization: Hrdsbrg./Merc. Co. Landmark Association

36. Date: 1986

37. New Survey  Resurvey \_\_\_\_\_

KENTUCKY HISTORIC RESOURCES  
 Individual Inventory Form

Resource # Me-184

38. UTM Point of Primary Building: Quadrant: <u>HARRISBURG</u>	Zone <u>16</u>	Easting <u>692620</u>	Northing <u>4186260</u>	39. G.I.S. Mod. [ ]
				40. Coord. Accuracy [ ]
41. UTM Points of Boundary (for N. R. eligible sites only):				
A. -----				D. -----
B. -----				E. -----
C. -----				F. -----
42. Total Acreage in Present Property:		43. Acreage included in proposed N.R. boundary:		
44. Site Plan (and boundary description and justification for N.R. sites):				

See attached

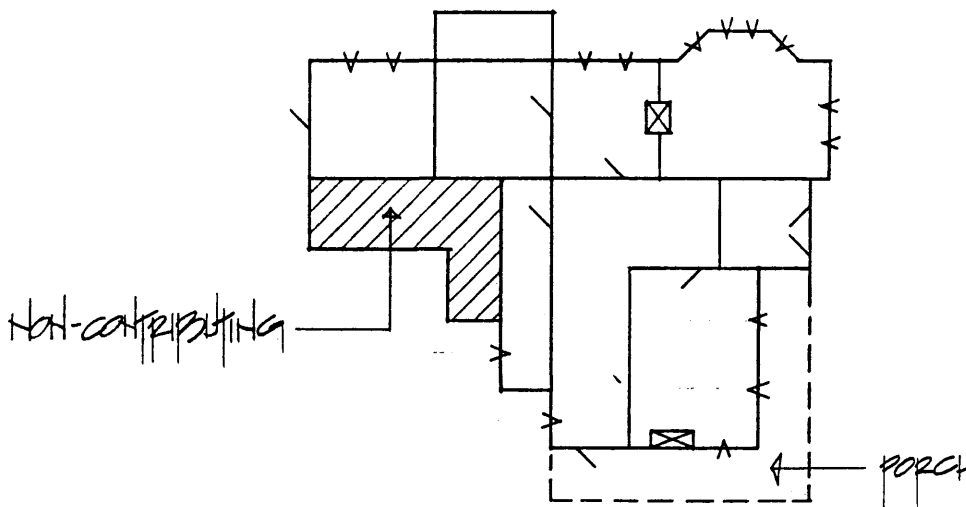

45. Description and House Plan:

Wildwood is a brick two-story Italianate residence. The floorplan is basically that of a T-plan with a three-story tower positioned at the juncture of the arms of the T. The front facade is five bays with a central entrance through the tower. A one-story wraparound porch links the exterior doors on the north and east facades. The doors and windows are segmentally arched with stone sills and brick hood moldings. The windows are 2/2 with interior wooden shutters. The roof has sections of both hip and gable with centralized brick chimneys. The main entrance has a double-leaf door. The eaves overhang. The brick on the facades is running bond. The major changes which have occurred to the structure include the addition of rooms to the rear for bathrooms in the 1950's and the alteration of the tower roof due to storm damage in the 1940's. The tower now has a flat roof.

14. History:  
 The owner of Wildwood was William W. Goddard known throughout Mercer County as a tobacco grower, cattle breeder, horseman, and staunch supporter fo the southern cause during the Civil War. The house was bought from the Goddard family in 1917 by James T. Patterson.

KENTUCKY HISTORIC RESOURCE INVENTORY SUPPLEMENT  
BOUNDARY AND LOCATION INFORMATION

Historic Property Name Wildwood Site # ME-184

Multiple Resource/Thematic Nomination Title MERCER COUNTY MRA

U.T.M. Coordinates - List multiple UTMs if property is ten or more acres.

A. \_\_\_\_\_ D. \_\_\_\_\_

B. \_\_\_\_\_ E. \_\_\_\_\_

C. \_\_\_\_\_ F. \_\_\_\_\_

Verbal Boundary Description \_\_\_\_\_ Acreage 1.6

From a point of beginning 50 feet east and 59 feet north of the northeast corner of the building; then south 227 feet to a point; then west 296 feet to a point; then north 227 feet to a point; then east 296 feet to the point of beginning.

The boundary contains all elements contributing to the domestic space.

The nominated area includes one contributing building.

Sketch of Site Plan (Showing outbuildings, structures, landscape features and the site boundary as described above.)

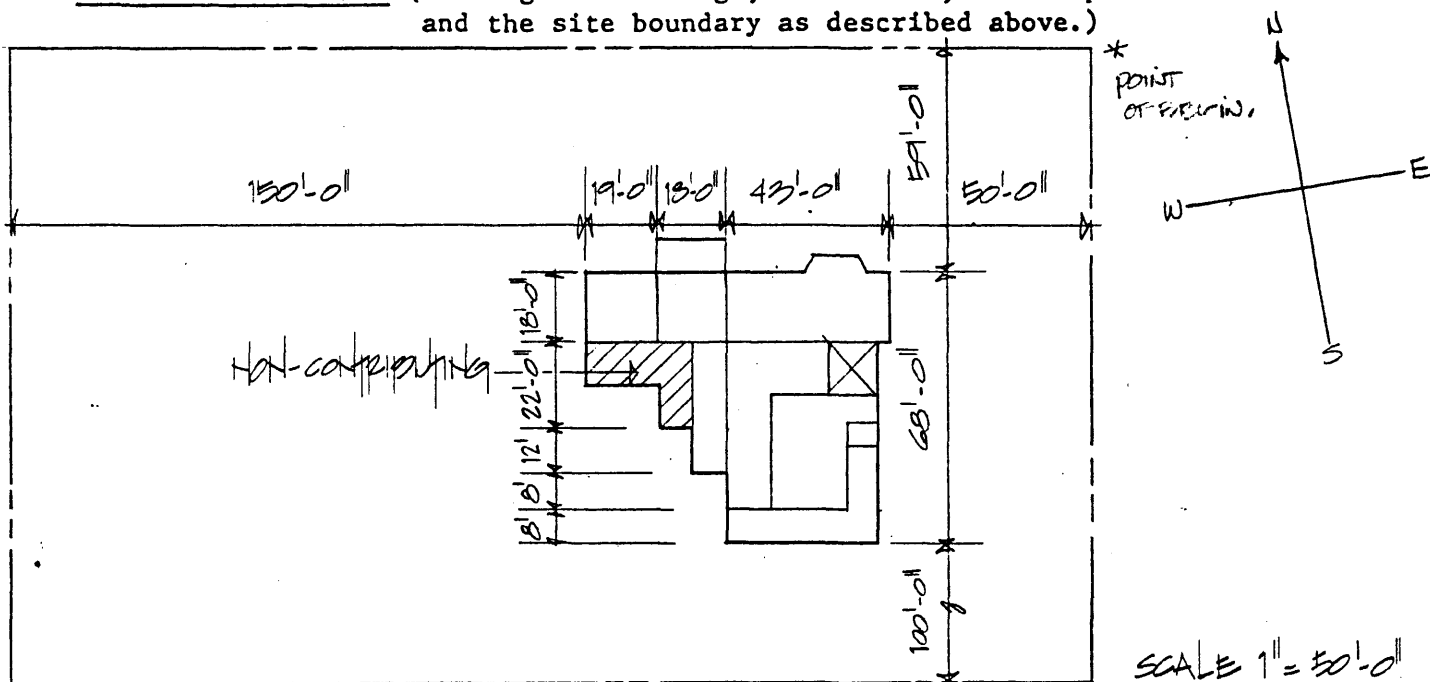

Official Courthouse Property Reference:

Continuation Sheet: Me-184 W.W. Goddard House

**Significance Statement**

The W. W. Goddard House is significant under Criterion C as an example of the local interpretation of the Italian Villa style. The Mercer County builder added a central tower to the T-plan form and used ornamental elements from the Italianate style such as elongated windows with brick hood moldings, wide eaves, bracketed entrance, and a wrap around porch. (significant date ca. 1870)

**Verbal Boundary Justification**

The boundary was chosen arbitrarily to provide a setting for the house and to define the domestic space associated with the house. Beyond the boundary are modern outbuildings associated with the farming operation.

The nominated area includes one contributing building.