

PH0352345

DATA SHEET

UNITED STATES DEPARTMENT OF THE INTERIOR
NATIONAL PARK SERVICE

FOR NPS USE ONLY

RECEIVED APR 28 1976

DATE ENTERED JUN 29 1976

NATIONAL REGISTER OF HISTORIC PLACES INVENTORY -- NOMINATION FORM

SEE INSTRUCTIONS IN HOW TO COMPLETE NATIONAL REGISTER FORMS
TYPE ALL ENTRIES -- COMPLETE APPLICABLE SECTIONS

1 NAME

HISTORIC

nh
****Original** Manatee County Courthouse *(original)*

AND/OR COMMON

Manatee Methodist Church, Manatee Methodist Church parsonage

LOCATION

STREET & NUMBER

SW corner Manatee Ave. and 15th St.

— NOT FOR PUBLICATION

CITY, TOWN

Bradenton

— VICINITY OF

CONGRESSIONAL DISTRICT

Seventh

STATE

Florida

CODE

12

COUNTY

Manatee

CODE

081

CLASSIFICATION

CATEGORY	OWNERSHIP	STATUS	PRESENT USE
<input type="checkbox"/> DISTRICT	<input checked="" type="checkbox"/> PUBLIC	<input type="checkbox"/> OCCUPIED	<input type="checkbox"/> AGRICULTURE
<input checked="" type="checkbox"/> BUILDING(S)	<input type="checkbox"/> PRIVATE	<input checked="" type="checkbox"/> UNOCCUPIED	<input type="checkbox"/> MUSEUM
<input type="checkbox"/> STRUCTURE	<input type="checkbox"/> BOTH	<input checked="" type="checkbox"/> WORK IN PROGRESS	<input type="checkbox"/> COMMERCIAL
<input type="checkbox"/> SITE	PUBLIC ACQUISITION	ACCESSIBLE	<input type="checkbox"/> EDUCATIONAL
<input type="checkbox"/> OBJECT	<input type="checkbox"/> IN PROCESS	<input checked="" type="checkbox"/> YES: RESTRICTED	<input type="checkbox"/> ENTERTAINMENT
	<input type="checkbox"/> BEING CONSIDERED	<input type="checkbox"/> YES: UNRESTRICTED	<input type="checkbox"/> GOVERNMENT
		<input type="checkbox"/> NO	<input type="checkbox"/> INDUSTRIAL
			<input type="checkbox"/> MILITARY
			<input checked="" type="checkbox"/> OTHER: vacant

OWNER OF PROPERTY

NAME

City of Bradenton

STREET & NUMBER

604 - 15th Street East

CITY, TOWN

Bradenton

— VICINITY OF

STATE

Florida

LOCATION OF LEGAL DESCRIPTION

COURTHOUSE,
REGISTRY OF DEEDS, ETC.

Manatee County Courthouse

STREET & NUMBER

CITY, TOWN

Bradenton

STATE

Florida

6 REPRESENTATION IN EXISTING SURVEYS

TITLE

N/A

DATE

— FEDERAL — STATE — COUNTY — LOCAL

DEPOSITORY FOR
SURVEY RECORDS

CITY, TOWN

STATE

7 DESCRIPTION

CONDITION		CHECK ONE	CHECK ONE
<input type="checkbox"/> EXCELLENT	<input type="checkbox"/> DETERIORATED	<input type="checkbox"/> UNALTERED	<input type="checkbox"/> ORIGINAL SITE 1866
<input type="checkbox"/> GOOD	<input type="checkbox"/> RUINS	<input checked="" type="checkbox"/> ALTERED	<input checked="" type="checkbox"/> MOVED DATE 1886
<input checked="" type="checkbox"/> FAIR	<input type="checkbox"/> UNEXPOSED		1906
			1975

DESCRIBE THE PRESENT AND ORIGINAL (IF KNOWN) PHYSICAL APPEARANCE

The Manatee County Courthouse is a 25' x 35' braced post and beam structure with drop siding. The gable roof structure has a three bay facade composed of a three light panel door flanked by double one-over-one double hung sash windows in plain surrounds. An offset panel door is also located on the facade. The gable ends are two bay with metal casements.

The structure has been relocated four times and obviously altered at least that many times if not more. Physical research should reveal the original appearance with a good degree of accuracy.

8 SIGNIFICANCE

PERIOD	AREAS OF SIGNIFICANCE -- CHECK AND JUSTIFY BELOW			
—PREHISTORIC	—ARCHEOLOGY-PREHISTORIC	—COMMUNITY PLANNING	—LANDSCAPE ARCHITECTURE	—RELIGION
—1400-1499	—ARCHEOLOGY-HISTORIC	—CONSERVATION	—LAW	—SCIENCE
—1500-1599	—AGRICULTURE	—ECONOMICS	—LITERATURE	—SCULPTURE
—1600-1699	—ARCHITECTURE	—EDUCATION	—MILITARY	—SOCIAL/HUMANITARIAN
—1700-1799	—ART	—ENGINEERING	—MUSIC	—THEATER
<input checked="" type="checkbox"/> 1800-1899	—COMMERCE	—EXPLORATION/SETTLEMENT	—PHILOSOPHY	—TRANSPORTATION
—1900-	—COMMUNICATIONS	—INDUSTRY	<input checked="" type="checkbox"/> POLITICS/GOVERNMENT	—OTHER (SPECIFY)
		—INVENTION		

SPECIFIC DATES 1860-1866 BUILDER/ARCHITECT Ezekiel Glazier, builder

STATEMENT OF SIGNIFICANCE

The Manatee County Courthouse is the oldest remaining county courthouse built explicitly for that purpose that has been identified to date in the state of Florida. It is an important physical remnant of the early settlement of Manatee County and of Manatee's (now Bradenton) role as the first seat of government in the county.

Manatee County was established January 9, 1855; three years later in April, 1858, the Board of County Commissioners appointed a committee to "advertise for proposals for a Courthouse and Jail" (Commission Minutes, Book 1, p. 3). In December of the same year the commission voted to accept plans for the courthouse which were submitted by Ezekiel Glazier and in January 1859 entered into a contract with Glazier to construct the courthouse (Commission Minutes, Book 1, pp. 4, 5; Florida Peninsula, January 1, 1859). Apparently after some conflict, on April 2, 1860, the commissioners reached a compromise with Glazier concerning the completion of the courthouse. He was required "to complete the house according to Contract, that is to say he [Glazier] shall furnish the number of benches specified in the bill, and put another coat of paint on the outside of the House" (Commission Minutes, Book 1, p. 8). Situated on Court House Square, this building served as the first permanent seat of county government until 1866 when the county seat was moved to Pine Level. During its period of use as a courthouse the building was made available for use as a school (Commission Minutes, Book 1, p. 8).

In 1866 after the relocation of the county seat, the Board of Commissioners sold the courthouse in Manatee to the Methodist Church (Deed Book 2, p. 75). Apparently the building was moved a short distance north of its original location and remodeled on the interior for use as a church. In 1886-1887, the church constructed a new sanctuary and relocated the old courthouse to the east for use as a parsonage. In 1906 the structure was sold and moved north to be used as a private residence (Gates, p. 10; see enclosed maps).

In 1975 the courthouse building was moved to its present location. While the building has been relocated four times, it is important to understand that this building was the county's first seat of government. For this reason, the building itself is invested with important historical associations which probably make it one of the most important historic sites in the county.

9 MAJOR BIBLIOGRAPHICAL REFERENCES

See continuation sheet

10 GEOGRAPHICAL DATA

ACREAGE OF NOMINATED PROPERTY less than 1

UTM REFERENCES

A

1	7
---	---

3	47	1	10
---	----	---	----

30	4	1	95	5
----	---	---	----	---

 ZONE EASTING NORTHING

B

--	--

--	--	--	--

--	--	--	--	--

 ZONE EASTING NORTHING

VERBAL BOUNDARY DESCRIPTION

LIST ALL STATES AND COUNTIES FOR PROPERTIES OVERLAPPING STATE OR COUNTY BOUNDARIES

STATE	CODE	COUNTY	CODE

11 FORM PREPARED BY

NAME / TITLE

Phillip A. Werndli, Historic Sites Specialist

ORGANIZATION

Div. of Archives, History & Records Mgmt.

DATE

March, 1976

STREET & NUMBER

Dept. of State, The Capitol

TELEPHONE

904-488-7365

CITY OR TOWN

Tallahassee

STATE

Florida

12 STATE HISTORIC PRESERVATION OFFICER CERTIFICATION

THE EVALUATED SIGNIFICANCE OF THIS PROPERTY WITHIN THE STATE IS:

NATIONAL

STATE

LOCAL

As the designated State Historic Preservation Officer for the National Historic Preservation Act of 1966 (Public Law 89-665), I hereby nominate this property for inclusion in the National Register and certify that it has been evaluated according to the criteria and procedures set forth by the National Park Service.

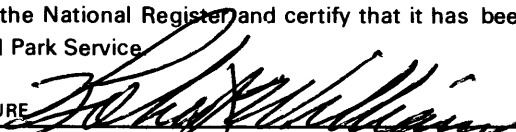

STATE HISTORIC PRESERVATION OFFICER SIGNATURE



Robert Williams

TITLE State Historic Preservation Officer

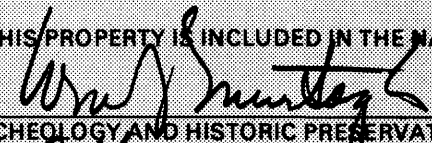
DATE 4/23/76

FOR NPS USE ONLY	
I HEREBY CERTIFY THAT THIS PROPERTY IS INCLUDED IN THE NATIONAL REGISTER	
  DIRECTOR, OFFICE OF ARCHEOLOGY AND HISTORIC PRESERVATION	DATE 4/27/76
  ATTENDING OFFICER KEEPER OF THE NATIONAL REGISTER	DATE 6-23-76

UNITED STATES DEPARTMENT OF THE INTERIOR
NATIONAL PARK SERVICE

**NATIONAL REGISTER OF HISTORIC PLACES
INVENTORY -- NOMINATION FORM**

FOR NPS USE ONLY

RECEIVED APR 28 1976

DATE ENTERED

JUN 29 1976

Original Manatee County Courthouse

CONTINUATION SHEET

ITEM NUMBER 9 PAGE 1

Florida Peninsula [Tampa], January 1, 1859.

Gates, Eva M. One Hundred Years of Manatee Methodism: The Old Church with the New Spirit. Manatee, Florida: Manatee Methodist Church, 1949.

Manatee County. Clerk of the Circuit Court. Deed Books.
Clerk of the Circuit Court, vault. Manatee County Court-
house, Bradenton.

_____. County Commission. Minutes. Clerk of the
Circuit Court, vault. Manatee County Courthouse, Bradenton.
Book I, pp. 3, 4, 5, 6, 9, 18.

Simpson, Joseph Herman. "History of Manatee County." MSS,
Bradenton, Florida, 1915. Re-typed by Rita Anderson,
Bradenton, Florida: Manatee County Historical Commission,
1975, no page numbers.

UNITED STATES DEPARTMENT OF THE INTERIOR
NATIONAL PARK SERVICE

**NATIONAL REGISTER OF HISTORIC PLACES
PROPERTY MAP FORM**

FOR NPS USE ONLY

RECEIVED APR 28 1976

DATE ENTERED JUN 29 1976

SEE INSTRUCTIONS IN *HOW TO COMPLETE NATIONAL REGISTER FORMS*
TYPE ALL ENTRIES -- ENCLOSE WITH MAP

NAME

HISTORIC

Original Manatee County Courthouse

AND/OR COMMON

2 LOCATION

CITY, TOWN

Bradenton

____ VICINITY OF

COUNTY

Manatee

STATE

Florida

3 MAP REFERENCE

SOURCE

hand drawn

Map 1

SCALE

not to scale

DATE

1976

REQUIREMENTS

TO BE INCLUDED ON ALL MAPS

1. PROPERTY BOUNDARIES
2. NORTH ARROW
3. UTM REFERENCES

MAP 1

John Jackson Plat of Block 13
Scale: 4/1

ORANGE Street
(4 1/2 Ave E)

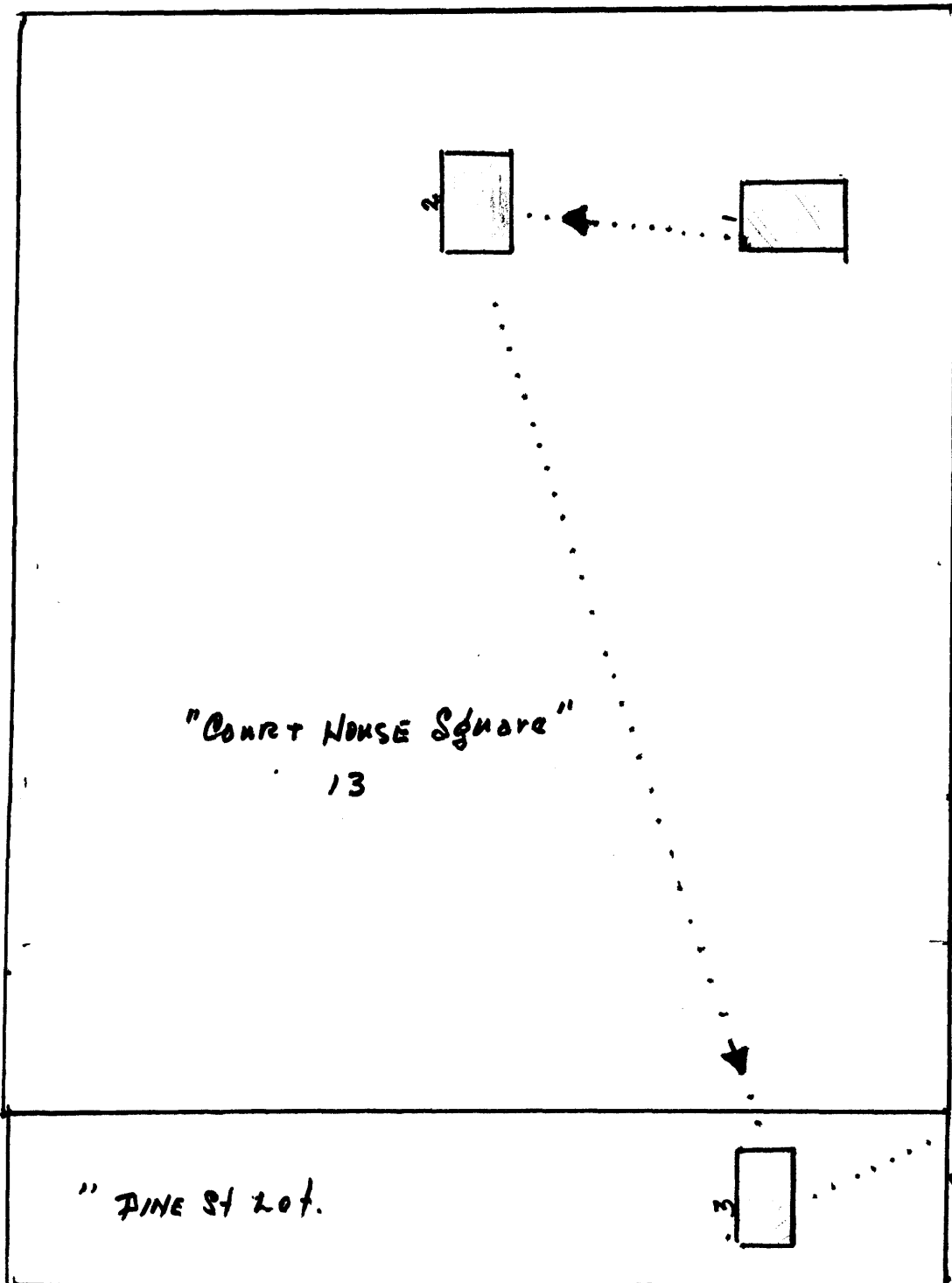

"COURT HOUSE Square"
13

"PINE St Lot."

340'

1. Original Location of Courthouse 1860. Used as Church in this spot until 1886 or 1887.
2. Moved to this location to be used as a parsonage until 1906.
3. Moved to "Pine Street Lot" belonging to heir of Josiah Gates 1906. Remained in this location until moved about two blocks south to Manatee Village Historical Park December 5, 1975.
4. Moved to Manatee Village Historical Park (not shown) to be restored to original design.

by:

G. Warren Johnson, Jr.
G. Warren Johnson, Jr.

Encl. # 16

UNITED STATES DEPARTMENT OF THE INTERIOR
NATIONAL PARK SERVICE

**NATIONAL REGISTER OF HISTORIC PLACES
PROPERTY MAP FORM**

FOR NPS USE ONLY

RECEIVED APR 28 1976

DATE ENTERED JUN 29 1976

SEE INSTRUCTIONS IN *HOW TO COMPLETE NATIONAL REGISTER FORMS*
TYPE ALL ENTRIES -- ENCLOSE WITH MAP

NAME

HISTORIC

Original Manatee County Courthouse

AND/OR COMMON

2 LOCATION

CITY, TOWN

Bradenton

___ VICINITY OF

COUNTY

Manatee

STATE

Florida

3 MAP REFERENCE

SOURCE hand drawn

Map 2

SCALE not to scale

DATE 1976

REQUIREMENTS

TO BE INCLUDED ON ALL MAPS

1. PROPERTY BOUNDARIES
2. NORTH ARROW
3. UTM REFERENCES

MAP 2

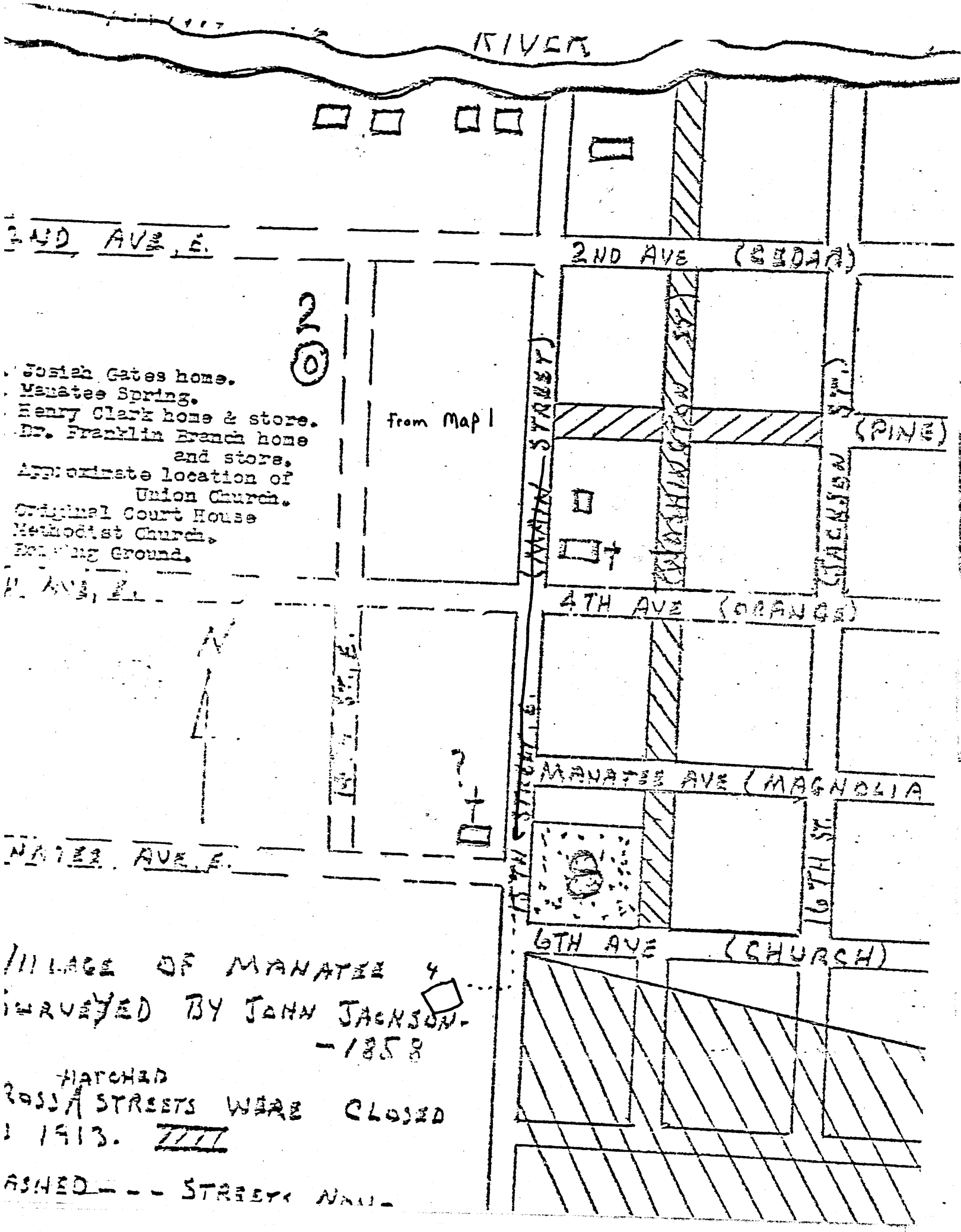

- Josiah Gates home.
- Manatee Spring.
- Henry Clark home & store.
- Dr. Franklin Branch home and store.
- Approximate location of Union Church.
- Original Court House
- Methodist Church.
- Bowling Ground.

from Map 1

VILLAGE OF MANATEE
 SURVEYED BY JOHN JACKSON
 - 1858

HATCHED
 CROSS STREETS WERE CLOSED
 1913. TTTT

ASHED - - - STREETS WERE