

**NATIONAL REGISTER OF HISTORIC PLACES
INVENTORY - NOMINATION FORM**

(Type all entries - complete applicable sections)

STATE: Colorado	
COUNTY: Lake	
FOR NPS USE ONLY	
ENTRY NUMBER 70-8-05.0009	DATE 8/35

1. NAME

COMMON:
Healy House

AND/OR HISTORIC:
Healy House

2. LOCATION

STREET AND NUMBER:
912 Harrison (corner of East Tenth) *Avenue*

CITY OR TOWN:
Leadville,

STATE: **Colorado** CODE: **05** COUNTY: **Lake** CODE: **065**

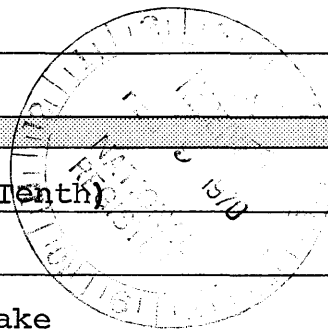

3. CLASSIFICATION

CATEGORY (Check One)	OWNERSHIP	STATUS	ACCESSIBLE TO THE PUBLIC
<input type="checkbox"/> District <input type="checkbox"/> Site <input type="checkbox"/> Object <input checked="" type="checkbox"/> Building <input type="checkbox"/> Structure	<input checked="" type="checkbox"/> Public <input type="checkbox"/> Private <input type="checkbox"/> Both	<input checked="" type="checkbox"/> Occupied <input type="checkbox"/> Unoccupied <input type="checkbox"/> Preservation work in progress	Yes: <input type="checkbox"/> Restricted <input checked="" type="checkbox"/> Unrestricted <input type="checkbox"/> No
PRESENT USE (Check One or More as Appropriate)			
<input type="checkbox"/> Agricultural <input type="checkbox"/> Commercial <input checked="" type="checkbox"/> Educational <input type="checkbox"/> Entertainment	<input type="checkbox"/> Government <input type="checkbox"/> Industrial <input type="checkbox"/> Military <input checked="" type="checkbox"/> Museum	<input type="checkbox"/> Park <input type="checkbox"/> Private Residence <input type="checkbox"/> Religious <input type="checkbox"/> Scientific	<input type="checkbox"/> Transportation <input type="checkbox"/> Other (Specify) _____ <input type="checkbox"/> Comments _____

4. OWNER OF PROPERTY

OWNER'S NAME:
State Historical Society of Colorado

STREET AND NUMBER:
200 Fourteenth Avenue

CITY OR TOWN: **Denver** STATE: **Colorado** CODE: **05**

5. LOCATION OF LEGAL DESCRIPTION

COURTHOUSE, REGISTRY OF DEEDS, ETC.:
State Museum, State Historical Society of Colorado

STREET AND NUMBER:
200 Fourteenth Avenue

CITY OR TOWN: **Denver** STATE: **Colorado** CODE: **05**

6. REPRESENTATION IN EXISTING SURVEYS

TITLE OF SURVEY:
August R. Meyer Placer Survey #381 as per G. Ellis Burcaw (State)

DATE OF SURVEY: **1879 as per 1964** Federal State County Local

DEPOSITORY FOR SURVEY RECORDS:
Copies at the State Museum

STREET AND NUMBER:
200 Fourteenth Avenue

CITY OR TOWN: **Denver** STATE: **colorado** CODE: **05**

SEE INSTRUCTIONS

STATE: **Colorado**

COUNTY: **Lake**

ENTRY NUMBER: **70-8-05.0009**

DATE: **8/35**

FOR NPS USE ONLY

7. DESCRIPTION

CONDITION

(Check One)	
<input checked="" type="checkbox"/> Excellent	<input type="checkbox"/> Good <input type="checkbox"/> Fair <input type="checkbox"/> Deteriorated <input type="checkbox"/> Ruins <input type="checkbox"/> Unexposed
(Check One)	
<input type="checkbox"/> Altered	<input checked="" type="checkbox"/> Unaltered
(Check One)	
<input type="checkbox"/> Moved	<input checked="" type="checkbox"/> Original Site

DESCRIBE THE PRESENT AND ORIGINAL (if known) PHYSICAL APPEARANCE

Healy House was constructed by August R. Meyer, a mining engineer, in the fall of 1878. Originally, the wood frame building was two stories in height and possessed nine rooms. At the time, it was one of Leadville's finest homes.

After changing owners, first from the Meyers to the First Methodist Episcopal Church (1881), then to the Kelly family, the house became a boarding establishment in 1886.

When Representative Daniel Healy bought the house from his sister, Ellen Healy Kelly in 1888, a third floor was added; bring^{ING} the number of rooms to thirteen.

From 1912 until 1936 another member of the Healy family occupied the residence, Nellie A. Healy. The house was donated to the Leadville Historical Association by the heirs of the Healy estate in 1936; at which time restoration work was begun. In 1947, the House and grounds were donated to the State Historical Society of Colorado by the Leadville Historical Association. Since that time, much authentic restoration has been performed, based upon old photographs and documents.

The interior of the Healy House State Museum is done in Victorian taste. The furnishings came from either the Healy Estate or the residences of other rich homes of the period.

Today, the Healy House is one of the Society's regional museums. Open to the public free of charge, the Healy House is an example of the "Elegant Eighties" which existed in the mining camps of Leadville.

SEE INSTRUCTIONS

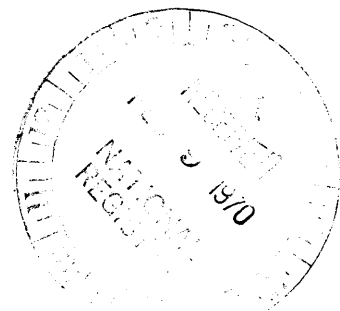

NATIONAL REGISTER OF HISTORIC PLACES
INVENTORY - NOMINATION FORM

(Continuation Sheet)

STATE	
Colorado	
COUNTY	
Lake	
FOR NPS USE ONLY	
ENTRY NUMBER	DATE
70-8-05-0009	8/25

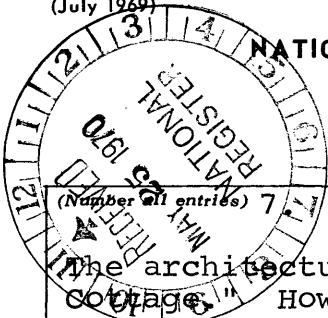

Description (continued and expanded)

The architectural style of Healy House may be called "Victorian Cottage." However, except for size, the exterior of the building is mostly unpretentious. The two story, wooden, porch has plain, square columns and pilasters resting upon a cutwork balustrade on the first story. Columns support crowning cornices with dentil range and lacy scroll brackets lie beneath the porch eave line. The second story is a balcony porch, uncovered, with a cutwork balustrade which rests upon the cornice of the first story. The style of the wood trim resembles classic revival, as interpreted by the Victorian period.

Attached to the house, and to the east, was the kitchen with a porch that faced to the south. Today, this area serves as a reception room for visitors. Adjoining this room, on the east, is a room that was originally the barn. In 1886, the barn was moved against the house to serve as an addition to the living quarters. In 1958, this room was enlarged by the State to provide living quarters for the regional curator. This addition lies to the south of the barn.

Altogether, the house sits on an east-west axis; with the 1958 addition forming an ell approximately 25 feet to the south. As mentioned earlier, the third floor, which was also frame, was added in 1898. There are no known photographs of the original roof line. The new roof was, and is, a simple hipped roof.

Restoration of Healy House's exterior was largely concerned with painting the exterior in the manner indicated by late 19th century photographs; replacing the balustrade; and installing new wooden shutters to replace those which had deteriorated beyond repair. The interior restoration incorporated the usual cleaning, painting and replacement of interior trim, wallpaper, etc. Care was taken to duplicate the wallpaper with that type which was in vogue during the 1880's. Some rooms, e.g., the Nellie Healy Room, contain the original paper on the walls. Furnishings are not originals owned by the Meyers or Healys; but they represent the period and area. It should be noted here that the stained glass window in the house is not original to the interior; but, was donated by descendents of two pioneer families, the Ewing and the White families.

All construction, including the 1958 addition, is frame with wood siding. The addition matches the original building's exterior in every way. All exterior trim, e.g., balustrades, cornices, etc., are of wood.

SIGNIFICANCE

PERIOD (Check One or More as Appropriate)

- Pre-Columbian | 16th Century | 18th Century | 20th Century
 15th Century | 17th Century | 19th Century

SPECIFIC DATE(S) (If Applicable and Known) 1878

AREAS OF SIGNIFICANCE (Check One or More as Appropriate)

- | | | | |
|--|---|--|--|
| <input type="checkbox"/> Aboriginal | <input type="checkbox"/> Education | <input type="checkbox"/> Political | <input type="checkbox"/> Urban Planning |
| <input type="checkbox"/> Prehistoric | <input type="checkbox"/> Engineering | <input type="checkbox"/> Religion/Philosophy | <input type="checkbox"/> Other (Specify) |
| <input type="checkbox"/> Historic | <input type="checkbox"/> Industry | <input type="checkbox"/> Science | _____ |
| <input type="checkbox"/> Agriculture | <input type="checkbox"/> Invention | <input type="checkbox"/> Sculpture | _____ |
| <input checked="" type="checkbox"/> Architecture | <input type="checkbox"/> Landscape Architecture | <input type="checkbox"/> Social/Humanitarian | _____ |
| <input type="checkbox"/> Art | <input type="checkbox"/> Literature | <input type="checkbox"/> Theater | _____ |
| <input type="checkbox"/> Commerce | <input type="checkbox"/> Military | <input type="checkbox"/> Transportation | _____ |
| <input type="checkbox"/> Communications | <input type="checkbox"/> Music | | _____ |
| <input type="checkbox"/> Conservation | | | _____ |

STATEMENT OF SIGNIFICANCE

Leadville became an important mining camp circa 1880. Not only did its mines revive the sagging economy of Colorado, but also that of the country.

Although perched approximately two miles above sea level and located within the rough terrain of the Rockies, Leadville's population became cosmopolitan. A reflection of this materialistic, Victorian period can be seen in Healy House; built by August R. Meyer in 1878, Healy House became one of Leadville's finest homes. The ostentatious age of the "Elegant Eighties" is appropriately reflected in the mirrors backed by diamond dust and the red velvet and gold ornamentation.

As a restored historic house and regional museum, the Healy House demonstrates to over twenty thousand visitors a year what was a significant era in Colorado's history.

SEE INSTRUCTIONS

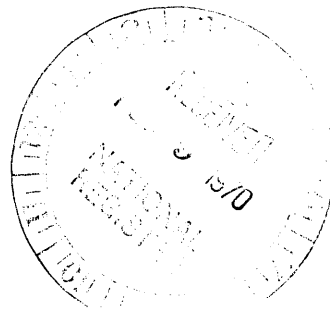

9 MAJOR BIBLIOGRAPHICAL REFERENCES

Healy House and Dexter Cabin by the State Historical Society of Colorado

The Colorado Magazine, a journal of the State Historical Society of Colorado, Vol. XXIII, p.25, January, 1946

10 GEOGRAPHICAL DATA

LATITUDE AND LONGITUDE COORDINATES DEFINING A RECTANGLE LOCATING THE PROPERTY			O R	LATITUDE AND LONGITUDE COORDINATES DEFINING THE CENTER POINT OF A PROPERTY OF LESS THAN TEN ACRES		
CORNER	LATITUDE	LONGITUDE		LATITUDE	LONGITUDE	
	Degrees Minutes Seconds	Degrees Minutes Seconds		Degrees Minutes Seconds	Degrees Minutes Seconds	
NW	° ' "	° ' "		39 ° 15' 8 "	106 ° 17' 18 "	
NE	° ' "	° ' "				
SE	° ' "	° ' "				
SW	° ' "	° ' "				

APPROXIMATE ACREAGE OF NOMINATED PROPERTY: 1.3

LIST ALL STATES AND COUNTIES FOR PROPERTIES OVERLAPPING STATE OR COUNTY BOUNDARIES

STATE:	CODE	COUNTY:	CODE

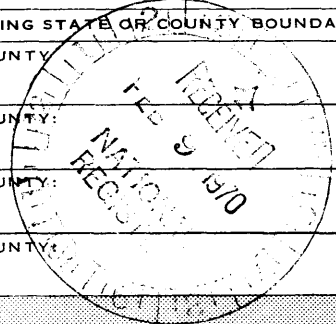

SEE INSTRUCTIONS

11 FORM PREPARED BY

NAME AND TITLE: Robert Fink, Assistant to the Director

ORGANIZATION: State Historical Society of Colorado DATE: 1/14/70

STREET AND NUMBER: 200 Fourteenth Avenue

CITY OR TOWN: Denver STATE: Colorado CODE: 05

12 STATE LIAISON OFFICER CERTIFICATION

NATIONAL REGISTER VERIFICATION

As the designated State Liaison Officer for the National Historic Preservation Act of 1966 (Public Law 89-665), I hereby nominate this property for inclusion in the National Register and certify that it has been evaluated according to the criteria and procedures set forth by the National Park Service. The recommended level of significance of this nomination is:

National State Local

Name: Stephen H. Hart

Title: State Liaison Officer

Date: _____

I hereby certify that this property is included in the National Register.

Ernest Allen Connally
Chief, Office of Archeology and Historic Preservation

Date: AUG 25 1970

ATTEST:

William J. [Signature]
Keeper of The National Register

Date: FEB 17 1970

NATIONAL REGISTER OF HISTORIC PLACES

PROPERTY MAP FORM

(Type all entries - attach to or enclose with map)

STATE	Colorado	
COUNTY	Lake	
FOR NPS USE ONLY		
ENTRY NUMBER	70.8.05.00090	DATE
		8/35

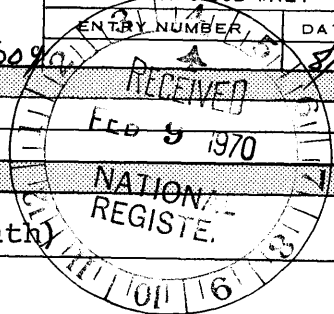

SEE INSTRUCTIONS

1. NAME

COMMON: Healy House

AND/OR HISTORIC: Healy House

2. LOCATION

STREET AND NUMBER:

912 Harrison (corner of East Tenth)

CITY OR TOWN:

Leadville

STATE:

Colorado

CODE

05

COUNTY:

Lake

CODE

065

3. MAP REFERENCE

SOURCE:

Insurance Maps of Leadville, Colorado by Sanborn/Perris Map Co.

SCALE: 1" = 50'

DATE: 1895

4. REQUIREMENTS

TO BE INCLUDED ON ALL MAPS

1. Property boundaries where required.
2. North arrow.
3. Latitude and longitude reference.

North Popular

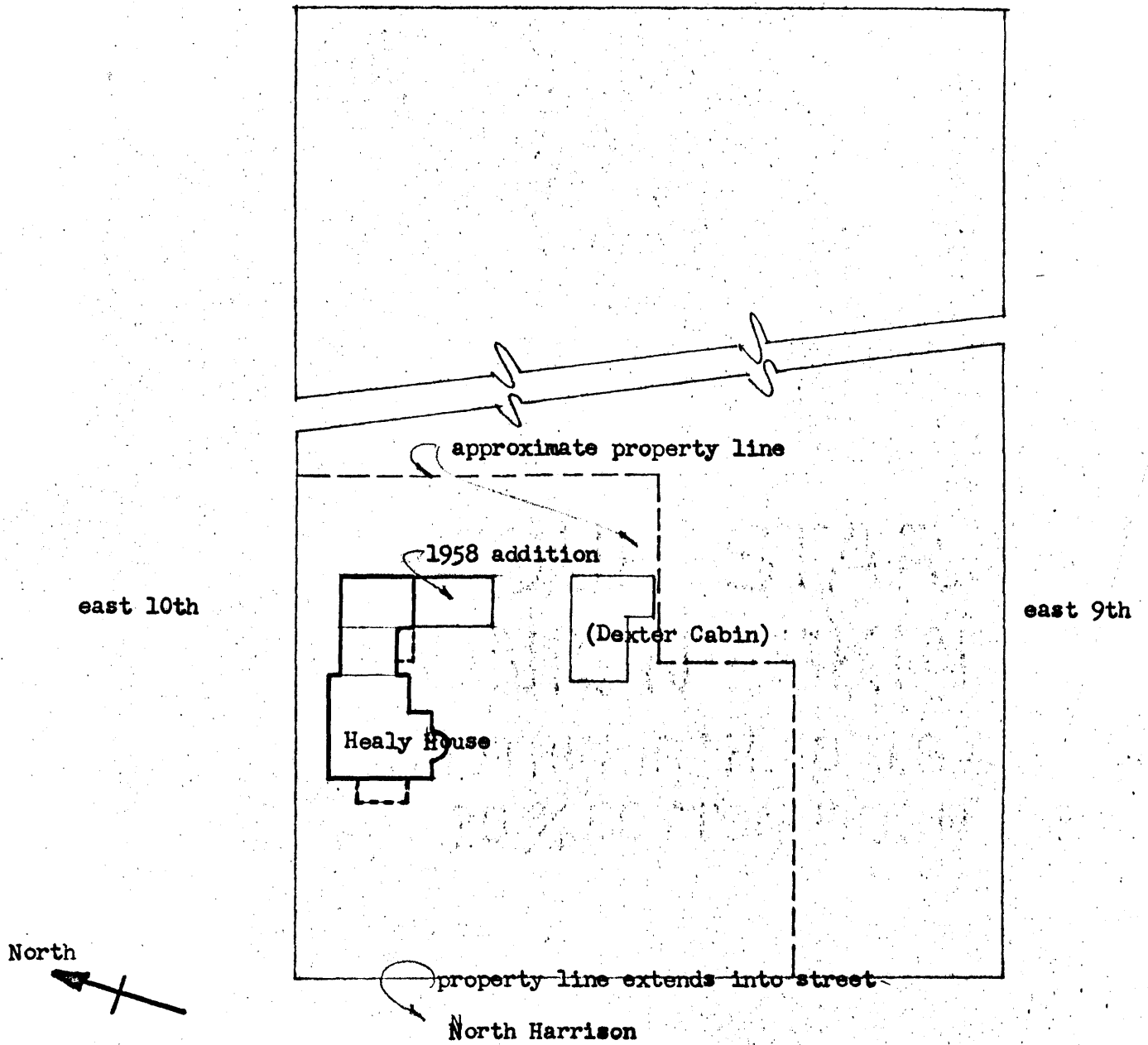

Healy House, Leadville, Colorado

Map from Insurance Maps of Leadville, Colo.

by Sanborn/Perris Map Company, 1895

Scale: 1" = 50'

note: property lines, Dexter Cabin, and
the 1958 addition are recent

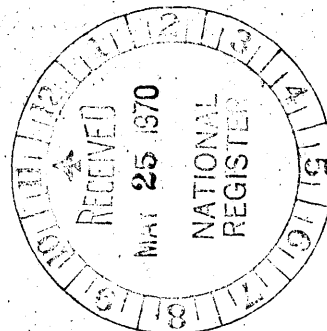

Form 10-301
(Dec. 1968)

UNITED STATES DEPARTMENT OF THE INTERIOR
NATIONAL PARK SERVICE

NATIONAL REGISTER OF HISTORIC PLACES
PROPERTY MAP FORM

(Type all entries - attach to or enclose with map)

STATE	
Colorado	
COUNTY	
Lake	
FOR NPS USE ONLY	
ENTRY NUMBER	DATE
70-P-05-0009	8/25

SEE INSTRUCTIONS

1. NAME

COMMON: Healy House
AND/OR HISTORIC: Healy House

2. LOCATION

STREET AND NUMBER:
912 Harrison (corner of East Tenth)
CITY OR TOWN:
Leadville
STATE: Colorado CODE 05 COUNTY: Lake CODE 065

3. MAP REFERENCE

SOURCE:
U.S.G.S. Atlas of Leadville, Colorado
SCALE: 1" = 800'
DATE: 1883

4. REQUIREMENTS

- TO BE INCLUDED ON ALL MAPS
1. Property boundaries where required.
 2. North arrow.
 3. Latitude and longitude reference.

*Leadville
10/11
1883*

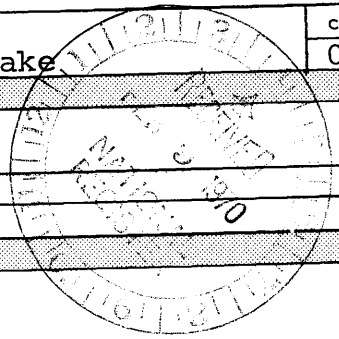

39°15'8"

39 15

Scale: 1 inch to one foot of 1:9000.

Capitol Hill

106°17'18"

NORTH



HEALY HOUSE

U.S.G.S. Map from U.S.G.S. Atlas of Leadville, Colorado 1883

Scale: 1" = 800'



NATIONAL REGISTER OF HISTORIC PLACES

PROPERTY MAP FORM

(Type all entries - attach to or enclose with map)

STATE Colorado	
COUNTY Lake	
FOR NPS USE ONLY	
ENTRY NUMBER 70-8-05-0009	DATE 8/55

SEE INSTRUCTIONS

1. NAME

COMMON: Healy House
 AND/OR HISTORIC: Healy House

2. LOCATION

STREET AND NUMBER: 912 Harrison (corner of East Tenth)
 CITY OR TOWN: Leadville
 STATE: Colorado CODE 05 COUNTY: Lake CODE 065

3. MAP REFERENCE

SOURCE: Leadville City Map (Tracing, E. Irwin)
 SCALE: 1" = 1050'
 DATE: 4/19/40

4. REQUIREMENTS

TO BE INCLUDED ON ALL MAPS

1. Property boundaries where required.
2. North arrow.
3. Latitude and longitude reference.

Healy House

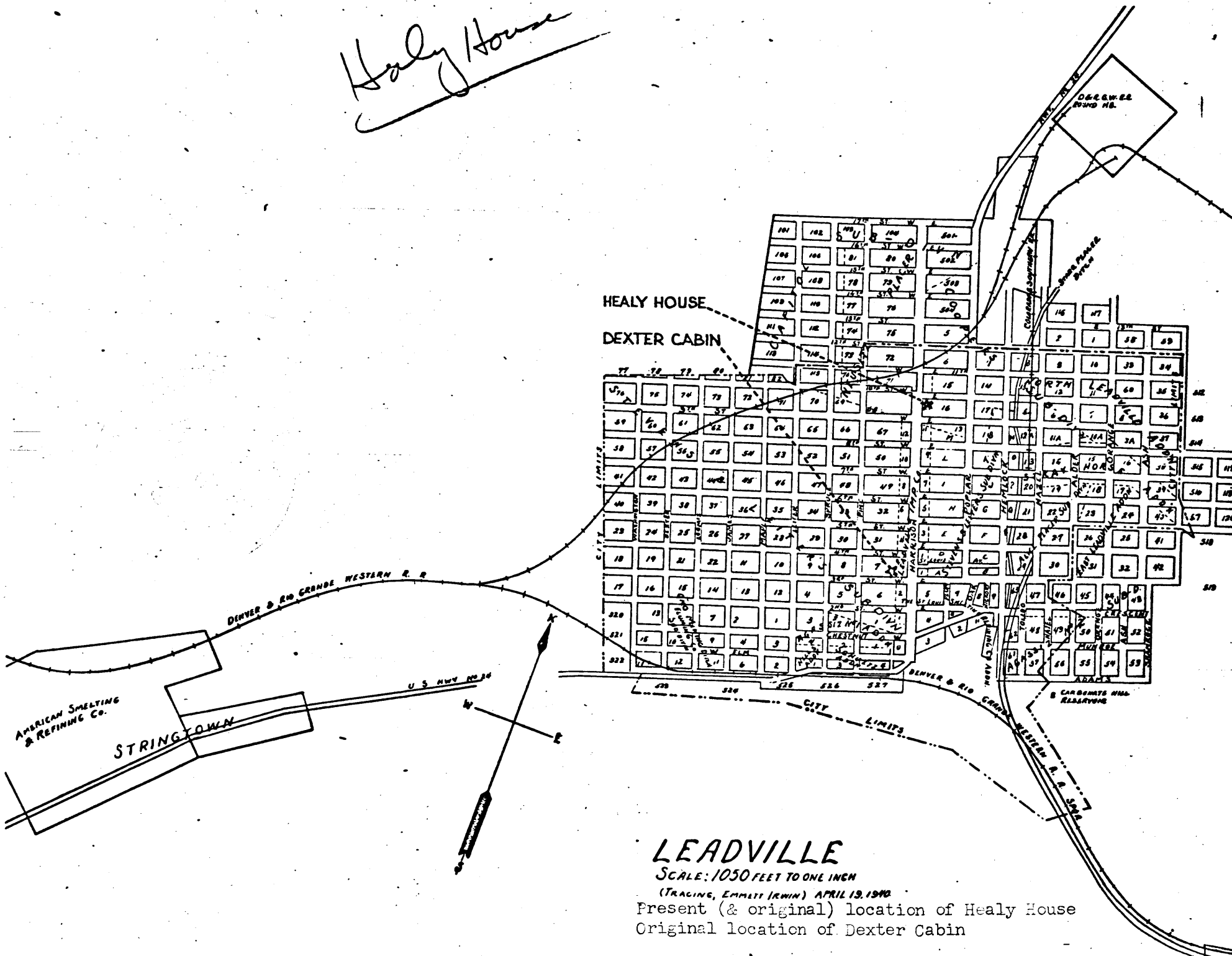

LEADVILLE
SCALE: 1050 FEET TO ONE INCH

(TRACING, EMMETT IRWIN) APRIL 19, 1940
Present (& original) location of Healy House
Original location of Dexter Cabin