

**United States Department of the Interior
Heritage Conservation and Recreation Service**

**National Register of Historic Places
Inventory—Nomination Form**

See instructions in *How to Complete National Register Forms*
Type all entries—complete applicable sections

1. Name

historic Morgan City City Hall and Courthouse

and/or common

2. Location

street & number corner of Everett and First Streets not for publication

city, town Morgan City vicinity of congressional district 3rd--Wilbert J. Tauzin

state Ia. code 22 county St. Mary Parish code 101

3. Classification

Category	Ownership	Status	Present Use
<input type="checkbox"/> district	<input checked="" type="checkbox"/> public	<input checked="" type="checkbox"/> occupied	<input type="checkbox"/> agriculture <input type="checkbox"/> museum
<input checked="" type="checkbox"/> building(s)	<input type="checkbox"/> private	<input type="checkbox"/> unoccupied	<input type="checkbox"/> commercial <input type="checkbox"/> park
<input type="checkbox"/> structure	<input type="checkbox"/> both	<input type="checkbox"/> work in progress	<input type="checkbox"/> educational <input type="checkbox"/> private residence
<input type="checkbox"/> site	Public Acquisition	Accessible	<input type="checkbox"/> entertainment <input type="checkbox"/> religious
<input type="checkbox"/> object	<input type="checkbox"/> in process	<input checked="" type="checkbox"/> yes: restricted	<input type="checkbox"/> government <input type="checkbox"/> scientific
	<input type="checkbox"/> being considered	<input type="checkbox"/> yes: unrestricted	<input type="checkbox"/> industrial <input type="checkbox"/> transportation
		<input type="checkbox"/> no	<input type="checkbox"/> military <input type="checkbox"/> other:

4. Owner of Property

name City of Morgan City Dr. C. R. Brownell, Mayor

street & number P. O. Box 1218

city, town Morgan City vicinity of state Ia. 70380

5. Location of Legal Description

courthouse, registry of deeds, etc. St. Mary Parish Courthouse

street & number

city, town Franklin state Ia.

6. Representation in Existing Surveys

title Ia. Historic Sites Survey has this property been determined eligible? yes no

date 1980 federal state county local

depository for survey records Ia. State Historic Preservation Office

city, town Baton Rouge state Ia.

7. Description

Condition excellent good fair deteriorated ruins unexposed**Check one** unaltered altered**Check one** original site moved

date _____

Describe the present and original (if known) physical appearance

The Morgan City City Hall and Courthouse is located one block back from the industrial waterfront in the city's central business district. It is a 2 story rectangular hip roofed building laid up in common bond brick.

Victorian Renaissance Revival features include:

- (1) shallow brick 2 story pilasters dividing the north and west facades into bays.
- (2) the corbelled brick entablature panels.
- (3) the 2 square bracketed rooftop campaniles located in the centers of the north and west facades. The one on the north facade is open while the one on the west facade contains a clock and round arch windows.
- (4) the pairs of shallow arched windows in many of the bays.

The building is entered on the west (short) side through a large hall, with a double staircase leading to the old ballroom/courtroom upstairs. Originally this room had a stage, but this has been enclosed for office space.

In the 1920's 3 transomed side lighted entrance doorways were installed on the north (long) facade along with a Doric colonnade on the north and west facades. The doorways still exist, but the entrance area itself has been divided into offices.

Originally the three east bays of the north facade had iron doors with fire engine stalls. Much of this area has been divided into offices. The center bay still has a police car stall.

The original council chamber is still intact with elaborate pressed tin ornamentation.

8. Significance

Period	Areas of Significance—Check and justify below			
<input type="checkbox"/> prehistoric	<input type="checkbox"/> archeology-prehistoric	<input type="checkbox"/> community planning	<input type="checkbox"/> landscape architecture	<input type="checkbox"/> religion
<input type="checkbox"/> 1400–1499	<input type="checkbox"/> archeology-historic	<input type="checkbox"/> conservation	<input type="checkbox"/> law	<input type="checkbox"/> science
<input type="checkbox"/> 1500–1599	<input type="checkbox"/> agriculture	<input type="checkbox"/> economics	<input type="checkbox"/> literature	<input type="checkbox"/> sculpture
<input type="checkbox"/> 1600–1699	<input checked="" type="checkbox"/> architecture	<input type="checkbox"/> education	<input type="checkbox"/> military	<input type="checkbox"/> social/ humanitarian
<input type="checkbox"/> 1700–1799	<input type="checkbox"/> art	<input type="checkbox"/> engineering	<input type="checkbox"/> music	<input type="checkbox"/> theater
<input type="checkbox"/> 1800–1899	<input type="checkbox"/> commerce	<input type="checkbox"/> exploration/settlement	<input type="checkbox"/> philosophy	<input type="checkbox"/> transportation
<input checked="" type="checkbox"/> 1900–	<input type="checkbox"/> communications	<input type="checkbox"/> industry	<input checked="" type="checkbox"/> politics/government	<input type="checkbox"/> other (specify)
		<input type="checkbox"/> invention		

Specific dates 1905 **Builder/Architect** J.M. Pamelee, Architect

Statement of Significance (in one paragraph) M. L. Wilcox & F. Zylicz, Builders
Criteria C and A

The Morgan City City Hall and Courthouse is significant in the area of architecture as a landmark in the city's central business area. It is probably the largest building in the area, is handsomely detailed, and its two rooftop campaniles are visible for many blocks. It stands today as the visual centerpiece of the Morgan City Central Business District. In addition, of the city's 50+ year old buildings in the downtown area the city hall is easily the most pretentious. It stands as an independent hip roof block which is 3 bays deep and 7 bays wide and has 2 rooftop campaniles. Other buildings in the area are 1 or 2 story, false front, party wall commercial structures.

The Morgan City City Hall and Courthouse is significant in the area of politics/government because since its construction it has served as the seat of municipal government and the hub of political activity in the city.

9. Major Bibliographical References

Chain of Title, St. Mary Parish Courthouse
 Research Report Submitted by City of Morgan City, located in Morgan City City Hall and
 Courthouse National Register file, State Historic Preservation Office, Baton Rouge.
Morgan City Review, August 31, 1951.

ACREAGE NOT VERIFIED

10. Geographical Data

UTM NOT VERIFIED

Acreeage of nominated property approx. 0.6 acre

Quadrangle name Morgan City, LA.

Quadrangle scale 1:62,500

UMT References

A

1	5	6	7	10	3	15	10	3	12	8	16	1	10	10
Zone			Easting				Northing							

B

Zone			Easting				Northing							

C

Zone			Easting				Northing							

D

Zone			Easting				Northing							

E

Zone			Easting				Northing							

F

Zone			Easting				Northing							

G

Zone			Easting				Northing							

H

Zone			Easting				Northing							

Verbal boundary description and justification

See attached sketch map.

List all states and counties for properties overlapping state or county boundaries

state	code	county	code

11. Form Prepared By

name/title The Honorable Dr. C. R. Brownell, Mayor of Morgan City

organization _____ date December 1980

street & number P. O. Box 1218 telephone 504-385-1770

city or town Morgan City state La. 70380

12. State Historic Preservation Officer Certification

The evaluated significance of this property within the state is:

national state local

As the designated State Historic Preservation Officer for the National Historic Preservation Act of 1966 (Public Law 89-665), I hereby nominate this property for inclusion in the National Register and certify that it has been evaluated according to the criteria and procedures set forth by the Heritage Conservation and Recreation Service.

State Historic Preservation Officer signature *[Signature]*

title State Hist. Pres. Off. date 2/16/81

For HCRS use only	
I hereby certify that this property is included in the National Register	
<i>[Signature]</i>	date <u>April 9, 1981</u>
Keeper of the National Register	
Attest:	date
Chief of Registration	

MORGAN CITY - CITY HALL

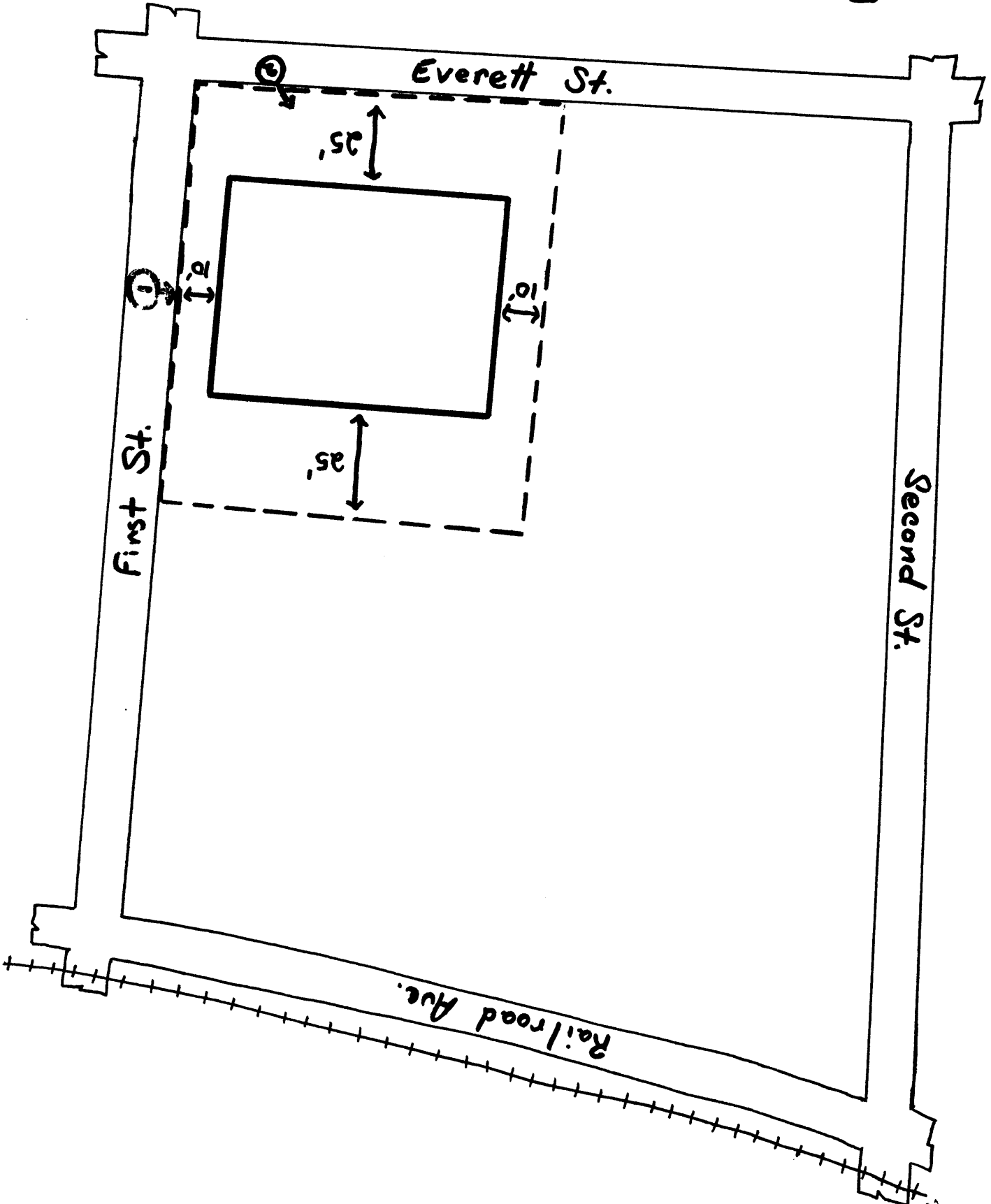

FEB 25 1981
APR 9 1981