

PLANK HOUSES OF GOSHEN, NEW HAMPSHIRE  
 THEMATIC GROUP NOMINATION TO THE NATIONAL REGISTER  
 INDIVIDUAL PROPERTY INVENTORY FORM

Site #4

PROPERTY NAME: <i>Garber House</i>	OWNER: <i>Thomas &amp; Anna Garber</i>
LOCATION: <i>Willey Hill Road, 1/4 mile from Route 31</i>	ADDRESS: <i>Star Route 2 Goshen, NH 03752</i>
UTM REFERENCES: <i>(See continuation sheet)</i>	ACREAGE: <i>56.5</i>
USGS QUADRANGLE: <i>Sunapee NH 15' series</i>	VERBAL BOUNDARY DESCRIPTION:  <i>(See continuation sheet)</i>
PHYSICAL DESCRIPTION: <p><i>This three-inch vertical plank house is one-and-a-half stories with gable roof and rests on a granite foundation. The main block measures roughly 32'x20' and is five bays across by two deep; an ell extends to the west. Windows are 6/6 double hung sash with plain surrounds. The central entry is the building's most notable feature and consists of a six-panel door framed by fluted surrounds with corner blocks and topped by a centered rectangular panel with raised diamond motif. This treatment is flanked by four-pane sidelights resting on panels framed by fluted pilasters. The ell and connected garage measure 42'x15' and are set back seven feet from the main house, an area which provides for an open porch supported by bracketed posts. The four-pane transom light over the garage door suggests that it was once used as a barn.</i></p> <p><i>(See continuation sheet)</i></p>	
STATEMENT OF SIGNIFICANCE: <p><i>The Garber property (c. 1835) is a farm property which continues in agricultural use. In addition to its architectural significance as a plank house, its finely detailed frontispiece is also noteworthy. This is one of two plank houses with this type of door treatment (the other is the Burford House, Site #7). The stepped lintel arrangement above the door is reminiscent of high style Federal door surrounds.</i></p>	
MAP: (Indicate North in Circle)    <i>(See continuation sheet)</i>	PHOTOGRAPH:     
RECORDED BY: <i>Doris Newman</i> ADDRESS: <i>Goshen, NH</i>  DATE: <i>3/8/83</i>	DESCRIPTION OF VIEW: <i>Front (south) &amp; side (east) elevations</i> PHOTOGRAPHER: <i>Leslie Goat, Aug. 1982</i> NEGATIVE WITH: <i>Town Clerk, Goshen NH</i>

PLANK HOUSES OF GOSHEN, NEW HAMPSHIRE  
THEMATIC GROUP NOMINATION TO THE NATIONAL REGISTER  
INDIVIDUAL PROPERTY INVENTORY FORM

\*\*\*

CONTINUATION SHEET

SITE NUMBER: #4 CONTINUATION SHEET NUMBER: #2  
PROPERTY NAME: Garber House

UTM Refernces

Zone 18 Easting: 7-32-700 Northing: 47-95-550

Verbal Boundary Description and Justification:

*Boundaries of the nominated property are highlighted in yellow on the attached sketch map. These boundaries represent the surviving acreage still associated with the house.*

Description (continued):

*Southeast of the ell is a gable-roofed barn with board and batten siding; it has two additions, one with a gable roof and one with a shed roof. There are also two shed-roofed henhouses and a gable-roofed shed, all of which are sided with vertical boards and roofed with roll roofing. The complex is grouped around a circular drive. There is fenced pasture, cleared fields, stone walls, gardens, and livestock present, all of which reinforce the agricultural character of this farm property. The balance of the land is tillage and woodland.*

PLANK HOUSES OF GOSHEN, NEW HAMPSHIRE  
THEMATIC GROUP NOMINATION TO THE NATIONAL REGISTER  
INDIVIDUAL PROPERTY INVENTORY FORM

\*\*\*

CONTINUATION SHEET

SITE NUMBER: #4

CONTINUATION SHEET NUMBER: 3

PROPERTY NAME: Garber House

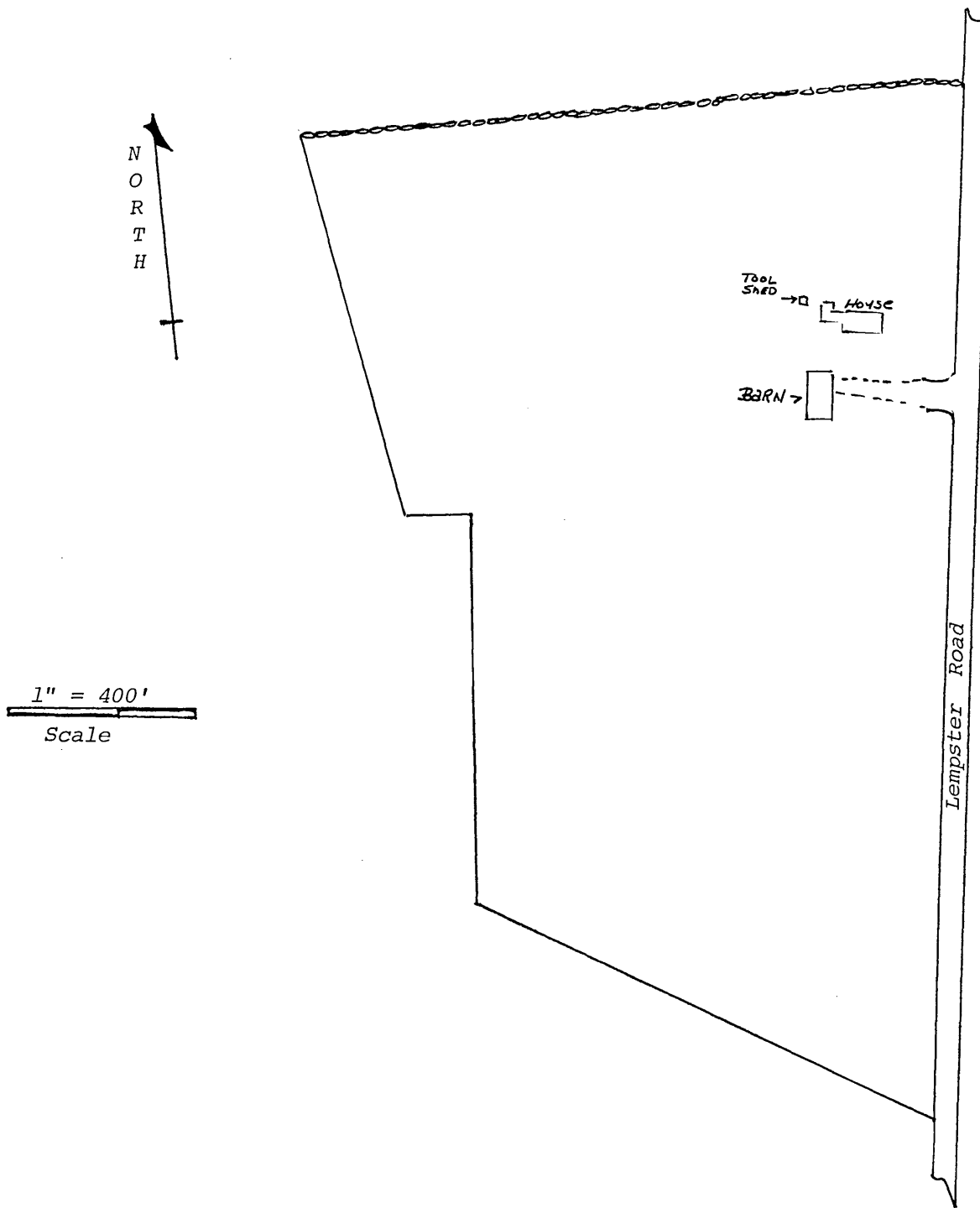

United States Department of the Interior  
National Park Service

SEP 5 1989

# National Register of Historic Places Continuation Sheet

Section number \_\_\_\_\_ Page \_\_\_\_\_

---

GARBER HOUSE (Plank Houses of Goshen New Hampshire TR)

Corrected UTM References (per Round II recommendations)

<u>Site #</u>	<u>Pt.</u>	<u>Zone</u>	<u>Easting</u>	<u>Northing</u>
4	A	18	732370	4794750
	B	18	732155	4794975
	C	18	732250	4795400
	D	18	732620	4795300

United States Department of the Interior  
National Park Service

National Register of Historic Places  
Inventory—Nomination Form

For NPS use only  
received 5/27/85  
date entered

Continuation sheet

Item number

Page 1 of 2

Multiple Resource Area  
Thematic Group

dnr-11

Name Plank Houses of Goshen New Hampshire Multiple Resource Area  
State Sullivan County, NEW HAMPSHIRE

*THEMATIC RESOURCE*

*Conn 6/21/85*

Nomination/Type of Review

Date/Signature

1. Backside Inn

Entered in the  
National Register

*for* Keeper

*Delores Byers 6/21/85*

Attest

2. Burford House

~~Entered in the~~  
Substantive Review

*for* Keeper

*Accept Patrick Andrew 6/21/85*

Attest

3. Cote House

Entered in the  
National Register

*for* Keeper

*Delores Byers 6/21/85*

Attest

4. Covit House

Entered in the  
National Register

*for* Keeper

*Delores Byers 6/21/85*

Attest

5. Durham House

Entered in the  
National Register

*for* Keeper

*Delores Byers 6/21/85*

Attest

6. Garber House

Entered in the  
National Register

*for* Keeper

*Delores Byers 6/21/85*

Attest

7. Giffen House

Entered in the  
National Register

*for* Keeper

*Delores Byers 6/21/85*

Attest

8. Janicke House

Entered in the  
National Register

*for* Keeper

*Delores Byers 6/21/85*

Attest

9. Knights-Morey House

Entered in the  
National Register

*for* Keeper

*Delores Byers 6/21/85*

Attest

10. Lear House

Entered in the  
National Register

*for* Keeper

*Delores Byers 6/21/85*

Attest