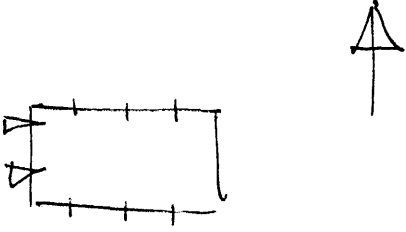

1. Historic Name (s) Roberts Chapel		22. ADD/County Bluegrass/Jessamine	
Original Owner		23. Zoning Classification Magisterial District	
Present Name Roberts Chapel - Methodist Church		24. U.S.G. S. Quadrant (15'/75') Little Hickman	
3. Owner's Name Pastor, Roberts Chapel Methodist Church		25. UTM Reference Zone 16 Easting 7111580 Northing 4188220	
4. Owner's Address Rt. 2, Nicholasville 40356		26. Prehistoric Site Historic Site <input checked="" type="checkbox"/> Building	
5. Location E. side US 27; 4.5 mi. S. of Nicholasville		Object Structure	
6. Open to Public Yes <input checked="" type="radio"/> No <input type="radio"/>	7. Visible from road Yes <input checked="" type="radio"/> No <input type="radio"/>	8. Ownership Private <input checked="" type="checkbox"/> Local <input type="checkbox"/> State <input type="checkbox"/> Federal <input type="checkbox"/>	
9. Local Contact/Organization		27. District Name: Yes <input type="checkbox"/> No <input checked="" type="checkbox"/>	
10. Site Plan with North Arrow 		28. Significance Evaluation National Register	
See Attached Sheet		29. Status National Landmark <input type="checkbox"/> National Register <input type="checkbox"/> Landmark Certificate <input type="checkbox"/> Kentucky Survey <input type="checkbox"/> Local Landmark <input type="checkbox"/> HABS/HAER <input type="checkbox"/>	
11. Architect		30. Theme Primary architecture	
12. Builder		Secondary <input type="checkbox"/> Other <input type="checkbox"/>	
13. Date 1840s		31. Endangered Yes <input type="checkbox"/> No <input checked="" type="checkbox"/>	
14. Style Gothic Grk. Rev.		32. ATTACH PHOTO	
15. Original Use Church		Roll No. 18 and 51	
16. Present Use Church		Picture No. _____	
17. Condition Interior <input type="checkbox"/> Exterior good		Direction _____	
18. Description 3-bay axial facade; Flemish front; brick cornice abuts bracketted cornice; pointed-arch openings with brick labelmolds; Greek Revival church remodeled in Gothic Revival in 3rd 1/4 19th century by adding pointed arches and cornice brackets.		33. Tape No. _____ Negative No. _____	
19. History		34. Prepared by: NCP- KTG	
20. Significance Architecture: the church is one of very few in Jessamine County in a Gothic Revival style; it is a good representative example in a good state of preservation		35. Organization KHC	
21. Source of Information		36. Date summer 1977	
		37. Revision Dates _____ 38. Staff Review _____	

KENTUCKY HISTORIC RESOURCE INVENTORY SUPPLEMENT
BOUNDARY AND LOCATION INFORMATION

Historic Property Name Roberts Chapel Site # JK-43
Multiple Resource/Thematic Nomination Title Jessamine Co.

U.T.M. Coordinates - List multiple UTM's if property is ten or more acres.

A. 16 711580 4188220 D. _____
B. _____ E. _____
C. _____ F. _____

Verbal Boundary Description

Acreage 1.38 acre

Church property bounded by fence on N, E, S,
and by U.S. 27 on W.; includes church and
frame cottage, the ministers residence.

Sketch of Site Plan (Showing outbuildings, structures, landscape features and
the site boundary as described above.)

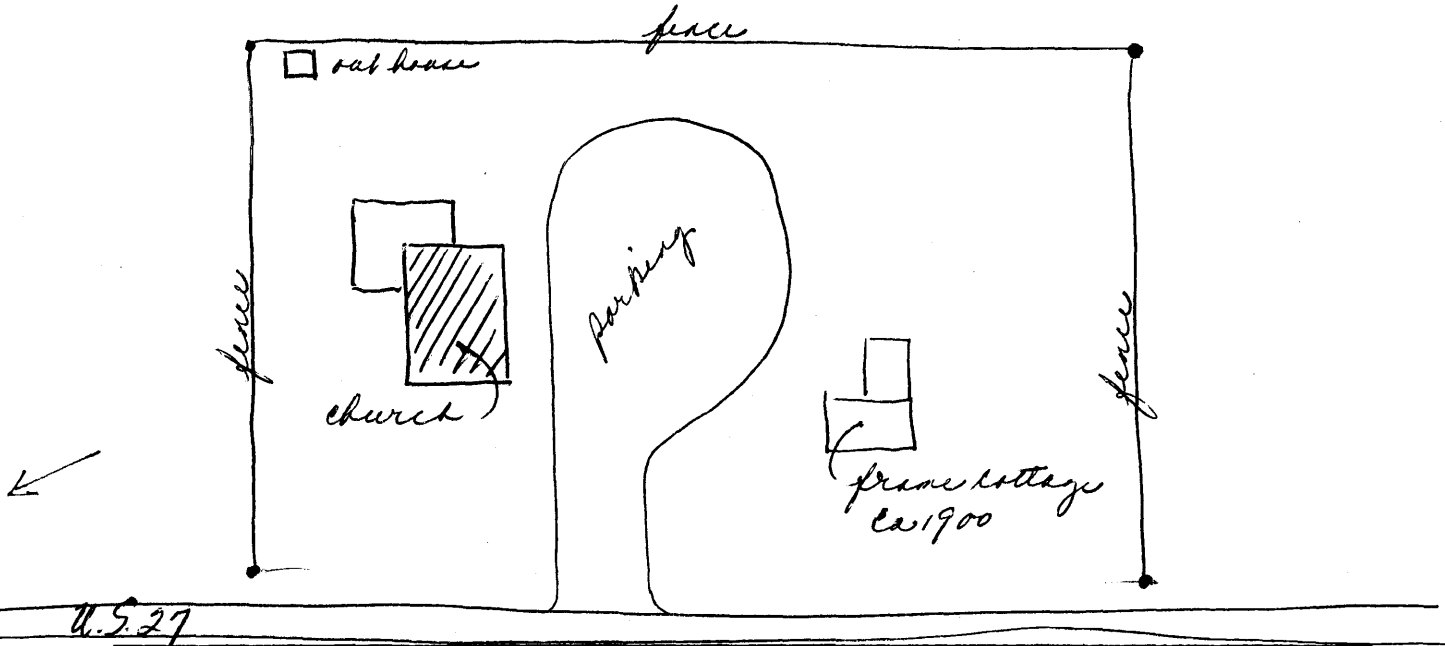

Official Courthouse Property Reference: