

MASSACHUSETTS HISTORICAL COMMISSION
 294 Washington Street, Boston, MA 02108

PHOTO (3x3" or 5x5", black & white)
 Staple to left side of form
 Photo number 103:1

Town REHOBOTH

Address 85 Carpenter Street

Historic Name Samuel Viall House

Use: Original wash house or summer kitchen

Present residence

Ownership: Private individual
 Private organization _____

Public _____

Original owner Peter or Thomas
 Carpenter

SKETCH MAP

Draw map showing property's location in relation to nearest cross streets and other buildings or geographical features. Indicate north.



DESCRIPTION:

Date ca 1800

Source tradition

Style Greek Revival

Architect unknown

Exterior wall fabric clapboard

Outbuildings barn

Major alterations (with dates) _____

completely remodelled ca 1850

Moved no Date _____

Approx. acreage one

Setting 30' from road; gable end to road;
rural context

UTM: 19/3128800/46358800

Recorded by V H Adams

Organization Rehoboth Historical Commission

Date June 1981

ARCHITECTURAL SIGNIFICANCE (describe important architectural features and evaluate in terms of other buildings within community)

The architectural significance of the Samuel Viall House is dual; it stands as a well detailed and proportioned three-bay sidehall plan Greek Revival cottage, very few of which were built in Rehoboth, and also illustrates the architectural metamorphoses so often generated by this conservative and economically limited town in the 19th century.

The core of this house was probably built by Peter or Thomas Carpenter of 89 Carpenter Street ca. 1800 as an outbuilding, perhaps a wash house and summer kitchen. The house has undergone several transformations since it was purchased from the Carpenters by Samuel Viall in ca. 1850. The original structure of unknown height was built into a hill on the street (north) side. The original brick foundation, highly unusual in

(Continued)

HISTORICAL SIGNIFICANCE (explain the role owners played in local or state history and how the building relates to the development of the community)

The Viall family, members of whom were prosperous dairy farmers, owned the property into the twentieth century. This is the only house built on Carpenter Street between the early 19th and mid 20th centuries.

BIBLIOGRAPHY and/or REFERENCES

INVENTORY FORM CONTINUATION SHEET

MASSACHUSETTS HISTORICAL COMMISSION
Office of the Secretary, Boston

Community: Rehoboth	Form No: 212
Property Name: Samuel Viall House	

Indicate each item on inventory form which is being continued below.

Architectural Significance (Continued)

Rehoboth, rises to a full story on the south side. The structure retains a center brick chimney with a fireplace and oven on the south side at ground level. The original post and beam construction is fully exposed here. A stone lintel support for a hearth directly above appears original, indicating at least one original floor above the cellar. Above, at street level, renovations have created a one-and-one-half story Greek Revival sidehall plan cottage. In the entrance hall and front (north) parlor, the door and window moldings mirror the channelled pilasters found on the exterior of contemporary large Greek Revival structures such as the Village Congregational Church (#2). Undecorated square blocks mark corner interesections. The same motif is echoed in the parlor fireplace mantel. Details are completed by a dado and chairrail. In 1953, the north room was enlarged (west), but the dado and trim were reused or replicated. The south room is unaltered, although less interesting architecturally, but contains a massive free standing "High Street Furnace Com" cast iron fireplace with engaged ionic columns and brass trim. The east additions to the house, including garage and sunporch, date to the 20th century. A late 19th to early 20th century barn, earlier at the site of the present garage, was moved south of the house approximately two hundred feet ca. 1940.

As a particularly handsome example of an uncommon architectural type in Rehoboth which also represents the evolution of building form, the Samuel Viall House meets criterion C of the National Register of Historic Places individually.

Staple to Inventory form at bottom

United States Department of the Interior
National Park Service

National Register of Historic Places
Inventory—Nomination Form

For NPS use only
received
date entered

Continuation sheet

Item number

Page 724

Multiple Resource Area
Thematic Group

Name Rehoboth Multiple Resource Area
State Massachusetts

Nomination/Type of Review

Date/Signature

- 31. Martin Farm Substantive Review Keeper M. J. [Signature] 6/6/83
Attest _____
- 32. Peck-Bowen House Entered in the National Register for Keeper Melrose Byers 6/6/83
Attest _____
- 33. Perry, James House Entered in the National Register for Keeper Melrose Byers 6/6/83
Attest _____
- 34. Pierce, Capt. Mial, Farm Entered in the National Register for Keeper Melrose Byers 6/6/83
Attest _____
- 35. Viall, Samuel, House Entered in the National Register for Keeper Melrose Byers 6/6/83
Attest _____
- 36. Wheeler, Aaron, House Entered in the National Register for Keeper Melrose Byers 6/6/83
Attest _____
- 37. Wheeler-Ingalls House Keeper _____
Attest _____
- 38. Keeper _____
Attest _____
- 39. Keeper _____
Attest _____
- 40. Keeper _____
Attest _____

35

T

United States Department of the Interior
National Park Service

Horton, Welcome, Farm (Rehoboth MRA)
Bristol County
MASSACHUSETTS

Working No. 4/25/83
Fed. Reg. Date: 2.7.84
Date Due: 5/26/83 - 6/9/83
Action: ACCEPT 6/6/83
 RETURN
 REJECT
Entered in the National Register
Federal Agency: _____

- resubmission
- nomination by person or local government
- owner objection
- appeal

Substantive Review: sample request appeal NR decision

Reviewer's comments:

Recom./Criteria _____
Reviewer _____
Discipline _____
Date _____
 see continuation sheet

Nomination returned for: technical corrections cited below
 substantive reasons discussed below

1. Name

2. Location

3. Classification

Category	Ownership	Status	Present Use
	Public Acquisition	Accessible	

4. Owner of Property

5. Location of Legal Description

6. Representation in Existing Surveys

has this property been determined eligible? yes no

7. Description

Condition		Check one	Check one
<input type="checkbox"/> excellent	<input type="checkbox"/> deteriorated	<input type="checkbox"/> unaltered	<input type="checkbox"/> original site
<input type="checkbox"/> good	<input type="checkbox"/> ruins	<input type="checkbox"/> altered	<input type="checkbox"/> moved date _____
<input type="checkbox"/> fair	<input type="checkbox"/> unexposed		

Describe the present and original (if known) physical appearance

- summary paragraph
- completeness
- clarity
- alterations/integrity
- dates
- boundary selection

8. Significance

Period _____ Area of Significance—Check and justify below

Specific dates _____ Builder/Architect _____

Statement of Significance (in one paragraph)

- summary paragraph
- completeness
- clarity
- applicable criteria
- justification of areas checked
- relating significance to the resource
- context
- relationship of integrity to significance
- justification of exception
- other

9. Major Bibliographical References

10. Geographical Data

Acres of nominated property _____

Quadrangle name _____

UMT References _____

Verbal boundary description and justification _____

11. Form Prepared By

12. State Historic Preservation Officer Certification

The evaluated significance of this property within the state is:

national state local

State Historic Preservation Officer signature _____

title _____ date _____

13. Other

- Maps
- Photographs
- Other

Questions concerning this nomination may be directed to _____

Signed _____ Date _____ Phone: 202 272-3504

Comments for any item may be continued on an attached sheet



212

85 CARPENTER STREET

103:1

Vial Samuel, House

Rehehota MRA, Ma

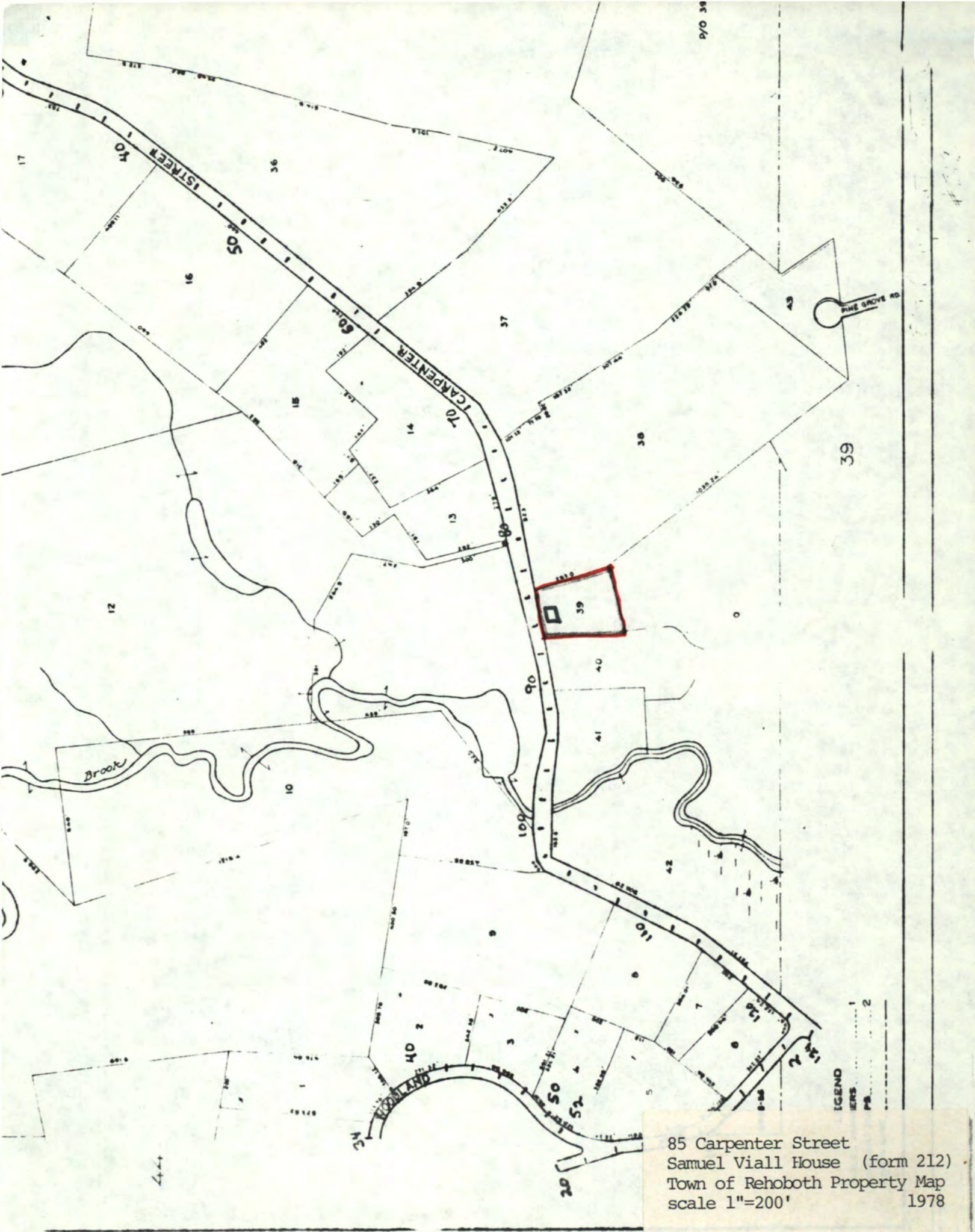

85 Carpenter Street
 Samuel Viall House (form 212)
 Town of Rehoboth Property Map
 scale 1"=200'
 1978

Please refer to the map in the
Multiple Property Cover Sheet
for this property

Multiple Property Cover Sheet Reference Number: 64000292