

United States Department of the Interior National Park Service

APR 17 1990

National Register of Historic Places Registration Form

NATIONAL REGISTER

This form is for use in nominating or requesting determinations of eligibility for individual properties or districts. See instructions in Guidelines for Completing National Register Forms (National Register Bulletin 16). Complete each item by marking "x" in the appropriate box or by entering the requested information. If an item does not apply to the property being documented, enter "N/A" for "not applicable." For functions, styles, materials, and areas of significance, enter only the categories and subcategories listed in the instructions. For additional space use continuation sheets (Form 10-900a). Type all entries.

1. Name of Property

historic name Buchanan Street Historic District
other names/site number N/A

2. Location

street & number Along sections of Buchanan, Union, and Wellington Streets, and Riverview Dr.
city, town Hickman and Wellington Streets, and Riverview Dr.
state Kentucky code KY county Fulton code 075 zip code 42050

3. Classification

Table with 3 columns: Ownership of Property, Category of Property, and Number of Resources within Property. Includes sub-rows for Contributing and Noncontributing resources.

Name of related multiple property listing: Hickman, Kentucky, Multiple Resource Area

Number of contributing resources previously listed in the National Register 0

4. State/Federal Agency Certification

As the designated authority under the National Historic Preservation Act of 1966, as amended, I hereby certify that this nomination request for determination of eligibility meets the documentation standards for registering properties in the National Register of Historic Places and meets the procedural and professional requirements set forth in 36 CFR Part 60. In my opinion, the property meets does not meet the National Register criteria. See continuation sheet. Signature of certifying official David L. Morgan, State Historic Preservation Officer, Kentucky Heritage Council. Date 6-12-90

In my opinion, the property meets does not meet the National Register criteria. See continuation sheet. Signature of commenting or other official. Date. State or Federal agency and bureau.

5. National Park Service Certification

I, hereby, certify that this property is: entered in the National Register. determined eligible for the National Register. determined not eligible for the National Register. removed from the National Register. other, (explain:)

Signature of the Keeper

Date of Action

6. Function or Use

Historic Functions (enter categories from instructions)

Dwelling/Single Family

Religion/Church

Current Functions (enter categories from instructions)

Dwelling/Single Family

Religion/Church

7. Description

Architectural Classification

(enter categories from instructions)

Greek Revival/ Neo-Classic Revival

Victorian Gothic / Colonial Revival

Italianate

Materials (enter categories from instructions)

foundation Brick/Stone/Hollow Core Concrete

walls Brick/Wood/Hollow Core Concrete

roof Asphalt

other Wood/Cast Iron

Describe present and historic physical appearance.

The Buchanan Street Historic District contains sixteen primary buildings located along Buchanan and adjacent streets in Hickman, Kentucky. This area is located on the top of a steep bluff overlooking the Mississippi River and is relatively level. To the north of the district are modern and remodeled structures on Moulton Street while to the east, south, and west the bluff steeply descends several hundred feet into ravines and lower sections of the town. The Buchanan Street Historic District contains fourteen residences and four religious buildings of which all but one contribute to the character of the district. The only non-contributing building in the district was built after the district's period of significance. In addition to these buildings the district contains several secondary structures such as automobile garages and fencing.

Before 1850, the majority of the buildings in Hickman were constructed either in the lower town section or along the bluff on Moulton Street. During the town's boom of the 1850s many new brick and frame residences were built south of Moulton Street along Wellington and Buchanan Streets. This area was a preferred residential section of the community because of its flat, developable land and location above the floods which beset Hickman. Several residences are known to have been built in the area in this decade but none survive. The house at 103 W. Wellington is the oldest house in the district and appears to have been constructed in the 1860s with Greek Revival influences.

By the late 19th century several other new buildings were constructed on Buchanan, Wellington and adjacent streets. The most notable of these include the Cowgill House at 204 Buchanan Street which was built in 1890 with Italianate influences. Other buildings of this period include the Italianate companion residences on Buchanan Street built by John Cowgill, and the Helm residence built in 1889. Several one-story Folk Victorian T-plan residences were also built in these years, two of which remain at 203 Buchanan Street and 615 Obion Street.

In addition to being a prominent residential area, several lots were also purchased by local congregations for church buildings. In 1899, the Victorian Gothic style Episcopal Church was built at the northwest corner of Buchanan and Union Streets. Other churches located in the area include an independant

8. Statement of Significance

Certifying official has considered the significance of this property in relation to other properties:

APR 17 1990

nationally statewide locally

Applicable National Register Criteria A B C D

Criteria Considerations (Exceptions) A B C D E F G

Areas of Significance (enter categories from instructions)
 Architecture

Period of Significance
 ca. 1870 - ca. 1935

Significant Dates
 N/A

Cultural Affiliation
 N/A

Significant Person
 N/A

Architect/Builder
 Unknown

State significance of property, and justify criteria, criteria considerations, and areas and periods of significance noted above.

The Buchanan Street Historic District is significant under criteria C for its late 19th and early 20th century architectural appearance. It retains its early 20th century architectural character and contains some of the finest historic architecture in Hickman. This area is located on the top of the Old Hickman bluff and was a preferred residential section of the town during its growth and development. The district contains sixteen primary buildings of which all but one were built prior to 1935. Most structures were constructed between 1890 and 1920 and represent some of the finest homes built in Hickman during these decades. The district retains its original architectural character and there are no primary buildings constructed after the period of significance.

The land comprising the Buchanan Street Historic District was laid out as part of the original town plan in 1837 by G.W.L. Marr and it became a preferred residential area of Hickman in the mid-19th century. While most of the early residences of the community were built in the lower town section, flooding from the Mississippi River was a continual problem. By 1860, numerous residences lined the top of the bluff along Moulton, Wellington, and Buchanan Streets and were the homes of many of Hickman's leading citizens. Descriptions and historic maps of the bluff area reveal many fine brick and frame residences occupying lots in the district into the 1870s and 1880s. Homes continued to be built to the late 19th century and several residences built with Italianate influences such as the Henry Cowgill House remain from this period. Other homes were built in vernacular forms such as T-plan designs or central passage plans with Queen Anne detailing.

In addition to the many residences built in the area several church congregations also built frame and brick churches on the bluff. By 1900, both the Episcopal and Methodist congregations had built brick churches across from each other on Union Street and Wellington Street and an independent church had a frame building on Tennessee Street. These locations were desired because of the level land available and safety from flooding.

See continuation sheet

9. Major Bibliographical References

1990

Fulton County Historical Society, Fulton County History. Taylor Publishing Company: Dallas, 1983

Hickman Courier. "Special Manufacturing and Industrial Edition." Hickman, Kentucky, September 19, 1902.

Powers, William. Interview. Hickman, Kentucky. 11, July, 1989

Sanborn-Perris Company, New York. Sanborn Fire Insurance Maps of Hickman, Kentucky, 1886, 1892, 1896, 1900, 1905, 1910, 1917, 1927.

Simmons, Phyllis, Interview. Hickman, Kentucky. 10 July, 1989.

Vision Development Inc., "Historic Walking Tour of Hickman, Kentucky." n.d.

See continuation sheet

Previous documentation on file (NPS):

- preliminary determination of individual listing (36 CFR 67) has been requested
- previously listed in the National Register
- previously determined eligible by the National Register
- designated a National Historic Landmark
- recorded by Historic American Buildings Survey # _____
- recorded by Historic American Engineering Record # _____

Primary location of additional data:

- State historic preservation office
- Other State agency
- Federal agency
- Local government
- University
- Other

Specify repository: _____

10. Geographical Data

Acreage of property 6.8 acres

UTM References

A 116 303620 40493110
 Zone Easting Northing

C 116 303360 40491810

B 116 3035160 404911810
 Zone Easting Northing

D 116 3034010 40493210

Hickman Quad.

See continuation sheet

Verbal Boundary Description

See continuation sheet

Boundary Justification

See continuation sheet

11. Form Prepared By

name/title Philip Thomason
 organization Thomason and Assoc. date 9/29/89
 street & number P.O. Box 121225 telephone 615-383-0227
 city or town Nashville state TN zip code 37212

United States Department of the Interior
National Park Service

1990

National Register of Historic Places
Continuation SheetSection number 7 Page 2Buchanan Street Historic District
Hickman, Kentucky Multiple Resource Area

church at the northeast corner of Buchanan and Tennessee Streets, and a Methodist Church at the southeast corner of Wellington and Union Streets. The independent church building was later replaced in 1916 with a church built by the Christian Church congregation. This building was constructed with Spanish Mission detailing with a curvilinear parapet wall. The Methodist Church was a one-story brick building but burned in the 1930s and was replaced with the present Late Gothic design.

In the early 20th century, Hickman's rapid growth and development resulted in many new residences constructed in the town including properties on the bluff. The most notable of these was the Neo-Classical style residence built by Dr. James Hubbard at 215 Buchanan Street. This brick residence was designed with stone quoins, leaded glass windows, and a monumental Ionic portico on the main facade. Upon its completion it was regarded as one of the finest residences in Hickman. Other important structures built in these years were the S.M. Hubbard residence and Moore residence which were both of hollow core concrete block construction. These houses were built in Foursquare plans with Colonial Revival detailing. The Henry Helm House on Buchanan Street was constructed in a Foursquare plan with Prairie style influences in its horizontality and wide eaves. Several of these homes also had brick and frame automobile garages constructed to the side or rear which also contribute to the character of the district.

After 1920, few new structures were built in the Buchanan Street area with the Episcopal Church parsonage the only intrusion in the district. This building was moved to the site in the 1940s and has been remodeled several times. No other non-contributing residence or primary building is located in the district. The Buchanan Street Historic District continues to maintain its early 20th century character and appearance.

Individual Property Descriptions

1. 101 Buchanan Street: 2 story frame, 3 bay, rectangular plan, Foursquare residence built ca. 1905. The house has a brick foundation, hipped roof with composition shingles, hipped roof dormer with paired diamond light windows, exterior brick chimney and added metal siding. On the side (E) facade is an original 1 story wing with a hipped roof. On the side (W) facade is a ca. 1960 1 story frame garage addition. The main (N) facade has a 1 story porch with square Doric motif columns. The main entrance has an original single light glass and frame door. Windows are 1/1 light rectangular wood sash. (C)

17 1990

United States Department of the Interior
National Park ServiceNational Register of Historic Places
Continuation SheetSection number 7 Page 3Buchanan Street Historic District
Hickman, Kentucky Multiple Resource Area

2. 107 Buchanan Street (FUH-38): 1 story brick, 3 bay, rectangular plan, Italianate influenced residence built ca. 1890. The house has a stuccoed brick foundation, hipped roof with composition shingles, bracketed cornice, exterior brick chimney, and stucco exterior. On the main (N) facade is a partial width shed roof porch with slender Tuscan columns. The main entrance door is glass light and frame with sidelights and boarded transom. Windows are rectangular 4/4 light wood sash set within an arched opening. 109 Buchanan Street is identical in plan. (C)

3. 109 Buchanan Street: 1 story frame, 3 bay, rectangular plan, Italianate influenced residence built ca. 1890. The house has a brick foundation, hipped roof with composition shingles, bracketed cornice, and exterior brick chimney. On the main (N) facade is a gable front porch with slender wood columns. The main facade entrance door is single light glass and frame panelled door with sidelights and transom. Windows are 4/4 light rectangular wood sash with arched window heads. 107 Buchanan Street is identical in plan. (C)

4. 203 Buchanan Street (FUH-41): 1 story frame, 3 bay, T-Plan residence built ca. 1895. The house has a gable roof with asphalt shingles, concrete block foundation and weatherboard siding. On the main (N) facade is a full width shed roof porch with wood columns, solid wood railing and screen panels. The entrance door is original wood panel with sidelights and transom. The projecting gable front bay has diagonal framing and diamond shaped shingles in the gable field. Windows are 4/4 light rectangular wood sash. (C)
At the rear is a 1 story frame, ca. 1920 gable roof shed. (C)

5. Henry Cowgill House, 204 Buchanan Street (FUH-44): 2 story brick, 3 bay, rectangular plan, Italianate residence built ca. 1890. The house has a hipped roof with composition shingles, interior brick chimneys, and corbelled brick cornice. On the main (W) facade is panelled entrance door with sidelights, transom, and modillion block cornice. Windows are 1/1 light rectangular wood sash. On the side (N) facade is a 1 story sunroom with 1/1 light rectangular wood sash windows. On the rear (E) facade is a 1 story brick, flat roof, addition with garage. The rear entrance door is wood frame with divided transom and is flanked by 1/1 light rectangular wood sash windows. On the second story of the rear (E) facade is an entrance door with transom. Attached to the side (N) facade is a 1 story concrete block garage with a flat roof. (C)

6. Henry Helm House, 206 Buchanan Street (FUH-40): 2 story brick, 3 bay, Foursquare residence built ca. 1915. The house has a hipped roof with asbestos shingles, hipped roof dormer with louvered panels, interior brick chimneys and wide eaves with exposed rafters. On the main (S) facade is a full width porch

17 1990

United States Department of the Interior
National Park ServiceNational Register of Historic Places
Continuation SheetSection number 7 Page 4Buchanan Street Historic District
Hickman, Kentucky Multiple Resource Area

with dentilled cornice and paired square wood columns. The entrance door is original single light and frame with sidelights and divided transom. Windows are single or triple 5/1 vertical light rectangular wood sash. The main facade porch extends to the side (W) facade to form a porte cochere with dentilled cornice and paired square wood columns. Also on the side (W) facade is an enclosed porch. On the rear (N) facade is an enclosed sunroom addition. (C)

At the side is a ca. 1915 1 story brick, hipped roof garage with 4/4 light rectangular wood sash windows. (C)

7. Annie Helm House, 209 Buchanan Street (FUH-42): 1 1/2 story frame, 5 bay, residence built in 1889. The house has a gable roof with composition shingles, interior brick chimneys, and vinyl siding. At the roofline of the main (N) facade is a central gable front bay with a 2/2 light wood sash window and fishscale shingles in the gable field. Flanking the center bay are 2 gable front dormers with 2/2 light wood sash windows and fishscale shingles in the gable fields. The main entrance has a wood louvered screen door on the exterior and transom. Windows are 1/1 light rectangular wood sash. On the side (E) facade is a polygonal bay with 1/1 light rectangular wood sash windows. On the side (W) facade is an open carport with gable roof. (C)

At the rear is a cast iron gazebo added to the site ca. 1950. (NC)

8. Dr. James Hubbard House, 215 Buchanan Street (FUH-43): 2 1/2 story brick, 4 bay, rectangular plan, Neo-Classical residence built ca. 1903. The house has a hipped slate roof with ridge tiles and finial, interior brick chimneys, deep cornice with block modillions, smooth stone quoins, and stone foundation. On the main (N) facade is a projecting gable front 2 story porch with a Palladian style window in the gable field, deep cornice with block modillions, and full height fluted Ionic columns. The projecting entrance bay has original glass light and frame door with curved leaded glass sidelights and divided transom. Above the entrance is a balcony with wrought iron railing and original entrance door of glass light and frame flanked by engaged columns with sidelights and transom set within an arched opening with stone voussoirs. Windows on the main (N) facade first story are arched 1/1 light wood sash with leaded glass upper lights and stone lintels with keystone. Second floor windows are oval leaded glass with stone surrounds and keystones. On the side (E) and (W) facades are projecting gable front bays with attic fanlight windows in the gable fields. On the side (W) facade is a 1 story flat roof porch with triple Ionic columns resting on piers with turned balustrade. Side entrance door is original glass light and frame with leaded glass transom. Remaining windows are 2/2 light rectangular wood sash with stone lintels and keystones. (C)

To the rear is a ca. 1960 1 story brick garage with gable roof, exposed rafters, and metal garage doors. (NC)

United States Department of the Interior
National Park Service

APR 17 1990

National Register of Historic Places
Continuation SheetSection number 7 Page 5Buchanan Street Historic District
Hickman, Kentucky Multiple Resource Area

9. 615 Obion Street: 1 story frame, 5 bay, ca. 1890 residence with a double gable front. The residence has a gable roof of asphalt shingles, and ca. 1970 metal siding. The house no longer retains its original porch. The main entrance has an original paneled door with sidelights and transom. Windows are 1/1 wood sash. The south facade has an original 2 bay wing. (C)

To the south of the residence is a ca. 1980 gable front metal garage. (NC)

10. Frank Moore House, 305 Riverview Drive (FUH-45): 2 story hollow core concrete, 3 bay, Foursquare residence built ca. 1914. The house has a hipped roof with composition shingles, interior hollow core concrete chimneys, and concrete foundation. At the roofline is a hipped roof dormer with a multi-light window. On the main (N) facade is a 1 story full width shed roof porch which wraps around to the side (E) facade with hollow core concrete columns and railing. The entrance door is original leaded glass and frame with divided transom. Windows are 9/1 light rectangular wood sash. On the rear (S) facade is a shed roof porch with wood posts and railing. The rear facade entrance door is panelled frame with transom. (C)

At the rear is a 1 story ca. 1914 concrete block garage with hipped roof. (C)

11. The First Christian Church, 111 Tennessee Street (FUH-39): 1 story brick, 3 bay, Spanish Mission influenced church built in 1918. The church is rectangular in plan with a projecting corner entrance bay. At the roofline is a stepped parapet with concrete coping and interior brick chimneys. The projecting corner entrance bay on the main (SW) facade has a gable front with parapet and diamond pattern in the gable field. The arched brick entrance has an arched transom and double entrance doors of glass light and frame. Brick cheek walls extend beyond the bay. On either side of the projecting entrance bay are arched fixed multi-light windows. On both the side (S) and (W) facades are large central windows flanked by brick buttresses. The windows are a quatrefoil design with multi-lights, concrete surrounds and keystones. Also on the side (W) facade are secondary double entrance doors of glass light and frame with multi-light transom and a bracketed hood. Windows are 6/6 light rectangular wood sash. (C)

To the east of the church is a ca. 1900 cast iron dart fence located along the sidewalk at Buchanan Street. (C)

12. St. Paul's Episcopal Church, 611 Union Street (FUH-3): 1 story brick, 2 bay, rectangular plan, Victorian Gothic church built in 1899. The church has a brick foundation and gable roof with composition shingles. The church's gable front design has a square corner entrance tower with a bell shaped roof topped by a

United States Department of the Interior
National Park Service

APR 17 1990

National Register of Historic Places
Continuation SheetSection number 7 Page 6Buchanan Street Historic District
Hickman, Kentucky Multiple Resource Area

cross. On the tower sides just below the roofline are grouped pointed arch louvered openings with rusticated brick relief arching. The tower windows are pointed arch fixed multi-light with rusticated brick relief arching. On the main (E) facade of the tower are double raised wood panel entrance doors with pointed arch transom and rusticated brick relief arching. On the gable front of the main (E) facade is a large pointed arch stained glass window with wood tracery and rusticated brick relief arching. Above this window in the gable field is a small circular attic window with border glass. Windows on the side (S) and (N) facades are pointed arch 1/1 light stained glass with stained glass border glass and rusticated brick relief arching. Also on the side (N) facade is an original four panel wood frame entrance door with a pointed arch transom with stained glass and stained glass border glass and rusticated brick relief arching. In the center bay of the rear (W) facade is a large pointed arch stained glass window with rusticated brick relief arching. In the gable field is a small circular attic louvered opening framed by rusticated brick. Either side of the central window were originally two entrance doors. The remaining door is original four panel wood frame with rusticated brick relief arching. The other door has been removed and replaced with a 4 light rectangular sash window. The church interior retains original hammerbeam wood roof trusses, wood pews, and carved altar and railing. (C)

13. At the rear of the church is a 1 story frame, 4 bay, Parish House built ca. 1930 and remodeled ca. 1980. The Parish House has a hipped roof with composition shingles, wide eaves, aluminum siding, 6/6 light rectangular wood sash windows, and glass light and frame entrance door. (NC)

14. The First Methodist Church, 101 E. Wellington Street (FUH-37): 1 story brick, 3 bay, rectangular plan, gable front, Late Gothic Revival church built in 1934. The church has a steeply pitched gable roof with composition shingles and parapet walls with concrete coping. The main (N) facade and side (E) and (W) facade bays are divided by stepped brick buttresses. In the center bay of the main (N) facade is a large pointed arch stained glass window with wood tracery. On both the side (E) and (W) facades are projecting gable front entrance bays. The double wood frame pointed arch entrance doors are set within recessed pointed arch openings. Windows on the side (E) and (W) facades are pointed arch stained glass with wood tracery. At the rear (S) facade is a 2 story brick ell with flat roof, interior brick chimneys, and 8/4 light rectangular metal frame windows. At the rear is a 1 story, concrete block, gable roof building with wood frame door and 2/2 light rectangular metal frame windows. (C)

15. 103 W. Wellington Street (FUH-73): 1 story frame, 5 bay, rectangular plan, Greek Revival residence built ca. 1870. The house has a stuccoed brick

APR 17 1990

United States Department of the Interior
National Park ServiceNational Register of Historic Places
Continuation SheetSection number 7 Page 7Buchanan Street Historic District
Hickman, Kentucky Multiple Resource Area

foundation, gable roof with composition shingles, interior brick chimney, and vinyl siding. On the main (N) facade is a central projecting gable front porch with polygonal wood columns, wood balustrade with square balusters and wrought iron railing. The central entrance door has an exterior louvered door, divided light sidelights and divided light transom. Windows are 6/6 light rectangular wood sash. On the rear (S) facade are two gable roof all additions with brick foundations, vinyl siding, and 2/2 and 4/4 light rectangular wood sash windows. (C)

To the side is a carport with flat metal roof and wrought iron columns. (NC)

16. S.M. Hubbard House, 113 W. Wellington Street (FUH-36): 2 story hollow core concrete, 3 bay, Foursquare residence built ca. 1915. The house has a hipped roof with composition shingles, shed roof dormers with grouped attic louvers, and interior hollow core concrete chimneys. On the main (N) facade is a full width shed roof porch with wood Doric columns. The wood frame entrance door has a surround with fluted pilasters and dentilled cornice. Windows are 1/1 light rectangular wood sash. The first floor windows on the main facade have a decorative frame panel below the windows. On the side (W) facade is a shed roof porch with hollow core concrete columns which is now enclosed with screen panels. (C)

At the rear is a 1 story frame, gable roof ca. 1920 shed. (C)

At the sidewalk is a ca. 1890 cast iron fence associated with the previous residence on this site. (C)

APR 17 1990

United States Department of the Interior
National Park ServiceNational Register of Historic Places
Continuation SheetSection number 8 Page 2Buchanan Street Historic District
Hickman, Kentucky Multiple Resource Area

After 1900, Hickman experienced a boom in construction and economic development which is reflected in the Buchanan Street area. All of the mid-19th century brick and frame residences were razed and new buildings were constructed on their sites. The S.M. Hubbard House on Wellington Street replaced an earlier frame home and the Henry Helm House replaced an earlier brick residence. Altogether five two-story residences were built in the district between 1903 and 1918 and replaced earlier homes on these lots. Four of these were built in Foursquare plans with Colonial Revival or Prairie style influences. The high style Neo-Classical residence at 215 Buchanan Street built by Dr. James Hubbard is the only example of this style in the town and is the most architecturally significant residence of the period. Owners such as the Hubbard family and Helm family were some of the most prominent in Hickman and their homes reflected the prosperity and prominence of the community.

Following World War I, most lots in the area had been developed and little new construction occurred for several decades. The Christian Church at the northeast corner of Buchanan and Tennessee Streets was completed in 1918 and was the last major building constructed in the district until the 1930s. While no major residence was built during the Depression, a new Methodist Church was built in 1934 to replace an earlier church destroyed by fire. The Buchanan Street Historic District retains its early 20th century architectural character and represents one of the most significant collections of historic architecture in Hickman.

MAY 17 1990

United States Department of the Interior
National Park ServiceNational Register of Historic Places
Continuation SheetSection number 10 Page 1Buchanan Street Historic District
Hickman, Kentucky Multiple Resource Area

Verbal Boundary Description: The boundary for the Buchanan Street Historic District is illustrated on the accompanying Fulton County tax map which is drawn at a scale of 1" = 100'. The boundary includes lot 357, lots 359-363, lots 375-382 of the Old Hickman plat. The boundary also includes seven unnumbered lots located along the south side of Buchanan Street. In addition to these properties the boundary includes lots 143 and 205 of the West Hickman subdivision.

Verbal Boundary Justification: The boundary for the Buchanan Street Historic District includes all unaltered contiguous properties which retain architectural integrity along Buchanan and Wellington Streets. All but one of these contiguous buildings were constructed during the district's period of significance and the district retains its overall site and setting. Properties excluded on the edges of the district are those which were built after the district's period of significance or have been extensively altered and no longer retain original architectural character. The boundary is drawn on the north to exclude modern and altered structures on Wellington Street. To the east and south the boundary is drawn to exclude modern structures and a steep ravine to the south of Buchanan Street. On the west the boundary excludes modern or altered structures.

BUCHANAN STREET
HISTORIC DISTRICT
District Boundary

APR 11 1990

Scale: 1" = 100'



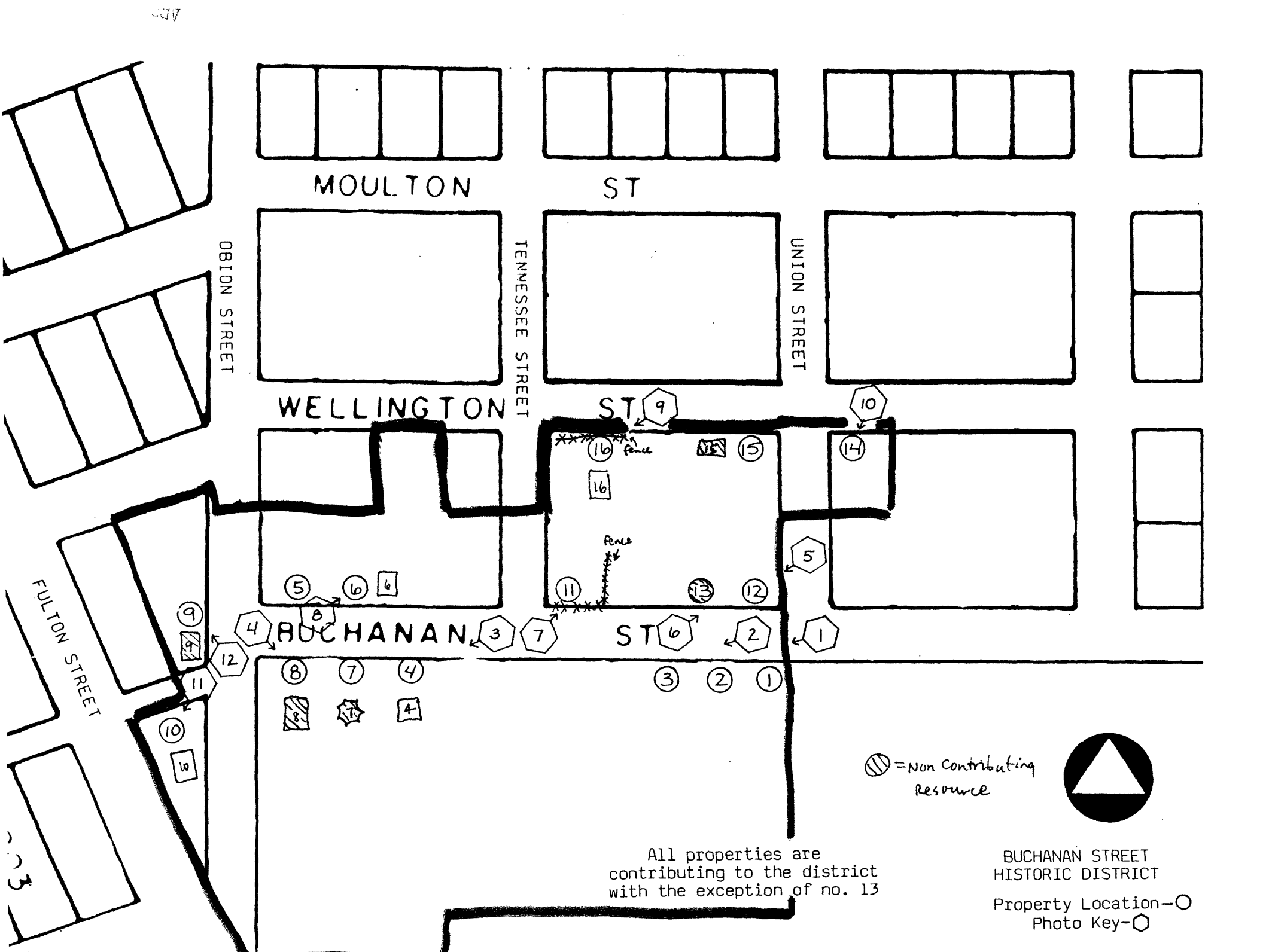

MOULTON

ST

WELLINGTON

ST

BUCHANAN

ST

OBION STREET

TENNESSEE STREET

UNION STREET

FULTON STREET

⊘ = Non Contributing Resource



All properties are contributing to the district with the exception of no. 13

BUCHANAN STREET HISTORIC DISTRICT

Property Location—○
Photo Key—⊘

United States Department of the Interior
National Park Service

APR 17 1990

**National Register of Historic Places
Continuation Sheet**

Section number _____ Photo Sheet _____ Page _____

Buchanan Street Historic District
Hickman, Kentucky Multiple Resource Area

Hickman, Kentucky Multiple Resource Area

Buchanan Street Historic District

Photo by: Thomason and Associates

Neg: KY Heritage Council

Date: July, 1989

View: Towards southwest of 101, 107 and 109 Buchanan Street.

Photo # 1 of 12

View: Towards southwest of 107 and 109 Buchanan Street.

Photo # 2 of 12

View: Towards southwest of 203 Buchanan Street.

Photo # 3 of 12

View: Towards southeast of 215 Buchanan Street.

Photo # 4 of 12

View: Towards southwest of 611 Union Street, St. Paul's Episcopal Church.

Photo # 5 of 12

View: Towards northeast of cast iron fence in 100 block of Buchanan Street.

Photo # 6 of 12

View: Towards northeast of 111 Tennessee Street, First Christian Church.

Photo # 7 of 12

View: Towards northeast of 206 Buchanan Street.

Photo # 8 of 12

View: Towards southwest of 113 W. Wellington Street.

Photo # 9 of 12

View: Towards southwest of 101 E. Wellington Street, First Methodist Church.

Photo # 10 of 12

View: Towards southwest of 305 Riverview Drive.

Photo # 11 of 12

View: Towards northwest of 615 Obion Street.

Photo # 12 of 12