

STATE OF LOUISIANA DEPARTMENT OF CULTURE,
RECREATION AND TOURISM: Division of
Archaeology and Historic Preservation,
P. O. Box 44247. Baton Rouge, La. 70804

(Photo here)

I.
Parish East Carroll
Municipality Lake Providence
U.S.G.S. Quad Lake Providence, La-Mississippi
Township _____ Range _____ Section _____
Type of Property district
Name (common) Lake Providence Residential
Name (historic) Historic District
Address Lake Providence

Present Owner multiple ownership
Address _____

Date or period of construction 1840-1925

- II.
1. Good to excellent example of local type X
 2. Average example _____
 3. Poor example _____

III. Physical description of property and historical significance

The Lake Providence Residential Historic District comprises 14 large and pretentious residences, most of which are set along the south shore of Lake Providence. Though they are mainly significant as individual works of architecture, they are also the only continuous group of historic residences in East Carroll Parish. Unifying elements of the district include its predominant 1 1/2 story scale, its semi-rural character with large lots, its common shoreline, and its architectural quality. Each of the major contributing structures represents the "high water mark" of its particular period or style achieved in north-eastern Louisiana.

(See attached inventory)

IV.
Recorded by East Carroll Parish Historical
Date Society March 1980
For National Register Multiple Resource
Nomination

V.
Sources consulted _____
see bibliographical references
listed in Item 9 of National Register
form for Lake Providence Multiple
Resource Nomination

LAKE PROVIDENCE RESIDENTIAL HISTORIC DISTRICT INVENTORY

** 1. Delony House (See photos P,Q,and R)

Built ca 1840. Legend has it that the house was moved to its present location in the 1870's. It is a pit sawn frame, five bay, central hall plan house, with a pedimented portico and a rear kitchen wing. Noteworthy details include corner block fenestration, simple aedicule mantels, double panel doors, and slender posts. The house is significant as one of only two pedimented Greek Revival houses in the parish and one of only about six in the region.

* 2. Walsworth House (See photos P & R)

Built ca 1925. This is one of the two largest bungalow style residences in the parish. The porch has recently been sensitively enclosed with darkened glass.

** 3. Voelker House (See photos O & N)

Built ca 1905. This is probably the largest Queen Anne Revival residence in the area. The interior features considerable wainscotting and etched glass doors, though the plan is rather ordinary, having a central hall, double parlors, and 3 wings. Nonetheless, it is unusual for a Louisiana Queen Anne house to have as many as 3 semi-octagonal bays. Equally unusual is the completely circumscribed porch and the separately articulated pavilion port cochere under its own double transverse gable roof.

INTR 4. Kennedy House (See photo M) Ca 1940. 1 story cottage.

* 5. Holt House (See photos J & K)

Built ca 1880, this large 5 bay, one story, central hall plan house has full length sliphead windows, shoulder molded fenestration, two wooden aedicule motif mantels, and one carved slate mantel. It is significant as a fine representation of the last phase of the Greek Revival--a style which persisted in Louisiana much longer than one might expect.

* 6. Minsky House (See photos H, I & K)

Built ca 1925. One of the two largest bungalows in the parish, the Minsky House is in a good state of preservation. The only recent change has been the partial glazing in of a side porch.

** 7. Bass House (See photos F, G & H)

Built ca 1875. The Bass House is a two story, brick, central hall plan residence with painted slate mantels, elaborate ceiling moldings, a pair of two story protruding bays, an elaborate onion hanger cornice, arched windows, and a one bay scrollsaw ornamented porch. It is probably the only extant fully developed example of the Italian villa style in the region.

- INTR 8. Deal House--ca 1970 ranch house intrusion
- ** 9. King House (See photo E)
- Built ca 1905, this frame, 1 1/2 story, central hall plan residence has been partially burned on the upper half story and is currently under repair. Many of the Colonial Revival columns on the double curving porch have been lost, but the strapwork in the central gable is intact. The house's double turret design is almost unique in Louisiana.
- * 10. Grace Episcopal Church (See photo B)
- Built ca 1926. This two story basilica plan church is sparingly articulated with roundhead windows and a side tower. The style might be described as vaguely Romanesque.
- INTR 11. Leach House (See photo D) Ca 1970 ranch house instrusion
- ** 12. Hamley House (See photos B and C)
- Built ca 1840. This one story frame house has been considerably modified in the interior and several of the original 6 over 6 windows have been replaced. The handsome pedimented portico with its open work columns dates from the 1870's. It is significant as one of only two pedimented Greek Revival residences in the parish and one of about six in the region.
- * 13. Parra House (See photos A & C)
- Built ca 1905. This two story frame boxlike Queen Anne Revival residence is distinguished only by its Eastlake porch and strapwork gable. It is more or less typical of middle class residences found in eastern cities at the turn of the century, but untypical of rural northeastern Louisiana.
- * 14. Brandenburg House (See photos A & C)
- Built ca 1905. This two story frame boxlike Queen Anne Revival residence is distinguished only by its Eastlake porch and large scroll brackets. It is more or less typical of middle class residences found in eastern cities at the turn of the century, but untypical of rural northeastern Louisiana.

** Major contributing structure

* Minor contributing structure-important to the scene

INTR Intrusion

RESIDENTIAL DISTRICT

Approx. 13 Acres

(PHOTO DIRECTIONS GIVEN AS CIRCLED LETTERS)

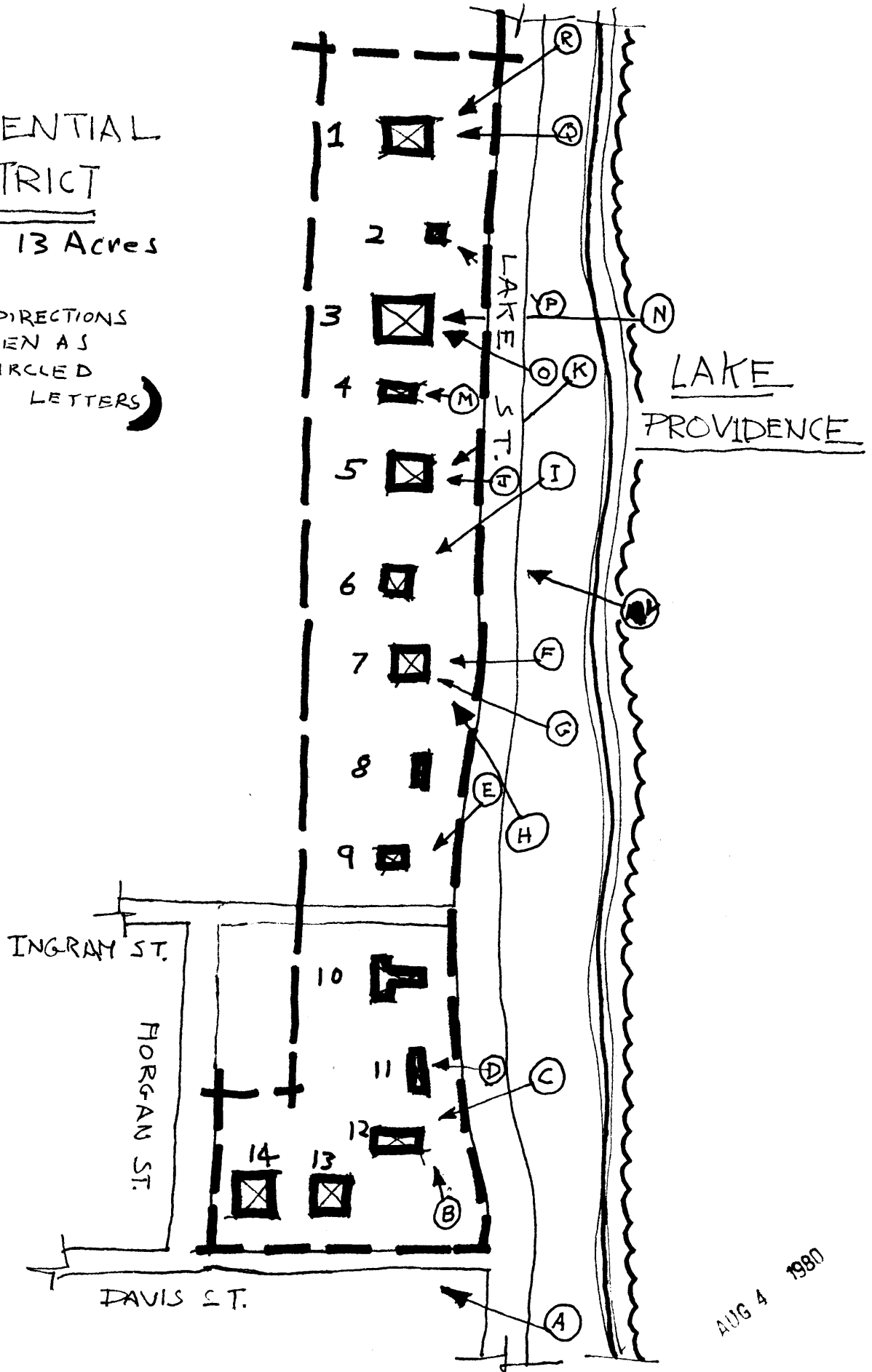

AUG 4 1980

Lake Providence, La. Residential District

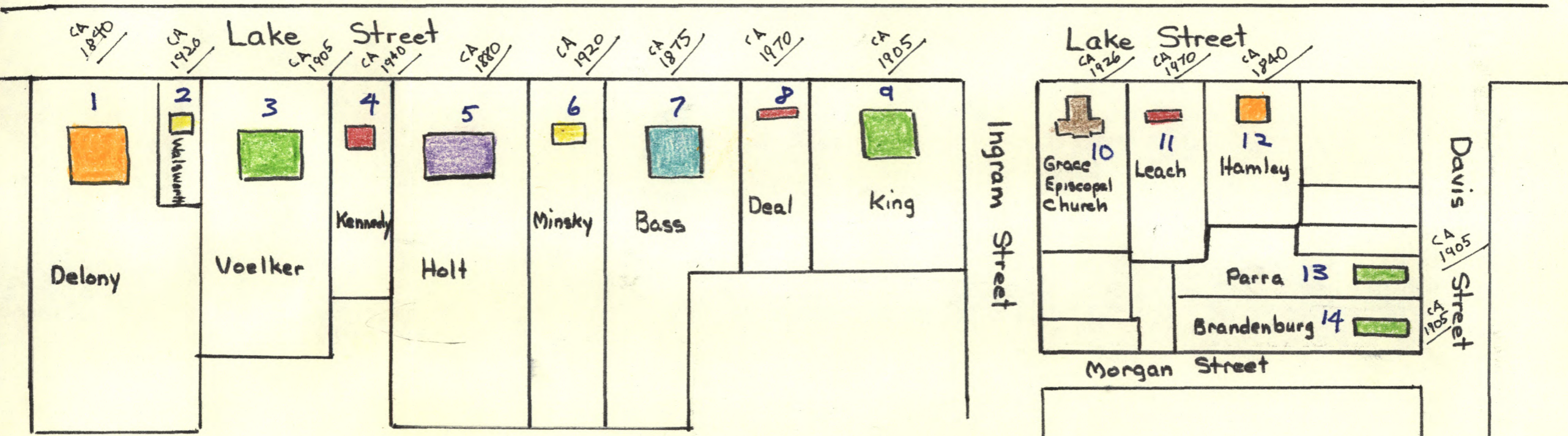

- 1840-
- 1875-
- 1880-
- 1900-1905-
- 1920-
- 1926-
- Intrusions -

OCL 3 1970

Wing 4 1900