

United States Department of the Interior  
National Park Service

National Register of Historic Places  
Continuation Sheet

Section number \_\_\_\_\_ Page \_\_\_\_\_

SUPPLEMENTARY LISTING RECORD

NRIS Reference Number: 92001787

Date Listed: 1/28/93

Brooder, Frank House  
Property Name

Carbon  
County

MT  
State

Historic & Architectural Resources of Fromberg  
Multiple Name

-----  
This property is listed in the National Register of Historic Places in accordance with the attached nomination documentation subject to the following exceptions, exclusions, or amendments, notwithstanding the National Park Service certification included in the nomination documentation.

Patrick Anderson  
Signature of the Keeper

1/28/93  
Date of Action

=====  
Amended Items in Nomination:

**Materials:** The foundation material was incorrectly listed as concrete. The nomination is amended to read: brick, in order to correspond with the narrative text.

**Significant Dates:** All dates listed under this data element must fall within the period of significance provided for the nomination (Bulletin 16A p.43). The date 1924 lies outside the period of significance (1909-1918) and is not reflective of the site's importance addressed under criteria A and C. The nomination is revised to delete 1924.

This information was confirmed by telephone with the MT SHPO.

-----  
**DISTRIBUTION:**

- National Register property file
- Nominating Authority (without nomination attachment)

1787

United States Department of the Interior  
National Park Service

DEC 11 1993

NATIONAL REGISTER OF HISTORIC PLACES  
REGISTRATION FORM

NATIONAL  
REGISTER

1. Name of Property

historic name: Brooder, Frank, House

other name/site number:

2. Location

street & number: 303 North Street

not for publication: n/a  
vicinity: n/a

city/town: Fromberg

state: Montana code: MT county: Carbon code: 009 zip code: 59029

3. State/Federal Agency Certification

As the designated authority under the National Historic Preservation Act of 1986, as amended, I hereby certify that this X nomination    request for determination of eligibility meets the documentation standards for registering properties in the National Register of Historic Places and meets the procedural and professional requirements set forth in 36 CFR Part 60. In my opinion, the property X meets    does not meet the National Register Criteria. I recommend that this property be considered significant    nationally    statewide X locally. (   See continuation sheet for additional comments.)

Maurell Shufy SHPO 12-11-93  
Signature of certifying official/Title Date

Montana State Historic Preservation Office  
State or Federal agency or bureau

In my opinion, the property    meets    does not meet the National Register criteria.

\_\_\_\_\_  
Signature of commenting or other official Date

\_\_\_\_\_  
State or Federal agency and bureau

4. National Park Service Certification

I, hereby certify that this property is:

entered in the National Register  
   see continuation sheet

   determined eligible for the  
National Register

   see continuation sheet  
   determined not eligible for the  
National Register

   see continuation sheet  
   removed from the National Register

   see continuation sheet  
   other (explain): \_\_\_\_\_

Signature of the Keeper

Patrick Anderson

Date of Action

1/20/93

---

**5. Classification**

---

<b>Ownership of Property:</b> Private	<b>Number of Resources within Property</b>	
	Contributing	Noncontributing
<b>Category of Property:</b> Buildings	<u>1</u>	<u>1</u> building(s)
<b>Number of contributing resources previously listed in the National Register:</b> 0	___	___ sites
	___	___ structures
	___	___ objects
<b>Name of related multiple property listing:</b> Historic and Architectural Properties in Fromberg	<u>1</u>	<u>1</u> Total

---

**6. Function or Use**

---

<b>Historic Functions:</b>	<b>Current Functions:</b>
Domestic: single dwelling Health care: hospital	Domestic: single dwelling

---

**7. Description**

---

<b>Architectural Classification:</b>	<b>Materials:</b>
Colonial Revival	foundation: stone walls: brick roof: asphalt

---

**Narrative Description**

The Frank Brooder House is located in Fromberg, Montana, a small rural community in the southcentral portion of the state. The property is located along the north edge of town on a rise overlooking the Clarks Fork Valley to the east. At the property is the historic house and a garage. The house faces east toward the valley and is surrounded by a large lawn, overgrown with mature trees and bushes.

The 2½ story Colonial Revival house is square in plan, has a hipped roof, and a full-width front porch. The exterior walls of the house are constructed of brick, laid in English bond. The house rests on a brick foundation. The asphalt-covered, hipped roof rises to a central ridge; corbeled brick chimneys are located at either end of the ridge. The house has a wide entablature that is part of the boxed wall-roof junction, with little overhang. A gable resting on a three-sided pavilion is centered on the front facade of the house. The first floor of the pavilion has double entry doors at center and one-over-one, double-hung sash in the canted sides. Each of the three sides of the second floor of the pavilion has a double-hung window. A Palladian window is located in the broken cornice of the pavilion's gable. The side walls of the gable are paneled and the gable end is shingled. The full-width front porch crosses in front of the pavilion; it is enclosed with bands of fixed windows and plywood infill. Sandstone sills and segmental arches highlight window openings on the main level; upper level openings have sandstone sills. Windows are mostly one-over-one, double-hung wood-sash. A cottage window is located on either side of the pavilion on the first floor. A one-story bay projects from the center of the north wall. The bay is three-sided, features decorative brick quoins at the wall junctures, and has a hip roof. Window openings in all three sides of the bay are boarded. Adjoining the west wall of the house towards the south end is a flat-roofed porch covered with masonite siding; a door in the west wall of the house is positioned at the roof level of this porch.

United States Department of the Interior  
National Park Service

## NATIONAL REGISTER OF HISTORIC PLACES CONTINUATION SHEET

Section number 7

Frank Brooder House

Page 1

---

Both the front and rear porches were enclosed and otherwise altered in the 1950s. A historic photo taken soon after the house was constructed in 1909, shows both porches as open and having round column supports and a roof balcony trimmed by a balustrade. The 1909 photo also depicts a small gabled dormer on the south facing roof slope; the dormer no longer exists.

The house retains integrity despite alterations to the porches and removal of roof dormers. The overall form, massing, and scale of the house is intact as well as important stylistic details such as the central pavilion, the bay, and historic windows and trimming. The house remains in its historic setting, a residential neighborhood with no modern intrusions. Retaining all other aspects of integrity, the house easily conveys its important historical and architectural associations.

The rectangular, wood-frame garage has stucco wall finishing, a flat roof, and two garage doors on the south. It does not contribute to the house's significant historical and architectural associations.

---

## 8. Statement of Significance

---

Applicable National Register Criteria: A, C

Areas of Significance: Exploration/Settlement  
Architecture

Criteria Considerations (Exceptions): n/a

Period(s) of Significance: 1909-1918

Significant Person(s): n/a

Significant Dates: 1911; 1924

Cultural Affiliation: n/a

Architect/Builder: McLean, Archibald (architect)  
Parker, W. C. (builder)

### Narrative Statement of Significance

The Frank Brooder House is being nominated to the National Register of Historic Places under the "Historic and Architectural Resources of Fromberg" multiple property listing. The significance of the house is established locally under the historic context of "Residential Development in Fromberg, 1900-1929" and meets registration requirements developed for the associated property type, "Residential Buildings." The Frank Brooder House is eligible for listing in the National Register under Criterion A for its association with the growth and emergence of Fromberg; and under Criterion C as an outstanding example of the Colonial Revival style. The house has sustained few alterations since construction and retains integrity in all aspects.

The Frank Brooder House derives significance under Criterion A as a representation of Fromberg's rise as an important retail trade and shipping center for the surrounding agricultural region in the first two decades of the twentieth century. Fromberg's increasing prosperity and population growth stimulated construction of many new houses. They included several large, architecturally sophisticated houses, such as this one, that were constructed for Fromberg's emerging upper class of businessmen and professionals.

This house was constructed in 1909 for Frank Brooder, cashier at the Clark Fork Valley Bank in Fromberg. In 1911, Brooder left Fromberg, selling the house to Dr. David Williams. Although Williams announced plans to use the nine-bedroom dwelling as a hospital, he did not practice medicine in Fromberg for several years. Williams was employed as a doctor for a mining company in Gebo, Wyoming, in 1913 and served in the U.S. Army medical corps during World War I. In 1921, Williams returned to Fromberg and finally opened a hospital in the house although he apparently did not have any supporting staff. Williams only operated the hospital for a few years before leaving Fromberg in 1924. The house remained empty for many years thereafter.

The Frank Brooder House derives significance under Criterion C as an excellent example of the Colonial Revival style. The hipped roof, rectangular shaped house conforms to the "Classic Box," a Colonial Revival subtype popular from about the 1890s to the mid-1910s. Colonial Revival influences are most vividly expressed by the projecting pavilion and Palladian window, symmetrically balanced window arrangements, brick quoins at the bay, and entablature at the roof-wall juncture, and the predominance of double-hung windows.

---

## 9. Major Bibliographic References

---

Big Horn County Rustler (Basin). 17 October 1913.

Fromberg Herald. 20 July 1911; 9 July 1921; 22 May 1924.

Miller, Lester. Interview with Erica Kuhlman. 14 September 1988.

Weatherford, Melvin. Interview with Erica Kuhlman. 1 September 1988.

### Previous documentation on file (NPS):

- preliminary determination of individual listing (36 CFR 67) has been requested.
- previously listed in the National Register
- previously determined eligible by the National Register
- designated a National Historic Landmark
- recorded by Historic American Buildings Survey # \_\_\_\_\_
- recorded by Historic American Engineering Record # \_\_\_\_\_

### Primary Location of Additional Data:

- State Historic Preservation Office
- Other State agency
- Federal agency
- Local government
- University
- Other -- Specify Repository:

---

## 10. Geographical Data

---

**Acreage of Property:** less than one acre

**UTM References:**

	Zone	Easting	Northing
A	12	663580	5028630

### Verbal Boundary Description

The Frank Brooder House is located on an unplatted tract in the SE $\frac{1}{4}$  NW $\frac{1}{4}$  SW $\frac{1}{4}$  SE $\frac{1}{4}$  Section 17, T5S R23E. The beginning point for the boundary is located 810 feet north of the mid-point on the line between Sections 17 and 20, T5S R23E and 125 feet due east of the Bartlett Canal. The boundary then proceeds west 150 feet along the north edge of North Street. It then continues north 100 feet and then east 150 feet along a tree row, and then south 150 feet to the point of beginning.

### Boundary Justification

The boundary has been drawn to include the house, garage and landscaped yard surrounding these features.

---

## 11. Form Prepared By

---

**name/title:** Mary McCormick (Erika Kuhlman of the Fromberg Historical Society did the initial research and wrote the first draft in 1989.)

**organization:** Renewable Technologies, Inc.

**date:** April 1992

**street & number:** 511 Metals Bank Building

**telephone:** 406/444-7715

**city or town:** Butte

**state:** MT

**zip code:** 59701

---

### Property Owner

---

**name/title:** Tom and Shirley Knutson

**street & number:** 303 North Street

**city or town:** Fromberg

**state:** MT

**zip code:** 59029

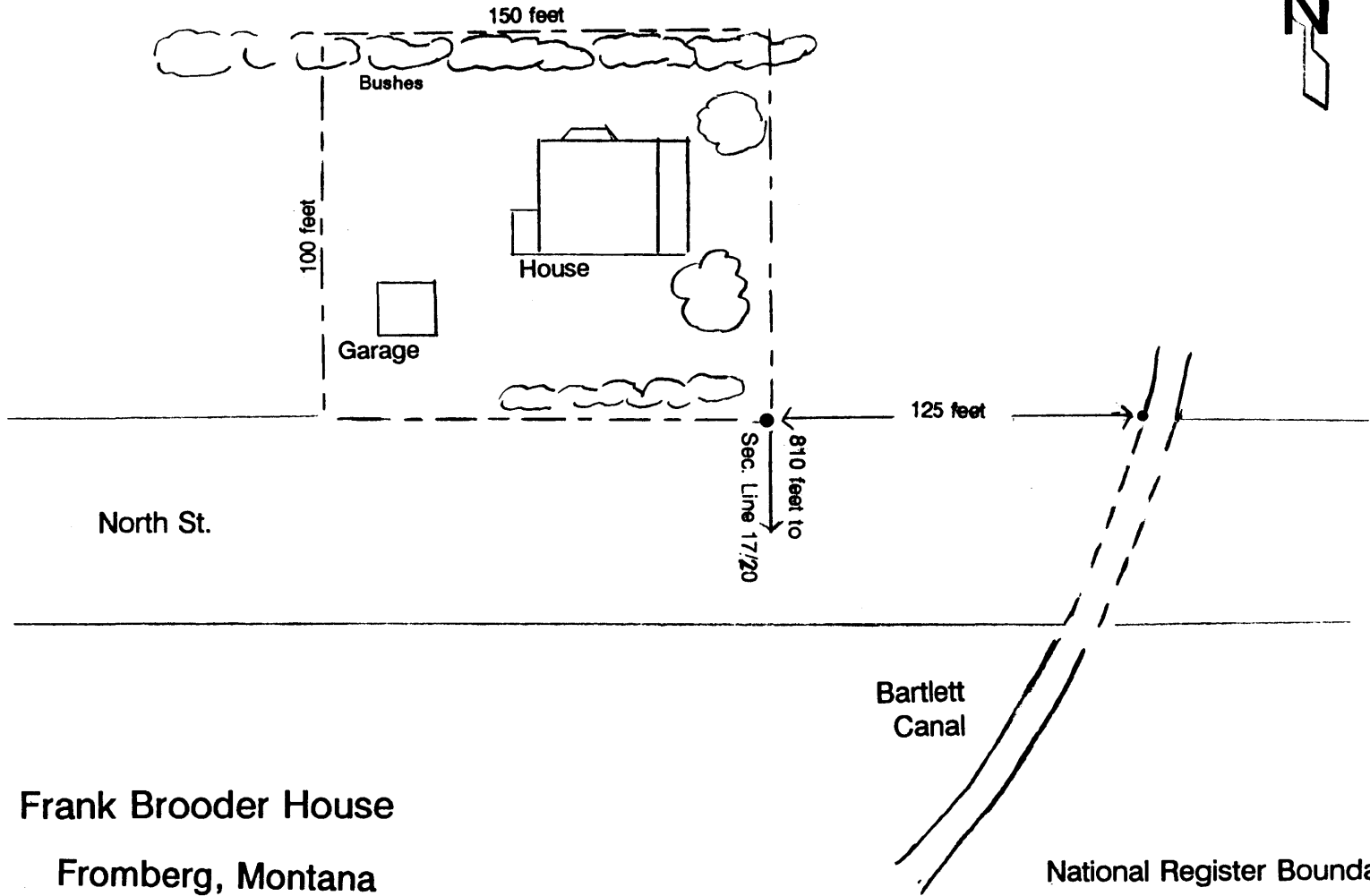

Frank Brooder House

Fromberg, Montana

SE1/4 NW1/4 SW1/4 SE1/4  
Section 17, T5S R23E

National Register Boundary:  
-----

Not to Scale  
August 1992