

United States Department of the Interior  
National Park Service

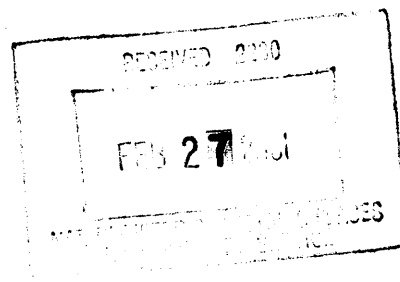

301

National Register Of Historic Places  
Registration Form

This form is for use in nominating or requesting determinations for individual properties and districts. See instructions in *How to Complete the National Register of Historic Places Registration Form* (National Register Bulletin 16A). Complete each item by marking "x" in the appropriate box or by entering the information requested. If any item does not apply to the property being documented, enter "N/A" for "not applicable." For functions, architectural classification, materials, and areas of significance, enter only categories and subcategories from the instructions. Place additional entries and narrative items on continuation sheets (NPS Form 10-900a). Use a typewriter, word processor, or computer, to complete all items.

1. Name of Property

historic name Woman's Club of Lincoln

other names/site number \_\_\_\_\_

2. Location

street & number 499 E Street NA  not for publication

city or town Lincoln NA  vicinity

state California code CA county Placer code 61 zip code 95648

3. State/Federal Agency Certification

As the designated authority under the National Historic Preservation Act of 1966, as amended, I hereby certify that this  nomination  request for determination of eligibility meets the documentation standards for registering properties in the National Register of Historic Places and meets the procedural and professional requirements set forth in 36 CFR Part 60. In my opinion, the property  meets  does not meet the National Register Criteria. I recommend that this property be considered significant  nationally  statewide  locally. (  See continuation sheet for additional comments.)

K. Miller 2/21/01  
Signature of certifying official/Title Date

California Office of Historic Preservation  
State or Federal agency and bureau

in my opinion, the property  meets  does not meet the National Register criteria. (  See continuation sheet for additional comments.)

\_\_\_\_\_  
Signature of commenting or other official Date

\_\_\_\_\_  
State or Federal agency and bureau

4. National Park Service Certification

I hereby certify that this property is:

- entered in the National Register
  - See continuation sheet.
- determined eligible for the National Register
  - See continuation sheet.
- determined not eligible for the National Register
- removed from the National Register
- other (explain): \_\_\_\_\_

Edson H. Beall 5/30/01  
Signature of the Keeper Date of Action

**5. Classification**

**Ownership of Property**

(Check as many boxes as apply)

- private
- public-local
- public-State
- public-Federal

**Category of Property**

(Check only one box)

- building(s)
- district
- site
- structure
- object

**Number of Resources within Property**

(Do not include previously listed resources in the count.)

Contributing	Noncontributing	
1		buildings
		sites
		structures
		objects
1	0	Total

**Name of related multiple property listing**

(Enter "N/A" if property is not part of a multiple property listing.)

N/A \_\_\_\_\_

**Number of contributing resources previously listed in the National Register**

0 \_\_\_\_\_

**6. Function or Use**

**Historic Functions**

(Enter categories from instructions)

**SOCIAL: Meeting hall** \_\_\_\_\_

**Clubhouse** \_\_\_\_\_

**Civic** \_\_\_\_\_

\_\_\_\_\_

\_\_\_\_\_

\_\_\_\_\_

\_\_\_\_\_

**Current Functions**

(Enter categories from instructions)

**SOCIAL: Meeting hall** \_\_\_\_\_

**Clubhouse** \_\_\_\_\_

**Civic** \_\_\_\_\_

\_\_\_\_\_

\_\_\_\_\_

\_\_\_\_\_

\_\_\_\_\_

**7. Description**

**Architectural Classification**

(Enter categories from instructions)

**Spanish Colonial Revival** \_\_\_\_\_

\_\_\_\_\_

\_\_\_\_\_

**Materials**

(Enter categories from instructions)

foundation **concrete** \_\_\_\_\_

roof **tile** \_\_\_\_\_

walls **stucco** \_\_\_\_\_

\_\_\_\_\_

other \_\_\_\_\_

\_\_\_\_\_

**Narrative Description**

(Describe the historic and current condition of the property on one or more continuation sheets.)

**8. Statement of Significance**

**Applicable National Register Criteria**

(Mark "x" in one or more boxes for the criteria qualifying the property for National Register listing)

- A Property is associated with events that have made a significant contribution to the broad patterns of our history.
- B Property is associated with the lives of persons significant in our past.
- C Property embodies the distinctive characteristics of a type, period, or method of construction or represents the work of a master, or possesses high artistic values, or represents a significant and distinguishable entity whose components lack individual distinction.
- D Property has yielded, or is likely to yield information important in prehistory or history.

**Criteria Considerations**

(Mark "X" in all the boxes that apply.)

Property is:

- A owned by a religious institution or used for religious purposes.
- B removed from its original location.
- C a birthplace or a grave.
- D a cemetery.
- E a reconstructed building, object, or structure.
- F a commemorative property.
- G less than 50 years of age or achieved significance within the past 50 years.

**Narrative Statement of Significance**

(Explain the significance of the property on one or more continuation sheets.)

**9. Major Bibliographical References**

(Cite the books, articles, and other sources used in preparing this form on one or more continuation sheets.)

**Previous documentation on file (NPS):**

- preliminary determination of individual listing (36 CFR 67) has been requested.
- previously listed in the National Register
- previously determined eligible by the National Register
- designated a National Historic Landmark
- recorded by Historic American Buildings Survey # \_\_\_\_\_
- recorded by Historic American Engineering Record # \_\_\_\_\_

**Areas of Significance**

(Enter categories from instructions)

**Social History**

---



---



---



---



---



---

**Period of Significance**

**1924-1950**

---



---



---

**Significant Dates**

**NA**

---



---



---

**Significant Person**

(Complete if Criterion B is marked above)

**NA**

---



---



---

**Cultural Affiliation**

**NA**

---



---



---

**Architect/Builder**

**Architect: Dean and Dean**

**Builder: Whitsell, William V.**

---



---

**Primary Location of Additional Data**

- State Historic Preservation Office
- Other State agency
- Federal agency
- Local government
- University
- Other

Name of repository:

---

**Woman's Club of Lincoln**

Name of Property

**Placer County, California**

County and State

**10. Geographical Data**

**Acreage of Property less than one acre**

**UTM References**

(Place additional UTM references on a continuation sheet)

	Zone	Easting	Northing		Zone	Easting	Northing
1	10	648420	4305920	3	_____	_____	_____
2	_____	_____	_____	4	_____	_____	_____

See continuation sheet.

**Verbal Boundary Description**

(Describe the boundaries of the property on a continuation sheet.)

**Boundary Justification**

(Explain why the boundaries were selected on a continuation sheet.)

**11. Form Prepared By**

name/title **Dorothy Nowak, President/Evelyn Procissi, Historian and Committee Chairman**

organization **Woman's Club of Lincoln** date **9/10/2000**

street & number **499 E Street** telephone **916-645-2616**

city or town **Lincoln** state **CA** zip code **95648**

**Additional Documentation**

Submit the following items with the completed form:

**Continuation Sheets**

**Maps**

A **USGS map** (7.5 or 15 minute series) indicating the property's location.

A **Sketch map** for historic districts and properties having large acreage or numerous resources.

**Photographs**

Representative **black and white photographs** of the property.

**Additional items**

(Check with the SHPO or FPO for any additional items)

**Property Owner**

(Complete this item at the request of the SHPO or FPO.)

name **Woman's Club of Lincoln**

street & number **499 E Street** telephone **916-645-2616**

city or town **Lincoln** state **CA** zip code **95648**

**Paperwork Reduction Act Statement:** This information is being collected for applications to the National Register of Historic Places to nominate properties for listing or determine eligibility for listing, to list properties, and to amend existing listings. Response to this request is required to obtain a benefit in accordance with the National Historic Preservation Act, as amended (16 U.S.C. 470 *et seq.*).

**Estimated Burden Statement:** Public reporting burden for this form is estimated to average 18.1 hours per response including the time for reviewing instructions, gathering and maintaining data, and completing and reviewing the form. Direct comments regarding this burden estimate or any aspect of this form to the Chief, Administrative Services Division, National Park Service, P.O. Box 37127, Washington, DC 20013-7127; and the Office of Management and Budget, Paperwork Reductions Project (1024-0018), Washington, DC 20503.

United States Department of the Interior  
National Park Service

National Register of Historic Places  
Continuation Sheet

Section number 7 Page 1

Woman's Club of Lincoln  
Lincoln, CA

**Description:**

The Spanish Colonial Clubhouse in Lincoln, California is built on a corner lot 75 feet on the west (E street) by 78 feet on the north (5<sup>th</sup> Street) in the downtown area of 5<sup>th</sup> and E streets. It is surrounded by residential homes and the old City Hall building is across E street to the west. The Clubhouse is single-story (62' by 55') wood-frame with a stucco finish and a red clay tile roof covering the main hall. There is a semi-circular front entrance roof, with a semi-flat roof covering the east side of the building. Mature trees and shrubs provide attractive landscaping.

**Exterior:**

The front entrance opens at the corner of 5<sup>th</sup> and E streets from a brick patio (34' 8" by 28' 7"). Two French doors open on the south from the patio into the main hall. A stucco wall (3' high and 1' wide) encloses the patio from the street. There are three steps, with wrought iron hand railings, that lead from the patio down to the sidewalk. A large wooden door opens into the foyer, from the front or main entrance. A border of shrubs fills the area between the brick patio and the building. The west side entrance leads into the porch and kitchen areas, on the south side of the main hall. Two sets of windows flank the side door. A small storage area (10'8" by 9'5") opens from the porch on the east side of the building.

The building plot is spacious as there is also a large lawn south of the clubhouse which is sometimes used for outdoor events. This extra lot measuring 75' by 78' was a gift to the club in December, 1924, by Carrie Gladding. Thus combined, the clubhouse area covers 150' by 78'.

**Interior:**

The interior floor plan has not changed. It is the same as originally built in 1923. The dimensions of the various interior rooms are as follows:

1. Foyer and Hall (21'9" x 9'2")  
small closet on right of door
2. Powder and Cloak Room (10' x 7'7")  
one window to the west and a closet (10' x 1') on right side
3. Ladies Restroom (6'5 1/2" x 9'4") extended from Powder Room  
one window to the north
4. Directors Room (16'2" x 14'4")  
one window to the north, two to the east. New vertical blinds cover these windows.  
large fireplace with built-in bookshelves to the left.

United States Department of the Interior  
National Park Service

National Register of Historic Places  
Continuation Sheet

Section number 7 Page 2

Woman's Club of Lincoln  
Lincoln, CA

Interior

4. Continued  
new wall to wall carpet and Maxfield Parrish paintings on the walls
5. Men's Rest Room (6'11" x 3'4") one window to the east
6. Storage Area (10'2" x 6'1") at end of hall  
one window to the east
7. The Main Hall (62'10" x 24'4") can be divided into 2 rooms by folding French glass doors
8. Kitchen (18'10 1/2" x 15')
9. Back Porch area (utility room) 18' 10 1/2" x 15') door opens on west side
10. Patio (Back) Storage Area (10'8"x 9'5") door opens from porch area on east side
11. Basement—When entering the porch from the kitchen, there is a door on the right side that leads 10 steps downstairs to the basement area (8'4" x 9'4") A 4 foot extension on the west side creates a hallway (4' x 2'). The floors and walls are made of concrete and are well constructed. There is a sump pump for use in case of heavy rains. The area is used for seasonal storage.

For the most part, except for repairs, replacements and minor changes, the Clubhouse remains almost as it was in 1923-24, when it was built.

Interior:

As one walks into the foyer, there are two arched door-ways into the main hall. The ceiling in the larger area of the main hall has beautiful, natural wood beams that meet in the middle forming a peaked center. The floors are of hard-wood maple. Draw drapes cover the three recessed windows on the south side, the two French doors which open onto the patio on the north side, and the four large windows at the east end of the room. A beautiful, very large, picture window on the west end of the room is enhanced by the same draw drapes. This window is flanked by a pair of decorative built-in shelves.

A Baldwin grand piano, purchased in 1935 for \$1100, has a special spot in the south-west corner of the room. On the left wall, as you enter, hangs an antique wall clock.

A practical and pretty linen and crystal cupboard with drawers in the middle and glass doors on each side, is on the south wall before one enters the kitchen. Two swinging doors open into the kitchen itself.

The kitchen has very sturdy, wooden cupboards, both upper and lower, on the east side with a window between the upper cupboards. There is a larger window over the double porcelain sinks on the south wall with one set of upper cupboards to the left of the sinks and lower cupboards on each side.

United States Department of the Interior  
National Park ServiceNational Register of Historic Places  
Continuation SheetSection number 7 Page 3Woman's Club of Lincoln  
Lincoln, CA**Interior**, (continued)

All of the counters now have Formica tops. There is a large worktable with upper shelves in the center of the room. It is used for storage. A large commercial range, purchased about twenty years ago, dominates the west wall. A door at the west end opens into the porch area. Here we have a wall of cupboards on the north side, two refrigerators on the south wall and a large storage cabinet in the south-west corner. Wash trays are in the north-west corner. A door in the middle of the west wall leads outside to E street. Another door on the east leads to the back patio and storage area. The third and smallest door to the right of the kitchen door (when entering from the kitchen) opens to the basement which is also used for some storage.

**Updates, Repairs, Renovations and Acquisitions**

- Circa 1924-25 Settee and chair donated by the Farm Bureau  
Rug and Fireplace donated by the W.C.T.U.  
Mission type furniture donated by the Diamond Match Company  
First electric stove donated by P.G.& E.
- 1925 Back porch area enlarged
- 1940 Changed from wood furnace to gas furnace
- 1942 Beautiful gold trimmed, glass punch bowl set donated by Judge Hayt and wife, Gertrude (a member)
- 1944-45 Interior redecorated and repairs made
- 1949-51 Roof repairs
- 1953 New roof
- 1954 New sewer lines
- 1956 Interior painted and new drapes purchased
- 1957 New air conditioner, new light fixtures and a rug purchased for the Directors room
- 1958 Painted exterior
- 1960 Purchased 100 folding chairs, new sinks and drainboards
- 1963 Roof repairs
- 1964 Interior redecorated
- 1969 Kitchen wiring updated
- 1970 Painted Exterior

**United States Department of the Interior  
National Park Service**

**National Register of Historic Places  
Continuation Sheet**

Section number 7 Page 4

---

Woman's Club of Lincoln  
Lincoln, CA

**Updates** (continued)

- 1971 Windows replaced on south side, cost \$500.
- 1977 Painted all interiors and exterior trim
- 1980 New drapes installed
- 1981 New roof
- 1986 Automatic yard sprinkler system installed, gift of Edward and Francis Grey,  
in memory of their mother, Mildred C. Grey
- 1993 New roof over Directors room
- 1997 Central heat and air unit installed, gift of member Donna Freeman and  
husband Homer, electricity updated
- 1998 New Formica kitchen counter tops
- 1999 Roof repaired, interior painted, exterior trim painted
- 2000 All outside windows glazed and frames refinished and repaired
- 2000 Folding chairs repainted, new silverware purchased



**United States Department of the Interior  
National Park Service**

**National Register of Historic Places  
Continuation Sheet**

Section number 8 Page 1

---

Woman's Club of Lincoln  
Lincoln, CA

"Service is the keynote of success."  
Woman's Club Motto

**Statement of Significance**

The Woman's Club of Lincoln is located in the small city of Lincoln, CA. This Woman's Club is significant under Criterion A in the area of social history, for its long association with community and civic life, dating from 1923 to the arbitrary cut-off date of 1950.

The Club, which began as a Woman's Improvement Club, was organized in 1911 for the purpose of serving the community and enriching the lives of its member. This women's group eventually became the Woman's Club of Lincoln, a club historically significant for its involvement in the welfare of the citizens of the community and its interest in the betterment and beautification of the City of Lincoln. By-laws were adopted in September 1922 and revised in 1942, 1953 and 1987.

In time, the need for a building of their own was realized. In 1923, the construction of the clubhouse began and in 1924 their clubhouse was a reality. This building became a community-gathering place and continues to serve as a well-preserved focal point for both the social and civic life of Lincoln.

**1911-1923**

"From a humble beginning in 1911..." these are words taken from a recorded history of the Woman's Club of Lincoln. The humble refers to the Civic Improvement Club, which favored the Woman's Suffrage Movement, and the many ways the women assisted in this endeavor. It was August of 1920 before women nation-wide won the right to vote.

In March of 1912, this local women's group joined the State Federation of Women's Clubs and initiated their motto, with the red rose as their flower symbol.

Sanitation, water wells, and garbage were all important priorities at this time. The custom of Christmas boxes for the needy, which is still in effect, began in 1916. The club was also one of the organizations that had a section in the local cemetery, which was established in April of 1867. Carrie Gladding generously purchased and graded the land for the Club's area. Schools were an important part of their program. The women were able to purchase playground equipment for the grammar school and even provided a phonograph. They were also instrumental in securing a site for a future grammar school.

United States Department of the Interior  
National Park Service

## National Register of Historic Places Continuation Sheet

Section number 8 Page 2

---

Woman's Club of Lincoln  
Lincoln, CA

The war years, 1917-1918, were trying times for the women of the Club, as all worked hard for the Red Cross and had little time for other club activities. After the war the Club planted 130 memorial trees along the highway south of Lincoln, commemorating each town boy who was in the service of his country.

The Club was now meeting in the basement of the Library, in place of the homes that were formerly used. The need of a clubhouse was very much in evidence. This project was pursued under the leadership of Carrie Gladding, wife of Albert Gladding. Albert came to Lincoln in 1875 to help his father, Charles Gladding, one of the co-owners and co-founders of the Gladding, McBean Pottery Plant. He managed the plant until 1929. This company is the only remaining large-scale producer of Decorative Architectural Terra Cotta products in the United States. Albert Gladding was a leading force in organizing the High School in Lincoln. He served as a trustee (circa 1907-1910). He also was a prime mover in the incorporation of Lincoln in 1890.

Carrie Chandler Gladding was the daughter of ex-State Senator Augustus L. Chandler. She and Albert were wed in 1883 and had a family of ten children. Mrs. Gladding was considered the "God Mother" of the club for her unusual generosity. She served as president from 1919 to 1921. About a year later, August 4, 1922, the club was incorporated as "The Woman's Club of Lincoln." It must be mentioned that Carrie Gladding's mother was a member of the Woman's Christian Temperance Union (W.C.T.U.), an organization that advocated abstinence from all alcoholic beverages and abolition of liquor sales. In making her donations to the club, Mrs. Gladding stipulated that no alcohol should be allowed on the premises. That edict exists to this day. Our 77-year-old clubhouse is alcohol free. Mrs. Gladding's monetary donations were made in honor of her mother and also her father, who was a Farm Bureau member.

### 1923-1950

Although the prior years and the social and civic endeavors were notable, the period between 1923 and 1950 was probably the most significant for the Woman's Club.

The building project became a reality when Walter Jansen, a city councilman for many years, and his wife, Emma, donated portions of the original lots #15 and #16 in the heart of the city. Mrs. Gladding and other club members, as well as residents of the city donated funds. This

**United States Department of the Interior  
National Park Service**

**National Register of Historic Places  
Continuation Sheet**

Section number 8 Page 3

---

Woman's Club of Lincoln  
Lincoln, CA

money was supplemented with funds raised by the club from various moneymaking activities. On September 17, 1923, the contractor, William V. Whitsell, and the club signed an agreement. The cost would be \$11,860.00 with work to be completed 80 days after the start of work as designated by the Architect, Dean and Dean of Sacramento. This firm also did the design for the new Catholic Church in 1926. A bank loan was granted for the sum of \$3,500.00 on December 13, 1923, payable in four years at 6% interest. Construction began in late 1923 and was completed in January of 1924. April 8, 1924 was the date of the first meeting of the Woman's Club of Lincoln in their "dream" building. It was a fitting tribute to the many hours of work by this ambitious group of women.

It was after that time that the Woman's Club became even more involved with the community, its organizations, events and needs. Various types of activities occurred at the clubhouse, some of which are listed here:

- Sewed for the Red Cross
- Made lap robes, afghans, and care packages for hospital patients and Veterans
- Held annual flower shows for several years
- Formed various sections, such as card, music, book and garden
- Joined the Federated Garden Section 1932-1939
- Hosted speakers on civic concerns, schools and education, health, investments, religion, music and the arts
- Had school and musical programs
- Set up art displays
- Hosted and supported community events
- Sponsored a Camp Fire Group
- For many years, the Sierra College Chorus provided Christmas programs for members and guests
- Supported the Boy Scouts, Placer County Retarded Children's Association, the Auburn Hospice, and the Lincoln Arts
- Purchased books for the High School and Lincoln Libraries in memory of deceased members
- Served Rotary lunches almost continuously from 1925 to the present day
- Donated to the Community Christmas Basket program
- Made donations to the Music Scholarship Fund, School Band, Library, Swimming Pool, Chamber of Commerce, Feats of Clay, and health funds
- On June 3, 1932 an outstanding event occurred. It was then at a garden party that the mortgage was burnt.

United States Department of the Interior  
National Park Service

# National Register of Historic Places Continuation Sheet

Section number 8 Page 4

---

Woman's Club of Lincoln  
Lincoln, CA

In reality, the Woman's Clubhouse has been an asset to the Lincoln community from its very early years. At one time, there were few comparable places for meetings, dances, and socials. Thus the clubhouse has served a number of groups and fraternal and service organizations. Some that have used or are using the facility are listed as follows:

- Adecco Personnel Office
- City of Lincoln
- Business and Professional Women's Club
- Church of the Nazarene
- Solid Rock Tabernacle
- Well Baby Clinic
- Friendship Chapter #67 Order of Easter Star
- Gold Hill Lodge #32 Free and Accepted Masons
- Netah Council Degree of Pocahantas
- Pocahantas Deputies Association
- Placer Parlor #138 Native Daughters of the Golden West
- Silver Star Parlor #63 Native Sons of the Golden West
- Mother and Daughter Banquets and Teas
- Jazz-er-cize Studio
- Greentree Dance Studio
- Newman Trucking
- Lincoln Dance Club
- Horizon Schools
- P. G. & E. Company
- Y. M. C. A.
- Rotary Club from 1925 to the present
- Junior Woman's Club
- Interim Personnel Inc.
- Private parties for weddings, showers, memorials, birthdays, anniversaries, and numerous other social events

During the years (1915-1975) the club belonged to the Federation of Women's Clubs, several awards were granted. Following is a list of some of the certificates that were earned: Fine Arts, Music, Crafts, Literature, Cultural Heritage, Citizenship, Achievements, Religion, Community Improvement, Civil Defense, Public Affairs, Veterans, Health and Welfare, Youth Conservation, Gerontology, Publicity, and Gardens.

Several members held important city offices:

**United States Department of the Interior  
National Park Service**

**National Register of Historic Places  
Continuation Sheet**

Section number 8 Page 5

---

Woman's Club of Lincoln  
Lincoln, CA

- \* Past President, Mildred Crook Grey - City Clerk 1982-1994
- \* Past President, Mabel Ahart - City Clerk 1943-1950  
Mary Webber Fitzhugh - City Clerk 1956-1962  
Past President, Dorothy Grout - City Clerk and City Worker - circa 1950-1955
- \* Past President, Roberta Ragsdale Babcock - City Council member and two term  
City Mayor -1982-1994. Fourth generation member of Pioneer Family  
Roberta's mother, Edna Ragsdale, was a club member from 1954 until her  
death in 1980. She also was one of the few women in the nation to vote in  
every election since the time women were allowed to vote in 1920. She  
was recognized as the second woman in the United States to receive a  
radio operator's license.  
Celeste Stockley - City Council member from 1952-1956. It is believed that  
Celeste was Lincoln's first woman mayor.
- \* Bertha Landis - Lincoln Librarian from 1909-1934
- \* Members of Placer County Pioneer Families

**United States Department of the Interior  
National Park Service**

**National Register of Historic Places  
Continuation Sheet**

Section number 8 Page 6

---

Woman's Club of Lincoln  
Lincoln, CA

**Summary**

Over the years the club members have held a variety of moneymaking affairs for the maintenance of the clubhouse. Luncheons, dinners, fashion shows, raffles, and sales were some of the successful events that were sponsored. Currently, the opening luncheon in October, the Salad Bar Buffet and Raffle in the spring and the Rotary meals are the primary sources of income other than donations and rentals.

From its early beginning, through it's historical past and now to the present, the Woman's Club of Lincoln has been an important part of the city's life. Lincoln has had both lean years and prosperous years. It has recently seen unusual growth with new advantages and also new problems. The club has endured similar patterns of change. However, our motto still prevails. Although needs and problems have differed over the years, the women of the club are still here to offer support to the community and our historical clubhouse will always be available, an asset to the city and its citizens.

We, the present members are constantly amazed at the foresight that was shown when plans and designs for the clubhouse were chosen so many years ago. The building seems to be timeless, in that it meets our needs as well today, as it must have met the needs of those women in the past. We can only hope future generations of club members will maintain and preserve it just as we are striving to do today.

United States Department of the Interior  
National Park Service

## National Register of Historic Places Continuation Sheet

Section number   9   Page   1  

---

Woman's Club of Lincoln  
Lincoln, CA

### Major Bibliographical References:

Woman's Club Archives  
Logan, Jerry – Lincoln Historian  
Logan, Jerry – Western Placer County and Lincoln, Volume I – 1990  
Logan, Jerry – Western Placer County and Lincoln, Volume II -- 1993

United States Department of the Interior  
National Park Service

**National Register of Historic Places  
Continuation Sheet**

Section number 10 Page 1

---

Woman's Club of Lincoln  
Lincoln, CA

**Verbal Boundary Description**

Parcel 78' x 150' Rectangular Lot  
78' on 5<sup>th</sup> street  
75' on E street  
Lot in back 78' x 75'

The North twenty-five (25) feet of the West seventy-eight (78) feet of lot fifteen (15) and the West seventy-eight (78) feet of lot sixteen (16), all in block twenty-nine (29), as laid down on file in the office of the Recorder of Placer County, California.

The West seventy-eight feet of lot fourteen (14) and the south twenty-five (25) feet of the West seventy-eight (78) feet of lot fifteen (15) of block twenty-nine(29) according to the plat of said Town of Lincoln on file in the office of the recorder of Placer County, California.

**Boundary Justification:**

These are the historic boundaries that have always been associated with the property.



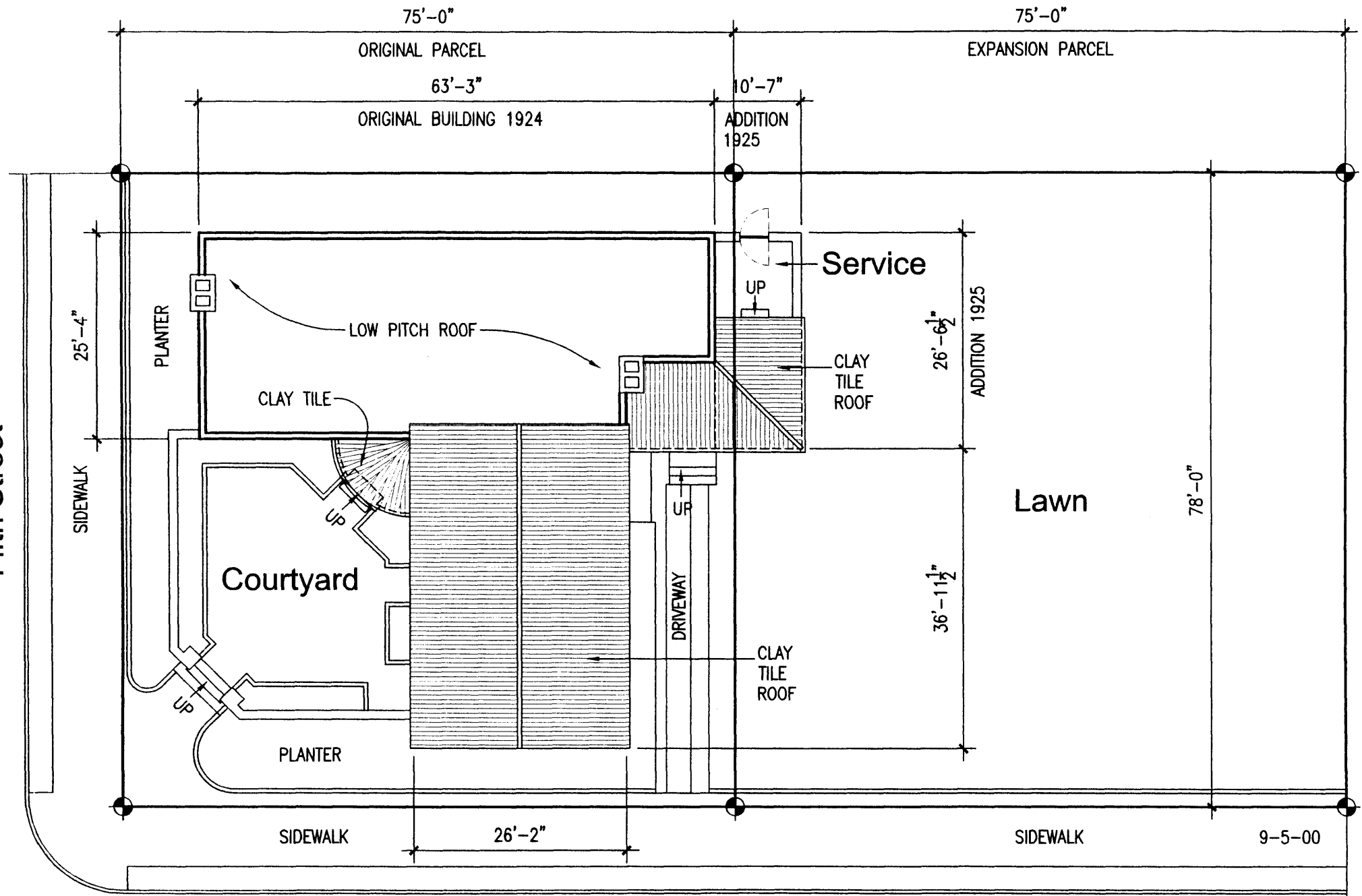

# Site Plan 1/16"

"E" Street

Women's Clubhouse Lincoln, CA  
Placer County

C:\SDSK\PROJ\9729LNCL\729WOMENC.DWG

## **PHOTOGRAPHIC LOG OF WOMAN'S CLUB OF LINCOLN**

- **Photo No. ①**  
Name of Photographer: **Mary B. Kennedy\ Jacqueline Johnson**  
Date of Photo: **August 01, 2000**  
Location of Original Negative: **Woman's Club**  
Description of View and Orientation: **Photograph shows the front elevation of the Woman's club viewed from the intersection of 5<sup>th</sup> Street and E Street and depicts the north side of the building.**
- **Photo No. ②**  
Name of Photographer: **Mary B. Kennedy\ Jacqueline Johnson**  
Date of Photo: **August 01, 2000**  
Location of Original Negative: **Woman's Club**  
Description of View and Orientation: **Photograph depicts the steps and court yard leading to the front entrance of the Woman's Club viewed from the corner of 5<sup>th</sup> and E Streets looking toward the southeast.**
- **Photo No. 3**  
Name of Photographer: **Mary B. Kennedy\ Jacqueline Johnson**  
Date of Photo: **August 01, 2000**  
Location of Original Negative: **Woman's Club**  
Description of View and Orientation: **Photograph depicts the front entrance of the building viewed across the court yard looking to the southeast.**
- **Photo No. 4**  
Name of Photographer: **Mary B. Kennedy\ Jacqueline Johnson**  
Date of Photo: **August 01, 2000**  
Location of Original Negative: **Woman's Club**  
Description of View and Orientation: **Photograph depicts the court yard and the two french doors leading to the main hall of the building looking to the south.**
- **Photo No. ⑤**  
Name of Photographer: **Mary B. Kennedy\ Jacqueline Johnson**  
Date of Photo: **August 01, 2000**  
Location of Original Negative: **Woman's Club**  
Description of View and Orientation: **Photograph depicts the west side and a portion of the rear of the building viewed from E Street looking northeast.**
- **Photo No. ⑥**  
Name of Photographer: **Mary B. Kennedy\ Jacqueline Johnson**  
Date of Photo: **August 01, 2000**  
Location of Original Negative: **Woman's Club**  
Description of View and Orientation: **Photograph depicts the east elevation of the building viewed from across 5<sup>th</sup> Street looking to the southwest.**
- **Photo No. ⑦**  
Name of Photographer: **Mary B. Kennedy\ Jacqueline Johnson**  
Date of Photo: **August 01, 2000**  
Location of Original Negative: **Woman's Club**  
Description of View and Orientation: **Photograph depicts the rear entrance of the building viewed from E Street looking east.**

- **Photo No. 8**  
 Name of Photographer: **Mary B. Kennedy\ Jacqueline Johnson**  
 Date of Photo: **August 01, 2000**  
 Location of Original Negative: **Woman's Club**  
 Description of View and Orientation: **Photograph depicts the back of the building, it forms an L. The long arm of the L facing south, the short arm of the L facing north , viewed from E street facing the northeast.**
- **Photo No. 9**  
 Name of Photographer: **Mary B. Kennedy\ Jacqueline Johnson**  
 Date of Photo: **August 01, 2000**  
 Location of Original Negative: **Woman's Club**  
 Description of View and Orientation: **Photograph depicts the entrance hall of the building the door on the left leads to the Woman's Restroom. The second door opens into the Directors Room. The photograph is looking toward the northeast.**
- **Photo No. 10**  
 Name of Photographer: **Mary B. Kennedy\ Jacqueline Johnson**  
 Date of Photo: **August 01, 2000**  
 Location of Original Negative: **Woman's Club**  
 Description of View and Orientation: **Photograph depicts part of the large meeting room of the building viewed looking to the west. The folding french doors in the foreground that can be used to divide the room.**
- **Photo No. 11**  
 Name of Photographer: **Mary B. Kennedy\ Jacqueline Johnson**  
 Date of Photo: **August 01, 2000**  
 Location of Original Negative: **Woman's Club**  
 Description of View and Orientation: **Photograph depicts the east end of the large meeting room showing the folding french doors that divide the room.**
- **Photo No. 12**  
 Name of Photographer: **Mary B. Kennedy\ Jacqueline Johnson**  
 Date of Photo: **August 01, 2000**  
 Location of Original Negative: **Woman's Club**  
 Description of View and Orientation: **Photograph depicts the open beamed construction of the ceiling of the main room of the building.**
- **Photo No. 13**  
 Name of Photographer: **Mary B. Kennedy\ Jacqueline Johnson**  
 Date of Photo: **August 01, 2000**  
 Location of Original Negative: **Woman's Club**  
 Description of View and Orientation: **Photograph depict the Directors Room from the entrance hall looking to the north.**
- **Photo No. 14**  
 Name of Photographer: **Mary B. Kennedy\ Jacqueline Johnson**  
 Date of Photo: **August 01, 2000**  
 Location of Original Negative: **Woman's Club**  
 Description of View and Orientation: **Photograph depicts part of the building's kitchen viewed looking to the east.**

- **Photo No. 15**

Name of Photographer: **Mary B. Kennedy\ Jacqueline Johnson**

Date of Photo: **August 01, 2000**

Location of Original Negative: **Woman's Club**

Description of View and Orientation: **Photograph depicts the building's kitchen looking toward the west. The background shows the enclosed porch [Utility Room] to the back entrance.**