



ARCHITECTURAL/HISTORICAL COMPONENT FORM

**IMPORTANT:** USE IN CONJUNCTION WITH THE GREEN INVENTORY RECORD FORM FOR RECORDING HISTORIC STRUCTURES AND DISTRICTS. USE SEPARATELY FOR RECORDING STRUCTURES LOCATED WITHIN DISTRICT BOUNDARIES.

1) Resource No. \_\_\_\_\_ 2) Temp No. 4 3) Name Lafayette House

4) Address 600 E. Simpson, Lafayette, CO 5) District Name Lafayette Coal Mining Era Buildings

I. INTEGRITY: 6) Condition: Good  Fair \_\_\_\_\_ Deteriorated \_\_\_\_\_

7) Original Use boarding house 8) Present Use residence

9) Original Site  Moved \_\_\_\_\_ Date(s) of Move: \_\_\_\_\_

10) Unaltered \_\_\_\_\_ Altered  Explain: 1940s wash house interior converted to nursery school. 1979 porch built on north side, repainted.

II. DESCRIPTION: 11) Building Materials wood

12) Construction Date 1900 13) Architect/Builder \_\_\_\_\_

14) Architectural Style(s) vernacular

15) Special Features/Surroundings: Lafayette House is a large two-story rectangular house with a hip roof and small porch at the north and south sides. The exterior material is narrow clapboard siding. The first-story windows are larger than those of the second floor but have the same form of a simple surrounds with cornice heads. A series of scrolled brackets support the eaves overhang. A small wash house of the same narrow clapboard siding is located at the south of the property at the alley, and there is a hitching post of Lyons sandstone at the west side of the house.

16) Archaeological Potential: Yes \_\_\_\_\_ No \_\_\_\_\_ Unknown  Explain: \_\_\_\_\_

III. CULTURAL ACTIVITIES: Key the resource type (ie: house, barn, shed, school, church, etc) to the cultural activity theme and sub-theme category associated with it.

|               | AREA OF SIGNIFICANCE |  |
|---------------|----------------------|--|
| 17) THEME     | industry             |  |
| 18) SUB-THEME | coal                 |  |
| 19) TYPES     | housing              |  |

(Attach Photographs)

Frame Number \_\_\_\_\_  
 Roll Number \_\_\_\_\_  
 Facade Orientation \_\_\_\_\_

**IV. SIGNIFICANCE:** Assess whether or not the resource has any historical or architectural merit by checking appropriate categories and justifying below. Include any relevant historical data.

20) Architectural Significance:

- Represents work of a master
- Possesses high artistic values
- Represents a type, period, or method of construction

21) Historical Significance:

- Associated with significant persons
- Associated with significant events or patterns
- Contributes to the significance of an historic district

The Lafayette House is the town's best preserved boarding house and, in representing a building type, has architectural importance. As a multiple residential dwelling, it also contributes to the understanding of the lifestyle of the miners, to whom it catered, and thus the history of the mining town.

The Lafayette House opened its doors for business in 1900, accepting both overnight guests and boarders. The boarders were in most cases coal miners from the mines in and around Lafayette. The wash house to the rear of the structure was constructed so that the men could clean up before entering the house. It is thought that the building may have been sold, for the following year, it was refitted by John W. Jones. Within a month, however, Jones had sold the establishment to the Hobart family. In 1901, owner John V. Higgs promoted the Lafayette House with the motto, "The Best is None Too Good." He charged 50¢ a night, or \$6.00 per week including meals.

Many boarding houses were operated in Lafayette, as well as at the coal mine camps. These businesses catered to single miners, providing both bed and board. An inventory of a room in such a boarding house in 1928 consisted of the following:

(continued)

22) List Any Associated Cultural Group: n/a

**V. REFERENCES:**

- Boulder County Courthouse Records.
- Inventory of Equipment of Lange Boarding House, Columbine Mine, Serene, Co, 1 April 1928.
- Lafayette Leader, 8 January 1909, #49.
- Lafayette News, 4 January 1901, V. 3, #132, p. 101.
- Lafayette News, 18 January 1907, V. 9, #38.

IV (continued)

|                             |                 |                  |
|-----------------------------|-----------------|------------------|
| 1 double springs & mattress | 1 chair         | 2 sheet blankets |
| 2 stands                    | 1 heavy blanket | 1 window shade   |
| 2 sash curtains             |                 |                  |
| 2 comforters                |                 |                  |

In addition to the miners, the Lafayette House also provided quarters for Baldwin-Felts detectives who were brought to Lafayette by Mine owners to break the strike of 1910-1914.

During the 1940s, the structure became the Pillar of Fire Church. The wash house was converted to a kindergarten/nursery school, the only one in Lafayette.

Boarding houses in mining communities such as Lafayette played a vital role in furnishing living quarters for a large number of miners. In Lafayette, there are several boarding houses that remain from the coal mining era. Of these, the Lafayette House is the most prominent and least altered.

INVENTORY RECORD



IMPORTANT: COMPLETE THIS SHEET FOR EACH RESOURCE PLUS EITHER AN ARCHAEOLOGICAL OR HISTORICAL/ARCHITECTURAL COMPONENT FORM.

|     |                   |
|-----|-------------------|
| ___ | NOT FOR FIELD USE |
| ___ | DET. ELIG.        |
| ___ | DET. NOT ELIG.    |
| ___ | NOMINATED         |
| ___ | LISTED, DATE      |

I. IDENTIFICATION: 1) Resource No. \_\_\_\_\_ 2) Temp. No. 4

3) Resource Name Lafayette House 4) Project Name Lafayette Thematic District

5) Category: Arch. Site   , Hist./Archit. Structure X, Hist./Archit. District X.  
Thematic

6) (For Arch. site) In a District: yes no; Name NA

II. LOCATION: 7) Township 15; Range 69W; SE  $\frac{1}{4}$  of SW  $\frac{1}{4}$  of NE  $\frac{1}{4}$  of NW  $\frac{1}{4}$  of  
Section 2; P.M. 6th. 8) County Boulder

9) USGS QUAD Lafayette, Colorado; 7.5 X 15; Date 1965 (71) Attach photocopy  
portion of Quad. Clearly show site. 10) Other maps NA

11) Dimensions --- mX --- m 12) Area --- sq.m (+4047=) less than 1 acre

13) UTM Reference: (One UTM centered on resource may be given for resource under 10 acres.)

A. | 1, 3 | ; | 4 | 9, 2 | 8, 6, 0 | mE; | 4, 4 | 2, 7 | 3, 4, 0 | mN. B. | | ; | | | | | | mE; | | | | | | mN.

C. | | ; | | | | | | mE; | | | | | | mN. D. | | ; | | | | | | mE; | | | | | | mN.

14) Address 600 East Simpson, Lafayette, Colorado Lot 5, Block 1 Addition 6

III. MANAGEMENT DATA: 15) Field Assessment: Eligible X Not Eligible    Need Data   

16) Owner/Address Edward Parker, Box 929, Silverplume, CO 80476

17) Gov't Involvement: County    State    Federal    Private   ; Agency NA

18) Disturbance: none    light X moderate    heavy    total   ; Explain A front porch was constructed  
by the present owner.

19) Threats to Resource: Water Erosion    Wind Erosion    Animal Activity    Neglect    Vandalism     
Recreation    Construction   ; Comments NA

20) Management Recommendations Follow the Secretary's Standards for Rehabilitation.

V. REFERENCE: 21) State/Fed. Permit Nos. NA

22) Photo Nos. L-1, 23A, 24A, 25A, 26A, on file at Colorado Historical Society

23) Report Title NA

24) Recorder Manuel M. Weiss 25) Recording Date January 23, 1982

26) Recorder Affiliation Community Services Collaborative 27) Phone No. 303-442-3601

V. SKETCH MAP: Map all features and show the boundaries of the resources. Show all major topographic features, permanent modern features, and vegetation zones as appropriate. Give names of features, streets and addresses if known. Provide scale, key and direction.

scale:  
[square] = 3 meters

key:

↑  
N  
true X  
mag. \_\_\_\_\_

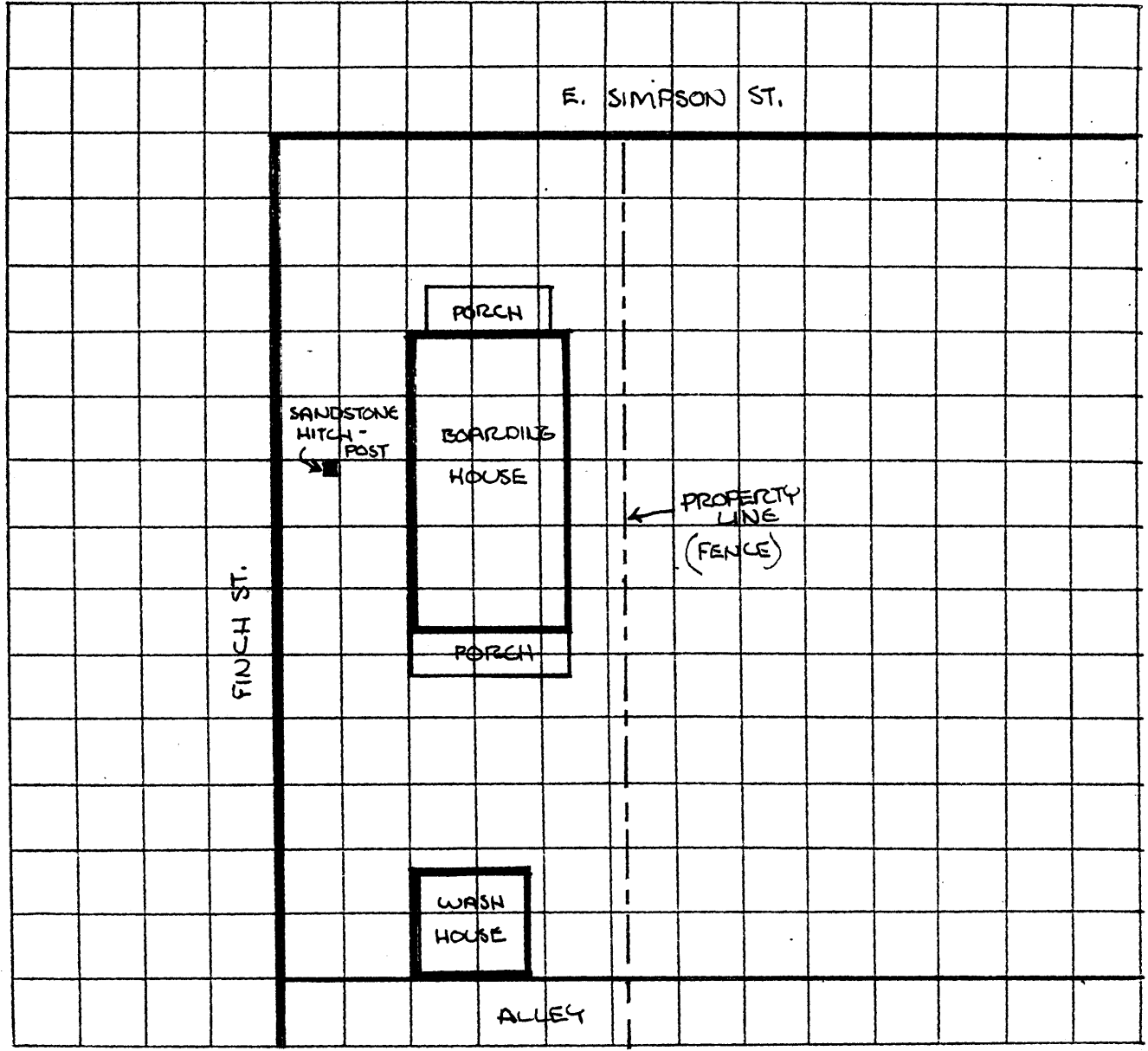

28) Location/Access: From the intersection of Highway 287 and East Simpson, drive east six blocks. The structure is situated on the southeast corner.

29) Boundary Description: Lots 5 and 6, Block 1, Lafayette, Colorado.

30) Boundary Justification: Limited to the lots occupied by the buildings.

