

PH0524767

NATIONAL REGISTER OF HISTORIC PLACES
INVENTORY - NOMINATION FORM

(Type all entries - complete applicable sections)

STATE: MAINE	
COUNTY: KENNEBEC	
FOR NPS USE ONLY	
ENTRY NUMBER 76-P-18-0037	DATE 8/65

1. NAME

COMMON:
Elm Hill Farm

AND/OR HISTORIC:
The Merrick Cottage

2. LOCATION

STREET AND NUMBER:
Litchfield Road (west of Middle Street) No Number

CITY OR TOWN:
Hallowell 04347

STATE Maine	CODE 18	COUNTY: Kennebec	CODE 011
-----------------------	-------------------	----------------------------	--------------------

3. CLASSIFICATION

CATEGORY (Check One)	OWNERSHIP	PUBLIC ACQUISITION	STATUS	ACCESSIBLE TO THE PUBLIC
<input type="checkbox"/> District <input type="checkbox"/> Site <input type="checkbox"/> Object <input checked="" type="checkbox"/> Building <input type="checkbox"/> Structure	<input type="checkbox"/> Public <input checked="" type="checkbox"/> Private <input type="checkbox"/> Both	<input type="checkbox"/> In Process <input type="checkbox"/> Being Considered	<input checked="" type="checkbox"/> Occupied <input type="checkbox"/> Unoccupied <input type="checkbox"/> Preservation work in progress	Yes: <input type="checkbox"/> Restricted <input type="checkbox"/> Unrestricted <input checked="" type="checkbox"/> No
PRESENT USE (Check One or More as Appropriate)				
<input checked="" type="checkbox"/> Agricultural <input type="checkbox"/> Commercial <input type="checkbox"/> Educational <input type="checkbox"/> Entertainment	<input type="checkbox"/> Government <input type="checkbox"/> Industrial <input type="checkbox"/> Military <input type="checkbox"/> Museum	<input type="checkbox"/> Park <input checked="" type="checkbox"/> Private Residence <input type="checkbox"/> Religious <input type="checkbox"/> Scientific	<input type="checkbox"/> Transportation <input type="checkbox"/> Other (Specify) _____	<input type="checkbox"/> Comments _____ _____

4. OWNER OF PROPERTY

OWNER'S NAME:
William Loring Vaughan

STREET AND NUMBER:
Litchfield Road

CITY OR TOWN:
Hallowell

STATE:
Maine

CODE:
018

5. LOCATION OF LEGAL DESCRIPTION

COURTHOUSE, REGISTRY OF DEEDS, ETC.:
Kennebec County Courthouse

STREET AND NUMBER:
State Street

CITY OR TOWN:
Augusta

STATE:
Maine

CODE:
18

6. REPRESENTATION IN EXISTING SURVEYS

TITLE OF SURVEY:

DATE OF SURVEY: Federal State County Local

DEPOSITORY FOR SURVEY RECORDS:

STREET AND NUMBER:

CITY OR TOWN: STATE: CODE:

SEE INSTRUCTIONS

STATE: **Maine**

COUNTY: **Kennebec**

ENTRY NUMBER

DATE

FOR NPS USE ONLY

7. DESCRIPTION

CONDITION	(Check One)					
	<input checked="" type="checkbox"/> Excellent	<input type="checkbox"/> Good	<input type="checkbox"/> Fair	<input type="checkbox"/> Deteriorated	<input type="checkbox"/> Ruins	<input type="checkbox"/> Unexposed
	(Check One)			(Check One)		
	<input checked="" type="checkbox"/> Altered	<input type="checkbox"/> Unaltered	<input type="checkbox"/> Moved	<input checked="" type="checkbox"/> Original Site		

DESCRIBE THE PRESENT AND ORIGINAL (if known) PHYSICAL APPEARANCE

LOCATION, SETTING AND GROUNDS:

This 1799 wooden frame cottage is located approximately 1,300 feet back from the Kennebec River at the top of the hillside of Hallowell. This location borders on the residential area. The setting is pastoral. The cottage today is the central dwelling house in a farm complex. The cottage, facing south, is about 200 feet removed from the Litchfield Road to the south and 200 feet west of Middle Street. The out-buildings, which are adjacent to the cottage, include a garage, storehouse and barns which shelter Guernsey cattle and store the produce of a model farm. The grounds are enclosed by a post and rail fence. There are lush lawns, gardens and hedges interspaced between the elm trees; whence, the name Elm Hill Farm, is aptly derived.

BASIC STRUCTURE AND BUILDING MATERIALS:

Original Appearance: The cottage was built on a square plan with a low-pitched gabled roof. The octagonal bay of the dining room shows only from the rear of the house. The interior plan includes a central hall with two rooms at either side, a chimney in the partition between front and rear rooms. The stairs are located off the dining room which is unusual. The hall is lined with book shelves behind paneled doors. The cottage in 1799 was sheathed with hand shaped clapboard; these are in place today.

Present Appearance: The dormers were added later and presently there are four bedrooms, two baths and a large central hall upstairs. Probably the upstairs was divided differently, but there is one fireplace existing and hearths in the other rooms. There is nothing above the dining room. There is, today, a full cellar with an outside bulkhead entrance way. The cottage is painted white. The window and front door blinds are black. The windows, 12 lights each, and frames, are probably not original. The front door and fan light above are original and the steps up to the threshold are granite, grist mill wheel sections. A two-story ell has been built for additional living and service space. This is attached midway back on the west side wall of the cottage.

SEE INSTRUCTIONS

6. SIGNIFICANCE

PERIOD (Check One or More as Appropriate)

- Pre-Columbian | 16th Century | 18th Century | 20th Century
 15th Century | 17th Century | 19th Century

SPECIFIC DATE(S) (If Applicable and Known) **1799**

AREAS OF SIGNIFICANCE (Check One or More as Appropriate)

- | | | | |
|---|---|--|--|
| <input type="checkbox"/> Aboriginal | <input checked="" type="checkbox"/> Education | <input type="checkbox"/> Political | <input type="checkbox"/> Urban Planning |
| <input type="checkbox"/> Prehistoric | <input type="checkbox"/> Engineering | <input type="checkbox"/> Religion/Philosophy | <input type="checkbox"/> Other (Specify) |
| <input type="checkbox"/> Historic | <input type="checkbox"/> Industry | <input type="checkbox"/> Science | _____ |
| <input checked="" type="checkbox"/> Agriculture | <input type="checkbox"/> Invention | <input type="checkbox"/> Sculpture | _____ |
| <input type="checkbox"/> Architecture | <input type="checkbox"/> Landscape Architecture | <input type="checkbox"/> Social/Humanitarian | _____ |
| <input type="checkbox"/> Art | <input type="checkbox"/> Literature | <input type="checkbox"/> Theater | _____ |
| <input type="checkbox"/> Commerce | <input type="checkbox"/> Military | <input type="checkbox"/> Transportation | _____ |
| <input type="checkbox"/> Communications | <input type="checkbox"/> Music | | |
| <input type="checkbox"/> Conservation | | | |

STATEMENT OF SIGNIFICANCE

The name of John Merrick is closely associated with that of Dr. Benjamin Vaughan and of Charles Vaughan, Esq. These first representatives of the Merrick and Vaughan families in Hallowell came from England and settled side by side on the banks of the Kennebec River.

Mr. John Merrick was born in London, August 27, 1766. He received a thorough classical education and having completed a divinity course, Mr. Merrick preached at Stamford, but was never ordained to the ministry. From 1794 to 1797, he resided with the family of Dr. Benjamin Vaughan in the capacity of tutor; and in 1795 he accompanied Mrs. Vaughan and her children to New England.

In 1797, Mr. Merrick returned to England where he married Rebecca Vaughan, daughter of Samuel Vaughan, and sister of Dr. Benjamin and Charles Vaughan, and brought his bride at once to Hallowell. Here he built and occupied the spacious cottage which stands upon one of the most beautiful sites in the town, and which is still known as the Merrick Cottage. At the time of his coming to Hallowell, the village was rapidly increasing in population; and Mr. Merrick entered most heartily into the spirit of the place and devoted all his energies to the promotion of the public welfare. He was especially interested in the cause of education. In 1802, he was appointed one of the Trustees of the Hallowell Academy; and for the remainder of his long life, he devoted himself to the interests of this school.

Mr. Merrick was also a member of the Board of Overseers of Bowdoin College from 1805 to 1851.

In the affairs of the town, Mr. Merrick showed himself a truly loyal and public-spirited citizen. He served ably and conscientiously as Selectman, as Surveyor of Highways, and as Overseer of the Poor. He was also for some years cashier of the Hallowell Bank.

In 1810, a project was started for the opening of a road from

SEE INSTRUCTIONS

9. MAJOR BIBLIOGRAPHICAL REFERENCES

Nason, Emma H., Old Hallowell on the Kennebec, Augusta 1909, pgs. 38, 99, 106
 North, James W., History of Augusta, Maine, 1870, pp. 391
 Nash, Charles E., History of Augusta, pp. 71-192
 Vaughan, W. W., Hallowell Memories
 Collections of the Maine Historical Society, Vol. 7, pp. 379
 Snell, Katherine H. and Leden Vincent P., Historic Hallowell,
 Augusta, 1962.

10. GEOGRAPHICAL DATA

LATITUDE AND LONGITUDE COORDINATES DEFINING A RECTANGLE LOCATING THE PROPERTY			O R	LATITUDE AND LONGITUDE COORDINATES DEFINING THE CENTER POINT OF A PROPERTY OF LESS THAN TEN ACRES		
CORNER	LATITUDE	LONGITUDE		LATITUDE	LONGITUDE	
	Degrees Minutes Seconds	Degrees Minutes Seconds		Degrees	Minutes	Seconds
NW	44° 16' 53"	69° 48' 5"				
NE	44° 16' 53"	69° 47' 51"				
SE	44° 16' 24.2"	69° 47' 51"				
SW	44° 16' 42.3"	69° 48' 5"				
APPROXIMATE AREA OF NOMINATED PROPERTY:				25 acres		
LIST ALL STATES AND COUNTIES FOR PROPERTIES OVERLAPPING STATE OR COUNTY BOUNDARIES						
STATE:	CODE	COUNTY:	CODE			
STATE:	CODE	COUNTY:	CODE			
STATE:	CODE	COUNTY:	CODE			
STATE:	CODE	COUNTY:	CODE			

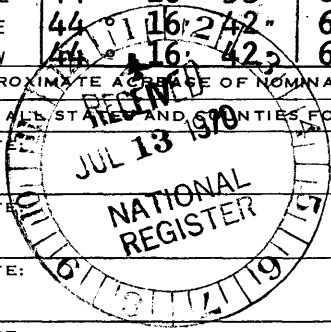

19/1263501/1963925
 1-141-76
 19/1263501/1963925
 1-141-76

SEE INSTRUCTIONS
 19/1263501/1963925

11. FORM PREPARED BY

NAME AND TITLE: John W. Briggs, Historian		
ORGANIZATION: State Park and Recreation Commission	DATE: June 25, 1970	
STREET AND NUMBER: State House		
CITY OR TOWN: Augusta	STATE: Maine	CODE: 18

12. STATE LIAISON OFFICER CERTIFICATION NATIONAL REGISTER VERIFICATION

<p>As the designated State Liaison Officer for the National Historic Preservation Act of 1966 (Public Law 89-665), I hereby nominate this property for inclusion in the National Register and certify that it has been evaluated according to the criteria and procedures set forth by the National Park Service. The recommended level of significance of this nomination is:</p> <p>National <input type="checkbox"/> State <input type="checkbox"/> Local <input checked="" type="checkbox"/></p> <p>Name <u>Lawrence Stuart</u> Lawrence Stuart Title <u>Director</u></p> <p>Date <u>7/9/70.</u></p>	<p>I hereby certify that this property is included in the National Register.</p> <p><u>Ernest Allen Connally</u> Chief, Office of Archeology and Historic Preservation</p> <p>Date <u>AUG 25 1970</u></p> <p>ATTEST: <u>William J. Huntley</u> Keeper of The National Register</p> <p>Date <u>AUG 7 1970</u></p>
---	---

NATIONAL REGISTER OF HISTORIC PLACES
INVENTORY - NOMINATION FORM

(Continuation Sheet)

STATE	
MAINE	
COUNTY	
KENNEBEC	
FOR NPS USE ONLY	
ENTRY NUMBER	DATE
70-8-18-0037	8/25

(Number all entries)

The Kennebec to the Chaudiere and thence to Quebec, which, it was thought, would greatly increase the business of this region and open an avenue from the Atlantic to Canada. Mr. Merrick was appointed by Governor Gore to be a member of a Board of Commissioners to further this project.

He made the first recording of a trial in shorthand.

He was an accurate mathematician, surveyor, and navigator. He devoted much time to the study of geology and astronomy, and invented a new practical method for mapping out the heavens. He had also a thorough knowledge of anatomy, and in cases of necessity proved himself an excellent surgeon. With all this, Mr. Merrick possessed the most highly cultivated literary and musical tastes.

John died October 22, 1862 at the advanced age of 96.

The Merrick house passed at one time out of the possession of the Merrick family, and was owned by Captain Swanton and afterwards by Governor Bodwell. It was purchased by Henry Vaughan, Esq., the son of Benjamin Vaughan, and a lineal descendant through his maternal line, from Samuel Merrick, the brother of Mr. John Merrick. Mr. Vaughan restored the house as nearly as possible to its original condition. Such a house, with its many hallowed associations, is a rare and valuable possession, not only to its owner, but to the town that claims it among the oldest and most interesting of its ancient dwellings.

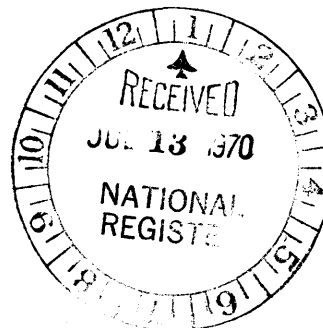

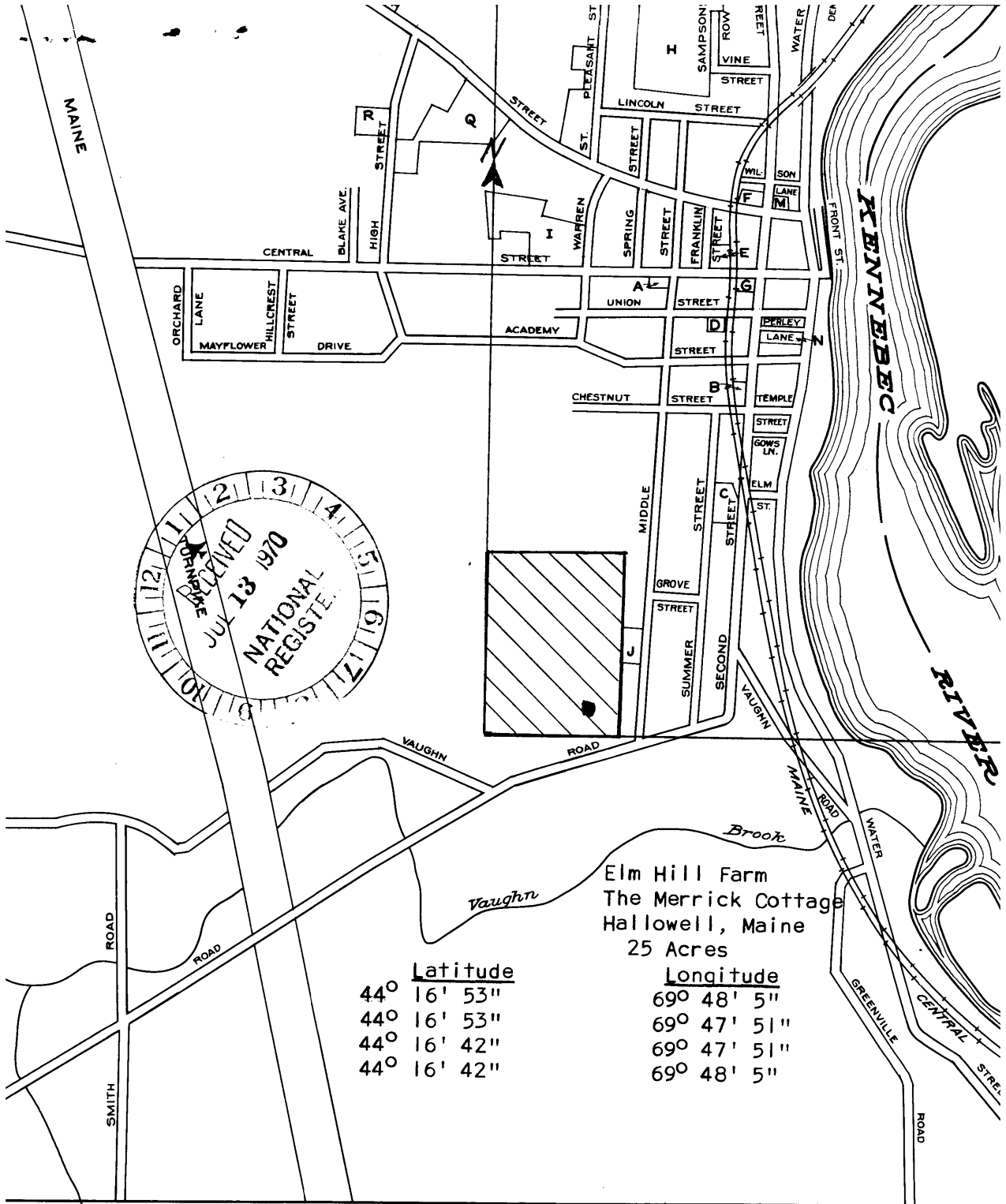

Elm Hill Farm
 The Merrick Cottage
 Hallowell, Maine
 25 Acres

	<u>Latitude</u>	<u>Longitude</u>
44°	16' 53"	69° 48' 5"
44°	16' 53"	69° 47' 51"
44°	16' 42"	69° 47' 51"
44°	16' 42"	69° 48' 5"

CITY OF
HALLOWELL
 KENNEBEC COUNTY, MAINE
 1965

JAMES W. SEWALL COMPANY OLD TOWN, MAINE

SCALE

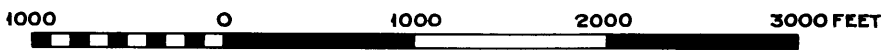

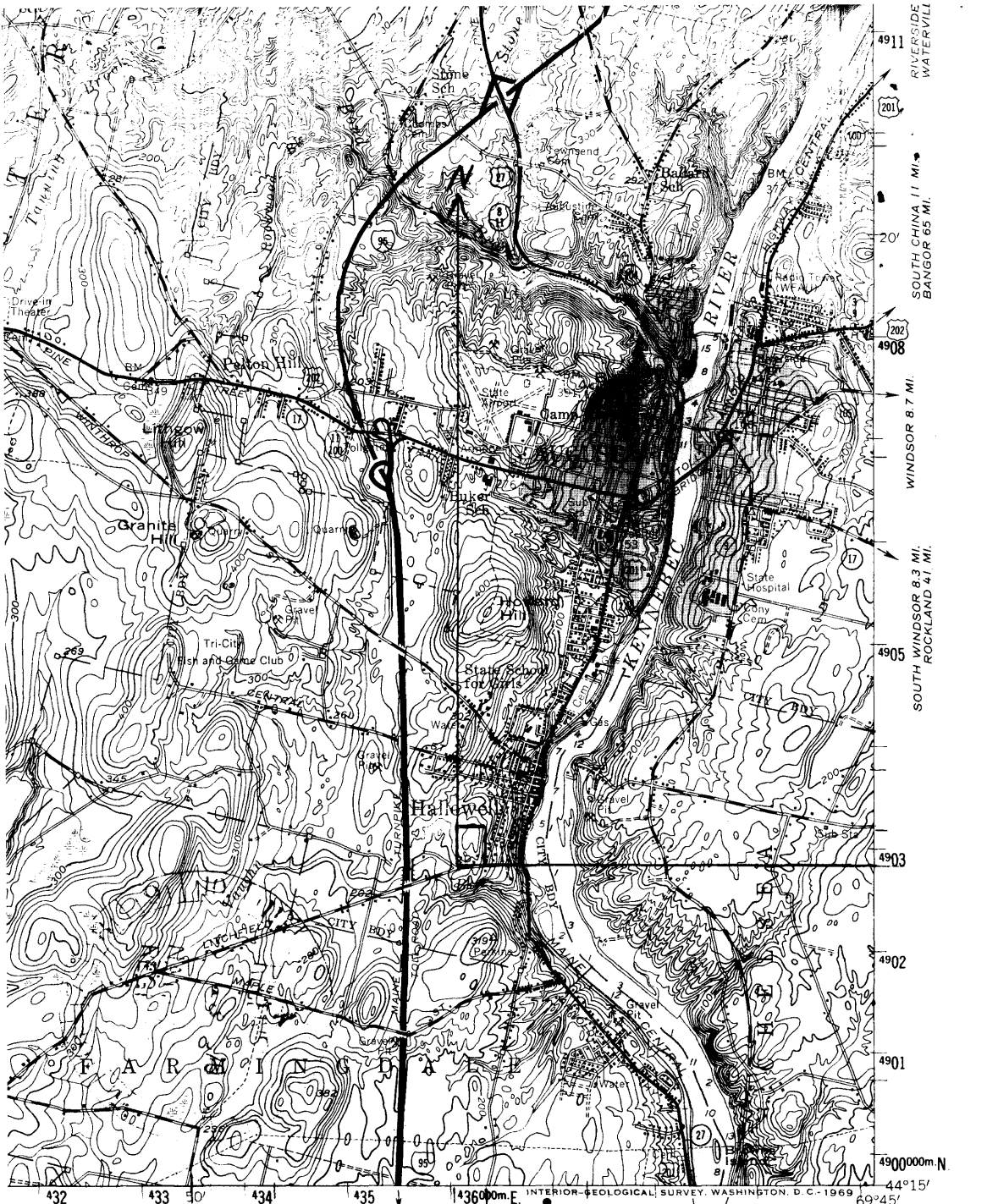

3
 5000
 4
 ER
 WATER
 ARDS
 I, D. C. 2024
 LABLE ON F

Elm Hill Farm
 The Merrick Cottage
 Hallowell, Maine 25 acres

Latitude

Longitude

44° 16' 53"
 44° 16' 53"
 44° 16' 42"
 44° 16' 42"

69° 48' 5"
 69° 47' 51"
 69° 47' 51"
 69° 48' 5"

AD CADIATION
1964

Light-duty
 Unimproved dirt
 U.S. Route State Route

AUGUSTA, ME.
 N4415—W6945/15

1956

AMS 7072 IV—SERIES V711

(WISCASSETT)
1072 II