

**NATIONAL REGISTER OF HISTORIC PLACES
INVENTORY - NOMINATION FORM**

(Type all entries - complete applicable sections)

STATE: Maine	
COUNTY: Cumberland	
FOR NPS USE ONLY	
ENTRY NUMBER 69-12.18-5012	DATE 12/3/69

1. NAME

COMMON:
First Parish Church

AND/OR HISTORIC:

2. LOCATION

STREET AND NUMBER:
207 Maine Street

CITY OR TOWN:
Brunswick

STATE Maine	CODE 18-1150	COUNTY: Cumberland	CODE 005
----------------	-----------------	-----------------------	-------------

3. CLASSIFICATION

CATEGORY (Check One)	OWNERSHIP	STATUS	ACCESSIBLE TO THE PUBLIC
<input type="checkbox"/> District <input checked="" type="checkbox"/> Building <input type="checkbox"/> Site <input type="checkbox"/> Structure <input type="checkbox"/> Object	<input type="checkbox"/> Public <input checked="" type="checkbox"/> Private <input type="checkbox"/> Both	Public Acquisition: <input type="checkbox"/> In Process <input type="checkbox"/> Being Considered	<input checked="" type="checkbox"/> Occupied <input type="checkbox"/> Unoccupied <input checked="" type="checkbox"/> Preservation work in progress
PRESENT USE (Check One or More as Appropriate)			
<input type="checkbox"/> Agricultural <input type="checkbox"/> Commercial <input type="checkbox"/> Educational <input type="checkbox"/> Entertainment	<input type="checkbox"/> Government <input type="checkbox"/> Industrial <input type="checkbox"/> Military <input type="checkbox"/> Museum	<input type="checkbox"/> Park <input type="checkbox"/> Private Residence <input checked="" type="checkbox"/> Religious <input type="checkbox"/> Scientific	<input type="checkbox"/> Transportation <input type="checkbox"/> Other (Specify) <input type="checkbox"/> Comments

4. OWNER OF PROPERTY

OWNER'S NAME:
The First Parish Church of Brunswick

STREET AND NUMBER:
9 Cleveland Street

CITY OR TOWN:
Brunswick

STATE: Maine	CODE 18-1150
-----------------	-----------------

5. LOCATION OF LEGAL DESCRIPTION

COURTHOUSE, REGISTRY OF DEEDS, ETC.:
Cumberland County Courthouse

STREET AND NUMBER:

CITY OR TOWN:
Portland

STATE: Maine	CODE 6400
-----------------	--------------

6. REPRESENTATION IN EXISTING SURVEYS

TITLE OF SURVEY:

DATE OF SURVEY: Federal State County Local

DEPOSITORY FOR SURVEY RECORDS:

STREET AND NUMBER:

CITY OR TOWN: STATE: CODE:

SEE INSTRUCTIONS

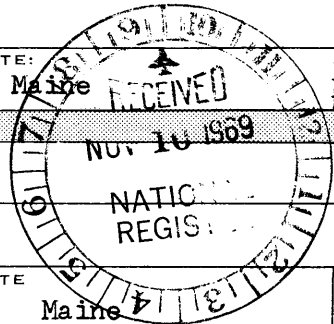

STATE: Maine
COUNTY: Cumberland
ENTRY NUMBER
DATE

FOR NPS USE ONLY

7. DESCRIPTION

CONDITION	(Check One)					
	<input type="checkbox"/> Excellent	<input checked="" type="checkbox"/> Good	<input type="checkbox"/> Fair	<input type="checkbox"/> Deteriorated	<input type="checkbox"/> Ruins	<input type="checkbox"/> Unexposed
	(Check One)			(Check One)		
	<input type="checkbox"/> Altered	<input checked="" type="checkbox"/> Unaltered	<input type="checkbox"/> Moved	<input checked="" type="checkbox"/> Original Site		

DESCRIBE THE PRESENT AND ORIGINAL (if known) PHYSICAL APPEARANCE

In 1848, two years after the building was completed, several alterations were made in the interest of greater beauty and serviceability. The rear pews were raised a few inches, and the sounding board was installed. The greatest changes were in the tower. Professor Smith of Bowdoin College felt that the tower was too clumsy and heavy. He presented plans for a spire and enlarged belfrey windows which would allow the church bell to be more easily heard. The spire was erected on the tower on July 24, 1848. Eighteen years later, on October 30, 1866, the spire broke from the tower during a furious northeaster and crashed to the street below. The spire has never been replaced. In 1883 the vestry was added to the church. Also during the late 1800's several stained glass memorial windows were placed in the church. Upjohn furnished the plans for the church, but he did not supervise the construction. The church was constructed by members of the church congregation. The reason for this assumption is that workmanship on the structure is better in some places than in others. Several of the piers are off center and in several places workmen made errors in their measurements. When the recent restorations took place no attempt was made to leave the building with perfect dimensions due to the fact that the building was never in that state. The interesting 18" stenciling pattern located above the dado cap has been restored by Mr. Paul Greenwald, a local expert. A particularly interesting feature of the church is the manner in which the wooden truss system projects well out into the nave. This has the effect of making the nave appear much narrower than it actually is. With restoration nearly complete, the church has been returned to the beautiful state it was originally in.

SEE INSTRUCTIONS

8. SIGNIFICANCE

PERIOD (Check One or More as Appropriate)

<input type="checkbox"/> Pre-Columbian	<input type="checkbox"/> 16th Century	<input type="checkbox"/> 18th Century	<input type="checkbox"/> 20th Century
<input type="checkbox"/> 15th Century	<input type="checkbox"/> 17th Century	<input checked="" type="checkbox"/> 19th Century	

SPECIFIC DATE(S) (If Applicable and Known) Erected 1845

AREAS OF SIGNIFICANCE (Check One or More as Appropriate)

<input type="checkbox"/> Aboriginal	<input type="checkbox"/> Education	<input type="checkbox"/> Political	<input type="checkbox"/> Urban Planning
<input type="checkbox"/> Prehistoric	<input type="checkbox"/> Engineering	<input checked="" type="checkbox"/> Religion/Philosophy	<input type="checkbox"/> Other (Specify) _____
<input type="checkbox"/> Historic	<input type="checkbox"/> Industry	<input type="checkbox"/> Science	_____
<input type="checkbox"/> Agriculture	<input type="checkbox"/> Invention	<input type="checkbox"/> Sculpture	_____
<input checked="" type="checkbox"/> Architecture	<input checked="" type="checkbox"/> Landscape Architecture	<input type="checkbox"/> Social/Humanitarian	_____
<input type="checkbox"/> Art	<input type="checkbox"/> Literature	<input type="checkbox"/> Theater	_____
<input type="checkbox"/> Commerce	<input type="checkbox"/> Military	<input type="checkbox"/> Transportation	_____
<input type="checkbox"/> Communications	<input type="checkbox"/> Music		
<input type="checkbox"/> Conservation			

STATEMENT OF SIGNIFICANCE

The present First Parish Church building is the fourth in the history of the parish. Others were erected in 1735, 1756, and 1806. The 1806 building stood on the site of the present building.

The present building was dedicated on March 18, 1846. The builders were Messrs. Coolidge Graves and Isaiah Coombs. The chairman of the building committee was Professor William Smyth. The total cost of the building was \$13,101.

Historically and architecturally, the First Parish Church of Brunswick ranks as the most important Gothic-Revival structure in the state if not in New England. The church was designed in 1845 by the English-born Richard Upjohn, whose Gothic Revival Gardiner Mansion of 1839 in Gardiner, Maine, had signalled the start of this country's second great eclectic style following the Greek Revival of the 1820's.

Upjohn, the first president of the American Institute of Architects, left the Northeast an enormous architectural legacy of many hundreds of buildings, the best known survivor today being Trinity Church of lower Manhattan, built in 1845. Locally, the additional Upjohn churches of St. Paul's Episcopal Church in Brunswick, the Central Congregational Church in Bath, and the Bowdoin College Chapel - all designed 1845-46 - provide a nationally significant group of Upjohn architecture that continually enriches the Bath-Brunswick area.

There has always existed a close and friendly relation between the First Parish and Bowdoin College. The College gave financial assistance in the erection of both buildings on this site, and has certain rights in the use of the building. Until 1966 the Baccalaureate Services and the Commencement Exercises had been held either in this building or in the former one ever since the College was founded, and every Bowdoin graduate had received his degree in one or the other building except during World War II, when a few small commencements were held in the Bowdoin Chapel.

From the pulpit of this church on July 8, 1875, Henry Wadsworth Longfellow read "Morituri Salutamus", the poem written for the fiftieth anniversary of his graduation from Bowdoin. Other noted personages who have spoken from the pulpit include President William Howard Taft, John Masefield, Poet Laureate of England, Mrs. Franklin Delano Roosevelt, and Martin Luther King.

Harriett Beecher Stowe's biographer, Adams, stated that she received a vision of the death scene of Uncle Tom while sitting in pew 23 during the communion service of March 2, 1851.

In 1960 the First Parish Church voted to join the United Church of Christ. In 1968 extensive renovations were started on the church. The renovation projects were nearing the final states of completion at the time of this writing.

SEE INSTRUCTIONS

9. MAJOR BIBLIOGRAPHICAL REFERENCES

Upjohn, Everand M., Richard Upjohn, Architect and Churches, Columbia Press 1889.
 Newspaper article, July 21, 1929, Portland Sunday Telegram.
 Progress Report on First Parish Church Structural Renovations, Howard F. Peckworth,
 Consulting Engineer
 Report on Brunswick First Parish Church, Brooks Stoddard, Department of Art
 Bowdoin College
 Newspaper article, Brunswick, Maine Times-Record, June 24, 1968.

10. GEOGRAPHICAL DATA

LATITUDE AND LONGITUDE COORDINATES DEFINING A RECTANGLE LOCATING THE PROPERTY			O R	LATITUDE AND LONGITUDE COORDINATES DEFINING THE CENTER POINT OF A PROPERTY OF LESS THAN TEN ACRES		
CORNER	LATITUDE	LONGITUDE		LATITUDE	LONGITUDE	
	Degrees Minutes Seconds	Degrees Minutes Seconds		Degrees Minutes Seconds	Degrees Minutes Seconds	
NW	° ' "	° ' "		43° 54' 29"	69° 57' 47"	
NE	° ' "	° ' "				
SE	° ' "	° ' "				
SW	° ' "	° ' "				

APPROXIMATE ACREAGE OF NOMINATED PROPERTY:

LIST ALL STATES AND COUNTIES FOR PROPERTIES OVERLAPPING STATE OR COUNTY BOUNDARIES

STATE:	CODE	COUNTY	CODE

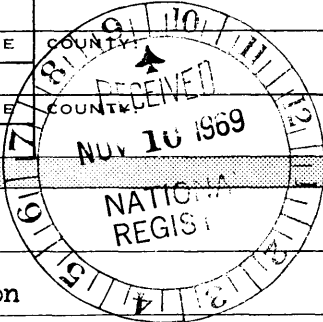

11. FORM PREPARED BY

NAME AND TITLE: John W. Briggs, Historian

ORGANIZATION: State Park & Recreation Commission DATE: November 7, 1969

STREET AND NUMBER: State House

CITY OR TOWN: Augusta STATE: Maine CODE: 18-0160

12. STATE LIAISON OFFICER CERTIFICATION NATIONAL REGISTER VERIFICATION

As the designated State Liaison Officer for the National Historic Preservation Act of 1966 (Public Law 89-665), I hereby nominate this property for inclusion in the National Register and certify that it has been evaluated according to the criteria and procedures set forth by the National Park Service. The recommended level of significance of this nomination is:

National State Local

Name: Lawrence Stuart
 Title: Director
 Date: November 7, 1969

I hereby certify that this property is included in the National Register.

Robert Allen Connally
 Chief, Office of Archeology and Historic Preservation

Date: DEC 2 1969

ATTEST:
William J. Tourtelot
 Keeper of The National Register
 Date: NOV 28 1969

SEE INSTRUCTIONS

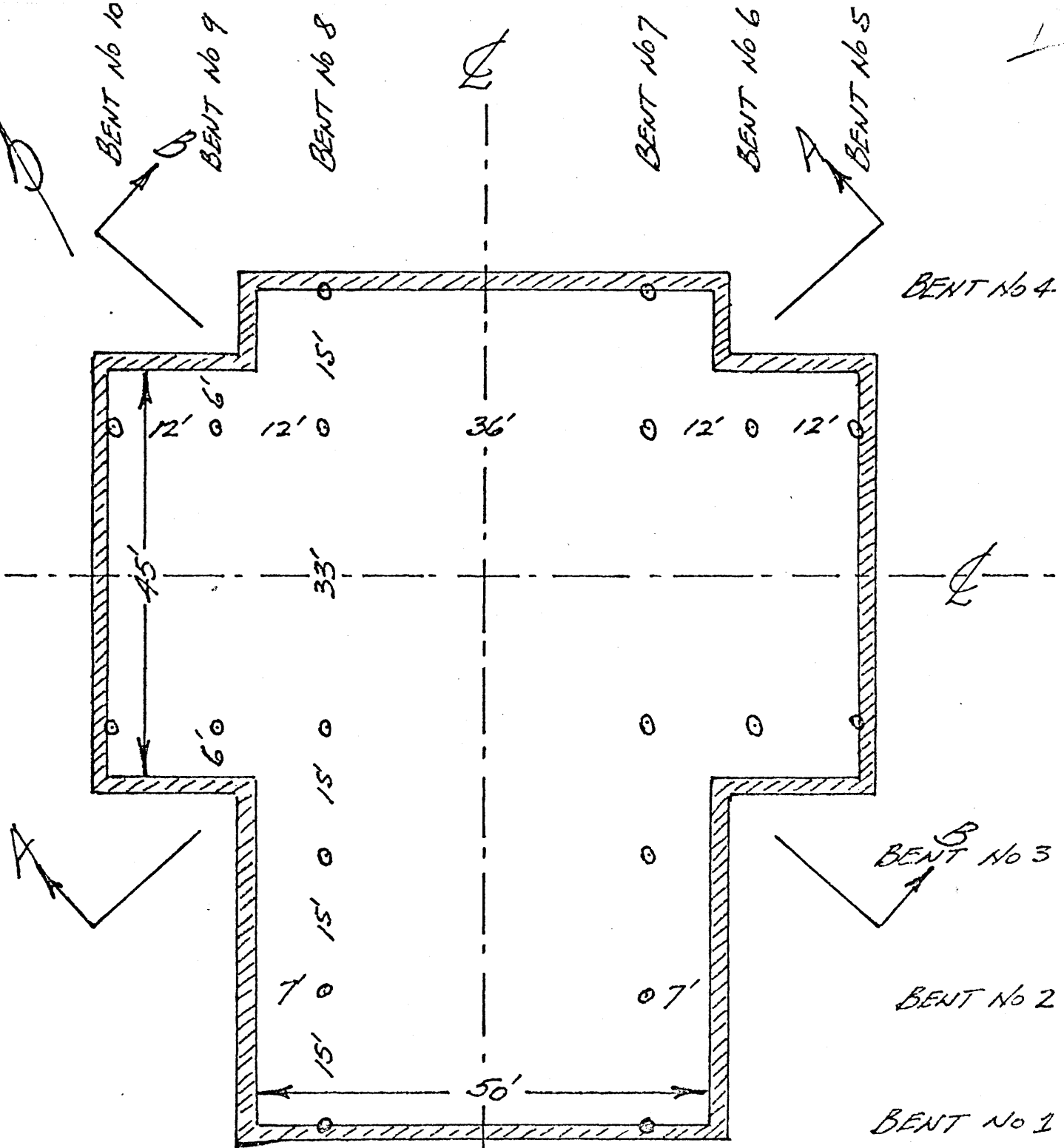

PLAN
NAVE AND TRANSEPTS

FIRST PARISH CHURCH BUILDING

BRUNSWICK, MAINE

SCALE 1" = 16' APPROXIMATELY

Explanation of the logic behind Richard Upjohn's interior truss design in the First Parish Church, Brunswick, Maine

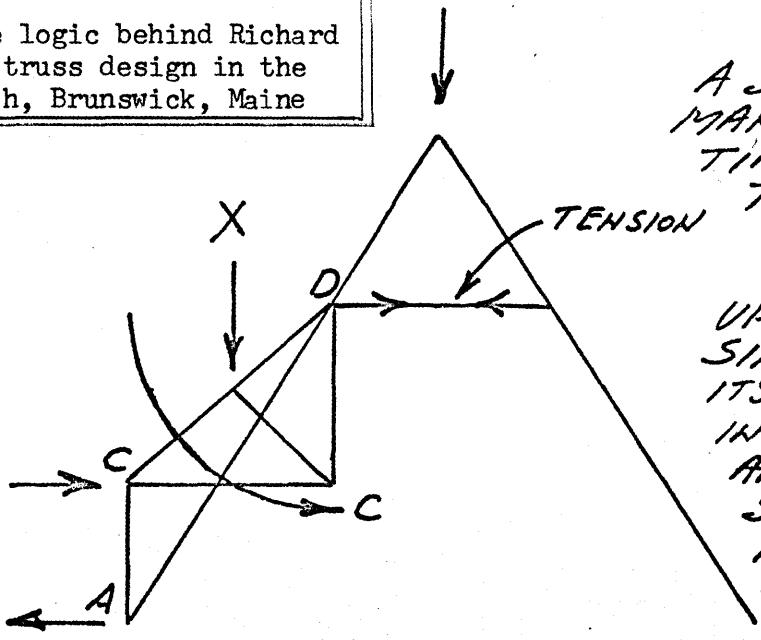

A SIMPLE TRUSS BRIDGE MAKES THE BEAM MANY TIMES STRONGER AND THE TRUSS ACTS AS A UNIT

UPJOHN TURNED THE SIMPLE TRUSS BRIDGE ON ITS SIDE TO FORM THE INVERTED GAMBREL ROOF AND TO ELIMINATE THE SIDE THRUST (A) WHICH IS SUPPORTED IN STONE CATHEDRALS BY THE FLYING BUTTRESS

FIGURE 4

THE LOAD X ON THE INVERTED GAMBREL ROOF TENDS TO ROTATE THE SIMPLE TRUSS BRIDGE COUNTERCLOCKWISE AROUND POINT D - THUS THE LOAD X ON THE TRUSS CREATES THE HORIZONTAL FORCE C WHICH BALANCES OR CANCELS OUT THE OPPOSITE HORIZONTAL FORCE AT A

NATIONAL REGISTER OF HISTORIC PLACES

PROPERTY MAP FORM

(Type all entries - attach to or enclose with map)

STATE Maine	
COUNTY Cumberland	
FOR NPS USE ONLY	
ENTRY NUMBER 69-12-18-0012	DATE 12/3/69

SEE INSTRUCTIONS

1. NAME

COMMON: First Parish Church

AND/OR HISTORIC:

2. LOCATION

STREET AND NUMBER:

207 Maine Street

CITY OR TOWN:

Brunswick

STATE:

Maine

CODE

18-1550

COUNTY:

Cumberland

CODE

005

3. MAP REFERENCE

SOURCE:

U.S.G.S. 15 min. quadrangle Bath

SCALE: 1:62,500

DATE: 1956

4. REQUIREMENTS

TO BE INCLUDED ON ALL MAPS

1. Property boundaries where required.
2. North arrow.
3. Latitude and longitude reference.

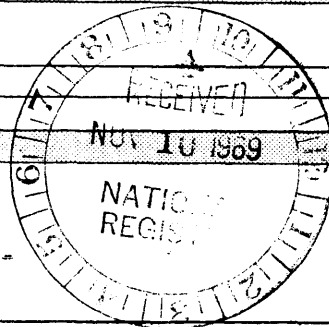

6972 II
(LEWISTON)

UNITED STATES
DEPARTMENT OF THE INTERIOR
GEOLOGICAL SURVEY

BATH QUADRANGLE
MAINE
15 MINUTE SERIES (TOPOGRAPHIC)

UNI
DEPARTM
CORPS

43° 54' 29"
69° 57' 47"

.1956

First Parish Church, Brunswick, Maine

