

**United States Department of the Interior
Heritage Conservation and Recreation Service**

**National Register of Historic Places
Inventory—Nomination Form**

See instructions in *How to Complete National Register Forms*
Type all entries—complete applicable sections

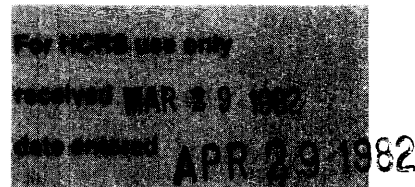

1. Name

historic Speed Hall

and/or common Same

2. Location

street & number College Street NA not for publication

city, town Barbourville NA vicinity of congressional district 05

state Kentucky code 021 county Knox code 121

3. Classification

Category	Ownership	Status	Present Use
<input type="checkbox"/> district	<input type="checkbox"/> public	<input type="checkbox"/> occupied	<input type="checkbox"/> agriculture
<input checked="" type="checkbox"/> building(s)	<input checked="" type="checkbox"/> private	<input type="checkbox"/> unoccupied	<input type="checkbox"/> commercial
<input type="checkbox"/> structure	<input type="checkbox"/> both	<input checked="" type="checkbox"/> work in progress	<input checked="" type="checkbox"/> educational
<input type="checkbox"/> site	Public Acquisition	Accessible	<input type="checkbox"/> entertainment
<input type="checkbox"/> object	<u>NA</u> in process	<input type="checkbox"/> yes: restricted	<input type="checkbox"/> government
	<input type="checkbox"/> being considered	<input checked="" type="checkbox"/> yes: unrestricted	<input type="checkbox"/> industrial
		<input type="checkbox"/> no	<input type="checkbox"/> military
			<input type="checkbox"/> museum
			<input type="checkbox"/> park
			<input type="checkbox"/> private residence
			<input type="checkbox"/> religious
			<input type="checkbox"/> scientific
			<input type="checkbox"/> transportation
			<input type="checkbox"/> other:

4. Owner of Property

name Union College c/o Mr. Mahlon Miller, President

street & number College Street

city, town Barbourville NA vicinity of state Kentucky

5. Location of Legal Description

courthouse, registry of deeds, etc. Knox County Courthouse

street & number Court Square

city, town Barbourville state Kentucky

6. Representation in Existing Surveys

title Survey of Historic Sites in Kentucky has this property been determined eligible? yes no

date January 1982 federal state county local

depository for survey records Heritage Division, Dept. of the Arts

city, town Frankfort state Kentucky

7. Description

Condition		Check one	Check one
<input type="checkbox"/> excellent	<input type="checkbox"/> deteriorated	<input type="checkbox"/> unaltered	<input checked="" type="checkbox"/> original site
<input checked="" type="checkbox"/> good	<input type="checkbox"/> ruins	<input checked="" type="checkbox"/> altered	<input type="checkbox"/> moved date _____
<input type="checkbox"/> fair	<input type="checkbox"/> unexposed		

Describe the present and original (if known) physical appearance

Speed Hall, constructed in 1903-05, stands near the heart of the Union College campus on an attractive, tree-shaded lawn. The campus is located in a residential neighborhood just north of the courthouse square and business center of Barbourville, a small eastern Kentucky community of approximately 3500.

Facing southwest towards College Street, Speed Hall is a 2½-story brick building with a hipped roof of asbestos shingles. The regularity of the otherwise rectangular mass is alleviated by various projecting bays on the east, south, and west sides of the building. These translate into numerous intersecting planes in the roof. Several shingled dormers jut from the roof as well. A dentilled cornice surrounds the building. Most window openings are straight-headed with smooth stone lintels and sills and contain double-hung sash windows. Smaller, round-arch windows pierce the gables on the southwest and southeast walls.

A one-story Colonial Revival porch shelters the main (southwest) facade and wraps around to the northwest. Fifteen Ionic columns support the porch. A one-story brick addition is located at the northeast (rear) corner of the building.

Much of the original woodwork including the broad oak staircase remains intact on the interior.

8. Significance

Period	Areas of Significance—Check and justify below			
<input type="checkbox"/> prehistoric	<input type="checkbox"/> archeology-prehistoric	<input type="checkbox"/> community planning	<input type="checkbox"/> landscape architecture	<input type="checkbox"/> religion
<input type="checkbox"/> 1400–1499	<input type="checkbox"/> archeology-historic	<input type="checkbox"/> conservation	<input type="checkbox"/> law	<input type="checkbox"/> science
<input type="checkbox"/> 1500–1599	<input type="checkbox"/> agriculture	<input type="checkbox"/> economics	<input type="checkbox"/> literature	<input type="checkbox"/> sculpture
<input type="checkbox"/> 1600–1699	<input checked="" type="checkbox"/> architecture	<input checked="" type="checkbox"/> education	<input type="checkbox"/> military	<input type="checkbox"/> social/ humanitarian
<input type="checkbox"/> 1700–1799	<input type="checkbox"/> art	<input type="checkbox"/> engineering	<input type="checkbox"/> music	<input type="checkbox"/> theater
<input type="checkbox"/> 1800–1899	<input type="checkbox"/> commerce	<input type="checkbox"/> exploration/settlement	<input type="checkbox"/> philosophy	<input type="checkbox"/> transportation
<input checked="" type="checkbox"/> 1900–	<input type="checkbox"/> communications	<input type="checkbox"/> industry	<input type="checkbox"/> politics/government	<input type="checkbox"/> other (specify)
		<input type="checkbox"/> invention		

Specific dates 1905 **Builder/Architect** Unknown

Statement of Significance (in one paragraph)

Speed Hall, constructed in 1903–05, is the oldest building on the campus of Union College. Union, a small school of 1,030 students, was founded in 1879 and was the first college located in southeastern Kentucky. It continues to serve not only the commonwealth, but the neighboring regions of western Virginia and east Tennessee as well. By its association with the early days of the school's founding, Speed Hall, therefore, has a special meaning for the college and the community of Barbourville. It can also be said to be the most important building in terms of its architecture constructed in the town during the first quarter of the twentieth century.

Most of Barbourville's significant historic buildings are confined to late nineteenth century Victorian residences. The majority of these structures which retain their original exterior appearance are frame, with gingerbread trim typical of the period. Few buildings of any consequence were constructed during the first two decades of the twentieth century. The two or three brick structures that were of any architectural merit dating to the period are no longer extant. Speed Hall is by far the most impressive and still remains virtually unchanged on the exterior. It projects, as was initially intended by its builders, an inviting, home-like image for Union's students.

Speed Hall was named for Fanny Henning Speed, a generous benefactor who, more than anyone else, kept the college alive in its early difficult days. Fanny Speed, from Louisville, was the wife of Joshua Speed, an intimate friend of Abraham Lincoln. Mrs. Speed's involvement with Union College developed as a result of her acquaintance with Dr. Daniel Stevenson. She was a member of the Trinity Methodist Episcopal Church in Louisville where Stevenson served as pastor before he became president of Union in 1886. Upon her death, the school fell heir to one-half her estate, valued at \$500,000. These funds gave some financial permanence to the college and made possible the completion of the first important building program set in motion since the founding of the college.²

Speed Hall served as the women's dormitory from 1905 until the official opening of Pfeiffer Hall in 1943. It was then used for a time as the music department and later as the home economics department. In 1960, the first two floors were converted entirely to administrative use, leaving the third floor for storage.³

¹Other buildings over fifty years of age on campus include the Old Classroom Building, constructed in 1907 (listed in the National Register 30 May, 1975); and Stevenson Hall (1907).

²"Old Classroom Building, Knox County, Kentucky," National Register nomination form.

³Information provided by Milton Townsend, Union College, Barbourville, Kentucky.

9. Major Bibliographical References

"Old Classroom Building, Knox County, Kentucky." National Register nomination form, Heritage Division, Frankfort, Kentucky.

Information provided by Mr. Milton Townsend, Union College, Barbourville, Kentucky.

10. Geographical Data UTM NOT VERIFIED ACRES NOT VERIFIED

Acreeage of nominated property .21

Quadrangle name Barbourville

Quadrangle scale 1:24000

UMT References

A

1	7
---	---

2	4	2	4	8	0
---	---	---	---	---	---

4	0	8	4	2	1	0
---	---	---	---	---	---	---

 Zone Easting Northing

B

--	--

--	--	--	--

--	--	--	--	--	--

 Zone Easting Northing

C

--	--

--	--	--	--

--	--	--	--	--	--

D

--	--

--	--	--	--

--	--	--	--	--	--

E

--	--

--	--	--	--

--	--	--	--	--	--

F

--	--

--	--	--	--

--	--	--	--	--	--

G

--	--

--	--	--	--

--	--	--	--	--	--

H

--	--

--	--	--	--

--	--	--	--	--	--

Verbal boundary description and justification

The nominated area includes Speed Hall, with the sidewalk surrounding the building as the boundary. The walkway lies roughly 10' from all exterior walls. (See Map 1)

List all states and counties for properties overlapping state or county boundaries

state	code	county	code
-------	------	--------	------

state	code	county	code
-------	------	--------	------

11. Form Prepared By

name/title Gloria Mills, historian; Charlotte Worsham, architectural historian

organization Heritage Division, Dept. of the Arts date January 1982

street & number 2200 Capital Plaza Tower telephone (502) 564-7508

city or town Frankfort state Kentucky

12. State Historic Preservation Officer Certification

The evaluated significance of this property within the state is:

national state local

As the designated State Historic Preservation Officer for the National Historic Preservation Act of 1966 (Public Law 89-665), I hereby nominate this property for inclusion in the National Register and certify that it has been evaluated according to the criteria and procedures set forth by the Heritage Conservation and Recreation Service.

State Historic Preservation Officer signature Mary Cronan Appel

title SHPO date 3/11/82

For HCRS use only

I hereby certify that this property is included in the National Register

Selma Byers
 for Keeper of the National Register

Entered in the National Register date 4/29/82

Attest: _____ date _____
 Chief of Registration

Speed Hall
Knox, Co., KY

Map 1

Campus plan.
Date unknown.

Nominated area shown in red.

**CAMPUS PLAN
UNION COLLEGE
BARBOURVILLE, KY**

- 1. BALDWIN PLACE
- 2. STEVENSON HALL
- 3. CLASS ROOM BUILDING
- 4. CREAMERY
- 5. ADMINISTRATION BUILDING (SPEED HALL)
- 6. PRESBYTER HALL
- 7. CONWAY BOATMAN CHAPEL
- 8. LAUNDRY BUILDING
- 9. TENNIS COURTS
- 10. VETERANS BUILDING
- 11. EGGY COTTAGE
- 12. CAMPUS COTTAGE
- 13. SNACK SHACK
- 14. MAINTENANCE BUILDING
- 15. EPHRAIM CHURCH
- 16. SWIMMING POOL
- 17. PROPOSED PHYSICAL EDUCATION BUILDING
- 18. COLLEGE COURTS
- 19. STORAGE BUILDING
- 20. TEMPORARY STORAGE BUILDINGS

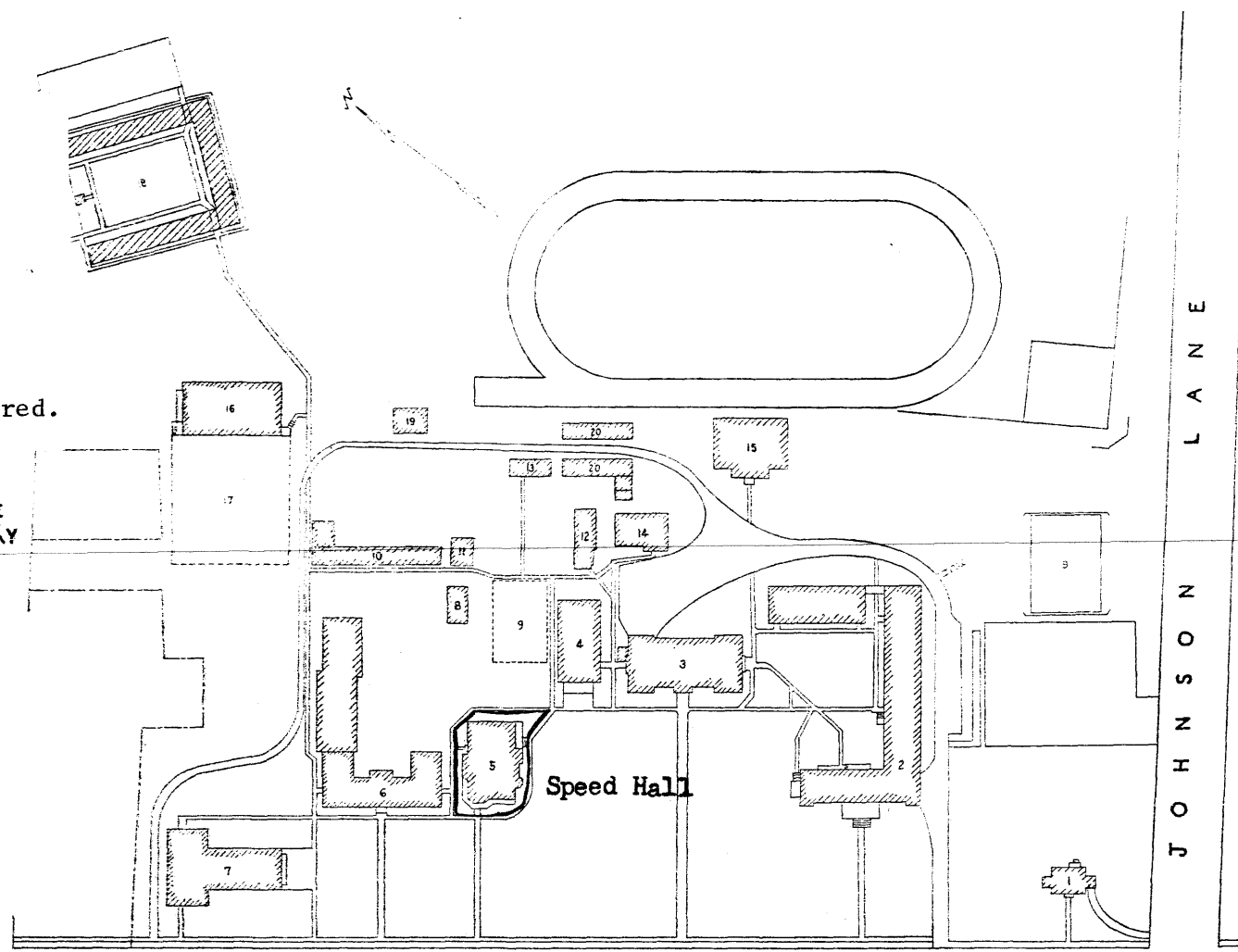

COLLEGE STREET

Main Campus

Speed Hall
Knox Co., KY

Map 2

Campus map.
Date unknown.
No scale.

Union College

Barbourville, Kentucky

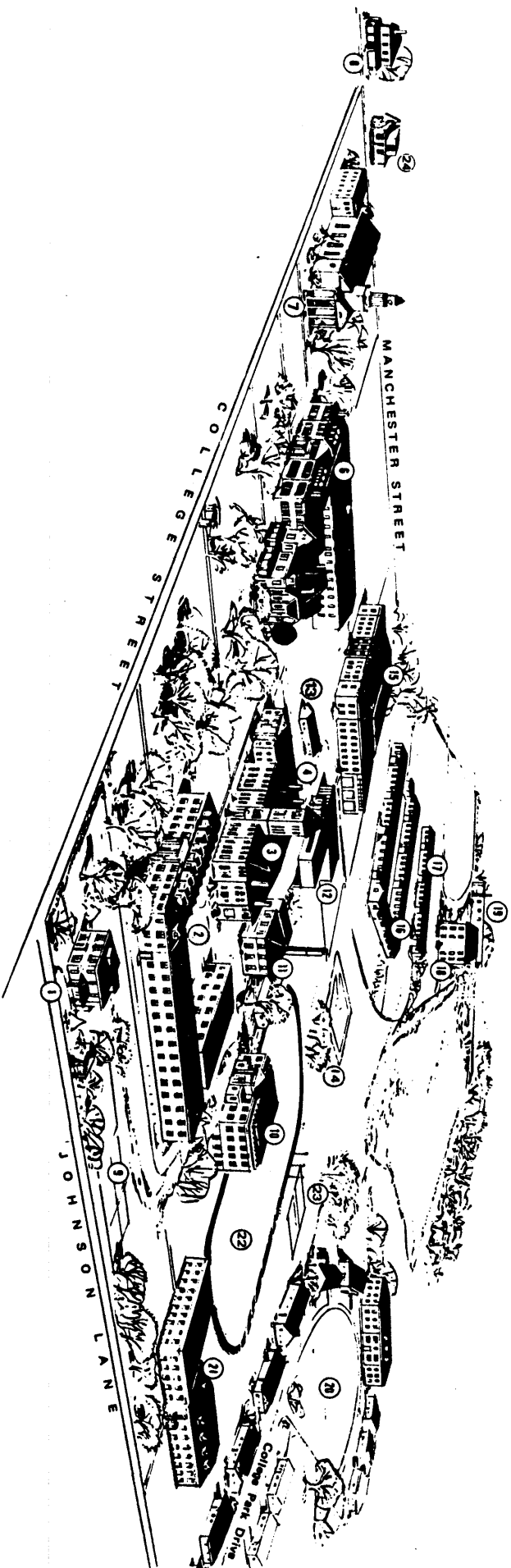

1. Baldwin Place, President's Residence
2. Stevenson Hall, Men's Residence
3. Classroom Building, Historical Site
4. Abigail E. Weeks Library
- Speed Hall, Administration Building
6. Pfeiffer Hall, Women's Residence
7. Conway Boatman Chapel — Fine Arts Building
8. Home Economics Building
9. Tennis Courts
10. Dramatic Arts Center
11. Data Processing Center
12. Student Center
13. The Lighthouse, Religious Life Center
14. Colonel Harland Sanders Baseball Field
15. Physical Education Building and Swimming Pool
16. College Courts, Married Students' Apartments
17. College Courts Addition
18. Lakeside Hall, Men's Residence
19. Mining Enforcement and Safety Administration
20. College Park, Faculty Housing
21. Mahlon Miller Science Center
22. Athletic Field, Track
23. Tennis Courts
24. Manchester Street Building, Regional Studies