

FORM A - AREA SURVEY

MASSACHUSETTS HISTORICAL COMMISSION
Office of the Secretary, State House, Boston

ry MD 044405 30

Form numbers in this area	Area no.
	92-A-1

2. Photo (3x3" or 3x5")
Staple to left side of form
Photo number _____

1. Town Worcester
Name of area (if any) former Worcester State Lunatic Hospital & Grounds - National Register District now Worcester State Hospital

3. General date or period 1876-1929

4. Is area uniform (explain):
in style? no (major bldgs. are Victorian Gothic)
in condition? yes (good)
in type of ownership? yes (Comm. of Mass.)
in use? no (residential, outpatient, vacant)

5. Map. Use space below to draw a general map of the area involved. Indicate any historic properties for which individual reports are completed on Forms B thru F, using corresponding numbers. Show street names (including route numbers, if any) and indicate north. Indicate with an "x" existing houses not inventoried on Form B.

Area straddles maps 80, 81, 92, 93 & 105

DO NOT WRITE IN THIS SPACE
USGS Quadrant _____
MHC Photo no. _____

6. Recorded by S. Lee & B.R. Pfeiffer
Organization Worc. Heritage Pres. Soc.

UTM Date February 1978

- (over) A 19/270985/4684320
- B 19/271740/4685055
- C 19/272325/4684760
- D 19/271780/4683630
- E 19/270975/4683635

7. Historical data. Explain the historical/architectural importance of this area.

ubd }
The Worcester State Lunatic Hospital occupies the southeastern slope of Millstone Hill, 255' above Lake Quināigamond. The area included in this nomination includes most of the farm and woodland which was purchased for the hospital's site in the mid 1870's, as well as additional parcels which were purchased to protect the site's rural qualities. Boundaries were selected to include landscaped grounds and fields which preserve much of the property's nineteenth-century appearance. The nominated area is bounded on the west by the Belmont Home and by Green Hill Park, on the south by Belmont Street, on the east by Plantation Street and on the north by Notre Dame de Namur, Home for Aged Sisters. Property contained within this nomination is shown as lots A & B on page 4 of Worcester Assessors' Book 57. Buildings in the district are:

1. Main Hospital Building, built 1874-1877 (Weston & Rand, arch'ts); enlarged 1887 (Rand & Taylor, arch'ts), kitchen enlarged 1898 (Fuller, Delano & Frost, arch'ts). The Main Building is a Victorian Gothic style structure, built of gneiss rubble and trimmed with rock-faced granite and red brick. The structure's complex plan was originally symmetrical; although additions to the building's rear (northwest) have altered the plan slightly, the building's facade (southeast) retains its symmetry. More than 1,000 feet long, the facade has a $4\frac{1}{2}$ story central section (Administration Building) from which rises a high clock tower. This clock tower is trimmed with pointed arches, trefoils, polished columns and cast-iron cresting, and is a local landmark, visible for miles. Other features of the Administration Building are a center-entry flanked by four-story bay windows, a porte-cochere set on polished granite columns and brick window trim. Except for a minor brick addition above the porte-cochere, the building is unaltered.

Wings which flank the Administration Building are $3\frac{1}{2}$ stories high and recede in three stages. Bearing the same design motifs as the Administration Building, these wings have projecting bays centered at each stage. These bays rise to high hip roofs and ventilator turrets which form an important element in the structure's skyline. Centered on the first three stories of the bays are brick bay windows. In 1887, pavilions of the wings' original design were extended and
cont'd.

8. Bibliography and/or references such as local histories, deeds, assessor's records, early maps, etc.

Worcester Historical Society. Organization file.
city atlases & directories.

American Architect and Building News, Vol. I, April 29, 1876, p. 141
(plans and facade rendering).

Engineering Record, Vol. XL, 7/8/1899, p. 139 and Builders' Weekly
Vol. I, no. 24, 3/12/1898, p. 4 (building notices - additions to
the kitchen and laundry, designed by Fuller, Delano & Frost).

Engineering Record, Vol. LIV, 7/21/1906, p. 54 (attendants' bldg.).

Crane, Ellery Bicknell, History of Worcester County. Vol. I, pp. 380-1.

American Arch't & Bldg. News, Vol 22, 9/24/1887, p. xii. (additions
to the State Lunatic Hospital - Arch't: Rand & Taylor of Boston
bldr: J.M. Buzzell, cost: \$30,000 .

INVENTORY FORM CONTINUATION SHEET

MASSACHUSETTS HISTORICAL COMMISSION
Office of the Secretary, Boston

Community: Worcester	Form No: 92-A-1
Property Name: Worcester State Hospital	

1.

Indicate each item on inventory form which is being continued below.

7.

nearly free-standing circular pavilions were added to two outer pavilions (see shaded area on map). Perhaps at the same time, additions were made to the rear of the building (see map). Designed by George Dutton Rand of Rand & Taylor, these additions were built in the same style as the original structure and complement its design. The addition of sun porches to some of the facade's pavilions (ca. 1930) and the removal of small portions of the roof from the outermost wings are the only alterations to the wings' facades.

2. Old Laundry Building, built 1874-1877, (Weston & Rand, arch'ts), extended 1898 (Fuller, Delano & Frost, arch'ts). Connected to the Main Hospital Building by a corridor, the Old Laundry Building is a one and one-half story gneiss and granite structure with brick trimmings. The building is designed in the same manner as the Main Hospital Building, having pointed arches, a steeply pitched slate roof and tower. It is likely that the eastern half of the present structure was built in 1898-1899.

3. Old Boiler Room, built 1874-1877 (Weston & Rand, arch'ts), top floor added - early 20th century. Connected to the Old Laundry Building, the Old Boiler Room is a two-story brick structure, the first story of which rises from a rock-faced granite plinth to a brick cornice; windows of the base are evenly spaced and set in arched surrounds. The building's second story is of brick, with metal-frame windows, flat roof and a circular-plan smokestack.

4. Stable? built 1874-1877?, minor additions, early twentieth century. Having the appearance of a stable or carriage house, this structure is not mentioned in original descriptions of the hospital, nor is it noted clearly on atlases. However, stylistic details suggest that it was built at the same time as the hospital or shortly thereafter. The stable is a one-and-one-half story brick building, set on a base of rock-faced granite, laid in a broken course, and enclosed by a slate-covered hip roof. The building is decorated with black-brick banding and has arched window heads. A minor addition has been made to the building's southeast corner, in the same style as the rest of the structure.

5. Nurses' Home, ca. 1900-1906 (?). Built southwest of the Main Hospital Building, the Nurses' Home is 3½ stories high, built of gneiss rubble and trimmed with red brick. The building has a symmetrical facade with a shallow central pavilion and evenly spaced windows. The structure is enclosed by a slate-covered hip roof with dormers. It is possible that this building was completed prior to 1900; however, 19th-century city atlases do not include accurate surveys of the hospital property, making identification of outbuildings uncertain.

cont'd.

Staple to Inventory form at bottom

INVENTORY FORM CONTINUATION SHEET

MASSACHUSETTS HISTORICAL COMMISSION
Office of the Secretary, Boston

2.

Community: Worcester	Form No: 92-A-1
Property Name: Worcester State Hospital	

Indicate each item on inventory form which is being continued below.

7.

6. Attendants' Home, built 1906. The Attendants' Home is located east of the Main Hospital Building and is identical to the Nurses' Home, except a brick banding beneath its cornice, a detail not used on the Nurses' Home.

7. Farm House, 365 Plantation Street, built prior to 1896. Marked "Farm House" on twentieth-century atlases, this building is a two and one-half story brick building with an "L" shaped floor plan. The building has a slate-covered hip roof with dormers and ventilator/cupolas. Decoration of the building is limited to its dormers, cornice and a porch along its east wall. It is likely that the building was designed to house farmworkers who were hired to assist in the farming carried out on the hospital property. Between 1896 and 1911 a wing was built on the west side of the original structure.

8. 21, 22, 23 & 24 Hospital Avenue, built 1920's (?). Built for doctors and staff housing, these four houses are of essentially the same plan and design, with variations limited to the second story and roof type. All are built of brick and have rectangular floor plans with center entries (east) and sun porches (south). 21 and 22 are identical to each other and have shingled second stories, low-pitched roofs and Tuscan entry porches. 23 has a brick entry porch, high gambrel roof and shed dormers. 24 has a second story of brick, hip roof with central dormer and brick entry porch. It is likely that all of the four structures were built as single-family houses by the hospital.

9. S.B. Watson Cottage, 297 Belmont Street, built 1851. Originally a one and one-half story, side-hall plan, Greek Revival style cottage, 297 Belmont Street was occupied by S.B. Watson, a farmer, in 1851. Purchased by the state in the 1870's, the house has undergone extensive alterations, presumably to provide housing for part of the hospital staff. Presently, the building has a symmetrical facade (east) on which a center entry is flanked by bay windows. The facade is framed by pilasters and an entablature/cornice. (The original facade was on the structure's south wall and resembled 269 Belmont Street - see below). At the northwest corner of the original 1½ story house is a two-story, gable-roofed addition.

10. Henry Prentice Cottage, 269 Belmont Street, built ca. 1845-51. The Prentice Cottage is an excellent local example of Greek Revival style architecture. First occupied by Henry Prentice, a farmer, the cottage and its farm were acquired by the state in the 1870's. Remaining in nearly original condition, the cottage is a one-and-one-half story frame structure with a side hall floor plan. The house's gabled facade is trimmed with pilasters and low pediments

cont'd.

Staple to Inventory form at bottom

INVENTORY FORM CONTINUATION SHEET

MASSACHUSETTS HISTORICAL COMMISSION
Office of the Secretary, Boston

Community: Worcester	Form No: 92-A-1
Property Name: Worcester State Hospital	

3.

Indicate each item on inventory form which is being continued below.

7.

10 ctd. over the windows. The entry is framed by panelled stiles which support corner blocks containing fretwork, above which is a moulded cap. To the rear of the house is a 1½ story stable, sheathed in broad-and-bottom siding.

Non - contributing buildings

11. Youth Guidance Center, built 1970: a one-story concrete block and brick structure with a flat roof; exterior walls are covered with brick, metal panels and plate glass.

12. Bryan Building, built 1955: a concrete and steel frame building consisting of an eight-story rectangular-plan structure with two four-story wings extending from its south wall (facade); symmetrical in plan and elevation, this structure is faced with red brick and has windows arranged in groups; the building's exterior is without decoration; at the structures southeast corner an elevated walkway provides access to the nearby Main Hospital Building/

13. Service Building, built 1956: a three-story concrete-block structure faced with red brick; the building has a rectangular plan and flat roof; on the building's south wall is a loading bay and platform.

14. New Laundry Building, built 1962: a one-story building of concrete-block construction, faced with red brick; the structure has a rectangular floor plan with one story in the front (south) and two stories at its rear (north) due to a change of ground level; the building is enclosed by a flat roof and has metal-framed windows.

15. Garage 1930's, extended 1960's: a one story- concrete block garage with flat roof.

Significance:

The Worcester State Hospital is located on a tract of more than 200 acres approximately one mile from the center of the city. In constant use as a regional mental hospital since 1877, the property contains buildings related to several phases of its development. The hospital's most imposing building is the Main Hospital Building (1), which is unmatched in Central Massachusetts for the size and complexity of its Victorian Gothic design. More than 1000 feet long, this structure stands high on a hillside with its turrets (for ventilation) and high clock tower visible for several miles distant. This main building was designed initially to

Staple to Inventory form at bottom

cont'd.

INVENTORY FORM CONTINUATION SHEET

MASSACHUSETTS HISTORICAL COMMISSION
Office of the Secretary, Boston

Community: Worcester	Form No: 92-A-1
Property Name: Worcester State Hospital	

4.

Indicate each item on inventory form which is being continued below.

7.

house the hospital's staff and 400 patients, a number which was increased twice during construction until the plan was adapted to 600 patients and building costs exceeded \$1,000,000. At the time of its completion, the hospital's interior was divided into self-contained wards, each of which had a parlor, gallery, dining room, reading room and attendant's room. In addition, the hospital was equipped with a number of private suites; at the rear of the hospital's central administration building was a separate structure containing a chapel/meeting hall (Sargent Hall) and matron quarters. To the rear of the hospital and connected only by enclosed passages were the Laundry Room (2), Boiler House (3), and carpenter shop(4?).

Once opened, the hospital underwent a rapid increase in the number of patients, requiring additions in 1887 and the re-arrangement of wards. As the hospital population increased, separate living quarters were added for the staff which managed the hospital farm(7), part of which was reportedly worked by patient as therapy. Subsequently separate housing was built for attendants (6), nurses (5), and, finally, separate houses were built for resident doctors and staff(8). By 1927, the hospital had achieved a capacity of 2,086 patients, although it had 2224 patients at that time, in addition to several hundred non-resident patients. Since that time, Worcester State Hospital has remained a regional center for mental health treatment, with subsequent new buildings to adapt the property to changing methods of treatment (11 & 12). At present, much of the Main Hospital Building, the Attendant's Home and the Farm House are vacant as a result of the active "de-institutionalization" of many of the hospital's former resident patients.

The land on which the hospital stands is part of a 275-acre tract which was purchased by the Commonwealth from individual owners during the 1870's. Of the buildings which previously stood here, only the Henry Prentice Cottage (10), an excellent and well-preserved Greek Revival style cottage, and the S.B. Watson Cottage (9), now altered, remain as farmhouses pre-dating the hospital. Despite the addition of new buildings and paths, much of the property's nineteenth-century landscape plan remains in the main tree-lined drive (Hospital Avenue), stone gates at Belmont Street, stone wall along Belmont and partially along Plantation Street, cobble-stone wall and stairways north of the Nurses' Home, and in a later driveway (ca. 1895) to the Farm House. Originally, the hospital property extended on the east side of Plantation Street to Lake Quinsigamond; as this area has been built over by other departments of the state in the mid twentieth century, it has not been included in this nomination.

Worcester's largest Victorian institution, Worcester State Hospital (originally known as the State Lunatic Hospital) is the successor to an earlier hospital of 1832-1833 which stood on Summer Street, nearer to Worcester's business district. This earlier hospital, one of the first public mental hospitals

Staple to Inventory form at bottom

cont'd.

INVENTORY FORM CONTINUATION SHEET

MASSACHUSETTS HISTORICAL COMMISSION
Office of the Secretary, Boston

Community: Worcester	Form No: 92-A-1
Property Name: Worcester State Hospital	

5.

Indicate each item on inventory form which is being continued below.

7.

in the country, was located in Worcester after the town offered to purchase a twelve-acre site and to donate it to the state. Opened in 1833 and enlarged at various times, the first hospital had become severely overcrowded and had outgrown its site by the 1870's. Planning for the present hospital was carried out by a board of trustees, made up in part of prominent Worcester citizens, including Henry Chapin (Worcester's second mayor), Thomas Hovey Gage (aphysician), General William S. Lincoln, and John D. Washburn (a United States ambassador to Switzerland). Reflecting local involvement in and donations to the hospital, many of the halls within the Main Hospital Building bear the names of the city's prominent families, such as Salisbury, Washburn, Lincoln, and Sargent (named for Joseph Sargent, a Worcester physician).

Its high architectural quality, well-preserved site and importance as a regional mental hospital make the Worcester State Hospital a property of exceptional historical significance.

Staple to Inventory form at bottom

INVENTORY FORM CONTINUATION SHEET

MASSACHUSETTS HISTORICAL COMMISSION
Office of the Secretary, Boston

6.

Community: Worcester	Form No: 92-A-1
Property Name: Worcester State Hospital	

Indicate each item on inventory form which is being continued below.

7.

Property List

<u>Property</u>	<u>Assessor's Data</u>	<u>Present Owner</u>
Belmont Street	Book 57, p. 4 Lot B--144.64 acres	Commonwealth of Mass. Worcester State Hospital Worcester, Mass.
	Book 57, p. 4 Lot A--75,86 acres	Commonwealth of Mass. University of Mass. Amherst, Mass.

Staple to Inventory form at bottom

Property Worcester Multiple Resource Area (Partial Inventory)

State MA (Worcester) Working Number 8.30.79.2060

TECHNICAL

CONTROL

Photos 383 + 13
Maps 2, 63

HISTORIAN

Excellent multiple resource nomination for the entire city of Worcester. Both the general description & statement of significance & the individual inventory sheets are well done. Each type of property included is well justified, & reasons are listed for not including others at this time (e.g. 3-deckers). Opposition is high. Minor problems with some properties are listed on attached sheets.

Call/Accept
Lightner
10-30-79

ARCHITECTURAL HISTORIAN

Concur with Bruce's comments on 102-L-3, 116-CBD-11, 117-E, and 130-CBD-50 and 44. Integrity and/or boundaries need to be addressed specifically on individual forms. DOUBLE

ARCHEOLOGIST

116-CBD-11 - Destroyed, cannot be listed.
130-CBD-44 - I am not convinced this has lost integrity. See attached.
102-L-3 - Period of significance and categorization of 1 bldg need to be discussed with State.

OTHER

ACCEPT
MURPHY
2/28/80

With 3 exceptions all properties appear to me to meet the criteria and the forms are adequate. ~~Both~~ BOTH TECHNICALLY AND TO DETERMINE SIGNIFICANCE. ALTHOUGH SOME OF THE FORMS DID NOT CONTAIN STRONG STATEMENTS OF SIGNIFICANCE THE RESOURCE CATEGORIES WERE THOROUGHLY DISCUSSED IN THE BODY OF THE NOMINATION; THEREFORE SIGNIFICANCE WAS ESTABLISHED. VBDs WERE NOT NECESSARY BECAUSE

HAER

OF THE SCALE MAPS AND CLEARLY DELINEATED BOUNDARIES. PRECEDENCE WAS MISSING ON SOME PROPERTIES BUT IS NOW INCLUDED AFTER THE 2/11/CORRECTIONS. THE ONLY PROPERTIES THAT I DO NOT RECOMMEND LISTING ARE
✓ 116-CBD-13 - DESTROYED BY FIRE MD - 116 CBD-11
130-CBD-44 - DOES NOT RETAIN INTEGRITY FOR INDIVIDUAL ELIGIBILITY

Inventory _____
Review _____

REVIEW UNIT CHIEF

✓ 102-L-3 I ~~DO NOT~~ ^{AM NOT} CONVINCED ABOUT BOUNDARIES BUT BELIEVE THEY COULD BE OK. ~~BASED~~ ON ADDITIONAL DOCUMENTATION SUBMITTED - I DEFER JUDGEMENT.

Recommend listing all ^{now} properties except these 3. Return 116-CBD-11 to State (not eligible); ~~to discuss further~~ ^{to discuss further w/NR staff + state. DOUBLE}
Return 102-L-3 to state for correction; ^{3/5/80}
HOLD 130-CBD-44 for info from state ^{DOUBLE}

BRANCH CHIEF 3/3/80

KEEPER

Staff conference 3/5/80 - agreed to action as noted below:
Accept with exception of 116-CBD-11 (official notification of fire & demo from State), 102-L-3 (returning to state for revision - also returning 116-CBD-11) and 130-CBD-44 (holding from state)

Soldner
3/5/80

National Register Write-up _____ Send-back _____ Entered MAR 5 1980
Federal Register Entry 2.3.81 Re-submit _____ ^{SEE 3/3/80 REPORT}

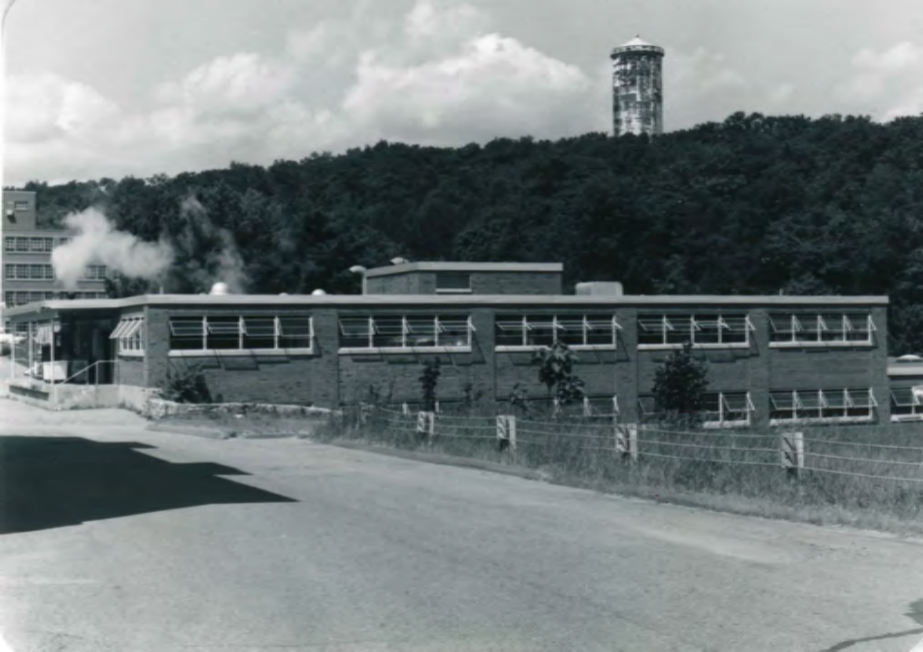

30 AUG 1979

92-A-1
Worcester Asylum
New Laundry
Building - Worcester, MA
South + east elev.



80 AUG 1979

Worcester M.A., MA

92-A-1

Worcester Asylum

near Main

Hospital Building

East elevation



by Berkeley

Prestige Prints

by Berkeley

Prestige Prints

JAN 1978

JAN 1978

30 AUG 1979

92-A-1

Worcester Asylum

365 Plantation

Street Worcester, MA, MA

East elevation



30 AUG 1979

Worcester MA, Ma

92-A-1

~~Worcester Asylum~~

Belmont St
entry gates

South Division



30 AUG 1979

92-A-1
Worcester Asylum
Old laundry
Building Worcester
MA, MA
South elevation



30 AUG 1979

92-A-1

Worcester Asylum

Stable

Worcester MA, Ma

South elevation



92-A-1
Worcester MRA, Ma
Attendants'
Worcester Asylum
Home - west
Elevation

30 AUG 1979



30 AUG 1979

9Z-A-1

Nurses' Home

Worcester, MA, Ma

east elevation

Worcester Asylum



3 02 AUG 1979

92-A-1
Worcester, MA 4, and
Service Bldg.
Worcester Asylum
South & east
elevations



30 AUG 1979

Worcester Asylum

92-A-1

Bryan Building
Worcester M.L.A. Mm

South-west
election



by Berkeley

Prestige Prints

JAN 1978

JAN 1978

JAN

Worcester, MA, MA
92-A-1
Worcester Asylum
Main Building
Clock Tower
south elevation

80 AUG 1979



30 AUG 1979

92-A-1
Worcester MA, Ma
Main Bldg.
Worcester Asylum
South & east
elevations



30 AUG 1979

Worcester Asylum
92-A-1
Worcester MA, MA
Pavilion - Main
Building -
South + east elev.



90 AUG 1979

Worcester Asylum

92-A-1

Worcester MA
MA

detail - main

Building

South elevation



30 AUG 1979

Worcester Asylum

92-A-1

Worcester MRA MA

View - west

wing of main

Hospital - South
elevation



30 AUG 1979

Worcester Asylum
92-A1
Worcester MA
Worc. State Hospital
main Bldg ca 1880
South elevation



by Berkeley

Prestige Prints

1978

JAN 1978

JAN 1978

30 AUG 1979

Worcester Asylum

92-A-1

Worcester MRA #

297 Belmont St

South + east
elevations



30 AUG 1979

Worcester MA, MA

92-A-1

22 Hospital
Worcester Asylum Ave.

East elevation



80 AUG 1979

92-A-1

Worcester Asylum

Youth Guidance
Center
East location

Worcester MRA, Ma



by Berkeley

Prestige Prints

JAN 1978

JAN 1978

Worcester Ass. 10/19

92-A-1

269 Belmont St
Worcester MA, MA

South elevation

80 AUG 1979



Mapped, edited, and published by the Geological Survey
Control by USGS, NOS/NOAA, and Massachusetts Geodetic Survey
Topography by planetable survey 1935. Revised from aerial
photographs taken 1972. Field checked 1973
Polyconic projection, 1927 North American datum
10,000-foot grid based on Massachusetts coordinate system,
mainland zone
1000-metre Universal Transverse Mercator grid,
zone 19
Fine red dashed lines indicate selected fence and field lines where
generally visible on aerial photographs. This information is unchecked
Red tint indicates areas in which only landmark buildings are shown
Areas covered by dashed light-blue pattern are subject
to controlled inundation by Hodges Village Dam

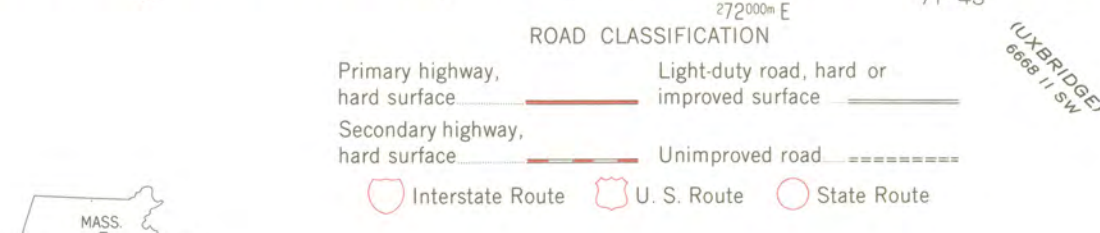
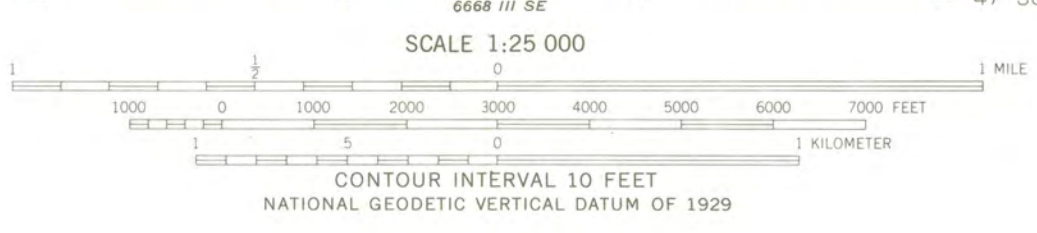
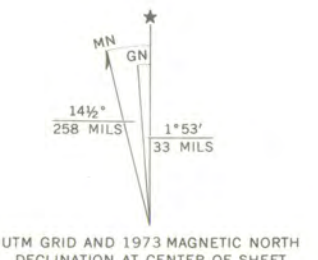

WORCESTER SOUTH, MASS.
N4207.5—W7145/7.5
1973
AMS 6668 III NE—SERIES V814

30 AUG 1979

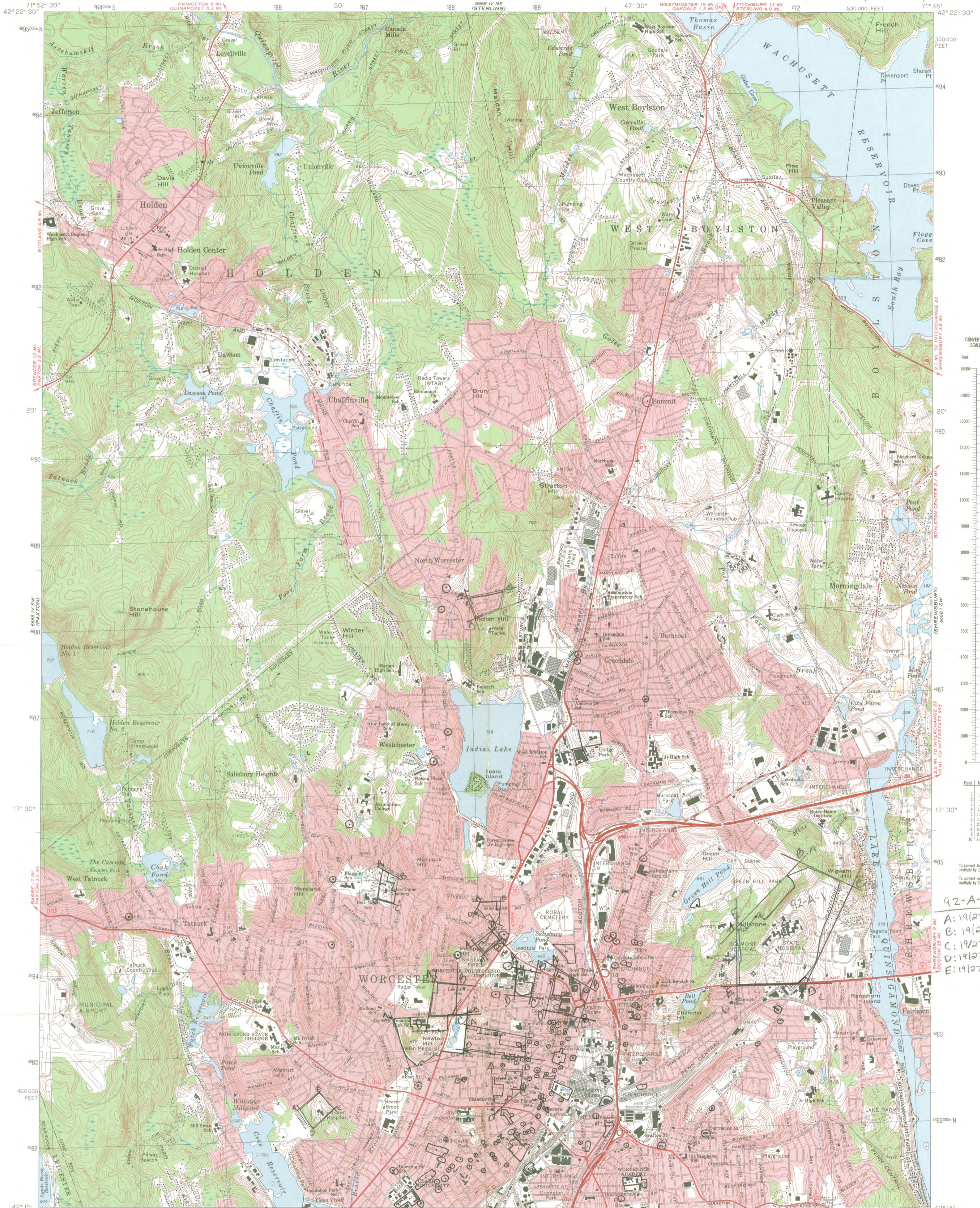

92-A-1
A: 19121725/4685045
B: 19121735/4687755
C: 19121745/4683645
D: 19121755/4683045
E: 19121765/4683310

Mapped, edited, and published by the Geological Survey
Control by USGS, NOS/NOAA, and Massachusetts Geodetic Survey
Topography by planetable surveys 1941. Revised from aerial
photographs taken 1972. Field checked 1974
Polyconic projection, 1927 North American datum
10,000-foot grid based on Massachusetts coordinate system,
mainland zone
1000 metre Universal Transverse Mercator grid,
zone 19
Fine red dashed lines indicate selected fence and field lines where
generally visible on aerial photographs. This information is unchecked
Red tint indicates areas in which only landmark buildings are shown

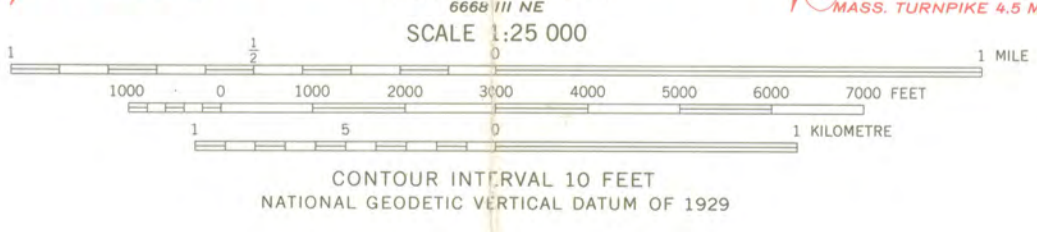

ROAD CLASSIFICATION
Primary highway, hard surface
Secondary highway, hard surface
Light-duty road, hard or improved surface
Unimproved road
Interstate Route
U. S. Route
State Route

THIS MAP COMPLIES WITH NATIONAL MAP ACCURACY STANDARDS
FOR SALE BY U. S. GEOLOGICAL SURVEY, RESTON, VIRGINIA 22092
A FOLDER DESCRIBING TOPOGRAPHIC MAPS AND SYMBOLS IS AVAILABLE ON REQUEST

WORCESTER NORTH, MASS.
N4215—W7145/7.5

1974
AMS 6668 IV SE—SERIES V814

30 AUG 1979
MAR 5 1980

SEE MAP SHEET 80

WORCESTER STATE
HOSPITAL FORM 92-A-1

N 467000
E 528,000

SEE MAP SHEET 93

COMPILED BY PHOTOGRAMMETRIC METHODS

moore survey & mapping corp.

CONTROL BY MASS. GEODETIC SURVEY, U.S.C. & G.S., & M.S.&M. CORP.

UPDATED BY _____ DATE: _____

THIS MAP REPRODUCED FROM MAPPING MEETING NATIONAL MAP ACCURACY STANDARDS AT A SCALE OF 1"=200'

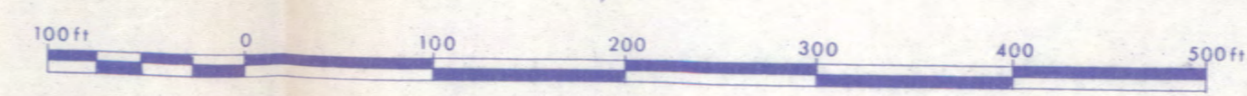

500 FOOT GRID BASED ON MASS. RECTANGULAR COORDINATE SYSTEM

INDEX	
68	69
80	92
92	93

SHREWSBURY
WORCESTER

LAKE QUINSIGAMOND

CITY OF WORCESTER
MASSACHUSETTS

PLANIMETRIC BASE MAP

PROJECT: M.S.M. 2517

DATE OF PHOTOGRAPHY: _____
SHEET 81 OF 220 SHEETS



N 469,000
E 531,000

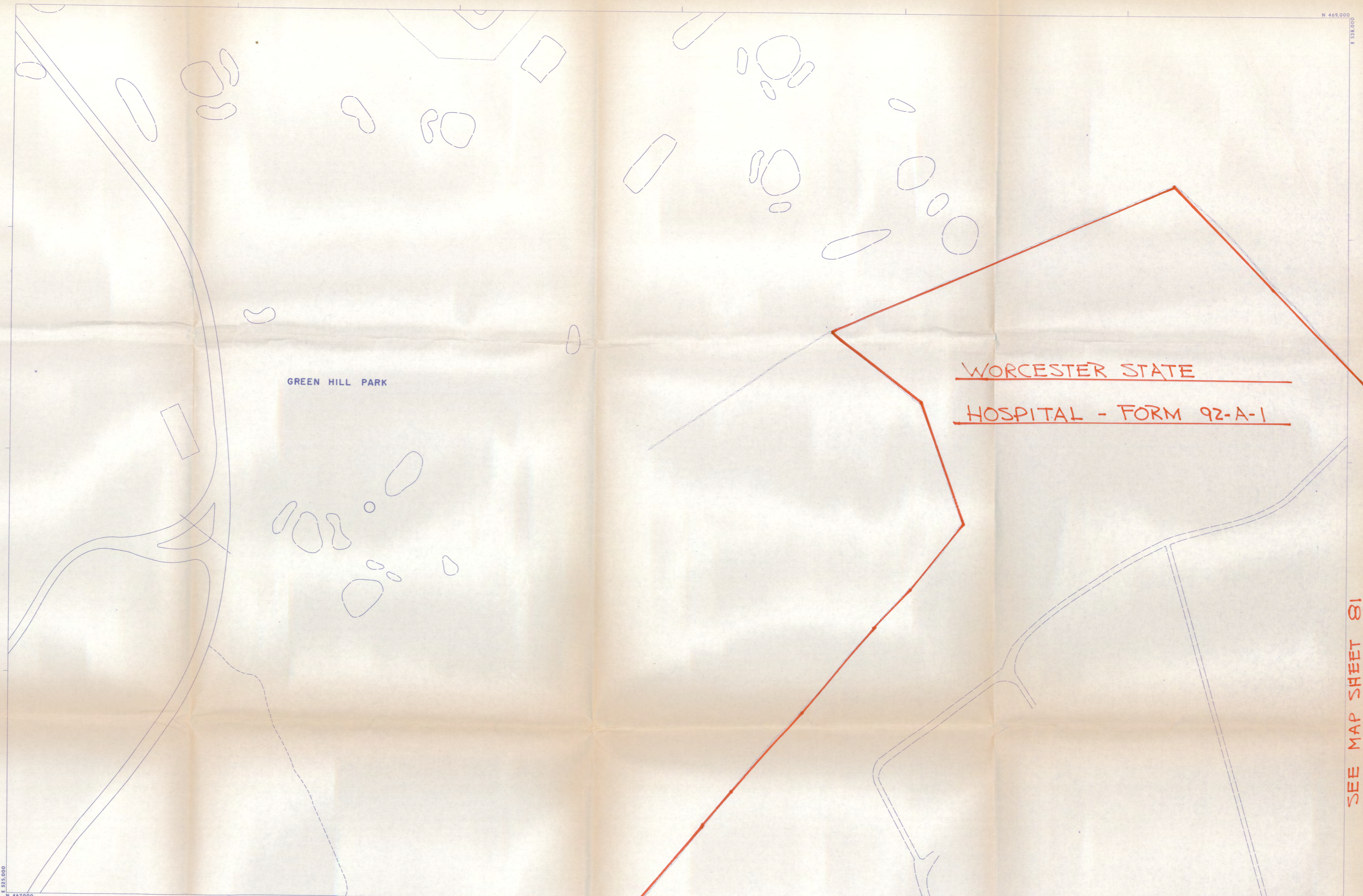

GREEN HILL PARK

WORCESTER STATE
HOSPITAL - FORM 92-A-1

SEE MAP SHEET 92

SEE MAP SHEET 81

COMPILED BY PHOTOGRAMMETRIC METHODS

moore survey & mapping corp.

CONTROL BY MASS. GEODETIC SURVEY, U.S.C. & G.S., & M.S.&M. CORP.

UPDATED BY _____, DATE: _____

THIS MAP REPRODUCED FROM MAPPING MEETING NATIONAL MAP ACCURACY STANDARDS AT A SCALE OF 1"=200'



500 FOOT GRID BASED ON MASS. RECTANGULAR COORDINATE SYSTEM

INDEX

67	68	69
79		81
91	92	93

CITY OF WORCESTER MASSACHUSETTS

PLANIMETRIC BASE MAP

PROJECT: M.S.M. 2517

DATE OF PHOTOGRAPHY: _____

SHEET 80 OF 220 SHEETS



SEE MAP SHEETS 80+81

N 462000
E 538,000

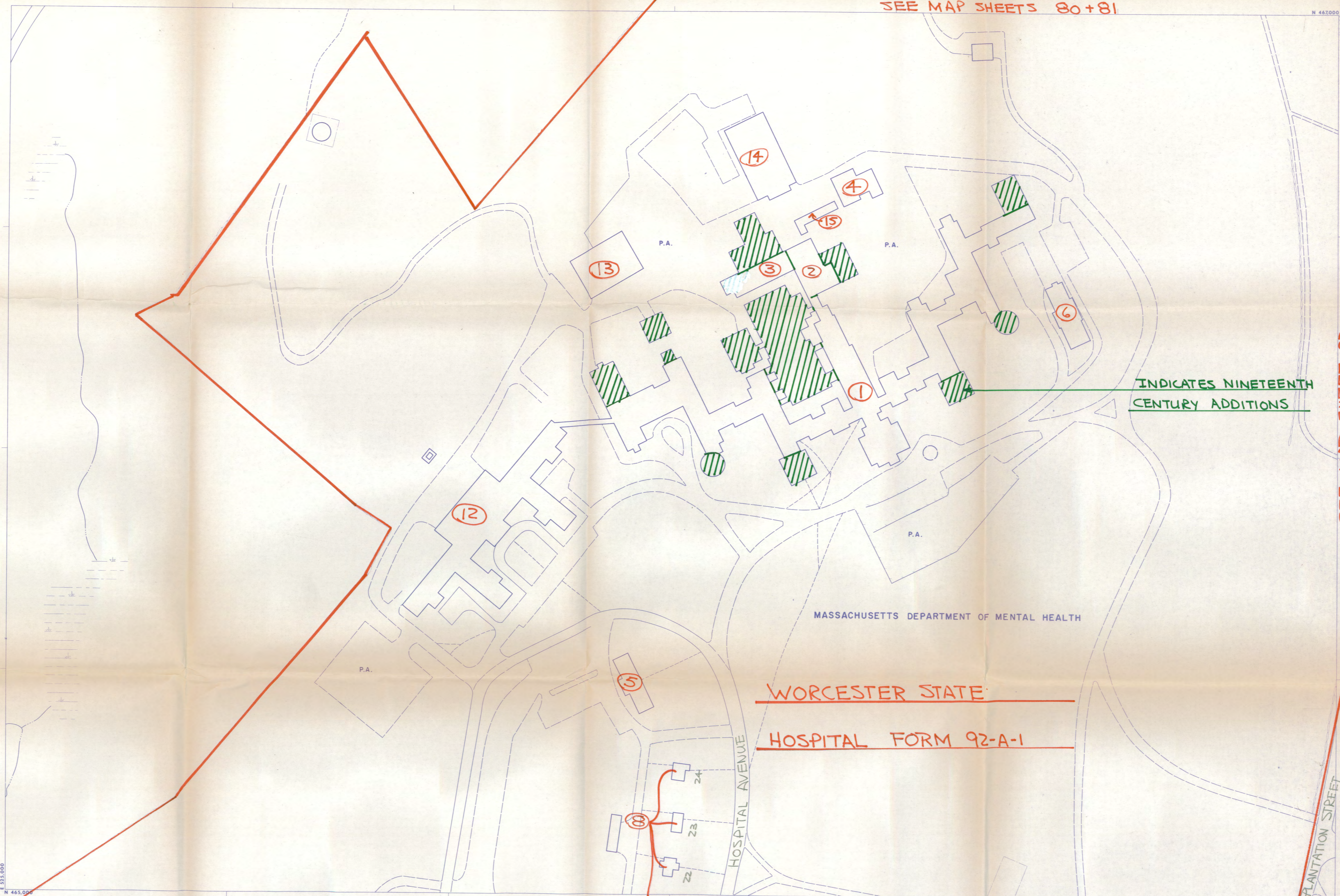

INDICATES NINETEENTH CENTURY ADDITIONS

WORCESTER STATE
HOSPITAL FORM 92-A-1

SEE MAP SHEET 105

COMPILED BY PHOTOGAMMETRIC METHODS

moore survey & mapping corp.

CONTROL BY MASS. GEODETIC SURVEY, U.S.C. & G.S., & M.S. & M. CORP.

UPDATED BY _____, DATE: _____

THIS MAP REPRODUCED FROM MAPPING MEETING NATIONAL MAP ACCURACY STANDARDS AT A SCALE OF 1"=200'

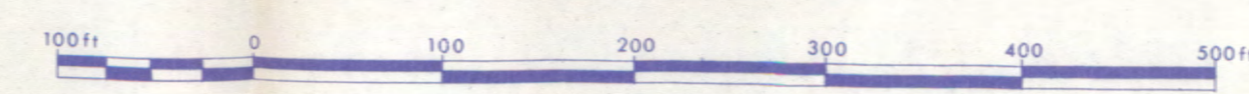

500 FOOT GRID BASED ON MASS. RECTANGULAR COORDINATE SYSTEM

INDEX		
79	80	81
91	92	93
104	105	106

CITY OF WORCESTER MASSACHUSETTS

PLANIMETRIC BASE MAP

PROJECT: M.S.M. 2517

DATE OF PHOTOGRAPHY: _____

SHEET 92 OF 220 SHEETS



SEE MAP SHEET 93

THE AREA SHOWN IS

INDICATES NINETEENTH
CENTURY ADDITIONS

WORCESTER ST.

WORCESTER ST.

THE AREA SHOWN IS

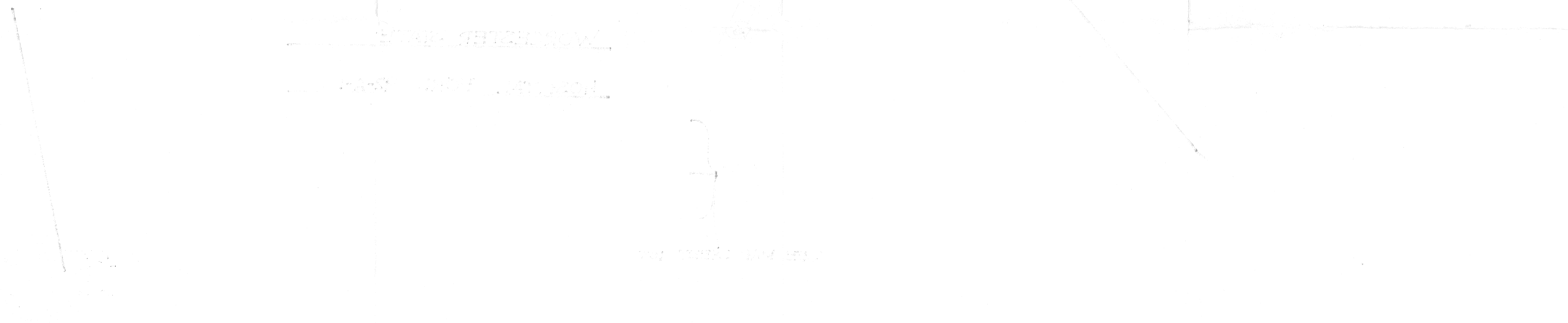

SEE MAP SHEET 81

WORCESTER STATE
HOSPITAL - FORM 92-A-1

SEE MAP SHEET 92

PLANTATION STREET

BELMONT STREET

UNIVERSITY OF MASSACHUSETTS
MEDICAL SCHOOL

REGATTA POINT
STATE PARK

LAKE QUINSIGAMOND

SHREWSBURY
WORCESTER

E 528,000
N 465,000

N 462,000
E 531,000

COMPILED BY PHOTOGRAMMETRIC METHODS

moore survey & mapping corp.

CONTROL BY MASS. GEODETIC SURVEY, U.S.C. & G.S., & M.S. & M. CORP.

UPDATED BY _____ DATE: _____

THIS MAP REPRODUCED
FROM MAPPING MEETING
NATIONAL MAP ACCURACY
STANDARDS AT A SCALE
OF 1"=200'

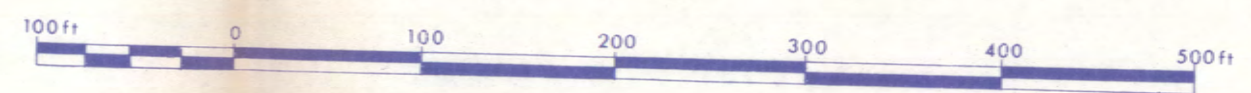

500 FOOT GRID BASED ON
MASS. RECTANGULAR COORDINATE SYSTEM

INDEX	
80	81
92	106
105	107

CITY OF WORCESTER
MASSACHUSETTS

PLANIMETRIC BASE MAP

PROJECT: M.S.M. 2517

DATE OF PHOTOGRAPHY: 4-22-75

SHEET 93 OF 220 SHEETS



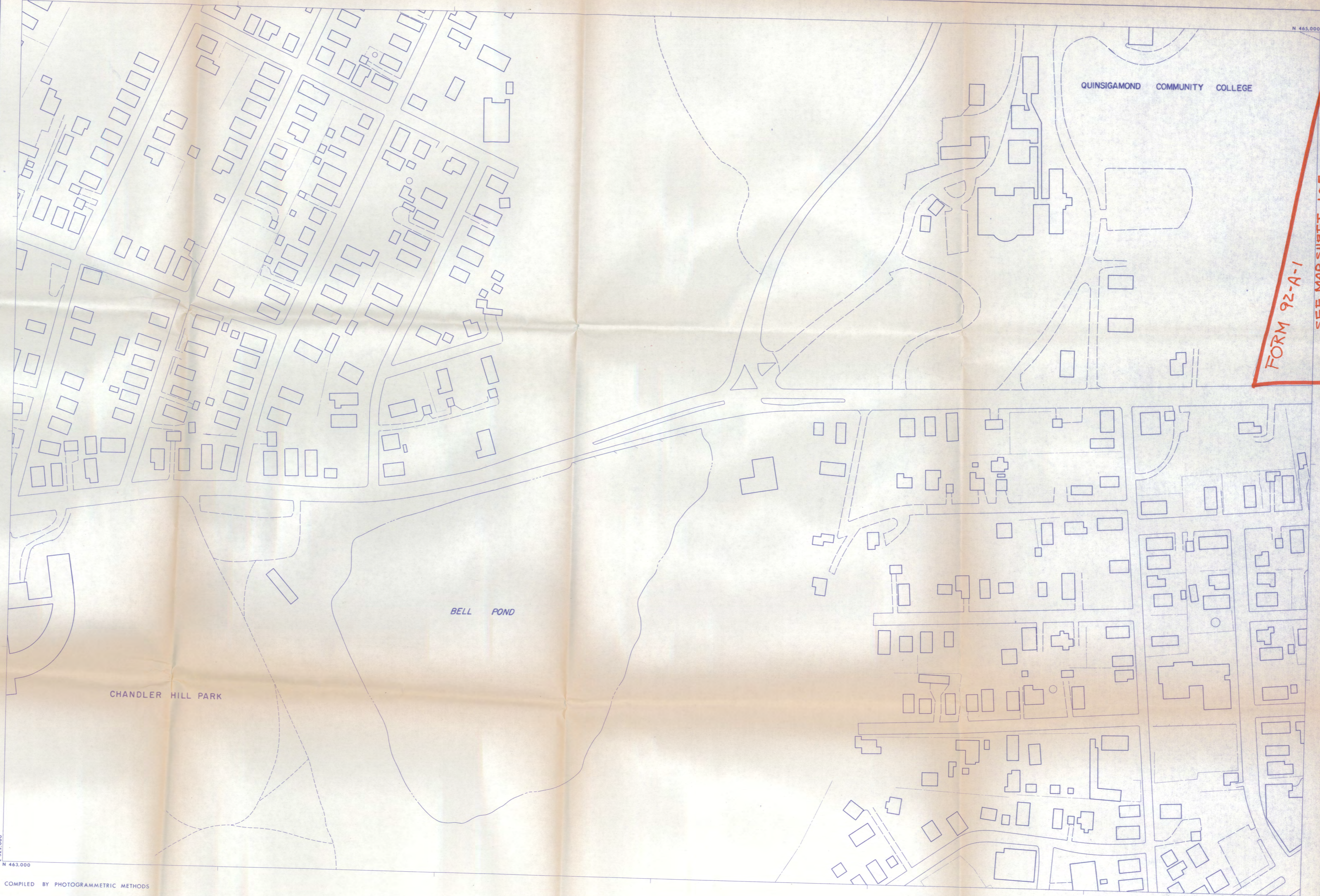

N 465,000
E 535,000

E 522,000
N 463,000

COMPILED BY PHOTOGRAMMETRIC METHODS

moore survey & mapping corp.

CONTROL BY MASS. GEODETIC SURVEY, U.S.C. & G.S., & M.S. & M. CORP.

UPDATED BY _____ DATE: _____

THIS MAP REPRODUCED FROM MAPPING MEETING NATIONAL MAP ACCURACY STANDARDS AT A SCALE OF 1"=200'



500 FOOT GRID BASED ON MASS. RECTANGULAR COORDINATE SYSTEM

INDEX		
90	91	92
103		105
117	118	119

CITY OF WORCESTER
MASSACHUSETTS

PLANIMETRIC BASE MAP

PROJECT: M.S.M. 2517

DATE OF PHOTOGRAPHY: 4-28-79
SHEET 104 OF 220 SHEETS



FORM 92-A-1
SEE MAP SHEET 105

Please refer to the map in the
Multiple Property Cover Sheet
for this property

Multiple Property Cover Sheet Reference Number: 64000304

Worcester Multiple Resource Center
9-11-79

YP
and - grants info



The Commonwealth of Massachusetts
Department of Mental Health

(MA)

DAVID J. MYERSON M.B.

WORCESTER STATE HOSPITAL
WORCESTER, MASS. 01604

October 29, 1979

Mr. Charles A. Herrington
Acting Keeper of the National Register
United States Department of the Interior
Heritage Conservation and Recreation Service
Washington, D.C. 20240

Dear Mr. Herrington:

We were please to receive your letter and we refer to number 663. We are pleased to state that we would like the Clock Tower Building listed in the National Register of historical places. This is an old building, build in 1878. This building is made of granite and block cement, and five stories high. At the entrance is an unusual tower holding a clock, which sits upon the top of a hill overlooking the Lake Quinsigamond Valley. This tower can be seen from miles around and, upon request, photographs can be submitted. The interior of the building is extremely ornate with high wood doors and brass hardware. Please send us any information which you need or which we may need, especially the standards for fixing up old buildings.

Since the building belongs to the Commonwealth of Massachusetts, perhaps we will be unable to take advantage of the Tax Reform Act benefits. However, we are more than anxious to secure restoration funds which may be available for the preservation and renovation of the Clock Tower in the building.

Sincerely,
Charles W. Smith amt

Charles W. Smith
Steward

CWS/amt

Commonwealth of Massachusetts
Worcester State Hospital
Worcester, MA

Re: [Worcester Multiple Resource Area
Belmont Street]

es 11/23

THE NATIONAL REGISTER OF HISTORIC PLACES	
NOV 9 1979	
DATE REC'D	_____
INDIVIDUAL RESPONSE (ATTACHED)	_____
INFORMATIVE MATERIAL SENT	_____
TELEPHONE CALL (ATTACHED)	_____
DATE ACTION TAKEN	_____
INITIALS	_____

[Faint, mostly illegible text, likely bleed-through from the reverse side of the page. Some words like "action", "material", and "response" are faintly visible.]

[Handwritten signature or initials, possibly "John M. ..."]

[Large, faint, illegible text at the bottom of the page, possibly a stamp or header from another document.]