

KENTUCKY HISTORIC RESOURCES
Individual Inventory Form

Resource # TR-22
TRIGG County

1. Name of Resource:
John McCaughan House

2. Original Owner:
John McCaughan

3. Other Names:
None

4. Prehistoric Site Building Object
Historic Site Structure Other

5. Location:
east side KY 276, 2.2 miles north of
U.S. 68, near Cadiz

6. Owner's Name:
Mr. & Mrs. Herbert Sizemore [P]

7. Owner's Address:
Route #1, Box 277
Cadiz, Kentucky 42211

8. Evaluation: [G]

9. Recognition & Date:
Nat.Landmark Local Landmark
Nat.Register HABS/HAER
Highway Marker KY Inventory
KY Landmark Certificate

10. N.R.Status & Date:

11. N.R.Group:
District Name: []
Mult.Resource Area: []
Thematic Name: Early Stone Buildings []

12. Historical Theme:
Primary: Architecture [030]
Secondary: Settlement [040]
Other: []

13. Statement of Significance:
Excellent two-story, dry-stone house of
type commonly built by Scotch-Irish in
the Bluegrass, but only one of this type
found in western Kentucky.
[]

14. History:
House built for John McCaughan about 1814.
McCaughan was born in Ireland in 1773,
came to America in 1792, received com-
mission as surveyor in Kentucky territory.
A Presbyterian, he married Hannah Johnston
from Blount County, Tennessee, in 1802.
In 1831 he freed his slaves and moved
to Ohio.

15. Source of historical information and/or contact
person:
Trigg County Sesquicentennial Program

16. Date:
Original Building ca. 1814 [8]
Addition []

17. Style:
Federal [21]
[]

18. Architect/Builder:
Unknown

19. No. of Stories: 2 plus [2.0]

20. Original Floor Plan:
Hall-Parlor [HP]

21. Single Pile Double Pile N.A.

22. Roof Form & Material: Original
Gable Not Original

23. Structural Material:
Stone [S]

24. Exterior Material: Stone [S]
[]

25. Foundation Material:
Stone [S]

26. Major Alterations: None
Moved/Rebuilt Other
Additions

27. Special Features:

28. Outbuildings:
None [0]

29. Original Function:
Residence [01A]

30. Present Use:
Residence [01A]

31. Condition:
Excellent [F]

32. Endangered: Yes
No

33. Attach Photos:
Roll: 6 Photo Nos: 0-9 No. of Slides:

34. Prepared by: Carolyn Murray-Wooley

35. Organization: Kentucky Heritage Council

36. Date: December 1983

37. New Survey Resurvey

KENTUCKY HISTORIC RESOURCES
Individual Inventory Form

Resource # TR-22

38. UTM Point of Primary Building:	Zone	Easting	Northing	39. G.I.S. Mod.	[]
Quadrant: Cobb	1 6	4 3 2 6 4 0	4 0 8 4 0 6 0	40. Coordi.Accuracy	[]

41. UTM Points of Boundary (for N. R. eligible sites only):

A. -----	D. -----
B. -----	E. -----
C. -----	F. -----

42. Total Acreage in Present Property: 43. Acreage included in proposed N.R. boundary: ca. 16.6

44. Site Plan (and boundary description and justification for N.R. sites):

See Attached Site Plan

45. Description and House Plan:

Three-bay, two-story, dry-stone house. Interior chimneys each gable end. Masonry in irregular courses, quoined at corners; 9 - 11 member voussoirs with skewbacks and without keystones. Walls are very hard light-gray limestone (Meramec series, Upper Mississippian); voussoirs softer, golden color (may be the Mooretown formation found intruded in Meramec); solid lintels above openings on second floor. Original mortar flat, high proportion of sand. Top plate returned on end. House probably built to face creek—quality of masonry best on north side. Enclosed corner stair arises from hall behind S door, space taken from parlor.

Windows, doors, and frames have been replaced, rough-hewn ceiling joists exposed, and mantels removed. One-story frame wing built on east end which is not unharmonious with the house. Cellar access rebuilt on west end.

House located in lovely wooded creek valley.

KENTUCKY HISTORIC RESOURCE INVENTORY SUPPLEMENT
BOUNDARY AND LOCATION INFORMATION

Historic Property Name John McLaughlin house Site # Tr 22
Multiple Resource/Thematic Nomination Title _____

U.T.M. Coordinates - List multiple UTM's if property is ten or more acres.

A. 16 432830 4084160 D. 16 432600 4084120
B. 16 432865 4083900 E. _____
C. 16 432630 4083910 F. _____

Verbal Boundary Description ca 16.6 acres

Beginning at A, at the UTM NE of the house, thence S 900 ft to B, thence E 800 ft to C at the road, thence N with road 750 ft to D, thence E 900 ft to the beginning. No other buildings remain. Outside this boundary, the once cleared farm land has reforested.

Sketch of Site Plan (Showing outbuildings, structures, landscape features and the site boundary as described above.)

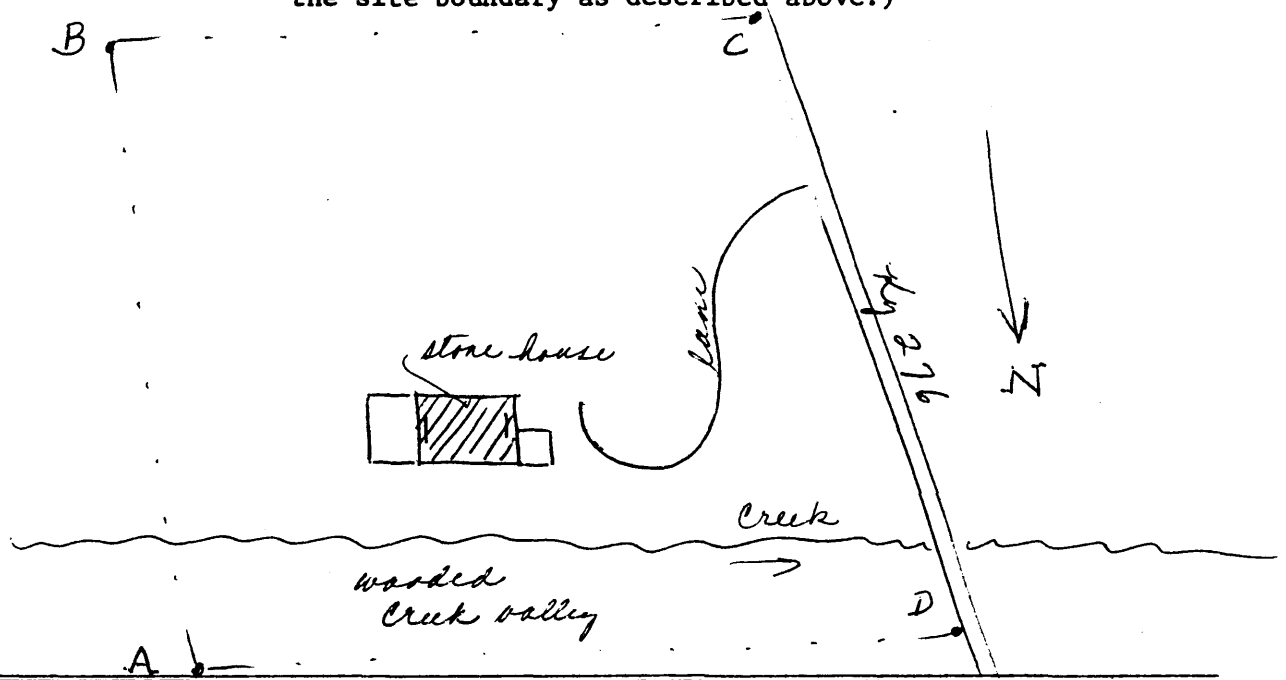

Official Courthouse Property Reference:

Trigg County Courthouse