

909

United States Department of the Interior
National Park Service

JUN 16 1989

National Register of Historic Places
Registration Form

NATIONAL
REGISTER

This form is for use in nominating or requesting determinations of eligibility for individual properties or districts. See instructions in *Guidelines for Completing National Register Forms* (National Register Bulletin 16). Complete each item by marking "x" in the appropriate box or by entering the requested information. If an item does not apply to the property being documented, enter "N/A" for "not applicable." For functions, styles, materials, and areas of significance, enter only the categories and subcategories listed in the instructions. For additional space use continuation sheets (Form 10-900a). Type all entries.

1. Name of Property

historic name Rorex, John M., House
other names/site number Armstrong House (BL-885)

2. Location

street & number At the junction of Brick Mill Road and Old Niles N/A not for publication
city, town Ferry Road - Maryville vicinity
state Tennessee code TN county Blount code 009 zip code 37801

3. Classification

Ownership of Property	Category of Property	Number of Resources within Property	
<input checked="" type="checkbox"/> private	<input checked="" type="checkbox"/> building(s)	Contributing	Noncontributing
<input type="checkbox"/> public-local	<input type="checkbox"/> district	<u>2</u>	<u>2</u> buildings
<input type="checkbox"/> public-State	<input type="checkbox"/> site	_____	_____ sites
<input type="checkbox"/> public-Federal	<input type="checkbox"/> structure	_____	_____ structures
	<input type="checkbox"/> object	<u>2</u>	<u>2</u> objects
			Total

Name of related multiple property listing:
Hist. & Arch. Resources of Blount Co.

Number of contributing resources previously listed in the National Register 0

4. State/Federal Agency Certification

As the designated authority under the National Historic Preservation Act of 1966, as amended, I hereby certify that this nomination request for determination of eligibility meets the documentation standards for registering properties in the National Register of Historic Places and meets the procedural and professional requirements set forth in 36 CFR Part 60. In my opinion, the property meets does not meet the National Register criteria. See continuation sheet.

Herbert L. Byrum 6/8/89
Signature of certifying official Date
Deputy SHPO, Tennessee Historical Commission
State or Federal agency and bureau

In my opinion, the property meets does not meet the National Register criteria. See continuation sheet.

Signature of commenting or other official Date

State or Federal agency and bureau

5. National Park Service Certification

I, hereby, certify that this property is:

- entered in the National Register. See continuation sheet.
- determined eligible for the National Register. See continuation sheet.
- determined not eligible for the National Register.
- removed from the National Register.
- other, (explain:)

Herbert L. Byrum 7/25/89
Entered in the National Register Date of Action

Signature of the Keeper

Date of Action

6. Function or Use

Historic Functions (enter categories from instructions)

DOMESTIC/Single Dwelling
DOMESTIC/Secondary Structure

Current Functions (enter categories from instructions)

DOMESTIC/Single Dwelling
DOMESTIC/Secondary Structure**7. Description**Architectural Classification
(enter categories from instructions)OTHER/I-House/Italianate

Materials (enter categories from instructions)

foundation Brickwalls Weatherboardroof Metal Standing Seamother Wood

Describe present and historic physical appearance.

The John M. Rorex House is a two-story frame, 3 bay, I-House residence with Italianate influences built ca. 1875. The house has weatherboard siding, a brick foundation, gable roof of metal standing seam and exterior end brick chimneys. On the main (N) and (E) facades is a one story porch with ca. 1920 tapered frame posts on brick piers. The main entrance has an original four panel door with upper arched panels and an enclosed arched transom. Windows are original six-over-six arched sash with original shutters and wood sills. Some windows in the one-story ell have six-over-six replacement windows and three-over-one vertical light sash from ca. 1920. Doors on the east facade are ca. 1920 glass and frame additions. The rear ell has an original interior brick chimney and a one-story ca. 1920 shed roof addition on the rear facade.

The interior was built in a central hall plan and retains a milled newel post and square balusters on the staircase and an original mantle displays Greek Revival influences such as Doric pilasters. No interior photographs were possible.

At the rear of the house are three outbuildings: 1. One-story smokehouse built ca. 1875 is of both timber and balloon frame construction with main joists pegged together. The building has a stone foundation, gable roof of metal standing seam and weatherboard siding (C); 2. One-story woodshed built ca. 1920 with a shed roof and weatherboard siding (NC); 3. One-story gable roof frame shed with vertical board siding built ca. 1910 (NC). The property is sited on a hill overlooking Little Baker Creek and the Brick Mill site. It was originally in the center of the Brick Mill community but few buildings remain extant near the property.

8. Statement of Significance

Certifying official has considered the significance of this property in relation to other properties:

nationally statewide locally

Applicable National Register Criteria A B C D

Criteria Considerations (Exceptions) A B C D E F G N/A

Areas of Significance (enter categories from instructions)

Architecture

Period of Significance

ca. 1875

Significant Dates

ca. 1875

Cultural Affiliation

N/A

Significant Person

N/A

Architect/Builder

Unknown

State significance of property, and justify criteria, criteria considerations, and areas and periods of significance noted above.

The John M. Rorex House is significant under criterion C as a fine example of a late 19th century I-House with Italianate detailing. The house is one of only a few rural properties which display Italianate influences such as its arched windows. The house retains its original form and design and has not been significantly altered.

This residence was built ca. 1875 for John M. Rorex who owned the house and farm consisting of 200 acres. Rorex also operated the nearby Brick Mill in the 1880s and 1890s and is listed in a state directory of 1891 as operating a flour mill in the community. Rorex owned this property until 1902 when it was sold to Mary Armstrong at auction for \$3,000. The house remained in the Armstrong family until 1953 when it was sold to the Kimbrough family. In recent years there have been several owners who have made some modifications but the original plan and design of the house has not been altered.

See continuation sheet

9. Major Bibliographical References

Blount County Deed Records. 1800 - 1989. Blount County Courthouse, Maryville, Tennessee.

Burns, Inez E. History of Blount County, Tennessee: From War Trail to Landing Strip. Tennessee Historical Commission, Mary Blount Chapter DAR, 1957.

Morgan, John. Blount County Cultural Resource Survey. Tennessee Historical Commission, Nashville, Tennessee.

See continuation sheet

Previous documentation on file (NPS): N/A

- preliminary determination of individual listing (36 CFR 67) has been requested
- previously listed in the National Register
- previously determined eligible by the National Register
- designated a National Historic Landmark
- recorded by Historic American Buildings Survey # _____
- recorded by Historic American Engineering Record # _____

Primary location of additional data:

- State historic preservation office
- Other State agency
- Federal agency
- Local government
- University
- Other

Specify repository: _____

10. Geographical Data

Acreage of property 1.63 acres.

UTM References

A

1	6	7	6	2	0	8	0	3	9	4	9	7	2	0
Zone				Easting				Northing						

B

Zone				Easting				Northing						

C

--	--	--	--	--	--	--	--	--	--	--	--	--	--	--

D

--	--	--	--	--	--	--	--	--	--	--	--	--	--	--

Binfield Quad

See continuation sheet

Verbal Boundary Description

The boundary for the Rorex House is illustrated on accompanying Blount County tax map 100, lot 67.14, which is drawn at a scale of 1" = 400'.

See continuation sheet

Boundary Justification

The boundary for the Rorex House includes the entire lot historically associated with the property.

See continuation sheet

11. Form Prepared By

name/title Philip Thomason
organization Thomason and Associates date 3/30/89
street & number P.O. Box 121225 telephone 615-383-0227
city or town Nashville state TN zip code 37212

**United States Department of the Interior
National Park Service**

**National Register of Historic Places
Continuation Sheet**

Photographs
Section number _____ Page 1 Hist. and Arch. Resources of Blount Co.

John M. Rorex House
Brick Mill Rd., Maryville vic., Blount County, TN
Photographs By: Thomason and Assoc.
Date: Fall, 1988
Location of Neg: THC

View: West facade.
Photo # 1

View: North and east facades.
Photo # 2

View: South facade.
Photo # 3

View: Shed.
Photo # 4

View: Shed.
Photo # 5

View: Smokehouse.
Photo # 6

885 — JOHN M. ROREX
HOUSE

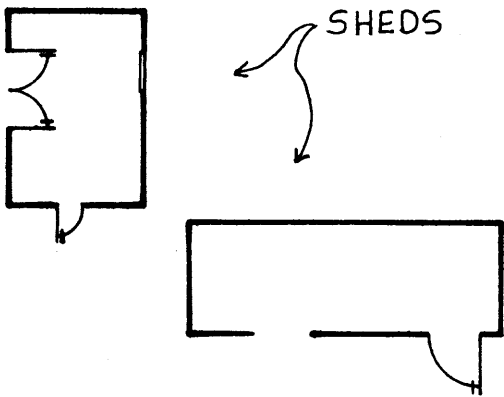

SHEDS

↑
PROPERTY SLOPES DOWN
TO A RIVER

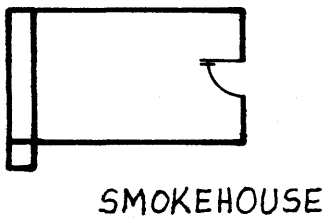

SMOKEHOUSE

