

**United States Department of the Interior
Heritage Conservation and Recreation Service**

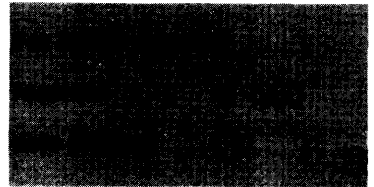

**National Register of Historic Places
Inventory—Nomination Form**

See instructions in *How to Complete National Register Forms*
Type all entries—complete applicable sections

1. Name

historic Grevenberg House

and/or common Same

2. Location

street & number City Park, Sterling Road not for publication

city, town Franklin vicinity of congressional district 3rd - David Treen

state Louisiana code 022 county St. Mary code 101

3. Classification

Category	Ownership	Status	Present Use	
<input type="checkbox"/> district	<input checked="" type="checkbox"/> public	<input checked="" type="checkbox"/> occupied	<input type="checkbox"/> agriculture	<input checked="" type="checkbox"/> museum
<input checked="" type="checkbox"/> building(s)	<input type="checkbox"/> private	<input type="checkbox"/> unoccupied	<input type="checkbox"/> commercial	<input type="checkbox"/> park
<input type="checkbox"/> structure	<input type="checkbox"/> both	<input type="checkbox"/> work in progress	<input type="checkbox"/> educational	<input type="checkbox"/> private residence
<input type="checkbox"/> site	Public Acquisition	Accessible	<input type="checkbox"/> entertainment	<input type="checkbox"/> religious
<input type="checkbox"/> object	<input type="checkbox"/> in process	<input checked="" type="checkbox"/> yes: restricted	<input type="checkbox"/> government	<input type="checkbox"/> scientific
	<input type="checkbox"/> being considered	<input type="checkbox"/> yes: unrestricted	<input type="checkbox"/> industrial	<input type="checkbox"/> transportation
		<input type="checkbox"/> no	<input type="checkbox"/> military	<input type="checkbox"/> other:

4. Owner of Property

name City of Franklin

street & number Municipal Building, 319 Willow Street

city, town Franklin vicinity of state Louisiana

5. Location of Legal Description

courthouse, registry of deeds, etc. St. Mary Parish Courthouse

street & number Main Street

city, town Franklin state Louisiana

6. Representation in Existing Surveys

title LA Historic Sites Survey has this property been determined eligible? yes no

date 1979 federal state county local

depository for survey records State Historic Preservation Office

city, town Baton Rouge state Louisiana

7. Description

Condition

excellent
 good
 fair

deteriorated
 ruins
 unexposed

Check one

unaltered
 altered

Check one

original site
 moved date _____

Describe the present and original (if known) physical appearance

The Grevemberg House is set in a municipal children's park in an early 20th century residential area of Franklin. The house has a two-story, quatre style Corinthian temple form with a symmetrical pair of one-story side wings. The temple portion has a side hall, double parlor plan, with a grand stair which has a heavy turned newel post. Windows and doors are set in simple frames with moldings built up of multiple square cut boards and pediment shaped tops. It is unclear whether the downstairs parlors were originally one space, but they are today. This large oblong room has two stark black marble mantels and a pair of front windows set under a single cornice.

8. Significance

Period	Areas of Significance—Check and justify below			
<input type="checkbox"/> prehistoric	<input type="checkbox"/> archeology-prehistoric	<input type="checkbox"/> community planning	<input type="checkbox"/> landscape architecture	<input type="checkbox"/> religion
<input type="checkbox"/> 1400-1499	<input type="checkbox"/> archeology-historic	<input type="checkbox"/> conservation	<input type="checkbox"/> law	<input type="checkbox"/> science
<input type="checkbox"/> 1500-1599	<input type="checkbox"/> agriculture	<input type="checkbox"/> economics	<input type="checkbox"/> literature	<input type="checkbox"/> sculpture
<input type="checkbox"/> 1600-1699	<input checked="" type="checkbox"/> architecture	<input type="checkbox"/> education	<input type="checkbox"/> military	<input type="checkbox"/> social/ humanitarian
<input type="checkbox"/> 1700-1799	<input type="checkbox"/> art	<input type="checkbox"/> engineering	<input type="checkbox"/> music	<input type="checkbox"/> theater
<input checked="" type="checkbox"/> 1800-1899	<input type="checkbox"/> commerce	<input type="checkbox"/> exploration/settlement	<input type="checkbox"/> philosophy	<input type="checkbox"/> transportation
<input type="checkbox"/> 1900-	<input type="checkbox"/> communications	<input type="checkbox"/> industry	<input type="checkbox"/> politics/government	<input type="checkbox"/> other (specify)
		<input type="checkbox"/> invention		

Specific dates c. 1851 **Builder/Architect** Henry C. Wilson, Builder

Statement of Significance (in one paragraph) Criterion C

The Grevenberg House is significant in the area of architecture as a fine example of a Greek Revival residence. Although it is one of several comparable designs in Franklin, it is unusual in Louisiana because its design is based upon a fully articulated temple form rather than the application of classical details to the traditional raised cottage.

The house was built by Henry C. Wilson in about 1851, when he purchased its site. In 1857 he sold it to Mrs. Frances Wykoff Grevenberg. She and her family owned the home until 1880, and it continues even today to be known as the Grevenberg House. In 1900 the house was purchased by Donelson Caffery, Jr., son of the U. S. Senator. The Caffery family owned the house during 1900-1918 and 1938-49. From 1949 to 1966 it served as a recreation center. In 1969 the St. Mary Chapter of the Louisiana Landmarks Society leased the building and restored it in consultation with architect Samuel Wilson, Jr., with financial help from the parish police jury and Evangeline Economic Development District. Today it is open to the public as a museum.

9. Major Bibliographical References

St. Mary Parish Conveyance Records

10. Geographical Data

UTM NOT VERIFIED

Acreeage of nominated property approx. 1/4 acre

ACREAGE NOT VERIFIED

Quadrangle name _____

Quadrangle scale _____

UMT References

A

1	5	6	4	5	2	9	0	3	2	9	7	6	6	0
Zone		Easting				Northing								

B

Zone		Easting				Northing							

C

Zone		Easting				Northing							

D

Zone		Easting				Northing							

E

Zone		Easting				Northing							

F

Zone		Easting				Northing							

G

Zone		Easting				Northing							

H

Zone		Easting				Northing							

Verbal boundary description and justification

Boundaries drawn to encompass only the house because the setting has been changed - now having the character of a playground.

List all states and counties for properties overlapping state or county boundaries

state _____ code _____ county _____ code _____

state _____ code _____ county _____ code _____

11. Form Prepared By

name/title Mrs. H. H. Dinkins, Jr. Board Member

organization St. Mary Chapter of the Louisiana Landmarks Society, Inc. date September 1979

street & number P. O. Box 225 telephone 318/923-7948

city or town Franklin state Louisiana 70538

12. State Historic Preservation Officer Certification

The evaluated significance of this property within the state is:

national state local

As the designated State Historic Preservation Officer for the National Historic Preservation Act of 1966 (Public Law 89-665), I hereby nominate this property for inclusion in the National Register and certify that it has been evaluated according to the criteria and procedures set forth by the Heritage Conservation and Recreation Service.

State Historic Preservation Officer signature *J. Bernard Turner*

title State Historic Preservation Officer date 3/27/80

For HCRS use only	
I hereby certify that this property is included in the National Register	
<i>Sally G. Olden</i>	date 6/6/80
Keeper of the National Register	
Attest: <i>Beth Grovona</i>	date 6/3/80
Chief of Registration	

STERLING RD.

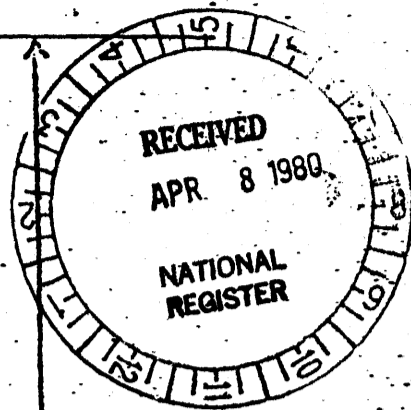

BOUNDARIES RUN PARALELL TO SIDES OF HOUSE

PHOTO ①

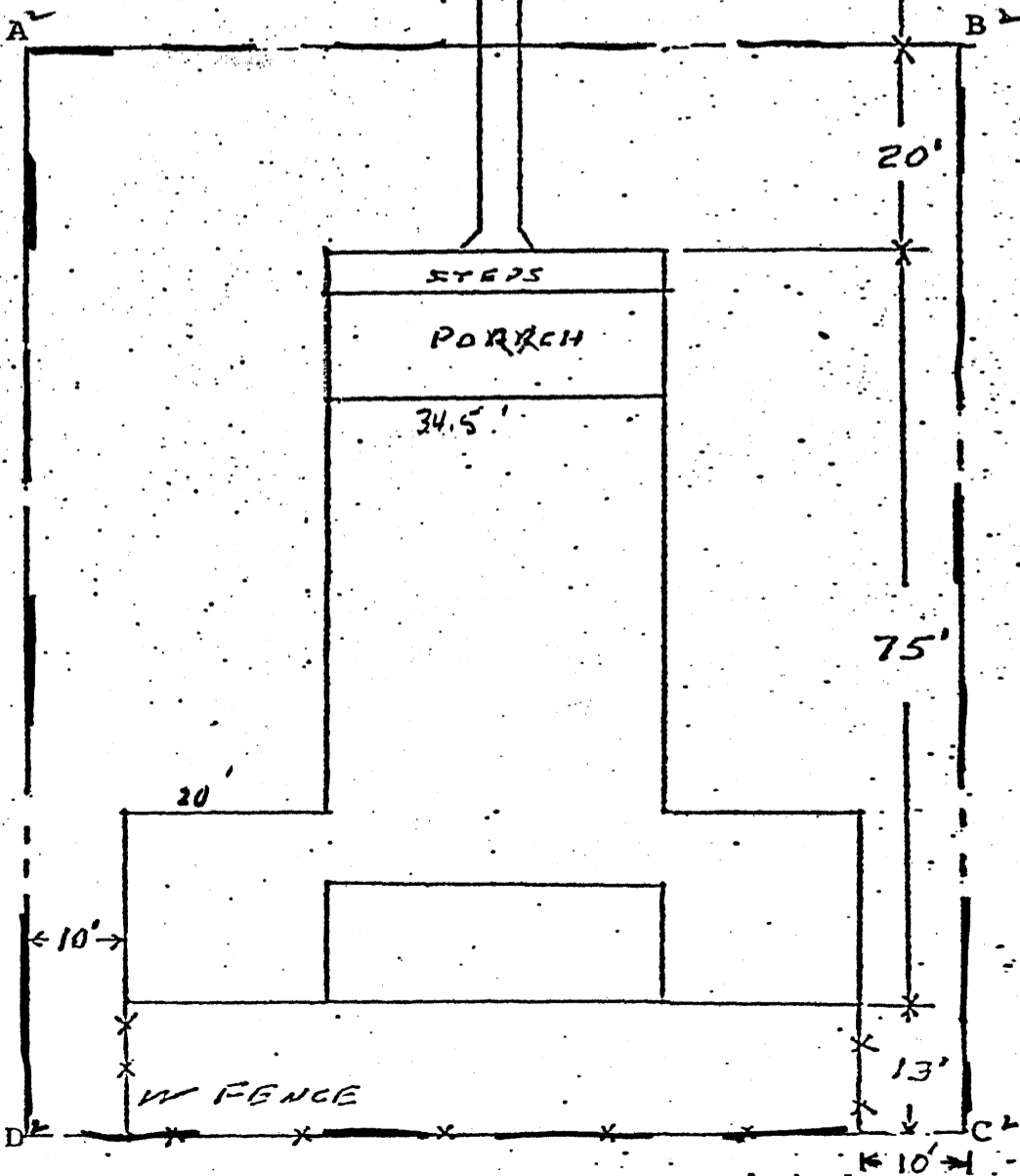

PROPERTY 08' X 94.5'

CREVEMBERG HOUSE BY CAFFERY HOME CITY OF FRANKLIN CO.

PHOTO ②

DRAWN: RAG