

**NATIONAL REGISTER OF HISTORIC PLACES  
INVENTORY - NOMINATION FORM**

(Type all entries - complete applicable sections)

STATE: <b>Utah</b>	
COUNTY: <b>Piute</b>	
FOR NPS USE ONLY	
ENTRY NUMBER <b>71,449,0011</b>	DATE <b>4/16/71</b>

1. NAME	
COMMON:	<b>Piute County Courthouse</b>
AND/OR HISTORIC:	

2. LOCATION			
STREET AND NUMBER: <b>Center Street and U. S. Highway 89</b>			
CITY OR TOWN: <b>Junction</b>			
STATE <b>Utah</b>	CODE <b>49</b>	COUNTY: <b>Piute</b>	CODE <b>031</b>

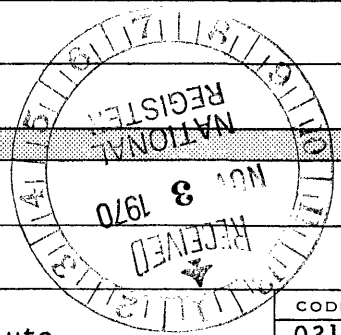

3. CLASSIFICATION				
CATEGORY (Check One)	OWNERSHIP		STATUS	ACCESSIBLE TO THE PUBLIC
District <input type="checkbox"/> Building <input checked="" type="checkbox"/> Site <input type="checkbox"/> Structure <input type="checkbox"/> Object <input type="checkbox"/>	Public <input checked="" type="checkbox"/> Private <input type="checkbox"/> Both <input type="checkbox"/>	Public Acquisition: In Process <input type="checkbox"/> Being Considered <input type="checkbox"/>	Occupied <input checked="" type="checkbox"/> Unoccupied <input type="checkbox"/> Preservation work in progress <input type="checkbox"/>	Yes: Restricted <input checked="" type="checkbox"/> Unrestricted <input type="checkbox"/> No: <input type="checkbox"/>
PRESENT USE (Check One or More as Appropriate)				
Agricultural <input checked="" type="checkbox"/>	Government <input checked="" type="checkbox"/>	Park <input type="checkbox"/>	Transportation <input type="checkbox"/>	Comments <input type="checkbox"/>
Commercial <input type="checkbox"/>	Industrial <input type="checkbox"/>	Private Residence <input type="checkbox"/>	Other (Specify) <input type="checkbox"/>	
Educational <input checked="" type="checkbox"/>	Military <input type="checkbox"/>	Religious <input type="checkbox"/>		
Entertainment <input type="checkbox"/>	Museum <input type="checkbox"/>	Scientific <input type="checkbox"/>		

4. OWNER OF PROPERTY			
OWNERS NAME: <b>Piute County</b>			
STREET AND NUMBER: <b>Center Street and U. S. Highway 89</b>			
CITY OR TOWN: <b>Junction</b>	STATE: <b>Utah</b>	CODE <b>49</b>	

5. LOCATION OF LEGAL DESCRIPTION			
COURTHOUSE, REGISTRY OF DEEDS, ETC.: <b>Piute County Courthouse</b>			
STREET AND NUMBER: <b>Center Street and U. S. Highway 89</b>			
CITY OR TOWN: <b>Junction</b>	STATE: <b>Utah</b>	CODE <b>49</b>	
APPROXIMATE ACREAGE OF NOMINATED PROPERTY: <b>1.14 acres</b>			

6. REPRESENTATION IN EXISTING SURVEYS			
TITLE OF SURVEY: <b>Historic Sites Survey</b>			
DATE OF SURVEY: <b>February 1970</b> Federal <input checked="" type="checkbox"/> State <input checked="" type="checkbox"/> County <input type="checkbox"/> Local <input type="checkbox"/>			
DEPOSITORY FOR SURVEY RECORDS: <b>Utah State Historical Society</b>			
STREET AND NUMBER: <b>603 East South Temple</b>			
CITY OR TOWN: <b>Salt Lake City</b>	STATE: <b>Utah</b>	CODE <b>49</b>	

SEE INSTRUCTIONS

STATE: Utah  
COUNTY: Piute  
ENTRY NUMBER: 71,449,0011  
DATE: 4/16/71  
FOR NPS USE ONLY

**7. DESCRIPTION**

CONDITION	(Check One)							
	Excellent <input type="checkbox"/>	Good <input checked="" type="checkbox"/>	Fair <input type="checkbox"/>	Deteriorated <input type="checkbox"/>	Ruins <input type="checkbox"/>	Unexposed <input type="checkbox"/>		
INTEGRITY	(Check One)			(Check One)				
	Altered <input checked="" type="checkbox"/>			Unaltered <input type="checkbox"/>				
			Moved <input type="checkbox"/>			Original Site <input checked="" type="checkbox"/>		

DESCRIBE THE PRESENT AND ORIGINAL (if known) PHYSICAL APPEARANCE

The Piute County Courthouse is constructed of red-burnt brick, made on the site by the builders, Young, Allen and Morrill. The brick walls are set on granite slabs hauled from nearby Kingston. The structure rises two full stories with small false towers in three corners and a major tower on the southeast. The architectural style is Edwardian with arched windows and archways on both floor levels. The exterior of the structure is unaltered.

The interior has undergone some modifications, due to a fire in 1943 and the recent remodeling of the jail cell into a lounge area for employees in the south west corner of the first floor. The stairs were widened when replaced.

However, the major offices on the main floor remain with only slight changes. The second floor has seven offices used for county and town government. The courtroom remains, with its judge's stand and jury box as it was constructed.

The wood trim on the interior was hand turned on the site also. The structure demonstrates a remarkable pioneer commitment and high quality craftsmanship.

SEE INSTRUCTIONS

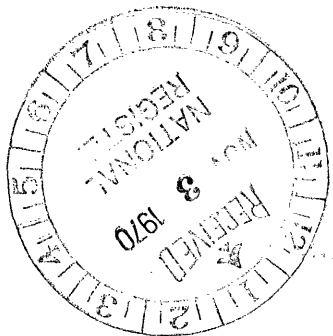

**8. SIGNIFICANCE**

PERIOD (Check One or More as Appropriate)

Pre-Columbian <input type="checkbox"/>	16th Century <input type="checkbox"/>	18th Century <input type="checkbox"/>	20th Century <input checked="" type="checkbox"/>
15th Century <input type="checkbox"/>	17th Century <input type="checkbox"/>	19th Century <input type="checkbox"/>	

SPECIFIC DATE(S) (If Applicable and Known) **1903**

AREAS OF SIGNIFICANCE (Check One or More as Appropriate)

Aboriginal <input type="checkbox"/>	Education <input type="checkbox"/>	Political <input checked="" type="checkbox"/>	Urban Planning <input type="checkbox"/>
Prehistoric <input type="checkbox"/>	Engineering <input type="checkbox"/>	Religion/Philosophy <input type="checkbox"/>	Other (Specify) <input type="checkbox"/>
Historic <input type="checkbox"/>	Industry <input type="checkbox"/>	Science <input type="checkbox"/>	<u>Architecture</u>
Agriculture <input type="checkbox"/>	Invention <input type="checkbox"/>	Sculpture <input type="checkbox"/>	_____
Art <input type="checkbox"/>	Landscape <input type="checkbox"/>	Social/Humanitarian <input type="checkbox"/>	_____
Commerce <input type="checkbox"/>	Architecture <input type="checkbox"/>	Theater <input type="checkbox"/>	_____
Communications <input type="checkbox"/>	Literature <input type="checkbox"/>	Transportation <input type="checkbox"/>	_____
Conservation <input type="checkbox"/>	Military <input type="checkbox"/>		_____
	Music <input type="checkbox"/>		_____

STATEMENT OF SIGNIFICANCE (Include Personages, Dates, Events, Etc.)

SEE INSTRUCTIONS

Piute County Courthouse stands in the small rural town of Junction as a monument to the building skills of the pioneers and to their public commitment. The population of the county has remained between one and two thousand people. In 1892 a special bond election defeated a proposal for the building. However, by 1902 John Morrill donated a lot for the structure and \$225.00 were provided for plans. The building was designed by Provo architect, R. C. Watkins. Young, Allen and Morrill were contracted for \$7,670.00 to build the structure which was completed in 1903. It has served as the center for county government since that time.

Being located in a livestock-mining region, it has had its share of outlaw cases and mining suits. The little courtroom reminds those who see it of a colorful history. The original "pot-bellied" stoves were replaced with central heating. On July 4, 1930 the community celebrated "getting electricity" in their town and the courthouse.

A fire, in 1943, damaged parts of the interior. The stairs were reconstructed and most of the interior repainted. However, the general integrity of the building remains very good. Plans for limited restoration of the exterior and the courtroom are underway.

The building <sup>sits</sup> ~~sits~~ in a grove of trees, which were planted originally to provide a shaded camping area for travelers through the area. Indians and whites have used the site extensively. The tall trees now furnish a lovely backdrop for the courthouse.

In this remote setting of rural Utah, the Piute County Courthouse is extremely important.

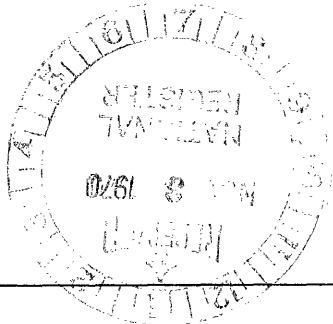

**9. MAJOR BIBLIOGRAPHICAL REFERENCES**

Irene Elder, "Piute Restores Little Red Courthouse," Salt Lake Tribune (July 31, 1966).

Piute County Records (Recorder's Office, Piute County Courthouse, Junction, Utah).

"Fire Wrecks Courthouse, Burns Records in Fire," Salt Lake Tribune (January 31, 1944).

**10. GEOGRAPHICAL DATA**

LATITUDE AND LONGITUDE COORDINATES DEFINING A RECTANGLE LOCATING THE PROPERTY			O R	LATITUDE AND LONGITUDE COORDINATES DEFINING THE CENTER POINT OF A PROPERTY OF LESS THAN ONE ACRE		
CORNER	LATITUDE	LONGITUDE		LATITUDE	LONGITUDE	
	Degrees Minutes Seconds	Degrees Minutes Seconds		Degrees	Minutes	Seconds
NW	° ' "	° ' "		38°	14'	14"
NE	° ' "	° ' "		112°	13'	11"
SE	° ' "	° ' "				
SW	° ' "	° ' "				

**LIST ALL STATES AND COUNTIES FOR PROPERTIES OVERLAPPING STATE OR COUNTY BOUNDARIES**

STATE:	CODE	COUNTY	CODE
STATE:	CODE	COUNTY:	CODE
STATE:	CODE	COUNTY:	CODE
STATE:	CODE	COUNTY:	CODE

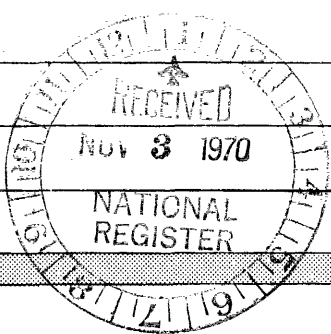

**11. FORM PREPARED BY**

NAME AND TITLE: Melvin T. Smith

ORGANIZATION: Utah State Historical Society DATE: October 2, 1970

STREET AND NUMBER: 603 East South Temple

CITY OR TOWN: Salt Lake City STATE: Utah CODE: 49

**12. STATE LIAISON OFFICER CERTIFICATION NATIONAL REGISTER VERIFICATION**

As the designated State Liaison Officer for the National Historic Preservation Act of 1966 (Public Law 89-665), I hereby nominate this property for inclusion in the National Register and certify that it has been evaluated according to the criteria and procedures set forth by the National Park Service. The recommended level of significance of this nomination is:

National  State  Local

Name: Milton L. Weilenmann

Title: Utah State Liaison Officer

Date: October 3, 1970

I hereby certify that this property is included in the National Register.

Ernest A. Connally  
Chief, Office of Archeology and Historic Preservation

Date: APR 16 1971

ATTEST:

William J. Murtagh  
Keeper of The National Register

Date: MAR 12 1971

SEE INSTRUCTIONS

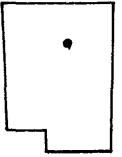

SCALE: 1" = 800'  
DATE: MAY 1970

WATER & SEWER NEEDS MAP  
LONGITUDE: 112° - 13' - 11"  
LATITUDE: 38° - 14' - 14"

BLUTE COUNTY COURTHOUSE  
MAIN STREET AT CENTER STREET  
FUNCTION: UTAH

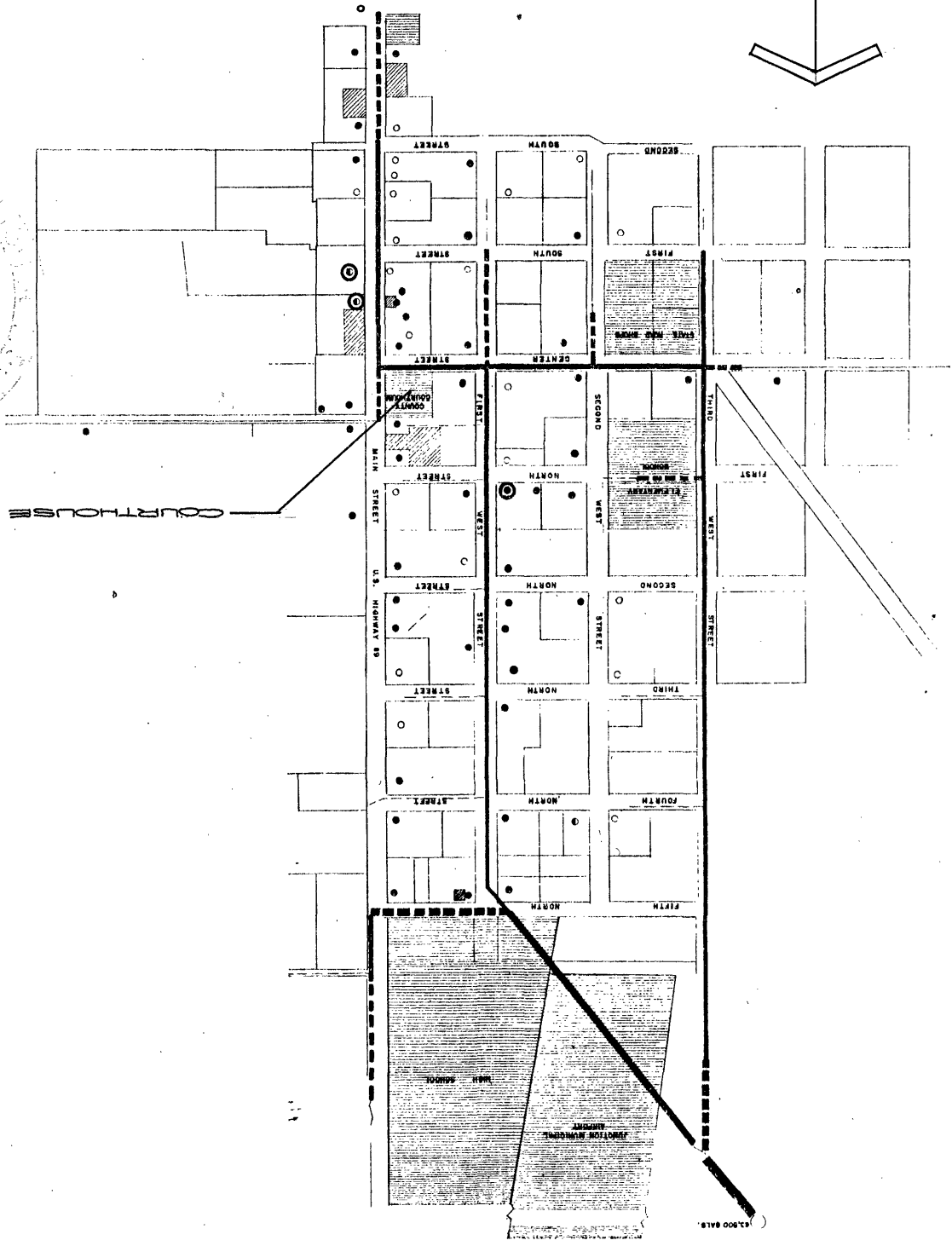
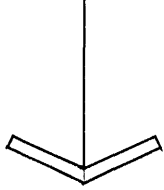

RECEIVED  
NOV 3 1970  
NATIONAL  
REGISTER

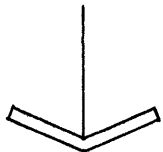

BLUTE COUNTY COURTHOUSE

MAIN STREET AT CENTER STREET

LOCATION, UTAH

LATITUDE: 38° 14' 11"

LONGITUDE: 109° 14' 11"

DATE: MAY 1970

SCALE: 1" = 40'

CENTER STREET

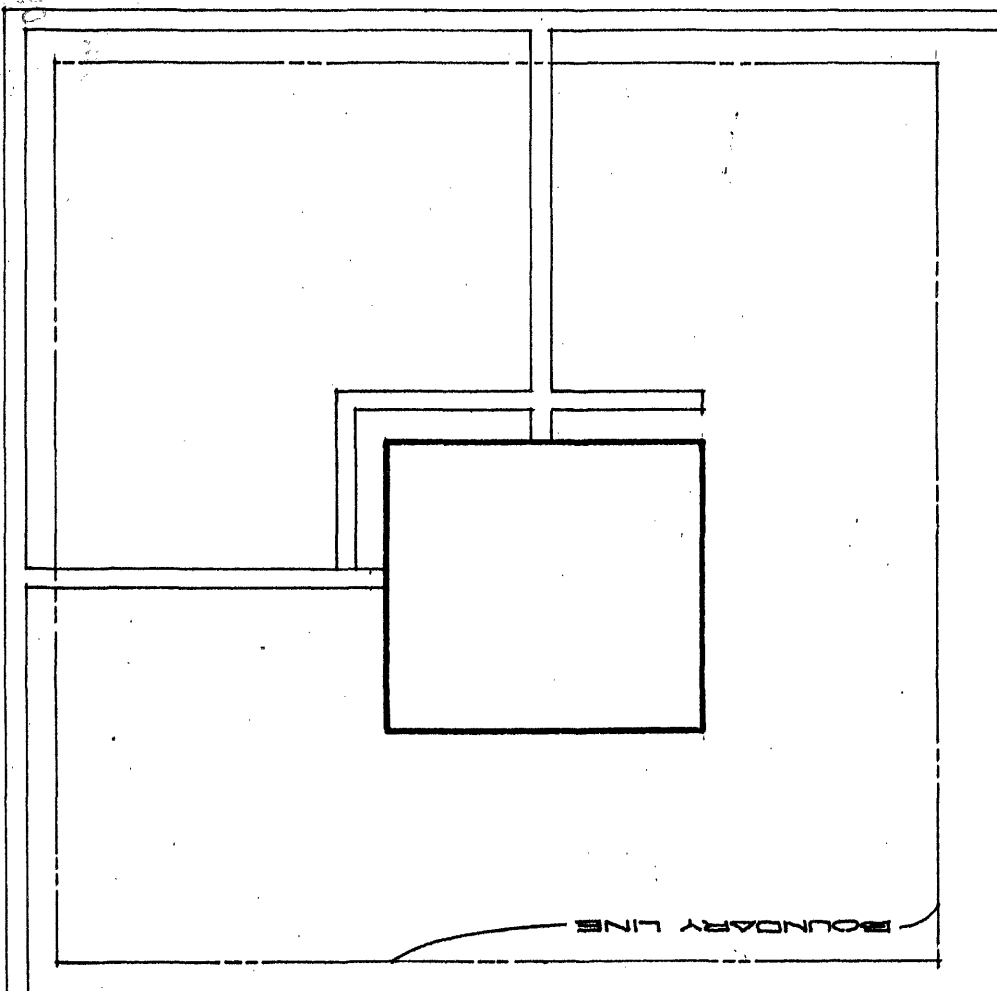

BOUNDARY LINE

CANAL

MAIN STREET - US HIGHWAY 89

