

UNITED STATES DEPARTMENT OF THE INTERIOR
NATIONAL PARK SERVICE

**NATIONAL REGISTER OF HISTORIC PLACES
INVENTORY -- NOMINATION FORM**

FOR NPS USE ONLY

RECEIVED NOV 01 1979

DATE ENTERED

SEE INSTRUCTIONS IN *HOW TO COMPLETE NATIONAL REGISTER FORMS*
TYPE ALL ENTRIES -- COMPLETE APPLICABLE SECTIONS

1 NAME

John Drinker House

HISTORIC

AND/OR COMMON

2 LOCATION

STREET & NUMBER

The Sam Mason Road Route 24/1 at 26/1 intersection,

Sam Mason Road

NOT FOR PUBLICATION

CITY, TOWN

CONGRESSIONAL DISTRICT

VICINITY OF Bunker Hill

STATE

CODE

COUNTY

CODE

West Virginia

54

Berkeley

003

3 CLASSIFICATION**CATEGORY**

- DISTRICT
 BUILDING(S)
 STRUCTURE
 SITE
 OBJECT

OWNERSHIP

- PUBLIC
 PRIVATE
 BOTH
PUBLIC ACQUISITION
 IN PROCESS
 BEING CONSIDERED

STATUS

- OCCUPIED
 UNOCCUPIED
 WORK IN PROGRESS
ACCESSIBLE
 YES: RESTRICTED
 YES: UNRESTRICTED
 NO

PRESENT USE

- AGRICULTURE
 COMMERCIAL
 EDUCATIONAL
 ENTERTAINMENT
 GOVERNMENT
 INDUSTRIAL
 MILITARY
 MUSEUM
 PARK
 PRIVATE RESIDENCE
 RELIGIOUS
 SCIENTIFIC
 TRANSPORTATION
 OTHER

4 OWNER OF PROPERTY

NAME

Mr. & Mrs. Peter A. Baker

STREET & NUMBER

CITY, TOWN

Bunker Hill, W25413

VICINITY OF

STATE

5 LOCATION OF LEGAL DESCRIPTIONCOURTHOUSE, Berkeley County
REGISTRY OF DEEDS, ETC.

STREET & NUMBER

CITY, TOWN

Martinsburg, WV 25401

STATE

6 REPRESENTATION IN EXISTING SURVEYSTITLE G-60, Berkeley County Historical Society & Berkeley County Historical
Landmarks Commission Survey

DATE

1973-78

FEDERAL STATE COUNTY LOCAL

DEPOSITORY FOR
SURVEY RECORDS

Berkeley County Courthouse

CITY, TOWN

Martinsburg, WV 25401

STATE

7 DESCRIPTION

CONDITION

EXCELLENT
 GOOD
 FAIR

DETERIORATED
 RUINS
 UNEXPOSED

CHECK ONE

UNALTERED
 ALTERED

CHECK ONE

ORIGINAL SITE
 MOVED DATE _____

DESCRIBE THE PRESENT AND ORIGINAL (IF KNOWN) PHYSICAL APPEARANCE

The layout of the Drinker house is central block with one wing. The main part of the house was built in 1815, the Federal period. It is a 5 bay, 2 story house constructed of limestone with a gable roof and large inside end chimneys. The coursed rubble limestone walls are finished with beautiful quoins. The outstanding feature of this house is the arched main entrance of gauged stone. It is beautiful work and has no peer in Berkeley County. The house features a central hall floor plan with one or two rooms each side. The staircase is an open string stair of 2 flights to the second floor. The house is a ruin and the mantel pieces are gone. Only the chair rail remains in some of the rooms. The fireboxes have plastered surrounds. Off the south side is the first floor ruins of a one and one half story, 3 bay log house. The whitewashed roof outline on the stone house reveals a tall recessed porch. This house is attached to the stone house by a board wall that has a door to a breezeway between the two houses. The log house probably predates the stone mansion. Just off the log house is a separate stone smokehouse also in ruins. Located to the north of the house is the ruins of the slave quarters. It is constructed of at least four separate stone buildings all grouped together part of which are standing. It was of an unusual type of stone construction and has no known rival in Berkeley County. Also included is a dump pile.

8 SIGNIFICANCE

PERIOD	AREAS OF SIGNIFICANCE -- CHECK AND JUSTIFY BELOW				
<input type="checkbox"/> PREHISTORIC	<input type="checkbox"/> ARCHEOLOGY-PREHISTORIC	<input type="checkbox"/> COMMUNITY PLANNING	<input type="checkbox"/> LANDSCAPE ARCHITECTURE	<input type="checkbox"/> RELIGION	
<input type="checkbox"/> 1400-1499	<input checked="" type="checkbox"/> ARCHEOLOGY-HISTORIC	<input type="checkbox"/> CONSERVATION	<input type="checkbox"/> LAW	<input type="checkbox"/> SCIENCE	
<input type="checkbox"/> 1500-1599	<input type="checkbox"/> AGRICULTURE	<input type="checkbox"/> ECONOMICS	<input type="checkbox"/> LITERATURE	<input type="checkbox"/> SCULPTURE	
<input type="checkbox"/> 1600-1699	<input checked="" type="checkbox"/> ARCHITECTURE	<input type="checkbox"/> EDUCATION	<input type="checkbox"/> MILITARY	<input type="checkbox"/> SOCIAL/HUMANITARIAN	
<input type="checkbox"/> 1700-1799	<input checked="" type="checkbox"/> ART	<input type="checkbox"/> ENGINEERING	<input type="checkbox"/> MUSIC	<input type="checkbox"/> THEATER	
<input checked="" type="checkbox"/> 1800-1899	<input type="checkbox"/> COMMERCE	<input type="checkbox"/> EXPLORATION/SETTLEMENT	<input type="checkbox"/> PHILOSOPHY	<input type="checkbox"/> TRANSPORTATION	
<input type="checkbox"/> 1900-	<input type="checkbox"/> COMMUNICATIONS	<input type="checkbox"/> INDUSTRY	<input type="checkbox"/> POLITICS/GOVERNMENT	<input type="checkbox"/> OTHER (SPECIFY)	
		<input type="checkbox"/> INVENTION			

SPECIFIC DATES

BUILDER/ARCHITECT

STATEMENT OF SIGNIFICANCE

The house and other ruins on the property are very significant for their architecture and association with John Drinker, an early Quaker portrait artist. The house had outstanding features such as the beautiful arched main entrance of gauged stone. The quality of workmanship displayed in the stone work ranks as one of Berkeley County's finer. The house in general was one of Berkeley County's finest. John Drinker was a Philadelphia portrait artist. He purchased land in Berkeley County in 1797. He married Elizabeth Peppers of Berkeley County the same year. He purchased a 213 acre tract of land where the house is located in 1808. Then he built the beautiful stone mansion in ca. 1815. It is known that he was an artist from 1787 to 1802. Among known portraits of the Berkeley County area are Mrs. John Briscoe, Dr. John Briscoe, Jr., Sarah Darke Rutherford. John Drinker died in the 1820s. His widow remained a resident of the house until 1858. Both are buried at the Morgan Chapel cemetery. He was a member of the Society of Friends. The Museum of Early Southern Decorative Arts, Winston-Salem, North Carolina, owns some of his work.

9 MAJOR BIBLIOGRAPHICAL REFERENCES

Letter from Museum of Early Southern Decorative Arts

10 GEOGRAPHICAL DATA

UTM NOT VERIFIED

ACREAGE OF NOMINATED PROPERTY 2 Acres

UTM REFERENCES

A	17	7	51	7	3	0	4	3	5	5	9	7	9
	ZONE	EASTING			NORTHING			B					
C													
	ZONE	EASTING			NORTHING			D					

VERBAL BOUNDARY DESCRIPTION

Beginning at Sylvan Run, thence W crossing a road and along a fence 300 ft. thence along fence N 300 ft., thence along fence E 200 ft. thence along fence back of slave quarters 100 ft, thence with fence ^a to Sylvan Run, thence up the run S 400 ft. to the beginning

LIST ALL STATES AND COUNTIES FOR PROPERTIES OVERLAPPING STATE OR COUNTY BOUNDARIES

STATE	CODE	COUNTY	CODE
STATE	CODE	COUNTY	CODE

11 FORM PREPARED BY

NAME / TITLE Don C. Wood, Genealogist, Historian, Historic Archeologist

ORGANIZATION President, Berkeley County Historical Society DATE

Chairman, Berkeley County Historical Landmarks Commission

STREET & NUMBER TELEPHONE

Route 3, Box 79

CITY OR TOWN STATE

Martinsburg, WV 25401

12 STATE HISTORIC PRESERVATION OFFICER CERTIFICATION

THE EVALUATED SIGNIFICANCE OF THIS PROPERTY WITHIN THE STATE IS:

NATIONAL STATE LOCAL

As the designated State Historic Preservation Officer for the National Historic Preservation Act of 1966 (Public Law 89-665), I hereby nominate this property for inclusion in the National Register and certify that it has been evaluated according to the criteria and procedures set forth by the National Park Service.

FEDERAL REPRESENTATIVE SIGNATURE

TITLE

DATE

FOR NPS USE ONLY

I HEREBY CERTIFY THAT THIS PROPERTY IS INCLUDED IN THE NATIONAL REGISTER

DATE

DIRECTOR, OFFICE OF ARCHEOLOGY AND HISTORIC PRESERVATION

ATTEST:

DATE

KEEPER OF THE NATIONAL REGISTER

FOR HCRS USE ONLY

RECEIVED

DATE ENTERED

DEC 10 1978

NATIONAL REGISTER OF HISTORIC PLACES INVENTORY -- NOMINATION FORM

John Drinker House

CONTINUATION SHEET

ITEM NUMBER 8

PAGE 2

The ruins of the John Drinker house should be listed on The National Register of Historic Places and Sites because of the fine workmanship still evident in the building and because of historic associations with John Drinker, an early Quaker portrait artist. Of particular interest are the portraits of Dr. and Mrs. John Briscoe, the builder of "Piedmont" in Jefferson County. These portraits were recently purchased by The Museum of Early Southern Decorative Arts in Winston-Salem, North Carolina. The house was a large Federal period structure of stone with a gauged stone main entrance, the only example of this work in Berkeley County. Elsewhere on the property are the ruins of outbuildings. This was a 213 acre tract of land. The 2 acres with mansions and dependencies ruins is an extremely important historic archeology resource. John Drinker, a Quaker artist from New York born March 12, 1760, died February 16, 1825, childless, leaving his estate to his widow Elizabeth Pepper, who he married in Berkeley County April 12, 1797. Traditionally it is claimed that his widow ran an underground slave train.

Elizabeth Drinker's will written Oct 1, 1856 clearly shows her concern for the freedom of the black people. To David and Elizabeth Wright she left "the services of my Negro boy Eli until he shall attain the age of twenty five." To Mary Jane Pepper "the services of my negro girl Mary and her children." At the death of Mary Jane, Mary and all her issue were to receive their freedom. All her other slaves except Betsy and Sally, the afflicted one, when they were old enough to be hired out to "good master" for two years "and the net proceeds of said servants after paying all expenses incident to them selves are to be applied to their removal beyond the limits of the State of Virginia." She put up her Back Creek Valley farm for the support of "old servant Betsy and the afflicted one Sally and such of the smaller servants as are too small to earn their support until they arrive at such an age that they can be hired out and earn their support and the expenses of which I charge my lands lying on Back Creek in Berkeley Co Va. and at the expiration of two years if the parents of these children including their entire family wish their freedom and leave the State of Virginia it is my wish for them to do so."

There is supposed to be an underground tunnel which lead from the basement of the Drinker mansion (ruins). This well also had a place where you could go down so far and stand. This could have been for cleaning or used for hiding.

Though considerable has been written on the underground railroad, verification of stops and routes is difficult. The Quakers were basically opposed to slavery and operated many of the stations. John Drinker was a Quaker who had come from New York and would have had many connections for help in setting up an underground railroad. In the book "Underground Railroad from Slavery to Freedom" by Wilbur H. Seibert, much information about the underground routes is discussed. Any information that could be uncovered in reference to the Drinker underground railroad stop would contribute much to history.

The Drinker property has another historic archeology significance in providing material for the study of an 18th century Quaker artist's life.

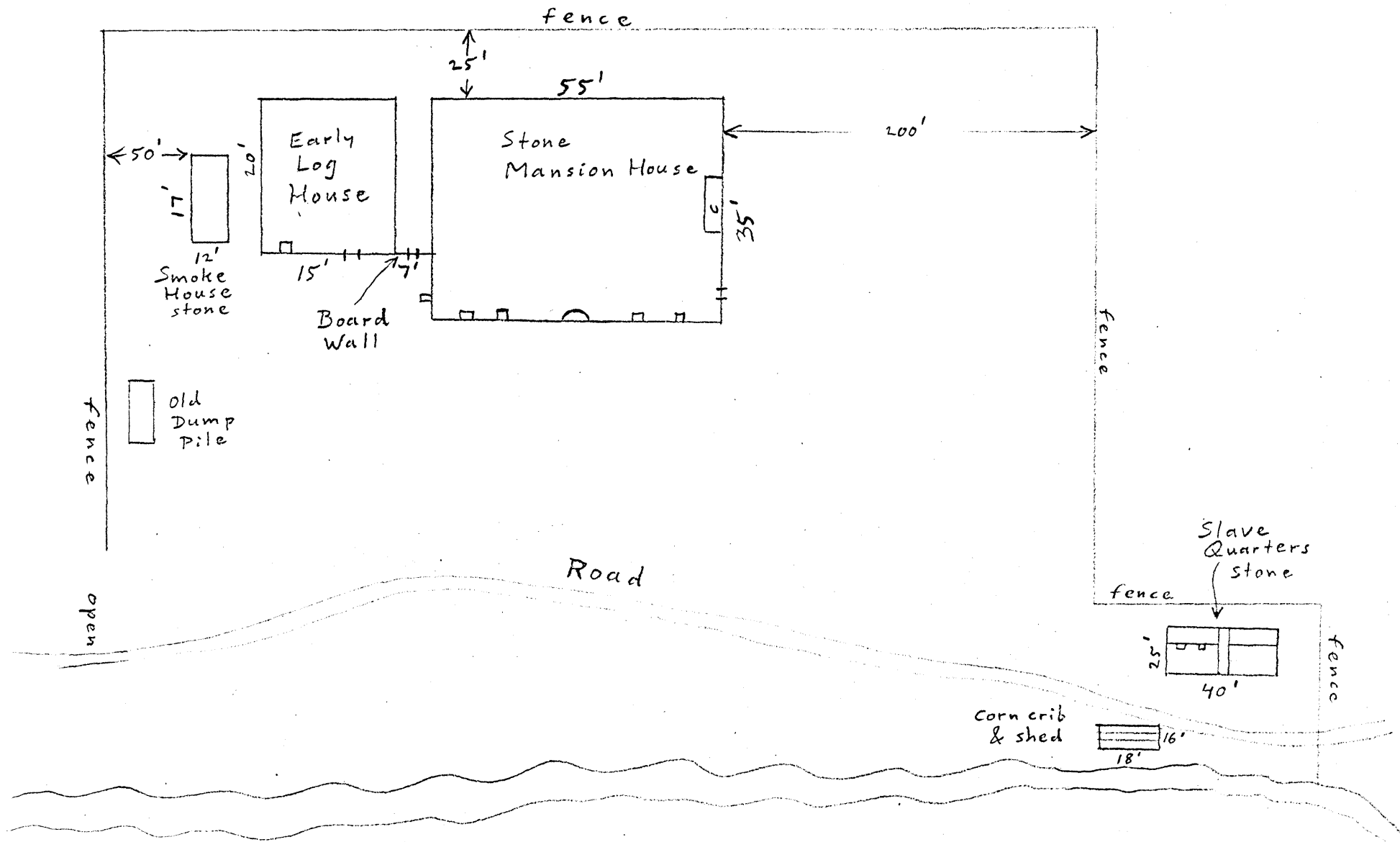

Mansion House-all four main walls standing, outstanding stone work, part cut stone (limestone), roof and interior of house caved in.

Log House Ruins-was two story, now one, no roof, part of south wall was replaced with boards.

Smokehouse-stone, roof gone (section of wall was plastered inside).

Slave quarters-stone, 3/4 walls down, looks like in 4 sections, west side added at later date.

Corn Crib-in good shape, open slat

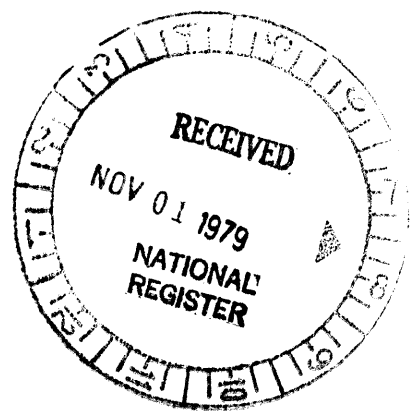

NAME OF PROPERTY John Drinker House STATE W. Virginia

The attached National Register Inventory-Nomination form is being returned to your office for clarification of the information indicated below. PLEASE RETURN THIS FORM WHEN THE NOMINATION IS RESUBMITTED.

7 Description: _____

8 Statement of Significance: Please discuss the building's integrity. Why is it eligible despite the ruinous condition of the building?

9 Bibliography: _____

10 Geographical Data -- Acreage: _____
UTM Reference(s): _____
Verbal Boundary Description: _____

12 Certification: _____
Photographic Coverage: _____

Map Coverage: _____

Other: Is there a more precise address.

Questions concerning this nomination may be directed to Ray Luce
on the National Register staff, telephone 202-343-6401

Thank you for your attention to the above items.

W. Ray Luce Date: 9/22/80
Chief, Branch of Registration