

148

National Register of Historic Places Registration Form

This form is for use in nominating or requesting determinations for individual properties and districts. See instructions in National Register Bulletin #39 for *Complete the National Register of Historic Places Registration Form*. If any item does not apply to the property being documented, enter "N/A" for not applicable. For functions, architectural classification, materials, and areas of significance, enter only categories and subcategories from the instructions.

1. Name of Property

Historic name Christ Episcopal Church
Other names/site number _____
Name of related multiple property listing N/A

2. Location

Street & Number: 530 10th Street
City or town: Tracy City State: TN County: Grundy
Not For Publication: N/A Vicinity: Zip Code: 37387

3. State/Federal Agency Certification

As the designated authority under the National Historic Preservation Act, as amended,
I hereby certify that this nomination request for determination of eligibility meets the documentation standards for registering properties in the National Register of Historic Places and meets the procedural and professional requirements set forth in 36 CFR Part 60.

In my opinion, the property meets does not meet the National Register Criteria. I recommend that this property be considered significant at the following level(s) of significance:
 national statewide local

Applicable National Register Criteria: A B C D

[Signature] 3/16/15
Signature of certifying official/Title: Date
 State Historic Preservation Officer, Tennessee Historical Commission
State or Federal agency/bureau or Tribal Government

In my opinion, the property meets does not meet the National Register criteria.

Signature of Commenting Official: Date

Title: State of Federal agency/bureau or Tribal Government

One Hundred North Main Building
 Name of Property

Shelby County, TN
 County and State

4. National Park Service Certification

I hereby certify that this property is:

- entered in the National Register
- determined eligible for the National Register
- determined not eligible for the National Register
- removed from the National Register

other (explain:)

Jim Johnson
 Signature of the Keeper

4-24-2015
 Date of Action

5. Classification

Ownership of Property

(Check as many boxes as apply.)

- Private
- Public – Local
- Public – State
- Public – Federal

Category of Property

(Check only one box.)

- Building(s)
- District
- Site
- Structure
- Object

Number of Resources within Property

Contributing	Noncontributing	
1	0	buildings
0	0	sites
0	0	structures
0	0	objects
1	0	Total

Number of contributing resources previously listed in the National Register 0

United States Department of the Interior
National Park Service

National Register of Historic Places Continuation Sheet

Name of Property

County and State

Name of multiple property listing (if applicable)

Section number _____ Page _____

SUPPLEMENTARY LISTING RECORD

NRIS Reference Number: 15000186

Date Listed: 4/24/2015

Property Name: Christ Episcopal Church

County: Grundy

State: TN

This property is listed in the National Register of Historic Places in accordance with the attached nomination documentation subject to the following exceptions, exclusions, or amendments, notwithstanding the National Park Service certification included in the nomination documentation.

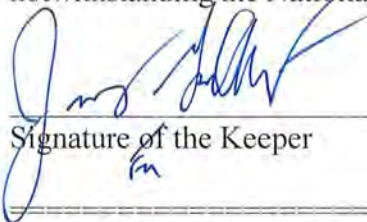

Signature of the Keeper

4.24.2015

Date of Action

Amended Items in Nomination:

Section 8: Period of Significance

The Period of Significance is hereby changed to: 1925

The 1950 addition to the church, while not detracting from the overall integrity and late Gothic Revival design, does not add to the architectural significance of the property.

The Tennessee State Historic Preservation Office was notified of this amendment.

DISTRIBUTION:

National Register property file

Nominating Authority (without nomination attachment)

Christ Episcopal Church
Name of Property

Grundy County, Tennessee
County and State

6. Function or Use

Historic Functions

RELIGIOUS: Church buildings

Current Functions

RELIGIOUS: Church buildings

7. Description

Architectural Classification

LATE 19th AND 20th CENTURY REVIVALS: Late Gothic Revival

Materials:

Principal exterior materials of the property: WOOD: Weatherboard, STONE, CONCRETE: Concrete block

Narrative Description

Christ Episcopal Church is located in Tracy City (pop. 1,456) Grundy County, Tennessee and is situated in a quiet neighborhood setting on the corner of 10th and 5th Streets. The church, constructed in 1925, faces west on the original 1873 church site and is adjacent to the Parish house, which was built ca. 1952. The site features large trees out front, a stone retaining wall, and a small asphalt parking lot to the south. The Gothic Revival style church maintains a high degree of integrity and remains unchanged with the exception of a back addition ca. 1950s and a rear door exiting the baptistery for handicap accessibility ca. 1974. The church's floor plan is a front facing L-shaped plan with the Baptistery being an irregular projection.

Christ Episcopal Church is a frame structure with a cross gabled roof covered in asphalt shingles. The church features Gothic arch stained glass windows, weatherboard siding, and a concrete block foundation finished with a parge coat. The weatherboards extend into the gables without a break and the roof displays open eave overhangs with exposed rafters and knee brace brackets, all typical of the Gothic Revival style. The church's interior features plaster walls, wainscoting, Tiffany style stained glass windows, wood floors, and original woodwork from the 1873 church which was destroyed in a storm in the early 1920s. Overall the

Christ Episcopal Church
Name of Property

Grundy County, Tennessee
County and State

church is representative of the late Gothic Revival architectural style that was prevalent among many church edifices in the United States during the late nineteenth and early twentieth centuries.

Exterior

The façade (west elevation) faces 10th street and features a concrete block foundation with square-cut quarry face stone in regular courses. There are steps made of poured concrete and stone leading up to the elevated front entrance with a black wrought iron banister with twisted balusters. Centered on the central block of the façade is a projecting narthex with a recessed entrance and a dropped secondary front facing, steeply pitched gabled roof clad in asphalt shingles. The double board and batten front doors are rectangular in shape and depict a gothic arch that comes together in the center of the doorway. The doors include wrought iron handles that feature a twisted design. To the south of the recessed entrance is a rectangular wooden sign reading Christ Church Episcopal in wood block letters painted black. Located on the north and south elevations of the projecting narthex are small square stained glass windows within a wood frame.

Flanking the narthex on each side of the central block of the church, are stained glass windows with a simple wood casing and lip on the headers. The central block of the church features a front facing steeply pitched gable roof with five knee brace brackets evenly spaced under the roof's projecting eave. In the central block of the church's gable is a louvered vent. The vent features horizontal wood slats with a small diagonal corner pieces.

To the south of the building's central block and front entrance is the Baptistry, a square bell tower with flared eaves and exposed beams. Centered on the south and west sides of the tower is a stained glass window with a Gothic arch. The window is surrounded by a rectangular casement that was a later addition with the installation of storm glass to protect the stained glass. Inside the casement there is wood surrounding the Gothic arch. The baptistry has multileveled eaves with a square tower roof topped with a decorative Celtic cross finial. Both levels of eaves have exposed rafters with the lower level of the east side having a gutter system that continues on across the north façade's roof line and across the addition. Centered on each side of the tower, between the two eave levels, are louvered vents identical in appearance to the one on the central block of the west façade with the south facing side's vent being doubled. The east facing side of the tower has been modified to include a small projecting vestibule and handicap entrance ca. 1974 with a concrete block foundation, weatherboard siding and a simple pitched roof covered in asphalt shingles. A handicap ramp made of poured concrete with black metal railing runs along the south façade and attaches to this entrance.

The central block of the south elevation features two stained glass windows identical to those on the façade with a rectangular casement and storm glass. Projecting from the right side of the south elevation is the 1950's addition. This frame addition has a concrete block foundation and continues with the white weatherboard. The roof is side gabled with exposed rafters and includes a small gabled roof over the entrance located on the addition's west façade with large brackets for support. Two poured concrete steps lead up the entrance with a wood railing and turned spindles. The door is paneled with a three over three glazing. Flanking this entrance are two six-over-six double-hung wood sash windows with metal storm windows. The gable end of the addition has two window bays with the same six-over-six double-hung wood sash windows and storm windows. Located in the center of this elevation near the top of the gable is a louvered vent in an oblong rectangular shape. The east or rear elevation of the addition features one left aligned six-over-one double-hung wood sash window.

Christ Episcopal Church
Name of Property

Grundey County, Tennessee
County and State

Flush to the right of the 1950's addition, on the east elevation, is the rear of the sanctuary. Centered on the sanctuary's facade are three bays of stained glass Gothic arch windows with a raised central ribbon of three that depict one connecting scene. Flanking these are individual windows featuring imagery of angels. The three bays of windows are each framed in wood that comes up into a 90 degree angle with a small projecting lip above to deter water. Above the windows in the center of the sanctuary's eave is a square louvered vent that matches those on the Baptistry and front facade. The gabled roof has a projecting eave with five evenly spaced knee brace brackets below.

The north elevation displays the same concrete block foundation extending about 3' above ground level with a small wood door for crawl space access below the three bays of stained glass windows located on the right side of the elevation. The three bays of stained glass windows are located in the sanctuary and are identical to the windows that they mirror on the south facade. These windows also include storm glass. Two more bays of windows are located on the easternmost section of the facade for the organ room and storage closet. These six-over-six double hung windows are topped with a gentle curve while maintaining the same square casement as the adjacent stained glass windows. The second window from the east has had its panes painted over and includes a glass storm window, while the first window has a metal storm window installed. The roof's open eave displays exposed rafters.

Interior

The central block of the church includes the sanctuary and organ room with the baptistry and 1950's addition projecting from it to the south, and the narthex projecting to the west. The sanctuary features original 3" and 3 1/2" heart pine wood floors cut by the Werner Lumber Mill in Tracy City with two sections of pews facing east and a central aisle with red carpet that wraps behind the pews to the Baptistry and main entrance. Centered on the west wall of the sanctuary are oak doors leading to the narthex with a small cross cut out of each. Above these doors is a set of three Tiffany style stained glass windows, each topped in a point with a connecting wood frame. The sanctuary's mansard ceiling features wood slats finished in a dark stain that matches woodwork throughout the interior. The sanctuary walls are plaster with wood slat wainscoting below. The wood pews feature scrolled backs and kneelers with a Celtic cross featured on each end.

Separating the nave, where the congregation sits, from the chancel, is a simple wood chancel screen. Divided into three sections, the screen features arched brackets on each corner with the central section's brackets coming together into a Gothic arch with a crucifix above. The chancel is elevated one step above the nave and includes a pulpit on the left and lectern on the right with the walls behind angling in to allow for the organ room and pipes on the north wall and 1950s addition behind the south wall. Flanking each side of the nave are the choir pews with the original altar carved in 1892 centered on the rear/east wall. Above the altar are three bays of stained glass windows with a central ribbon of three featuring a connecting scene of Jesus as a shepherd. The two individual windows flanking the central windows depict angels. These windows were given to the church by St. Margaret's Altar Guild in 1926 and were selected by a Rose Kunz Quinn, who was a very active member of the church and served several terms as president and secretary of St. Margaret's Altar Guild.¹ The nave of the sanctuary features stained glass windows on each side with vertical rectangular panes of glass in a light blue color with a thin band of gold lining the outside.

¹ Andrews, Christ Episcopal Church, 73.

Christ Episcopal Church
Name of Property

Grundy County, Tennessee
County and State

The red carpet from the sanctuary flows into the baptistery through a Gothic arch doorway with the pine flooring continuing underneath. Inside the baptistery, there is wood paneling that extends from the floor nine feet up the wall, with rectangular wooden window frames surrounding the Gothic arch stained glass windows.

The narthex also features red carpet over pine flooring with faux wood veneer paneled walls and the front entrance projecting into the space. Centered on the north wall is a stained glass window depicting the founder and first Bishop of the congregation, James Harvey Otey. Mirroring this window on the south wall is a stained glass window depicting Saint Cecilia. The ceiling features hand hewn wood beams to support a cathedral ceiling above.

The 1950s addition is made up of four rooms including a choir room, kitchen, office, and meeting room. Each room's walls are covered in paneling made of particleboard and have tiled ceilings. All rooms have brown VCT tile flooring with the exception of the office, which features carpet.

Christ Episcopal Church
 Name of Property

Grundy County, Tennessee
 County and State

8. Statement of Significance

Applicable National Register Criteria

Areas of Significance

Architecture

Period of Significance

1925-1950

Significant Dates

Significant Person

N/A

Cultural Affiliation

N/A

Architect/Builder

N/A

- A Property is associated with events that have made a significant contribution to the broad patterns of our history.
- B Property is associated with the lives of persons significant in our past.
- C Property embodies the distinctive characteristics of a type, period, or method of construction or represents the work of a master, or possesses high artistic values, or represents a significant and distinguishable entity whose components lack individual distinction.
- D Property has yielded, or is likely to yield, information important in prehistory or history.

Criteria Considerations N/A
 (Mark "x" in all the boxes that apply.)
 Property is:

- A Owned by a religious institution or used for religious purposes.
- B removed from its original location.
- C a birthplace or grave.
- D a cemetery.
- E a reconstructed building, object, or structure.
- F a commemorative property.
- G less than 50 years old or achieving significance within the past 50 years.

Christ Episcopal Church
Name of Property

Grundy County, Tennessee
County and State

Statement of Significance Summary Paragraph

Christ Episcopal Church is significant under Criterion C for its high degree of architectural integrity representing the Gothic Revival Style. The church is an excellent local representative of the late Gothic Revival architectural style that was prevalent among many church edifices in the United States during the late nineteenth and early twentieth centuries. The period of significance, from 1925-1950, was chosen to include the later 1950 addition to the church structure that incorporates the Gothic Revival style in its exterior design. The parish house ca. 1952 is included as a non-contributing building because of its separate architectural style and significance to the local history of the church. Because Christ Episcopal Church is significant for its architecture it meets Criterion Consideration A.

Narrative Statement of Significance

Christ Episcopal Church is significant under Criterion C for its representation of Gothic Revival style architecture locally. The Gothic Revival style gained popularity in the late 18th and early 19th century as Europe and the United States entered into the Romantic Movement. This movement proclaimed the superiority of the Christian medieval past and revived the gothic architectural style.² The style is prevalent among many church edifices in the United States built during the late nineteenth and early twentieth centuries. During this period, many church architects, especially while designing Episcopal churches, followed the Gothic Revival style and were strongly influenced by Augustus W. N. Pugin and the English ecclesiologists who promoted the archeologically accurate Gothic parish church, as it was thought to be the only suitable structure for Christian worship.³

Constructed in 1925, the Christ Episcopal Church follows the Episcopalians intention to design a suitable structure for Christian worship in the Gothic Revival style.⁴ The church represents a simple Gothic Revival style in a small rural town with its Gothic arch windows, weatherboards that extend into the gables without a break, and steeply pitched gabled roof with open eave overhands, exposed rafters and brackets.⁵ The church serves as a simplistic version of the architectural style in that it lacks many of the elaborate decorative elements such as the lacy bargeboard and foliated ornamentation that are prevalent in the Gothic Revival style.⁶ Christ Church maintains a high degree of integrity as little has been altered to the church with the exception of two additions to the structure. These include the rear addition for offices, storage, and a kitchen ca. 1950, and a small vestibule added to the rear of the baptistery for handicap accessibility ca. 1974. The Church's stained glass windows also now include glass storm windows to avoid the yellowing of other storm window types. The interior remains virtually untouched from its construction in 1925 and includes original pieces from the 1873 church.

According to the Tennessee Historical Commission's survey of Grundy County, and previous National Register listings, including a multiple property listing for historic resources in Grundy County, Christ Episcopal Church is the only church representative of the Gothic Revival style in the county. Although it is the only church constructed in this style, Tracy City possesses five of the ten Gothic Revival buildings in

²Poppeliers & Chambers, What Style is it, 46.

³ Ibid, 53.

⁴ Episcopal Church Building Completed, Mrs. Grundy, 1.

⁵ Virginia and Lee McAlester, A Field Guide, 197-200.

⁶Poppeliers & Chambers, What Style is it, 48.

Christ Episcopal Church
Name of Property

Grundy County, Tennessee
County and State

Grundy County. From this we can ascertain that the Gothic Revival Style was most prevalent in Tracy City, due to the town being the heart of the coal fields and largest community in the county during the coal and coke industry's peak in the late 19th and early 20th centuries.

Situated in the Sequatchie Valley, approximately 24 miles away from Tracy City, is the town of South Pittsburg (pop. 3,117) in Marion County. Here there are a number of Gothic Revival churches, two of which were constructed around the same time as Christ Church. These churches include the Cumberland Presbyterian Church ca. 1920 and the Holly Ave. Methodist Church ca. 1930. Both of these churches differ drastically from Christ Church in that they are both made of brick, do not feature bell towers, and have much larger massing and scale. Earlier churches from the late 19th century in South Pittsburg are more comparable to Christ Church in Tracy City. Similar stylistic elements can be found in the Christ Episcopal Church ca. 1882-84 (NR-listed 22 August 1977). Christ Episcopal Church in South Pittsburg not only carries the same name as Christ Church in Tracy, but is similar in materials, style, form, and features. The most striking similarity is the bell tower that also features louvered vents and a square tower roof with multileveled flared eaves topped with a decorative cross finial. Other similarities include weatherboard siding, Gothic arch stained glass windows, a cross gabled roof, and exposed rafters. Because South Pittsburg has a greater population than Tracy City, the church has a much larger footprint to accommodate a bigger congregation. Other differences include flared eaves and Gothic arch windows throughout, verge boards on the gabled roof entrance porches, and no stone features. Christ Church in Tracy city remains the only example of a church of its size and style in the surrounding area located in a small rural town.

Early Church History

Christ Church is the oldest continuously operating Episcopal Church on the Cumberland Plateau and was the first church in Tracy City, TN.⁷ At the time Tracy City was a frontier town that was fueled by coal and timber. The first Episcopal services held in Tracy City on August 30th 1868 were due to the efforts of a Mrs. Wesley, who in 1867 wrote to Bishop Quintard requesting that a missionary be sent to them.⁸ The Rev. F.L. Knight from Sewanee Divinity School, University Place, reported later that year on May 15, 1867, "I have regular services at "Lower Coal Banks" and am invited to arrange for services at Tracy City."⁹

Because there was no church building of any kind, the service was held in a sawmill shed across from the railroad depot. The pulpit and altar were makeshift and the congregation sat on logs or stood. The Rt. Rev. Charles Tod Quintard, bishop of the Diocese of Tennessee, conducted the service. A dear friend, the Rt. Rev. Alexander Greg, bishop of Texas, assisted him along with other clergy from the seminary at the University of the South at Sewanee. This is established in Bishop Tod Quintard's diary, read by him in address to the clergy and laity assembled in Convention of the Diocese at Clarksville, Tennessee, May 26, 1869.

The 12th Sunday after Trinity, 1868 accompanied by the Right Reverend, the Bishop of Texas, (Rt. Rev. Alexander Gregg) and the Rev. Dr. Knight. I visited Tracy City, a distance of 12 miles from University Place. No more fitting place being available, we were forced to gather a congregation in an open mill. The

⁷ Milestones of a Mountain Mission, 1.

⁸ Matlock, Christ Church, 1.

⁹ Ibid

Christ Episcopal Church
Name of Property

Grundy County, Tennessee
County and State

appointments and surroundings were not all that could be desired, but the people gladly heard the Word preached. I officiated in the morning, assisted by Dr. Knight and by the Bishop of Texas in the afternoon.¹⁰

Bishop Quintard also served as vice chancellor of the University of Sewanee, beginning a long and enduring relationship between Christ Church and the seminary at Sewanee. Worship was held in the sawmill until a community structure, Temperance Hall, was built for all denominations to use.¹¹ Services were held in this building by Bishop Quintard, the Rev. W.P. DuBose, Rev. F.A. Shoup, Milner Jones and others.¹²

In 1873 local Episcopalians erected their own church- the town's first- under the leadership of Milnor Jones, a theology student at Sewanee, chiefly through the efforts of three widowed sisters Mesdames Nance, Randolph and Garner. He was among countless Sewanee seminarians who trekked to Tracy City by train, horseback and foot to conduct services at the mountain mission.¹³

By 1887 church services were held regularly, the building had been greatly improved, and a deed to the property for the sum of one dollar from the Tennessee Coal and Iron co. made around twelve years prior on September 15, 1881,¹⁴ was placed for registration on June 2nd.¹⁵ The congregation raised money in 1889 to further improve the church and construct a vestibule and belfry. Even with these improvements completed, a movement was now underway to build a new church of stone.¹⁶

In 1891 the church began to feel a sense of stability when Rev. Henry Easter arrived. Rev. Easter was a master carver who served as a devoted priest of Christ Church until 1896. While there he carved an altar, bishop's chair, priest's chair and desk, lectern, and communion rail, all of which are present in the church today and were in memory of his mother.¹⁷

Over the years, under the direction of Christ Church priests, missions were established and services held at Good Shepherd at Foster Falls, St. Albans at Coalmont and St. Vernard at Gruetli with the rector at Tracy City in charge.

The congregation's original church building was destroyed by a storm, but was replaced soon after in 1925 with the present building.¹⁸ In 1968, the church congregation celebrated its Centennial Anniversary.¹⁹

Today the Christ Episcopal Church remains a significant part of Tracy City's religious and cultural history. The congregation takes pride in this history, as well as the preservation of the church building itself. The congregation has been tireless in its efforts to preserve the church throughout the years, restoring stain glass windows and maintaining the overall building. The Christ Episcopal Church stands as a physical reminder of

¹⁰ Parrott, Heritage of Grundy, 72.

¹¹ Ibid, 73.

¹² Matlock, Christ Church, 2.

¹³ Milestones of a Mountain Mission, 1.

¹⁴ Grundy County Deed Book 1, 588.

¹⁵ Ibid, 589.

¹⁶ Matlock, Christ Church, 3.

¹⁷ Milestones of a Mountain Mission, 1.

¹⁸ Episcopal Church Building Completed, Mrs. Grundy, 1.

¹⁹ Andrews, Christ Episcopal Church, 73.

Christ Episcopal Church
Name of Property

Grundy County, Tennessee
County and State

the town's religious establishment and relationship with the University of Sewanee seminary and a period of prosperity in Tracy City, Tennessee.

Christ Episcopal Church
 Name of Property

Grundy County, Tennessee
 County and State

9. Major Bibliographic References

Bibliography

Elaine Andrews, "Christ Episcopal Church Tracy City," in *The Heritage of Grundy County, TN*, (Waynesville, NC: County Heritage Inc., 2004,) 73.

"Episcopal Church Building Completed," *Mrs. Grundy*, Vol. 39, No. 1, January 22, 1925.

James Parrott, "Christ Church Episcopal Established 12th Sunday After Trinity 1868," in *The Heritage of Grundy County, TN*, (Waynesville, NC: County Heritage Inc., 2004,) 72-73.

John C. Poppeliers and S. Allen Chambers Jr., *What Style is it: A Guide to American Architecture* (John Wiley and Sons, Inc., Hoboken, New Jersey, 2003).

"Many Visitors Help Christ Church Celebrate Centennial," *Grundy County Herald*, Volume 39 Number 12, 1968.

Milestones of a Mountain Mission: A Brief History of Christ Church Tracy City, Tennessee.

Rev. J.W. Matlock, "Christ Church," 1978.

Virginia and Lee McAlester, *A Field Guide to American Houses* (New York: Alfred A. Knopf, Inc., 1984, 2009).

Previous documentation on file (NPS):		Primary location of additional data:	
preliminary determination of individual listing (36 CFR 67 has been requested)			State Historic Preservation Office
previously listed in the National Register			Other State agency
previously determined eligible by the National Register			Federal agency
designated a National Historic Landmark			Local government
recorded by Historic American Buildings Survey #			University
recorded by Historic American Engineering Record #			Other
recorded by Historic American Landscape Survey #		Name of repository:	
Historic Resources Survey Number (if assigned):			

Christ Episcopal Church
Name of Property

Grundy County, Tennessee
County and State

10. Geographical Data

Acreage of Property 1 acre **USGS Quadrangle** Tracy City

Latitude/Longitude Coordinates

Latitude: 35.258014

Longitude: -85.737570

Verbal Boundary Description

Christ Episcopal Church is located at 530 10th Street on Parcel 1 of Grundy County Tax Map 102K. The boundaries include one acre of the southern half of this parcel beginning at the northeast corner of Fifth and Tenth Streets running with the line of Fifth Street east 130' to the southwest corner of parcel 4, thence north 223' to the northwesterly corner of parcel 4; thence 115' west to the line of Tenth Street; thence south along Tenth Street to the beginning point.

Boundary Justification

The boundaries were selected to follow the 1887 description of the property deeded to the Protestant Episcopal Church in the State of Tennessee, with the boundaries slightly modified to follow the current parcel boundary lines.

Christ Episcopal Church
Name of Property

Grundy County, Tennessee
County and State

CHRIST EPISCOPAL CHURCH
530 10th St, Tracy City, TN 37387



Christ Episcopal Church
Name of Property

Grundy County, Tennessee
County and State

CHRIST EPISCOPAL CHURCH
530 10th St, Tracy City, TN 37387



Christ Episcopal Church
Name of Property

Grundy County, Tennessee
County and State

11. Form Prepared By

Name Melissa Mortimer
Organization Southeast Tennessee Development District
Street & Number 1000 Riverfront Parkway Date _____
City or Town Chattanooga Telephone 423-424-4266
E-mail mmortimer@sedev.org State TN Zip Code 37402

Additional Documentation

Submit the following items with the completed form:

- **Maps:** A **USGS map** or equivalent (7.5 or 15 minute series) indicating the property's location.
- **Sketch map** for historic districts and properties having large acreage or numerous resources. Key all photographs to map.
- **Photographs** (refer to Tennessee Historical Commission National Register *Photo Policy* for submittal of digital images and prints)
- **Additional items:** (additional supporting documentation including historic photographs, historic maps, etc. should be included on a Continuation Sheet following the photographic log and sketch maps)

Paperwork Reduction Act Statement: This information is being collected for applications to the National Register of Historic Places to nominate properties for listing or determine eligibility for listing, to list properties, and to amend existing listings. Response to this request is required to obtain a benefit in accordance with the National Historic Preservation Act, as amended (16 U.S.C.460 et seq.).
Estimated Burden Statement: Public reporting burden for this form is estimated to average 100 hours per response including time for reviewing instructions, gathering and maintaining data, and completing and reviewing the form. Direct comments regarding this burden estimate or any aspect of this form to the Office of Planning and Performance Management, U.S. Dept. of the Interior, 1849 C. Street, NW, Washington, DC.

Christ Episcopal Church
Name of Property

Grundy County, Tennessee
County and State

Photo Log

Name of Property: Christ Episcopal Church
City or Vicinity: Tracy City
County: Grundy State: Tennessee
Photographer: Melissa Mortimer
Date Photographed: June 9, 2014

Description of Photograph(s) and number, include description of view indicating direction of camera:

- 1 of 25 Front/ west façade. Photographer facing northeast.
- 2 of 25 Front vestibule. Photographer facing east.
- 3 of 25 Front/west façade. Photographer facing southeast.
- 4 of 25 South façade. Photographer facing northeast.
- 5 of 25 Baptistery and 1974 handicap entrance. Photographer facing northwest.
- 6 of 25 Rear/east façade. Photographer facing northeast.
- 7 of 25 Rear/east façade. Photographer facing southwest.
- 8 of 25 North façade. Photographer facing southwest.
- 9 of 25 West façade and view of site. Photographer facing southeast.
- 10 of 25 View of site and Parish House location. Photographer facing northeast.
- 11 of 25 Parish House circa 1950. Photographer facing northeast.
- 12 of 25 View of site parking lot and stone wall. Photographer facing northeast
- 13 of 25 Rear of Parish House. Photographer facing northwest.
- 14 of 25 Sanctuary interior. Photographer facing east.
- 15 of 25 Sanctuary altar. Photographer facing east.
- 16 of 25 Organ and Choir seating. Photographer facing northeast.
- 17 of 25 Sanctuary. Photographer facing east.
- 18 of 25 Detail of Sanctuary chancel screen. Photographer facing east.

Christ Episcopal Church
Name of Property

Grundy County, Tennessee
County and State

-
- 19 of 25 Sanctuary pews. Photographer facing southeast.
- 20 of 25 Tiffany style windows in Sanctuary. Photographer facing west.
- 21 of 25 Sanctuary stained glass window. Photographer facing north.
- 22 of 25 Ceiling detail in narthex. Photographer facing west.
- 23 of 25 Sanctuary. Photographer facing northwest.
- 24 of 25 Gothic arch leading into Baptistery. Photographer facing south.
- 25 of 25 Baptistery. Photographer facing southwest.

Christ Episcopal Church
Name of Property

Grundy County, Tennessee
County and State

Site Plan and Photo Key

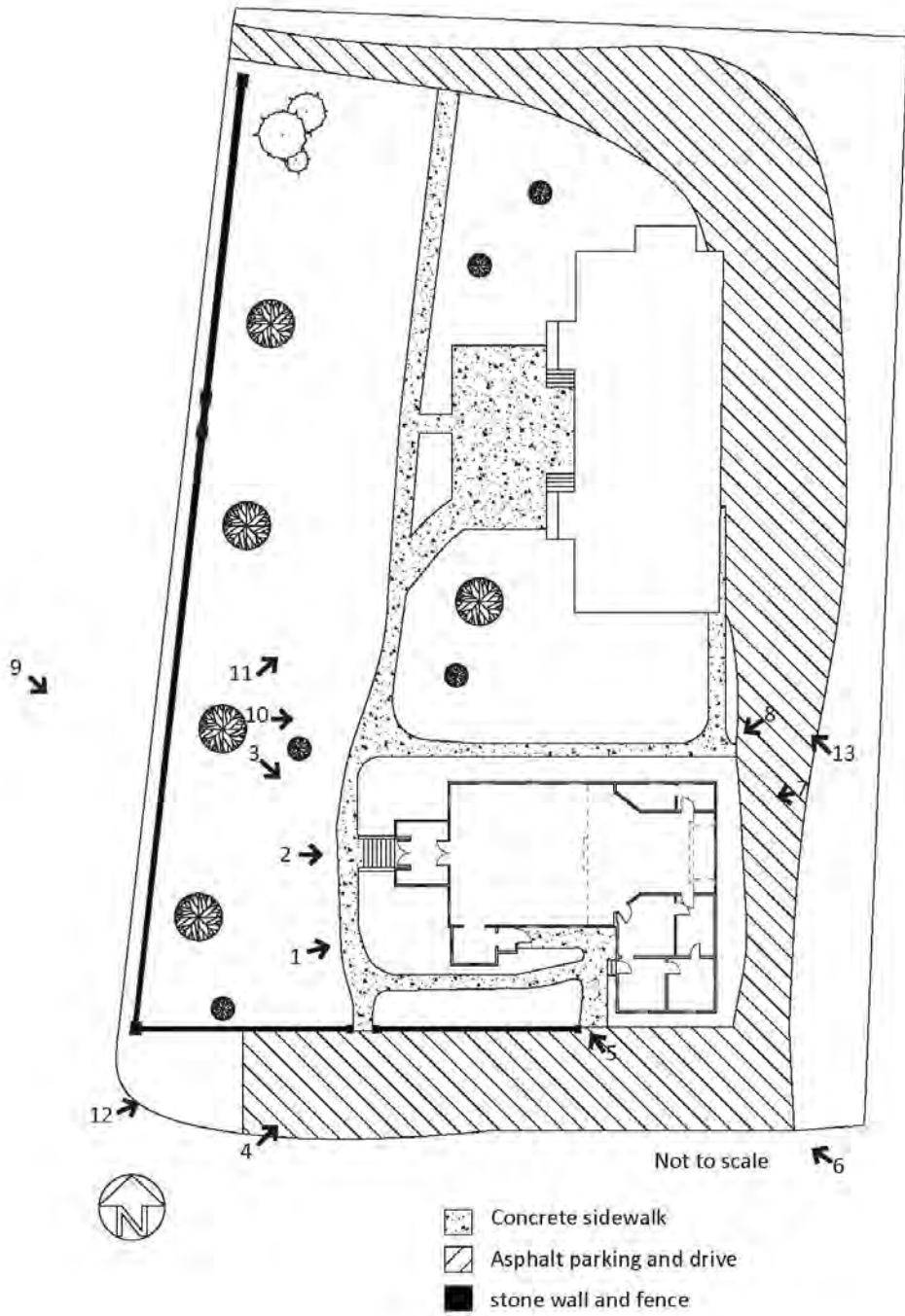

Christ Episcopal Church
Name of Property

Grundy County, Tennessee
County and State

Floor Plan and Photo Key

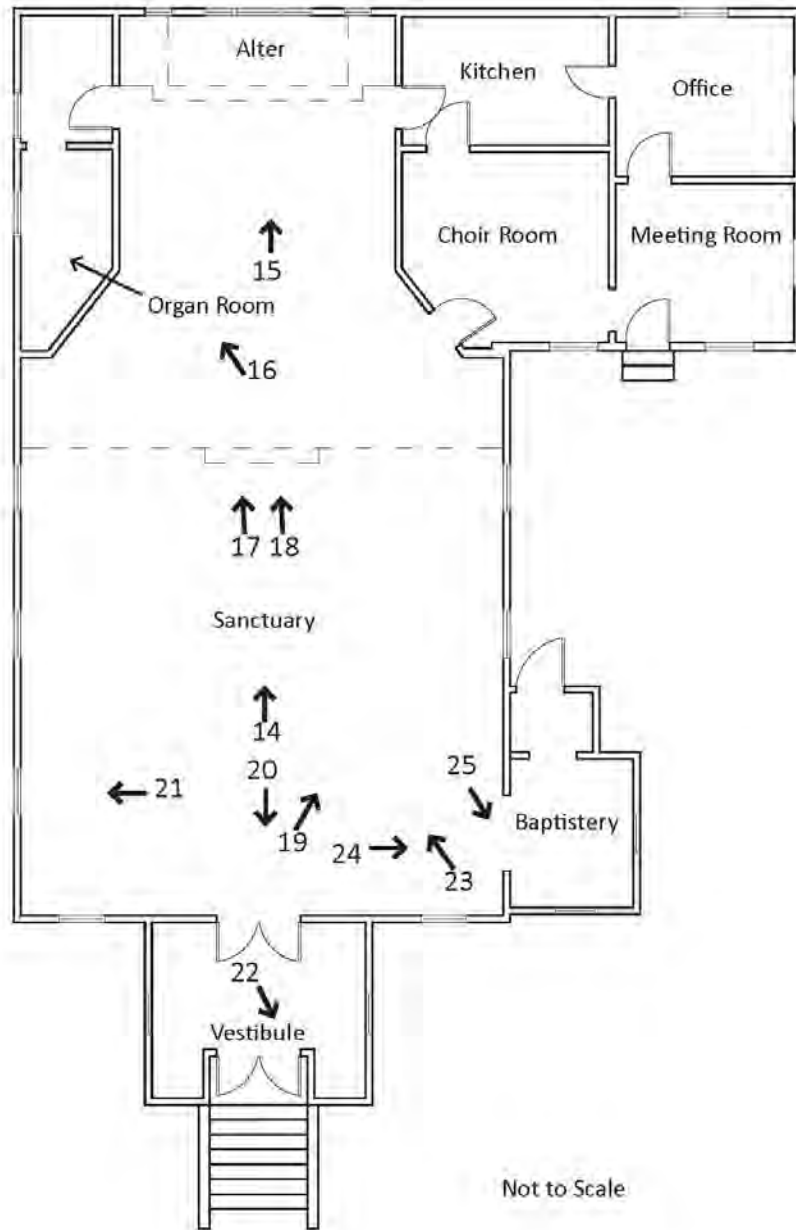





C RIST
CHURCH
EPISCOPAL



CHURCH OF THE HOLY TRINITY





































Small, illegible label or plaque located below the window.









UNITED STATES DEPARTMENT OF THE INTERIOR
NATIONAL PARK SERVICE

NATIONAL REGISTER OF HISTORIC PLACES
EVALUATION/RETURN SHEET

REQUESTED ACTION: NOMINATION

PROPERTY NAME: Christ Episcopal Church

MULTIPLE NAME:

STATE & COUNTY: TENNESSEE, Grundy

DATE RECEIVED: 3/13/15 DATE OF PENDING LIST: 4/08/15
DATE OF 16TH DAY: 4/23/15 DATE OF 45TH DAY: 4/28/15
DATE OF WEEKLY LIST:

REFERENCE NUMBER: 15000186

REASONS FOR REVIEW:

APPEAL: N DATA PROBLEM: N LANDSCAPE: N LESS THAN 50 YEARS: N
OTHER: N PDIL: N PERIOD: N PROGRAM UNAPPROVED: N
REQUEST: Y SAMPLE: N SLR DRAFT: N NATIONAL: N

COMMENT WAIVER: N

ACCEPT RETURN REJECT 4-24-2015 DATE

ABSTRACT/SUMMARY COMMENTS:

SLR - Δ Pos.

RECOM./CRITERIA Accept C

REVIEWER _____ DISCIPLINE _____

TELEPHONE _____ DATE _____

DOCUMENTATION see attached comments Y/N Y see attached SLR Y/N Y

If a nomination is returned to the nominating authority, the nomination is no longer under consideration by the NPS.



TENNESSEE HISTORICAL COMMISSION
STATE HISTORIC PRESERVATION OFFICE
2941 LEBANON ROAD
NASHVILLE, TENNESSEE 37214
OFFICE: (615) 532-1550
www.tnhistoricalcommission.org
E-mail: Claudette.Stager@tn.gov
(615) 532-1550, ext. 105
<http://www.tn.gov/environment/history>



February 12, 2015

J. Paul Loether
Deputy Keeper and Chief
National Register and National Historic Landmark Programs
National Register of Historic Places
1201 Eye St. NW, 8th Fl.
Washington D.C. 20005

Dear Mr. Loether:

Enclosed please find the documentation to nominate *Christ Episcopal Church* to the National Register of Historic Places. The enclosed disk contains the true and correct copy of the nomination for the *Christ Episcopal Church* to the National Register of Historic Places.

If you have any questions or if more information is needed, please contact Christine Mathieson at (615) 770-1086 or Christine.Mathieson@tn.gov.

Sincerely,

Claudette Stager
Deputy State Historic Preservation Officer

CS:cm

Enclosures(4)