

**United States Department of the Interior  
Heritage Conservation and Recreation Service**

**National Register of Historic Places  
Inventory—Nomination Form**

See instructions in *How to Complete National Register Forms*  
Type all entries—complete applicable sections

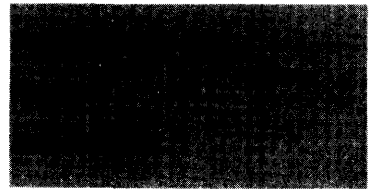

## 1. Name

historic Unknown

~~and/or~~ common Green Shutters

## 2. Location

street & number ~~1 block east of Illinois Central Railroad on Franklin St., not for publication~~ N/A

city, town Tangipahoa N/A vicinity of congressional district 6th - Henson Moore

state LA code 22 parish Tangipahoa code 105  
~~county~~

## 3. Classification

Category	Ownership	Status	Present Use
<input type="checkbox"/> district	<input type="checkbox"/> public	<input checked="" type="checkbox"/> occupied	<input type="checkbox"/> agriculture
<input checked="" type="checkbox"/> building(s)	<input checked="" type="checkbox"/> private	<input type="checkbox"/> unoccupied	<input type="checkbox"/> commercial
<input type="checkbox"/> structure	<input type="checkbox"/> both	<input type="checkbox"/> work in progress	<input type="checkbox"/> educational
<input type="checkbox"/> site	<b>Public Acquisition</b>	<b>Accessible</b>	<input checked="" type="checkbox"/> private residence
<input type="checkbox"/> object	<input checked="" type="checkbox"/> in process	<input checked="" type="checkbox"/> yes: restricted	<input type="checkbox"/> religious
	<input checked="" type="checkbox"/> being considered	<input type="checkbox"/> yes: unrestricted	<input type="checkbox"/> scientific
		<input type="checkbox"/> no	<input type="checkbox"/> transportation
			<input type="checkbox"/> other:

## 4. Owner of Property

name Mrs. Eunice L. Catha and Miss Norma Lambert

street & number P. O. Box 256

city, town Tangipaha N/A vicinity of state LA 70465

## 5. Location of Legal Description

courthouse, registry of deeds, etc. Tangipahoa Parish Courthouse

street & number P. O. Box 667 Mulberry and Bay Streets (no specific no.)

city, town Amite state LA 70422

## 6. Representation in Existing Surveys

title LA Historic Sites Survey has this property been determined eligible?  yes  no

date 1980  federal  state  county  local

depository for survey records Louisiana State Historic Preservation Office

city, town Baton Rouge state LA

---

## 7. Description

---

<b>Condition</b>		<b>Check one</b>	<b>Check one</b>
<input type="checkbox"/> excellent	<input type="checkbox"/> deteriorated	<input type="checkbox"/> unaltered	<input checked="" type="checkbox"/> original site
<input checked="" type="checkbox"/> good	<input type="checkbox"/> ruins	<input checked="" type="checkbox"/> altered	<input type="checkbox"/> moved date <u>N/A</u>
<input type="checkbox"/> fair	<input type="checkbox"/> unexposed		

---

### Describe the present and original (if known) physical appearance

Green Shutters (c.1850) is a provincial Greek Revival cottage located southeast of the center of the village of Tangipahoa. The setting is essentially semi-rural. At one time the house was approached via an alley of trees. All but three of these are gone and a paved road now runs in front of the house. The house has suffered little loss of integrity.

Green Shutters is a frame raised cottage with circular sawn pegged timbers and a central hall plan two rooms deep. There is also a rear kitchen wing. Windows are six over six and the two front rooms have aedicule motif mantels. The five bay facade is articulated with six attenuated posts which have molded capitals and a central front door which has a full aedicule motif with transom and side lights.

In the 1940's the following changes were made:

1. The sides and rear of the house were recovered in asbestos siding.
2. The rear porch was enclosed.
3. A side carport was added.
4. Six steel awnings were attached on the side.
5. Certain superficial interior changes were made. These include the installation of notty pine paneling in the two front rooms either side of the hall and the installation of plywood paneling on the lower half of the central hall walls.

### Assessment of Integrity

Despite these changes, the house retains enough significance to merit Register listing. The house is significant as an example of an early Louisiana archetype. The salient characteristics of this type are still clearly discernible even to the casual observer.

Adjacent to the house is a brick cistern which is not related to the basic architectural significance of the property. However, because it is so close to the house, it would have been difficult to exclude it from the nominated area.

## 8. Significance

Period	Areas of Significance—Check and justify below			
<input type="checkbox"/> prehistoric	<input type="checkbox"/> archeology-prehistoric	<input type="checkbox"/> community planning	<input type="checkbox"/> landscape architecture	<input type="checkbox"/> religion
<input type="checkbox"/> 1400–1499	<input type="checkbox"/> archeology-historic	<input type="checkbox"/> conservation	<input type="checkbox"/> law	<input type="checkbox"/> science
<input type="checkbox"/> 1500–1599	<input type="checkbox"/> agriculture	<input type="checkbox"/> economics	<input type="checkbox"/> literature	<input type="checkbox"/> sculpture
<input type="checkbox"/> 1600–1699	<input checked="" type="checkbox"/> architecture	<input type="checkbox"/> education	<input type="checkbox"/> military	<input type="checkbox"/> social/ humanitarian
<input type="checkbox"/> 1700–1799	<input type="checkbox"/> art	<input type="checkbox"/> engineering	<input type="checkbox"/> music	<input type="checkbox"/> theater
<input checked="" type="checkbox"/> 1800–1899	<input type="checkbox"/> commerce	<input type="checkbox"/> exploration/settlement	<input type="checkbox"/> philosophy	<input type="checkbox"/> transportation
<input type="checkbox"/> 1900–	<input type="checkbox"/> communications	<input type="checkbox"/> industry	<input type="checkbox"/> politics/government	<input type="checkbox"/> other (specify)
		<input type="checkbox"/> invention		

**Specific dates** c. 1850 **Builder/Architect** not known

**Statement of Significance (in one paragraph)** Criterion C

Green Shutters is locally significant in the area of architecture because it is a landmark in the architectural heritage of Tangipahoa Parish. It is one of the oldest structures in the parish and one of the few remaining examples of the Greek Revival style.

Tangipahoa Parish was traversed by the New Orleans, Jackson and Great Northern Railroad in the early 1850's and towns such as Tangipahoa were established at ten mile intervals along the line. However, there are almost no structures remaining from this early period. Most of the extant historic buildings in the parish date from the late-nineteenth or early-twentieth centuries. Green Shutters is one of approximately six Greek Revival structures remaining in the parish. In addition, as far as the State Historic Preservation Office is aware, it is also the parish's only example of a Greek Revival raised cottage. Given the above, Green Shutters has a special place in the patrimony of Tangipahoa Parish.

### Historical Sketch

The name of the builder of Green Shutters is not known. Judging from the architectural evidence, it dates from c.1850. According to tradition, Confederate soldiers from nearby Camp Moore were brought to the house to recuperate. The house passed through several owners after the war until it was purchased in 1900 by Dr. John W. Lambert, a local family physician. Lambert lived there until his death in 1931, and the house has remained in his family since. It is presently owned by his two daughters.

## 9. Major Bibliographical References

Research Report submitted by owners, located in Green Shutters National Register file, Louisiana State Historic Preservation Office, Baton Rouge, Chain of Title, Tangipahoa Parish Courthouse.

## 10. Geographical Data

Acreeage of nominated property approx. .3 acre  
Quadrangle name Kentwood, La./Miss.

Quadrangle scale 1:62,500

### UMT References

A 

1	5	7	3	8	1	5	0	3	4	1	8	0	8	5
Zone			Easting				Northing							

B 

Zone			Easting				Northing							

C 

Zone			Easting				Northing							

D 

Zone			Easting				Northing							

E 

Zone			Easting				Northing							

F 

Zone			Easting				Northing							

G 

Zone			Easting				Northing							

H 

Zone			Easting				Northing							

### Verbal boundary description and justification

See attached sketch map.

### List all states and counties for properties overlapping state or county boundaries

state	code	county	code
N/A			

state	code	county	code
-------	------	--------	------

## 11. Form Prepared By

name/title Mrs. Eunice L. Catha and Miss Norma Lambert

organization N/A date December 1980

street & number P. O. Box 256 telephone (504) 229-6348

city or town Tangipahoa state LA 70465

## 12. State Historic Preservation Officer Certification

The evaluated significance of this property within the state is:

national  state  local

As the designated State Historic Preservation Officer for the National Historic Preservation Act of 1966 (Public Law 89-665), I hereby nominate this property for inclusion in the National Register and certify that it has been evaluated according to the criteria and procedures set forth by the Heritage Conservation and Recreation Service.

State Historic Preservation Officer signature 

Robert B. DeBlieux

title State Historic Preservation Officer date June 25, 1982

For HCRS use only

I hereby certify that this property is included in the National Register



date 8.11.82

Keeper of the National Register

Attest:

date

Chief of Registration

# GREEN SHUTTERS

NOTE: SITE BOUNDARIES  
PARALLEL BLDG. FACADES  
AT DISTANCES SHOWN.

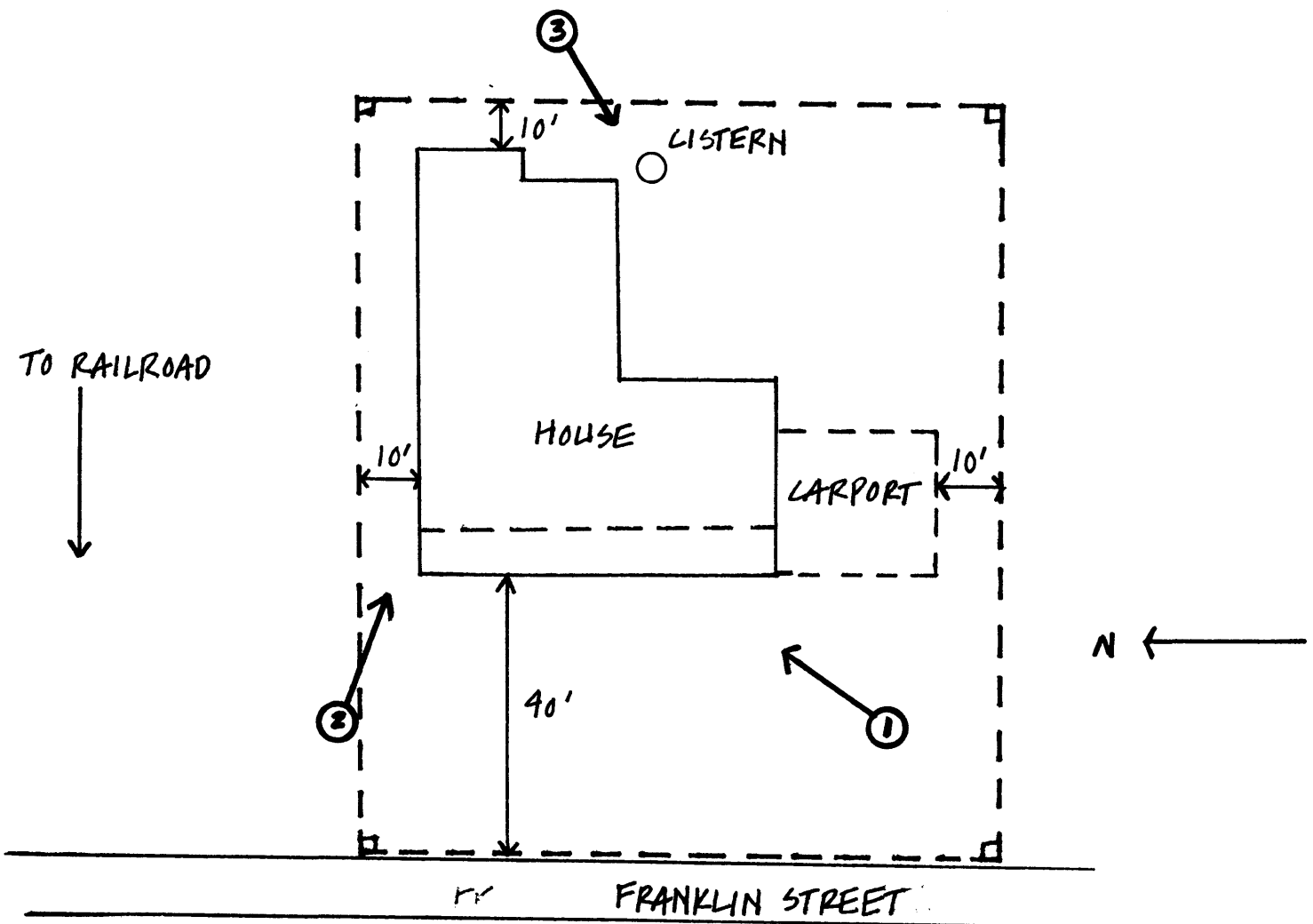

SCALE: APPROX.  $\frac{3}{8}'' = 10'$