

6th

Denver Park and Parkway System (Theme Resource)
 Denver County, CO

Scale: 1"=200' Date: Unknown
 By: City and County of Denver

Exhibit A, Map 1 of 4 sections.
 MONACO STREET PARKWAY. Boundaries shown in
 red. Photos shown in red circles

SE



Denver Park and Parkway System (Theme Resource)
 Denver County, CO
 Scale: 1"=200' Date: Unknown
 By: City and County of Denver
 Exhibit A. Map 2 of 4 sections.

Monaco Street Parkway. Boundaries shown in red. Photos shown in red circles.

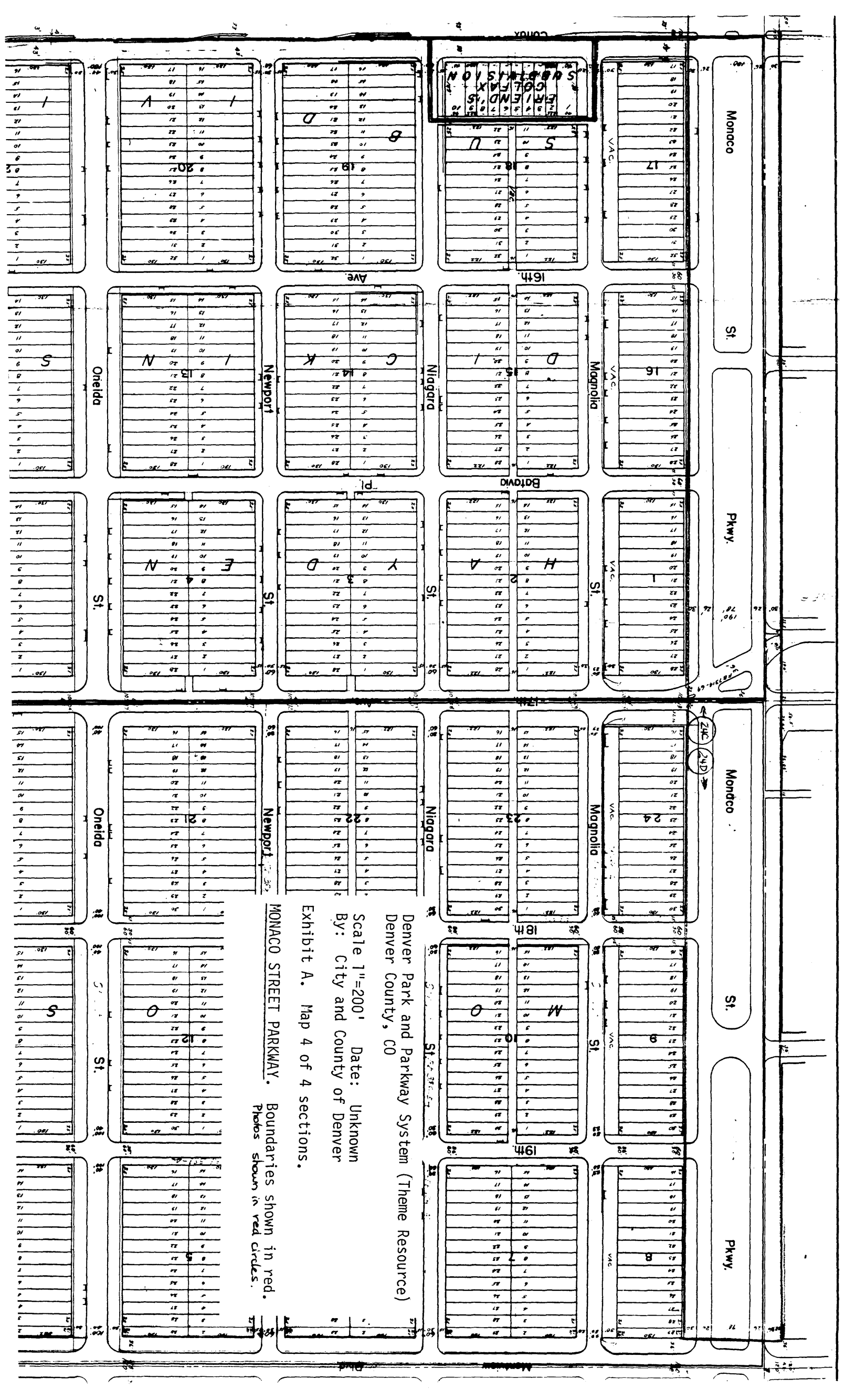

Denver Park and Parkway System (Theme Resource)
 Denver County, CO

Scale 1"=200' Date: Unknown
 By: City and County of Denver

Exhibit A. Map 4 of 4 sections.

MONACO STREET PARKWAY. Boundaries shown in red.
 Plots shown in red circles.

SPECIAL EXEMPTION

Monaco

St.

Pkwy.

Monaco

St.

Pkwy.

Onaida

St.

Onaida

St.

Newport

St.

Newport

St.

Niagara

St.

Niagara

St.

Magnolia

St.

Magnolia

St.

Ave

Onaida

St.

Onaida

St.

Ave

Newport

St.

Newport

St.

Ave

Niagara

St.

Niagara

St.

Ave

Magnolia

St.

Magnolia

St.

1

2

3

4

5

6

7

8

9

10

11

12

13

14

15

16

17

18

19

20

21

22

23

24

25

26

27

28

29

30

31

32

33

1

2

3

4

5

6

7

8

9

10

11

12

13

14

15

16

17

18

19

20

21

22

23

24

25

26

27

28

29

30

31

32

33

1

2

3

4

5

6

7

8

9

10

11

12

13

14

15

16

17

18

19

20

21

22

23

24

25

26

27

28

29

30

31

32

33

1

2

3

4

5

6

7

8

9

10

11

12

13

14

15

16

17

18

19

20

21

22

23

24

25

26

27

28

29

30

31

32

33

1

2

3

4

5

6

7

8

9

10

11

12

13

14

15

16

17

18

19

20

21

22

23

24

25

26

27

28

29

30

31

32

33

1

2

3

4

5

6

7

8

9

10

11

12

13

14

15

16

17

18

19

20

21

22

23

24

25

26

27

28

29

30

31

32

33

1

2

3

4

5

6

7

8

9

10

11

12

13

14

15

16

17

18

19

20

21

22

23

24

25

26

27

28

29

30

31

32

33

1

2

3

4

5

6

7

8

9

10

11

12

13

14

15

16

17

18

19

20

21

22

23

24

25

26

27

28

29

30

31

32

33

1

2