

**United States Department of the Interior
Heritage Conservation and Recreation Service**

**National Register of Historic Places
Inventory—Nomination Form**

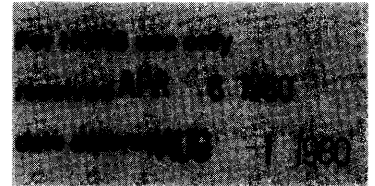

See instructions in *How to Complete National Register Forms*
Type all entries—complete applicable sections

1. Name

historic Hart House

and/or common same

2. Location

street & number at the northern terminus of Iowa St. not for publication

city, town Baton Rouge vicinity of congressional district 6th-Henson Moore

state La. code 022 county East Baton Rouge Parish code 033

3. Classification

Category	Ownership	Status	Present Use	
<input type="checkbox"/> district	<input type="checkbox"/> public	<input checked="" type="checkbox"/> occupied	<input type="checkbox"/> agriculture	<input type="checkbox"/> museum
<input checked="" type="checkbox"/> building(s)	<input checked="" type="checkbox"/> private	<input type="checkbox"/> unoccupied	<input type="checkbox"/> commercial	<input type="checkbox"/> park
<input type="checkbox"/> structure	<input type="checkbox"/> both	<input type="checkbox"/> work in progress	<input type="checkbox"/> educational	<input checked="" type="checkbox"/> private residence
<input type="checkbox"/> site	Public Acquisition	Accessible	<input type="checkbox"/> entertainment	<input type="checkbox"/> religious
<input type="checkbox"/> object	<input type="checkbox"/> in process	<input checked="" type="checkbox"/> yes: restricted	<input type="checkbox"/> government	<input type="checkbox"/> scientific
	<input type="checkbox"/> being considered	<input type="checkbox"/> yes: unrestricted	<input type="checkbox"/> industrial	<input type="checkbox"/> transportation
		<input type="checkbox"/> no	<input type="checkbox"/> military	<input type="checkbox"/> other:

4. Owner of Property

name Baton Rouge Recreation and Parks Commission

street & number P. O. Box 15887

city, town Baton Rouge vicinity of state Louisiana 70895

5. Location of Legal Description

courthouse, registry of deeds, etc. East Baton Rouge Parish Courthouse

street & number

city, town Baton Rouge vicinity of state La.

6. Representation in Existing Surveys

title Louisiana Historic Sites Survey has this property been determined eligible? yes no

date 1979 federal state county local

depository for survey records State Historic Preservation Office

city, town Baton Rouge vicinity of state La.

7. Description

Condition		Check one	Check one
<input type="checkbox"/> excellent	<input type="checkbox"/> deteriorated	<input type="checkbox"/> unaltered	<input checked="" type="checkbox"/> original site
<input checked="" type="checkbox"/> good	<input type="checkbox"/> ruins	<input checked="" type="checkbox"/> altered	<input type="checkbox"/> moved date _____
<input type="checkbox"/> fair	<input type="checkbox"/> unexposed		

Describe the present and original (if known) physical appearance

The Hart house is set in a private garden in a mid-twentieth century residential area of Baton Rouge. Boundaries were drawn to include the garden, the house, a late-nineteenth century gazebo and an old board and batten garage.

The house itself is a one and one-half story, frame Queen Anne Revival structure with a partial "wrap around" front gallery and a large central semi-octagonal dormer. The plan is centered around an "L" shaped hall which encompasses a rear living room with an elaborate Colonial Revival mantel. There are three bedrooms with replaced mantels and a rear kitchen-dining room wing.

This rear wing was substantially enlarged in the mid-twentieth century. Other changes made at that time include: (1) the addition of a bathroom on the side gallery; (2) the replacement of the gallery floor; (3) the replacement of window and door cornices on the front facade; and (4) the addition of a cast iron door and ballustrade. Despite these changes the house still conveys a turn-of-the-century appearance.

8. Significance

Period	Areas of Significance—Check and justify below			
<input type="checkbox"/> prehistoric	<input type="checkbox"/> archeology-prehistoric	<input type="checkbox"/> community planning	<input type="checkbox"/> landscape architecture	<input type="checkbox"/> religion
<input type="checkbox"/> 1400-1499	<input type="checkbox"/> archeology-historic	<input type="checkbox"/> conservation	<input type="checkbox"/> law	<input type="checkbox"/> science
<input type="checkbox"/> 1500-1599	<input type="checkbox"/> agriculture	<input type="checkbox"/> economics	<input type="checkbox"/> literature	<input type="checkbox"/> sculpture
<input type="checkbox"/> 1600-1699	<input type="checkbox"/> architecture	<input type="checkbox"/> education	<input type="checkbox"/> military	<input type="checkbox"/> social/
<input type="checkbox"/> 1700-1799	<input type="checkbox"/> art	<input type="checkbox"/> engineering	<input type="checkbox"/> music	<input type="checkbox"/> humanitarian
<input type="checkbox"/> 1800-1899	<input type="checkbox"/> commerce	<input type="checkbox"/> exploration/settlement	<input type="checkbox"/> philosophy	<input type="checkbox"/> theater
<input checked="" type="checkbox"/> 1900-	<input type="checkbox"/> communications	<input type="checkbox"/> industry	<input checked="" type="checkbox"/> politics/government	<input type="checkbox"/> transportation
		<input type="checkbox"/> invention		<input type="checkbox"/> other (specify)

Specific dates c. 1904 **Builder/Architect** Builder-Robert A. Hart

Statement of Significance (in one paragraph) Criterion B

The Hart House is historically significant due to its association with Robert A. Hart, a prominent Baton Rouge businessman and land developer who was mayor of the city from 1898 until 1902. Hart purchased Magnolia Mound Plantation in 1904, but never occupied the old home himself. He chose instead to have the home now known as the Hart House built nearby as his residence.

Baton Rouge was incorporated in 1898 and Hart was the first mayor of the newly incorporated city. A lifelong resident of Baton Rouge, Hart was highly esteemed by his contemporaries. A 1901 source included the following assessment: "Mayor Robert A. Hart, the guiding financier of city affairs, is thoroughly a man of the people of Baton Rouge, and it has been partly through his keen business instincts that matters of city improvement have progressed most successfully." Hart died in Baton Rouge in 1939. The first line of his obituary read: "There passed away yesterday a gentleman who knew Baton Rouge as do few of this generation." For these reasons, it seems quite obvious that Hart was a locally prominent individual and that his house, therefore, is locally significant.

9. Major Bibliographical References

Baton Rouge State Times, May 26, 1939.

Elks' Souvenir of Baton Rouge, 1901.

Research Report Prepared by Marion Hart LeBlanc, located in Hart House National Register File, State Historic Preservation Office, Baton Rouge.

~~Vertical File, Baton Rouge Mayors, Louisiana Room, LSU Library, Baton Rouge.~~

10. Geographical Data

UTM NOT VERIFIED

ACREAGE NOT VERIFIED

Acreeage of nominated property approx. 4.5 acres

Quadrangle name _____

Quadrangle scale _____

UMT References

A

1	6	6	7	4	2	3	0	3	3	6	7	2	6	0
Zone		Easting				Northing								

B

Zone		Easting				Northing							

C

Zone		Easting				Northing							

D

Zone		Easting				Northing							

E

Zone		Easting				Northing							

F

Zone		Easting				Northing							

G

Zone		Easting				Northing							

H

Zone		Easting				Northing							

Verbal boundary description and justification

See attached city plat map.

List all states and counties for properties overlapping state or county boundaries

state	code	county	code
-------	------	--------	------

state	code	county	code
-------	------	--------	------

11. Form Prepared By

name/title Mr. and Mrs. John T. Anderson

organization _____ date December 1979

street & number Box 173 telephone _____

city or town Baton Rouge state La. 70821

12. State Historic Preservation Officer Certification

The evaluated significance of this property within the state is:

national state local

As the designated State Historic Preservation Officer for the National Historic Preservation Act of 1966 (Public Law 89-665), I hereby nominate this property for inclusion in the National Register and certify that it has been evaluated according to the criteria and procedures set forth by the Heritage Conservation and Recreation Service.

State Historic Preservation Officer signature *[Signature]*

title State Historic Preservation Officer date 3/27/80

For HCRS use only I hereby certify that this property is included in the National Register	
<i>[Signature]</i> Keeper of the National Register	date <u>8/1/80</u>
Attest: <i>[Signature]</i> Chief of Registration	date <u>7/28/80</u>

FHR-8-300A
(11/78)

UNITED STATES DEPARTMENT OF THE INTERIOR
HERITAGE CONSERVATION AND RECREATION SERVICE

**NATIONAL REGISTER OF HISTORIC PLACES
INVENTORY -- NOMINATION FORM**

FOR HCRS USE ONLY

RECEIVED APR 8 1980

DATE ENTERED AUG 1 1980

CONTINUATION SHEET

ITEM NUMBER 9 PAGE 2

Item 9 Bibliography Continued

Acts of the Louisiana Legislature, 1898.

340.63'

AUG 1 1980

PLAT



TERMINUS OF IOWA ST.

210'

4 PHOTO

DRIVE WAY

470.5

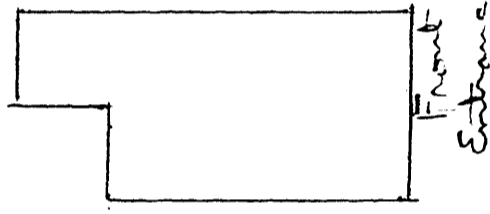

139.77'

2 PHOTO



GAZEBO

3 PHOTO

GARAGE



1 PHOTO

5 PHOTO

260.5'

480'

John Anderson
P. O. Box 173
Baton Rouge, La. 70821

SCALE 1" = 50'
4.514 acres

REAR FENCE OF
MAGNOLIA MOUND
HISTORIC TOURIST
SITE

