

KENTUCKY HISTORIC RESOURCES INVENTORY

OL-240

Site No.

1. Historic Name(s) **Wesley Church**

Original Owner **Wesley Methodist Congregation**

2. Present Name **Wesley Methodist Chapel**

3. Location **Haunz Lane at Interstate 71, 1 1/10 mi. N of KY**

4. Owner's Name **Mrs. Carl Haunz** *new listing* 22.

5. Owner's Address **6101 Haunz Lane, Louisville, Kentucky 40222**

6. Open to Public Yes No X

7. Ownership Private X Local State Federal

8. Site Plan with North Arrow *attached*

9. Architect/Builder **Silas Babbitt**

10. Date **1824** A. B.

11. Style **Federal** A. B.

12. Original Use **Church** H

13. Present Use **Barn**

14. Condition **Stone Good** B
inside poor

15. Stones, No. of **One ?** B

16. Description **Single room dry stone church, size ca. 32 x 44. Has two entrances on E gable end, three windows on N and S sides, one window in W end above pulpit, and one window in gable of E end (perhaps to light a balcony). Masonry in regular courses of large square tooled stones, quoined at corners. Voussoirs without keystones above doors only. Two chimneys on W end have segmentally arched fireplace openings flanking the pulpit area. Window frames are pegged; inside, the reveals are stuccoed and plastered. The doorways have square stone sills. One old door remains; is of diagonally beaded boards on one side; old nails**
(Continue on Back)

17. Single Pile Double Pile NA XX

18. Floor Plan **Single Cell** B

19. Structural Fabric **Stone** A. B.

20. Decorative Fabric **None** A. B.

21. Roof Form & Material **Gable**

22. Foundation Material **Stone** A

23. Outbuildings **None** B

24. Alterations Moved Additions Wall Treatment

25. History **Deeded to trustees of the Wesley Methodist Episcopal Church by Jacob Shrader. Church built in 1824 for the congregation which had met in members homes until that time. The first**

26. Significance **Only known unaltered early stone church in state.**

27. Source of Information **Inspection 1981 Survey Form**

28. ADD/County **Oldham**

29. U.S.G.S. Quadrant (15/75') **Anchorage** G.I.S. Mod.

30. UTM Reference **16 6 28 0 0 0 4 2 4 3 4 3 0**
Zone Easting Northing

31. Coordinate Accuracy

32. Prehistoric Site Object
Historic Site Structure
(Building) Other

33. National Register District Name:

34. Significance of Evaluation

35. Status Date

National Landmark

National Register

Landmark Certificate

Kentucky Survey

Local Landmark

HABS/HAER

36. Historic Theme

Primary **Architecture** C

Secondary **Religion** W

Other

37. Endangered Yes X
By Neglect No

38. ATTACH PHOTO **Attached**

Roll No. **Stone 11**

Picture No. **21 - 28**

Direction **same as also**

39. Prepared by: **Carolyn M. Wooley**

40. Organization **Kentucky Heritage Council**

41. Date **January 1984**

42. Revision Dates 43. Staff Review

JUN 6 1985

16. outline the six-panel reverse side (~~photo 5~~). Masonry is indented around doorway, and has nailing blocks to which the frame was attached (photo 5).

The 1981 survey form reports yellow poplar rafters marked with Roman numerals. ^{Roof}Roof has ridge beam and collars, sawn sheathing, and new metal roofing which covers over the chimneys. Inside has racks for drying tobacco. Now used as a barn.

The church is located on a knoll above a branch of Harrods Creek and an old road bed, below the bank of Interstate 71, from which church can be seen.

25. sermon was preached by Reverend Reuben Ross (of OL-232) and last by P. J. Ross in 1892. Contractor for the building was Silas Babbitt, age 20, and his helper, Bruce Jean, age 18.

Early Jefferson County Minute Books refer to the site as "Camp Ground" perhaps because of early 19th century revivals. Deeded in 1903 by W. H. Maddox to Fred Haunz.

KENTUCKY HISTORIC RESOURCE INVENTORY SUPPLEMENT
BOUNDARY AND LOCATION INFORMATION

Historic Property Name Vesley Church Site # Ql 240
Multiple Resource/Thematic Nomination Title _____

U.T.M. Coordinates - List multiple UTMs if property is ten or more acres.

A. 16 628080 4243580 D. 16 627840 4243460

B. 16 628200 4243440 E. _____

C. 16 627940 4243260 F. _____

Verbal Boundary Description Acres ca. 13 acres

Beginning at A, N of the church at the Interstate, thence SE 656 ft to B, thence SW 984 ft to C at the road, thence with road N.W. 665 ft to D at the Interstate, thence W Interstate line NE 787 ft to the beginning, containing the church and church yard. No other buildings are within this boundary.

contributing building

Sketch of Site Plan (Showing outbuildings, structures, landscape features and the site boundary as described above.)

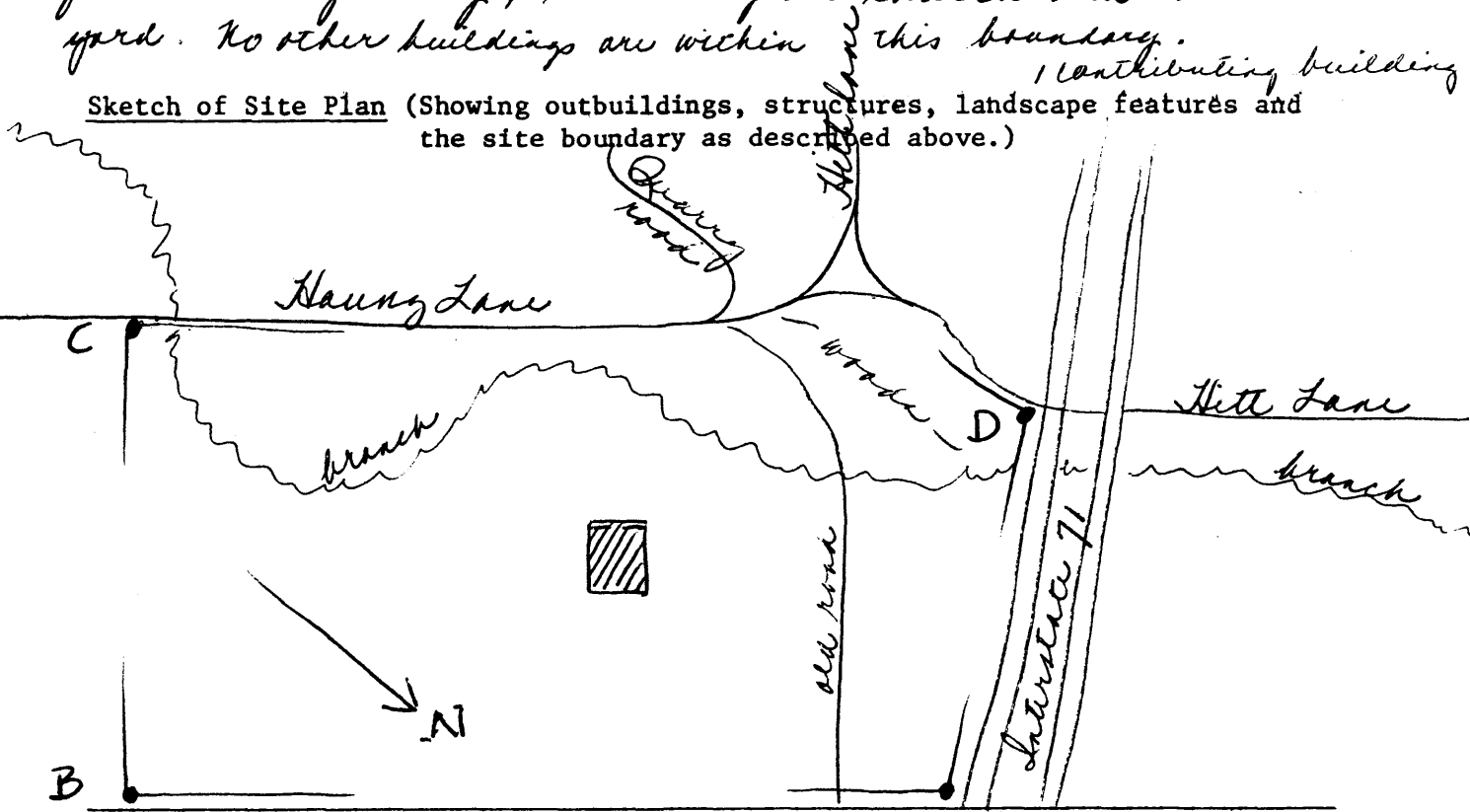

Official Courthouse Property Reference:

A