

United States Department of the Interior
National Park Service

National Register of Historic Places
Continuation Sheet

Section number _____ Page _____

SUPPLEMENTARY LISTING RECORD

NRIS Reference Number: 98001206

Property Name: Cretsinger, John, House

County: Guthrie State: Iowa

none
Multiple Name

This property is listed in the National Register of Historic Places in accordance with the attached nomination documentation subject to the following exceptions, exclusions, or amendments, notwithstanding the National Park Service certification included in the nomination documentation.

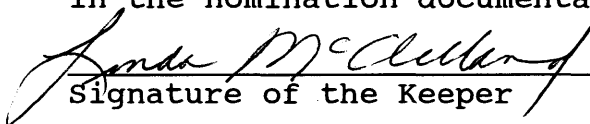
Signature of the Keeper

October 7, 1998
Date of Action

=====
Amended Items in Nomination:

Section 8. Significance: "Architecture" is, hereby, added to the nomination to correspond to the property's significance under Criteria C and D.

Beth Foster of the Iowa State Historic Preservation Office was notified of this amendment.

DISTRIBUTION:

- National Register property file
- Nominating Authority (without nomination attachment)

United States Department of the Interior
National Park Service

National Register of Historic Places
Registration Form

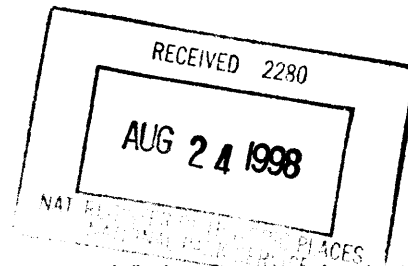

1206

This form is for use in nominating or requesting determinations for individual properties and districts. See instructions in *How to Complete the National Register of Historic Places Registration Form* (National Register Bulletin 16A). Complete each item by marking "x" in the appropriate box or by entering the information requested. If an item does not apply to the property being documented, enter "N/A" for "not applicable." For functions, architectural classification, materials, and areas of significance, enter only categories and subcategories from the instructions. Place additional entries and narrative items on continuation sheets (NPS Form 10-900a). Use a typewriter, word processor, or computer, to complete all items.

1. Name of Property

historic name Cretsinger, John, House

other names/site number _____

2. Location

street & number 1363 Burl Lane N/A not for publication

city or town Coon Rapids N/A vicinity

state Iowa code IA county Guthrie code 077 zip code 50058

3. State/Federal Agency Certification

As the designated authority under the National Historic Preservation Act, as amended, I hereby certify that this nomination request for determination of eligibility meets the documentation standards for registering properties in the National Register of Historic Places and meets the procedural and professional requirements set forth in 36 CFR Part 60. In my opinion, the property meets does not meet the National Register criteria. I recommend that this property be considered significant nationally statewide locally. (See continuation sheet for additional comments.)

Patricia O'Rourke DSM 8-12-98
Signature of certifying official/Title Date

STATE HISTORICAL SOCIETY OF IOWA
State or Federal agency and bureau

In my opinion, the property meets does not meet the National Register criteria. (See continuation sheet for additional comments.)

Signature of commenting official/Title Date

State or Federal agency and bureau

4. National Park Service Certification

I hereby certify that the property is:

- entered in the National Register. See continuation sheet.
- determined eligible for the National Register See continuation sheet.
- determined not eligible for the National Register.
- removed from the National Register.
- other, (explain): _____

Signature of the Keeper

Date of Action

Sandra McClelland

10/07/98

Name of Property

County and State

5. Classification

Ownership of Property (Check as many boxes as apply)

- private, public-local, public-State, public-Federal

Category of Property (Check only one box)

- building(s), district, site, structure, object

Number of Resources within Property (Do not include previously listed resources in the count.)

Table with columns: Contributing, Noncontributing, buildings, sites, structures, objects, Total

Name of related multiple property listing (Enter "N/A" if property is not part of a multiple property listing.)

N/A

Number of contributing resources previously listed in the National Register

N/A

6. Function or Use

Historic Functions (Enter categories from instructions)

- Domestic/single dwelling, Domestic/Secondary structure

Current Functions (Enter categories from instructions)

- Work in progress

Description

Architectural Classification (Enter categories from instructions)

No style

Materials (Enter categories from instructions)

- foundation Stone, walls Wood/log, Wood/weatherboard, roof Asphalt, other

Narrative Description

(Describe the historic and current condition of the property on one or more continuation sheets.)

Name of Property

County and State

8. Statement of Significance

Applicable National Register Criteria

(Mark "x" in one or more boxes for the criteria qualifying the property for National Register listing.)

- A Property is associated with events that have made a significant contribution to the broad patterns of our history.
B Property is associated with the lives of persons significant in our past.
C Property embodies the distinctive characteristics of a type, period, or method of construction or represents the work of a master, or possesses high artistic values, or represents a significant and distinguishable entity whose components lack individual distinction.
D Property has yielded, or is likely to yield, information important in prehistory or history.

Criteria Considerations

(Mark "x" in all the boxes that apply.)

Property is:

- A owned by a religious institution or used for religious purposes.
B removed from its original location.
C a birthplace or grave.
D a cemetery.
E a reconstructed building, object, or structure.
F a commemorative property.
G less than 50 years of age or achieved significance within the past 50 years.

Areas of Significance

(Enter categories from instructions)

Exploration/settlement

Period of Significance

1853 - Ca. 1874

Significant Dates

1853

Ca. 1874

Significant Person

(Complete if Criterion B is marked above)

N/A

Cultural Affiliation

Architect/Builder

Tuttle, Benjamin & Joseph

Cretsinger, John

Narrative Statement of Significance

(Explain the significance of the property on one or more continuation sheets.)

9. Major Bibliographical References

Bibliography

(Cite the books, articles, and other sources used in preparing this form on one or more continuation sheets.)

Previous documentation on file (NPS):

- preliminary determination of individual listing (36 CFR 67) has been requested
previously listed in the National Register
previously determined eligible by the National Register
designated a National Historic Landmark
recorded by Historic American Buildings Survey
recorded by Historic American Engineering Record

Primary location of additional data:

- State Historic Preservation Office
Other State agency
Federal agency
Local government
University
Other

Name of repository:

Cretsinger, John, House
Name of Property

Guthrie County, Iowa
County and State

10. Geographical Data

Acreage of Property less than one acre

UTM References

(Place additional UTM references on a continuation sheet.)

1

1	5	3	5	7	6	0	0	4	6	3	0	2	0	0
---	---	---	---	---	---	---	---	---	---	---	---	---	---	---

Zone Easting Northing

2

--	--	--	--	--	--	--	--	--	--	--	--	--	--	--

3

--	--	--	--	--	--	--	--	--	--	--	--	--	--	--

Zone Easting Northing

4

--	--	--	--	--	--	--	--	--	--	--	--	--	--	--

See continuation sheet

Verbal Boundary Description

(Describe the boundaries of the property on a continuation sheet.)

Boundary Justification

(Explain why the boundaries were selected on a continuation sheet.)

11. Form Prepared By

name/title Franklin Cretsinger

organization _____ date _____

street & number 1363 Burl Lane telephone 712-684-2890

city or town Coon Rapids state Iowa zip code 50058

Additional Documentation

Submit the following items with the completed form:

Continuation Sheets

Maps

- A USGS map (7.5 or 15 minute series) indicating the property's location.
- A Sketch map for historic districts and properties having large acreage or numerous resources.

Photographs

Representative black and white photographs of the property.

Additional Items

(Check with the SHPO or FPO for any additional items)

Property Owner

(Complete this item at the request of SHPO or FPO.)

name Franklin and Ruth Cretsinger

street & number 1363 Burl Lane telephone 712-684-2890

city or town Coon Rapids state Iowa zip code 50058

Paperwork Reduction Act Statement: This information is being collected for applications to the National Register of Historic Places to nominate properties for listing or determine eligibility for listing, to list properties, and to amend existing listings. Response to this request is required to obtain a benefit in accordance with the National Historic Preservation Act, as amended (16 U.S.C. 470 et seq.).

Estimated Burden Statement: Public reporting burden for this form is estimated to average 16.1 hours per response including time for reviewing instructions, gathering and maintaining data, and completing and reviewing the form. Direct comments regarding this burden estimate or any aspect of this form to the Chief, Administrative Services Division, National Park Service, P.O. Box 37127, Washington, DC 20013-7127; and the Office of Management and Budget, Paperwork Reduction Projects (1024-0016), Washington, DC 20503.

United States Department of the Interior
National Park ServiceNational Register of Historic Places
Continuation SheetSection number 7 Page 1Cretsinger, John, House
Guthrie County, IowaSee page 60, 16A
#2

The log cabin in Tuttles Grove is located in a forest at 1363 Burl Lane, five miles south of Coon Rapids, Iowa, in Guthrie County. Its setting is on a north slope, surrounded by timber. An original cabin, in excess of 140 years of age located this far west in Iowa is extremely rare. The house was constructed by Benjamin and Joseph Tuttle in November or December of 1853. The source for this information is found on page 711 of The History of Guthrie and Adair County printed by the Continental Historical Company of Springfield, Illinois in October of 1884. These two people came to this county from Hancock County, Illinois. Being chiefly hunters, they, after a short sojourn in this county went west, following the game.

George Mingus settled on this same section in the fall of 1854, buying out the claim of Joseph Tuttle. He was a native of Cherokee County, North Carolina. He died in this house on the 12th day of January 1859, having hurt himself a short time previously lifting timbers while building a bridge over the Middle Raccoon River in Carroll County. Jacob Cretsinger purchased this property sometime between 1861 and 1864. It has been owned by the Cretsinger family since and is currently owned by Franklin and Ruth Cretsinger. Hence comes the other name of Cretsinger Log Cabin.

The original cabin's size is 19 by 23 feet, with inside measurements of 16 feet 6 inches by 20 feet 10 inches. The difference in size being the thickness of the logs in the walls, also the siding and interior plaster. It is a 1 1/2 story cabin with a basement. The lean-to kitchen which is 8 by 22 feet, was built after 1867 by John Cretsinger. Its original construction is of weatherboard with wooden shingles. It is still as it was, except the wooden shingles have been replaced with asphalt. An inside entrance to the basement was made at that time by making a trap door through the floor of the lean-to kitchen. The walls of the basement are stones held together with cement. The basement floor was dirt. Later a concrete floor was poured, and the base of the stone walls was reinforced with concrete. This entrance allowed for an escape to a storm cellar in the event of violent weather, as well as protection from any Native Americans should the need arise. The trap door was normally covered by a small rug. The south wall consists of a center door, with two windows, one on each side of the door. The small outside entry was later added by Charles M. Cretsinger in 1949. This was the main entrance to the cabin. The west wall of the cabin originally had a fireplace in the center. This was later removed and replaced by a window. The loft upstairs is one large room, directly over the main cabin. Originally a ladder led to it, but was later replaced by stairs. The additional bedrooms, bathroom and porch were built in 1946 and 1947 at a time when building materials were scarce following World War II. Work is currently in progress on the house, however, the condition of the logs is excellent, as is the soundness of the structure. The foundation of stones cemented together is still very sturdy. The smokehouse on the property was replaced in 1930 by Charles M. Cretsinger because the old one had deteriorated too badly. It is built of commercial block.

The spring located 500 feet southwest of the house was dug out in 1929 for the purpose of putting up ice in the winter, before the days of rural electrification. It was redone and protected with a high dike in 1965 by Maud Cretsinger.

The historic integrity of this house derives from its location, its well preserved internal log construction, and exterior appearance. Likely, there are few similar houses this old and this far west in Iowa. It may well be the oldest original standing building within a 50 mile radius of it.

United States Department of the Interior
National Park Service

National Register of Historic Places Continuation Sheet

Section number 8 Page 2

Cretsinger, John, House
Guthrie County, Iowa

The John Cretsinger house is eligible under Criterion A for its association with the early settlement history of what became known as Coon Rapids. It is significant under Criterion C as one of the best surviving examples of the saltbox type house in this vicinity. It is also significant under Criterion D for its ability to yield information about log construction methods in this part of Iowa.

Some of the significance of this property is when the log house was built. There were no other buildings within 30 miles from it. The Indian group that resided in this area were led by a man who the white man called Johnny Green, who was a Potawatomi.

Later school was held in this house.

The first solemnization of marriage was held in this house in 1855, between Luther Straight and Miss Lydia Tuttle.

The first ground in this township was broken by George Mingus, who lived there, in the spring of 1855. The first wheat sown and corn planted was by the same party.

The first Fourth of July celebration was held on the front yard of this log cabin in 1859.

The cabin was sided sometime between November of 1867 and 1874, probably about the time the lean-to kitchen was built.

The Tuttle's Grove Post Office was instituted around 1875, and was within one-fourth mile of this cabin. The Postmaster at that time being James Moore.

The mail route established in 1858, between Panora and Sioux City went near this cabin. The contract with the U.S. Government was held by Jacob Cretsinger. His bid of \$999.00 was accepted between Panora and Denison, the next lowest bid being \$1,000.00. When he received the contract his oldest son John Cretsinger carried the mail. He later died in the year 1865. He had developed pneumonia after being in a severe storm, while carrying the mail on horseback. Since a mail stop was needed in the vicinity where he lived, a petition was sent to Washington to establish a Post Office with Augustus Frizell as postmaster. It was to be called Fairview, Iowa, however, the authority's replied there was already a Fairview, Iowa and asked that other names be selected. Niles Grove and Ribbleton were considered, but Coon Rapids was the name finally selected from a suggestion by Jacob Cretsinger. During the time he owned this cabin, he built his home approximately 250 yards southwest of this cabin. Sometime later, in 1867, he sold this cabin to his brother John Cretsinger. John raised a family of fourteen children in this cabin, thus showing a need for the add-ons he built.

Once the work in progress is completed on this cabin, papers and documents will be placed on display. Among these papers are the first fire insurance policy on the cabin showing a value of \$350.00, and an annual premium of \$9.50. The only known receipt from the Tuttle's Grove Post Office, signed by the Postmaster, plus deeds, tax receipts and letters to the early inhabitants between 1855 and 1879. These letters pertain to their daily problems and their daily lives. Also included on display will be history books, early maps and family genealogy from early inhabitants.

United States Department of the Interior
National Park Service

National Register of Historic Places Continuation Sheet

Section number 9 Page 3

Cretsinger, John, House
Guthrie County, Iowa

Bibliography:

History of Guthrie and Adair Counties, Continental Historical Company, October 1884.

Lee, Harold, Roswell Garst

Andreas, Alfred T., Historical Atlas of the State of Iowa, Andreas Atlas Company.

**United States Department of the Interior
National Park Service**

National Register of Historic Places Continuation Sheet

Section number 10 Page 4

Cretsinger, John, House
Guthrie County, Iowa

Verbal Boundary Description:

Less than one acre located in the southwest corner of the Southwest 1/4 of the Northwest 1/4 of Section 20, Range 81-33.

Boundary Justification:

The nominated property includes the entire parcel historically associated with the Joseph and Benjamin Tuttle residence.

United States Department of the Interior
National Park Service

National Register of Historic Places Continuation Sheet

Section number Photographs Page 5

Cretsinger, John, House
Guthrie County, Iowa

Photographer on picture # 1 unknown

Date - Between 1867 and 1874
Negatives - none known to exist

Photographer on pictures # 2-3-4

Franklin Cretsinger
April 15, 1997
Negatives are in possession of photographer

#1 North and East side of cabin and kitchen -camera facing Southwest

#2 South facade of house - camera to North

#3 West facade of house - camera facing East

#4 South and West facade of house - camera facing Northeast

#5 North facade of house - camera facing Southwest

#6 North facade of house - camera facing Southeast

United States Department of the Interior
National Park Service

National Register of Historic Places
Continuation Sheet

Section number Site Map Page 6

Cretsinger, John, House
Guthrie County, Iowa

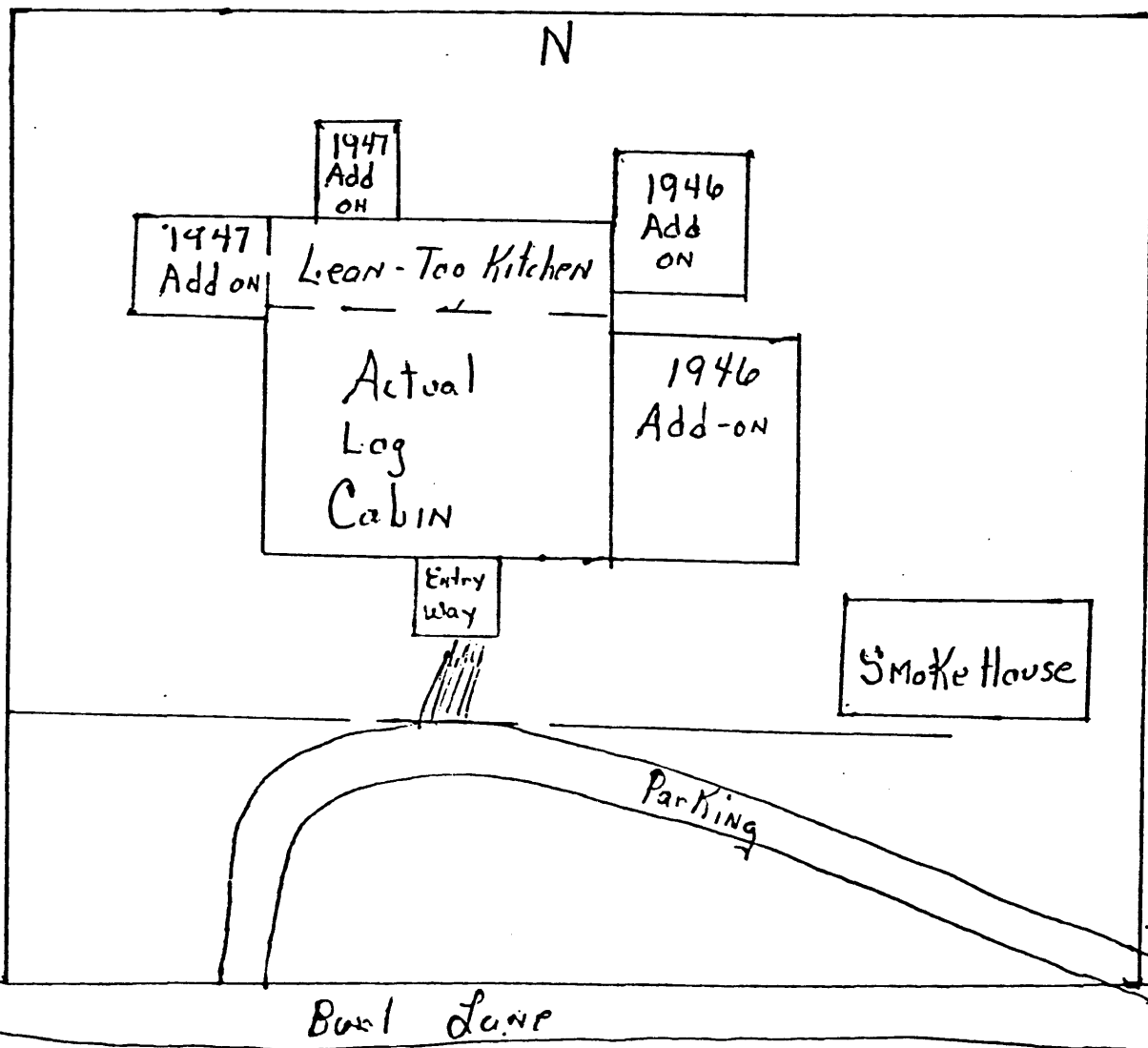

United States Department of the Interior
National Park Service

National Register of Historic Places Continuation Sheet

Section number Plat Map Page 7

Cretsinger, John, House
Guthrie County, Iowa

Source: 1875 Illustrated Historical Atlas of the State of Iowa

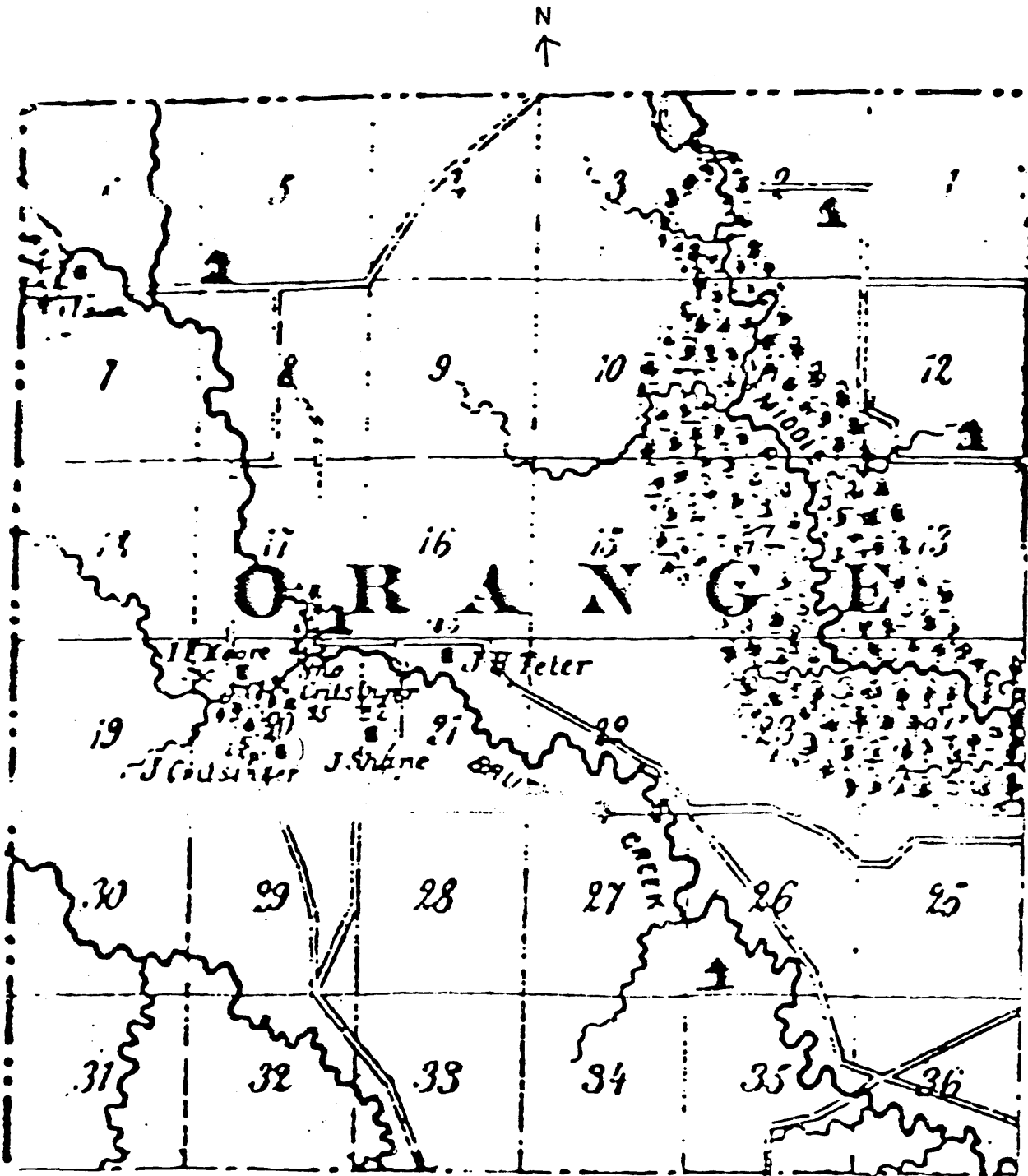

United States Department of the Interior
National Park Service

National Register of Historic Places
Continuation Sheet

Section number Plat Map Page 7

Cretsingler, John, House
Guthrie County, Iowa

Source: 1997 Guthrie County Atlas
Farm & Home Publishers, Ltd., PO Box 305, Belmond, IA

T-81-K



ORANGE PLAT

R-33-W

