

798

United States Department of the Interior  
National Park Service

NATIONAL REGISTER OF HISTORIC PLACES  
REGISTRATION FORM

This form is for use in nominating or requesting determinations for individual properties and districts. See instructions in How to Complete the National Register of Historic Places Registration Form (National Register Bulletin 16A). Complete each item by marking "X" in the appropriate box or by entering the information requested. If any item does not apply to the property being documented, enter "N/A" for "not applicable." For functions, architectural classification, materials, and areas of significance, enter only categories and subcategories from the instructions. Place additional entries and narrative items on continuation sheets (NPS Form 10-900a). Use a typewriter, word processor, or computer, to complete all items.

1. Name of Property

historic name English, J. Colin School

other names/site number English, J. Colin Elementary School/LL1200

2. Location

street & number 120 Pine Island Road n/a  not for publication

city or town North Fort Myers n/a  vicinity

state FLORIDA code FL county Lee code 071 zip code 33903

3. State/Federal Agency Certification

As the designated authority under the National Historic Preservation Act, as amended, I hereby certify that this  nomination  request for determination of eligibility meets the documentation standards for registering properties in the National Register of Historic Places and meets the procedural and professional requirements set forth in 36 CFR Part 60. In my opinion, the property  meets  does not meet the National Register criteria. I recommend that this property be considered significant  nationally  statewide  locally. ( See continuation sheet for additional comments.)

[Signature] 5/25/99  
Signature of certifying official/Title Date

Florida State Historic Preservation Officer, Division of Historical Resources  
State or Federal agency and bureau

In my opinion, the property  meets  does not meet the National Register criteria. ( See continuation sheet for additional comments.)

\_\_\_\_\_  
Signature of certifying official/Title Date

\_\_\_\_\_  
State of Federal agency and bureau

4. National Park Service Certification

I hereby certify that the property is:

- entered in the National Register  See continuation sheet
- determined eligible for the National Register  See continuation sheet.
- determined not eligible for the National Register  See continuation sheet.
- removed from the National Register.
- other, (explain) \_\_\_\_\_

[Signature] \_\_\_\_\_  
Signature of the Keeper Date of Action 7-8-99

English, J. Colin School  
Name of Property

Lee Co., FL  
County and State

**5. Classification**

**Ownership of Property**  
(Check as many boxes as apply)

- private
- public-local
- public-State
- public-Federal

**Category of Property**  
(Check only one box)

- buildings
- district
- site
- structure
- object

**Number of Resources within Property**  
(Do not include any previously listed resources in the count)

Contributing	Noncontributing	
2	0	buildings
0	0	sites
1	0	structures
0	0	objects
3	0	total

**Name of related multiple property listings**  
(Enter "N/A" if property is not part of a multiple property listing.)

**Number of contributing resources previously listed in the National Register**

Historic Resources of Lee County, Florida

0

**6. Function or Use**

**Historic Functions**  
(Enter categories from instructions)

Education: School  
\_\_\_\_\_  
\_\_\_\_\_  
\_\_\_\_\_  
\_\_\_\_\_  
\_\_\_\_\_  
\_\_\_\_\_  
\_\_\_\_\_

**Current Functions**  
(Enter categories from instructions)

Education: School  
\_\_\_\_\_  
\_\_\_\_\_  
\_\_\_\_\_  
\_\_\_\_\_  
\_\_\_\_\_  
\_\_\_\_\_  
\_\_\_\_\_

**7. Description**

**Architectural Classification**  
(Enter categories from instructions)

Late 19<sup>th</sup> and 20<sup>th</sup> Century Revivals: \_\_\_\_\_  
Mission/Spanish Colonial Revival \_\_\_\_\_  
\_\_\_\_\_

**Materials**  
(Enter categories from instructions)

foundation Brick \_\_\_\_\_  
walls Brick \_\_\_\_\_  
Stucco \_\_\_\_\_  
roof Asphalt \_\_\_\_\_  
other Terra Cotta \_\_\_\_\_  
\_\_\_\_\_

**Narrative Description**

(Describe the historic and current condition of the property on one or more continuation sheets.)

**8. Statement of Significance**

**Applicable National Register Criteria**

(Mark "X" in one or more boxes for the criteria qualifying the property for National Register listing.)

- A** Property is associated with events that have made a significant contribution to the broad patterns of our history.
- B** Property is associated with the lives of persons significant in our past.
- C** Property embodies the distinctive characteristics of a type, period, or method of construction or represents the work of a master, or possesses high artistic values, or represents a significant and distinguishable entity whose components lack individual distinction.
- D** Property has yielded, or is likely to yield information important in prehistory or history.

**Criteria Considerations**

(Mark "X" in all the boxes that apply.)

Property is:

- A** owned by a religious institution or used for religious purposes.
- B** removed from its original location.
- C** a birthplace or grave.
- D** a cemetery.
- E** a reconstructed building, object, or structure.
- F** a commemorative property.
- G** less than 50 years of age or achieved significance within the past 50 years

**Narrative Statement of Significance**

(Explain the significance of the property on one or more continuation sheets.)

**9. Major Bibliographical References**

**Bibliography**

Cite the books, articles, and other sources used in preparing this form on one or more continuation sheets.)

**Previous documentation on file (NPS):**

- preliminary determination of individual listing (36 CFR 36) has been requested
- previously listed in the National Register
- previously determined eligible by the National Register
- designated a National Historic Landmark
- recorded by Historic American Buildings Survey # \_\_\_\_\_
- recorded by Historic American Engineering Record

**Areas of Significance**

(Enter categories from instructions)

Education \_\_\_\_\_

Architecture \_\_\_\_\_

\_\_\_\_\_  
\_\_\_\_\_  
\_\_\_\_\_

**Period of Significance**

1928-1949 \_\_\_\_\_

\_\_\_\_\_  
\_\_\_\_\_

**Significant Dates**

1928 \_\_\_\_\_

\_\_\_\_\_  
\_\_\_\_\_

**Significant Person**

n/a \_\_\_\_\_

**Cultural Affiliation**

n/a \_\_\_\_\_

\_\_\_\_\_  
\_\_\_\_\_

**Architect/Builder**

Architect: Walker, N. Gaillard \_\_\_\_\_

Builder: Wheeler, C. Franklyn \_\_\_\_\_

\_\_\_\_\_

**Primary location of additional data:**

- State Historic Preservation Office
- Other State Agency
- Federal agency
- Local government
- University
- Other

Name of Repository \_\_\_\_\_

\_\_\_\_\_  
# \_\_\_\_\_

English, J. Colin School  
Name of Property

Lee Co., FL  
County and State

**10. Geographical Data**

**Acreage of Property** Less than 1 acre

**UTM References**

(Place additional references on a continuation sheet.)

1	1	7	4	1	1	6	5	0	2	9	5	1	3	8	0
	Zone		Easting						Northing						
2															

3															
	Zone		Easting						Northing						
4															

See continuation sheet

**Verbal Boundary Description**

(Describe the boundaries of the property on a continuation sheet.)

**Boundary Justification**

(Explain why the boundaries were selected on a continuation sheet.)

**11. Form Prepared By**

name/title Stephen Olausen, Consultant/Barbara E. Mattick, Historic Preservationist Supervisor

organization Bureau of Historic Preservation date May 1999

street & number R.A. Gray Building, 500 S. Bronough Street telephone (850) 487-2333

city or town Tallahassee state Florida zip code 32399-0250

**Additional Documentation**

Submit the following items with the completed form:

**Continuation Sheets**

**Maps**

A **USGS map** (7.5 or 15 minute series) indicating the property's location.

A **Sketch map** for historic districts and properties having large acreage or numerous resources.

**Photographs**

Representative **black and white photographs** of the property.

**Additional items**

(check with the SHPO or FPO for any additional items)

**Property Owner**

(Complete this item at the request of SHPO or FPO.)

name Lee County District School Board, Facilities (Stephanie Keys)

street & number 2055 Central Avenue telephone (941) 479-4204

city or town Fort Myers state FL zip code 33901

**Paperwork Reduction Act Statement:** This information is being collected for applications to the National Register of Historic Places to nominate properties for listing or determine eligibility for listing, to list properties, and amend listings. Response to this request is required to obtain a benefit in accordance with the National Historic Preservation Act, as amended (16 U.S.C. 470 et seq.).

**Estimated Burden Statement:** Public reporting burden for this form is estimated to average 18.1 hours per response including time for reviewing instructions, gathering and maintaining data, and completing and reviewing the form. Direct comments regarding this burden estimate or any aspect of this form to the Chief, Administrative Services Division, National Park Service, P.O. Box 37127, Washington, DC 20013-7127; and the Office of Management and Budget, Paperwork Reduction Projects (1024-0018), Washington, DC 20503.

United States Department of the Interior  
National Park Service

**NATIONAL REGISTER OF HISTORIC PLACES  
CONTINUATION SHEET**

**Section number** 7 **Page** 1 **ENGLISH, J. COLIN SCHOOL**  
**North Fort Myers, Lee Co., FL**

---

**SUMMARY**

J. Colin English School is located in the North Fort Myers area of Lee County at 120 Pine Island Road. Included within the National Register boundaries for the property are the original school building, a former cafeteria building, and a low marl stone wall that encloses a landscaped lawn in front of the school. The original school building is a modest example of the Mediterranean Revival style. Identifying features of the style present include arched window and door openings and decorative terra-cotta crests and finials. The former cafeteria was built in 1946 and has a masonry vernacular design. It is constructed of concrete block and has rough stucco exterior surfacing.

**PRESENT AND ORIGINAL APPEARANCE**

**Setting**

North Fort Myers is a sprawling unincorporated area on the north side of the Caloosahatchee River, between the City of Cape Coral and Interstate-75. The J. Colin English School complex is located west of Old Highway 41 (North Tamiami Trail) at 120 Pine Island Road. To the east of the school property is a narrow strip of county property that contains a water tower (photos 1 and 2). Immediately adjacent to the water tower is a small residential subdivision along Beachwood Court. Residential areas also border the school property on the south and west. Immediately to the north is the partially developed North Fort Myers Community Park.

The historic J. Colin English School is located at the southeastern corner of the school property, which is a rectangular tract of land measuring approximately ten acres. Surrounding the historic school on the north and west are a number of non-contributing school buildings that were added to the campus after the historic period. The area included within the proposed National Register boundaries contains the original school building and a contributing former cafeteria building (photos 3 and 17). Also included is a low random marl stone wall that was constructed at the same time as the original school building and runs along the southern boundary of the property (photo 4). The lawn between the school and the stone wall is landscaped with sabal palm, cypress, and oak trees and a variety of shrubs.

**J. COLIN ENGLISH SCHOOL**

**Exterior**

Like most of the schools erected in Lee County during the 1920s, the J. Colin English School has a central block with wings plan. The walls of the original portions of the building are constructed of hollow clay tile and are finished with a brick veneer. Additions to the rear of the east and west extensions of the building

**United States Department of the Interior  
National Park Service**

**NATIONAL REGISTER OF HISTORIC PLACES  
CONTINUATION SHEET**

Section number 7 Page 2 **ENGLISH, J. COLIN SCHOOL  
North Fort Myers, Lee Co., FL**

---

have concrete block walls and stucco exterior fabric. All of the building units have flat, built-up roofs with a low parapet. The parapets are topped with an overhanging brick course and a decorative dentil cornice.

*Facade (south elevation)*

The facade or south elevation is divided into five bays (photo 3). The central bay contains most of the building's decorative elements (photo 5). A double-door entrance with a twelve-light transom is recessed behind an arched opening. The arched portion of the opening has a stucco surround that contrast with the brick walls of the building. The surround extends to a stepped parapet with square and rectangular raised panels. The parapet is framed by raised molding and urn finials adorn the corners. Pairs of narrow arched windows with stuccoed hoods are located on either side of the entrance arch. Above the windows are decorative terra-cotta crests that are inscribed with "1928," the year construction on the school began.

Shed roof extensions with pantile surfacing run flank the main block. Each extension contains a group of three large arched windows with brick caps and lintels. The openings have been partially filled and now contain small rectangular metal windows.

The outer wings of the facade are identical and feature a large central window flanked by two smaller rectangular windows. The window groupings are joined by a decorative masonry hood.

*West and east sides*

The west and east sides of the building have the same configurations (photos 6 and 9). The primary architectural elements are two sets of windows that copy the configuration of those in the outer wings of the facade. At the mid point of each elevation the exterior wall fabric changes from brick to stucco, showing clearly the extent of the original building and two classroom additions that were added in 1949.

*Rear (north elevation)*

The window pattern of the outer bays of the facade and sides is carried to two sets of windows located in the walls between the wing extensions and the auditorium (photo 7). An arched window with a brick surround is located in the walls of the original wings that face the auditorium. The remaining fenestration in the wing additions and the auditorium consists of single rectangular windows. Paired doors located at the corners of the wings lead to the school hallway.

**United States Department of the Interior  
National Park Service**

**NATIONAL REGISTER OF HISTORIC PLACES  
CONTINUATION SHEET**

Section number 7 Page 3 **ENGLISH, J. COLIN SCHOOL  
North Fort Myers, Lee Co., FL**

---

**Exterior alterations**

The most significant exterior alterations to the original appearance of the building are the replacement of all the original windows and doors and the two classroom additions to the rear of the wings. Built in 1949, the classroom additions fall within the period of historic significance for the school. A small rectangular addition, which houses the school's electrical plant, was attached to the rear of the west wing during the late 1950s. The installation of the replacement windows occurred during a 1970 renovation of the building. At about the same time, air conditioning units that are located in the central openings of the window groupings were added.

**Interior**

Most of the interior spaces of the building are intact and exhibit their original woodwork and appointments. The main entrance to the building opens a U-shaped hall through which all of the school rooms are accessed. The east/west running portion of the hall contains a series of decorative archways (photo 10). The rectangular door openings of the original portion of the wings are visible midway down the north/south running halls and lead to the classroom additions to the rear of the building (photo 11). Most of the original wood panel doors and six-light transoms have been preserved (photo 12). The original portion of the school contains six classrooms that feature built-in cabinets and blackboards (photos 13 and 14). Boy's and Girl's bathrooms are located at the ends of the east/west running halls, and the original school offices, which now house spaces for the school counselor and curriculum technology, are located in the central bay extension. The two rear additions contain classrooms and bathrooms that mirror those of the original wings.

**Interior alterations**

The most significant interior alteration has been the subdivision of the auditorium into office and storage space (photo 15). The area now contains seven rooms that serve as the school's reception area, records storage, principal and assistant principal offices, clinic, a waiting area, and general storage. Other interior alterations include the lowering of the classroom ceilings to accommodate electrical and air-conditioning conduits and the covering of some of the plaster walls with wood paneling.

**CAFETERIA**

The cafeteria is a rectangular concrete block building with a low-pitched, metal, gable roof (photos 16 and 17). A small gable extension projects from the north wall. The exterior walls are covered with rough-textured stucco. Fenestration consists of large rectangular double-hung sash windows. The windows are divided by square pilasters. Entrances to the building are located on the south elevation and west side.

**United States Department of the Interior  
National Park Service**

**NATIONAL REGISTER OF HISTORIC PLACES  
CONTINUATION SHEET**

Section number 7 Page 4

**ENGLISH, J. COLIN SCHOOL  
North Fort Myers, Lee Co., FL**

---

The interior of the cafeteria was subdivided into two classrooms in the late 1950s (photo 18). Other alterations to the original appearance of the building include the enclosure of several of the window openings and the replacement of the original doorway on the west side.



United States Department of the Interior  
National Park Service

**NATIONAL REGISTER OF HISTORIC PLACES  
CONTINUATION SHEET**

Section number 8 Page 1 **ENGLISH, J. COLIN SCHOOL**  
**North Fort Myers, Lee Co., FL**

---

**SUMMARY**

J. Colin English School is eligible for listing in the National Register of Historic Places under criteria A and C at the local level in the areas of education and architecture. It was constructed in 1928 at the end of a massive building campaign undertaken by the Lee County School Board in the 1920s to improve school facilities throughout the county. It is the most significant surviving historic building in the unincorporated area of North Fort Myers. In the area of architecture the building is significant as an example of an early twentieth century school and as a good illustration of the Mediterranean Revival style as it was applied to public buildings. It contributes to the *Historic Resources of Lee County, Florida* multiple property group under historic context V, **Historic Development of the Lee County School System, 1887-1950** and property type F.3, **Educational Buildings**.

**DEVELOPMENT OF J. COLIN ENGLISH SCHOOL**

The sprawling unincorporated community of North Fort Myers encompasses a number of historic place names. The area in which the J. Colin English School is located was formerly known as New Prospect. The oldest of the communities in North Fort Myers, New Prospect was founded in 1872 when a group of settlers planted orange groves there. In 1884 a cemetery was established and the first New Prospect school, a small wood frame building, was constructed. The first subdivision in the area was platted in 1911. Settlement of the community remained sparse until the land boom years of the mid 1920s. In 1926 two large residential subdivisions--Palmona Park and Tamiami Estates--were platted. Subsequent development, especially in Palmona Park, led to a rapid increase in the area's population, and in early 1928 a group of New Prospect residents petitioned the Lee County Board of Public Instruction to erect a new school in the community.<sup>1</sup>

In February 1928 the School Board approved New Prospect's request for permission to issue \$40,000 in bonds for the construction of the New Prospect School. A five acre tract of land on the north side of Pine Island Road was donated to the board by the J.W. Williams Company. In July architect N. Gaillard Walker was commissioned to draw plans for the new school.<sup>2</sup>

Work on the New Prospect School was begun in the fall of 1928. The contractor for the building was C.

---

<sup>1</sup>Florida Preservation Services, "Lee County Historic Sites Survey," (Report prepared for the Lee County Planning Department, December, 1986) 72; Lee County School Board, Minutes, February 8, 1928.

<sup>2</sup>Lee County School Board, Minutes, February 8 and July 16, 1928; *The Fort Myers Press*, September 9, 1926.

United States Department of the Interior  
National Park Service

**NATIONAL REGISTER OF HISTORIC PLACES  
CONTINUATION SHEET**

**Section number** 8 **Page** 2 **ENGLISH, J. COLIN SCHOOL**  
**North Fort Myers, Lee Co., FL**

---

**Franklyn Wheeler**, who had previously constructed the Alva High School in 1927. The building, which was designed in the then popular Mediterranean Revival style and featured eight classrooms and an auditorium, was completed in time for the opening of the 1929 school year. The first principal of the school was Harry F. Henry. In November the trustees of the school district petitioned the School Board to change the school's name to J. Colin English School, in honor of the then Lee County school superintendent.<sup>3</sup>

English was born in the western Lee County community of Alva in 1895. He was one of several members of the prominent pioneer English family that helped settle the Alva area. After graduating from Alva High School in 1913, he went to Emory University in Atlanta. He graduated from Emory in 1917 and served with 303rd Company of the Quartermaster Corps during World War I. While overseas he attended post-graduate courses at the University of Edinburgh in Scotland. English returned to Lee County in the early 1920s and was elected school superintendent in 1924. His term, which lasted until 1932, was distinguished by the consolidation of the county's school districts and the first concerted county-wide school building program. He also guided the school system through the toughest years of the Great Depression when many of the local school districts went bankrupt. In 1936 English was elected Superintendent of Florida Schools and moved to Tallahassee. His experience in Lee County during the Depression prompted him to establish a statewide financing system that struggling school districts could tap for emergency funds. In 1948 he was a candidate for governor, but lost to Fuller Warren of Jacksonville. He remained in Tallahassee until his death in 1985.<sup>4</sup>

The J. Colin English School has been in continuous service since its completion. In 1946 a cafeteria building was constructed immediately to the rear of the auditorium. Two years later, two classrooms were added to the rear of the wings of the original building. In anticipation of subsequent expansions of the school complex, an additional ten acres of land surrounding the school property were purchased in 1950. In 1957, after the erection of a larger cafeteria, the original cafeteria was subdivided for use as classroom space. Four additional classroom buildings and a library were added to the property between 1953 and 1971. During a 1970 renovation of the original school building, the auditorium was subdivided into administrative offices.<sup>5</sup>

---

<sup>3</sup>Lee County School Board, Minutes, July 16 and November 21, 1928.

<sup>4</sup>*Fort Myers News Press*, n.d.

<sup>5</sup>Donald O. Stone and Beth W. Carter, *The First 100 Years: Lee County Public Schools, 1887-1987* (Fort Myers, Florida: Department of Printing, The School Board of Lee County, 1987) 168, 227; The School District of Lee County, Florida, Facilities Department, "List of Construction Projects," typescript, n.d.

**United States Department of the Interior  
National Park Service**

**NATIONAL REGISTER OF HISTORIC PLACES  
CONTINUATION SHEET**

Section number 8 Page 3

**ENGLISH, J. COLIN SCHOOL  
North Fort Myers, Lee Co., FL**

---

**CONCLUSION**

**Criterion A**

J. Colin English School is eligible for listing the National Register of Historic Places under criterion A in the area of education. It is the only surviving historic educational building in the North Fort Myers area of Lee County. It was constructed as part of a general expansion program undertaken by the Lee County School Board in response to a rapidly growing population of school age children during the years of the Florida Land Boom. In the context of Florida's history, it is also a relatively rare, example of a historic school that continues to serve its original function.

**Criterion C**

The building has additional significance under criterion C as an example of the use of contemporary architectural concepts in educational facility design. Designed for a small population of school age children, the school featured eight spacious, well lit classrooms, an auditorium, and indoor bathroom facilities. The 1948 addition brought the total number of classrooms to ten, and the 1946 cafeteria building was among the first free standing facilities of its kind in Lee County.

The school has further significance under criterion C as an example of the work of prominent local architect N. Gaillard Walker, who was one of two architects hired by the Lee County Board of Public Instruction to draw plans for schools erected in the late 1920s. It is the only surviving historic Mediterranean Revival style building the community. Elements of the style are exhibited by a stepped parapet with urn finials and raised panels, terra-cotta crests, and arched window and door openings. With the exception of the removal of the original windows and doors, the building retains its historic exterior appearance to a high degree. It is the largest and most architecturally elaborate historic building in North Fort Myers. The low marl stone wall is a landscape feature that is unique among the Lee County's schools.

**United States Department of the Interior  
National Park Service**

**NATIONAL REGISTER OF HISTORIC PLACES  
CONTINUATION SHEET**

Section number   9   Page   1   **ENGLISH, J. COLIN SCHOOL**  
**North Fort Myers, Lee Co., FL**

---

**MAJOR BIBLIOGRAPHICAL REFERENCES**

Florida Preservation Services, "Lee County Historic Sites Survey," Report prepared for the Lee County Planning Department, December, 1986.

Grismer, Karl H. *The Story of Fort Myers*. Fort Myers Beach, Florida: The Island Press Publishers, 1982. Facsimile reproduction of 1949 edition.

Lee County School Board. Minutes, 1928-1950.

Stone, Donald O. and Beth W. Carter. *The First 100 Years: Lee County Public Schools, 1887-1987*. Fort Myers, Florida: Department of Printing, The School Board of Lee County, 1987.

"The History of J. Colin English School," typescript manuscript located at J. Collin English Elementary School, n.d.

The School District of Lee County, Florida, Facilities Department, "List of Construction Projects," typescript, n.d.

**United States Department of the Interior  
National Park Service**

**NATIONAL REGISTER OF HISTORIC PLACES  
CONTINUATION SHEET**

Section number 10 Page 1

**ENGLISH, J. COLIN SCHOOL  
North Fort Myers, Lee Co., FL**

---

**VERBAL BOUNDARY DESCRIPTION**

The J. Colin English School is located on a parcel of land on the north side of Pine Island Road, approximately 200 yards west of Fowler Street. The boundary encompasses the historic school building, the adjoining historic cafeteria building, the random marl stone wall, and the land immediately surrounding these resources, as shown on the attached site plan.

**BOUNDARY JUSTIFICATION**

The boundary includes the significant historic resources and the area immediately around them that were associated with the school during the period of significance, 1928-1949.

**United States Department of the Interior  
National Park Service**

**NATIONAL REGISTER OF HISTORIC PLACES  
CONTINUATION SHEET**

Section number \_\_\_\_\_ Photos \_\_\_\_\_ Page 1 **ENGLISH, J. COLIN SCHOOL**  
**North Fort Myers, Lee Co., FL**

---

**INVENTORY OF PHOTOGRAPHS**

1. J. COLIN ENGLISH ELEMENTARY SCHOOL
2. LEE COUNTY, FLORIDA
3. STEPHEN OLAUSEN
4. NOVEMBER 1996
5. HISTORIC PROPERTY ASSOCIATES
6. STREETScape VIEW OF SCHOOL PROPERTY AND NON-CONTRIBUTING WATER TOWER TO THE EAST OF THE SCHOOL, FACING NORTHWEST
7. PHOTO NO. 1 OF 18

Numbers 1-5 are the same for the remaining photographs.

6. STREETScape VIEW OF SCHOOL PROPERTY SHOWING NON-CONTRIBUTING SCHOOL BUILDINGS TO THE WEST OF THE HISTORIC SCHOOL, FACING NORTHEAST
7. PHOTO NO. 2 OF 18
6. VIEW OF FACADE (SOUTH ELEVATION), FACING NORTH
7. PHOTO NO. 3 OF 18
6. VIEW OF RANDOM MARL STONE WALL AND LANDSCAPING, FACING NORTHEAST
7. PHOTO NO. 4 OF 18
6. DETAIL VIEW OF CENTRAL BLOCK OF THE FACADE, FACING NORTH
7. PHOTO NO. 5 OF 18
6. VIEW OF WEST SIDE, FACING SOUTHEAST
7. PHOTO NO. 6 OF 18
6. VIEW OF WESTERN PORTION OF REAR ELEVATION, FACING SOUTHWEST
7. PHOTO NO. 7 OF 18
6. VIEW OF EASTERN PORTION OF REAR ELEVATION, FACING SOUTHWEST
7. PHOTO NO. 8 OF 18

**United States Department of the Interior  
National Park Service**

**NATIONAL REGISTER OF HISTORIC PLACES  
CONTINUATION SHEET**

Section number          Photos          Page   2   **ENGLISH, J. COLIN SCHOOL**  
**North Fort Myers, Lee Co., FL**

---

- 6. VIEW OF EAST SIDE, FACING SOUTHWEST
- 7. PHOTO NO. 9 OF 18
  
- 6. INTERIOR VIEW OF MAIN HALL, FACING EAST
- 7. PHOTO NO. 10 OF 18
  
- 6. INTERIOR VIEW OF EAST HALL, FACING NORTH
- 7. PHOTO NO. 11 OF 18
  
- 6. INTERIOR DETAIL VIEW OF ORIGINAL DOORS AND TRANSOM, FACING SOUTHEAST
- 7. PHOTO NO. 12 OF 18
  
- 6. INTERIOR VIEW OF A TYPICAL CLASSROOM, FACING EAST
- 7. PHOTO NO. 13 OF 18
  
- 6. INTERIOR VIEW OF COMPUTER LAB, FACING SOUTHWEST
- 7. PHOTO NO. 14 OF 18
  
- 6. INTERIOR VIEW OF RECEPTION AREA IN THE FORMER AUDITORIUM, FACING  
NORTHEAST
- 7. PHOTO NO. 15 OF 18
  
- 6. VIEW OF SOUTH ELEVATION AND EAST SIDE OF FORMER CAFETERIA BUILDING,  
FACING NORTHWEST
- 7. PHOTO NO. 16 OF 18
  
- 6. VIEW OF WEST SIDE OF FORMER CAFETERIA BUILDING, FACING EAST
- 7. PHOTO NO. 17 OF 18
  
- 6. INTERIOR VIEW OF BAND ROOM IN THE FORMER CAFETERIA BUILDING, FACING  
SOUTHEAST
- 7. PHOTO NO. 18 OF 18

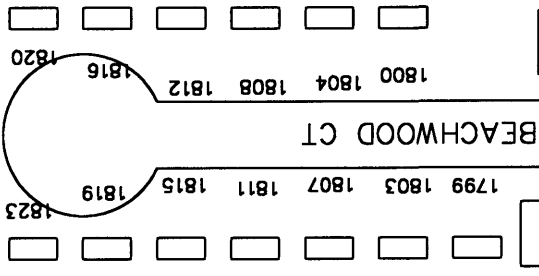
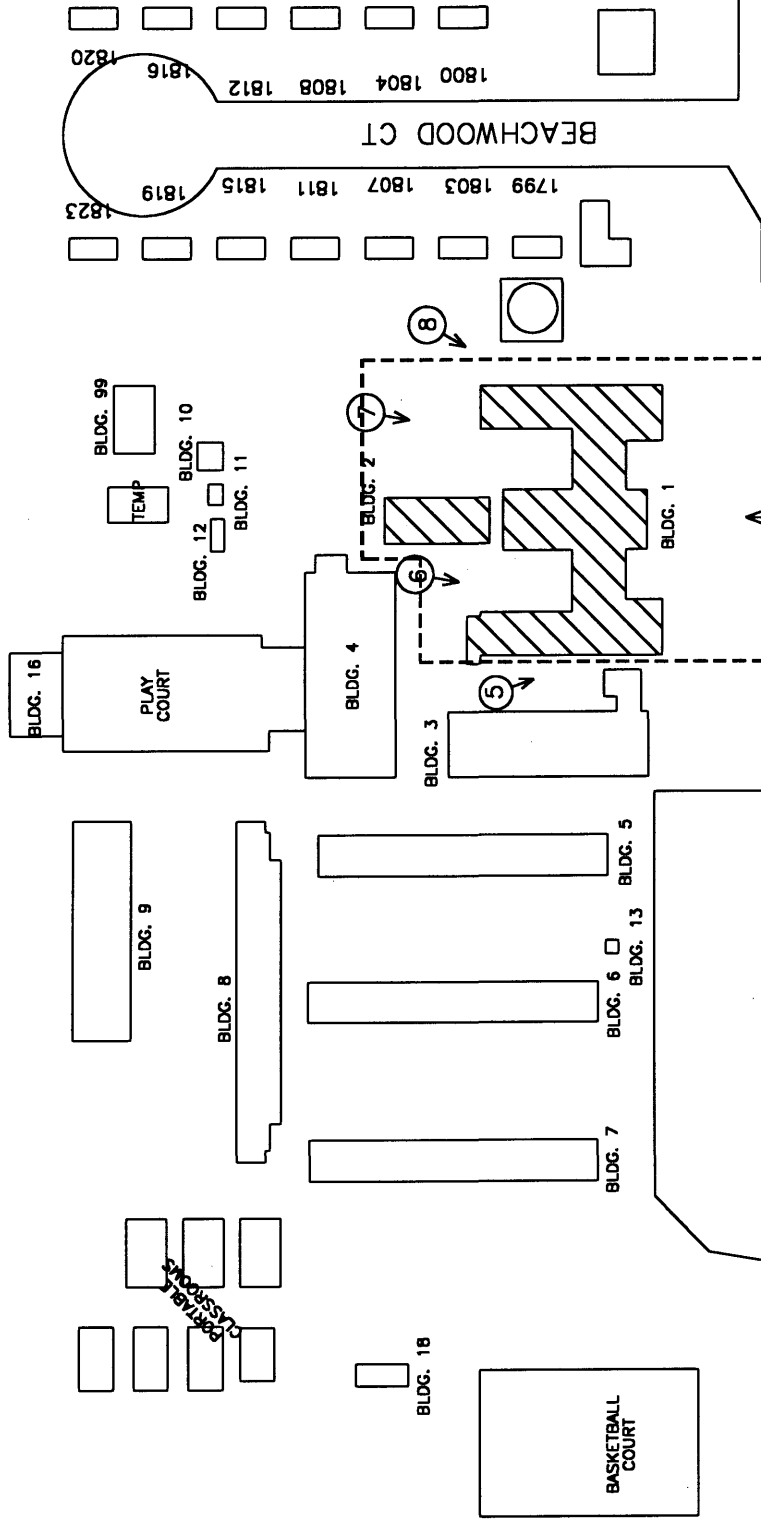

PINE ISLAND RD

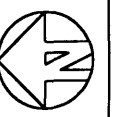
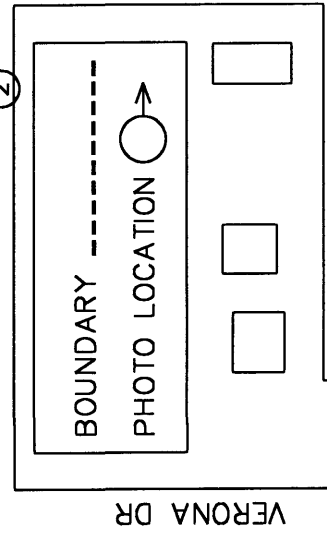

PREPARED BY  
 HISTORIC PROPERTY ASSOCIATES, INC.  
 NOVEMBER 1996

SITE PLAN: J. COLLIN ENGLISH ELEMENTARY SCHOOL  
 120 PINE ISLAND ROAD, NORTH FORT MYERS, FLORIDA



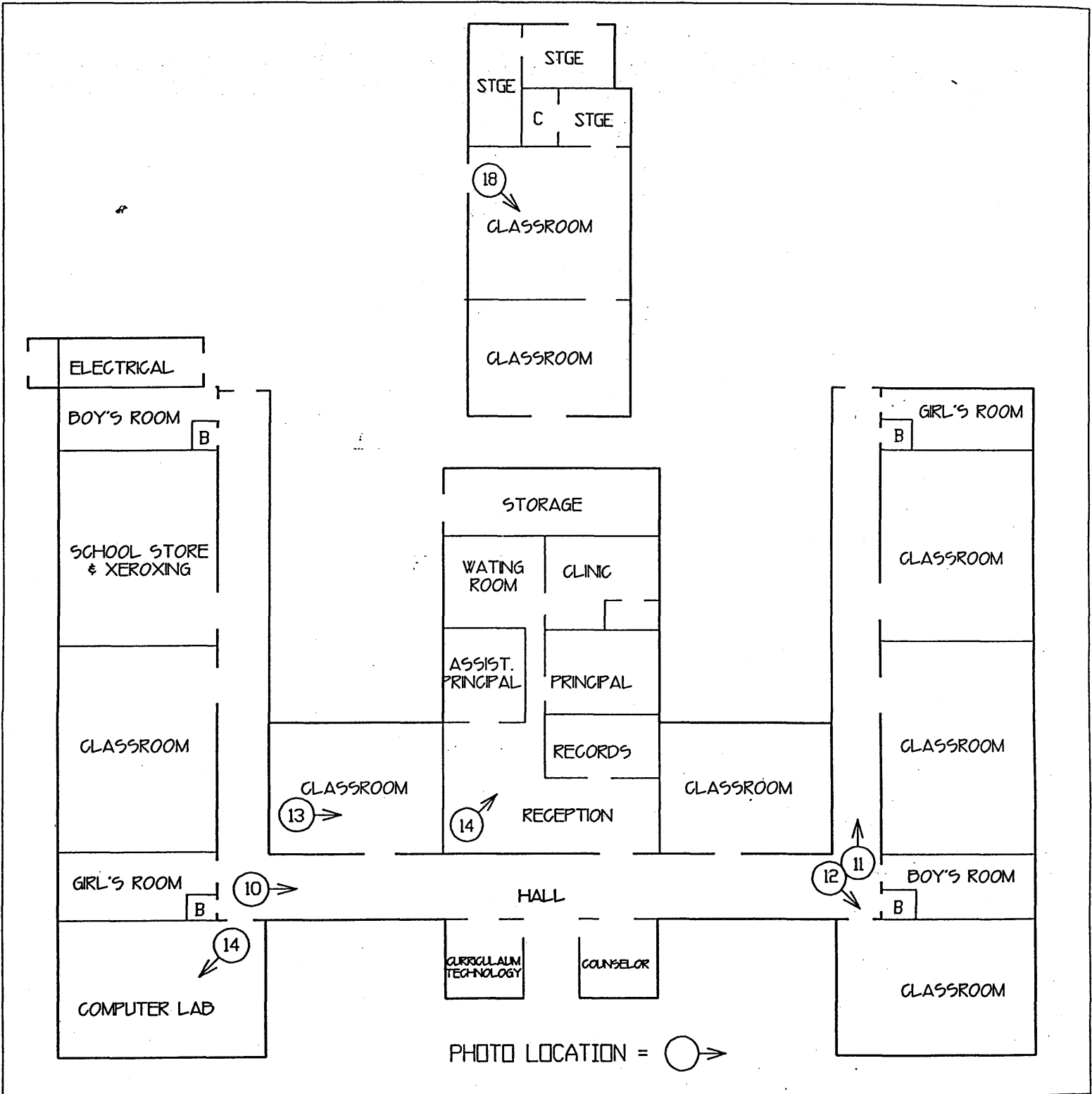

FLOOR PLAN: J. COLLIN ENGLISH ELEMENTARY SCHOOL  
 120 PINE ISLAND ROAD, NORTH FORT MYERS, FLORIDA

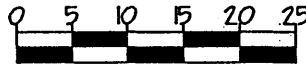

PREPARED BY  
 HISTORIC PROPERTY ASSOCIATES, INC.  
 NOVEMBER 1996

