

United States Department of the Interior
National Park Service

National Register of Historic Places
Registration Form

JUL 21 1989

NATIONAL
REGISTER

This form is for use in nominating or requesting determinations of eligibility for individual properties or districts. See instructions in *Guidelines for Completing National Register Forms* (National Register Bulletin 16). Complete each item by marking "x" in the appropriate box or by entering the requested information. If an item does not apply to the property being documented, enter "N/A" for "not applicable." For functions, styles, materials, and areas of significance, enter only the categories and subcategories listed in the instructions. For additional space use continuation sheets (Form 10-900a). Type all entries.

1. Name of Property

historic name WELLFLEET CENTER HISTORIC DISTRICT

other names/site number N/A/TIPLE

2. Location

street & number ROUGHLY BOUNDED BY CROSS STREET, HOLBROOK AVE., MAIN N/A not for publication

city, town STREET AND EAST MAIN STREET, SCHOOL ST. & DUCK CREEK N/A vicinity

state MASS. code 027 county BARNSTABLE code 001 zip code 02667

3. Classification

Ownership of Property

- private
- public-local
- public-State
- public-Federal

Category of Property

- building(s)
- district
- site
- structure
- object

Number of Resources within Property

Contributing	Noncontributing
<u>173</u>	<u>126</u> buildings
<u>-</u>	<u>-</u> sites
<u>2</u>	<u>3</u> structures
<u>7</u>	<u>3</u> objects
<u>182</u>	<u>132</u> Total

Name of related multiple property listing:

N/A

Number of contributing resources previously listed in the National Register 0

4. State/Federal Agency Certification

As the designated authority under the National Historic Preservation Act of 1966, as amended, I hereby certify that this nomination request for determination of eligibility meets the documentation standards for registering properties in the National Register of Historic Places and meets the procedural and professional requirements set forth in 36 CFR Part 60.

In my opinion, the property meets does not meet the National Register criteria. See continuation sheet.

Valerie A. Talmage

Signature of certifying official

State Historic Preservation Officer, Massachusetts Historical

Date

July 19 1989

Commission, Executive Director
State or Federal agency and bureau

In my opinion, the property meets does not meet the National Register criteria. See continuation sheet.

Signature of commenting or other official

Date

State or Federal agency and bureau

5. National Park Service Certification

I hereby, certify that this property is:

- entered in the National Register. See continuation sheet.
- determined eligible for the National Register. See continuation sheet.
- determined not eligible for the National Register.
- removed from the National Register.
- other, (explain:)

Entered in the
National Register

Alana Byers

8/21/89

Signature of the Keeper

Date of Action

6. Function or Use

Historic Functions (enter categories from instructions)

DOMESTIC: SINGLE DWELLINGDOMESTIC: SECONDARY STRUCTURECOMMERCE: SPECIALTY STORECOMMERCE: DEPARTMENT STORE

see continuation sheet

Current Functions (enter categories from instructions)

DOMESTIC: SINGLE DWELLINGDOMESTIC: SECONDARY STRUCTURECOMMERCE: SPECIALTY STOREDOMESTIC: MULTIPLE DWELLING

see continuation sheet

7. Description

Architectural Classification

(enter categories from instructions)

COLONIAL: GEORGIANLATE VICTORIAN: SECOND EMPIRE, ITALIANATEEARLY REPUBLIC: FEDERALMID-19th CENTURY: GREEK REVIVAL, GOTHIC REVIVAL

Materials (enter categories from instructions)

foundation BRICKwalls CLAPBOARDSHINGLEroof ASPHALTother N/A

Describe present and historic physical appearance.

Wellfleet, Massachusetts is located on outer Cape Cod, midway between Chatham at the "elbow" of the Cape and Provincetown at the northern tip. The town extends about eight miles from north to south between the towns of Truro and Eastham, and three and one-half miles west to east between Cape Cod Bay and the Atlantic Ocean. Topography consists of mainly sand and gravel outwash plains stretching from high dunes on the eastern, ocean, side to low ground on the west. On the eastern side, the rough outwash plains are dotted with kettlehole ponds formed where blocks of glacial ice melted. The regular Atlantic coastline contrasts with the deeply indented western shore, where mud flats, extensive salt marshes, and tidal creeks penetrate Wellfleet's narrow territory. Land along Wellfleet's entire eastern, northern, and western boundaries is largely undeveloped, having been acquired by the National Park Service since 1961 for inclusion in a conservation area of more than 25,000 acres known as the Cape Cod National Seashore.

The Wellfleet Center Historic District is situated roughly midway between the Atlantic shore and Cape Cod Bay. Duck Creek, a tidal stream that empties into Wellfleet Harbor, borders the district to the south, and salt and fresh water marshes are to the north. U.S. Route 6, a major north-south artery through the Outer Cape, bypasses the district to the east. The district occupies a hilly area, and the terrain slopes upward gradually from Duck Creek to East Commercial Street, then more steeply to Main Street along the district's northern boundary. The Congregational Church on Main Street occupies the district's highest point, and its belfry is visible from Wellfleet Harbor and Cape Cod Bay. North of the district, between two hills, is Squire's Pond, a kettlehole depression surrounded by swamp land. Across Duck Creek to the south is the town's common land, known locally as Cannon Hill.

The district contains approximately 119 acres and includes 299 buildings, five structures, and ten objects, of which 173 buildings, two structures, and seven objects contribute to the district's architectural and historical integrity. All contributing resources were in place by 1915, the end of the period of significance. Of the 126 noncontributing buildings, fifteen are historic buildings

United States Department of the Interior
National Park Service

National Register of Historic Places
Continuation Sheet

Section number 6 Page 1

WELLFLEET CENTER HISTORIC DISTRICT, MA

6. FUNCTION OR USE

Historic Function (continued)

RELIGION: RELIGIOUS STRUCTURE
DOMESTIC: MULTIPLE DWELLING
INDUSTRY: MANUFACTURING FACILITY

Current Function (continued)

COMMERCE: RESTAURANT
RELIGION: RELIGIOUS STRUCTURE

United States Department of the Interior
National Park ServiceNational Register of Historic Places
Continuation SheetSection number 7 Page 1

Wellfleet Center Historic District, MA

that have lost their integrity due to significant alterations. More than half of the remaining 111 noncontributing buildings are secondary structures such as garages, rental cottages, and barns associated with historic buildings but constructed after the period of significance. A number of undistinguished frame sheds of unknown vintage throughout the district have been identified on the District Data Sheet but are not included in the count of contributing and noncontributing resources.

Historically, most buildings in the district have been in either residential or commercial use. Many have shifted from one use to the other: first a residence, then a store, and then back to a residence as owners have changed over the decades. Some buildings have served as residences and shops simultaneously, with the owners living over the shops. Current building uses include residences, galleries, restaurants, and boutiques. Contributing institutional buildings include three church buildings, Masonic Hall, and the former Wellfleet Savings Bank. There is one manufacturing building in the district. Some of the outbuildings--small barns, garages, and sheds--have been converted for use as year-round residences, seasonal rental cottages, or antique stores.

Wellfleet Center Historic District is thickly settled. Except for two small lots made vacant by fires, there are limited openings in the street wall of the district. Building setbacks are generally shallow if they exist at all, and there is little space between the retail shops on Main and Commercial Street. On primarily residential streets, such as Holbrook Avenue and East Commercial Street, houses are built close together but most have a small front yard. The lanes leading off the main streets, such as Whit's Lane, and Masonic Lane, are unpaved, some maintain the old oyster shell surfaces that were common on the local 19th-century roads. Most streets have no sidewalks, although Main Street has a sidewalk on both sides. At the southern edge of the district, a footbridge across Duck Creek connects the village center to Cannon Hill. In the absence of parks in Wellfleet Center, the Town Hall lawn provides a small green space with a bench and shade trees.

Landscaping is entirely informal in the district. Few of the old trees that once lined the streets survive; several red maples and flowering trees have been planted in recent years through funds

Continued

United States Department of the Interior
National Park ServiceNational Register of Historic Places
Continuation SheetSection number 7 Page 2

Wellfleet Center Historic District, Mass.

appropriated at town meetings. An 80-foot stretch of white picket fence on Main Street is kept planted with local wild flowers and annuals. Most of the private residences have shrubs. The retail shops use the limited space around them for flowers in tubs or for annuals. A dory, no longer seaworthy, is planted with petunias and serves as a flowery local landmark at the intersection of East Commercial and Main Streets.

The architectural character of the district is predominantly Greek Revival, with at least one example of every other major 19th-century style represented. Most of the buildings, designed by local carpenter-architects, are vernacular interpretations of high styles. No building in the district exceeds 2-1/2 stories. All contributing buildings are of frame construction with shingle or clapboard siding. Most buildings are weathered grey or painted white, but a few on Main Street show brown, rust, or other colors. Typically, buildings have modest detailing, including pilasters, bracketing, or dentil work. In general, the buildings are not greatly altered on the exterior. Many property owners have attempted to maintain the historical character of their buildings. Often, the most serious changes are evidenced in historic buildings currently used as art galleries, where windows have been blinded to create unbroken wall space for display.

Generally, the district's buildings may be classified in four categories:

1. buildings that predate the period when the harbor village became the commercial center of Wellfleet (late-18th century to ca. 1830). With the exception of a couple of large Federal residences, the early buildings are Georgian and Federal capes that remain in residential use.
2. buildings that were moved into the village from outlying areas of town as Wellfleet Center flourished and later became a focus of local maritime and commercial activity (beginning ca. 1830). Some were brought in as residences and others for commercial use. In certain cases, uses have not remained constant, shifting over the years from residences to retail shops and back to residences again.

Continued

United States Department of the Interior
National Park ServiceNational Register of Historic Places
Continuation SheetSection number 7 Page 3

Wellfleet Center, Historic District, MASS.

3. buildings that were built in Wellfleet Center as it developed into the center of the maritime industry that supported Wellfleet's economy in the 19th century (ca. 1830 to ca. 1870). Most are in the Greek Revival style, but three notable Second Empire buildings and some derivations of the Italianate style survive.
4. buildings associated with the beginning of Wellfleet's shift from an economy dependent on the maritime trades to one based on summer resort activity and tourism (ca. 1880 to ca. 1915). Buildings of this period include churches, cottages, and the large Greek Revival summer mansion of Lorenzo Dow Baker, a prosperous trader and landowner as well as a promulgator of the tourist industry in Wellfleet.

The oldest buildings in the district are Cape Cod houses built in the second half of the 18th century and the early decades of the 19th century. Destruction of Barnstable County deed records by fire in 1827 makes precise dating of these buildings difficult. The dwellings reflect the period when the harbor village was beginning to develop into a flourishing maritime community, although the village was not yet the commercial and institutional center of town. A significant number of these capes were relocated to Wellfleet Center from outlying areas. Generally, the capes are of plank or conventional frame construction on brick foundations, 1-1 1/2 stories, double pile, with steep gable roofs, interior chimneys, and sparse exterior details associated with the Georgian or Federal styles. Most of the dwellings have five-bay (full cape) or four-bay (three-quarter cape) facades. Their clapboarded or shingled exteriors are either weathered or painted white.

Representative of the early houses is a Georgian full cape on Commercial street (ca. 1810, Map #121-22-42, MHC #E-70, Photo 20). The building's clapboarded east side (facade) and shingled sides are finished with narrow corner boards. Window openings containing 12-over-12 double-hung wood sash are located directly beneath the boxed cornice on the facade, a predominant form of construction before the use of extended stud heights increased the distance between window head and cornice.

Continued

United States Department of the Interior
National Park ServiceNational Register of Historic Places
Continuation SheetSection number 7 Page 4

Wellfleet Center Historic District, Mass.

With the silting in of small outer harbors along the Cape Cod Bay, and the erosion of Billingsgate Island at the mouth of Wellfleet Harbor, the Duck Creek village became an increasingly important focus for maritime activity in Wellfleet. Local people began to move their houses into the harbor village from outlying areas, with at least twenty houses moved into the district between ca. 1830 and 1880. Houses were moved in several ways. Some were screw-jacked up intact so that log rollers could be placed under them, then they were dragged by oxen to the nearest body of water, placed on a barge or raft and floated over to Duck Creek where they were again placed on logs and dragged to their new site. Other houses were cut up and the pieces were carried to the new location on carts or rafts. Some houses were taken apart (flaked) with their members carefully numbered for easy assembly at the new location in the center of town. Ells were sometimes reattached on a different wall of the house. Many of the relocated houses have a replacement stove chimney instead of the original central chimney.

A Georgian full cape moved onto School Street is the Mulford Rich House (ca. 1810, Map #121-22-101a, MHC #B-27). Moved in 1832 from an island settlement along Duck Pond east of Wellfleet Harbor, the Rich House is one of the earliest examples of a general exodus of buildings and people into the district in the mid-19th century. After the move, the ell from the rear of the house was repositioned on the west wall.

Holbrook Avenue alone has ten houses that were moved from formerly flourishing settlements at Bound Brook Island (to the west) and Truro (to the north). Before the Center's transformation into Wellfleet's institutional and commercial focus, Holbrook Avenue was part of the Holbrook farm and called Holbrook field. One Holbrook Avenue cape moved from Bound Brook Island in the 1850s is the Nehemiah Paine House (ca. 1775, Map #122-22-34, MHC #A-19). The house was moved intact, carried on a scow to the town wharf on Duck Creek just below Holbrook Avenue, then rolled up the hill on timbers to its present foundation. The central chimney was replaced by stove chimneys after the move, but the window arrangement, clapboard facade, and shingled sides remain.

A late-18th century cape on Cross Street (ca. 1775, Map #120-22-24, MHC #J-164, Photo 3) was also brought in from Bound Brook Island in

Continued

United States Department of the Interior
National Park ServiceNational Register of Historic Places
Continuation SheetSection number 7 Page 5

Wellfleet Center Historic District, Mass.

the 1850s. A three-quarter cape in the Georgian style, the house has 9-over-6 wood sash in the windows. The entry lobby is lit by a fourlight transom over the door which is flanked by pilasters bearing jack knife carvings of stars with rays in the frieze and a half moon and sun in the capitals. It is an outstanding door treatment in Wellfleet. Jack knife carving was a popular past-time of fishermen while they were at sea. They carved molding trim, fancies, and such decorative pieces as these door trims.

Variations to the typical cape form included construction of an additional story. A cape that came in early from Griffin Island, Creek House (ca. 1800, Map #121-22-64, MHC #C-34, Photos 4 and 5), is a three-quarter cape as seen from Dorcas Lane off East Commercial Street (Photo 4). However, the land on which the house was placed is so steeply pitched as to have permitted construction of another story beneath the earlier building (Photo 5). This made it possible to present a handsome, 2 1/2-story, Federal facade toward Duck Creek to the south. The new main entrance has wide pilasters, five-pane side lights, and a semi-circular door head under a narrow architrave. Windows contain 9-over-6 double-hung wood sash. The original house above the ground floor is of post and beam construction, and contains boxed corner posts, paneled fireplace walls, and the remains of a beehive oven. A round cellar was dug into the slope behind the two rooms on the ground floor. When a porch ell was added to the east wall in the late 1920s, the walls of the original cape were found to have been insulated with layers of sea weed. The Federal facade of this house, which contained Wellfleet's first post office, faces a road that ran along the northern bank of Duck Creek in the early-19th century.

Two houses constructed in the district contrast with the size and scale of the early capes. A ca. 1800 Federal style house on the north side of Main Street is known locally as a captain's house. Its grand scale suggests that it was once owned by the squire for whom the nearby Squire's Pond is named. The earliest available deed of 1835 shows the owner as Reuben Higgins. Used primarily as a residence, the Reuben Higgins House (Map #121-22-12, MHC #G-128, Photo 2) at various times also housed a dry goods store, a tea room, and an inn. The two-story, five-bay house has a center chimney and one of the few hipped roofs in the historic district. Symmetrically placed window frames are hung on the front beam immediately below

Continued

United States Department of the Interior
National Park ServiceNational Register of Historic Places
Continuation SheetSection number 7 Page 6

Wellfleet Center Historic District, Mass.

the cornice line. The entrance has a wide door surround, containing a six-light fixed transom and four-pane sidelights.

The Capt. Jesse Snow House on Commercial Street (ca. 1815, Map #123-22-20, MHC #F-87, Photo 11) is stylistically transitional with Federal massing and organization and Greek Revival ornament. The house is 2-1/2 stories with a gable roof and five-bay facade. Clapboarded walls are finished with paneled corner pilasters. The entrance consists of a broad entablature with plain door surrounds and full-length five-pane sidelights. Windows contain 6-over-6 double hung wood sash. This house is one of the most symmetrical and well-proportioned dwellings in the historic district.

By far the most popular choice of architectural style in the Wellfleet Center Historic District is the Greek Revival. The prevalence of this style is attributed to the village's rapid growth as the town's commercial core in the mid-19th century. Most of the buildings on Commercial and East Commercial Streets, which were laid out chiefly in the mid-19th century, are Greek Revival.

The Greek Revival style was chosen by nearly every prosperous merchant who built a residence in the central district during its expansion years. Two types of Greek Revival houses dominate. The first type, represented by the Hawes House on East Commercial Street (ca. 1860, Map #121-22-85, MHC #D-60, Photo 22), is a frame house of 2-1/2 stories with a three-bay facade oriented gable end to the street, an enclosed end-bay entry containing a double door, and an arched window in the gable end. Ornament on this and other houses includes thin corner boards, rakeboards, molded window surrounds, and brackets at the eaves and the cornice over the entry. Other examples of this house type seen on East Commercial and Main Streets incorporate a bay window in place of the two windows on the first floor of the facade.

A second form of Greek Revival house is the 1-1/2 story, three bay cottage with side ell. The door in the main house, occupying the end bay of the facade, is complemented by another door in the ell. Typical of these cottages is the Sarah Atwood House on East Commercial Street (ca. 1860, Map #121-22--83, MHC #D-58, Photo 6). The cottage has a gable roof, molded rakeboards, and corner

Continued

United States Department of the Interior
National Park ServiceNational Register of Historic Places
Continuation SheetSection number 7 Page 7

Wellfleet Center Historic District, Mass.

pilasters. The wing or ell continues the line of the facade without a setback, and the ornamental treatment of windows and doors on the wing complement those on the main house. The main door of the Atwood House is treated with full-length side lights and pilasters bearing a deep, layered architrave. The door in the ell repeats the pilasters and architrave but has no side lights.

The Greek Revival cottage with side ell is one of the most common house forms in the historic district, with approximately thirty extant examples primarily on Commercial, East Commercial, and Main Streets, and Holbrook Avenue. Variations of this house type include a bracketed cottage with a one-story cross-gabled ell, seen on Bank Street (ca. 1860, Map #121-22-30, MHC #E-67) and on Main Street (Samuel Kemp House, ca. 1870, Map #120-22-6-, MHC #H-150). A cottage with a two-story side ell is the Noah Swett House on Commercial Street (1858, Map #123-22-38, MHC #F-97).

Simeon Atwood built a third type of Greek Revival house on Baker Avenue up the street from his busy Commercial Street store. The gable end of the Simeon Atwood House (ca. 1855, Map #12022082, MHC #I-151, Photo 8) faces the Avenue's intersection with Bank Street. The three-bay facade of the 2 1/2 story frame house has a pedimented gable and a window treatment that is highly unusual in the historic district. The first floor displays long windows with 6-over-12 double-hung sash, semi-circular window heads, and shutters. The second floor windows have 6-over-6 sash and pedimented hoods, and the attic pediment includes a wheel window. Windows in the brick raised basement contain 3-over-3 sash. In the early-20th century a pergola was built onto the south side of the house, shading the main entrance. The Atwood House is now a gallery.

Wellfleet Center is unusual in having a mid-19th century apartment house, the largest of the few multi-family houses constructed in town during this period. In 1858, E. L. Collins built as an investment an apartment house on Commercial Street for seamen's families. He named the apartment house for his son Bradford Collins, although locally the building is known as the Governor Bradford Apartments (Map #123-22--2, MHC #E-76, Photo 14). The 2 1/2 story Greek Revival building has a gable roof and double interior stove chimneys. Each unit is three bays wide, with a side entry; the four entrances are paired in the 3rd, 4th, the 9th and

Continued

United States Department of the Interior
National Park ServiceNational Register of Historic Places
Continuation SheetSection number 7 Page 8

Wellfleet Center Historic District, Mass.

10th bays of the facade. The apartment house has paneled corner pilasters as well as broad entablatures and sidelights at each pair of entrances. A similar type of multi-family dwelling is seen in the later two-family house on Main Street know as the Isaiah Young House (ca. 1890, Map #120-22-61b, MHC #H-144, Photo 17). The Colonial Revival, 2 1/2 story house has a six-bay facade with entrances in the end bays, and brackets on the cornice and window and door hoods.

Greek Revival houses relocated to the Wellfleet Center district were used either for residential or commercial purposes. Among the buildings that remained residential is a 1 1/2 story dwelling on Commercial Street (ca. 1855, Map #123-22-44, MHC #F-93), moved from the high land on the north bank of the Herring River near the Truro town boundary. Floated in on a scow, the house was moved to its present site near the old railroad right-of-way in the 1860s, before the railroad extended its tracks into town.

A Greek Revival double store (ca. 1840, Map #120-22-75, MHC #138, Photo 1) on Main Street was created from two dwellings moved from Billingsgate Island by Dr. William Stone in the 1850s. The joined 1 1/2 story buildings have broken pediments, corner pilasters, and symmetrically placed display windows. Shed roof dormers and an oriel window added to the upper story of the larger (easternmost) building are later additions.

The Simeon Atwood Store (1832, Map #121-22-41, MHC #E-69, Photo 7), a grocery store, is the oldest commercial building original to Wellfleet Center. The 2 1/2 story frame building has an L-plan, with one front on Commercial Street and the other on Bank Street. Detailing on the store is very plain. Three windows on the east elevation contain original 9-over-6 wood sash. A porch between the two facades has been enclosed. For many years, the building has served commercial purposes under several owners. Since 1973, the hardware business has been replaced by boutiques on the first floor, a residence on the second floor, and a clam packing business in the basement.

A later Greek Revival commercial building original to the district is the former Wellfleet Marine Insurance Co, building across the

Continued

United States Department of the Interior
National Park ServiceNational Register of Historic Places
Continuation SheetSection number 7 Page 9

Wellfleet Center Historic District, Mass.

street (1878, Map #121-22-54, MHC #E-77). The building was squeezed in on the site of a coal-yard weighing scale which resulted in its tall and narrow configuration. A storefront consisting of an entrance flanked by display windows is shaded by a porch supported by narrow bracketed columns. The building was purchased in 1905 by Simeon Atwood, and is known as the "Customs House" because Atwood was the last deputy customs officer. Atwood used the building to store stoves for area residents, who dismantled their parlor stoves each May 1 and stopped them until the following winter.

Moved for Chequessett Neck and first appearing on a Wellfleet map in 1858 as a chandlery on Commercial Street is the former barn of Joshua Hamblen (ca. 1850, Map #123-22-4, MHC #E-80, Photo 25). Oriented gable end to the street, the 2 1/2-story building is shingled and has paired display windows on each side of the center entrance. Windows at the upper levels have been boarded over. There is a rear ell of one story. In 1800, the building was owned by A.H. Pervere who was a member of a large Wellfleet family engaged in the fishing business. By the turn of the 20th century the building was a grocery store and later a laundromat. The chandlery is now a seafood restaurant, and has a distinctive marquee, on the roof, of a doryman pulling in his net.

The building, currently known as Wellfleet Pottery (ca. 1850 # 123-22-37, MHC #F-98, Photo 13), was moved to the east side of Commercial Street from Truro in the 1870s. Built by the Advent Church Society, which failed when the world did not come to an end as anticipated in 1869, the building was moved to its harbor location in Wellfleet where it was first used as a chandlery. Oriented with its broad gable end to the street, the 2 1/2-story building was a broken pediment and narrow corner boards. A door in each end bay of the four-bay facade recall the dual entrances of a meetinghouse. The original double-height interior has been interfloored and incorporates the former church galleries. The second floor is now the home of the potter. Shop windows were cut into the facade of the building during its conversion to an art gallery, and wide wooden stairs with generous landings have been added at the rear for customer entrance.

In 1850, the Hawes brothers, local carpenters, constructed the district's only Greek Revival institutional building, the

United States Department of the Interior
National Park ServiceNational Register of Historic Places
Continuation SheetSection number 7 Page 10

Wellfleet Center Historic District, Mass.

Congregational Church (Map #121-22-91, MHC #G-119) on Main Street. The projecting center entry tower has a pedimented base with a deep entablature, paired Doric pilasters, and dentil cornice. The building is finished with flush boards on the facade and clapboards on the three remaining sides. The octagonal, ogee-roofed belfry replaces the original which blew off in a gale in 1879. On the face of the belfry's square base is the town clock.

A simple 2 1/2-story house of rectangular massing with spare ornament is the Dr. Thomas Stone House on Main Street (1861, Map #121-22-92, MHC #G-118, Photo 12). The center entry, bracketed hood over the door, and dentil work under the eaves of the three-bay facade suggest an Italianate influence. An ell has been added to northern end of the house.

A noteworthy Italianate facade in the historic district is actually a storefront wing added to a Greek Revival residence. The present Wellfleet Historical Society (Map #121-22-5 #G-132, Photo 15) on Main Street was added to the Payne Higgins House (Map #121-22-6, MHC #G-131). Constructed circa 1830, the house is a 2-story, Italianate storefront wing to the west side of his residence. The wing addition, which housed a dry goods store, has a steeply pitched gable roof, a broken pediment, and bracketed eaves. The center entrance is flanked by boxed display windows and contained a double door and a transom of four round-arched lights. Each display window contains double round-headed, 2-over-2 sash on the facade and a single 1-over-1 round-headed window at each side. It is a unique window treatment in the historic district. The storefront addition served as the town library from 1909 to 1956 and briefly as the town offices.

Several Second Empire style residential and institutional buildings are significant to the growth of the town center and its maritime economy after the mid-19th century. The Capt. Freeman Snow House on Commercial Street (1871, Map #123-222-15, MHC #F-84), Photo 9) is typical of the large comfortable homes built by men who had prospered in the maritime trade. The 2-1/2-story house has a high brick foundation, three-bay facade entrance, mansard roof, and narrow chimneys built for stove flues. Bay windows flank the center entrance, which has been built out as an enclosed entryway with a hipped roof. Windows contain 2-over-2 double-hung sash, and paired

Continued

United States Department of the Interior
National Park ServiceNational Register of Historic Places
Continuation SheetSection number 7 Page 11

Wellfleet Center Historic District, Mass.

brackets ornament the eaves and the cornice line of the bay windows. The Freeman Snow House is currently used as an art gallery and residence.

The former Wellfleet Savings Bank Building on Bank Street (Map #121-22-41a, MHC #E-68, Photo 10) was constructed in 1874 by Hansen and Peterson, off-Cape Builders. Richard Freeman, an important merchant and packet boat owner, was commissioned to purchase the lumber and other building materials, and Simeon Atwood, whose house overlooked the site, was appointed to deal with the hardwood interior finish. The bank building, situated on an incline northwest of the intersection of Bank, Commercial, and East Commercial Streets, is approached by six granite steps. The site is separated from the road by a fence of granite posts and replacement pipe rails. The 1 1/2-story building has a mansard roof of colored slate and a three-bay facade with entry in the end bay. A bracketed hood over the entrance shields a two-pane transom. First floor windows contain 2-over-2 sash and have a decorative broken-line architraves. Inset dormers have segmental-arched 2-over-2 sash and pedimented hoods. Exterior ornament also includes narrow corner pilasters and paired brackets under the eaves.

The Masonic Hall (1877, Map #121-22-28, MHC #E-66) is set on a steep incline north of the Bank Street-East Commercial Street intersection. The building is reached from East Commercial Street via a steep flight of stairs with a granite post fence and pipe railing. Masonic Lane, a narrow sandy lane extending south from Main Street, approaches the building from the rear. The 1 1/2-story Second Empire building has a three-bay facade with entrance in the center bay, a projecting tower with truncated steeple centered over the entrance, and a mansard roof of colored slates. The hall includes paired eave brackets, corner pilasters, and window hoods similar to the door and window hoods on the Wellfleet Savings Bank. A Masonic emblem appears on the tower over the entrance. The first floor is a hall reserved for general activities and the attic level contains the temple area. Masonic Hall is the only extant 19th-century meeting house in Wellfleet.

The mid-1880s consolidation of three buildings on Baker Avenue into a single large summer estate for Lorenzo Dow Baker marked the beginning of seasonal residency in Wellfleet Center. Belvernon

Continued

United States Department of the Interior
National Park ServiceNational Register of Historic Places
Continuation SheetSection number 7 Page 12

Wellfleet Center Historic District, Mass.

(ca. 1870, Map #120-22-93 b1 and -93 b2, MHC #1-153) is a sprawling Greek Revival residence located at the intersection of the paved (north-south) and unpaved (east-west) segments of Baker Avenue. Each of the three formerly detached units is frame 2-1/2 stories with a gable roof. The primary facade is oriented east, and consists of a three-bay elevation with an end-bay entry and round-arched window in the gable end. A one-story porch wraps around the south, east, and north walls. Rakeboards and a wide entablature are intact. The two rear units are oriented with their long elevations parallel to the unpaved portion of Baker Avenue. The front portion of the mansion house was constructed ca. 1870 by Will Atwood, son of the prominent merchant Simeon Atwood whose aforementioned Greek Revival residence is located further north on Baker Avenue.

The sole Gothic Revival house in the district, The Arbutus on Holbrook Avenue (ca. 1840, Map #120-22-84, MHC #A-12, Photo 18) was moved to Wellfleet Center for use as a summer home during the town's transformation into a seasonal resort community at the end of the 19th century. The 1 1/2-story, gable front cottage differs from other district houses of the same period by virtue of its vertical board tongue and groove siding, asymmetrical massing, side tower with wooden quoins, and curvilinear bargeboards. The house form is strikingly similar to cottages constructed in the Methodist campgrounds on Martha's Vineyard and Cape Cod in the mid-19th century, and was in fact moved to Wellfleet Center ca. 1900 from the abandoned Methodist campground in Yarmouth.

Also about the turn of the 20th century, town churches were constructed on Main Street in the Wellfleet Center. The Methodist Church (Map #121-22-MP. 4, MHC #G-127, Photo 16) was built in 1891 after an earlier church on the same site had been destroyed by fire. Clad in clapboards and shingles, the church is composed of two wide gabled sections, joined at a right angle and fitted with an entry tower. Each gable is ornamented by a large lancet-arched window with interlacing mullions. Stained glass windows were designed by Claire Leighton, a noted English artist who summered on the Cape in the 1940s and 1950s. The tower has a belfry surrounded by four pinnacles. Steeply pitched door hoods over the entrance and side door are supported by plain brackets. A handicap ramp recently built in front of the church is compatible with the original building in scale and materials.

Continued

United States Department of the Interior
National Park ServiceNational Register of Historic Places
Continuation SheetSection number 7 Page 13 Wellfleet Center Historic District, MA

The Catholic church, Our Lady of Lourdes (Map #120-22-71), was built by members of the parish in 1912. Designed in the Mediterranean style, this church is the only stuccoed building in the historic district. The small structure has round-arched windows and a center entry with roundheaded doorway set into a pilastered and pedimented porch at the gable end. The church was salvaged from the 1908 train wreck near Wellfleet's freight yard.

The historic district includes one contributing manufacturing building. The Cummings and Howe Pants Factory on Commercial Street (1878, Map #123-22-48a, MHC #E81, Photo 24) is a vernacular wood-frame building with a low-pitched gable roof and irregular fenestration. Constructed for use as a shoe factory, the building was used briefly by Cummings and Howe of Orleans as a pants factory. In succession the building has housed a shirt factory, a steel and die factory, and the local grain and fuel store. The factory was built near the railroad's freight yard, now a parking area, beside Duck Creek. No machinery or equipment survives from the 19th-century industrial ventures.

There are two unique structures in the district. Behind a Greek Revival residence on Main Street is the only remaining private Water Tower in Wellfleet Center (ca. 1890, Map #121-22-26, Photo 23). The wood-frame clapboarded structure is twenty-three feet tall. Inside is a covered wood water tank. Built over a well, the tower enclosed a gasoline pump to drive water up to the tank where gravity directed it into the house. A second frame structure is Uncle Tim's Bridge (MHC # D-900i, 1908) across Duck Creek. Connecting Wellfleet Center to reach the center without having to use the roundabout access of the old County Road to the east. It is called Uncle Tim's Bridge because Timothy Daniel's ship chandlery stood on the village side directly opposite the bridge. Repairs to the bridge in recent years have maintained the 1908 design.

A number of barns are located throughout the Wellfleet Center Historic District, particularly on streets with larger lots, such as Holbrook Avenue, Baker Avenue, and School Street. Several barns no longer contribute to the integrity of the district due to their conversion into seasonal housing or reuse for commercial purposes. Among the large intact barns is the Mulford Rich House barn on School Street (ca. 1890, Map #121-22-101a), which retains its

Continued

United States Department of the Interior
National Park ServiceNational Register of Historic Places
Continuation SheetSection number 7 Page 14

Wellfleet Center Historic District, Mass.

original door and loft opening and is now an antique shop. Across the street at the Newcomb Farm (ca. 1850, Map #121-22-22b) is a two-story former barn that is no longer contributing since its conversion for use as a rental cottage. Another relatively well-preserved barn faces Holbrook Avenue but accompanies a Main Street house (ca. 1850, Map #120-22-67, Photo 19). This barn, once a part of the Holbrook estate, is now is used as a garage, the center door has been placed on a hanger for easy opening and closing.

Several frame sheds in side or rear yards accompany residences throughout the district. Their locations are identified by lot number on the District Data Sheet. None are of sufficient size or architectural significance either to contribute to or detract from the integrity of the district, and consequently the sheds are not included in the count of contributing and noncontributing resources. Square or circular screened garden structures (all ca. 1975) figure prominently on a couple of residential properties and have been included in the resource count. Garages in the district are generally of wood-frame construction, and most appear to have been constructed at the rear of houselots between ca. 1920 and ca. 1960.

The district boundaries include several local landmarks, commemorative objects, and fences. The Town Pump (1885, MHC #D-901) at the intersection of East Commercial, Commercial, and Bank Streets, and the Flower Boat (ca. 1900, no map number, MHC #G-903) at the intersection of East, Main, and East Commercial Streets, are two prominent objects. On the lawn of Town Hall on Main Street are two noncontributing objects, a Cannon Monument (1975, Map #CR121-22-9, MHC #H-909) and a Plaque to the Pilgrims (1920, Map #CS121-22-9, MHC #0900002). A few fences survive in part, particularly the granite posts of the fences in front of the former Wellfleet Savings Bank and the Masonic Hall, a (ca. 1875) white picket fence that accompanies a Greek Revival house (Map #121-22-31, MHC #G-108) on Main Street.

Few buildings have been removed from the historic district since the early 20th century. A fire in 1976 destroyed a four-building block on the south side on Main Street between Bank Street and Holbrook Avenue, and another fire in early 1988 destroyed a 2-1/2-story Greek Revival house on the south side of East Commercial Street (Map

Continued

United States Department of the Interior
National Park ServiceNational Register of Historic Places
Continuation SheetSection number 7 Page 15

Wellfleet Center Historic District, Mass.

#121-22-63). In the 1930s a frame, two-story elementary school building on the northwest corner of Main Street and Ryder Court was condemned and subsequently removed. The most recent building demolition was twenty years ago, when the administration of the Congregational Church on Main Street had two buildings razed in order to create a parking area adjacent to the church. Demolished were the vacant high schools and a building then being used as a movie theater. The high school building had been built in 1866 north of School Street, in a spot central to all the outlying grammar schools. In response to shifting enrollment patterns, the school was moved in 1889, onto land in the central village owned by Dr. Thomas Stone, a long-time member of Wellfleet's school board. The high school was shingle-clad, 2 1/2 stories, with a pedimented gable roof and a single lancet window at the peak in the gable end. Hooded end-bay entries flanked a central window on the three-bay facade. The second floor had three windows with double architraves and 6-over-6 sash. The old movie house had had many earlier uses, but its date of construction and original use are unknown. The building was known as Union Hall when the Universalist Society bought it for religious meetings while the Universalists worshipped on the second floor.

Intrusions have little impact on the integrity of the historic district. The size, scale, materials, and design of recent buildings are generally sympathetic with their older neighbors. An important noncontributing building, the Town Hall on Main Street (1962, Map #CQ1221-22-9, MHC #H-143), is a reproduction of the Second Congregational Church building (1850) that had been moved into the district from South Wellfleet in 1913. The church was destroyed by fire in the mid-20th century, whereupon a reproduction was built. This reproduction burned in 1960. The only brick building in the district, the New England Telephone Building (Map #CX120-22-59), is a 1930s interpretation of the Cape Cod house located on the site of the aforementioned condemned elementary school. Other intrusions in the district are unobtrusive due to their locations. A frame kiln and pottery shop (1977, Map #BR121-22-70) on East Main Street has minimal visual impact due to its location below street level.

Historic buildings that have been substantially altered on the exterior constitute fifteen of the 126 noncontributing buildings in

Continued

United States Department of the Interior
National Park Service

National Register of Historic Places
Continuation Sheet

Section number 7 Page 16

Wellfleet Center, Historic District, Mass.

the district. Two buildings at the Duck Creek Inn on East Main Street are among the buildings that have been altered. The facade of a ca. 1870 Greek Revival house (Map #BL121-22-27, MHC #C-40) was reconfigured for use as a double cottage in 1975. Most alterations involve changes to the facade during the conversion of a building from its original use to another, most often from residential to commercial.

8. Statement of Significance

Certifying official has considered the significance of this property in relation to other properties:

 nationally statewide locallyApplicable National Register Criteria A B C DCriteria Considerations (Exceptions) A B C D E F G

Areas of Significance (enter categories from instructions)

ARCHITECTUREMARITIME HISTORYCOMMUNITY PLANNING & DEVELOPMENTRECREATION/ENTERTAINMENT: TOURISM

Period of Significance

ca.1830-1915

Significant Dates

N/A

Cultural Affiliation

N/A

Significant Person

N/A

Architect/Builder

N/A

State significance of property, and justify criteria, criteria considerations, and areas and periods of significance noted above.

The Wellfleet Center Historic District, Wellfleet, is a visually cohesive group of residential, commercial, and institutional buildings associated with the growth of Wellfleet Center from a small harbor village in the late-18th century to a flourishing maritime community in the second and third quarters of the 19th century. Containing approximately 119 acres in central Wellfleet, the densely settled district retains a village character, its narrow streets linking Duck Creek and adjacent maritime-related development with commercial and institutional buildings to the northeast and residences to the east, north, and west. Wellfleet Center became the focus of the town's commercial, specifically maritime, activities by the mid-19th century and the majority of the district's resources reflect the town's prosperity in those years. The district also documents Wellfleet Center's transformation into a summer resort community by the early 20th century, when seasonal residents and the Tourist trade bolstered a declining maritime economy. One hundred seventy-three buildings, two structures, and seven objects contribute to the district's architectural and historical integrity. Retaining integrity of location, design, setting, materials, workmanship, and association, the Wellfleet Center Historic District meets Criteria A, C and exceptions A and B of the National Register of Historic Places and is important on the local level.

Wellfleet comprises the historic northern precinct of the town of Nauset, incorporated in 1646 and renamed Eastham in 1651. The Plymouth Court had previously granted land on the outer Cape from Brewster to Truro to seven settlers in 1644, with the stipulation that they buy the land from Indian owners. After purchasing the land from the Wampanoag Indians, the purchasers granted themselves large acreage individually, but continued to hold much land in common. Settlers were attracted to the northern end of Eastham (now Wellfleet) by its good harbors and bountiful oyster beds, its fine bay fishing, and its outstanding shore-whaling. Although the northern community quickly developed a solid economic base, the

XX See continuation sheet

United States Department of the Interior
National Park ServiceNational Register of Historic Places
Continuation SheetSection number 8 Page 1

Wellfleet Center Historic District, Mass.

settlement further south (now Eastham) remained the town's religious and civic center. In 1694, the original purchasers extended ownership of the common land to new residents, and this larger group continued to divide the land among themselves.

In 1722 and 1723, the town of Eastham was divided into thirds, with two parishes carved out along the northern and southernmost boundaries: the North Parish, or Billingsgate (later Wellfleet); and the South Parish (later the town of Orleans, 1797). The original Billingsgate meetinghouse was located at Chequesset Neck in 1722, with a larger meetinghouse built at Duck Creek in 1725. In 1749, the Eastham town meeting conveyed to the Billingsgate parish ownership of all remaining public land in the northern third of the mother town. Residents of Billingsgate petitioned the General Court for political identity, which was granted to them in 1763, as the district of Wellfleet. The district of Wellfleet was made a town in 1775.

Wellfleet is bordered on the east by the Atlantic Ocean and on the west by Cape Cod Bay. Wellfleet's northern boundary with Truro (1709) was established with the creation of Nauset in 1646. The boundary with Eastham to the south, located in the vicinity of Blackfish Creek in 1763, was reestablished in 1847 further south at Hatches Creek, where it was drawn east to the ocean and west across Wellfleet Harbor out to Billingsgate Island. The water boundary caused much dispute over fishing rights between the two towns, and the line dividing each town's respective tidewaters was not definitely established until May 1887. [Guzzi] By 1935 Billingsgate Island had completely eroded.

In the 17th century, Wellfleet consisted of scattered settlements of subsistence farmers and fishermen. Concentrated settlements in the coastal portions of town were in evidence by the early-18th century, especially on the islands (Bound Brook, Billingsgate, and Great Island) on the western and southern edges of town, on Chequesset Neck, and along the mouth of Duck Creek on the harbor. Secondary inland settlements consisted of dispersed farmsteads and an occasional grist mill oriented along two north-south highways through Wellfleet, King's Highway and the County Road. King's Highway, passing east of the historic district, was a major regional highway which by 1720 connected Eastham to Truro and later to

Continued

United States Department of the Interior
National Park ServiceNational Register of Historic Places
Continuation SheetSection number 8 Page 2

Wellfleet Center Historic District, Mass.

Provincetown. Important through the end of the 18th century as a critical communication artery, King's Highway diminished in significance only with the establishment of the County Road in the early-19th century. The County Road branched off from King's Highway at South Wellfleet, passing immediately east of the village at Duck Creek and on to Truro. U.S. Route 6, the major 20th-century auto route through Cape Cod, follows the path of the County Road through Wellfleet.

An increased emphasis on Wellfleet's maritime economy toward the end of the 18th century corresponded with a decline in the usefulness of the town's land for farming. Soil fertility on the Cape in general had suffered from intensified, long-term agricultural production and land clearing. After attempts to fertilize the land failed, the lack of adequate ground cover combined with the effects of wind and water caused severe erosion problems. By the end of the 18th century, shifting sands had left thousands of acres uncultivated. In 1800, Wellfleet, with large tracts of land unfit for cultivation, was the most barren town on the Cape with the exception of Provincetown. These changes in the character of the landscape contributed to a change in the patterns of agricultural production on the outer Cape. In Wellfleet, home vegetable gardens and limited farms were in evidence, but the dearth of fertile land, particularly along the eastern shore, made large-scale farming prohibitive. [MHC State Survey Team, pp. 228-232]

As early as the late-17th and early-18th centuries, farmers in Wellfleet supplemented their income by engaging in other pursuits, most commonly the maritime-oriented trades. Whaling, with its ancillary activities of ship chandlery and cooperage, became increasingly important. In the years before the Revolution, more than a score of whaling vessels sailed out of Wellfleet Harbor. A substantial part of the local fishing industry was the harvest of shellfish, including oysters, clams, scallops, mussels, and lobsters. Just before the Revolution, Wellfleet's famed oysters died from an unknown cause. This serious blow to the town's economy, coupled with Britain's embargo of the Cape, temporarily halted the town's prosperity. With the end of the Revolution, Wellfleet's oyster industry revived and became, with Whaling, an important source of income for the town. Large scale replanting of oysters began early in the 19th century when forty schooners

Continued

United States Department of the Interior
National Park ServiceNational Register of Historic Places
Continuation SheetSection number 8 Page 3

Wellfleet Center Historic District, Mass.

transported oysters from the Chesapeake Bay to Wellfleet. The transplanting of these oysters from Virginia took place annually after the epidemic. The Billingsgate oyster from Wellfleet dominated the New England oyster business by the mid-19th century. [MHC State Survey Team, p. 276] Markets for Wellfleet oysters included Boston, Portland, Newburyport, and Salem.

Fin fishery also prospered in Wellfleet after the Revolution. Cod and mackerel were the two principal catches of Wellfleet vessels that arrived at both Wellfleet Center and South Wellfleet. In 1837, 496 men were employed in fishing and thirty-nine ships were outfitted and maintained. Commercial wharves to support these vessels were developed first by individuals in the 1830s, and by 1853 they were being capitalized by as many as sixty shareholders. A ship yard established on Duck Creek south of the historic district produced seven schooners between 1848 and 1853. The yard employed carpenters, fitters, and riggers. In conjunction with the fishing industry, thirty-nine salt works were developed to produce the salt necessary for salting down catches. Known locations of salt works include Commercial Street south of the district, and the Blackfish Creek vicinity in South Wellfleet.

In the 1820s, Wellfleet grew at a rate unparalleled until the post-World War II years, with a population of 2,046 in 1830. The silting up of outer harbors at the western settlements beginning in the 1830s prompted a consolidation of the maritime trades and concomitant expansion of the village at Duck Creek. The streets near the harbor began to fill up with houses constructed in situ or moved in from outlying areas. A smaller maritime community began to prosper along Blackfish Creek in South Wellfleet during the same period.

The surge in maritime activity and improvement of shipping facilities translated into an economic boom for Wellfleet by mid-century, and the town reached its peak population of 2,411 in 1850. (From 1850 onward Wellfleet began a steady decline in population which was not significantly reversed until after World War II.) The general prosperity of the period from ca. 1830 to ca. 1870 was evidenced at Wellfleet Center by the expansion of retailing on Main Street, the establishment of the Wellfleet Savings Bank, the construction of private homes, and the relocation of dwellings and

Continued

United States Department of the Interior
National Park ServiceNational Register of Historic Places
Continuation SheetSection number 8 Page 4

Wellfleet Center Historic District, Mass.

other buildings to the center from outlying areas. Congregational, Methodist, and Universalist societies established churches at Wellfleet Center in the 1840s. At least two public schools, including a primary school and the town high school, were constructed just outside the historic district.

The infra-structure to support the maritime industry developed near the harbor in modest, sevicable buildings. Along Commercial Street were the businesses that served the fishing industry: the cooper, oil maker, chandler, and ship-fitter. Here too, were the insurers, the packing houses, and the fish merchants. The Wellfleet Marine Insurance Company building was located on Commercial Street in 1878 (Map #121-22-54, MHC #E-77). The building is known locally as the "Customs House," although Wellfleet in fact never had a customs house. Instead, in June 1830, Wellfleet was allowed a deputy customs collector whose place of business was his own residence. The building acquired its association as the customs house because the town's last deputy customs officer, Simeon Atwood, owned the building in the early 20th century.

With the prosperity came a stratification of society which was manifested in the historic district's architecture. As successful fishing brought larger investments in maritime commerce with fish-packing houses, marine insurance, and great commercial wharves, a managerial and investor class began to emerge. More elaborate houses reflected the business position or wealth of some members of the community. Construction of Cape Cod houses gradually gave way on certain streets to larger Federal, Greek Revival, and Second Empire style residences. Unusually large for its period in the district is the transitional Federal and Greek Revival style home of Capt. Jess Snow (ca. 1815, Map #123-22-2-, MHC #F-87, Photo 11) on Commercial Street, a well-known local ship master. The Noah Swett House, also on Commercial Street (1858, Map #123-22-38, MHC #F-97), is a 1-1/2-story Greek Revival cottage with a side ell, a house type commonly found in the Wellfleet Center district. Noah Swett was a broker of salt fish in Boston, New York, and Philadelphia. He was secretary of the local Marine Insurance Company as well as the local agent for Boston banks doing business in Wellfleet in the 1860s and 1870s. The second popular Greek Revival house form in the district during the mid-19th century was the 2 1/2 - story, three-bay, side-entry residence. One such house was built by Washington

Continued

United States Department of the Interior
National Park ServiceNational Register of Historic Places
Continuation SheetSection number 8 Page 5

Wellfleet Center Historic District, Mass.

Pierce, a marine insurance underwriter (1860, Map #121-22-87, MHC #D-62). In contrast to these homes, the district's more modest dwellings were associated with fishermen and boat handlers, such as Henry DeLory, James DeLory, and J. Harding, whose capes still stand on Commercial Street, and Nehemiah Paine, a net repairman who lived in a cape on Holbrook Avenue that was moved in from Bound Brook Island.

As commercial activities related directly to the fishing industry found their place along the shores of Duck Creek, the commercial needs of the growing population were met by stores on Main Street, located on a high bridge overlooking the harbor. Grocery stores, ice cream shops, barber shops, photographer's rooms, and dry goods stores sprang up in the second half of the 19th century. A small commercial and institutional focus at the intersection of Bank, Commercial, and East Commercial Streets by the late 1870s included a dry goods store, Wellfleet Savings Bank, the Wellfleet Marine Insurance Company buildings, and Masonic Hall. This focus shifted to Main street with continued infilling of the district, including the construction of fewer buildings specifically oriented to the maritime trades.

From circa 1870 to World War I, Wellfleet Center underwent a fundamental economic change. The Cape Cod Central Railroad had been extended to Wellfleet in 1870, and connected Wellfleet Center with Orleans fourteen miles south. Construction of the railroad dike across the mouth of Duck Creek sealed off the upper reaches of the harbor at Wellfleet Center, thus transforming the upper harbor from a busy maritime center into a backwater of salt marsh and tidal flats. New developments in nautical technology during the Civil War years had replaced the familiar fishing schooner with steam engines and metal-hulled vessels. Local entrepreneurs began a period of retrenchment, and risk capital grew tight. Wellfleet's population waned, with a decline of 276 people recorded twenty years after the population peaked in 1850. Young people began leaving the town for off-Cape jobs, stores were empty, some houses were abandoned, vessels stood idle at decaying wharves, and prosperity faded.

The town's concern that too many young residents were leaving to find work elsewhere prompted construction of the only manufacturing building in the historic district, the Cummings and Howe Pants

Continued

United States Department of the Interior
National Park ServiceNational Register of Historic Places
Continuation SheetSection number 8 Page 6

Wellfleet Center Historic District, Mass.

Factory (1878, Map #123-22-48a, MHC #E-81, Photo 24). At a 1877 town meeting, \$400 was appropriated to encourage a shoe manufactory to begin operations at the Center. The town pledged to appropriate this sum for five years, and to begin operations at the Center. The town pledged to appropriate this sum for five years, and to exempt such a manufactory from taxes for the same five years. Constructed on a Commercial Street site near the railroad's freight yard, the building was completed but the shoe factory never got underway. Cummings and Howe of Orleans used the building for a pants factory and by 1889 it was a shirt factory. In more recent years the building has housed a steel and die factory, and the local grain and fuel store.

The gradual decline in the town's prosperity did not affect all residents equally. For the fisherman or shipyard worker, whose livelihood depended on the sea, there were hard times. By contrast, Lorenzo Dow Baker, a Wellfleet resident who initiated the import of bananas to the United States from Jamaica in 1870 and later founded the United Fruit Company, purchased buildings on five acres at the center of the village in the mid-1880s for use as a summer estate. Belvernon on Baker Avenue (ca. 1870, Map #120-22-93b1, MHC #1-153) is a rambling Greek Revival Residence with an ell for servants (brought to Wellfleet from Baker's Jamaica Estate) and various outbuildings. Shortly thereafter, the president of the Wellfleet Savings Bank, Isaiah Young, built a large two-family house on Main Street (ca. 1890, Map #120-22-61B, MHC #H-144, Photo 17). And Judge Hiram Harriman in 1900 moved a small cottage (ca. 1840, Map #120-22-84, MHC #A-12) from the abandoned Methodist campground in Yarmouth to Holbrook for use as a summer home.

Tourism and seasonal visitors helped bolster Wellfleet's floundering economy. The railroad, which had contributed to the decline of the local maritime industry, brought new visitors. After a merger of the Cape Cod Railroad and the Old Colony Railroad in 1872, the Cape Cod Branch of the Old Colony line was extended fourteen miles north from Wellfleet Center through Truro to Provincetown. Residents took in summer boarders or rented their houses to summer visitors who arrived by train. Many larger residences became rooming houses or were divided into apartments. Some outbuildings such as barns and large sheds were remodeled for use as summer rentals. Lorenzo Dow Baker came home each summer with friends, business associates, and

Continued

United States Department of the Interior
National Park ServiceNational Register of Historic Places
Continuation SheetSection number 8 Page 7

Wellfleet Center Historic District, Mass.

servants. He purchased many properties in Wellfleet from owners who were no longer financially able to maintain them. Baker invested some of his United Fruit Company profits into the Chequesset Inn, built in 1883 on Mercantile Wharf in Wellfleet Harbor south of the historic district.

Tourism saved Wellfleet's economy in the lean years at the turn of the 20th century. New construction at Wellfleet Center, however, had virtually halted. Among the few new buildings constructed in the historic district were the Methodist Church built in 1891 to replace an earlier burned church and Our Lady of Lourdes, Catholic church (1912), both on Main Street. In 1913, the former Second Congregational Church building (ca. 1833) was relocated from south Wellfleet to the center for use as the town offices. The present Town Hall is a reproduction of the church building. By 1915, the end of the period of significance, Wellfleet Center was no longer the fishing and maritime-oriented community of previous centuries. The local mackerel industry was dead by 1905, and the town's oyster harvests continued to decline, dropping sharply from 16,000 barrels in 1916 to a mere 1,800 in 1926. By 1925, Wellfleet hit its population nadir of 786 persons.

Mobility afforded by automobile travel has prompted a resurgence of town expansion in recent decades. U.S. Route 6, an automobile corridor through the Cape Cod region, was completed by the mid-1920s and widened in the mid-1950s. As roads improved and the automobile began to dominate travel, cabins were built and cottage colonies and motels developed. Two inn complexes in the historic district--Holden Inn on Commercial Street and Duck Creek Inn on East Main Street--consist of historic residential buildings and outbuildings that were converted for inn use by the mid-20th century.

Infill construction in the district is extremely limited because so little space is available in the concentrated center. Noncontributing buildings, however, have minimal impact upon the integrity of the district. The size, scale, and materials of recently built homes are generally sympathetic with those of older buildings, and garages are modest and typically located at the rear of house lots. Of great concern is traffic congestion on the narrow streets in the summer season and the impact of parking demands created by an increase in the number of retail businesses.

Continued

United States Department of the Interior
National Park Service

**National Register of Historic Places
Continuation Sheet**

Section number 8 Page 8

Wellfleet Center Historic District, Mass.

Wellfleet's current population is 2,324 persons. A rapid upswing in the town's year-round as well as seasonal population has begun to exploit the historic character of Wellfleet Center, particularly in the commercial areas on Main Street and Commercial Street, where historic buildings are being converted to retail uses. While much of Wellfleet is included in the conservation area of the Cape Cod National Seashore, the Route 6 corridor that runs the length of Wellfleet and immediately east of the historic district is threatened by major commercial development. The town's most recent major development project is a new post office, office, and retail complex on Route 6 in South Wellfleet. Discussion of a proposed building moratorium on Cape Cod is currently underway.

CHIEFTAIN BOND
50% COTTON FIBER

United States Department of the Interior
National Park Service

National Register of Historic Places
Continuation Sheet

Section number 9 Page 1 WELLFLEET CENTER HISTORIC DISTRICT , MASS.

9. BIBLIOGRAPHICAL REFERENCES

Unpublished Sources:

Documents pertaining to moving a house: contract between Rich & Baker. Wellfleet Historical Society, 1853.

Massachusetts Historical Commission. Wellfleet Town Report and Inventory. Typescript, 1984.

Published Sources:

Connally, Ernest Allen. "The Cape Cod House: An Introductory Study." Journal of the Society of Architectural Historians, XIX (May 1960).

Deyo, Simeon, ed. History of Barnstable County, Massachusetts, 1620-1890. New York: H.W. Blake, 1890.

Guzzi, Paul, Secretary of State. Historical Data Relating to Counties, Cities and Towns in Massachusetts. Boston: Commonwealth of Mass, 1975.

Janes, E. C. I Remember Cape Cod. Brattleboro, VT: Stephen Crane Press, 1974.

Massachusetts Historical Commission State Survey Team. Historic and Archaeological Resources of Cape Cod and the Islands. Boston: MHC, 1987.

Rich, Earl. Cape Cod Echoes. Orleans, MA: Salt Meadow Publications, 1973.

_____. More Cape Cod Echoes. Orleans, MA: Salt Meadow Publications, 1978.

Stetson, Judy. Wellfleet: A Pictorial History. Wellfleet, MA 1963.

50% COTTON FIBER

United States Department of the Interior
National Park Service

National Register of Historic Places
Continuation Sheet

Section number 10 Page 1

Wellfleet Center Historic District, MA

10.
UTM REFERENCES:

Quad: Wellfleet, MA
Scale: 1:24,000
Zone: 19

<u>Point</u>	<u>Easting</u>	<u>Northing</u>
A	415140	4643450
B	415300	4643010
C	415000	4643200
D	414720	4643060
E	414590	4642950
F	414760	4642590
G	414590	4642480
H	414390	4642760
I	414230	4642820
J	414210	4643160
K	414180	4643300
L	414420	4643340
M	414580	4643350
N	414830	4643720
O	414880	4643690
P	414740	4643370
Q	415100	4643310
R	415110	4643410

United States Department of the Interior
National Park ServiceNational Register of Historic Places
Continuation Sheet

Wellfleet Center Historic District, Mass.

Section number PHOTO Page 1

Photographs:

Wellfleet Center Historic District
Wellfleet, Massachusetts
Photographer: Warren Seyfert
Location of Negative: Warren Seyfert
Box 276
So. Wellfleet, MA 02663

Date: September 1986

<u>Photo#</u>	<u>Description Of View</u>
1	South side of Main St. between Bank St. and Holbrook Ave.(West)
2	Reuben Higgins House, north side of Main St. (North)
3	Detail of jack knife carving on Cape House on Cross St.
4	Creek House, original elevation as seen from Dorcas Lane.(South)
5	Creek House, Federal facade facing Duck Creek. (Northwest)
6	Sarah Atwood House, north side of East Commercial Sst. (North)
7	Simeon Atwood Store, intersection of Bank and Commercial Streets. (Southwest)
8	Simeon Atwood House, west side of Baker Ave. near Bank St. intersection. (West)
9	Capt. Freeman Snow House, west side of Commercial St. (West)
10	Wellfleet Savings Bank, Bank St. at intersection with Baker Ave. (Southwest)
11	Capt. Jesse Snow House, west side of Commercial St.(West)

Continued

United States Department of the Interior
National Park Service

National Register of Historic Places
Continuation Sheet

Section number PHOTO Page 2

Wellfleet Center Historic District, Mass.

- 12 Dr. Thomas Stone House, north side of Main Street.(Northeast)
- 13 Former Advent Church of Truro, now Wellfleet Pottery building. East side of Commercial St.(West - Duck Creek in the background to the right)
- 14 Governor Bradford Apartments, west side of Commercial St. (Northwest)
- 15 Addition to Payne Higgins House, now Wellfleet Historical Society. North side of Main Street. (North).
- 16 Methodist Church, north side of Main Street. (Northwest)
- 17 Isaiah Young House, north side of Main Street. (Northwest)
- 18 The Arbutus (Judge Harriman House), east side of Holbrook Ave. at Baker Ave.(East)
- 19 Barn on east side of Holbrook Ave. (associated with Main St. property); (East)
- 20 Cape on east side of Commercial St. (Northeast)
- 21 Uncle Tim's Bridge between Wellfleet Center and Cannon Hill. (Southeast)
- 22 Hawes House, north side of East Commercial St. (North)
- 23 Water tower at rear of Main St. property at corner of Masonic Lane. (West)
- 24 Cummings and Howe Pants Factory building, east side of Commercial St. at intersection with Railroad Ave. (Northeast)
- 25 Former Hamblen Barn, later chandlery, east side of Commercial St. near intersection with Railroad Ave. (Northeast)

DISTRICT DATA SHEET
WELFLEET CENTER HISTORIC DISTRICT, WELFLEET, MA

MAP #	MHC #	HISTORIC NAME	STREET ADDRESS	DATE OF CONSTRUCTION	STATUS	STYLE	RESOURCE	
A	121-22-39	---	Baker Avenue (east)	ca. 1940	NC	---	B	
B	121-22-39a	---	Baker Avenue (east)	ca. 1930	NC	---	B	
C	121-22-45	---	Baker Avenue (east)	ca. 1920	NC	Col. Revival	B	
D E	120-22-82	I-151	Sim. Atwood Hse. barn garage	ca. 1855	C	Gk. Revival	B	
				ca. 1920	NC	---	B	
				ca. 1925	NC	---	B	
	120-22-88	I-152	Wm. Tubman Hse.	Baker Avenue (west)	ca. 1855	C	Gk. Revival	B
	120-22-93b1, 93b2	I-153	Belvernon servants quarters/outbuildings	Baker Avenue (west)	ca. 1870 ca. 1870	3C 3C	Gk. Revival ---	3B 3B
F	121-22-46	---	Baker Avenue (west)	ca. 1930	NC	---	B	
G	121-22-47a	---	Baker Avenue (west)	ca. 1940	NC	---	B	
H, I	120-22-87/2	---	Bell Cottages (2)	Baker Avenue (north)	ca. 1950	2NC	---	2B
J	120-22-86	I-157	R.B. Jenkins Hse. garage	1850s	C	Second Empire	B	
				ca. 1925	NC	---	B	
	120-22-81	I-154	Bowling Alley	Baker Avenue (north)	ca. 1900	C	vernacular	B
	120-22-85	I-158	---	Baker Avenue (north)	1870	C	Gk. Revival	B
ca. 1870					C	Gk. Revival	B	
K	120-22-92	---	Baker Avenue (south)	ca. 1930	NC	---	B	
	120-22-93	I-155	Rich House	Baker Avenue (south)	ca. 1870	C	Gk. Revival	B

L	120-22-93a	I-156	Hopkins House garage	Baker Avenue (south)	ca. 1850 ca. 1925	C NC	vernacular ---	B B
	120-22-91	I-159	--- garage	Baker Avenue (south)	ca. 1870 ca. 1925	C NC	Second Empire ---	B B
	121-22-30	E-67	---	Bank Street (north)	ca. 1860	C	Gk. Revival	B
N	121-22-29	---	---	Bank Street (north)	ca. 1930	NC	---	B
	121-22-41a	E-68	Wellfleet Savings fence	Bank Street (south)	1874 ca. 1874	C C	Second Empire ---	B 0
O	121-22-41a	---	---	Bank Street (south)	1951	NC	---	B
P	120-22-36, 37	---	S. Rich House garage	Chequessett Neck Road	ca. 1810 ca. 1925	C NC	Federal ---	B B
	123-22-36a, 37a	F-99	Bay View	Commercial St. (east)	1840s	C	Gk. Revival	B
	123-22-37	F-98	Chandlery	Commercial St. (east)	ca. 1850	C	Gk. Revival	B
Q	123-22-38	F-97	Noah Swett House garage	Commercial St. (east)	1858 ca. 1925	C NC	Gk. Revival ---	B B
	123-22-39	F-96	The Moorings 4 cottages	Commercial St. (east)	ca. 1870 ca. 1930	C 4NC	Queen Anne ---	B 4B
R, S, T, U	123-22-40	---	--- garage	Commercial St. (east)	ca. 1940 ca. 1940	NC NC	--- ---	B B
	123-22-40a	---	---	Commercial St. (east)	ca. 1960	NC	---	B
	123-22-41	F-95	---	Commercial St. (east)	1825-1830	C	Gk. Revival	B
Y Z	123-22-42	F-94	John Freeman Hse. garden house garage	Commercial St. (east)	ca. 1830 ca. 1975 ca. 1925	C NC NC	Gk. Revival --- ---	B St. B

AA	123-22-43	---	---	Commercial St. (east)	ca. 1930	NC	---	B
AB, AC	123-22-44	F-93	---	Commercial St. (east)	ca. 1855	C	Gk. Revival	B
			2 garages		ca. 1925	2NC	---	2B
	123-22-48a	E-81	Pants Factory	Commercial St. (east)	1878	C	vernacular	B
	123-22-4	E-80	Hamblen barn	Commercial St. (east)	ca. 1850	C	Gk. Revival	B
	121-22-49a	---	---	Commercial St. (east)	ca. 1900	2C	attached sheds	2B
	121-22-50	E-79	---	Commercial St. (east)	1895	C	Stick Style	B
D, AE, AF, AG	121-22-51, 51a	---	Mid-Cape Lumber	Commercial St. (east)	ca. 1930	4NC	---	4B
AH	121-22-52	---	Legion Hall	Commercial St. (east)	1920	NC	vernacular	B
	121-22-53	E-78	---	Commercial St. (east)	ca. 1850	C	Federal	B
	121-22-54	E-77	Wellfleet Marine Insurance Co. Bldg.	Commercial St. (east)	1878	C	Gk. Revival	B
	123-22-27	F-92	Doane House	Commercial St. (west)	ca. 1870	C	Gk. Revival	B
	123-22-25	F-91	---	Commercial St. (west)	ca. 1850	C	Gk. Revival	B
	123-22-24	F-90	---	Commercial St. (west)	ca. 1850	C	Gk. Revival	B
	123-22-23	F-89	Jas. DeLory Hse.	Commercial St. (west)	ca. 1840	C	Georgian	B
	123-22-21	F-88	Henry DeLory Hse.	Commercial St. (west)	1820	C	Federal	B
AI, AJ, AK	123-22-20	F-87	Capt. Jesse Snow 3 cottages	Commercial St. (west)	ca. 1815 ca. 1950	C 3NC	Federal/Gk. Rev. ---	B 3B

123-22-51

AL AM	123-22-19	F-86	Holden Inn	Commercial St. (west)	1840-1850	C	Gk. Revival	B
		F-85	Freeman-Underhill House		1830s	C	Gk. Revival	B
			annex		1928	NC	utilitarian	B
			garage shed		1930s	NC	utilitarian	B
AN	123-22-15	F-84	Cpt. Freeman Snow barn	Commercial St. (west)	1871 ca. 1930	C NC	Second Empire ---	B B
AO	123-22-13	F-83	Ryder House garage	Commercial St. (west)	ca. 1840 ca. 1925	C NC	Gk. Revival ---	B B
	123-22-12a	F-82	---	Commercial St. (west)	1850s	C	Gk. Revival	B
	123-22-2	E-76	Bradford Apts. outhouse	Commercial St. (west)	1858 late 19th	C C	Gk. Revival ---	B B
AP	123-22-1, 1b	E-75	Collins House garden house sheds (2)	Commercial St. (west)	ca. 1860 ca. 1975	C NC	Federal ---	B St.
	121-22-48	E-74	---	Commercial St. (west)	ca. 1850	C	Gk. Revival	B
AQ AR	120-22-98	---	--- henhouse	off Commercial St. (west)	ca. 1970 1979	NC NC	--- ---	B B
	121-22-47c	E-73	---	Commercial St. (west)	ca. 1810	C	Georgian	B
	121-22-47b	E-72	--- shed	Commercial St. (west)	ca. 1860	C	Gk. Revival	B
	121-22-44	E-71	Higgins Store	Commercial St. (west)	ca. 1840	C	Gk. Revival	B
AS	121-22-43, 44	---	Nickerson Lumber	Commercial St. (west)	ca. 1920	NC	utilitarian	B
	121-22-42	E-70	--- barn/garage	Commercial St. (west)	ca. 1810 ca. 1850	C C	Georgian ---	B B
	121-22-41	E-69	S. Atwood Store	Commercial St. (west)	1832	C	Gk. Revival	B

AT	120-22-35	J-162	Pentinen House garage	Cross Street (east)	ca. 1860 ca. 1925	C NC	Gk. Revival ---	B B
	120-22-25	J-163	Isaac Pierce Hse. fence	Cross Street (west)	ca. 1850 ca. 1850	C C	Federal ---	B O
	120-22-24	J-164	E. Atwood House shed	Cross Street (west)	ca. 1775	C	Georgian	B
AU	120-22-23	J-165	N.C. Snow House cottage	Cross Street (west)	ca. 1880 ca. 1920	C NC	Greek Revival ---	B B
	120-22-22	J-166	---	Cross Street (west)	ca. 1850	C	Federal	B
	121-22-64	C-34	Creek House	Dorcas Lane	ca. 1800	C	Federal	B
---	D-901	Town Pump	East Commercial Street	1885	C	---	O	
121-22-28	E-66	Masonic Hall fence	E. Commerc'l St. (north)	1877 ca. 1877	C C	Second Empire ---	B O	
121-22-37	D-65	Blacksmith Shop	E. Commerc'l St. (north)	ca. 1900	C		B	
121-22-89	D-64	Daniels House shed	E. Commerc'l St. (north)	1855	C	Gk. Revival	B	
AV	121-22-88	D-63	Timothy Daniel studio/garage	E. Commerc'l St. (north)	ca. 1800 ca. 1870	C NC	Georgian altered Gk. Rev.	B B
	121-22-87	D-62	Wash. Pierce Hse. vacant house on lot garage	E. Commerc'l St. (north)	ca. 1860 ca. 1870 ca. 1925	C C NC	Gk. Revival Gk. Revival ---	B B B
AX	121-22-86	D-61	Linnell House garage/bike shop	E. Commerc'l St. (north)	ca. 1870 ca. 1950	C NC	Second Empire ---	B B
	121-22-85	D-60	Hawes House	E. Commerc'l St. (north)	ca. 1860	C	Gk. Revival	B

AY	121-22-84	D-59	Capt. Kennedy Hse. garage/apartment	E. Commerc'l St. (north)	ca. 1850 ca. 1925	C NC	Second Empire ---	B B
AZ	121-22-83	D-58	Sarah Atwood Hse. garage	E. Commerc'l St. (north)	ca. 1860 ca. 1925	C NC	Gk. Revival ---	B B
	121-22-82	D-57	Elmer Rich House	E. Commerc'l St. (north)	ca. 1845	C	Gk. Revival	B
BA	121-22-55	---	Fire Station	E. Commerc'l St. (south)	ca. 1930	NC	---	B
BB	121-22-57	---	---	E. Commerc'l St. (south)	ca. 1950	NC	---	B
BC	121-22-60	---	---	E. Commerc'l St. (south)	ca. 1930	NC	---	B
	121-22-61	D-56	Obadiah Rich Hse. 2 sheds	E. Commerc'l St. (south)	ca. 1860	C	Gk. Revival	B
BD	121-22-62	D-55	Knowles House cottage/garage	E. Commerc'l St. (south)	ca. 1860 ca. 1925	C NC	Gk. Revival ---	B B
BE BF	121-22-65	D-53	"By the Way" Inn garage	E. Commerc'l St. (south)	ca. 1860 ca. 1925	NC NC	altered Gk. Rev. ---	B B
	121-22-66	D-52	--- shed	E. Commerc'l St. (south)	ca. 1860	C	Gk. Revival	B
BG	121-22-67	D-51	Cherry Stone	E. Commerc'l St. (south)	ca. 1850	NC	altered shed	B
BH	121-22-111	C-50	--- garage	East Main St. (north)	ca. 1855 ca. 1925	C NC	Gk. Revival ---	B B
	121-22-110	C-49	Kemp House	East Main St. (north)	1820	C	Georgian	B
BI BJ	121-22-109	C-48	Pierce House gallery building	East Main St. (north)	1830-1850 ca. 1950	NC NC	altered Gk. Rev. ---	B B
	121-22-108	C-47	S. Nicholson Hse.	East Main St. (north)	ca. 1770	C	Georgian	B

BK BL BM BN	121-22-107	C-42	Holbrook-Hawes	East Main St. (north)	ca. 1810	C	Federal	B
		C-44	restaurant		1930s	NC	---	B
		C-45	Duck Creek Tavern		ca. 1870	NC	altered Gk. Rev.	B
		C-41	Saltworks House		1939	NC	---	B
		C-40	stable		1880, 1975	NC	---	B
	121-22-104	C-39	Carpenter Shop	East Main St. (north)	1800-1850	C	vernacular	B
BO	121-22-103	C-37	Wilmarth Cottage	East Main St. (north)	1800	C	Georgian	B
			garden house tool shed		ca. 1975	NC	---	St.
	121-22-102	G-115	---	East Main St. (north)	ca. 1860	C	---	B
			2 sheds					
BP	121-22-72	C-46	Cong. Parsonage	East Main St. (south)	ca. 1830	C	Gk. Revival	B
			cottage		ca. 1920	NC		B
BQ	121-22-71	---	---	East Main St. (south)	ca. 1930	NC	---	B
BR	121-22-70	C-38	---	East Main St. (south)	ca. 1820	C	Federal	B
			kiln and pottery shop		1977	NC		B
BS	121-22-68	C-36	Myrtle Bank	East Main St. (south)	ca. 1775	C	Georgian	B
			garage/apartment		ca. 1950	NC	---	B
	---	G-903	Flower Boat	East Main Street	ca. 1900	C	---	O
	121-22-68a	C-35	---	Higgins Lane	ca. 1800	C	Federal	B
			shed					
	122-22-30	A-20	Chubbock House	Holbrook Ave. (east)	ca. 1865	C	Gk. Revival	B
BT	122-22-34	A-19	Neh. Paine Hse.	Holbrook Ave. (east)	ca. 1775	C	Georgian	B
			garage		ca. 1925	NC	---	B
	122-22-35	A-18	D.Y. Newcomb Hse.	Holbrook Ave. (east)	ca. 1820	C	Georgian	B
			shed					

BU	120-22-96	A-17	Floyd Young Hse. garage	Holbrook Ave. (east)	ca. 1820 1950s	C NC	Georgian ---	B B
	120-22-95	A-16	Cedar Tree Cottage	Holbrook Ave. (east)	ca. 1870	C	Gk. Revival	B
	120-22-94	A-15	Hickman House	Holbrook Ave. (east)	ca. 1860	C	Gk. Revival	B
	120-22-90	A-14	G.W. Nickerson Hse.	Holbrook Ave. (east)	ca. 1800	C	Federal	B
	120-22-89	A-13	Harriman Hse. barn	Holbrook Ave. (east)	ca. 1850 ca. 1850	C C	Gk. Rev./Ital. Gk. Revival	B B
	120-22-84	A-12	The Arbutus	Holbrook Ave. (east)	ca. 1840	C	Gothic Revival	B
	120-22-83	A-11	F.A. Wiley House	Holbrook Ave. (east)	ca. 1860	C	Gk. Revival	B
	120-22-80	A-10	M.D. Holbrook Hse. barn cottage	Holbrook Ave. (east)	ca. 1870 ca. 1870 1976	C C NC	Gk. Revival --- ---	B B B
BV	120-22-79	---	---	Holbrook Ave. (east)	1962	NC	---	B
				garage	ca. 1962	NC	---	B
BW BX	120-22-70	A-9	J.W. Holbrook Hse. cottages (2) garage	Holbrook Ave. (east)	ca. 1780	C	Georgian	B
					1950s	2NC	---	2B
					1950s	NC	---	B
CB CC	120-22-68	---	---	Holbrook Ave. (east)	ca. 1940	NC	---	B
				garage	ca. 1940	NC	---	B
CD	122-22-6	A-22	Curran Cattle Barn shed	Holbrook Ave. (west)	1920-1921	NC	Col. Revival	B
CE	122-22-5	A-8	Morning Glory	Holbrook Ave. (west)	1838, 1870	NC	alt. Sec. Emp.	B
	122-22-4	A-7	The Springfield barn (now cottage)	Holbrook Ave. (west)	1867 1870	C C	Gk. Rev./Ital. vernacular	B B

	120-22-48	A-6	Hiram Hopkins Hse. Holbrook Ave. (west) shed	1860	C	Gk. Revival	B
CF	120-22-9	A-5	Nathan Nicholson garage/apartment	ca. 1800 ca. 1950	C NC	Georgian ---	B B
	120-22-47	A-4	Geo. W. Nickerson Holbrook Ave. (west)	ca. 1840/70	C	Gk. Revival	B
CG	120-22-46	A-3	J.H. Rich House barn (now cottage)	ca. 1850 ca. 1930	C NC	Gk. Revival ---	B B
CH	120-22-45	A-2	--- garage	ca. 1865 ca. 1925	C NC	Gk. Revival ---	B B
CI	120-22-44b	---	--- Holbrook Ave. (west)	1974	NC	---	B
CJ	120-22-44a	---	--- Holbrook Ave. (west)	ca. 1950	NC	---	B
CK	120-22-34a	---	--- Holbrook Ave. (west)	ca. 1950	NC	---	B
	120-22-34	A-1	R. Holbrook Hse. Holbrook Ave. (west)	ca. 1870	C	Gk. Revival	B
CL	121-22-97	---	--- Main Street (north)	ca. 1920	NC	Col. Revival	B
CM CN	121-22-95	G-116	D.B. Holbrook Hse. barn/antique shop shed	ca. 1850 ca. 1850	NC NC	altered Gk. Rev. altered barn	B B
	121-22-94	G-117	Isaac Freeman shed	1871	C	Italianate	B
CO	121-22-92	G-118	Dr. Stone House barn/cottage	1861 ca. 1861	C NC	Italianate altered barn	B B
	121-22-91	G-119	Congreg. Church Main Street (north)	1850, 1879	C	Gk. Revival	B
	121-22-90a	G-120	--- Main Street (north)	ca. 1850	C	Gk. Revival	B

CP 121-22-90	G-121	---	Main Street (north)	ca. 1850	NC	altered Gk. Rev.	B
121-22-19a	G-122	---	Main Street (north)	ca. 1830	C	Gk. Rev. barn	B
121-22-19	G-123	---	Main Street (north)	ca. 1820	C	Federal	B
121-22-M. P. 4	G-126	Method. Parsonage	Main Street (north)	1840s	C	Gk. Revival	B
121-22-M. P. 3	G-127	Methodist Church	Main Street (north)	1891	C	Shingle	B
121-22-12	G-128	R. Higgins House sheds (2)	Main Street (north)	ca. 1800	C	Federal	B
121-22-5, 6	G-131	Payne Higgins Hs.	Main Street (north)	ca. 1830	C	Gk. Revival	B
	G-132	Historical Society (addition)		1870	---	Italianate	---
121-22-4	G-133	---	Main Street (north)	ca. 1870	C	Gk. Revival	B
		tool shed					
121-22-3	G-134	---	Main Street (north)	ca. 1890	C	Italianate	B
121-22-2	G-135	---	Main Street (north)	ca. 1870	C	Gk. Revival	B
121-22-1	---	---	Main Street (north)	ca. 1930	C	---	B
CQ 121-22-9	H-143	W'fleet Town Hall	Main Street (north)	1962	NC	1850 repro.	B
CR	---	Cannon Mon't.		1975	NC	---	O
CS	---	Pilgrim Plaque		1920	NC	---	O
120-22-61b	H-144	Isaiah Young Hse.	Main Street (north)	ca. 1890	C	Colonial Rev.	B
CT	H-145	barn		1890, 1963	NC	altered barn	B
120-22-64	H-146	---	Main Street (north)	ca. 1840	C	Gk. Revival	B
	H-147	---		ca. 1860	C	Gk. Revival	B
120-22-62	H-148	Freemen House	Main Street (north)	ca. 1870	C	Gk. Revival	B
CU		garage		ca. 1925	NC	---	B
CV		trailer		ca. 1965	NC	---	B

	120-22-60b	H-149	---	Main Street (north)	ca. 1850	C	Gk. Revival	B
CW	120-22-60	H-150	Sam. W. Kemp Hse. barn/store	Main Street (north)	ca. 1870 ca. 1870	C NC	Gk. Revival altered. Gk. Rev.	B B
CX	120-22-59	---	---	Main Street (north)	ca. 1930	NC	Cape reproduct.	B
	121-22-81	G-102	Anchorage	Main Street (south)	ca. 1840	C	Gk. Revival	B
	121-22-80	G-103	Kelley House	Main Street (south)	ca. 1840	C	Gk. Revival	B
CY	121-22-79	---	---	Main Street (south)	ca. 1925	NC	---	B
CZ	121-22-78	---	---	Main Street (south)	ca. 1950	NC	---	B
DA	121-22-77	---	---	Main Street (south)	ca. 1950	NC	---	B
	121-22-76	G-104	---	Main Street (south)	ca. 1800	C	Federal	B
DB	121-22-75	---	---	Main Street (south)	1960s	NC	---	B
	121-22-74	G-105	Whit Holbrook Hs.	Main Street (south)	ca. 1840s	C	Gk. Revival	B
PC	121-22-33	G-106	--- office garage	Main Street (south)	1825 ca. 1906 1920	C C NC	Federal Col. Revival ---	B B B
	121-22-32	G-107	---	Main Street (south)	ca. 1820	C	Gk. Revival	B
	121-22-31	G-108	--- picket fence	Main Street (south)	ca. 1860 ca. 1875	C C	Gk. Revival ---	B O
	121-22-26	G-112	--- water tower	Main Street (south)	ca. 1860 ca. 1890	C C	Gk. Revival ---	B St.
	121-22-25	G-113	---	Main Street (south)	ca. 1850	C	Gk. Revival	B
DD	121-22-23	---	---	Main Street (south)	ca. 1940	NC	---	B

DE	121-22-24	G-114	Atwood-Taylor Hse garage	Main Street (south)	ca. 1870 ca. 1925	C NC	Gk. Revival ---	B B
DF	120-22-78	---	---	Main Street (south)	ca. 1920	NC	utilitarian	B
DG	120-22-77	---	---	Main Street (south)	ca. 1920	NC	Col. Revival	B
	120-22-76	H-136	---	Main Street (south)	ca. 1900	C	vernacular	B
	120-22-75a	H-137	Snow's Shop	Main Street (south)	ca. 1870	C	Gk. Revival	B
	120-22-75	H-138	Dry Goods Store	Main Street (south)	ca. 1840	2C	Gk. Revival	2B
	120-22-74	H-139	---	Main Street (south)	ca. 1840	C	Gk. Revival	B
	120-22-73	H-140	---	Main Street (south)	ca. 1840	C	Gk. Revival	B
	120-22-71	---	Our Lady of Lourdes	Main Street (south)	1912	C	Mediterranean	B
DH	120-22-69	---	---	Main Street (south)	ca. 1965	NC	---	B
	120-22-67	H-141	---	Main Street (south)	ca. 1850 ca. 1850	C C	Gk. Revival ---	B B
	120-22-66	H-142	Holbrook's Store	Main Street (south)	1866	C	Gk. Revival	B
DI	120-22-33	---	---	Main Street (south)	ca. 1950	NC	---	B
	120-22-32	J-160	---	Main Street (south)	ca. 1860 ca. 1860	C C	Gk. Revival Gk. Revival	B B
	120-22-31	J-161	Oliver House shed	Main Street (south)	ca. 1850	C	Gk. Revival	B
	120-22-21	J-167	Nelson Dyer House	Main Street (south)	1860-1870	C	Gk. Revival	B
	121-22-36	G-109	---	Masonic Lane (east)	ca. 1900	C	Gk. Revival	B
	121-22-36a	G-110	---	Masonic Lane (east)	ca. 1900	C	vernacular	B

	121-22-27	G-111	--- fence tool shed	Masonic Lane (west)	ca. 1810 ca. 1890	C C	Federal ---	B 0
DJ	123-22-5	---	---	Railroad Ave. (north)	ca. 1930	NC	---	B
DK	122-22-31	M-221	--- garage	Railroad Ave. (north)	ca. 1870 ca. 1925	C NC	Gk. Revival ---	B B
	122-22-32	M-222	Burden House shed	Railroad Ave. (north)	ca. 1875	C	Gk. Revival	B
DL	123-22-9	M-214	--- garage	Railroad Ave. (south)	ca. 1890 ca. 1925	C NC	Gk. Revival ---	B B
	123-22-8	M-215	Holbrook's	Railroad Ave. (south)	ca. 1900	C	vernacular	B
DM	123-22-7	M-216	Landerkin House garage shed	Railroad Ave. (south)	ca. 1870 ca. 1925	C NC	Second Empire ---	B B
	122-22-28	M-220	Canary Cottage shop tool shed	Railroad Ave. (south)	1880-1890 ca. 1900	C C	Gk. Revival vernacular	B B
DN	122-22-30	---	---	Railroad Ave. (south)	ca. 1930	NC	---	B
DO	122-22-33	M-223	Nathan Rich Hse. garage	Sandy Avenue	ca. 1750 ca. 1925	C NC	Georgian ---	B B
DP	121-22-100	---	---	School Street (east)	ca. 1930	NC	utilitarian	B
DQ	121-22-101	B-25	Penniman House cottage	School Street (east)	1820-1860 1980	C NC	Gk. Revival ---	B B
	121-22-101a	B-27	Mulford Rich Hse. barn/gift shop	School Street (east)	ca. 1810 ca. 1890	C C	Georgian utilitarian	B B

DR	201-22-6	B-31	Chamberlin House garage	School Street (east)	ca. 1820 ca. 1925	C NC	Federal ---	B B
	201-22-5	B-33	Apgar House	School Street (east)	1820-1860	C	Gk. Revival	B
DS DT	121-22-22	B-23	Wm. Newcomb Hse. cottage chain-link fence	School Street (west)	ca. 1850 1935 1940	C NC NC	Gk. Revival --- ---	B B O
DU	121-22-22b	B-24	Newcomb Farm barn	School Street (west)	ca. 1810 ca. 1850	C NC	Federal altered barn	B B
DV	121-22-22c	B-26	Solomon Laha Hse. garage	School Street (west)	1820-1860 ca. 1925	C NC	Gk. Revival ---	B B
DW	121-22-22d	---	---	School Street (west)	1950s	NC	---	B
	201-22-11	B-30	Charlie Davis Hse. shed	School Street (west)	1840-1858	C	Gk. Revival	B
DX	201-22-10	B-29	Rogers House garage/kennel	School Street (west)	ca. 1810 ca. 1925	C NC	Federal ---	B B
DY	201-22-9	B-28	Tavern	School Street (west)	ca. 1860	NC	altered Gk. Rev.	B
DZ	201-22-7	---	---	School Street (west)	ca. 1950	NC	---	B
	201-22-46	B-32	Lombard House shed	School Street (west)	ca. 1820	C	Federal	B
EA	121-22-74a	---	---	Whit's Lane (east)	ca. 1950	NC	---	B
EB	121-22-35	---	---	Whit's Lane (west)	ca. 1950	NC	---	B
		D-900	Uncle Tim's Bridge	across Duck Creek	1908	C	---	St.

KEY:

C = contributing, NC = noncontributing, B = building, O = object, St. = structure

NOTES:

1. Map numbers correspond to the assessor's maps for the Town of Wellfleet. The first two numbers indicate the sheet number, and the last number is the lot number. Example: 120-22-60b is Sheet 120-22, Lot 60b. The abbreviation "M.P." refers to a subplan known as Methodist Plan on the north side of Main Street. Since the Wellfleet assessor's maps are aerial maps and thus difficult to read, intrusions are indicated on the District Data Sheet with letters preceding the map numbers, from A to Z, then AA to AZ, BA to BZ, etc.

2. The buildings in the Wellfleet Center Historic District do not have street numbers. Streets are arranged alphabetically on the district data sheet. Generally, the data sheet records buildings beginning from Duck Creek to the southeast. Properties on north-south streets are listed beginning on the east side, from south to north, then the west side, from south to north. Properties on east-west streets begin with the north side of the street from east to west, then the south side of the street from east to west. Exceptions: 1) The listing of East Commercial Street picks up where Commercial Street ends (at Bank Street). 2) Baker Avenue is a T-shaped road consisting of a paved way running north to south and an unpaved way running east to west. Buildings on the paved way are listed first in the data sheet.

3. A number of undistinguished sheds located throughout the district are shown on the District Data Sheet but are not included in the total count of contributing and noncontributing resources.

VACANT/UNDEVELOPED LOTS (31 total)

Baker Avenue: (east) 121-22-45; (north) 120-22-100; (south) 120-22-97a, 120-22-97b, 120-20-90a
 Commercial Street: (east) 121-22-49; (west) 123-22-14, 123-22-27b, 123-22-27a, 123-22-9a, 121-22-47d
 East Commercial: (north) 121-22-37a; (south) 121-22-56, 121-22-58, 121-22-59, 121-22-63
 East Main Street: (north) 121-22-105; (south) 121-22-73
 Higgins Lane: 121-22-68b
 Holbrook Avenue: (east) 120-22-99, 120-22-unmarked (labeled "Town of Wellfleet"), 120-22-97
 Main Street: (north) 120-22-63; south 120-22-72
 Masonic Lane: (east) 121-22-34
 Railroad Avenue: (north) 123-22-6
 Sandy Avenue: (north) 122-22-1a, 120-22-1c, 120-22-98
 School Street: (west) 121-22-19c, 121-22-22a

NUMBER OF RESOURCES WITHIN WELLEET CENTER HISTORIC DISTRICT

	<u>Contributing</u>	<u>Noncontributing</u>
Buildings	173	126
Structures	2	3
<u>Objects</u>	<u>7</u>	<u>3</u>
Total	182	132

UNITED STATES DEPARTMENT OF THE INTERIOR
NATIONAL PARK SERVICE

NATIONAL REGISTER OF HISTORIC PLACES
EVALUATION/RETURN SHEET

REQUESTED ACTION: NOMINATION

PROPERTY Wellfleet Center Historic District
NAME:

MULTIPLE
NAME:

STATE & COUNTY: MASSACHUSETTS, Barnstable

DATE RECEIVED: 7/21/89 DATE OF PENDING LIST: 8/02/89
DATE OF 16TH DAY: 8/18/89 DATE OF 45TH DAY: 9/04/89
DATE OF WEEKLY LIST:

REFERENCE NUMBER: 89001147

NOMINATOR: STATE

REASONS FOR REVIEW:

APPEAL: N DATA PROBLEM: N LANDSCAPE: N LESS THAN 50 YEARS: N
OTHER: N PDIL: N PERIOD: N PROGRAM UNAPPROVED: N
REQUEST: N SAMPLE: N SLR DRAFT: N NATIONAL: N

COMMENT WAIVER: N

ACCEPT RETURN REJECT 8/21/89 DATE

Entered in the
National Register

ABSTRACT/SUMMARY COMMENTS:

RECOM./CRITERIA _____
REVIEWER _____
DISCIPLINE _____
DATE _____

DOCUMENTATION see attached comments Y/N see attached SLR Y/N

CLASSIFICATION

count resource type

STATE/FEDERAL AGENCY CERTIFICATION

FUNCTION

historic current

DESCRIPTION

architectural classification
 materials
 descriptive text

SIGNIFICANCE

Period Areas of Significance--Check and justify below

Specific dates Builder/Architect
Statement of Significance (in one paragraph)

summary paragraph
 completeness
 clarity
 applicable criteria
 justification of areas checked
 relating significance to the resource
 context
 relationship of integrity to significance
 justification of exception
 other

BIBLIOGRAPHY

GEOGRAPHICAL DATA

acreage verbal boundary description
 UTM's boundary justification

ACCOMPANYING DOCUMENTATION/PRESENTATION

sketch maps USGS maps photographs presentation

OTHER COMMENTS

Questions concerning this nomination may be directed to

Phone _____

Signed _____ Date _____



Wellfleet's Greek Revival Photo #1
Main Street (72-75A - sheet 120722)

Greek Revival Main Street
Wellfleet Sept. 86
Negative with Seyfert (cf. below)
No. 1 of 25
View looking west along street

WELLFLEET CENTER HISTORIC
DISTRICT, WELLFLEET, MA
PHOTO 1 of

(Greek Revival House)

Main St.

Wellfleet, MA

1986

W. Seyfert

Box 276

So. Wellfleet, MA 02663

W. SEYFERT
BOX 276
S WELLFLEET, MA. 02663

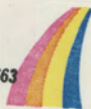



Federal style, Main Street, Wellfleet
Photo 2 #12 sheet 121-22

Blue Gateways

Sept. 86

Main Street, Wellfleet.
Photographer has negative

Photo 2 of 25
Facing north, to front of house

WELLFLEET CENTER HISTORIC
DISTRICT, WELLFLEET, MA
PHOTO 2

W. SEYFERT
BOX 276
S WELLFLEET, MA. 02663





Front Door - Pacific Northwest carrying
Cape moved from Bond Street
to Cross Street
84 - Sheet 120 - 122
Photo # 3

E. Atwood House Sept. 86
Cross Street, Wellfleet
Negative with Seyfert(cf. below)
No. 3 of 25
View of east-facing front door

Warren C Seyfert
Box 276
S Wellfleet MA 02663

WELLFLEET CENTER HISTORIC
DISTRICT, WELLFLEET, MA
PHOTO 3



3/4 Cape moved from Griffith's Island to site off
East Commercial Street - Rear side view
Photo 4 (64 - sheet 121-22) Wellfleet

By the Way Sept. 86
East Commercial Street, Wellfleet
Negative with Seyfert (cf. below)
No. 4 of 25
View of rear and side of house

WELLFLEET CENTER HISTORIC
DISTRICT, WELLFLEET, MA
PHOTO 4

W. SEYFERT
BOX 276
S WELLFLEET, MA. 02663



$\frac{3}{8}$ Cape Waded from Grinnell's Island to site
88 E. Convent St. Front view
Photo 5 - Cat. Sheet 121-22



WELLFLEET CENTER HISTORIC
DISTRICT, WELLFLEET, MA

PHOTO 5

Creek House

Commercial St East - off -

View of So. Facing Hse

W. Seyfert

Box 276

So. wellfleet 02663

9/86

Creek House Sept. 86
off East Commercial Street
Wellfleet

Negative with Seyfert (cf. below)
View of south-facing house



W. SEYFERT
BOX 276
S WELLFLEET, MA. 02663



1 1/2 story Greek Revival, E. Commercial st.
Wellsfleet
83-Sheet 121-22 Photo #6

Atwood House Sept. 8
E. Commercial St., Wellfleet
Negative with Seyfert (cf. below)
No. 6 of 25
View of South-facing house

WELLFLEET CENTER HISTORIC
DISTRICT, WELLFLEET, MA
PHOTO 6

W. SEYFERT
BOX 276
S WELLFLEET, MA. 02663





Simon Atwood Store, Commercial Street
Wellfleet
1832

41 - sheet 121-22 Photo #7

Simeon Atwood Store Sept 1986
Commercial Street, Wellfleet
Negative with Seyfert (cf. below)
No. 7 of 25
View of store, corner of Bank St.

WELLFLEET CENTER HISTORIC
DISTRICT, WELLFLEET, MA
PHOTO 7

Simeon Atwood Store
Commercial St.
Wellfleet
View of Store - corner bank



W. Seyfert
Box 276
So. Wellfleet, MA 02663

9/1986



Simons Ketchum House, Westfield, C. 1855
#82 - Sheet 120-122 Photo #8

WELLFLEET CENTER HISTORIC
DISTRICT, WELLFLEET, MA
PHOTO 8

Simeon Atwood House
Baker Ave
Wellfleet

W. Seyfert
Box 276
So. Wellfleet, MA 02663

9/1986

Simeon Atwood House Sept. 86
Baker Ave. Wellfleet
Negative with Seyfert (cf. below)
No. 8 of 25
View of east-facing house

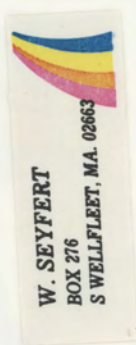



2½ story Second Empire style house
Camden Street, Weymouth
(15-sheet 123-22) Photo 9

Captain Freeman Snow House Sept 86
Commercial Street, Wellfleet
Negative with Seyfert (cf. below)
No. 9 of 25
View of east-facing house

WELLFLEET CENTER HISTORIC
DISTRICT, WELLFLEET, MA
PHOTO 9

W. SEYFERT
BOX 276
S WELLFLEET, MA. 02663





Old Wellfleet Savings Bank Building
Wellfleet's Bank Street
41a-Sheet 121-22 Photo 10

Wellfleet Savings Bank Sept. 86
Bank Street, Wellfleet
Negative with Seyfert (cf. below)
No. 10 of 25
View of north-facing building

WELLFLEET CENTER HISTORIC
DISTRICT, WELLFLEET, MA
PHOTO 10

Wellfleet Savings Bank
Bank St.
Wellfleet

W. Seyfert
Box 276

So. Wellfleet 02663

W. SEYFERT
BOX 276
S WELLFLEET, MA. 02663



9/86



Transitional Federal style house, c1820
Commercial Street, Wellfleet
20 - sheet 123-22 Photo # 11

Captain Jesse Snow House Sept.86
Commercial Street, Wellfleet
Negative with Seyfert(cf.below)
No. 11 of 25
View of east-facing house

WELLFLEET CENTER HISTORIC
DISTRICT, WELLFLEET, MA
PHOTO 11

Capt. Jesse Snow House
Commercial St.
Wellfleet, MA

W. Seyfert

Box 276

So. Wellfleet 02663

W. SEYFERT
BOX 276
S WELLFLEET, MA. 02663



9/86



~~1861- Dr. Stone's Horse~~ Main Street
Wellfleet
92 Sheet 121-22 Photo 12

Dr. Stone's House Sept.1986
Main-Street, Wellfleet
Negative with Seyfert(cf.below)
No.12 of 25
View of south-facing house

WELLFLEET CENTER HISTORIC
DISTRICT, WELLFLEET, MA
PHOTO 12

W. SEYFERT
BOX 276
S WELLFLEET, MA. 02663





Wellfleet Pottery, Commercial St.
Wellfleet
Photo 13 37 sheet 123-22

Roller Skating Rink Sept.86
Commercial Street, Wellfleet
Negative with Seyfert(cf.below)
No. 13 of 25
View of west-facing house

WELLFLEET CENTER HISTORIC
DISTRICT, WELLFLEET, MA
PHOTO 13

W. SEYFERT
BOX 276
S WELLFLEET, MA. 02663





Apartments for fishermen, 1858
Commercial St., Wellfleet
2 - Sheet 123-22 Photo 14

Bradford Apartments Sept.86
Commercial Street, Wellfleet
Negative with Seyfert(cf.below)
No.14 of 25
View of east-facing apartments

WELLFLEET CENTER HISTORIC
DISTRICT, WELLFLEET, MA
PHOTO 14

Bradford Apts.
Commercial St
Wellfleet -

W. Seyfert
Box 276
S. Wellfleet 02663

9/86





Park of multi-owner buildings
Main St., Wellfleet
5 Sheet 121-22 Photo 15

WELLFLEET CENTER HISTORIC
DISTRICT, WELLFLEET, MA
PHOTO 15

Historical Society Museum
Main St.
Wellfleet

9/1986

W. Seyfert
Box 276
So. Wellfleet
02663

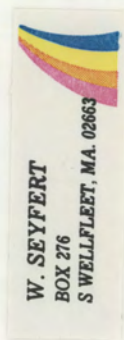

Historical Society Museum
Main Street, Wellfleet Sept. 1986
Negative with Seyfert (cf. below)
No. 15 of 25
View of south-facing building



Methodist Church Building, 1891
Wellfleet
3-Sheet 121-22 Photo 16

WELLFLEET CENTER HISTORIC
DISTRICT, WELLFLEET, MA
PHOTO 16

Methodist Church
Main St.
Wellfleet
1986

W. Seyfert
Box 276

So. Wellfleet 02663

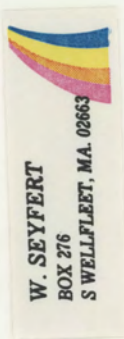

Methodist Church Sept. 1986
Main Street, Wellfleet
Negative with Seyfert (cf. below)
No. 16 of 25
Entrance faces to the south



Colonial Revival, Main St., Wellfleet
Ferdia Young House
61b - sheet 120-122 photo 17

Governor Cox's House (Young House)
Main Street, Wellfleet
Negative with Seyfert(cf.below)
No. 17 of 25
View of south-facing house
Sept. 1986

WELLFLEET CENTER HISTORIC
DISTRICT, WELLFLEET, MA
PHOTO 17

W. SEYFERT
BOX 276
S WELLFLEET, MA. 02663





Carpenter Gothic, Halbrook Avenue
Wellfleet
84-Sheet 120-22 Photo 18

The Arbutus Sept. 1986
Holbrook Avenue, Wellfleet
Negative with Seyfert(cf.below)
No. 18 of 25
View of south-facing house

WELLFLEET CENTER HISTORIC
DISTRICT, WELLFLEET, MA
PHOTO 18

The Arbutus
Holbrook Ave.
Wellfleet

1986

W. Seyfert

Box 276

So. Wellfleet 02663

W. SEYFERT
BOX 276
S WELLFLEET, MA. 02663





Barn facing Holbrook Avenue but part of
Main Street property
67 - Sheet 120 - 22 Photo 19

Barn Sept. 1986
Holbrook Avenue, Wellfleet
Negative with Seyfert(cf.below)
No. 19 of 25
View of west-facing building

WELLFLEET CENTER HISTORIC
DISTRICT, WELLFLEET, MA

PHOTO 19

Barn

Holbrook Ave

Wellfleet

1986

W. Seyfert

Box 276

So. Wellfleet, 02663

W. SEYFERT
BOX 276
S WELLFLEET, MA. 02663





An old Cape, Commercial street
Wellfleet
42-sheet 121-22 Photo 20

Commercial Street, Wellfleet
Negative with Seyfert(cf.below)
No. 20 of 25
View of east-facing house
Sept. 1986

WELLFLEET CENTER HISTORIC
DISTRICT, WELLFLEET, MA
PHOTO 20

Commercial St.
Wellfleet
1986

W. Seyfert
Box 276

So. Wellfleet 02663

W. SEYFERT
BOX 276
S WELLFLEET, MA. 02663

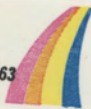



A Wellfleet landmark Photo 21
Between 58+59 on sheet 121-22

Uncle Tim's Bridge Sept.
Commercial Street, Wellfleet
Negative with Seyfert (cf. below)
No. 21 of 25
View from north end of bridge

WELLFLEET CENTER HISTORIC
DISTRICT, WELLFLEET, MA
PHOTO 21

W. SEYFERT
BOX 276
S WELLFLEET, MA. 02663





Typical 2 1/2 story Greek Revival
E. Commercial Street, Wall Street
85 - Street 131 - 23
photo 22

WELLFLEET CENTER HISTORIC
DISTRICT, WELLFLEET, MA
PHOTO 22

Hawes House
East Commercial St.
Wellfleet

1986

W. Seyfert
Box 276
So. Wellfleet 02663

Hawes House
1986, Sept.
East Commercial St. Wellfleet
Negative with Seyfert (cf. below)
No. 22 of 25
View of south-facing house

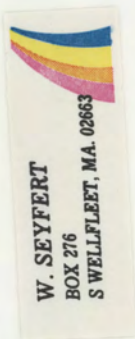



Water Tower, Wellfleet
26-sheet 121-22 Photo 23

WELLFLEET CENTER HISTORIC
DISTRICT, WELLFLEET, MA

PHOTO 23

Water Tower

Main St.

W. Seyfert

Box 276

So. Wellfleet 02663

9/1986

Water Tower Sept. 1986
Main Street, Wellfleet
Negative with Seyfert (cf. below)
No. 23 of 25
Location behind dwelling





An 1878 Industrial Building
Wellfleet
48a sheet 123-22 photo 24

Pants Factory Sept. 1986
Commercial Street, Wellfleet
Negative with Seyfert(cf.below)
No. 24 of 25
Industrial Building

WELLFLEET CENTER HISTORIC
DISTRICT, WELLFLEET, MA
PHOTO 24

Pants Factory
Commercial St.
Wellfleet
1986

W. SEYFERT
BOX 276
S WELLFLEET, MA. 02663



W. Seyfert
Box 276
So. Wellfleet 02663



An old commercial building is
— severe Greek Revival style —
4 - sheet 12-22 photo 25

Lobster Hut Sept. 1986
Commercial Street, Wellfleet
Negative with Seyfert(cf.below)
No. 25 of 25
Commercial Building

WELLFLEET CENTER HISTORIC
DISTRICT, WELLFLEET, MA
PHOTO 25

W. SEYFERT
BOX 276
S WELLFLEET, MA. 02663





SCALE 1:24,000
2016 19

A	415140	4643450
B	415300	4643010
C	415000	4643200
D	414720	4643060
E	414590	4642950
F	414460	4642590
G	414590	4642480
H	414390	4642760
I	414230	4642820
J	414210	4643160
K	414180	4643300
L	414420	4643340
M	414580	4643350
N	414830	4643720
O	414880	4643690
P	414740	4643370
Q	415100	4643310
R	415110	4643410

Mapped, edited, and published by the Geological Survey
Control by USC&GS and Massachusetts Geodetic Survey
Culture and drainage in part compiled from aerial photographs
taken 1938. Topography by planetable surveys 1941. Revised 1958
Hydrography compiled from USC&GS charts 580 (1954),
581 (1955), and 1208 (1955)
Polyconic projection. 1927 North American datum
10,000-foot grid based on Massachusetts coordinate system,
mainland zone
1000-meter Universal Transverse Mercator grid ticks,
zone 19, shown in blue

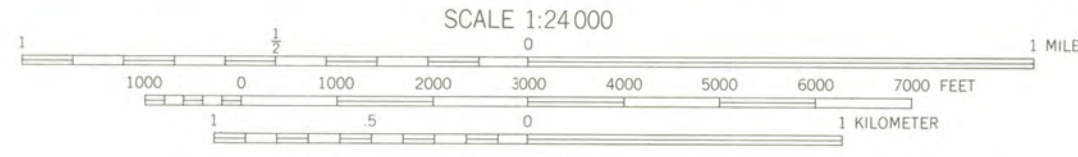
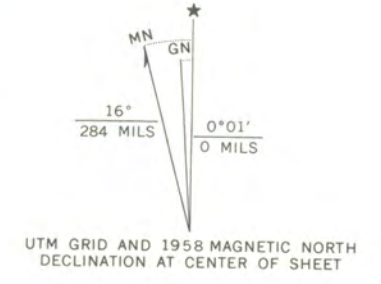

CONTOUR INTERVAL 10 FEET
DATUM IS MEAN SEA LEVEL
DEPTH CURVES AND SOUNDINGS IN FEET—DATUM IS MEAN LOW WATER
SHORELINE SHOWN REPRESENTS THE APPROXIMATE LINE OF MEAN HIGH WATER
THE MEAN RANGE OF TIDE IS APPROXIMATELY 7 FEET IN ATLANTIC OCEAN
AND 10 FEET IN WELLFLEET HARBOR

THIS MAP COMPLIES WITH NATIONAL MAP ACCURACY STANDARDS
FOR SALE BY U. S. GEOLOGICAL SURVEY, WASHINGTON 25, D. C.
A FOLDER DESCRIBING TOPOGRAPHIC MAPS AND SYMBOLS IS AVAILABLE ON REQUEST



ROAD CLASSIFICATION

Heavy-duty	Light-duty
Medium-duty	Unimproved dirt
U.S. Route	

WELLFLEET, MASS.
N4152.5—W6957.5/7.5
1958
AMS 6967 1 NE—SERIES V814

162

SHEET 120-22
REVISIONS

JUNE, 1968
DEC., 1977
MAR., 1984
JUNE, 1985
JUNE, 1986

WELLFLEET CENTER
HISTORIC DISTRICT
WELLFLEET, MASS.
CORRECTED DISTRICT
BOUNDARIES IN RED



ASSESSORS MAP

TOWN OF WELLFLEET
BARNSTABLE COUNTY
MASSACHUSETTS

PHOTO-IDENTIFIED AND COMPILED
BY

NEW ENGLAND SURVEY
SERVICE INC.
ENGINEERS AND SURVEYORS
566 ATLANTIC AVE.
BOSTON, MASS.

DRAWN
A M
CHECKED
P L Mc
DATE
17 NOV 64
SCALE
1" = 100'

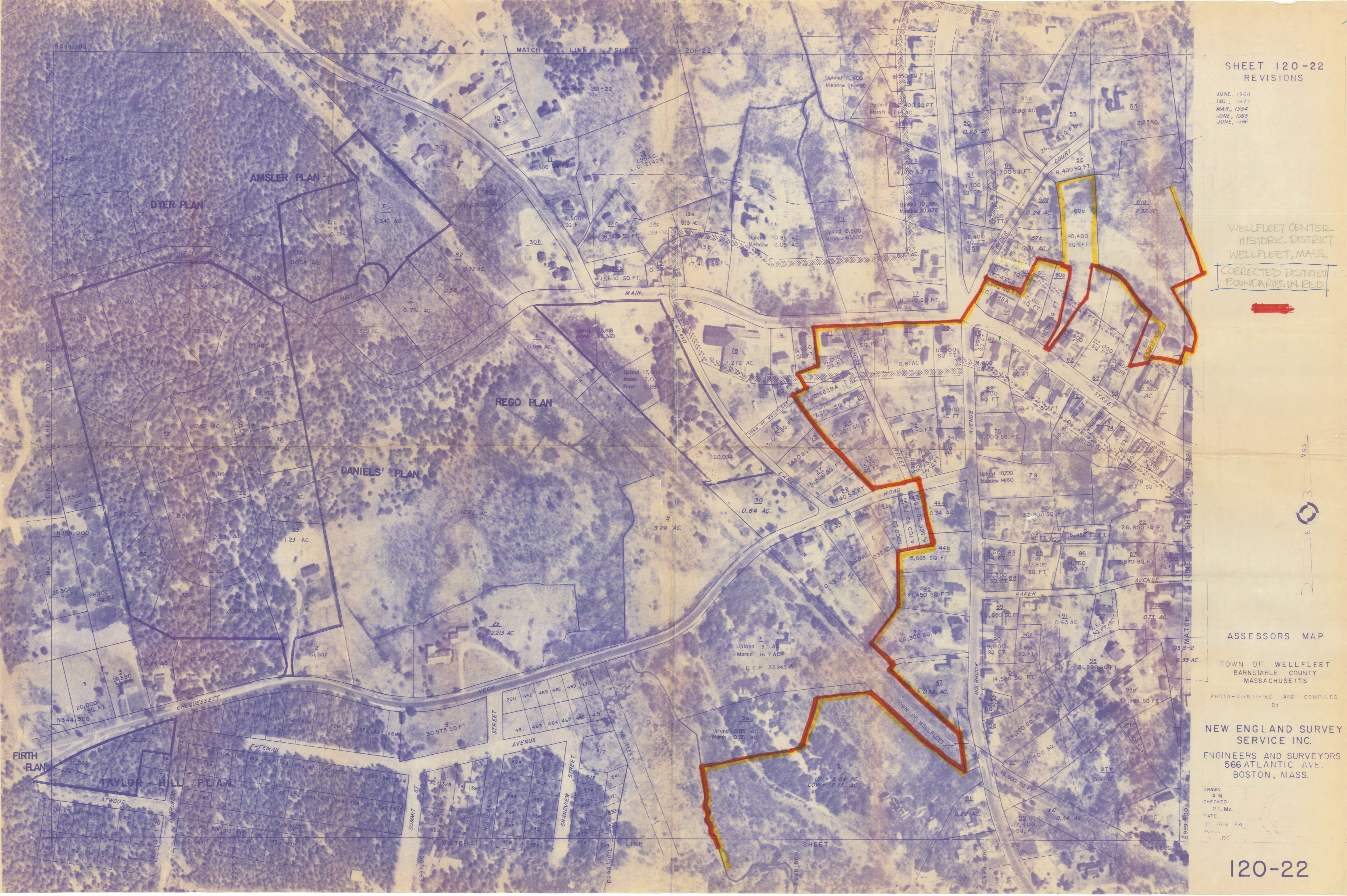

SHEET 121-22
REVISIONS

JUNE, 1968
DEC., 1977
MAR., 1984
JUNE, 1985
JUNE, 1986

WELLFLEET CENTER
HISTORIC DISTRICT
WELLFLEET, MASS.
CORRECTED DISTRICT
BOUNDARIES IN RED



ASSESSORS MAP

TOWN OF WELLFLEET
BARNSTABLE COUNTY
MASSACHUSETTS

PHOTO-IDENTIFIED AND COMPILED
BY

NEW ENGLAND SURVEY
SERVICE INC.
ENGINEERS AND SURVEYORS
566 ATLANTIC AVE.
BOSTON, MASS.

DRAWN
A.M.
CHECKED
R.L.Mc
DATE
17 NOV '64
SCALE:
1" = 100'



121-22



JUNE, 1968
DEC., 1977
MAR., 1984
JUNE, 1985
JUNE, 1986

WELLFLEET CENTER
HISTORIC DISTRICT
WELLFLEET, MASS.
CORRECTED DISTRICT
BOUNDARIES IN RED



ASSESSORS MAP

TOWN OF WELLFLEET
BARNSTABLE COUNTY
MASSACHUSETTS

PHOTO-IDENTIFIED AND COMPILED
BY

NEWENGLAND SURVEY
SERVICE INC.
ENGINEERS AND SURVEYORS
566 ATLANTIC AVE.
BOSTON, MASS.

DRAWN
A.M.
CHECKED
R.L.Mc.
DATE
5 Nov 1964
SCALE
1" = 100'

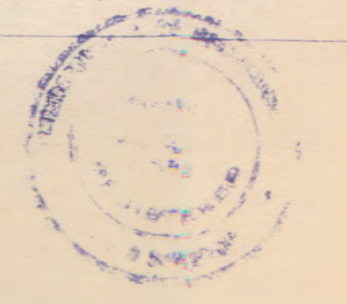

Sheet 122-22

JUNE, 1968
DEC., 1977
MAR., 1984
JUNE, 1985
JUNE, 1986

WELLFLEET CENTER
HISTORIC DISTRICT
WELLFLEET, MASS.
CORRECTED DISTRICT
BOUNDARIES IN RED

ASSESSORS MAP

TOWN OF WELLFLEET
BARNSTABLE COUNTY
MASSACHUSETTS

PHOTO IDENTIFIED AND COMPILED
BY

NEW ENGLAND SURVEY
SERVICE INC.
ENGINEERS AND SURVEYORS
566 ATLANTIC AVE.
BOSTON, MASS.

DRAWN A.M.
CHECKED R.L.Mc.
DATE NOV 64
SCALE 1" = 100'

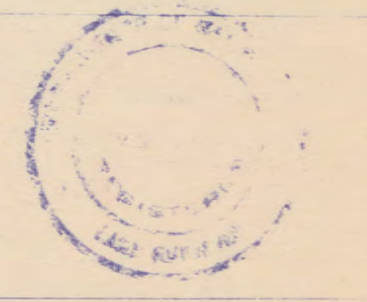

NOYES PLAN

"TREASURE COVE"
PLAN

TOWN OF WELLFLEET

E1,000,000

E1,000,000

N342,100

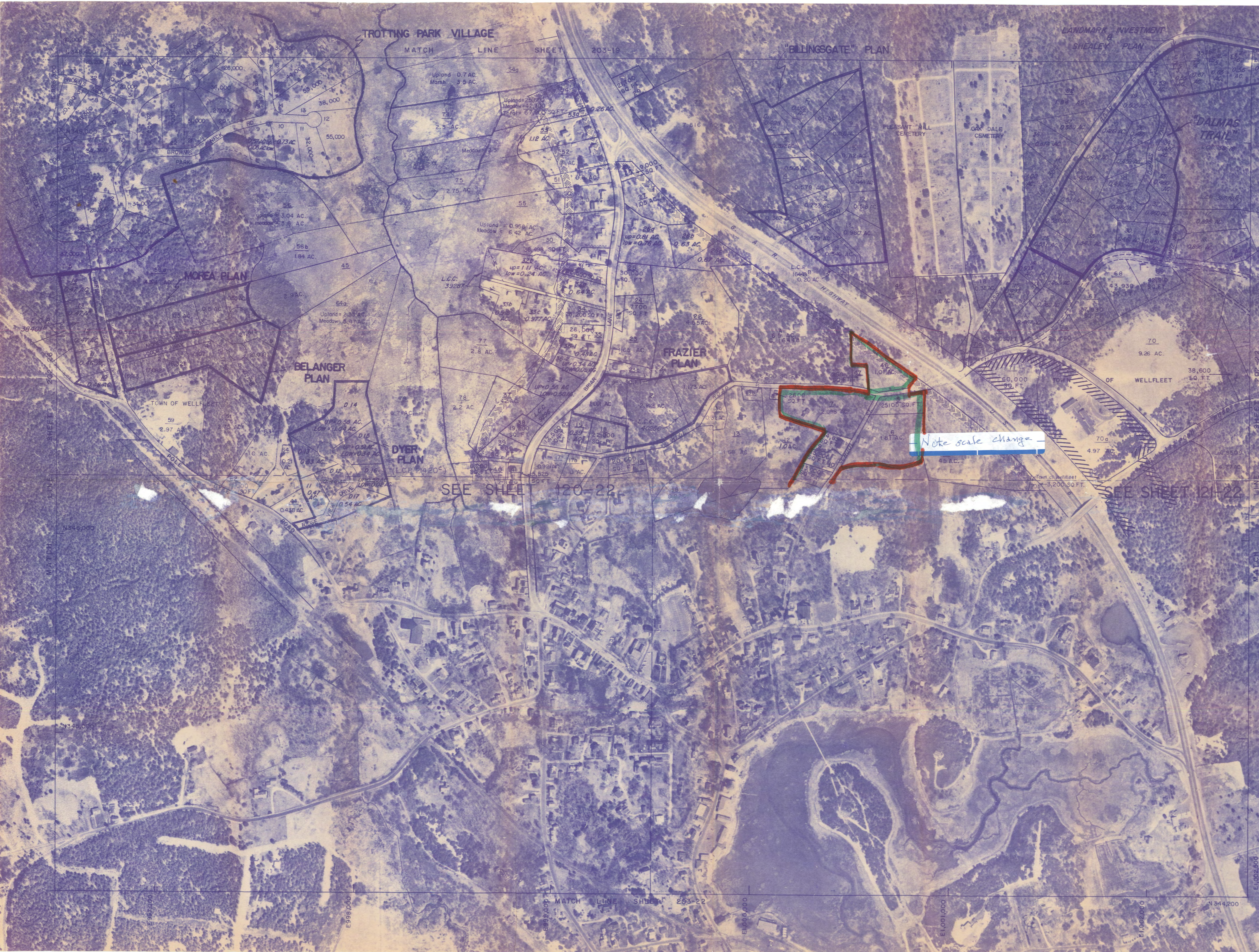

SHEET 201-22 REVISIONS

JUNE, 1968
 DEC., 1977
 MAR., 1984
 JUNE, 1985
 JUNE, 1986

WELLFLEET CENTER
 HISTORIC DISTRICT
 WELLFLEET, MASS.
 (NOTE SCALE CHANGE)
 CORRECTED DISTRICT
 BOUNDARIES IN RED

Note scale change



ASSESSORS MAP

TOWN OF WELLFLEET
 BARNSTABLE COUNTY
 MASSACHUSETTS

PHOTO-IDENTIFIED AND COMPILED
 BY

**NEW ENGLAND SURVEY
 SERVICE INC.**

ENGINEERS AND SURVEYORS
 566 ATLANTIC AVE.
 BOSTON, MASS.

DRAWN	AM
CHECKED	R.L.M.
DATE	10 NOV '64
SCALE	1" = 200'

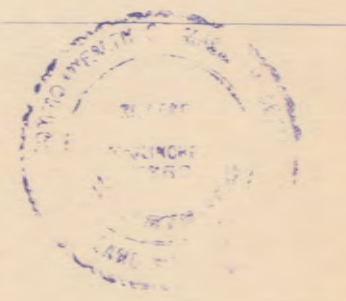



JUL 21 1989

NATIONAL
REGISTER

July 17, 1989

Carol Shull
National Register of Historic Places
Department of the Interior
National Park Service
P.O. Box 37127
Washington, DC 20013-7127

Dear Ms. Shull:

Enclosed you will find the following nomination forms:

Provincetown, (Barnstable), Provincetown Historic District

Wellfleet, (Barnstable), Wellfleet Center Historic District

It has been voted eligible by the State Review Board and have been signed by the State Historic Preservation Officer. Owners were notified of pending State Review Board consideration 30-75 days before the meeting and were afforded the opportunity to comment. Comments received to date are attached to the nomination form.

Sincerely,

Anne E. Tait
Acting National Register Director
Massachusetts Historical Commission

Enclosure: